



# Kerr-McGee Oil & Gas Onshore LP

A subsidiary of Anadarko Petroleum Corporation

1099 18<sup>th</sup> Street  
Denver, CO 80202  
720-929-6000

November 30, 2017

Matt Lepore  
Director, Colorado Oil and Gas Conservation Commission  
Department of Natural Resources  
The Chancery Building  
1120 Lincoln Street, Suite 801  
Denver, CO 80203

Re: **30 Day Certification Letter - 318A.e**  
ZELDA 25-6HZ (Doc No. 401455502)  
Township 2 North, Range 65 West  
Section 25: NWNW  
Unit Acreage: 720 Acres  
Unit Spacing: 01N65W SEC 1: N2NW  
02N65W SEC 25: W2; SEC 36: W2  
Weld County, Colorado

Dear Director Lepore:

Kerr-McGee Oil and Gas Onshore LP (“KMG”) hereby certifies that a thirty (30) day notice was sent to 3 mineral owners by certified mail. We have not received any objections to such well location, proposed spacing unit, or additional producing formation from the 2 notices. The undeliverable notices have a combined working interest of 2.34%. KMG hereby respectfully requests approval of this well.

If you have any questions or issues regarding this permit, please contact me at (720) 929-6907.

Sincerely,

**Kerr-McGee Oil and Gas Onshore LP**

A handwritten signature in blue ink, appearing to read 'Craig Richardson'.

Craig Richardson  
Regulatory Analyst II

Enclosure

# ZELDA 25-6HZ WELLBORE SPACING UNIT

DISTANCE FROM COMPLETED  
PORTION OF WELLBORE TO  
NEAREST UNIT BOUNDARY= 906'

**SURFACE LOCATION: NAD 83**  
GROUND ELEVATION= 4900.0'  
LATITUDE= 40.115729°  
LONGITUDE= -104.617332°  
LATITUDE= 40°06'56.625"  
LONGITUDE= -104°37'02.396"  
**HEEL LOCATION: NAD 83**  
LATITUDE= 40.113373°  
LONGITUDE= -104.616391°  
LATITUDE= 40°06'48.142"  
LONGITUDE= -104°36'59.008"  
**BOTTOM HOLE LOCATION: NAD 83**  
LATITUDE= 40.086584°  
LONGITUDE= -104.616162°  
LATITUDE= 40°05'11.702"  
LONGITUDE= -104°36'58.183"

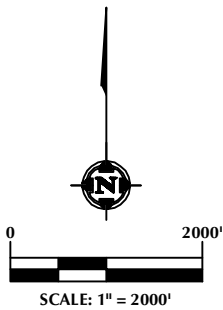
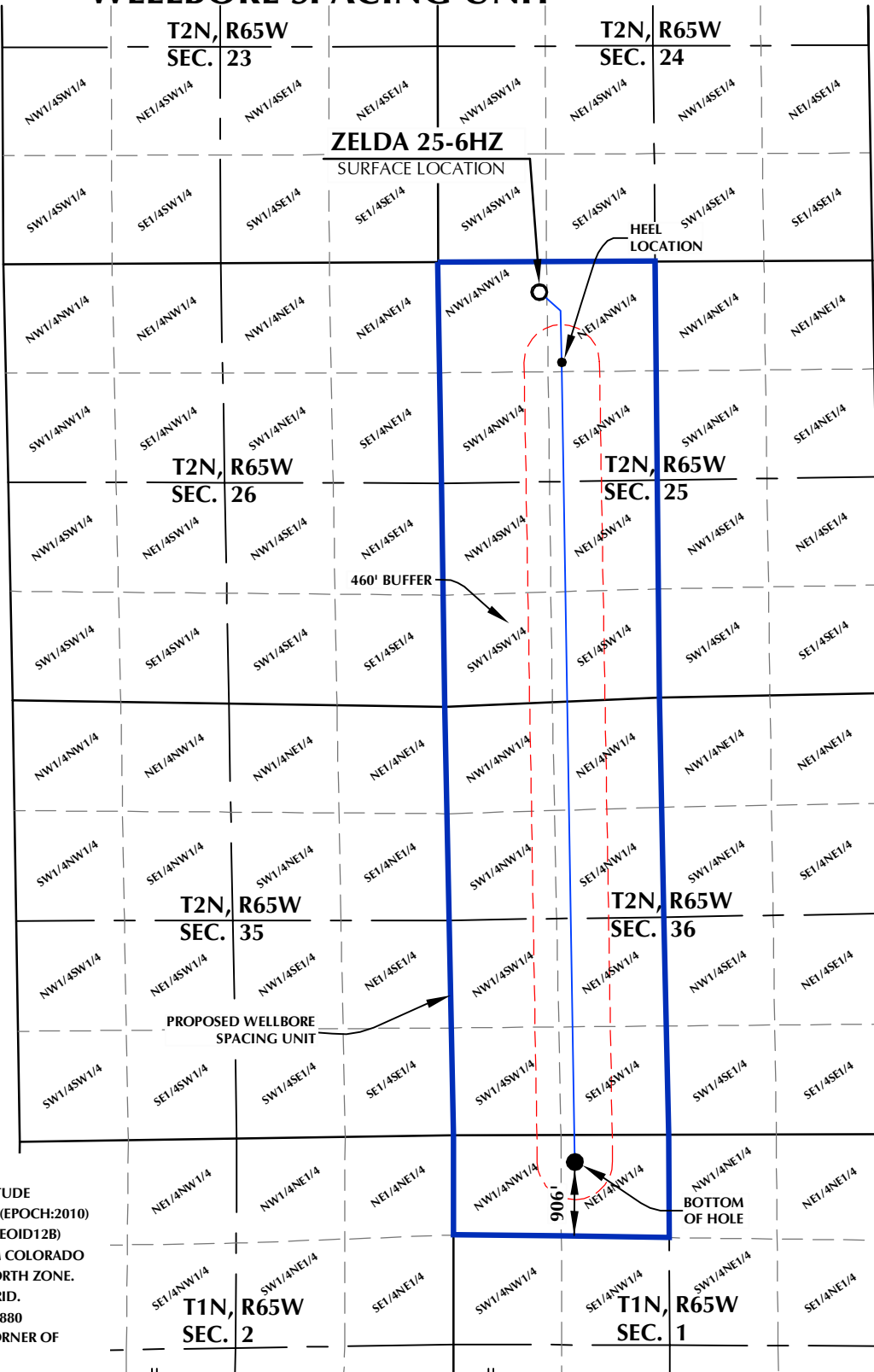

**NOTES:**

1. DRAWING LATITUDE AND LONGITUDE COORDINATES ARE NAD 83 (2011)(EPOCH:2010)
2. ELEVATION BASED ON NAVD88 (GEOID12B)
3. BASIS OF BEARING DERIVED FROM COLORADO COORDINATE SYSTEM OF 1983 NORTH ZONE.
4. ALL MEASURED DISTANCES ARE GRID.  
COMBINED SCALE FACTOR: .99972880  
CALCULATED FROM THE N. 1/4 CORNER OF SECTION 25, T2N, R65W

**WELL PAD - ZELDA 25-6HZ**

ZELDA 25-6HZ  
WELLBORE SPACING UNIT  
373' FNL & 1234' FWL NWNW (SURFACE)  
1230' FNL & 1491' FWL NENW (HEEL)  
LOCATED IN SECTION 25  
T2N, R65W, 6TH P.M.  
331' FNL & 1486' FWL LOT 2 (NENW) (BOTTOM)  
LOCATED IN SECTION 1  
T1N, R65W, 6TH P.M.  
WELD COUNTY, COLORADO

**Kerr-McGee Oil &  
Gas Onshore L.P.**  
1099 18th Street  
Denver, Colorado 80202



**CONSULTING, LLC**

**SHERIDAN OFFICE**  
1095 Saberton Avenue  
Sheridan, Wyoming 82801  
Phone 307-674-0609

**LOVELAND OFFICE**  
1635 Foxtrail Drive, Suite 204  
Loveland, Colorado 80538  
Phone 970-776-4331

DRAFTED BY:	LMO	CHECKED BY:	RKF
DATE DRAFTED:	9/15/17	DATE SURVEYED:	7/27/17
REVISED:		FILE NAME:	16-188