

LOCATION DRAWING TRUE RANCH FEE 27 EAST HORIZONTAL MULTI-WELL PAD

E1/2 SE1/4 SECTION 27, TOWNSHIP 12 NORTH, RANGE 65 EAST, 6TH P.M.

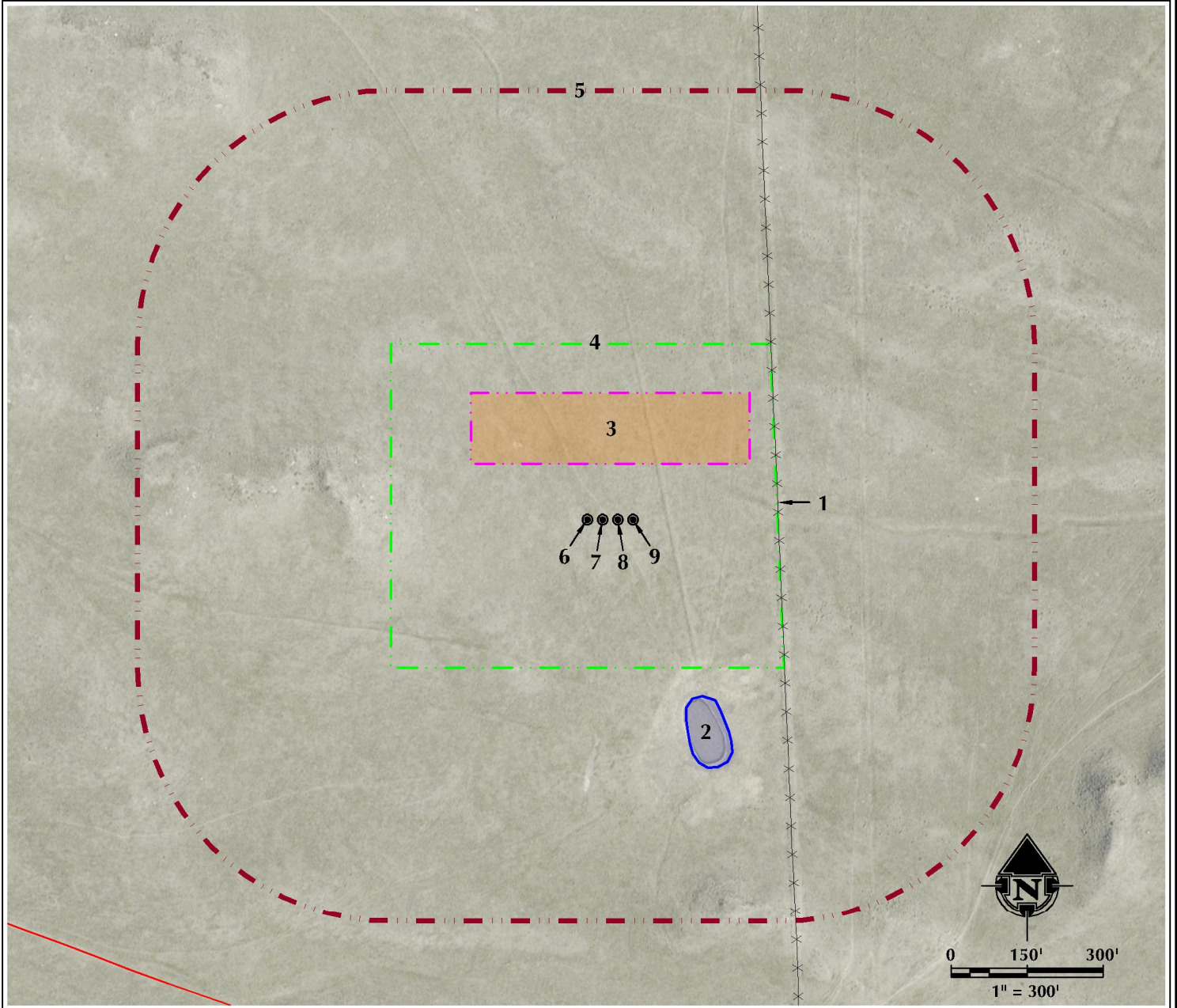

- | | |
|---|--|
| <ol style="list-style-type: none"> 1. EXISTING FENCE IS ±347' E. 2. EXISTING DRY POND IS ±395' SE. 3. PROPOSED TRUE RANCH FEE 27 EAST PRODUCTION FACILITY IS ±110' N. 4. OPERATIONAL DISTURBANCE AREA 5. 500' BUFFER 6. PROPOSED WELL: TRUE RANCH FEE 203-2703H 7. PROPOSED WELL: TRUE RANCH FEE 501-2703H | <ol style="list-style-type: none"> 8. PROPOSED WELL: TRUE RANCH FEE 202-2703H 9. PROPOSED WELL: TRUE RANCH FEE 201-2703H |
|---|--|

LEGEND		
<ul style="list-style-type: none"> EXISTING WELL PROPOSED WELL WATER WELL EXISTING FENCE PUBLIC ROAD PRIVATE ROAD 	<ul style="list-style-type: none"> 500' BUFFER DISTURBANCE AREA PROPOSED FACILITY DITCH/CANAL/DRAINAGE POND 	<ul style="list-style-type: none"> OVERHEAD POWER LINE EXISTING FACILITY EXISTING BUILDINGS RESIDENCE/BUILDING UNIT

*** REFERENCE LOCATION ***
 ALL MEASUREMENTS ARE MADE FROM
 REFERENCE WELL: TRUE RANCH FEE 501-2703H
 LAT: 40.973394° LONG: -104.639714° (NAD83)
 EXISTING GROUND ELEVATION = 5918.1'
 WELL FOOTAGES: 1010' FSL & 380' FEL

SURFACE USE: RANGELAND

609 CONSULTING, LLC

LOVELAND OFFICE
1615 Foxtrail Drive, Suite 204
Loveland, Colorado 80538
Phone 970-776-4331

SHERIDAN OFFICE
1099 Saberton Avenue
Sheridan, Wyoming 82801
Phone 307-674-0609

DATE SURVEYED: 10/16/17
 DATE: 11/3/17
 DRAFTER: SRS
 REVISED:

DATA SOURCES:
 - AERIAL COURTESY OF ESRI, INC.

NEAREST BUILDING UNIT: ±3592' SW

PREPARED FOR: **CLEAR CREEK**
Resource Partners