

Great Western Operating Company, LLC

Location Colorado
Field Wattenburg
Installation Wilson
Slot Slot N05 - Wilson IC 03-059HNX
Well Wilson IC 03-059HNX
Wellbore Wilson IC 03-059HNX (PWB)

Created by admin
 Date plotted 4-Oct-2017

Plot reference is Wilson IC 03-059HNX (PWB).
 Ref wellpath is Wilson IC 03-059HNX (PWP#1).
 Coordinates are in Feet reference Slot N05 - Wilson IC 03-059HNX.
 True Vertical Depths are reference Rig Datum.
 Measured Depths are reference Rig Datum.
 Rig Datum: Planned Datum #1
 Rig Datum to Mean Sea Level: 5005.80 ft.
 Plot North is aligned to TRUE North.

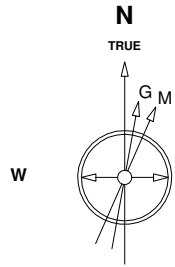

Scale 1 cm = 400 ft

East (Feet) ->

-14400 -13600 -12800 -12000 -11200 -10400 -9600 -8800 -8000 -7200 -6400 -5600 -4800 -4000 -3200 -2400 -1600 -800 0 800

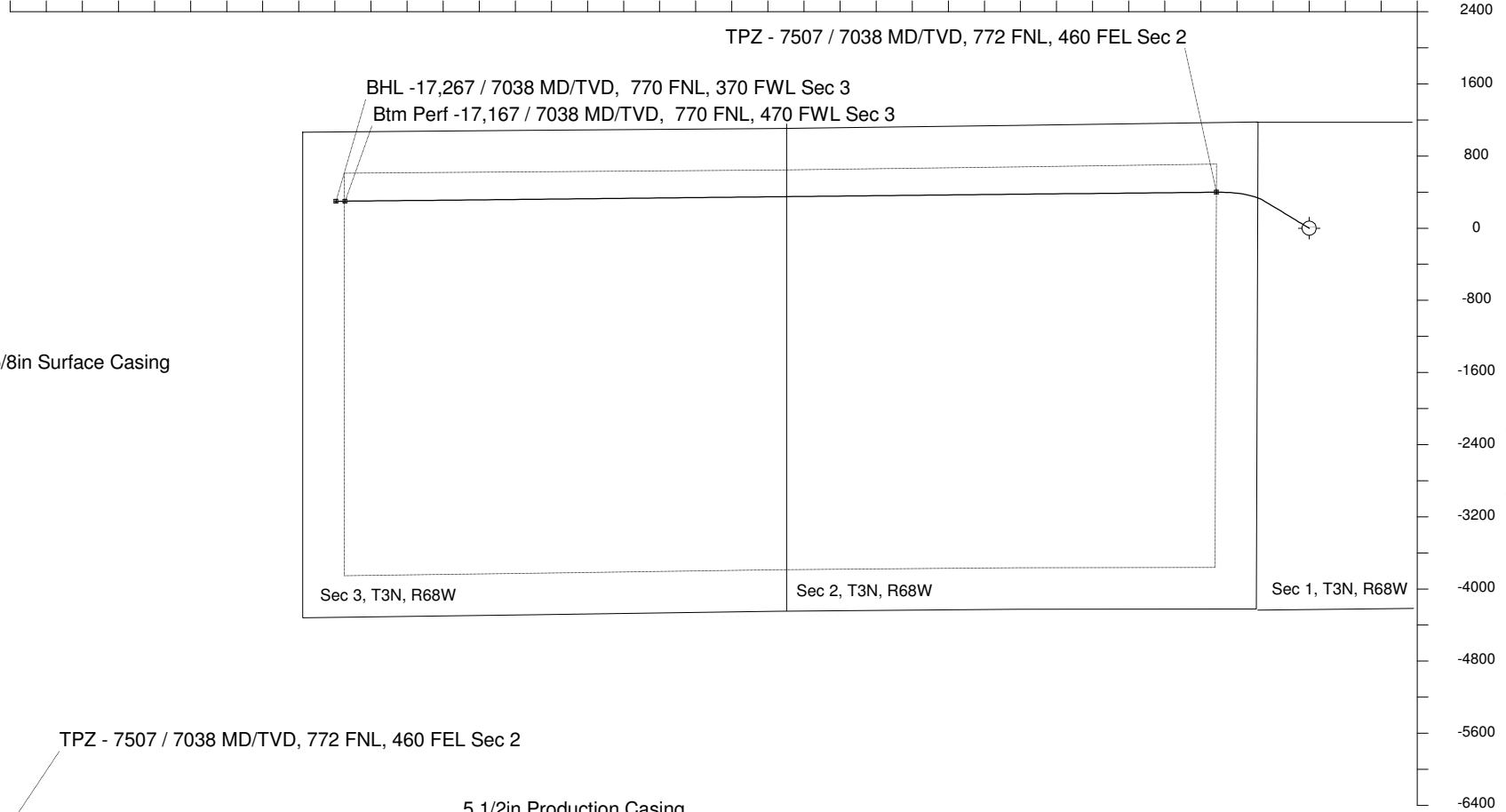

22-Sep-2016
 IGRF Model [1900,0-2020,0] Dip: 66.73 deg Field: 52381.9 nT
 Lat: N40 15 34.6500 Long: W104 57 32.1084 Elev: 4985.80 ft
 Magnetic North is 8.38 deg East of TRUE North
 To correct azimuth from Magnetic to TRUE add 8.38 deg

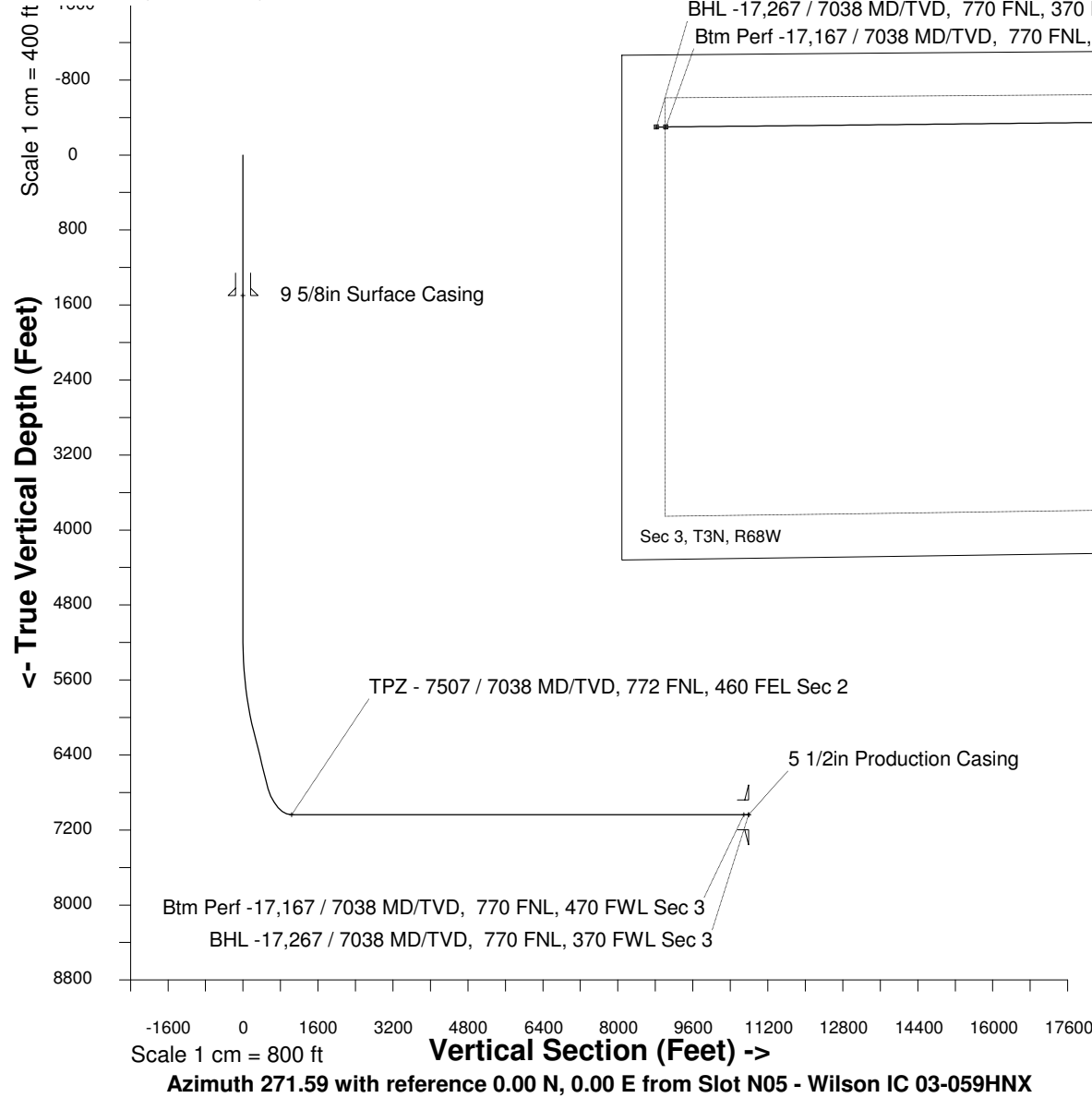

WELL PROFILE DATA

| Point | MD | Inc | Azi | TVD | North | East | deg/100ft | V. Sect |
|-------------------------|----------|-------|--------|---------|----------|------------|-----------|----------|
| Tie on | 0.00 | 0.00 | 0.00 | 0.00 | S 0.00 | W 0.00 | | 0.00 |
| KOP | 5181.50 | 0.00 | 301.24 | 5181.50 | S 0.00 | W 0.00 | 0.00 | 0.00 |
| End of Build | 6181.66 | 30.00 | 301.24 | 6136.57 | N 132.74 | W 218.84 | 9.84 | 222.43 |
| End of Hold | 6858.57 | 30.00 | 301.24 | 6722.76 | N 308.30 | W 508.26 | 0.00 | 516.61 |
| Target TPZ - ... Sec 2 | 7507.16 | 90.00 | 269.41 | 7038.00 | N 398.93 | W 1027.91 | 32.81 | 1038.56 |
| Target Btm Pe... Sec 3 | 17166.65 | 90.00 | 269.41 | 7038.00 | N 298.85 | W 10686.88 | 0.00 | 10691.05 |
| End of Turn | 17171.32 | 90.00 | 270.01 | 7038.00 | N 298.83 | W 10691.55 | 42.65 | 10695.73 |
| T.D. & Target BHL...c 3 | 17266.65 | 90.00 | 270.01 | 7038.00 | N 298.85 | W 10786.88 | 0.00 | 10791.02 |