

Extraction Oil & Gas
Project: Weld County, CO (NAD83)
Site: MLD Pad
Well: MLD 5
Wellbore: Wellbore #1
Plan: Plan #2 (MLD 5/Wellbore #1)
P 346

WELL DETAILS: MLD 5
Ground Elevation:: 4876.00
RKB Elevation: KB=25' @ 4901.00ft (P 346)
Rig Name: P 346

Northing 1353976.2000 Easting 3140465.2200 Latitude 40.303970 Longitude -104.996366



Planned Section Details

Sec	MD	Inc	Azi	TVD	+N/-S	+E/-W	Dleg	TFace	VSect
1	1550.50	0.48	40.23	1550.33	-4.52	-11.01	0.00	0.00	-9.63
2	1600.00	0.48	40.23	1599.83	-4.20	-10.74	0.00	0.00	-9.45
3	3092.37	29.37	216.19	3028.74	-301.53	-227.70	2.00	176.02	-150.14
4	4298.66	29.37	216.19	4080.00	-779.00	-577.00	0.00	0.00	-376.93
5	5767.09	0.00	0.00	5484.97	-1076.15	-794.38	2.00	180.00	-518.07
6	6274.16	0.00	0.00	5992.04	-1076.15	-794.38	0.00	0.00	-518.07
7	7174.16	90.00	89.29	6565.00	-1069.01	-221.47	10.00	89.29	36.99
8	11573.47	90.00	89.29	6565.00	-1014.20	4177.50	0.00	0.00	4298.85

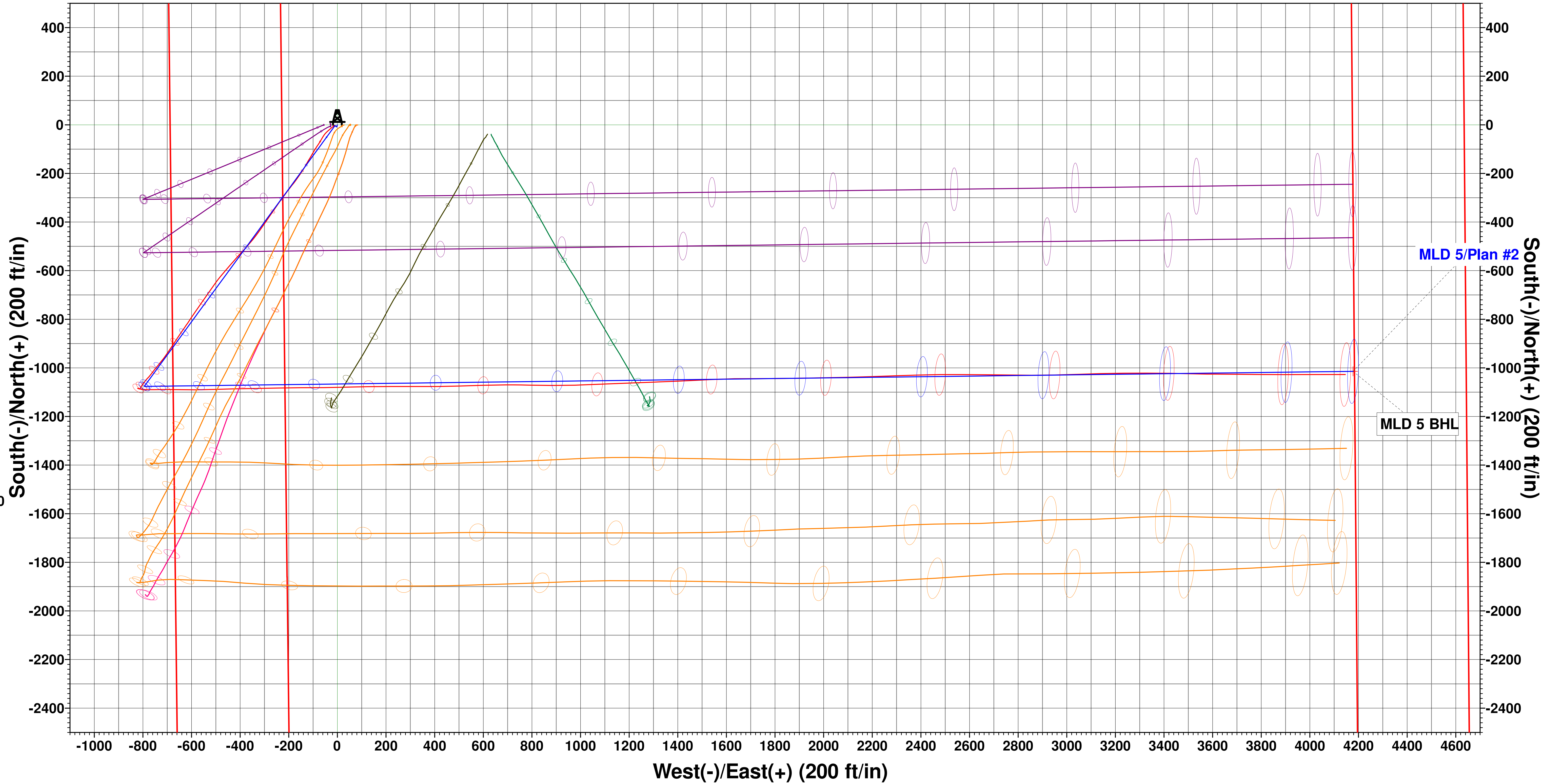
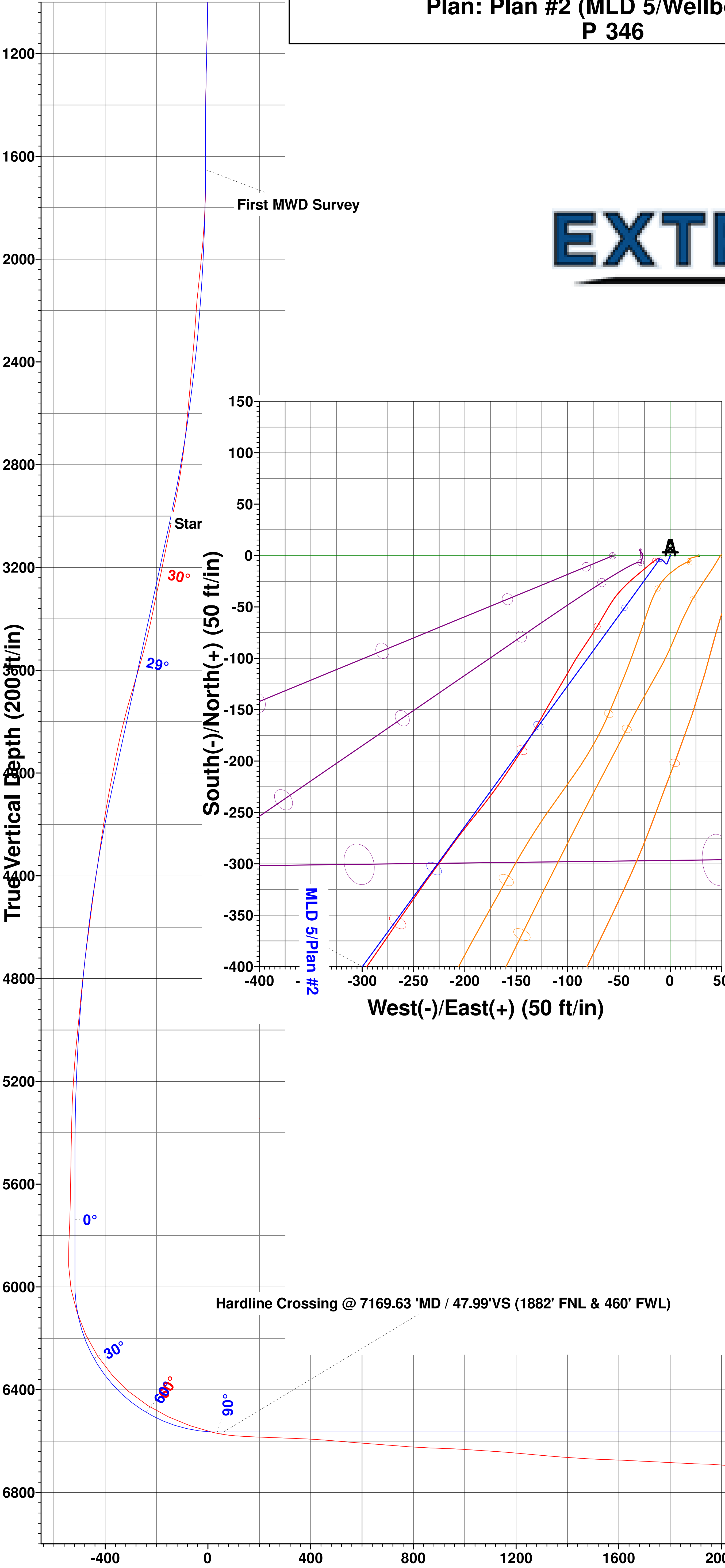

PTD @ 11540' MD / 4271.27' VS (1906' FNL & 498' FEL)

Final MWD Survey

T

G

M

Azimuths to Grid North
True North: -0.33°
Magnetic North: 8.28°

Magnetic Field
Strength: 52219.0snT
Dip Angle: 66.68°
Date: 8/15/2017
Model: HDGM

PROJECT DETAILS: Weld County, CO (NAD83)
Geodetic System: US State Plane 1983
Datum: North American Datum 1983
Ellipsoid: GRS 1980
Zone: Colorado Northern Zone
System Datum: Ground Level
Local North: Grid