

EXTRACTION OIL & GAS

**Weld County
Sec 32-T6N-R65W
WAKE NORTH 14**

ORIGINAL WELLBORE

Plan: PROPOSAL #1

Standard Planning Report

16 November, 2017

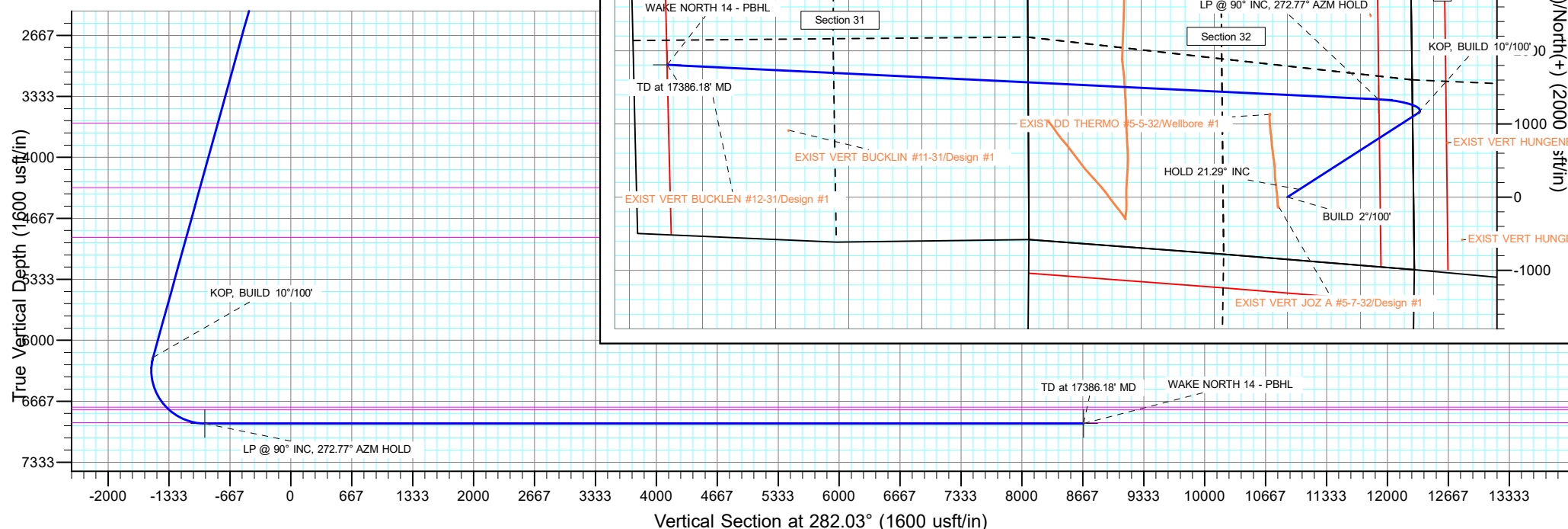

Planning Report

Database:	EDT_32Bit_ODBC	Local Co-ordinate Reference:	Well WAKE NORTH 14
Company:	EXTRACTION OIL & GAS	TVD Reference:	KB 25' @ 4666.00usft
Project:	Weld County	MD Reference:	KB 25' @ 4666.00usft
Site:	Sec 32-T6N-R65W	North Reference:	True
Well:	WAKE NORTH 14	Survey Calculation Method:	Minimum Curvature
Wellbore:	ORIGINAL WELLBORE		
Design:	PROPOSAL #1		

Project	Weld County		
Map System:	US State Plane 1983	System Datum:	Mean Sea Level
Geo Datum:	North American Datum 1983		
Map Zone:	Colorado Northern Zone		

Site		Sec 32-T6N-R65W			
Site Position:		Northing:	1,405,488.40 usft	Latitude:	40° 26' 36.996 N
From:	Lat/Long	Easting:	3,226,675.31 usft	Longitude:	104° 41' 8.088 W
Position Uncertainty:	0.00 usft	Slot Radius:	13.200 in	Grid Convergence:	0.53 °

Well	WAKE NORTH 14					
Well Position	+N/-S	-1,737.72 usft	Northing:	1,403,755.02 usft	Latitude:	40° 26' 19.824 N
	+E/-W	464.85 usft	Easting:	3,227,156.09 usft	Longitude:	104° 41' 2.076 W
Position Uncertainty		0.00 usft	Wellhead Elevation:		Ground Level:	4,641.00 usft

Wellbore	ORIGINAL WELLBORE				
Magnetics	Model Name	Sample Date	Declination (°)	Dip Angle (°)	Field Strength (nT)
	IGRF2015	6/29/2016	8.27	66.92	52,532.65039981

Design	PROPOSAL #1			
Audit Notes:				
Version:	Phase:	PROTOTYPE	Tie On Depth:	0.00
Vertical Section:	Depth From (TVD) (usft)	+N/-S (usft)	+E/-W (usft)	Direction (°)
	0.00	0.00	0.00	282.03

Plan Survey Tool Program			Date	11/16/2017	
Depth From (usft)	Depth To (usft)	Survey (Wellbore)	Tool Name	Remarks	
1	0.00	17,386.18	PROPOSAL #1 (ORIGINAL WEL	MWD OWSG	
				OWSG MWD - Standard	

Plan Sections										
Measured Depth (usft)	Inclination (°)	Azimuth (°)	Vertical Depth (usft)	+N/-S (usft)	+E/-W (usft)	Dogleg Rate (°/100ft)	Build Rate (°/100ft)	Turn Rate (°/100ft)	TFO (°)	Target
0.00	0.00	0.00	0.00	0.00	0.00	0.00	0.00	0.00	0.00	
200.00	0.00	0.00	200.00	0.00	0.00	0.00	0.00	0.00	0.00	
1,264.28	21.29	57.29	1,239.97	105.62	164.43	2.00	2.00	0.00	57.29	
6,572.39	21.29	57.29	6,185.97	1,146.99	1,785.74	0.00	0.00	0.00	0.00	
7,644.32	90.00	272.77	6,910.00	1,337.02	1,246.94	10.00	6.41	-13.48	-142.58	WAKE NORTH 14 - L
17,386.18	90.00	272.77	6,910.00	1,808.40	-8,483.51	0.00	0.00	0.00	0.00	WAKE NORTH 14 - P

Planning Report

Database:	EDT_32Bit_ODBC	Local Co-ordinate Reference:	Well WAKE NORTH 14
Company:	EXTRACTION OIL & GAS	TVD Reference:	KB 25' @ 4666.00usft
Project:	Weld County	MD Reference:	KB 25' @ 4666.00usft
Site:	Sec 32-T6N-R65W	North Reference:	True
Well:	WAKE NORTH 14	Survey Calculation Method:	Minimum Curvature
Wellbore:	ORIGINAL WELLBORE		
Design:	PROPOSAL #1		

Planned Survey									
Measured Depth (usft)	Inclination (°)	Azimuth (°)	Vertical Depth (usft)	+N/-S (usft)	+E/-W (usft)	Vertical Section (usft)	Dogleg Rate (°/100ft)	Build Rate (°/100ft)	Turn Rate (°/100ft)
0.00	0.00	0.00	0.00	0.00	0.00	0.00	0.00	0.00	0.00
100.00	0.00	0.00	100.00	0.00	0.00	0.00	0.00	0.00	0.00
200.00	0.00	0.00	200.00	0.00	0.00	0.00	0.00	0.00	0.00
BUILD 2°/100'									
300.00	2.00	57.29	299.98	0.94	1.47	-1.24	2.00	2.00	0.00
400.00	4.00	57.29	399.84	3.77	5.87	-4.96	2.00	2.00	0.00
500.00	6.00	57.29	499.45	8.48	13.20	-11.15	2.00	2.00	0.00
600.00	8.00	57.29	598.70	15.07	23.46	-19.80	2.00	2.00	0.00
700.00	10.00	57.29	697.47	23.52	36.62	-30.91	2.00	2.00	0.00
800.00	12.00	57.29	795.62	33.83	52.67	-44.46	2.00	2.00	0.00
900.00	14.00	57.29	893.06	45.99	71.60	-60.44	2.00	2.00	0.00
1,000.00	16.00	57.29	989.64	59.98	93.37	-78.82	2.00	2.00	0.00
1,100.00	18.00	57.29	1,085.27	75.78	117.97	-99.59	2.00	2.00	0.00
1,200.00	20.00	57.29	1,179.82	93.37	145.36	-122.71	2.00	2.00	0.00
1,264.28	21.29	57.29	1,239.97	105.62	164.43	-138.80	2.00	2.00	0.00
HOLD 21.29° INC									
1,300.00	21.29	57.29	1,273.25	112.62	175.34	-148.01	0.00	0.00	0.00
1,400.00	21.29	57.29	1,366.43	132.24	205.89	-173.80	0.00	0.00	0.00
1,500.00	21.29	57.29	1,459.61	151.86	236.43	-199.58	0.00	0.00	0.00
1,600.00	21.29	57.29	1,552.79	171.48	266.97	-225.36	0.00	0.00	0.00
1,700.00	21.29	57.29	1,645.96	191.10	297.52	-251.14	0.00	0.00	0.00
1,800.00	21.29	57.29	1,739.14	210.72	328.06	-276.93	0.00	0.00	0.00
1,900.00	21.29	57.29	1,832.32	230.34	358.61	-302.71	0.00	0.00	0.00
2,000.00	21.29	57.29	1,925.50	249.95	389.15	-328.49	0.00	0.00	0.00
2,100.00	21.29	57.29	2,018.68	269.57	419.69	-354.28	0.00	0.00	0.00
2,200.00	21.29	57.29	2,111.85	289.19	450.24	-380.06	0.00	0.00	0.00
2,300.00	21.29	57.29	2,205.03	308.81	480.78	-405.84	0.00	0.00	0.00
2,400.00	21.29	57.29	2,298.21	328.43	511.33	-431.63	0.00	0.00	0.00
2,500.00	21.29	57.29	2,391.39	348.05	541.87	-457.41	0.00	0.00	0.00
2,600.00	21.29	57.29	2,484.57	367.67	572.41	-483.19	0.00	0.00	0.00
2,700.00	21.29	57.29	2,577.75	387.28	602.96	-508.98	0.00	0.00	0.00
2,800.00	21.29	57.29	2,670.92	406.90	633.50	-534.76	0.00	0.00	0.00
2,900.00	21.29	57.29	2,764.10	426.52	664.05	-560.54	0.00	0.00	0.00
3,000.00	21.29	57.29	2,857.28	446.14	694.59	-586.33	0.00	0.00	0.00
3,100.00	21.29	57.29	2,950.46	465.76	725.13	-612.11	0.00	0.00	0.00
3,200.00	21.29	57.29	3,043.64	485.38	755.68	-637.89	0.00	0.00	0.00
3,300.00	21.29	57.29	3,136.81	505.00	786.22	-663.68	0.00	0.00	0.00
3,400.00	21.29	57.29	3,229.99	524.61	816.77	-689.46	0.00	0.00	0.00
3,500.00	21.29	57.29	3,323.17	544.23	847.31	-715.24	0.00	0.00	0.00
3,600.00	21.29	57.29	3,416.35	563.85	877.85	-741.02	0.00	0.00	0.00
3,700.00	21.29	57.29	3,509.53	583.47	908.40	-766.81	0.00	0.00	0.00
3,800.00	21.29	57.29	3,602.71	603.09	938.94	-792.59	0.00	0.00	0.00
3,825.00	21.29	57.29	3,626.00	607.99	946.58	-799.04	0.00	0.00	0.00
PARKMAN									
3,900.00	21.29	57.29	3,695.88	622.71	969.49	-818.37	0.00	0.00	0.00
4,000.00	21.29	57.29	3,789.06	642.33	1,000.03	-844.16	0.00	0.00	0.00
4,100.00	21.29	57.29	3,882.24	661.94	1,030.57	-869.94	0.00	0.00	0.00
4,200.00	21.29	57.29	3,975.42	681.56	1,061.12	-895.72	0.00	0.00	0.00
4,300.00	21.29	57.29	4,068.60	701.18	1,091.66	-921.51	0.00	0.00	0.00
4,400.00	21.29	57.29	4,161.77	720.80	1,122.20	-947.29	0.00	0.00	0.00
4,500.00	21.29	57.29	4,254.95	740.42	1,152.75	-973.07	0.00	0.00	0.00
4,580.54	21.29	57.29	4,330.00	756.22	1,177.35	-993.84	0.00	0.00	0.00
SUSSEX									

Planning Report

Database:	EDT_32Bit_ODBC	Local Co-ordinate Reference:	Well WAKE NORTH 14
Company:	EXTRACTION OIL & GAS	TVD Reference:	KB 25' @ 4666.00usft
Project:	Weld County	MD Reference:	KB 25' @ 4666.00usft
Site:	Sec 32-T6N-R65W	North Reference:	True
Well:	WAKE NORTH 14	Survey Calculation Method:	Minimum Curvature
Wellbore:	ORIGINAL WELLBORE		
Design:	PROPOSAL #1		

Planned Survey										
Measured Depth (usft)	Inclination (°)	Azimuth (°)	Vertical Depth (usft)	+N/-S (usft)	+E/-W (usft)	Vertical Section (usft)	Dogleg Rate (°/100ft)	Build Rate (°/100ft)	Turn Rate (°/100ft)	
4,600.00	21.29	57.29	4,348.13	760.04	1,183.29	-998.86	0.00	0.00	0.00	
4,700.00	21.29	57.29	4,441.31	779.66	1,213.84	-1,024.64	0.00	0.00	0.00	
4,800.00	21.29	57.29	4,534.49	799.27	1,244.38	-1,050.42	0.00	0.00	0.00	
4,900.00	21.29	57.29	4,627.67	818.89	1,274.92	-1,076.21	0.00	0.00	0.00	
5,000.00	21.29	57.29	4,720.84	838.51	1,305.47	-1,101.99	0.00	0.00	0.00	
5,100.00	21.29	57.29	4,814.02	858.13	1,336.01	-1,127.77	0.00	0.00	0.00	
5,165.44	21.29	57.29	4,875.00	870.97	1,356.00	-1,144.65	0.00	0.00	0.00	
SHANNON										
5,200.00	21.29	57.29	4,907.20	877.75	1,366.56	-1,153.56	0.00	0.00	0.00	
5,300.00	21.29	57.29	5,000.38	897.37	1,397.10	-1,179.34	0.00	0.00	0.00	
5,400.00	21.29	57.29	5,093.56	916.99	1,427.64	-1,205.12	0.00	0.00	0.00	
5,500.00	21.29	57.29	5,186.73	936.61	1,458.19	-1,230.90	0.00	0.00	0.00	
5,600.00	21.29	57.29	5,279.91	956.22	1,488.73	-1,256.69	0.00	0.00	0.00	
5,700.00	21.29	57.29	5,373.09	975.84	1,519.28	-1,282.47	0.00	0.00	0.00	
5,800.00	21.29	57.29	5,466.27	995.46	1,549.82	-1,308.25	0.00	0.00	0.00	
5,900.00	21.29	57.29	5,559.45	1,015.08	1,580.36	-1,334.04	0.00	0.00	0.00	
6,000.00	21.29	57.29	5,652.63	1,034.70	1,610.91	-1,359.82	0.00	0.00	0.00	
6,100.00	21.29	57.29	5,745.80	1,054.32	1,641.45	-1,385.60	0.00	0.00	0.00	
6,200.00	21.29	57.29	5,838.98	1,073.94	1,672.00	-1,411.39	0.00	0.00	0.00	
6,300.00	21.29	57.29	5,932.16	1,093.55	1,702.54	-1,437.17	0.00	0.00	0.00	
6,400.00	21.29	57.29	6,025.34	1,113.17	1,733.08	-1,462.95	0.00	0.00	0.00	
6,500.00	21.29	57.29	6,118.52	1,132.79	1,763.63	-1,488.74	0.00	0.00	0.00	
6,572.39	21.29	57.29	6,185.97	1,146.99	1,785.74	-1,507.40	0.00	0.00	0.00	
KOP, BUILD 10°/100'										
6,600.00	19.16	52.17	6,211.88	1,152.48	1,793.54	-1,513.88	10.00	-7.69	-18.53	
6,650.00	15.81	39.75	6,259.58	1,162.76	1,804.38	-1,522.35	10.00	-6.71	-24.83	
6,700.00	13.48	22.13	6,307.97	1,173.40	1,810.93	-1,526.54	10.00	-4.66	-35.25	
6,750.00	12.76	0.20	6,356.70	1,184.32	1,813.15	-1,526.43	10.00	-1.45	-43.87	
6,800.00	13.89	338.93	6,405.38	1,195.45	1,811.01	-1,522.02	10.00	2.26	-42.54	
6,850.00	16.50	322.55	6,453.65	1,206.69	1,804.53	-1,513.34	10.00	5.22	-32.76	
6,900.00	20.02	311.14	6,501.14	1,217.97	1,793.76	-1,500.45	10.00	7.04	-22.81	
6,950.00	24.05	303.22	6,547.49	1,229.19	1,778.79	-1,483.47	10.00	8.06	-15.84	
7,000.00	28.38	297.52	6,592.35	1,240.27	1,759.71	-1,462.50	10.00	8.65	-11.39	
7,050.00	32.88	293.25	6,635.36	1,251.12	1,736.69	-1,437.73	10.00	9.01	-8.55	
7,100.00	37.50	289.92	6,676.22	1,261.67	1,709.90	-1,409.32	10.00	9.23	-6.67	
7,150.00	42.19	287.22	6,714.60	1,271.83	1,679.53	-1,377.51	10.00	9.39	-5.39	
7,171.12	44.19	286.23	6,730.00	1,275.99	1,665.69	-1,363.10	10.00	9.47	-4.71	
SHARON SPRINGS										
7,200.00	46.94	284.97	6,750.22	1,281.53	1,645.83	-1,342.52	10.00	9.51	-4.33	
7,214.52	48.32	284.39	6,760.00	1,284.24	1,635.46	-1,331.81	10.00	9.54	-4.04	
NIOBRARA										
7,250.00	51.72	283.05	6,782.80	1,290.69	1,609.05	-1,304.64	10.00	9.58	-3.76	
7,300.00	56.53	281.37	6,812.09	1,299.24	1,569.46	-1,264.14	10.00	9.62	-3.36	
7,350.00	61.36	279.87	6,837.88	1,307.11	1,527.37	-1,221.33	10.00	9.66	-3.01	
7,400.00	66.21	278.49	6,859.96	1,314.26	1,483.10	-1,176.54	10.00	9.69	-2.74	
7,450.00	71.07	277.22	6,878.17	1,320.61	1,436.99	-1,130.12	10.00	9.72	-2.55	
7,500.00	75.93	276.02	6,892.37	1,326.13	1,389.38	-1,082.41	10.00	9.73	-2.40	
7,535.76	79.42	275.19	6,900.00	1,329.54	1,354.61	-1,047.69	10.00	9.74	-2.31	
NIO B TARGET										
7,550.00	80.80	274.87	6,902.45	1,330.77	1,340.64	-1,033.77	10.00	9.75	-2.27	
7,600.00	85.68	273.75	6,908.33	1,334.50	1,291.15	-984.59	10.00	9.75	-2.24	
7,644.32	90.00	272.77	6,910.00	1,337.02	1,246.94	-940.83	10.00	9.75	-2.21	
LP @ 90° INC, 272.77° AZM HOLD										

Planning Report

Database:	EDT_32Bit_ODBC	Local Co-ordinate Reference:	Well WAKE NORTH 14
Company:	EXTRACTION OIL & GAS	TVD Reference:	KB 25' @ 4666.00usft
Project:	Weld County	MD Reference:	KB 25' @ 4666.00usft
Site:	Sec 32-T6N-R65W	North Reference:	True
Well:	WAKE NORTH 14	Survey Calculation Method:	Minimum Curvature
Wellbore:	ORIGINAL WELLBORE		
Design:	PROPOSAL #1		

Planned Survey										
Measured Depth (usft)	Inclination (°)	Azimuth (°)	Vertical Depth (usft)	+N/-S (usft)	+E/-W (usft)	Vertical Section (usft)	Dogleg Rate (°/100ft)	Build Rate (°/100ft)	Turn Rate (°/100ft)	
7,700.00	90.00	272.77	6,910.00	1,339.71	1,191.33	-885.87	0.00	0.00	0.00	
7,800.00	90.00	272.77	6,910.00	1,344.55	1,091.44	-787.18	0.00	0.00	0.00	
7,900.00	90.00	272.77	6,910.00	1,349.39	991.56	-688.48	0.00	0.00	0.00	
8,000.00	90.00	272.77	6,910.00	1,354.22	891.68	-589.78	0.00	0.00	0.00	
8,100.00	90.00	272.77	6,910.00	1,359.06	791.80	-491.09	0.00	0.00	0.00	
8,200.00	90.00	272.77	6,910.00	1,363.90	691.91	-392.39	0.00	0.00	0.00	
8,300.00	90.00	272.77	6,910.00	1,368.74	592.03	-293.69	0.00	0.00	0.00	
8,400.00	90.00	272.77	6,910.00	1,373.57	492.15	-194.99	0.00	0.00	0.00	
8,500.00	90.00	272.77	6,910.00	1,378.41	392.26	-96.30	0.00	0.00	0.00	
8,600.00	90.00	272.77	6,910.00	1,383.25	292.38	2.40	0.00	0.00	0.00	
8,700.00	90.00	272.77	6,910.00	1,388.08	192.50	101.10	0.00	0.00	0.00	
8,800.00	90.00	272.77	6,910.00	1,392.92	92.61	199.79	0.00	0.00	0.00	
8,900.00	90.00	272.77	6,910.00	1,397.76	-7.27	298.49	0.00	0.00	0.00	
9,000.00	90.00	272.77	6,910.00	1,402.59	-107.15	397.19	0.00	0.00	0.00	
9,100.00	90.00	272.77	6,910.00	1,407.43	-207.03	495.88	0.00	0.00	0.00	
9,200.00	90.00	272.77	6,910.00	1,412.27	-306.92	594.58	0.00	0.00	0.00	
9,300.00	90.00	272.77	6,910.00	1,417.10	-406.80	693.28	0.00	0.00	0.00	
9,400.00	90.00	272.77	6,910.00	1,421.94	-506.68	791.97	0.00	0.00	0.00	
9,500.00	90.00	272.77	6,910.00	1,426.78	-606.57	890.67	0.00	0.00	0.00	
9,600.00	90.00	272.77	6,910.00	1,431.61	-706.45	989.37	0.00	0.00	0.00	
9,700.00	90.00	272.77	6,910.00	1,436.45	-806.33	1,088.06	0.00	0.00	0.00	
9,800.00	90.00	272.77	6,910.00	1,441.29	-906.22	1,186.76	0.00	0.00	0.00	
9,900.00	90.00	272.77	6,910.00	1,446.12	-1,006.10	1,285.46	0.00	0.00	0.00	
10,000.00	90.00	272.77	6,910.00	1,450.96	-1,105.98	1,384.15	0.00	0.00	0.00	
10,100.00	90.00	272.77	6,910.00	1,455.80	-1,205.86	1,482.85	0.00	0.00	0.00	
10,200.00	90.00	272.77	6,910.00	1,460.63	-1,305.75	1,581.55	0.00	0.00	0.00	
10,300.00	90.00	272.77	6,910.00	1,465.47	-1,405.63	1,680.25	0.00	0.00	0.00	
10,400.00	90.00	272.77	6,910.00	1,470.31	-1,505.51	1,778.94	0.00	0.00	0.00	
10,500.00	90.00	272.77	6,910.00	1,475.14	-1,605.40	1,877.64	0.00	0.00	0.00	
10,600.00	90.00	272.77	6,910.00	1,479.98	-1,705.28	1,976.34	0.00	0.00	0.00	
10,700.00	90.00	272.77	6,910.00	1,484.82	-1,805.16	2,075.03	0.00	0.00	0.00	
10,800.00	90.00	272.77	6,910.00	1,489.65	-1,905.04	2,173.73	0.00	0.00	0.00	
10,900.00	90.00	272.77	6,910.00	1,494.49	-2,004.93	2,272.43	0.00	0.00	0.00	
11,000.00	90.00	272.77	6,910.00	1,499.33	-2,104.81	2,371.12	0.00	0.00	0.00	
11,100.00	90.00	272.77	6,910.00	1,504.16	-2,204.69	2,469.82	0.00	0.00	0.00	
11,200.00	90.00	272.77	6,910.00	1,509.00	-2,304.58	2,568.52	0.00	0.00	0.00	
11,300.00	90.00	272.77	6,910.00	1,513.84	-2,404.46	2,667.21	0.00	0.00	0.00	
11,400.00	90.00	272.77	6,910.00	1,518.67	-2,504.34	2,765.91	0.00	0.00	0.00	
11,500.00	90.00	272.77	6,910.00	1,523.51	-2,604.23	2,864.61	0.00	0.00	0.00	
11,600.00	90.00	272.77	6,910.00	1,528.35	-2,704.11	2,963.30	0.00	0.00	0.00	
11,700.00	90.00	272.77	6,910.00	1,533.19	-2,803.99	3,062.00	0.00	0.00	0.00	
11,800.00	90.00	272.77	6,910.00	1,538.02	-2,903.87	3,160.70	0.00	0.00	0.00	
11,900.00	90.00	272.77	6,910.00	1,542.86	-3,003.76	3,259.39	0.00	0.00	0.00	
12,000.00	90.00	272.77	6,910.00	1,547.70	-3,103.64	3,358.09	0.00	0.00	0.00	
12,100.00	90.00	272.77	6,910.00	1,552.53	-3,203.52	3,456.79	0.00	0.00	0.00	
12,200.00	90.00	272.77	6,910.00	1,557.37	-3,303.41	3,555.49	0.00	0.00	0.00	
12,300.00	90.00	272.77	6,910.00	1,562.21	-3,403.29	3,654.18	0.00	0.00	0.00	
12,400.00	90.00	272.77	6,910.00	1,567.04	-3,503.17	3,752.88	0.00	0.00	0.00	
12,500.00	90.00	272.77	6,910.00	1,571.88	-3,603.06	3,851.58	0.00	0.00	0.00	
12,600.00	90.00	272.77	6,910.00	1,576.72	-3,702.94	3,950.27	0.00	0.00	0.00	
12,700.00	90.00	272.77	6,910.00	1,581.55	-3,802.82	4,048.97	0.00	0.00	0.00	
12,800.00	90.00	272.77	6,910.00	1,586.39	-3,902.70	4,147.67	0.00	0.00	0.00	
12,900.00	90.00	272.77	6,910.00	1,591.23	-4,002.59	4,246.36	0.00	0.00	0.00	
13,000.00	90.00	272.77	6,910.00	1,596.06	-4,102.47	4,345.06	0.00	0.00	0.00	

Planning Report

Database:	EDT_32Bit_ODBC	Local Co-ordinate Reference:	Well WAKE NORTH 14
Company:	EXTRACTION OIL & GAS	TVD Reference:	KB 25' @ 4666.00usft
Project:	Weld County	MD Reference:	KB 25' @ 4666.00usft
Site:	Sec 32-T6N-R65W	North Reference:	True
Well:	WAKE NORTH 14	Survey Calculation Method:	Minimum Curvature
Wellbore:	ORIGINAL WELLBORE		
Design:	PROPOSAL #1		

Planned Survey									
Measured Depth (usft)	Inclination (°)	Azimuth (°)	Vertical Depth (usft)	+N/-S (usft)	+E/-W (usft)	Vertical Section (usft)	Dogleg Rate (°/100ft)	Build Rate (°/100ft)	Turn Rate (°/100ft)
13,100.00	90.00	272.77	6,910.00	1,600.90	-4,202.35	4,443.76	0.00	0.00	0.00
13,200.00	90.00	272.77	6,910.00	1,605.74	-4,302.24	4,542.45	0.00	0.00	0.00
13,300.00	90.00	272.77	6,910.00	1,610.57	-4,402.12	4,641.15	0.00	0.00	0.00
13,400.00	90.00	272.77	6,910.00	1,615.41	-4,502.00	4,739.85	0.00	0.00	0.00
13,500.00	90.00	272.77	6,910.00	1,620.25	-4,601.88	4,838.54	0.00	0.00	0.00
13,600.00	90.00	272.77	6,910.00	1,625.08	-4,701.77	4,937.24	0.00	0.00	0.00
13,700.00	90.00	272.77	6,910.00	1,629.92	-4,801.65	5,035.94	0.00	0.00	0.00
13,800.00	90.00	272.77	6,910.00	1,634.76	-4,901.53	5,134.63	0.00	0.00	0.00
13,900.00	90.00	272.77	6,910.00	1,639.59	-5,001.42	5,233.33	0.00	0.00	0.00
14,000.00	90.00	272.77	6,910.00	1,644.43	-5,101.30	5,332.03	0.00	0.00	0.00
14,100.00	90.00	272.77	6,910.00	1,649.27	-5,201.18	5,430.73	0.00	0.00	0.00
14,200.00	90.00	272.77	6,910.00	1,654.10	-5,301.07	5,529.42	0.00	0.00	0.00
14,300.00	90.00	272.77	6,910.00	1,658.94	-5,400.95	5,628.12	0.00	0.00	0.00
14,400.00	90.00	272.77	6,910.00	1,663.78	-5,500.83	5,726.82	0.00	0.00	0.00
14,500.00	90.00	272.77	6,910.00	1,668.61	-5,600.71	5,825.51	0.00	0.00	0.00
14,600.00	90.00	272.77	6,910.00	1,673.45	-5,700.60	5,924.21	0.00	0.00	0.00
14,700.00	90.00	272.77	6,910.00	1,678.29	-5,800.48	6,022.91	0.00	0.00	0.00
14,800.00	90.00	272.77	6,910.00	1,683.12	-5,900.36	6,121.60	0.00	0.00	0.00
14,900.00	90.00	272.77	6,910.00	1,687.96	-6,000.25	6,220.30	0.00	0.00	0.00
15,000.00	90.00	272.77	6,910.00	1,692.80	-6,100.13	6,319.00	0.00	0.00	0.00
15,100.00	90.00	272.77	6,910.00	1,697.64	-6,200.01	6,417.69	0.00	0.00	0.00
15,200.00	90.00	272.77	6,910.00	1,702.47	-6,299.90	6,516.39	0.00	0.00	0.00
15,300.00	90.00	272.77	6,910.00	1,707.31	-6,399.78	6,615.09	0.00	0.00	0.00
15,400.00	90.00	272.77	6,910.00	1,712.15	-6,499.66	6,713.78	0.00	0.00	0.00
15,500.00	90.00	272.77	6,910.00	1,716.98	-6,599.54	6,812.48	0.00	0.00	0.00
15,600.00	90.00	272.77	6,910.00	1,721.82	-6,699.43	6,911.18	0.00	0.00	0.00
15,700.00	90.00	272.77	6,910.00	1,726.66	-6,799.31	7,009.87	0.00	0.00	0.00
15,800.00	90.00	272.77	6,910.00	1,731.49	-6,899.19	7,108.57	0.00	0.00	0.00
15,900.00	90.00	272.77	6,910.00	1,736.33	-6,999.08	7,207.27	0.00	0.00	0.00
16,000.00	90.00	272.77	6,910.00	1,741.17	-7,098.96	7,305.97	0.00	0.00	0.00
16,100.00	90.00	272.77	6,910.00	1,746.00	-7,198.84	7,404.66	0.00	0.00	0.00
16,200.00	90.00	272.77	6,910.00	1,750.84	-7,298.72	7,503.36	0.00	0.00	0.00
16,300.00	90.00	272.77	6,910.00	1,755.68	-7,398.61	7,602.06	0.00	0.00	0.00
16,400.00	90.00	272.77	6,910.00	1,760.51	-7,498.49	7,700.75	0.00	0.00	0.00
16,500.00	90.00	272.77	6,910.00	1,765.35	-7,598.37	7,799.45	0.00	0.00	0.00
16,600.00	90.00	272.77	6,910.00	1,770.19	-7,698.26	7,898.15	0.00	0.00	0.00
16,700.00	90.00	272.77	6,910.00	1,775.02	-7,798.14	7,996.84	0.00	0.00	0.00
16,800.00	90.00	272.77	6,910.00	1,779.86	-7,898.02	8,095.54	0.00	0.00	0.00
16,900.00	90.00	272.77	6,910.00	1,784.70	-7,997.91	8,194.24	0.00	0.00	0.00
17,000.00	90.00	272.77	6,910.00	1,789.53	-8,097.79	8,292.93	0.00	0.00	0.00
17,100.00	90.00	272.77	6,910.00	1,794.37	-8,197.67	8,391.63	0.00	0.00	0.00
17,200.00	90.00	272.77	6,910.00	1,799.21	-8,297.55	8,490.33	0.00	0.00	0.00
17,300.00	90.00	272.77	6,910.00	1,804.04	-8,397.44	8,589.02	0.00	0.00	0.00
17,386.18	90.00	272.77	6,910.00	1,808.40	-8,483.51	8,674.11	0.00	0.00	0.00
TD at 17386.18' MD									

Planning Report

Database:	EDT_32Bit_ODBC	Local Co-ordinate Reference:	Well WAKE NORTH 14
Company:	EXTRACTION OIL & GAS	TVD Reference:	KB 25' @ 4666.00usft
Project:	Weld County	MD Reference:	KB 25' @ 4666.00usft
Site:	Sec 32-T6N-R65W	North Reference:	True
Well:	WAKE NORTH 14	Survey Calculation Method:	Minimum Curvature
Wellbore:	ORIGINAL WELLBORE		
Design:	PROPOSAL #1		

Design Targets									
Target Name									
- hit/miss target	Dip Angle	Dip Dir.	TVD	+N/-S	+E/-W	Northing	Easting	Latitude	Longitude
- Shape	(°)	(°)	(usft)	(usft)	(usft)	(usft)	(usft)		
WAKE NORTH 14 - PBI - plan hits target center - Point	0.00	0.00	6,910.00	1,808.40	-8,483.51	1,405,485.27	3,218,656.30	40° 26' 37.680 N	104° 42' 51.804 W
WAKE NORTH 14 - LP - plan hits target center - Point	0.00	0.00	6,910.00	1,337.02	1,246.94	1,405,103.46	3,228,390.68	40° 26' 33.036 N	104° 40' 45.948 W

Formations						
Measured Depth	Vertical Depth	Name	Lithology	Dip	Dip Direction	
(usft)	(usft)			(°)	(°)	
3,825.00	3,626.00	PARKMAN				
4,580.54	4,330.00	SUSSEX				
5,165.44	4,875.00	SHANNON				
7,171.12	6,730.00	SHARON SPRINGS				
7,214.52	6,760.00	NIOBRARA				
7,535.76	6,900.00	NIO B TARGET				

Plan Annotations				
Measured Depth	Vertical Depth	Local Coordinates		Comment
(usft)	(usft)	+N/-S (usft)	+E/-W (usft)	
200.00	200.00	0.00	0.00	BUILD 2°/100'
1,264.28	1,239.97	105.62	164.43	HOLD 21.29° INC
6,572.39	6,185.97	1,146.99	1,785.74	KOP, BUILD 10°/100'
7,644.32	6,910.00	1,337.02	1,246.94	LP @ 90° INC, 272.77° AZM HOLD
17,386.18	6,910.00	1,808.40	-8,483.51	TD at 17386.18' MD