

T7 & 8N, R81W, 6th P.M.

SandRidge Exploration & Production, LLC

LEASE AREA PLAN
Darby 0781 5 and 6-2H35, and Boyer Ridge 0781 3, 4, 5 and 6-11H14 located as shown in the E1/2 of Section 35, T8N, R81W and Sections 2, 11, and 14 T7N, R81W, of the 6th P.M., Jackson County, Colorado.

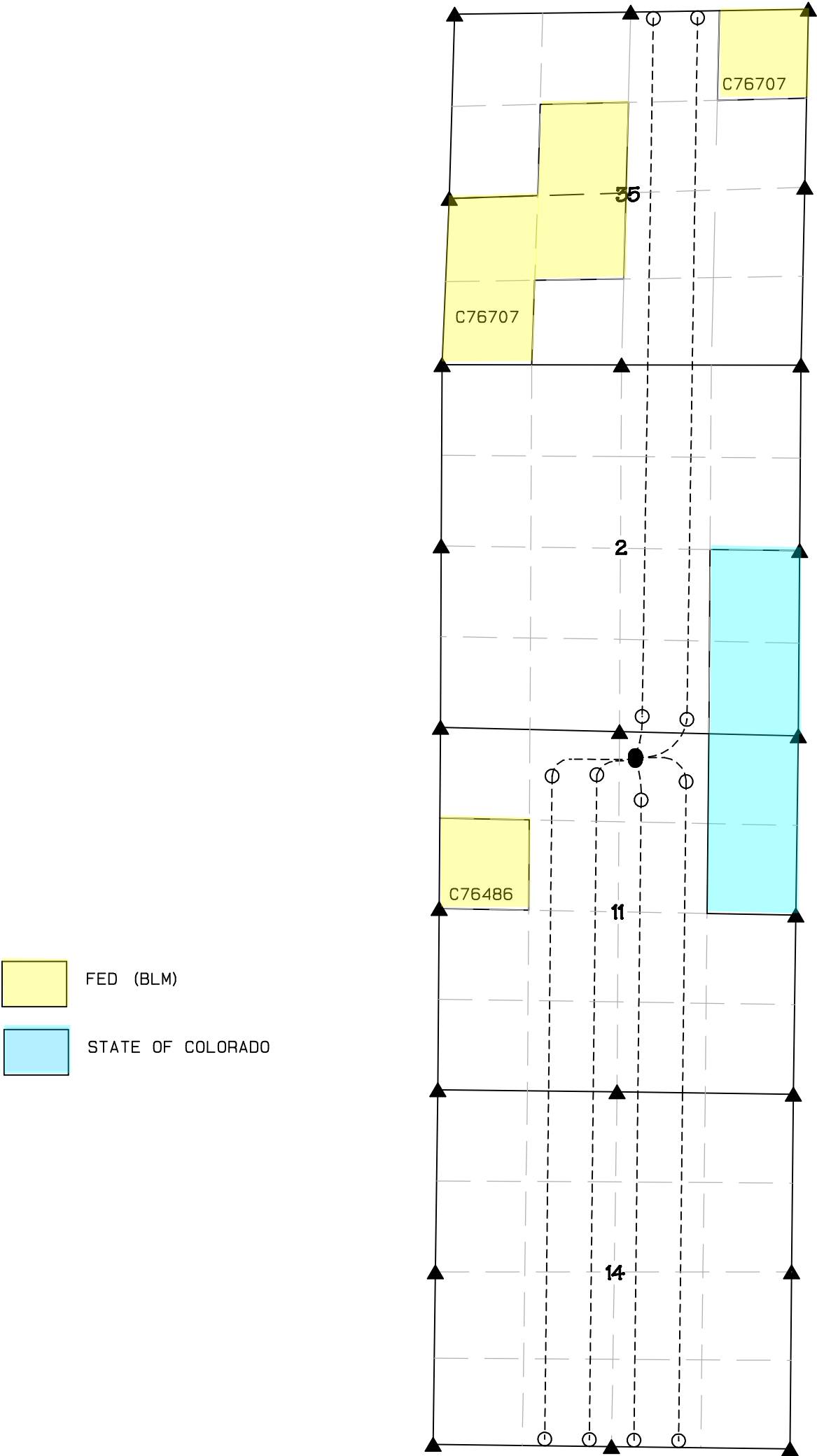

- FED (BLM)
- STATE OF COLORADO

LEGEND

- FOUND CORNER
- PROPOSED WELL
- PROPOSED BHL/LPL
-

BASIS OF BEARINGS:
US STATE PLANE 1983
CO NORTH 0501 GRID

BASIS OF ELEVATION
NAYD88 Computed using GEOID12B as measured using a combination of Static and Kinematic GPS based on an OPUS Solution Report.



GRAPHIC SCALE 1"=2000'

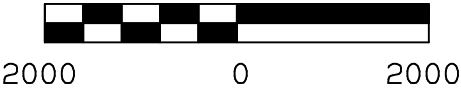

NORTH PARK ENGINEERING & CONSULTING, INC.
P.O. BOX 395
WALDEN, CO 80480
(970) 723-3725

| | |
|---------------------------------|-----------------------------------|
| DATE OF FIELD WORK: AUG 9, 2017 | DRAWING COMPLETION: SEPT 19, 2017 |
| SURVEYED BY: ADL/LRK | DRAWN BY: RPM CHECKED BY: TKH |