

SRC ENERGY

Location: COLORADO Slot: SLOT#12 TROUDT 40N-23C-M (760'FNL & 1760'FWL, SEC.27)
Field: WELD COUNTY (NAD83, TRUE NORTH) Well: TROUDT 40N-23C-M
Facility: SEC.27-T06N-R66W Wellbore: TROUDT 40N-23C-M PWB

Plot reference wellpath is TROUDT 40N-23C-M PWP (REV-A.0)	Grid System: NAD83 / Lambert Colorado SP, Northern Zone (501), US feet
True vertical depths are referenced to PD 562 (25) (RKB)	* = Wellpath was transformed from a different geodetic datum
Measured depths are referenced to PD 562 (25) (RKB)	North Reference: True north
PD 562 (25) (RKB) to Mean Sea Level: 4744 feet	Scale: True distance
Mean Sea Level to Mud line (At Slot: SLOT#12 TROUDT 40N-23C-M (760'FNL & 1760'FWL, SEC.27)): 0 feet	Depths are in feet
Coordinates are in feet referenced to Slot	Created by: doddanna on 2017-09-18
	Database: WellArchitectDB

Location Information

Facility Name			Grid East (US ft)	Grid North (US ft)	Latitude	Longitude
SEC.27-T06N-R66W			3203773.744	1412932.710	40°27'52.531"N	104°46'03.497"W
Slot	Local N (ft)	Local E (ft)	Grid East (US ft)	Grid North (US ft)	Latitude	Longitude
SLOT#12 TROUDT 40N-23C-M (760'FNL & 1760'FWL, SEC.27)	0.00	165.01	3203938.738	1412934.074	40°27'52.531"N	104°46'01.362"W
PD 562 (25) (RKB) to Mud line (At Slot: SLOT#12 TROUDT 40N-23C-M (760'FNL & 1760'FWL, SEC.27))						4744ft
Mean Sea Level to Mud line (At Slot: SLOT#12 TROUDT 40N-23C-M (760'FNL & 1760'FWL, SEC.27))						0ft
PD 562 (25) (RKB) to Mean Sea Level						4744ft

Survey Program

Start MD (ft)	End MD (ft)	Tool	Model	Log Name/Comment	Wellbore
25.00	1750.00	BHI NavTrak	Custom BHI NavTrak (Standard Rotating+Axial Core) (Rockies 0.03Gt model)		TROUDT 40N-23C-M PWB
1750.00	14836.05	BHI AutoTrak Curve	Custom BHI AutoTrak Curve (IFR1, Short) (Rockies 0.03Gt model)		TROUDT 40N-23C-M PWB



SRC ENERGY

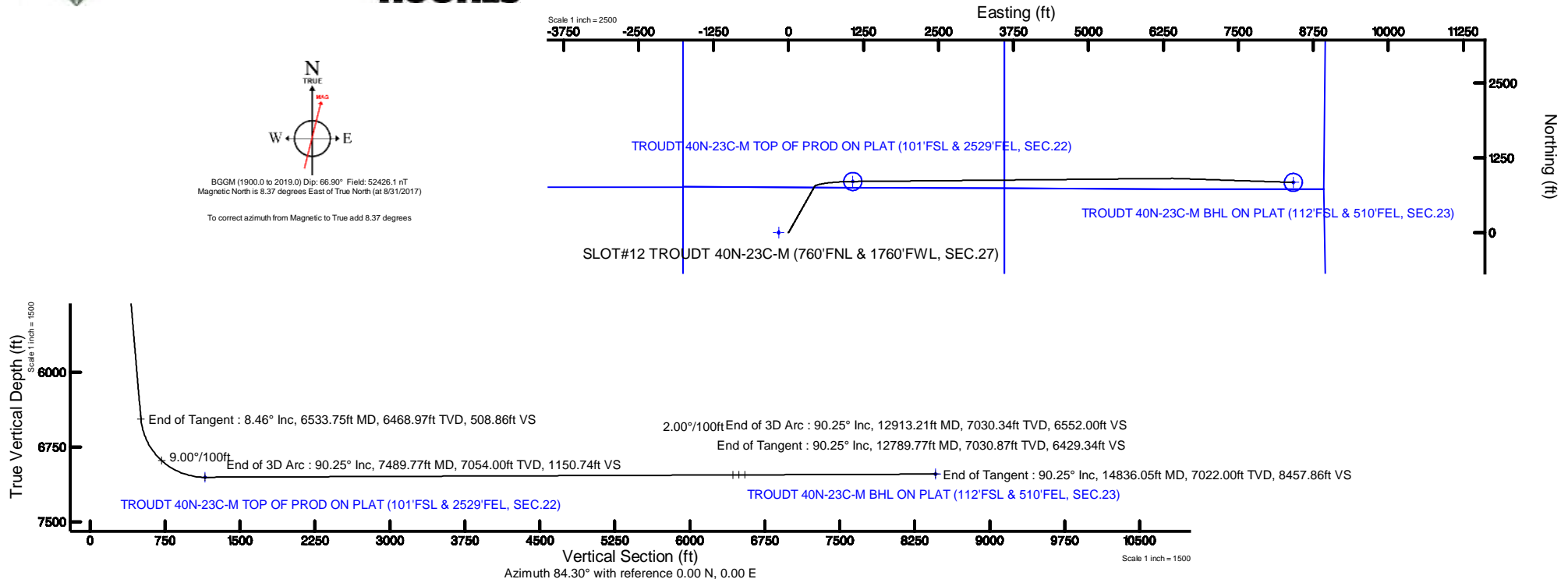
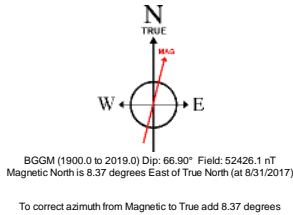

Targets

Name	MD (ft)	TVD (ft)	Local N (ft)	Local E (ft)	Grid East (US ft)	Grid North (US ft)	Latitude	Longitude
SEC.28-T06N-R66W		0.00	0.00	-165.01	3203773.74	1412932.71	40°27'52.531"N	104°46'03.497"W
SEC.22-T06N-R66W		1.00	1412.76	-8174.14	3195753.51	1414279.17	40°28'06.478"N	104°47'47.123"W
SEC.23-T06N-R66W		1.00	4231.30	-2032.31	3201871.60	1417148.27	40°28'34.342"N	104°44'27.680"W
SEC.26-T06N-R66W		1.00	-4763.04	510.16	3204488.23	1408175.60	40°27'05.465"N	104°45'54.763"W
SEC.27-T06N-R66W		1.00	-4763.04	510.16	3204488.23	1408175.60	40°27'05.465"N	104°45'54.763"W
TROUDT 40N-23C-M BHL ON PLAT (112'FSL & 510'FEL, SEC.23)	14836.05	7022.00	839.36	8416.11	3212347.30	1413842.94	40°28'00.811"N	104°44'12.473"W
TROUDT 40N-23C-M TOP OF PROD ON PLAT (101'FSL & 2529'FEL, SEC.22)	7489.77	7054.00	854.34	1071.25	3205002.85	1413797.21	40°28'00.973"N	104°44'47.502"W

Hole and Casing Sections

Name	Start MD (ft)	End MD (ft)	Interval (ft)	Start TVD (ft)	End TVD (ft)	Start Local N (ft)	Start Local E (ft)	End Local N (ft)	End Local E (ft)	Wellbore
13.5in Open Hole	25.00	1750.00	1725.00	25.00	1737.29	0.00	0.00	158.89	89.34	TROUDT 40N-23C-M PWB
9.625in Casing Surface	25.00	1750.00	1725.00	25.00	1737.29	0.00	0.00	158.89	89.34	TROUDT 40N-23C-M PWB
8.5in Open Hole	1750.00	14836.05	13086.05	1737.29	7022.00	158.89	89.34	839.36	8416.11	TROUDT 40N-23C-M PWB

Well Profile Data

Design Comment	MD (ft)	Inc (°)	Az (°)	TVD (ft)	Local N (ft)	Local E (ft)	DLS (°/100ft)	VS (ft)
Tie On	25.00	0.000	29.349	25.00	0.00	0.00	0.00	0.00
End of Tangent	300.00	0.000	29.349	300.00	0.00	0.00	0.00	0.00
End of Build	723.07	8.461	29.349	721.54	27.18	15.28	2.00	17.91
End of Tangent	6533.75	8.461	29.349	6468.97	772.45	434.34	0.00	508.86
End of 3D Arc	7489.77	90.250	89.450	7054.00	854.34	1071.25	9.00	1150.74
End of Tangent	12789.77	90.250	89.450	7030.87	905.22	6370.95	0.00	6429.34
End of 3D Arc	12913.21	90.248	91.919	7030.34	903.75	6494.37	2.00	6552.00
End of Tangent	14836.05	90.248	91.919	7022.00	839.36	8416.11	0.00	8457.86

TROUDT_40N-23C-M_PWP__REV-A.0_.las

~VERSION INFORMATION

VERS. 2.0 : CWLS LOG ASCII STANDARD-VERSION 2.0

WRAP. NO : ASCII DATA SECTION CONTAINS ONE ROW PER WELLPATH STATION

~WELL INFORMATION

#MNEM	.UNITS	DATA	:DESCRIPTION
#----	.-----	----	:-----
STRT	.ft	0.00	:START MD
STOP	.ft	14836.05	:STOP MD
STEP	.ft	0.0	:STEP (non-uniform increment)
NULL	.	-999.99	:NULL
COMP	.	SRC ENERGY	:OPERATOR
WELL	.	TROUDT 40N-23C-M	:WELL
FLD	.	WELD COUNTY (NAD83,TRUE NORTH)	:FIELD
LOC	.	COLORADO	:AREA (aka: Location)
CNTY	.	N/A	:COUNTY
STAT	.	N/A	:STATE
CTRY	.	N/A	:COUNTRY
SRVC	.	Baker Hughes	:CONTRACTOR
DATE	.	09/05/2017	:LOG REV DATE
API	.		:API NUMBER

~OTHER INFORMATION

#Software: WellArchitect(R) Version 5.0

#MNEM	.UNITS	DATA	:DESCRIPTION
#----	.-----	----	:-----
WPTYPE	.	PLANNED WELLPATH	:WELLPATH TYPE
FACILITY	.	SEC.27-T06N-R66W	:FACILITY
SLOT	.	SLOT#12 TROUDT 40N-23C-M (760'FNL & 1760'FWL, SEC.27):SLOT	:SLOT
WELLBORE	.	TROUDT 40N-23C-M PWB	:WELLBORE
WELLPATH	.	TROUDT 40N-23C-M PWP (REV-A.0)	:WELLPATH
MDREFPT	.	PD 562 (25') (RKB)	:MD REFERENCE POINT
TVDREFPT	.	PD 562 (25') (RKB)	:TVD REFERENCE POINT
LCLREFPT	.	Slot	:LOCAL COORDINATE REFERENCE PT

TROUDT_40N-23C-M_PWP__REV-A.0_.las

VSAZIMUTH.deg	84.30	:VERTICAL SECTION AZIMUTH
VSORIGN .ft	0.00	:VERTICAL SECTION ORIGIN NORTH
VSORIGE .ft	0.00	:VERTICAL SECTION ORIGIN EAST

~CURVE (WELLPATH) INFORMATION

#MNEM	.UNITS	:DESCRIPTION
#----	.-----	:-----
DEPT	.ft	:MEASURED DEPTH
INC	.deg	:INCLINATION
AZI	.deg	:AZIMUTH
TVD	.ft	:TRUE VERTICAL DEPTH
SECT	.ft	:CROSS SECTION (CURTAIN/VERTICAL)
LOCALN	.ft	:LOCAL NORTH
LOCALE	.ft	:LOCAL EAST
LAT	.deg	:LATITUDE
LONG	.deg	:LONGITUDE
DLS	.deg/100ft	:DOGLEG SEVERITY

~ASCII DATA

0.00	0.00	29.35	0.00	0.00	0.00	0.00	40.4645920	-104.7670450	0.00
25.00	0.00	29.35	25.00	0.00	0.00	0.00	40.4645920	-104.7670450	0.00
125.00	0.00	29.35	125.00	0.00	0.00	0.00	40.4645920	-104.7670450	0.00
225.00	0.00	29.35	225.00	0.00	0.00	0.00	40.4645920	-104.7670450	0.00
300.00	0.00	29.35	300.00	0.00	0.00	0.00	40.4645920	-104.7670450	0.00
325.00	0.50	29.35	325.00	0.06	0.10	0.05	40.4645923	-104.7670448	2.00
425.00	2.50	29.35	424.96	1.57	2.38	1.34	40.4645985	-104.7670402	2.00
525.00	4.50	29.35	524.77	5.07	7.70	4.33	40.4646131	-104.7670294	2.00
625.00	6.50	29.35	624.30	10.57	16.05	9.03	40.4646361	-104.7670126	2.00
723.07	8.46	29.35	721.54	17.91	27.18	15.28	40.4646666	-104.7669901	2.00
725.00	8.46	29.35	723.44	18.07	27.43	15.42	40.4646673	-104.7669896	0.00
825.00	8.46	29.35	822.35	26.52	40.25	22.63	40.4647025	-104.7669637	0.00
925.00	8.46	29.35	921.27	34.97	53.08	29.85	40.4647377	-104.7669377	0.00
1025.00	8.46	29.35	1020.18	43.42	65.91	37.06	40.4647729	-104.7669118	0.00
1125.00	8.46	29.35	1119.09	51.86	78.73	44.27	40.4648081	-104.7668859	0.00

TROUDT_40N-23C-M_PWP__REV-A.0_.las

1225.00	8.46	29.35	1218.00	60.31	91.56	51.48	40.4648433	-104.7668600	0.00
1325.00	8.46	29.35	1316.91	68.76	104.38	58.69	40.4648785	-104.7668341	0.00
1425.00	8.46	29.35	1415.82	77.21	117.21	65.91	40.4649137	-104.7668081	0.00
1525.00	8.46	29.35	1514.73	85.66	130.03	73.12	40.4649489	-104.7667822	0.00
1625.00	8.46	29.35	1613.65	94.11	142.86	80.33	40.4649841	-104.7667563	0.00
1725.00	8.46	29.35	1712.56	102.56	155.69	87.54	40.4650193	-104.7667304	0.00
1825.00	8.46	29.35	1811.47	111.01	168.51	94.75	40.4650545	-104.7667045	0.00
1925.00	8.46	29.35	1910.38	119.46	181.34	101.97	40.4650897	-104.7666786	0.00
2025.00	8.46	29.35	2009.29	127.91	194.16	109.18	40.4651250	-104.7666526	0.00
2125.00	8.46	29.35	2108.20	136.36	206.99	116.39	40.4651602	-104.7666267	0.00
2225.00	8.46	29.35	2207.12	144.81	219.81	123.60	40.4651954	-104.7666008	0.00
2325.00	8.46	29.35	2306.03	153.25	232.64	130.81	40.4652306	-104.7665749	0.00
2425.00	8.46	29.35	2404.94	161.70	245.47	138.02	40.4652658	-104.7665490	0.00
2525.00	8.46	29.35	2503.85	170.15	258.29	145.24	40.4653010	-104.7665230	0.00
2625.00	8.46	29.35	2602.76	178.60	271.12	152.45	40.4653362	-104.7664971	0.00
2725.00	8.46	29.35	2701.67	187.05	283.94	159.66	40.4653714	-104.7664712	0.00
2825.00	8.46	29.35	2800.58	195.50	296.77	166.87	40.4654066	-104.7664453	0.00
2925.00	8.46	29.35	2899.50	203.95	309.59	174.08	40.4654418	-104.7664194	0.00
3025.00	8.46	29.35	2998.41	212.40	322.42	181.30	40.4654770	-104.7663934	0.00
3125.00	8.46	29.35	3097.32	220.85	335.25	188.51	40.4655122	-104.7663675	0.00
3225.00	8.46	29.35	3196.23	229.30	348.07	195.72	40.4655474	-104.7663416	0.00
3325.00	8.46	29.35	3295.14	237.75	360.90	202.93	40.4655826	-104.7663157	0.00
3425.00	8.46	29.35	3394.05	246.20	373.72	210.14	40.4656178	-104.7662898	0.00
3525.00	8.46	29.35	3492.97	254.64	386.55	217.36	40.4656530	-104.7662639	0.00
3625.00	8.46	29.35	3591.88	263.09	399.38	224.57	40.4656882	-104.7662379	0.00
3725.00	8.46	29.35	3690.79	271.54	412.20	231.78	40.4657234	-104.7662120	0.00
3825.00	8.46	29.35	3789.70	279.99	425.03	238.99	40.4657586	-104.7661861	0.00
3925.00	8.46	29.35	3888.61	288.44	437.85	246.20	40.4657938	-104.7661602	0.00
4025.00	8.46	29.35	3987.52	296.89	450.68	253.42	40.4658290	-104.7661343	0.00
4125.00	8.46	29.35	4086.43	305.34	463.50	260.63	40.4658643	-104.7661083	0.00
4225.00	8.46	29.35	4185.35	313.79	476.33	267.84	40.4658995	-104.7660824	0.00
4325.00	8.46	29.35	4284.26	322.24	489.16	275.05	40.4659347	-104.7660565	0.00
4425.00	8.46	29.35	4383.17	330.69	501.98	282.26	40.4659699	-104.7660306	0.00
4525.00	8.46	29.35	4482.08	339.14	514.81	289.47	40.4660051	-104.7660047	0.00

TROUDT_40N-23C-M_PWP__REV-A.0_.las

4625.00	8.46	29.35	4580.99	347.58	527.63	296.69	40.4660403	-104.7659787	0.00
4725.00	8.46	29.35	4679.90	356.03	540.46	303.90	40.4660755	-104.7659528	0.00
4825.00	8.46	29.35	4778.82	364.48	553.28	311.11	40.4661107	-104.7659269	0.00
4925.00	8.46	29.35	4877.73	372.93	566.11	318.32	40.4661459	-104.7659010	0.00
5025.00	8.46	29.35	4976.64	381.38	578.94	325.53	40.4661811	-104.7658751	0.00
5125.00	8.46	29.35	5075.55	389.83	591.76	332.75	40.4662163	-104.7658491	0.00
5225.00	8.46	29.35	5174.46	398.28	604.59	339.96	40.4662515	-104.7658232	0.00
5325.00	8.46	29.35	5273.37	406.73	617.41	347.17	40.4662867	-104.7657973	0.00
5425.00	8.46	29.35	5372.28	415.18	630.24	354.38	40.4663219	-104.7657714	0.00
5525.00	8.46	29.35	5471.20	423.63	643.07	361.59	40.4663571	-104.7657455	0.00
5625.00	8.46	29.35	5570.11	432.08	655.89	368.81	40.4663923	-104.7657195	0.00
5725.00	8.46	29.35	5669.02	440.53	668.72	376.02	40.4664275	-104.7656936	0.00
5825.00	8.46	29.35	5767.93	448.97	681.54	383.23	40.4664627	-104.7656677	0.00
5925.00	8.46	29.35	5866.84	457.42	694.37	390.44	40.4664979	-104.7656418	0.00
6025.00	8.46	29.35	5965.75	465.87	707.19	397.65	40.4665331	-104.7656159	0.00
6125.00	8.46	29.35	6064.66	474.32	720.02	404.87	40.4665684	-104.7655899	0.00
6225.00	8.46	29.35	6163.58	482.77	732.85	412.08	40.4666036	-104.7655640	0.00
6325.00	8.46	29.35	6262.49	491.22	745.67	419.29	40.4666388	-104.7655381	0.00
6425.00	8.46	29.35	6361.40	499.67	758.50	426.50	40.4666740	-104.7655122	0.00
6525.00	8.46	29.35	6460.31	508.12	771.32	433.71	40.4667092	-104.7654863	0.00
6533.75	8.46	29.35	6468.97	508.86	772.45	434.34	40.4667123	-104.7654840	0.00
6625.00	14.40	59.28	6558.44	523.02	784.11	447.41	40.4667443	-104.7654370	9.00
6725.00	22.59	71.37	6653.23	553.07	796.63	476.37	40.4667786	-104.7653330	9.00
6825.00	31.21	77.13	6742.33	597.59	808.56	519.92	40.4668114	-104.7651765	9.00
6925.00	39.99	80.58	6823.57	655.49	819.61	577.00	40.4668417	-104.7649713	9.00
7025.00	48.84	82.95	6894.93	725.33	829.52	646.20	40.4668689	-104.7647226	9.00
7125.00	57.72	84.75	6954.67	805.40	838.03	725.81	40.4668922	-104.7644365	9.00
7225.00	66.63	86.22	7001.30	893.72	844.93	813.89	40.4669112	-104.7641199	9.00
7325.00	75.55	87.51	7033.68	988.13	850.07	908.25	40.4669253	-104.7637808	9.00
7425.00	84.47	88.70	7051.02	1086.29	853.30	1006.58	40.4669341	-104.7634274	9.00
7489.77	90.25	89.45	7054.00	1150.74	854.34	1071.25	40.4669370	-104.7631950	9.00
7525.00	90.25	89.45	7053.85	1185.83	854.68	1106.47	40.4669379	-104.7630684	0.00
7625.00	90.25	89.45	7053.41	1285.43	855.64	1206.47	40.4669405	-104.7627090	0.00
7725.00	90.25	89.45	7052.97	1385.02	856.60	1306.46	40.4669432	-104.7623496	0.00

TROUDT_40N-23C-M_PWP__REV-A.0_.las

7825.00	90.25	89.45	7052.54	1484.62	857.56	1406.46	40.4669458	-104.7619903	0.00
7925.00	90.25	89.45	7052.10	1584.22	858.52	1506.45	40.4669484	-104.7616309	0.00
8025.00	90.25	89.45	7051.66	1683.81	859.48	1606.45	40.4669510	-104.7612715	0.00
8125.00	90.25	89.45	7051.23	1783.41	860.44	1706.44	40.4669536	-104.7609122	0.00
8225.00	90.25	89.45	7050.79	1883.00	861.40	1806.43	40.4669563	-104.7605528	0.00
8325.00	90.25	89.45	7050.36	1982.60	862.36	1906.43	40.4669589	-104.7601934	0.00
8425.00	90.25	89.45	7049.92	2082.20	863.32	2006.42	40.4669615	-104.7598340	0.00
8525.00	90.25	89.45	7049.48	2181.79	864.28	2106.42	40.4669641	-104.7594747	0.00
8625.00	90.25	89.45	7049.05	2281.39	865.24	2206.41	40.4669667	-104.7591153	0.00
8725.00	90.25	89.45	7048.61	2380.98	866.20	2306.41	40.4669693	-104.7587559	0.00
8825.00	90.25	89.45	7048.17	2480.58	867.16	2406.40	40.4669719	-104.7583965	0.00
8925.00	90.25	89.45	7047.74	2580.18	868.12	2506.40	40.4669745	-104.7580372	0.00
9025.00	90.25	89.45	7047.30	2679.77	869.08	2606.39	40.4669771	-104.7576778	0.00
9125.00	90.25	89.45	7046.86	2779.37	870.04	2706.38	40.4669797	-104.7573184	0.00
9225.00	90.25	89.45	7046.43	2878.96	871.00	2806.38	40.4669823	-104.7569590	0.00
9325.00	90.25	89.45	7045.99	2978.56	871.96	2906.37	40.4669849	-104.7565997	0.00
9425.00	90.25	89.45	7045.56	3078.16	872.92	3006.37	40.4669876	-104.7562403	0.00
9525.00	90.25	89.45	7045.12	3177.75	873.88	3106.36	40.4669902	-104.7558809	0.00
9625.00	90.25	89.45	7044.68	3277.35	874.84	3206.36	40.4669928	-104.7555215	0.00
9725.00	90.25	89.45	7044.25	3376.94	875.80	3306.35	40.4669953	-104.7551622	0.00
9825.00	90.25	89.45	7043.81	3476.54	876.76	3406.35	40.4669979	-104.7548028	0.00
9925.00	90.25	89.45	7043.37	3576.14	877.72	3506.34	40.4670005	-104.7544434	0.00
10025.00	90.25	89.45	7042.94	3675.73	878.68	3606.33	40.4670031	-104.7540840	0.00
10125.00	90.25	89.45	7042.50	3775.33	879.64	3706.33	40.4670057	-104.7537247	0.00
10225.00	90.25	89.45	7042.07	3874.92	880.60	3806.32	40.4670083	-104.7533653	0.00
10325.00	90.25	89.45	7041.63	3974.52	881.56	3906.32	40.4670109	-104.7530059	0.00
10425.00	90.25	89.45	7041.19	4074.12	882.52	4006.31	40.4670135	-104.7526465	0.00
10525.00	90.25	89.45	7040.76	4173.71	883.48	4106.31	40.4670161	-104.7522872	0.00
10625.00	90.25	89.45	7040.32	4273.31	884.44	4206.30	40.4670187	-104.7519278	0.00
10725.00	90.25	89.45	7039.88	4372.91	885.40	4306.30	40.4670213	-104.7515684	0.00
10825.00	90.25	89.45	7039.45	4472.50	886.36	4406.29	40.4670239	-104.7512090	0.00
10925.00	90.25	89.45	7039.01	4572.10	887.32	4506.28	40.4670264	-104.7508497	0.00
11025.00	90.25	89.45	7038.57	4671.69	888.28	4606.28	40.4670290	-104.7504903	0.00
11125.00	90.25	89.45	7038.14	4771.29	889.24	4706.27	40.4670316	-104.7501309	0.00

TROUDT_40N-23C-M_PWP__REV-A.0_.las

11225.00	90.25	89.45	7037.70	4870.89	890.20	4806.27	40.4670342	-104.7497715	0.00
11325.00	90.25	89.45	7037.27	4970.48	891.16	4906.26	40.4670368	-104.7494122	0.00
11425.00	90.25	89.45	7036.83	5070.08	892.12	5006.26	40.4670394	-104.7490528	0.00
11525.00	90.25	89.45	7036.39	5169.67	893.08	5106.25	40.4670419	-104.7486934	0.00
11625.00	90.25	89.45	7035.96	5269.27	894.04	5206.25	40.4670445	-104.7483340	0.00
11725.00	90.25	89.45	7035.52	5368.87	895.00	5306.24	40.4670471	-104.7479746	0.00
11825.00	90.25	89.45	7035.08	5468.46	895.96	5406.23	40.4670497	-104.7476153	0.00
11925.00	90.25	89.45	7034.65	5568.06	896.92	5506.23	40.4670522	-104.7472559	0.00
12025.00	90.25	89.45	7034.21	5667.65	897.88	5606.22	40.4670548	-104.7468965	0.00
12125.00	90.25	89.45	7033.78	5767.25	898.84	5706.22	40.4670574	-104.7465371	0.00
12225.00	90.25	89.45	7033.34	5866.85	899.80	5806.21	40.4670600	-104.7461778	0.00
12325.00	90.25	89.45	7032.90	5966.44	900.76	5906.21	40.4670625	-104.7458184	0.00
12425.00	90.25	89.45	7032.47	6066.04	901.72	6006.20	40.4670651	-104.7454590	0.00
12525.00	90.25	89.45	7032.03	6165.63	902.68	6106.20	40.4670677	-104.7450996	0.00
12625.00	90.25	89.45	7031.59	6265.23	903.64	6206.19	40.4670702	-104.7447403	0.00
12725.00	90.25	89.45	7031.16	6364.83	904.60	6306.18	40.4670728	-104.7443809	0.00
12789.77	90.25	89.45	7030.87	6429.34	905.22	6370.95	40.4670745	-104.7441481	0.00
12825.00	90.25	90.16	7030.72	6464.40	905.34	6406.18	40.4670748	-104.7440215	2.00
12913.21	90.25	91.92	7030.34	6552.00	903.75	6494.37	40.4670703	-104.7437046	2.00
12925.00	90.25	91.92	7030.29	6563.69	903.35	6506.15	40.4670692	-104.7436622	0.00
13025.00	90.25	91.92	7029.85	6662.80	900.00	6606.10	40.4670600	-104.7433030	0.00
13125.00	90.25	91.92	7029.42	6761.92	896.65	6706.04	40.4670507	-104.7429438	0.00
13225.00	90.25	91.92	7028.99	6861.04	893.31	6805.98	40.4670414	-104.7425846	0.00
13325.00	90.25	91.92	7028.55	6960.16	889.96	6905.93	40.4670322	-104.7422255	0.00
13425.00	90.25	91.92	7028.12	7059.27	886.61	7005.87	40.4670229	-104.7418663	0.00
13525.00	90.25	91.92	7027.68	7158.39	883.26	7105.81	40.4670136	-104.7415071	0.00
13625.00	90.25	91.92	7027.25	7257.51	879.91	7205.76	40.4670044	-104.7411479	0.00
13725.00	90.25	91.92	7026.82	7356.62	876.56	7305.70	40.4669951	-104.7407887	0.00
13825.00	90.25	91.92	7026.38	7455.74	873.22	7405.64	40.4669858	-104.7404295	0.00
13925.00	90.25	91.92	7025.95	7554.86	869.87	7505.58	40.4669765	-104.7400703	0.00
14025.00	90.25	91.92	7025.52	7653.98	866.52	7605.53	40.4669673	-104.7397112	0.00
14125.00	90.25	91.92	7025.08	7753.09	863.17	7705.47	40.4669580	-104.7393520	0.00
14225.00	90.25	91.92	7024.65	7852.21	859.82	7805.41	40.4669487	-104.7389928	0.00
14325.00	90.25	91.92	7024.22	7951.33	856.47	7905.36	40.4669394	-104.7386336	0.00

TROUDT_40N-23C-M_PWP__REV-A.0_.las									
14425.00	90.25	91.92	7023.78	8050.45	853.13	8005.30	40.4669302	-104.7382744	0.00
14525.00	90.25	91.92	7023.35	8149.56	849.78	8105.24	40.4669209	-104.7379152	0.00
14625.00	90.25	91.92	7022.92	8248.68	846.43	8205.19	40.4669116	-104.7375560	0.00
14725.00	90.25	91.92	7022.48	8347.80	843.08	8305.13	40.4669023	-104.7371969	0.00
14825.00	90.25	91.92	7022.05	8446.92	839.73	8405.07	40.4668930	-104.7368377	0.00
14835.71	90.25	91.92	7022.00	8457.53	839.37	8415.78	40.4668920	-104.7367992	0.00
14836.05	90.25	91.92	7022.00	8457.86	839.36	8416.11	40.4668920	-104.7367980	0.00



Planned Wellpath Report

TROUDT 40N-23C-M PWP (REV-A.0)
Page 1 of 8



REFERENCE WELLPATH IDENTIFICATION

Operator	SRC ENERGY	Slot	SLOT#12 TROUDT 40N-23C-M (760'FNL & 1760'FWL, SEC.27)
Area	COLORADO	Well	TROUDT 40N-23C-M
Field	WELD COUNTY (NAD83, TRUE NORTH)	Wellbore	TROUDT 40N-23C-M PWB
Facility	SEC.27-T06N-R66W		

REPORT SETUP INFORMATION

Projection System	NAD83 / Lambert Colorado SP, Northern Zone (501), US feet	Software System	WellArchitect® 5.0
North Reference	True	User	Doddanna
Scale	0.999964	Report Generated	9/18/2017 at 4:29:59 PM
Convergence at slot	0.47° East	Database/Source file	WellArchitectDB/TROUDT_40N-23C-M_PWP__REV-A.0_.xml

WELLPATH LOCATION

	Local coordinates		Grid coordinates		Geographic coordinates	
	North[ft]	East[ft]	Easting[US ft]	Northing[US ft]	Latitude	Longitude
Slot Location	0.00	165.01	3203938.74	1412934.07	40°27'52.531"N	104°46'01.362"W
Facility Reference Pt			3203773.74	1412932.71	40°27'52.531"N	104°46'03.497"W
Field Reference Pt			3171284.48	1426358.81	40°30'07.643"N	104°53'02.634"W

WELLPATH DATUM

Calculation method	Minimum curvature	PD 562 (25') (RKB) to Facility Vertical Datum	4744.00ft
Horizontal Reference Pt	Slot	PD 562 (25') (RKB) to Mean Sea Level	4744.00ft
Vertical Reference Pt	PD 562 (25') (RKB)	PD 562 (25') (RKB) to Mud Line at Slot (SLOT#12 TROUDT 40N-23C-M (760'FNL & 1760'FWL, SEC.27))	4744.00ft
MD Reference Pt	PD 562 (25') (RKB)	Section Origin	N 0.00, E 0.00 ft
Field Vertical Reference	Mean Sea Level	Section Azimuth	84.30°



Planned Wellpath Report

TROUDT 40N-23C-M PWP (REV-A.0)

Page 2 of 8



REFERENCE WELLPATH IDENTIFICATION			
Operator	SRC ENERGY	Slot	SLOT#12 TROUDT 40N-23C-M (760'FNL & 1760'FWL, SEC.27)
Area	COLORADO	Well	TROUDT 40N-23C-M
Field	WELD COUNTY (NAD83,TRUE NORTH)	Wellbore	TROUDT 40N-23C-M PWB
Facility	SEC.27-T06N-R66W		

WELLPATH DATA (158 stations) † = interpolated/extrapolated station								
MD [ft]	Inclination [°]	Azimuth [°]	TVD [ft]	Vert Sect [ft]	North [ft]	East [ft]	DLS [°/100ft]	Comments
0.00†	0.000	29.349	0.00	0.00	0.00	0.00	0.00	
25.00	0.000	29.349	25.00	0.00	0.00	0.00	0.00	Tie On
125.00†	0.000	29.349	125.00	0.00	0.00	0.00	0.00	
225.00†	0.000	29.349	225.00	0.00	0.00	0.00	0.00	
300.00	0.000	29.349	300.00	0.00	0.00	0.00	0.00	End of Tangent
325.00†	0.500	29.349	325.00	0.06	0.10	0.05	2.00	
425.00†	2.500	29.349	424.96	1.57	2.38	1.34	2.00	
525.00†	4.500	29.349	524.77	5.07	7.70	4.33	2.00	
625.00†	6.500	29.349	624.30	10.57	16.05	9.03	2.00	
723.07	8.461	29.349	721.54	17.91	27.18	15.28	2.00	End of Build
725.00†	8.461	29.349	723.44	18.07	27.43	15.42	0.00	
825.00†	8.461	29.349	822.35	26.52	40.25	22.63	0.00	
925.00†	8.461	29.349	921.27	34.97	53.08	29.85	0.00	
1025.00†	8.461	29.349	1020.18	43.42	65.91	37.06	0.00	
1125.00†	8.461	29.349	1119.09	51.86	78.73	44.27	0.00	
1225.00†	8.461	29.349	1218.00	60.31	91.56	51.48	0.00	
1325.00†	8.461	29.349	1316.91	68.76	104.38	58.69	0.00	
1425.00†	8.461	29.349	1415.82	77.21	117.21	65.91	0.00	
1525.00†	8.461	29.349	1514.73	85.66	130.03	73.12	0.00	
1625.00†	8.461	29.349	1613.65	94.11	142.86	80.33	0.00	
1725.00†	8.461	29.349	1712.56	102.56	155.69	87.54	0.00	
1825.00†	8.461	29.349	1811.47	111.01	168.51	94.75	0.00	
1925.00†	8.461	29.349	1910.38	119.46	181.34	101.97	0.00	
2025.00†	8.461	29.349	2009.29	127.91	194.16	109.18	0.00	
2125.00†	8.461	29.349	2108.20	136.36	206.99	116.39	0.00	
2225.00†	8.461	29.349	2207.12	144.81	219.81	123.60	0.00	
2325.00†	8.461	29.349	2306.03	153.25	232.64	130.81	0.00	
2425.00†	8.461	29.349	2404.94	161.70	245.47	138.02	0.00	
2525.00†	8.461	29.349	2503.85	170.15	258.29	145.24	0.00	
2625.00†	8.461	29.349	2602.76	178.60	271.12	152.45	0.00	



Planned Wellpath Report

TROUDT 40N-23C-M PWP (REV-A.0)

Page 3 of 8



REFERENCE WELLPATH IDENTIFICATION			
Operator	SRC ENERGY	Slot	SLOT#12 TROUDT 40N-23C-M (760'FNL & 1760'FWL, SEC.27)
Area	COLORADO	Well	TROUDT 40N-23C-M
Field	WELD COUNTY (NAD83,TRUE NORTH)	Wellbore	TROUDT 40N-23C-M PWB
Facility	SEC.27-T06N-R66W		

WELLPATH DATA (158 stations) † = interpolated/extrapolated station								
MD [ft]	Inclination [°]	Azimuth [°]	TVD [ft]	Vert Sect [ft]	North [ft]	East [ft]	DLS [°/100ft]	Comments
2725.00†	8.461	29.349	2701.67	187.05	283.94	159.66	0.00	
2825.00†	8.461	29.349	2800.58	195.50	296.77	166.87	0.00	
2925.00†	8.461	29.349	2899.50	203.95	309.59	174.08	0.00	
3025.00†	8.461	29.349	2998.41	212.40	322.42	181.30	0.00	
3125.00†	8.461	29.349	3097.32	220.85	335.25	188.51	0.00	
3225.00†	8.461	29.349	3196.23	229.30	348.07	195.72	0.00	
3325.00†	8.461	29.349	3295.14	237.75	360.90	202.93	0.00	
3425.00†	8.461	29.349	3394.05	246.20	373.72	210.14	0.00	
3525.00†	8.461	29.349	3492.97	254.64	386.55	217.36	0.00	
3625.00†	8.461	29.349	3591.88	263.09	399.38	224.57	0.00	
3725.00†	8.461	29.349	3690.79	271.54	412.20	231.78	0.00	
3825.00†	8.461	29.349	3789.70	279.99	425.03	238.99	0.00	
3925.00†	8.461	29.349	3888.61	288.44	437.85	246.20	0.00	
4025.00†	8.461	29.349	3987.52	296.89	450.68	253.42	0.00	
4125.00†	8.461	29.349	4086.43	305.34	463.50	260.63	0.00	
4225.00†	8.461	29.349	4185.35	313.79	476.33	267.84	0.00	
4325.00†	8.461	29.349	4284.26	322.24	489.16	275.05	0.00	
4425.00†	8.461	29.349	4383.17	330.69	501.98	282.26	0.00	
4525.00†	8.461	29.349	4482.08	339.14	514.81	289.47	0.00	
4625.00†	8.461	29.349	4580.99	347.58	527.63	296.69	0.00	
4725.00†	8.461	29.349	4679.90	356.03	540.46	303.90	0.00	
4825.00†	8.461	29.349	4778.82	364.48	553.28	311.11	0.00	
4925.00†	8.461	29.349	4877.73	372.93	566.11	318.32	0.00	
5025.00†	8.461	29.349	4976.64	381.38	578.94	325.53	0.00	
5125.00†	8.461	29.349	5075.55	389.83	591.76	332.75	0.00	
5225.00†	8.461	29.349	5174.46	398.28	604.59	339.96	0.00	
5325.00†	8.461	29.349	5273.37	406.73	617.41	347.17	0.00	
5425.00†	8.461	29.349	5372.28	415.18	630.24	354.38	0.00	
5525.00†	8.461	29.349	5471.20	423.63	643.07	361.59	0.00	
5625.00†	8.461	29.349	5570.11	432.08	655.89	368.81	0.00	



Planned Wellpath Report

TROUDT 40N-23C-M PWP (REV-A.0)

Page 4 of 8



REFERENCE WELLPATH IDENTIFICATION			
Operator	SRC ENERGY	Slot	SLOT#12 TROUDT 40N-23C-M (760'FNL & 1760'FWL, SEC.27)
Area	COLORADO	Well	TROUDT 40N-23C-M
Field	WELD COUNTY (NAD83,TRUE NORTH)	Wellbore	TROUDT 40N-23C-M PWB
Facility	SEC.27-T06N-R66W		

WELLPATH DATA (158 stations) † = interpolated/extrapolated station								
MD [ft]	Inclination [°]	Azimuth [°]	TVD [ft]	Vert Sect [ft]	North [ft]	East [ft]	DLS [°/100ft]	Comments
5725.00†	8.461	29.349	5669.02	440.53	668.72	376.02	0.00	
5825.00†	8.461	29.349	5767.93	448.97	681.54	383.23	0.00	
5925.00†	8.461	29.349	5866.84	457.42	694.37	390.44	0.00	
6025.00†	8.461	29.349	5965.75	465.87	707.19	397.65	0.00	
6125.00†	8.461	29.349	6064.66	474.32	720.02	404.87	0.00	
6225.00†	8.461	29.349	6163.58	482.77	732.85	412.08	0.00	
6325.00†	8.461	29.349	6262.49	491.22	745.67	419.29	0.00	
6425.00†	8.461	29.349	6361.40	499.67	758.50	426.50	0.00	
6525.00†	8.461	29.349	6460.31	508.12	771.32	433.71	0.00	
6533.75	8.461	29.349	6468.97	508.86	772.45	434.34	0.00	End of Tangent
6625.00†	14.403	59.284	6558.44	523.02	784.11	447.41	9.00	
6725.00†	22.591	71.368	6653.23	553.07	796.63	476.37	9.00	
6825.00†	31.214	77.134	6742.33	597.59	808.56	519.92	9.00	
6925.00†	39.991	80.577	6823.57	655.49	819.61	577.00	9.00	
7025.00†	48.839	82.946	6894.93	725.33	829.52	646.20	9.00	
7125.00†	57.723	84.747	6954.67	805.40	838.03	725.81	9.00	
7225.00†	66.628	86.224	7001.30	893.72	844.93	813.89	9.00	
7325.00†	75.545	87.513	7033.68	988.13	850.07	908.25	9.00	
7425.00†	84.469	88.702	7051.02	1086.29	853.30	1006.58	9.00	
7489.77	90.250	89.450	7054.00 [†]	1150.74	854.34	1071.25	9.00	End of 3D Arc
7525.00†	90.250	89.450	7053.85	1185.83	854.68	1106.47	0.00	
7625.00†	90.250	89.450	7053.41	1285.43	855.64	1206.47	0.00	
7725.00†	90.250	89.450	7052.97	1385.02	856.60	1306.46	0.00	
7825.00†	90.250	89.450	7052.54	1484.62	857.56	1406.46	0.00	
7925.00†	90.250	89.450	7052.10	1584.22	858.52	1506.45	0.00	
8025.00†	90.250	89.450	7051.66	1683.81	859.48	1606.45	0.00	
8125.00†	90.250	89.450	7051.23	1783.41	860.44	1706.44	0.00	
8225.00†	90.250	89.450	7050.79	1883.00	861.40	1806.43	0.00	
8325.00†	90.250	89.450	7050.36	1982.60	862.36	1906.43	0.00	
8425.00†	90.250	89.450	7049.92	2082.20	863.32	2006.42	0.00	



Planned Wellpath Report

TROUDT 40N-23C-M PWP (REV-A.0)

Page 5 of 8



REFERENCE WELLPATH IDENTIFICATION			
Operator	SRC ENERGY	Slot	SLOT#12 TROUDT 40N-23C-M (760'FNL & 1760'FWL, SEC.27)
Area	COLORADO	Well	TROUDT 40N-23C-M
Field	WELD COUNTY (NAD83,TRUE NORTH)	Wellbore	TROUDT 40N-23C-M PWB
Facility	SEC.27-T06N-R66W		

WELLPATH DATA (158 stations) † = interpolated/extrapolated station								
MD [ft]	Inclination [°]	Azimuth [°]	TVD [ft]	Vert Sect [ft]	North [ft]	East [ft]	DLS [°/100ft]	Comments
8525.00†	90.250	89.450	7049.48	2181.79	864.28	2106.42	0.00	
8625.00†	90.250	89.450	7049.05	2281.39	865.24	2206.41	0.00	
8725.00†	90.250	89.450	7048.61	2380.98	866.20	2306.41	0.00	
8825.00†	90.250	89.450	7048.17	2480.58	867.16	2406.40	0.00	
8925.00†	90.250	89.450	7047.74	2580.18	868.12	2506.40	0.00	
9025.00†	90.250	89.450	7047.30	2679.77	869.08	2606.39	0.00	
9125.00†	90.250	89.450	7046.86	2779.37	870.04	2706.38	0.00	
9225.00†	90.250	89.450	7046.43	2878.96	871.00	2806.38	0.00	
9325.00†	90.250	89.450	7045.99	2978.56	871.96	2906.37	0.00	
9425.00†	90.250	89.450	7045.56	3078.16	872.92	3006.37	0.00	
9525.00†	90.250	89.450	7045.12	3177.75	873.88	3106.36	0.00	
9625.00†	90.250	89.450	7044.68	3277.35	874.84	3206.36	0.00	
9725.00†	90.250	89.450	7044.25	3376.94	875.80	3306.35	0.00	
9825.00†	90.250	89.450	7043.81	3476.54	876.76	3406.35	0.00	
9925.00†	90.250	89.450	7043.37	3576.14	877.72	3506.34	0.00	
10025.00†	90.250	89.450	7042.94	3675.73	878.68	3606.33	0.00	
10125.00†	90.250	89.450	7042.50	3775.33	879.64	3706.33	0.00	
10225.00†	90.250	89.450	7042.07	3874.92	880.60	3806.32	0.00	
10325.00†	90.250	89.450	7041.63	3974.52	881.56	3906.32	0.00	
10425.00†	90.250	89.450	7041.19	4074.12	882.52	4006.31	0.00	
10525.00†	90.250	89.450	7040.76	4173.71	883.48	4106.31	0.00	
10625.00†	90.250	89.450	7040.32	4273.31	884.44	4206.30	0.00	
10725.00†	90.250	89.450	7039.88	4372.91	885.40	4306.30	0.00	
10825.00†	90.250	89.450	7039.45	4472.50	886.36	4406.29	0.00	
10925.00†	90.250	89.450	7039.01	4572.10	887.32	4506.28	0.00	
11025.00†	90.250	89.450	7038.57	4671.69	888.28	4606.28	0.00	
11125.00†	90.250	89.450	7038.14	4771.29	889.24	4706.27	0.00	
11225.00†	90.250	89.450	7037.70	4870.89	890.20	4806.27	0.00	
11325.00†	90.250	89.450	7037.27	4970.48	891.16	4906.26	0.00	
11425.00†	90.250	89.450	7036.83	5070.08	892.12	5006.26	0.00	



Planned Wellpath Report

TROUDT 40N-23C-M PWP (REV-A.0)

Page 6 of 8



REFERENCE WELLPATH IDENTIFICATION			
Operator	SRC ENERGY	Slot	SLOT#12 TROUDT 40N-23C-M (760'FNL & 1760'FWL, SEC.27)
Area	COLORADO	Well	TROUDT 40N-23C-M
Field	WELD COUNTY (NAD83,TRUE NORTH)	Wellbore	TROUDT 40N-23C-M PWB
Facility	SEC.27-T06N-R66W		

WELLPATH DATA (158 stations) † = interpolated/extrapolated station								
MD [ft]	Inclination [°]	Azimuth [°]	TVD [ft]	Vert Sect [ft]	North [ft]	East [ft]	DLS [°/100ft]	Comments
11525.00†	90.250	89.450	7036.39	5169.67	893.08	5106.25	0.00	
11625.00†	90.250	89.450	7035.96	5269.27	894.04	5206.25	0.00	
11725.00†	90.250	89.450	7035.52	5368.87	895.00	5306.24	0.00	
11825.00†	90.250	89.450	7035.08	5468.46	895.96	5406.23	0.00	
11925.00†	90.250	89.450	7034.65	5568.06	896.92	5506.23	0.00	
12025.00†	90.250	89.450	7034.21	5667.65	897.88	5606.22	0.00	
12125.00†	90.250	89.450	7033.78	5767.25	898.84	5706.22	0.00	
12225.00†	90.250	89.450	7033.34	5866.85	899.80	5806.21	0.00	
12325.00†	90.250	89.450	7032.90	5966.44	900.76	5906.21	0.00	
12425.00†	90.250	89.450	7032.47	6066.04	901.72	6006.20	0.00	
12525.00†	90.250	89.450	7032.03	6165.63	902.68	6106.20	0.00	
12625.00†	90.250	89.450	7031.59	6265.23	903.64	6206.19	0.00	
12725.00†	90.250	89.450	7031.16	6364.83	904.60	6306.18	0.00	
12789.77	90.250	89.450	7030.87	6429.34	905.22	6370.95	0.00	End of Tangent
12825.00†	90.250	90.155	7030.72	6464.40	905.34	6406.18	2.00	
12913.21	90.248	91.919	7030.34	6552.00	903.75	6494.37	2.00	End of 3D Arc
12925.00†	90.248	91.919	7030.29	6563.69	903.35	6506.15	0.00	
13025.00†	90.248	91.919	7029.85	6662.80	900.00	6606.10	0.00	
13125.00†	90.248	91.919	7029.42	6761.92	896.65	6706.04	0.00	
13225.00†	90.248	91.919	7028.99	6861.04	893.31	6805.98	0.00	
13325.00†	90.248	91.919	7028.55	6960.16	889.96	6905.93	0.00	
13425.00†	90.248	91.919	7028.12	7059.27	886.61	7005.87	0.00	
13525.00†	90.248	91.919	7027.68	7158.39	883.26	7105.81	0.00	
13625.00†	90.248	91.919	7027.25	7257.51	879.91	7205.76	0.00	
13725.00†	90.248	91.919	7026.82	7356.62	876.56	7305.70	0.00	
13825.00†	90.248	91.919	7026.38	7455.74	873.22	7405.64	0.00	
13925.00†	90.248	91.919	7025.95	7554.86	869.87	7505.58	0.00	
14025.00†	90.248	91.919	7025.52	7653.98	866.52	7605.53	0.00	
14125.00†	90.248	91.919	7025.08	7753.09	863.17	7705.47	0.00	
14225.00†	90.248	91.919	7024.65	7852.21	859.82	7805.41	0.00	



Planned Wellpath Report

TROUDT 40N-23C-M PWP (REV-A.0)

Page 7 of 8



REFERENCE WELLPATH IDENTIFICATION			
Operator	SRC ENERGY	Slot	SLOT#12 TROUDT 40N-23C-M (760'FNL & 1760'FWL, SEC.27)
Area	COLORADO	Well	TROUDT 40N-23C-M
Field	WELD COUNTY (NAD83,TRUE NORTH)	Wellbore	TROUDT 40N-23C-M PWB
Facility	SEC.27-T06N-R66W		

WELLPATH DATA (158 stations) † = interpolated/extrapolated station								
MD [ft]	Inclination [°]	Azimuth [°]	TVD [ft]	Vert Sect [ft]	North [ft]	East [ft]	DLS [°/100ft]	Comments
14325.00†	90.248	91.919	7024.22	7951.33	856.47	7905.36	0.00	
14425.00†	90.248	91.919	7023.78	8050.45	853.13	8005.30	0.00	
14525.00†	90.248	91.919	7023.35	8149.56	849.78	8105.24	0.00	
14625.00†	90.248	91.919	7022.92	8248.68	846.43	8205.19	0.00	
14725.00†	90.248	91.919	7022.48	8347.80	843.08	8305.13	0.00	
14825.00†	90.248	91.919	7022.05	8446.92	839.73	8405.07	0.00	
14835.71†	90.248	91.919	7022.00	8457.53	839.37	8415.78	0.00	
14836.05	90.248	91.919	7022.00 ²	8457.86	839.36	8416.11	0.00	End of Tangent

HOLE & CASING SECTIONS - Ref Wellbore: TROUDT 40N-23C-M PWB Ref Wellpath: TROUDT 40N-23C-M PWP (REV-A.0)									
String/Diameter	Start MD [ft]	End MD [ft]	Interval [ft]	Start TVD [ft]	End TVD [ft]	Start N/S [ft]	Start E/W [ft]	End N/S [ft]	End E/W [ft]
13.5in Open Hole	25.00	1750.00	1725.00	25.00	1737.29	0.00	0.00	158.89	89.34
9.625in Casing Surface	25.00	1750.00	1725.00	25.00	1737.29	0.00	0.00	158.89	89.34
8.5in Open Hole	1750.00	14836.05	13086.05	1737.29	7022.00	158.89	89.34	839.36	8416.11



Planned Wellpath Report

TROUDT 40N-23C-M PWP (REV-A.0)
Page 8 of 8



REFERENCE WELLPATH IDENTIFICATION			
Operator	SRC ENERGY	Slot	SLOT#12 TROUDT 40N-23C-M (760'FNL & 1760'FWL, SEC.27)
Area	COLORADO	Well	TROUDT 40N-23C-M
Field	WELD COUNTY (NAD83,TRUE NORTH)	Wellbore	TROUDT 40N-23C-M PWB
Facility	SEC.27-T06N-R66W		

TARGETS									
Name	MD [ft]	TVD [ft]	North [ft]	East [ft]	Grid East [US ft]	Grid North [US ft]	Latitude	Longitude	Shape
SEC.28-T06N-R66W		0.00	0.00	-165.01	3203773.74	1412932.71	40°27'52.531"N	104°46'03.497"W	polygon
SEC.22-T06N-R66W		1.00	1412.76	-8174.14	3195753.51	1414279.17	40°28'06.478"N	104°47'47.123"W	polygon
SEC.23-T06N-R66W		1.00	4231.30	-2032.31	3201871.60	1417148.27	40°28'34.342"N	104°46'27.660"W	polygon
SEC.26-T06N-R66W		1.00	-4763.04	510.16	3204488.23	1408175.60	40°27'05.465"N	104°45'54.763"W	polygon
SEC.27-T06N-R66W		1.00	-4763.04	510.16	3204488.23	1408175.60	40°27'05.465"N	104°45'54.763"W	polygon
2) TROUDT 40N-23C-M BHL ON PLAT (112'FSL & 510'FEL, SEC.23)	14836.05	7022.00	839.36	8416.11	3212347.30	1413842.94	40°28'00.811"N	104°44'12.473"W	circle
1) TROUDT 40N-23C-M TOP OF PROD ON PLAT (101'FSL & 2529'FEL, SEC.22)	7489.77	7054.00	854.34	1071.25	3205002.85	1413797.21	40°28'00.973"N	104°45'47.502"W	circle

SURVEY PROGRAM - Ref Wellbore: TROUDT 40N-23C-M PWB Ref Wellpath: TROUDT 40N-23C-M PWP (REV-A.0)				
Start MD [ft]	End MD [ft]	Positional Uncertainty Model	Log Name/Comment	Wellbore
25.00	1750.00	Custom BHI NaviTrak (Standard Rotating+Axial Corr) (Rockies 0.03Gt model)		TROUDT 40N-23C-M PWB
1750.00	14836.05	Custom BHI AutoTrak Curve (IFR1, Short) (Rockies 0.03Gt model)		TROUDT 40N-23C-M PWB