

November 11, 2017

Mr. Chris Canfield, P.G.,
Environmental Protection Specialist, Northeast Region
Colorado Oil and Gas Conservation Commission
1120 Lincoln Street, Suite 801
Denver, CO 80203

**RE: No Further Action Request Letter
Nelson Milton Surface Release
Spill/Release Point ID #442507**

Dear Mr. Canfield:

Tasman Geosciences (Tasman) has prepared this No Further Action Request Letter (NFA Letter) on behalf of DCP Midstream, LP (DCP) to detail field activities that occurred at the Nelson Milton tank battery located in the SWSW ¼, Section 28, Township 2N, Range 68W (Site [Figure 1]) subsequent to a surface release that occurred in July 2015.

Background and Site Remediation Activities

On July 13, 2015, a buried unmarked valve located approximately 1-foot below ground surface (bgs) that terminated at the end of a buried DCP utility was struck by a third party operator while performing work activities at the Site. A condensate release occurred resulting in petroleum hydrocarbon impacts to surrounding surface soils. DCP Midstream (DCP) submitted an initial Form 19 on July 14, 2015 with a Supplemental Form 19 submitted on July 23, 2015 and the Colorado Oil and Gas Conservation Commission (COGCC) issued a Spill/Release Point ID #442507 for the Site.

Tasman personnel were dispatched to the Site on July 13, 2015 and installed oil absorbent boom immediately downgradient of the surface release area. Photographs of the release and the oil absorbent boom are provided on Figure 2. Impacted soil removal activities were initiated on July 15, 2015 from the soil stained area to an approximate depth of 1-foot bgs. The over excavation was conducted to expose and remove the DCP valve, cap the line, and expose and evaluate the integrity of the DCP flowline which was located approximately 5-feet bgs. Five soils samples (SS01 through SS05) were collected from the surface and from an over excavated area near the DCP valve as illustrated on Figure 3 and field screened using a photoionization detector (PID) and traditional headspace soil sampling techniques. Soil samples were submitted to Summit Scientific Laboratories (Summit) in Golden, CO for analysis of benzene, toluene, ethylbenzene, total xylenes (BTEX) and total petroleum hydrocarbons gasoline range organics (TPH-GRO) using USEPA Method 8260B and TPH diesel range organics (DRO) using USEPA Method 8015.

Soil excavation and investigation activities continued on July 16, 2015 and soil samples SS06 through SS09 were collected as illustrated on Figure 3, field screened using a PID and submitted

to Summit for laboratory analysis of BTEX and TPH-GRO/DRO. Based on the laboratory analytical data, impacted soils remained within the area of SS06 and therefore, additional surface soils were removed on November 2, 2015. Soil sample SS10 was collected as illustrated on Figure 3 and the laboratory analytical result was below COGCC standards. During excavation and soil sampling activities, a high PID reading (839 parts per million [ppm]) was observed approximately 25 feet south of the broken valve at 1-foot bgs (Figure 3). Upon further investigation, PID readings and soil impacts increased with depth down to a previously repaired/replaced third party HDPE flowline where a PID reading of >5,000 ppm was collected at 5-feet bgs immediately below the flowline and soil sample SS09 was collected and submitted to Summit for laboratory analysis. Based on the remediation and investigation efforts described and with the exception of soil located in the vicinity of SS04, soil impacts near the SS09 location at depths greater than would have been caused by the surface release were likely due to a separate and/or historic release unrelated to the DCP surface release. This is further supported by the location of pooled condensate material as seen on Figure 2 and the location of soil sample SS09. The observed concentrations at that location were likely not related to the valve strike and/or infiltration of condensate because the pooled condensate material from the surface release was downgradient of that soil sample location. Further, during the DCP excavation near the third party flowline, the soil around and above the line contained trash and grass and was not representative of clean backfill material.

DCP repeatedly and unsuccessfully attempted to coordinate with the third-party operator for additional remediation efforts required to mitigate impacts within the vicinity of SS09. At that time, the third-party operator claimed that impacted soils occurring from a separate and/or historic release were removed and properly disposed. However, based on the observed Site conditions during DCP's excavation and soil removal activities, it did not appear that the residual impacts from the separate and/or historic release were properly mitigated.

Due to asset transfer activities that occurred during 2015 and 2016 as well as tank battery reconstruction activities that occurred at the Site, further remediation activities within the vicinity of SS04 and SS09 were postponed. On June 29, 2017 subsequent to tank battery reconstruction activities, soil excavation and delineation activities were performed in the area of SS04 and SS09 at the Site. Prior to conducting excavation activities, hydrovacuum potholing was conducted to identify buried utilities. During potholing, newer steel flowlines were observed to the east of the valve and the former HDPE flowlines, considered to be the source of a previous release as described above, were unable to be located. It is assumed that when the tank battery reconstruction activities occurred, the old HDPE flowlines were removed and the new steel flowlines were installed.

During the June 29, 2017 excavation activities, the DCP valve which was the cause of the original surface release was exposed and approximately 10 yd³ of soil was removed and transported to the Waste Management North Weld County Landfill in Ault, Colorado for disposal. One soil sample (SS11@5') was collected at the location illustrated on Figure 3 to confirm that soil impacts were not present. Surrounding soils were also field screened using a PID and traditional headspace soil sampling techniques and petroleum hydrocarbon impacts were not observed. The soil sample was submitted to Summit for laboratory analysis of BTEX

and TPH-GRO/DRO and the analytical results were below laboratory detection limits and COGCC Table 910-1 standards. As such, residual impacts that may have been within the area of concern, as described, are presumed to have been mitigated during the tank battery reconstruction activities. The soil sample PID readings and laboratory analytical results are summarized on Table 1 and the laboratory reports are included in Appendix A.

No Further Action Request

Based on the information provided herein and the Site conditions observed during DCP's excavation and delineation activities, soil impacts that resulted from the DCP valve line strike have been mitigated. Therefore, Tasman on behalf of DCP is requesting a NFA determination from the COGCC for Spill/Release Point ID #442507.

Should you have any questions regarding this letter and the activities discussed herein, please contact me by phone at (303) 487-1228 or by e-mail at bhumphrey@tasman-geo.com.

Sincerely,



Brian Humphrey
Program Manager
Tasman Geosciences

Enclosures:

Table 1 – Soil Analytical Results Summary Table

Figure 1 – Site Location Map

Figure 2 – Site Photographs

Figure 3 – Excavation and Soil Sample Location Map

Attachment A – Laboratory Analytical Reports

cc:

Stephen Weathers – DCP Midstream
File

TABLES

TABLE 1
DCP MIDSTREAM - NELSON MILTON RELEASE
SOIL SAMPLE ANALYTICAL RESULTS SUMMARY TABLE

Sample ID	Date Sampled	Depth (Feet bgs)	PID Readings (ppm)	Benzene (mg/kg)	Toluene (mg/kg)	Ethylbenzene (mg/kg)	Total Xylenes (mg/kg)	TPH ⁽²⁾ (mg/kg)
SS01	7/15/2015	1	21.1	<0.002	<0.005	<0.005	<0.005	<50
SS02	7/15/2015	1	2.4	<0.0018	<0.0045	<0.0045	<0.0045	<50
SS03	7/15/2015	4	383	<0.002	<0.005	<0.005	<0.005	<50
SS04	7/15/2015	4	811	<0.002	<0.005	<0.005	1.1	917
SS05	7/15/2015	5	72.5	<0.002	<0.005	<0.005	<0.005	59
SS06	7/16/2015	1	550	<0.002	<0.005	<0.005	0.099	1,014
SS07	7/16/2015	1	84.6	<0.002	<0.005	<0.005	<0.005	160
SS08	7/16/2015	4	122.5	<0.002	<0.005	<0.005	<0.005	<50
SS09	7/16/2015	5	>5,000	<0.002	0.018	0.016	0.81	1,034
SS10	11/2/2015	1.5	8.4	<0.002	<0.005	<0.005	<0.005	<50
SS11 @ 5'	6/29/2017	5	10.4	<0.002	<0.005	<0.005	<0.005	<50
COGCC standards for Soil (mg/kg)⁽¹⁾				0.17	85	100	175	

Notes:

1). Standards for Soil are taken from 2 CCR 404-1, Table 910-1, effective February 1, 2014.

2). TPH - Total volatile and extractable petroleum hydrocarbons. Value calculated by adding GRO and DRO concentrations.

GRO - Gasoline range organics.

DRO - Diesel range organics.

mg/kg= Milligrams per kilogram.

bgs - Below ground surface.

PID - Photoionization Detector

ppm - Parts per million

Bold values indicate an exceedance of the COGCC soil standards for the Site.

FIGURES

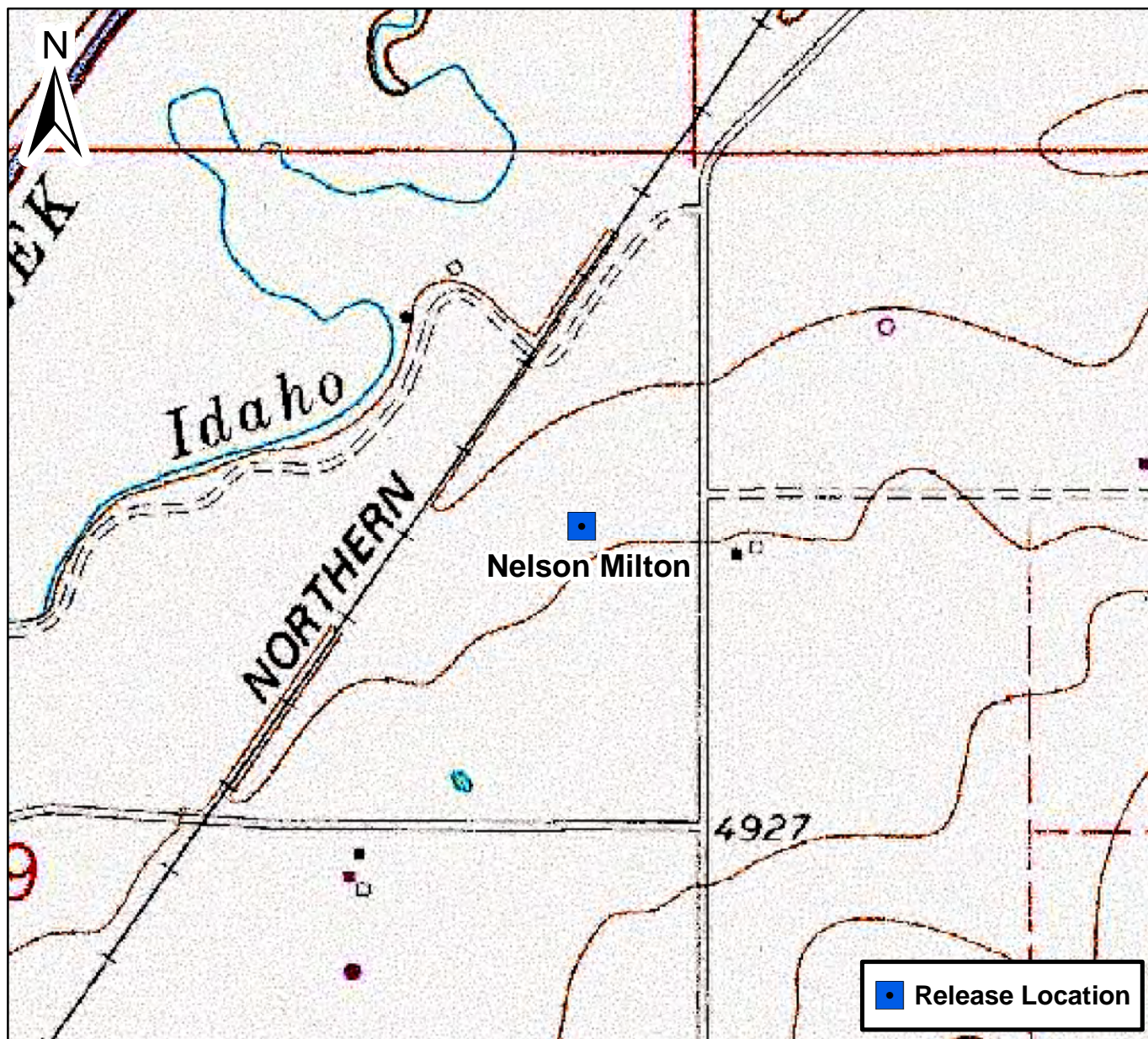

Figure 1

Site Location Map
Nelson Milton
SENE S29 T2N R68W
Weld County, Colorado





Looking North



Looking Northwest



Looking Northeast



Looking Southwest



Looking Northeast

PROJECT NO:	Nelson Milton	 <div data-bbox="378 1421 682 1550"> <p>Nelson Milton DCP Midstream SWSW S28 T2N R68W Weld County, CO Spill/Release Point ID#442507</p> </div> <div data-bbox="1039 1469 1270 1526"> <p>6899 Pecos St., Unit C Denver CO 80221</p> </div>	<p><u>Notes:</u> Photographs were taken subsequent to a buried valve line strike and condensate surface release.</p>	<p>FIGURE 2 Site Photographs</p>
DRAWN BY:	BDH			
DATE:	12/3/15			



PROJECT NO:	Nelson Milton	<div><div><div></div><div></div></div><div>Tasman Geosciences</div></div> <div>6899 Pecos St., Unit C Denver CO 80221</div>	<div><div>LEGEND</div><div><div><div></div><div></div><div></div><div></div><div></div><div></div></div>Approximate Excavation Extents to 5' BGS</div><div><div><div></div><div></div><div></div><div></div><div></div><div></div></div>Approximate Excavation Extents to 1' BGS</div><div><div>X</div>Soil Sample and PID Location</div><div><div><div></div><div></div></div><div>— —</div>DCP Valve and Flow Line</div></div>	<div><div>FIGURE 3</div><div>Excavation and Soil Sample Locations</div><div>Scale: 1" : 20'</div></div>
DRAWN BY:	BDH			
DATE:	10/5/17			
<div><div><div><div><div><div></div><div></div></div><div>Nelson Milton</div><div>DCP Midstream</div><div>SWSW S28 T2N R68W</div><div>Weld County, CO</div><div>Spill/Release Point ID#442507</div></div></div></div></div>				

ATTACHMENT A

Summit Scientific

741 Corporate Circle – Suite I ♦ Golden, Colorado 80401

303.277.9310 - laboratory ♦ 303.277.9531 - fax

July 16, 2015

Matt Pickett
DCP Midstream
370 17th Street #2500
Denver, CO 80202
RE: Nelson Milton

Enclosed are the results of analyses for samples received by Summit Scientific on 07/15/15 14:00. If you have any questions concerning this report, please feel free to contact me.

Sincerely,

A handwritten signature in black ink, appearing to read 'P. Shrewsbury', with a stylized, cursive script.

Paul Shrewsbury
President



DCP Midstream
370 17th Street #2500
Denver CO, 80202

Project: Nelson Milton
Project Number: [none]
Project Manager: Matt Pickett

Reported:
07/16/15 07:06

ANALYTICAL REPORT FOR SAMPLES

Sample ID	Laboratory ID	Matrix	Date Sampled	Date Received
SS01	1507160-01	Soil	07/15/15 08:25	07/15/15 14:00
SS02	1507160-02	Soil	07/15/15 09:45	07/15/15 14:00
SS03	1507160-03	Soil	07/15/15 11:30	07/15/15 14:00
SS04	1507160-04	Soil	07/15/15 11:45	07/15/15 14:00
SS05	1507160-05	Soil	07/15/15 11:55	07/15/15 14:00

Summit Scientific

The results in this report apply to the samples analyzed in accordance with the chain of custody document. This analytical report must be reproduced in its entirety.

DCP Midstream
370 17th Street #2500
Denver CO, 80202

Project: Nelson Milton

Project Number: [none]
Project Manager: Matt Pickett

Reported:
07/16/15 07:06

Summit Scientific 1507160

741 Corporate Circle Suite I ♦ Golden, Colorado 80401
303-277-9310 ♦ 303-374-5933 Fax

Page 1 of 1

Client: DCP Midstream
Address: _____
City/State/Zip: _____
Phone: _____ Fax: _____
Sampler Name: Brian Humphrey

Project Manager: Matthew Pickett
E-Mail: mgpickett@dcpcnmidstream.com
Project Name: Nelson Milton
Project Number: _____

Sample Description	Date Sampled	Time Sampled	Number of Containers	Preservative		Matrix			Analyze For:						Special Instructions		
				HCl	HNO ₃	(None)	Other (Specify)	Groundwater	Soil	Air - Canister Serial #	Other (Specify)						
5501	7/15/15	0825	1			X			X								
5502		0945	1														
5503		1130	1														
5504		1145	1														
5505	↓	1155	1			↓		↓				↓	↓				
Relinquished by:	Date/Time:	Received by:	Date/Time:	Turn Around Time (Check)										Notes:			
BGS	7-15-15/	TPO	7/15/15 1400	Same Day <input checked="" type="checkbox"/>				72 Hours <input type="checkbox"/>						Please cc: bhumphre casman@gco.com			
Relinquished by:	Date/Time:	Received by:	Date/Time:	24 Hours <input type="checkbox"/>				Standard <input type="checkbox"/>									
				48 Hours <input type="checkbox"/>													
Relinquished by:	Date/Time:	Received in Lab by:	Date/Time:	Sample Integrity:				Temperature Upon Receipt: 87°C						on ice			
				Intact: Yes <input checked="" type="checkbox"/> No <input type="checkbox"/>													

www.s2scientific.com

Summit Scientific

The results in this report apply to the samples analyzed in accordance with the chain of custody document. This analytical report must be reproduced in its entirety.





DCP Midstream
370 17th Street #2500
Denver CO, 80202

Project: Nelson Milton
Project Number: [none]
Project Manager: Matt Pickett

Reported:
07/16/15 07:06

SS01
1507160-01 (Soil)

Summit Scientific

Extractable Petroleum Hydrocarbons by 8015

Date Sampled: 07/15/15 08:25

Analyte	Result	Reporting Limit	Units	Dilution	Batch	Prepared	Analyzed	Method	Notes
C10-C28 (DRO)	ND	50	mg/kg	1	1507179	07/15/15	07/15/15	8015M	

Date Sampled: 07/15/15 08:25

Analyte	Result	Reporting Limit	Units	Dilution	Batch	Prepared	Analyzed	Method	Notes
Surrogate: o-Terphenyl		109 %	30-150		"	"	"	"	

Volatile Organic Compounds by EPA Method 8260B

Date Sampled: 07/15/15 08:25

Analyte	Result	Reporting Limit	Units	Dilution	Batch	Prepared	Analyzed	Method	Notes
Benzene	ND	0.0020	mg/kg	1	1507178	07/15/15	07/15/15	EPA 8260B	
Toluene	ND	0.0050	"	"	"	"	"	"	
Ethylbenzene	ND	0.0050	"	"	"	"	"	"	
Xylenes (total)	ND	0.0050	"	"	"	"	"	"	
Gasoline Range Hydrocarbons	ND	0.50	"	"	"	"	"	"	

Date Sampled: 07/15/15 08:25

Analyte	Result	Reporting Limit	Units	Dilution	Batch	Prepared	Analyzed	Method	Notes
Surrogate: 1,2-Dichloroethane-d4		103 %	23-173		"	"	"	"	
Surrogate: Toluene-d8		97.0 %	20-170		"	"	"	"	
Surrogate: 4-Bromofluorobenzene		99.3 %	21-167		"	"	"	"	

Summit Scientific

The results in this report apply to the samples analyzed in accordance with the chain of custody document. This analytical report must be reproduced in its entirety.



DCP Midstream
370 17th Street #2500
Denver CO, 80202

Project: Nelson Milton
Project Number: [none]
Project Manager: Matt Pickett

Reported:
07/16/15 07:06

SS02
1507160-02 (Soil)

Summit Scientific

Extractable Petroleum Hydrocarbons by 8015

Date Sampled: 07/15/15 09:45

Analyte	Result	Reporting Limit	Units	Dilution	Batch	Prepared	Analyzed	Method	Notes
C10-C28 (DRO)	ND	50	mg/kg	1	1507179	07/15/15	07/15/15	8015M	

Date Sampled: 07/15/15 09:45

Analyte	Result	Reporting Limit	Units	Dilution	Batch	Prepared	Analyzed	Method	Notes
Surrogate: o-Terphenyl		109 %	30-150		"	"	"	"	

Volatile Organic Compounds by EPA Method 8260B

Date Sampled: 07/15/15 09:45

Analyte	Result	Reporting Limit	Units	Dilution	Batch	Prepared	Analyzed	Method	Notes
Benzene	ND	0.0018	mg/kg	1	1507178	07/15/15	07/15/15	EPA 8260B	
Toluene	ND	0.0045	"	"	"	"	"	"	
Ethylbenzene	ND	0.0045	"	"	"	"	"	"	
Xylenes (total)	ND	0.0045	"	"	"	"	"	"	
Gasoline Range Hydrocarbons	ND	0.45	"	"	"	"	"	"	

Date Sampled: 07/15/15 09:45

Analyte	Result	Reporting Limit	Units	Dilution	Batch	Prepared	Analyzed	Method	Notes
Surrogate: 1,2-Dichloroethane-d4		105 %	23-173		"	"	"	"	
Surrogate: Toluene-d8		97.4 %	20-170		"	"	"	"	
Surrogate: 4-Bromofluorobenzene		99.4 %	21-167		"	"	"	"	

Summit Scientific

The results in this report apply to the samples analyzed in accordance with the chain of custody document. This analytical report must be reproduced in its entirety.



DCP Midstream
370 17th Street #2500
Denver CO, 80202

Project: Nelson Milton
Project Number: [none]
Project Manager: Matt Pickett

Reported:
07/16/15 07:06

SS03
1507160-03 (Soil)

Summit Scientific

Extractable Petroleum Hydrocarbons by 8015

Date Sampled: 07/15/15 11:30

Analyte	Result	Reporting Limit	Units	Dilution	Batch	Prepared	Analyzed	Method	Notes
C10-C28 (DRO)	ND	50	mg/kg	1	1507179	07/15/15	07/15/15	8015M	

Date Sampled: 07/15/15 11:30

Analyte	Result	Reporting Limit	Units	Dilution	Batch	Prepared	Analyzed	Method	Notes
Surrogate: o-Terphenyl		101 %	30-150		"	"	"	"	

Volatile Organic Compounds by EPA Method 8260B

Date Sampled: 07/15/15 11:30

Analyte	Result	Reporting Limit	Units	Dilution	Batch	Prepared	Analyzed	Method	Notes
Benzene	ND	0.0020	mg/kg	1	1507178	07/15/15	07/15/15	EPA 8260B	
Toluene	ND	0.0050	"	"	"	"	"	"	
Ethylbenzene	ND	0.0050	"	"	"	"	"	"	
Xylenes (total)	ND	0.0050	"	"	"	"	"	"	
Gasoline Range Hydrocarbons	0.78	0.50	"	"	"	"	"	"	

Date Sampled: 07/15/15 11:30

Analyte	Result	Reporting Limit	Units	Dilution	Batch	Prepared	Analyzed	Method	Notes
Surrogate: 1,2-Dichloroethane-d4		108 %	23-173		"	"	"	"	
Surrogate: Toluene-d8		96.6 %	20-170		"	"	"	"	
Surrogate: 4-Bromofluorobenzene		97.4 %	21-167		"	"	"	"	

Summit Scientific

The results in this report apply to the samples analyzed in accordance with the chain of custody document. This analytical report must be reproduced in its entirety.



DCP Midstream
370 17th Street #2500
Denver CO, 80202

Project: Nelson Milton
Project Number: [none]
Project Manager: Matt Pickett

Reported:
07/16/15 07:06

SS04
1507160-04 (Soil)

Summit Scientific

Extractable Petroleum Hydrocarbons by 8015

Date Sampled: 07/15/15 11:45

Analyte	Result	Reporting Limit	Units	Dilution	Batch	Prepared	Analyzed	Method	Notes
C10-C28 (DRO)	840	50	mg/kg	1	1507179	07/15/15	07/15/15	8015M	

Date Sampled: 07/15/15 11:45

Analyte	Result	Reporting Limit	Units	Dilution	Batch	Prepared	Analyzed	Method	Notes
Surrogate: o-Terphenyl		119 %	30-150		"	"	"	"	

Volatile Organic Compounds by EPA Method 8260B

Date Sampled: 07/15/15 11:45

Analyte	Result	Reporting Limit	Units	Dilution	Batch	Prepared	Analyzed	Method	Notes
Benzene	ND	0.0020	mg/kg	1	1507178	07/15/15	07/15/15	EPA 8260B	
Toluene	ND	0.0050	"	"	"	"	"	"	
Ethylbenzene	ND	0.0050	"	"	"	"	"	"	
Xylenes (total)	1.1	0.0050	"	"	"	"	"	"	
Gasoline Range Hydrocarbons	77	0.50	"	"	"	"	"	"	

Date Sampled: 07/15/15 11:45

Analyte	Result	Reporting Limit	Units	Dilution	Batch	Prepared	Analyzed	Method	Notes
Surrogate: 1,2-Dichloroethane-d4		100 %	23-173		"	"	"	"	
Surrogate: Toluene-d8		110 %	20-170		"	"	"	"	
Surrogate: 4-Bromofluorobenzene		130 %	21-167		"	"	"	"	

Summit Scientific

The results in this report apply to the samples analyzed in accordance with the chain of custody document. This analytical report must be reproduced in its entirety.



DCP Midstream
370 17th Street #2500
Denver CO, 80202

Project: Nelson Milton
Project Number: [none]
Project Manager: Matt Pickett

Reported:
07/16/15 07:06

SS05
1507160-05 (Soil)

Summit Scientific

Extractable Petroleum Hydrocarbons by 8015

Date Sampled: 07/15/15 11:55

Analyte	Result	Reporting Limit	Units	Dilution	Batch	Prepared	Analyzed	Method	Notes
C10-C28 (DRO)	59	50	mg/kg	1	1507179	07/15/15	07/15/15	8015M	

Date Sampled: 07/15/15 11:55

Analyte	Result	Reporting Limit	Units	Dilution	Batch	Prepared	Analyzed	Method	Notes
Surrogate: o-Terphenyl		99.7 %	30-150		"	"	"	"	

Volatile Organic Compounds by EPA Method 8260B

Date Sampled: 07/15/15 11:55

Analyte	Result	Reporting Limit	Units	Dilution	Batch	Prepared	Analyzed	Method	Notes
Benzene	ND	0.0020	mg/kg	1	1507178	07/15/15	07/15/15	EPA 8260B	
Toluene	ND	0.0050	"	"	"	"	"	"	
Ethylbenzene	ND	0.0050	"	"	"	"	"	"	
Xylenes (total)	ND	0.0050	"	"	"	"	"	"	
Gasoline Range Hydrocarbons	2.1	0.50	"	"	"	"	"	"	

Date Sampled: 07/15/15 11:55

Analyte	Result	Reporting Limit	Units	Dilution	Batch	Prepared	Analyzed	Method	Notes
Surrogate: 1,2-Dichloroethane-d4		105 %	23-173		"	"	"	"	
Surrogate: Toluene-d8		94.8 %	20-170		"	"	"	"	
Surrogate: 4-Bromofluorobenzene		98.3 %	21-167		"	"	"	"	

Summit Scientific

The results in this report apply to the samples analyzed in accordance with the chain of custody document. This analytical report must be reproduced in its entirety.



DCP Midstream
370 17th Street #2500
Denver CO, 80202

Project: Nelson Milton
Project Number: [none]
Project Manager: Matt Pickett

Reported:
07/16/15 07:06

Extractable Petroleum Hydrocarbons by 8015 - Quality Control
Summit Scientific

Analyte	Reporting			Spike	Source		%REC		RPD	
	Result	Limit	Units	Level	Result	%REC	Limits	RPD	Limit	Notes

Batch 1507179 - EPA 3550A

Blank (1507179-BLK1)

Prepared & Analyzed: 07/15/15

C10-C28 (DRO)	ND	50	mg/kg							
Surrogate: o-Terphenyl	13.6		"	12.2		112	30-150			

LCS (1507179-BS1)

Prepared & Analyzed: 07/15/15

C10-C28 (DRO)	493	50	mg/kg	501		98.3	73-134			
Surrogate: o-Terphenyl	13.1		"	12.2		108	30-150			

Matrix Spike (1507179-MS1)

Source: 1507160-01

Prepared & Analyzed: 07/15/15

C10-C28 (DRO)	436	50	mg/kg	443	20.8	93.9	50-148			
Surrogate: o-Terphenyl	11.4		"	10.8		106	30-150			

Summit Scientific

The results in this report apply to the samples analyzed in accordance with the chain of custody document. This analytical report must be reproduced in its entirety.



DCP Midstream
370 17th Street #2500
Denver CO, 80202

Project: Nelson Milton
Project Number: [none]
Project Manager: Matt Pickett

Reported:
07/16/15 07:06

Volatile Organic Compounds by EPA Method 8260B - Quality Control
Summit Scientific

Analyte	Reporting			Spike	Source		%REC		RPD	
	Result	Limit	Units	Level	Result	%REC	Limits	RPD	Limit	Notes

Batch 1507178 - EPA 5030 Soil MS

Blank (1507178-BLK1)

Prepared & Analyzed: 07/15/15

Benzene	ND	0.0020	mg/kg							
Toluene	ND	0.0050	"							
Ethylbenzene	ND	0.0050	"							
Xylenes (total)	ND	0.0050	"							
Gasoline Range Hydrocarbons	ND	0.50	"							
Surrogate: 1,2-Dichloroethane-d4	0.0393		"	0.0396		99.3	23-173			
Surrogate: Toluene-d8	0.0386		"	0.0400		96.4	20-170			
Surrogate: 4-Bromofluorobenzene	0.0396		"	0.0400		99.1	21-167			

LCS (1507178-BS1)

Prepared & Analyzed: 07/15/15

Benzene	0.107	0.0020	mg/kg	0.100		107	58-130			
Toluene	0.117	0.0050	"	0.100		117	61-134			
Ethylbenzene	0.141	0.0050	"	0.0992		142	74-139			
m,p-Xylene	0.288	0.010	"	0.200		144	73-137			
o-Xylene	0.142	0.0050	"	0.0984		145	73-141			
Surrogate: 1,2-Dichloroethane-d4	0.0403		"	0.0396		102	23-173			
Surrogate: Toluene-d8	0.0391		"	0.0400		97.8	20-170			
Surrogate: 4-Bromofluorobenzene	0.0391		"	0.0400		97.7	21-167			

Matrix Spike (1507178-MS1)

Source: 1507160-01

Prepared & Analyzed: 07/15/15

Benzene	0.101	0.0020	mg/kg	0.0928	ND	109	30-131			
Toluene	0.112	0.0050	"	0.0928	ND	121	30-134			
Ethylbenzene	0.132	0.0050	"	0.0920	ND	143	22-153			
m,p-Xylene	0.270	0.010	"	0.185	ND	146	10-159			
o-Xylene	0.135	0.0050	"	0.0913	ND	148	31-151			
Surrogate: 1,2-Dichloroethane-d4	0.0387		"	0.0367		105	23-173			
Surrogate: Toluene-d8	0.0363		"	0.0371		97.9	20-170			
Surrogate: 4-Bromofluorobenzene	0.0356		"	0.0371		96.1	21-167			

Summit Scientific

The results in this report apply to the samples analyzed in accordance with the chain of custody document. This analytical report must be reproduced in its entirety.



DCP Midstream
370 17th Street #2500
Denver CO, 80202

Project: Nelson Milton
Project Number: [none]
Project Manager: Matt Pickett

Reported:
07/16/15 07:06

Volatile Organic Compounds by EPA Method 8260B - Quality Control
Summit Scientific

Analyte	Reporting			Spike	Source		%REC		RPD	
	Result	Limit	Units	Level	Result	%REC	Limits	RPD	Limit	Notes

Batch 1507178 - EPA 5030 Soil MS

Matrix Spike Dup (1507178-MSD1)		Source: 1507160-01			Prepared & Analyzed: 07/15/15					
Benzene	0.108	0.0020	mg/kg	0.0988	ND	109	30-131	7.09	34	
Toluene	0.120	0.0050	"	0.0988	ND	122	30-134	7.06	30	
Ethylbenzene	0.139	0.0050	"	0.0980	ND	142	22-153	5.40	24	
m,p-Xylene	0.288	0.010	"	0.197	ND	146	10-159	6.46	68	
o-Xylene	0.141	0.0050	"	0.0972	ND	145	31-151	4.34	38	
Surrogate: 1,2-Dichloroethane-d4	0.0417		"	0.0391		107	23-173			
Surrogate: Toluene-d8	0.0393		"	0.0395		99.5	20-170			
Surrogate: 4-Bromofluorobenzene	0.0391		"	0.0395		98.9	21-167			

Summit Scientific

The results in this report apply to the samples analyzed in accordance with the chain of custody document. This analytical report must be reproduced in its entirety.



DCP Midstream
370 17th Street #2500
Denver CO, 80202

Project: Nelson Milton
Project Number: [none]
Project Manager: Matt Pickett

Reported:
07/16/15 07:06

Notes and Definitions

DET Analyte DETECTED
ND Analyte NOT DETECTED at or above the reporting limit
NR Not Reported
dry Sample results reported on a dry weight basis
RPD Relative Percent Difference

Summit Scientific

The results in this report apply to the samples analyzed in accordance with the chain of custody document. This analytical report must be reproduced in its entirety.

A handwritten signature in black ink, appearing to be 'M. Pickett'.

Summit Scientific

741 Corporate Circle – Suite I ♦ Golden, Colorado 80401

303.277.9310 - laboratory ♦ 303.277.9531 - fax

July 16, 2015

Matt Pickett
DCP Midstream
370 17th Street #2500
Denver, CO 80202
RE: Nelson Milton

Enclosed are the results of analyses for samples received by Summit Scientific on 07/16/15 11:20. If you have any questions concerning this report, please feel free to contact me.

Sincerely,

DRAFT REPORT
DATA SUBJECT TO CHANGE



DCP Midstream
370 17th Street #2500
Denver CO, 80202

Project: Nelson Milton
Project Number: [none]
Project Manager: Matt Pickett

Reported:
07/16/15 15:13

ANALYTICAL REPORT FOR SAMPLES

Sample ID	Laboratory ID	Matrix	Date Sampled	Date Received
SS06	1507167-01	Soil	07/16/15 10:00	07/16/15 11:20
SS07	1507167-02	Soil	07/16/15 10:06	07/16/15 11:20
SS08	1507167-03	Soil	07/16/15 10:13	07/16/15 11:20
SS09	1507167-04	Soil	07/16/15 10:20	07/16/15 11:20

DRAFT REPORT

The results in this report apply to the samples analyzed in accordance with the chain of custody document. This analytical report must be reproduced in its entirety.



DCP Midstream
370 17th Street #2500
Denver CO, 80202

Project: Nelson Milton

Project Number: [none]
Project Manager: Matt Pickett

Reported:
07/16/15 15:13

Summit Scientific

S₂

741 Corporate Circle, Suite J ♦ Golden, Colorado 80401
303-277-9310 ♦ 303-374-5933

1507167

Page 1 of 1

Client: DCP Midstream Project Manager: Matt Pickett
Address: _____ E-Mail: m.pickett@olep midstream.com
City/State/Zip: _____
Phone: _____ Fax: _____ Project Name: Nelson Milton
Sampler Name: Brian Humphrey Project Number: _____

ID	Sample Description	Date Sampled	Time Sampled	# of containers	Preservative				Matrix				Analysis Requested				Special Instructions
					HCl	HNO ₃	None	Other (Specify)	Groundwater	Soil	Air-Canister #	Other (Specify)					
1	SS06	7/16/15	1000				X			X			X	X			
2	SS07		1006				X			X			X	X			
3	SS08		1013				X			X			X	X			
4	SS09		1020				X			X			X	X			
5																	
6																	
7																	
8																	
9																	
10																	

Relinquished by: <u>[Signature]</u>	Date/Time: <u>7/16/15 11:20</u>	Received by: <u>[Signature]</u>	Date/Time: <u>7/16/15 11:20</u>	Turn Around Time (Check) Same Day <input checked="" type="checkbox"/> 72 hours — 24 hours — Standard — 48 hours —	Notes: <u>on ice</u>
Relinquished by:	Date/Time:	Received by:	Date/Time:	Sample Integrity: Temperature Upon Receipt: <u>13.1</u>	
Relinquished by:	Date/Time:	Received by:	Date/Time:	Intact: <input checked="" type="radio"/> Yes No	

www.s2scientific.com

DRAFT REPORT

The results in this report apply to the samples analyzed in accordance with the chain of custody document. This analytical report must be reproduced in its entirety.



DCP Midstream
370 17th Street #2500
Denver CO, 80202

Project: Nelson Milton
Project Number: [none]
Project Manager: Matt Pickett

Reported:
07/16/15 15:13

SS06
1507167-01 (Soil)

Summit Scientific

Extractable Petroleum Hydrocarbons by 8015

Date Sampled: 07/16/15 10:00

Analyte	Result	Reporting Limit	Units	Dilution	Batch	Prepared	Analyzed	Method	Notes
C10-C28 (DRO)	1000	50	mg/kg	1	1507185	07/16/15	07/16/15	8015M	

Date Sampled: 07/16/15 10:00

Analyte	Result	Reporting Limit	Units	Dilution	Batch	Prepared	Analyzed	Method	Notes
Surrogate: o-Terphenyl		179 %	30-150		"	"	"	"	S-02

Volatile Organic Compounds by EPA Method 8260B

Date Sampled: 07/16/15 10:00

Analyte	Result	Reporting Limit	Units	Dilution	Batch	Prepared	Analyzed	Method	Notes
Benzene	ND	0.0020	mg/kg	1	1507186	07/16/15	07/16/15	EPA 8260B	
Toluene	ND	0.0050	"	"	"	"	"	"	
Ethylbenzene	ND	0.0050	"	"	"	"	"	"	
Xylenes (total)	0.099	0.0050	"	"	"	"	"	"	
Gasoline Range Hydrocarbons	14	0.50	"	"	"	"	"	"	

Date Sampled: 07/16/15 10:00

Analyte	Result	Reporting Limit	Units	Dilution	Batch	Prepared	Analyzed	Method	Notes
Surrogate: 1,2-Dichloroethane-d4		106 %	23-173		"	"	"	"	
Surrogate: Toluene-d8		98.8 %	20-170		"	"	"	"	
Surrogate: 4-Bromofluorobenzene		95.1 %	21-167		"	"	"	"	

DRAFT REPORT

The results in this report apply to the samples analyzed in accordance with the chain of custody document. This analytical report must be reproduced in its entirety.



DCP Midstream
370 17th Street #2500
Denver CO, 80202

Project: Nelson Milton
Project Number: [none]
Project Manager: Matt Pickett

Reported:
07/16/15 15:13

SS07
1507167-02 (Soil)

Summit Scientific

Extractable Petroleum Hydrocarbons by 8015

Date Sampled: 07/16/15 10:06

Analyte	Result	Reporting Limit	Units	Dilution	Batch	Prepared	Analyzed	Method	Notes
C10-C28 (DRO)	160	50	mg/kg	1	1507185	07/16/15	07/16/15	8015M	

Date Sampled: 07/16/15 10:06

Analyte	Result	Reporting Limit	Units	Dilution	Batch	Prepared	Analyzed	Method	Notes
Surrogate: o-Terphenyl		107 %	30-150		"	"	"	"	

Volatile Organic Compounds by EPA Method 8260B

Date Sampled: 07/16/15 10:06

Analyte	Result	Reporting Limit	Units	Dilution	Batch	Prepared	Analyzed	Method	Notes
Benzene	ND	0.0020	mg/kg	1	1507186	07/16/15	07/16/15	EPA 8260B	
Toluene	ND	0.0050	"	"	"	"	"	"	
Ethylbenzene	ND	0.0050	"	"	"	"	"	"	
Xylenes (total)	ND	0.0050	"	"	"	"	"	"	
Gasoline Range Hydrocarbons	2.5	0.50	"	"	"	"	"	"	

Date Sampled: 07/16/15 10:06

Analyte	Result	Reporting Limit	Units	Dilution	Batch	Prepared	Analyzed	Method	Notes
Surrogate: 1,2-Dichloroethane-d4		118 %	23-173		"	"	"	"	
Surrogate: Toluene-d8		88.8 %	20-170		"	"	"	"	
Surrogate: 4-Bromofluorobenzene		104 %	21-167		"	"	"	"	

DRAFT REPORT

The results in this report apply to the samples analyzed in accordance with the chain of custody document. This analytical report must be reproduced in its entirety.



DCP Midstream
370 17th Street #2500
Denver CO, 80202

Project: Nelson Milton
Project Number: [none]
Project Manager: Matt Pickett

Reported:
07/16/15 15:13

SS08
1507167-03 (Soil)

Summit Scientific

Extractable Petroleum Hydrocarbons by 8015

Date Sampled: 07/16/15 10:13

Analyte	Result	Reporting Limit	Units	Dilution	Batch	Prepared	Analyzed	Method	Notes
C10-C28 (DRO)	ND	50	mg/kg	1	1507185	07/16/15	07/16/15	8015M	

Date Sampled: 07/16/15 10:13

Analyte	Result	Reporting Limit	Units	Dilution	Batch	Prepared	Analyzed	Method	Notes
Surrogate: o-Terphenyl		107 %	30-150		"	"	"	"	

Volatile Organic Compounds by EPA Method 8260B

Date Sampled: 07/16/15 10:13

Analyte	Result	Reporting Limit	Units	Dilution	Batch	Prepared	Analyzed	Method	Notes
Benzene	ND	0.0020	mg/kg	1	1507186	07/16/15	07/16/15	EPA 8260B	
Toluene	ND	0.0050	"	"	"	"	"	"	
Ethylbenzene	ND	0.0050	"	"	"	"	"	"	
Xylenes (total)	ND	0.0050	"	"	"	"	"	"	
Gasoline Range Hydrocarbons	2.0	0.50	"	"	"	"	"	"	

Date Sampled: 07/16/15 10:13

Analyte	Result	Reporting Limit	Units	Dilution	Batch	Prepared	Analyzed	Method	Notes
Surrogate: 1,2-Dichloroethane-d4		105 %	23-173		"	"	"	"	
Surrogate: Toluene-d8		92.0 %	20-170		"	"	"	"	
Surrogate: 4-Bromofluorobenzene		97.9 %	21-167		"	"	"	"	

DRAFT REPORT

The results in this report apply to the samples analyzed in accordance with the chain of custody document. This analytical report must be reproduced in its entirety.



DCP Midstream
370 17th Street #2500
Denver CO, 80202

Project: Nelson Milton
Project Number: [none]
Project Manager: Matt Pickett

Reported:
07/16/15 15:13

SS09
1507167-04 (Soil)

Summit Scientific

Extractable Petroleum Hydrocarbons by 8015

Date Sampled: **07/16/15 10:20**

Analyte	Result	Reporting Limit	Units	Dilution	Batch	Prepared	Analyzed	Method	Notes
C10-C28 (DRO)	1000	50	mg/kg	1	1507185	07/16/15	07/16/15	8015M	

Date Sampled: **07/16/15 10:20**

Analyte	Result	Reporting Limit	Units	Dilution	Batch	Prepared	Analyzed	Method	Notes
<i>Surrogate: o-Terphenyl</i>		151 %	30-150		"	"	"	"	S-02

Volatile Organic Compounds by EPA Method 8260B

Date Sampled: **07/16/15 10:20**

Analyte	Result	Reporting Limit	Units	Dilution	Batch	Prepared	Analyzed	Method	Notes
Benzene	ND	0.0020	mg/kg	1	1507186	07/16/15	07/16/15	EPA 8260B	
Toluene	0.018	0.0050	"	"	"	"	"	"	
Ethylbenzene	0.016	0.0050	"	"	"	"	"	"	
Xylenes (total)	0.81	0.0050	"	"	"	"	"	"	
Gasoline Range Hydrocarbons	34	0.50	"	"	"	"	"	"	

Date Sampled: **07/16/15 10:20**

Analyte	Result	Reporting Limit	Units	Dilution	Batch	Prepared	Analyzed	Method	Notes
<i>Surrogate: 1,2-Dichloroethane-d4</i>		107 %	23-173		"	"	"	"	
<i>Surrogate: Toluene-d8</i>		110 %	20-170		"	"	"	"	
<i>Surrogate: 4-Bromofluorobenzene</i>		104 %	21-167		"	"	"	"	

DRAFT REPORT

The results in this report apply to the samples analyzed in accordance with the chain of custody document. This analytical report must be reproduced in its entirety.



DCP Midstream
370 17th Street #2500
Denver CO, 80202

Project: Nelson Milton
Project Number: [none]
Project Manager: Matt Pickett

Reported:
07/16/15 15:13

Analyte	Reporting			Spike	Source		%REC		RPD	
	Result	Limit	Units	Level	Result	%REC	Limits	RPD	Limit	Notes

DRAFT REPORT

The results in this report apply to the samples analyzed in accordance with the chain of custody document. This analytical report must be reproduced in its entirety.



DCP Midstream
370 17th Street #2500
Denver CO, 80202

Project: Nelson Milton
Project Number: [none]
Project Manager: Matt Pickett

Reported:
07/16/15 15:13

Notes and Definitions

S-02 The surrogate recovery for this sample cannot be accurately quantified due to interference from coeluting organic compounds present in the sample extract.

DET Analyte DETECTED

ND Analyte NOT DETECTED at or above the reporting limit

NR Not Reported

dry Sample results reported on a dry weight basis

RPD Relative Percent Difference

DRAFT REPORT

The results in this report apply to the samples analyzed in accordance with the chain of custody document. This analytical report must be reproduced in its entirety.

Summit Scientific

741 Corporate Circle – Suite I ♦ Golden, Colorado 80401

303.277.9310 - laboratory ♦ 303.277.9531 - fax

November 03, 2015

Matt Pickett
DCP Midstream
370 17th Street #2500
Denver, CO 80202
RE: Nelson Milton

Enclosed are the results of analyses for samples received by Summit Scientific on 11/02/15 17:00. If you have any questions concerning this report, please feel free to contact me.

Sincerely,

A handwritten signature in black ink, appearing to read 'P. Shrewsbury', with a stylized, cursive script.

Paul Shrewsbury
President

DCP Midstream
370 17th Street #2500
Denver CO, 80202

Project: Nelson Milton

Project Number: RC Code - G017
Project Manager: Matt Pickett

Reported:
11/03/15 07:11

ANALYTICAL REPORT FOR SAMPLES

Sample ID	Laboratory ID	Matrix	Date Sampled	Date Received
SS10	1511001-01	Soil	11/02/15 14:50	11/02/15 17:00

Summit Scientific 15/1001

741 Corporate Circle Suite 1 ♦ Golden, Colorado 80401
303-277-9310 ♦ 303-374-5933 Fax

Client: DCP/Tasman

Address:

City/State/Zip: _____

Phone: _____

Sampler Name: T. Blessing

Page / of /

Project Manager: Matt Pickett / Brian Humphrey

E-Mail: mg.pickett@dep.mastrom.com / bhuanphre@tasman-geo.com

Project Name: Nelson Mandela

Project Number: RC Code - 6017

				Preservative		Matrix		Analyze For:												
Sample Description	Date Sampled	Time Sampled	Number of Containers	HCl	HNO ₃	None	Other (Specify)	Groundwater	Soil	Air - Canister Serial #	Other (Specify)									Special Instructions
SS10	11/2/15	1450	1		X			X			X B260 GBTE x	X 8015 DRD								
Relinquished by: [Signature] Date/Time: 11/2/15-1700				Received by: [Signature] Date/Time: 11/2/15 1700		Turn Around Time (Check) Same Day <input checked="" type="checkbox"/> 72 Hours 24 Hours <input type="checkbox"/> 48 Hours <input type="checkbox"/>		Notes: on ice												
Relinquished by: [Signature] Date/Time: 11/2/15 1730				Received by: [Signature] Date/Time: 11/2/15 1730		Sample Integrity: Temperature Upon Receipt: 12.4°C Intact: Yes <input checked="" type="checkbox"/> No <input type="checkbox"/>														
Relinquished by: _____ Date/Time: _____				Received in Lab by: _____ Date/Time: _____																

www.s2scientific.com

Summit Scientific

The results in this report apply to the samples analyzed in accordance with the chain of custody document. This analytical report must be reproduced in its entirety.





DCP Midstream
370 17th Street #2500
Denver CO, 80202

Project: Nelson Milton
Project Number: RC Code - G017
Project Manager: Matt Pickett

Reported:
11/03/15 07:11

SS10
1511001-01 (Soil)

Summit Scientific

Extractable Petroleum Hydrocarbons by 8015

Date Sampled: 11/02/15 14:50

Analyte	Result	Reporting Limit	Units	Dilution	Batch	Prepared	Analyzed	Method	Notes
C10-C28 (DRO)	ND	50	mg/kg	1	1511008	11/02/15	11/02/15	8015M	

Date Sampled: 11/02/15 14:50

Analyte	Result	Reporting Limit	Units	Dilution	Batch	Prepared	Analyzed	Method	Notes
Surrogate: o-Terphenyl		99.5 %	30-150		"	"	"	"	

Volatile Organic Compounds by EPA Method 8260B

Date Sampled: 11/02/15 14:50

Analyte	Result	Reporting Limit	Units	Dilution	Batch	Prepared	Analyzed	Method	Notes
Benzene	ND	0.0020	mg/kg	1	1511003	"	11/02/15	EPA 8260B	
Toluene	ND	0.0050	"	"	"	"	"	"	
Ethylbenzene	ND	0.0050	"	"	"	"	"	"	
Xylenes (total)	ND	0.0050	"	"	"	"	"	"	
Gasoline Range Hydrocarbons	ND	0.50	"	"	"	"	"	"	

Date Sampled: 11/02/15 14:50

Analyte	Result	Reporting Limit	Units	Dilution	Batch	Prepared	Analyzed	Method	Notes
Surrogate: 1,2-Dichloroethane-d4		109 %	23-173		"	"	"	"	
Surrogate: Toluene-d8		98.3 %	20-170		"	"	"	"	
Surrogate: 4-Bromofluorobenzene		95.5 %	21-167		"	"	"	"	

Summit Scientific

The results in this report apply to the samples analyzed in accordance with the chain of custody document. This analytical report must be reproduced in its entirety.



DCP Midstream
370 17th Street #2500
Denver CO, 80202

Project: Nelson Milton
Project Number: RC Code - G017
Project Manager: Matt Pickett

Reported:
11/03/15 07:11

Extractable Petroleum Hydrocarbons by 8015 - Quality Control
Summit Scientific

Analyte	Reporting			Spike	Source		%REC		RPD	
	Result	Limit	Units	Level	Result	%REC	Limits	RPD	Limit	Notes

Batch 1511008 - EPA 3550A

Blank (1511008-BLK1)

Prepared & Analyzed: 11/02/15

C10-C28 (DRO) ND 50 mg/kg

Surrogate: o-Terphenyl 11.9 " 12.2 97.4 30-150

LCS (1511008-BS1)

Prepared & Analyzed: 11/02/15

C10-C28 (DRO) 470 50 mg/kg 499 94.3 73-134

Surrogate: o-Terphenyl 12.4 " 12.2 101 30-150

Matrix Spike (1511008-MS1)

Source: 1510244-01

Prepared & Analyzed: 11/02/15

C10-C28 (DRO) 437 50 mg/kg 468 28.9 87.2 50-148

Surrogate: o-Terphenyl 11.0 " 11.4 95.9 30-150

Matrix Spike Dup (1511008-MSD1)

Source: 1510244-01

Prepared & Analyzed: 11/02/15

C10-C28 (DRO) 442 50 mg/kg 476 28.9 86.8 50-148 1.12 13

Surrogate: o-Terphenyl 11.3 " 11.6 97.1 30-150

Summit Scientific

The results in this report apply to the samples analyzed in accordance with the chain of custody document. This analytical report must be reproduced in its entirety.



DCP Midstream
370 17th Street #2500
Denver CO, 80202

Project: Nelson Milton
Project Number: RC Code - G017
Project Manager: Matt Pickett

Reported:
11/03/15 07:11

Volatile Organic Compounds by EPA Method 8260B - Quality Control
Summit Scientific

Analyte	Reporting			Spike	Source		%REC		RPD	
	Result	Limit	Units	Level	Result	%REC	Limits	RPD	Limit	Notes

Batch 1511003 - EPA 5030 Soil MS

Blank (1511003-BLK1)

Prepared & Analyzed: 11/02/15

Benzene	ND	0.0020	mg/kg							
Toluene	ND	0.0050	"							
Ethylbenzene	ND	0.0050	"							
Xylenes (total)	ND	0.0050	"							
Gasoline Range Hydrocarbons	ND	0.50	"							
<i>Surrogate: 1,2-Dichloroethane-d4</i>	<i>0.0407</i>		<i>"</i>	<i>0.0396</i>		<i>103</i>	<i>23-173</i>			
<i>Surrogate: Toluene-d8</i>	<i>0.0391</i>		<i>"</i>	<i>0.0400</i>		<i>97.7</i>	<i>20-170</i>			
<i>Surrogate: 4-Bromofluorobenzene</i>	<i>0.0376</i>		<i>"</i>	<i>0.0400</i>		<i>93.9</i>	<i>21-167</i>			

LCS (1511003-BS1)

Prepared & Analyzed: 11/02/15

Benzene	0.0967	0.0020	mg/kg	0.100		96.7	58-130			
Toluene	0.0955	0.0050	"	0.100		95.5	61-134			
Ethylbenzene	0.106	0.0050	"	0.0992		106	74-139			
m,p-Xylene	0.199	0.010	"	0.200		99.8	73-137			
o-Xylene	0.0964	0.0050	"	0.0984		98.0	73-141			
Xylenes (total)	0.296	0.0050	"				30-150			
Gasoline Range Hydrocarbons	2.23	0.50	"				30-150			
<i>Surrogate: 1,2-Dichloroethane-d4</i>	<i>0.0431</i>		<i>"</i>	<i>0.0396</i>		<i>109</i>	<i>23-173</i>			
<i>Surrogate: Toluene-d8</i>	<i>0.0399</i>		<i>"</i>	<i>0.0400</i>		<i>99.7</i>	<i>20-170</i>			
<i>Surrogate: 4-Bromofluorobenzene</i>	<i>0.0391</i>		<i>"</i>	<i>0.0400</i>		<i>97.7</i>	<i>21-167</i>			

Matrix Spike (1511003-MS1)

Source: 1510209-02

Prepared & Analyzed: 11/02/15

Benzene	0.0936	0.0020	mg/kg	0.0942	ND	99.4	30-131			
Toluene	0.0923	0.0050	"	0.0942	ND	98.0	30-134			
Ethylbenzene	0.107	0.0050	"	0.0934	ND	114	22-153			
m,p-Xylene	0.202	0.010	"	0.188	ND	107	10-159			
o-Xylene	0.0976	0.0050	"	0.0927	ND	105	31-151			
Xylenes (total)	0.299	0.0050	"		ND		30-150			
Gasoline Range Hydrocarbons	2.26	0.50	"		ND		30-150			
<i>Surrogate: 1,2-Dichloroethane-d4</i>	<i>0.0385</i>		<i>"</i>	<i>0.0373</i>		<i>103</i>	<i>23-173</i>			
<i>Surrogate: Toluene-d8</i>	<i>0.0371</i>		<i>"</i>	<i>0.0377</i>		<i>98.6</i>	<i>20-170</i>			
<i>Surrogate: 4-Bromofluorobenzene</i>	<i>0.0360</i>		<i>"</i>	<i>0.0377</i>		<i>95.7</i>	<i>21-167</i>			

Summit Scientific

The results in this report apply to the samples analyzed in accordance with the chain of custody document. This analytical report must be reproduced in its entirety.



DCP Midstream
370 17th Street #2500
Denver CO, 80202

Project: Nelson Milton
Project Number: RC Code - G017
Project Manager: Matt Pickett

Reported:
11/03/15 07:11

Volatile Organic Compounds by EPA Method 8260B - Quality Control
Summit Scientific

Analyte	Reporting			Spike	Source		%REC		RPD	
	Result	Limit	Units	Level	Result	%REC	Limits	RPD	Limit	Notes

Batch 1511003 - EPA 5030 Soil MS

Matrix Spike Dup (1511003-MSD1)	Source: 1510209-02			Prepared & Analyzed: 11/02/15						
Benzene	0.0962	0.0020	mg/kg	0.0940	ND	102	30-131	2.76	34	
Toluene	0.0943	0.0050	"	0.0940	ND	100	30-134	2.11	30	
Ethylbenzene	0.108	0.0050	"	0.0932	ND	116	22-153	0.864	24	
m,p-Xylene	0.203	0.010	"	0.188	ND	108	10-159	0.579	68	
o-Xylene	0.0988	0.0050	"	0.0925	ND	107	31-151	1.22	38	
Xylenes (total)	0.302	0.0050	"		ND		30-150	0.788	20	
Gasoline Range Hydrocarbons	2.42	0.50	"		ND		30-150	7.13	20	
<i>Surrogate: 1,2-Dichloroethane-d4</i>	<i>0.0408</i>		<i>"</i>	<i>0.0372</i>		<i>110</i>	<i>23-173</i>			
<i>Surrogate: Toluene-d8</i>	<i>0.0367</i>		<i>"</i>	<i>0.0376</i>		<i>97.7</i>	<i>20-170</i>			
<i>Surrogate: 4-Bromofluorobenzene</i>	<i>0.0356</i>		<i>"</i>	<i>0.0376</i>		<i>94.8</i>	<i>21-167</i>			

Summit Scientific

The results in this report apply to the samples analyzed in accordance with the chain of custody document. This analytical report must be reproduced in its entirety.



DCP Midstream
370 17th Street #2500
Denver CO, 80202

Project: Nelson Milton
Project Number: RC Code - G017
Project Manager: Matt Pickett

Reported:
11/03/15 07:11

Notes and Definitions

DET Analyte DETECTED
ND Analyte NOT DETECTED at or above the reporting limit
NR Not Reported
dry Sample results reported on a dry weight basis
RPD Relative Percent Difference

A handwritten signature in black ink, appearing to be 'M. Pickett'.

Summit Scientific

741 Corporate Circle – Suite I ♦ Golden, Colorado 80401

303.277.9310 - laboratory ♦ 303.277.9531 - fax

June 30, 2017

Brian Humphrey
DCP Operating Company
370 17th Street #2500
Denver, CO 80202
RE: Nelson Milton

Enclosed are the results of analyses for samples received by Summit Scientific on 06/29/17 17:00. If you have any questions concerning this report, please feel free to contact me.

Sincerely,

A handwritten signature in black ink, appearing to read 'P. Shrewsbury', with a stylized, cursive script.

Paul Shrewsbury
President



DCP Operating Company
370 17th Street #2500
Denver CO, 80202

Project: Nelson Milton
Project Number: [none]
Project Manager: Brian Humphrey

Reported:
06/30/17 06:51

ANALYTICAL REPORT FOR SAMPLES

Sample ID	Laboratory ID	Matrix	Date Sampled	Date Received
SS11@5'	1706301-01	Soil	06/29/17 12:45	06/29/17 17:00

Summit Scientific

A handwritten signature in black ink, appearing to be 'MSM'.

The results in this report apply to the samples analyzed in accordance with the chain of custody document. This analytical report must be reproduced in its entirety.



DCP Operating Company
370 17th Street #2500
Denver CO, 80202

Project: Nelson Milton
Project Number: [none]
Project Manager: Brian Humphrey

Reported:
06/30/17 06:51

Sample Receipt Checklist

S2 Work Order: 170630

Client: DCP Midstream

Client Project ID: Nelson Milton

Shipped Via: PN

Airbill #: _____

(UPS, FedEx, Hand Delivered, Pick-up, etc.)

Matrix (check all that apply): ☐ Air ☒ Soil/Solid ☐ Water ☐ Other: _____
(Describe)

Cooler ID					
Temp (°C)	2.7				

Thermometer ID: 61857155-K

	Yes	No	N/A	Comments (if any)
If samples require cooling, was the temperature at 4°C +/- 2°C ⁽¹⁾ ?				
NOTE: If samples are delivered the same day of sampling, this requirement is met provided that there is evidence that cooling has begun.	✓			
Were all samples received intact ⁽¹⁾ ?	✓			
Was adequate sample volume provided ⁽¹⁾ ?	✓			
If custody seals are present, are they intact ⁽¹⁾ ?			✓	
Are short holding time analytes or samples with HTs due within 48 hours present?			✓	
Is a chain-of-custody (COC) form present and filled out completely ⁽¹⁾ ?	✓			
Does the COC agree with the number and type of sample bottles received ⁽¹⁾ ?	✓			
Do the sample IDs on the bottle labels match the COC ⁽¹⁾ ?	✓			
Is the COC properly relinquished by the client w/ date and time recorded ⁽¹⁾ ?	✓			
For volatiles in water – is there headspace present? If yes, contact client and note in narrative.			✓	
Are samples preserved that require preservation (excluding cooling) ⁽¹⁾ ?			✓	
Note the type of preservative in the Comments column – HCl, H2SO4, NaOH, HNO3, ect			✓	
If samples are acid preserved for metals, is the pH ≤ 2 ⁽¹⁾ ?			✓	
Record the pH in Comments.			✓	
If dissolved metals are requested, were samples field filtered?			✓	
Additional Comments (if any):				
⁽¹⁾ If NO, then contact the client before proceeding with analysis and note in case narrative.				

Nakita
Custodian Printed Name

[Signature]
Signature or Initials of Custodian

6/29/17 1700
Date/Time



DCP Operating Company
370 17th Street #2500
Denver CO, 80202

Project: Nelson Milton
Project Number: [none]
Project Manager: Brian Humphrey

Reported:
06/30/17 06:51

SS11@5'
1706301-01 (Soil)

Summit Scientific

Extractable Petroleum Hydrocarbons by 8015

Date Sampled: 06/29/17 12:45

Analyte	Result	Reporting Limit	Units	Dilution	Batch	Prepared	Analyzed	Method	Notes
C10-C28 (DRO)	ND	50	mg/kg	1	1706308	06/29/17	06/29/17	8015M	

Date Sampled: 06/29/17 12:45

Analyte	Result	Reporting Limit	Units	Dilution	Batch	Prepared	Analyzed	Method	Notes
Surrogate: o-Terphenyl		121 %	30-150		"	"	"	"	

Volatile Organic Compounds by EPA Method 8260B

Date Sampled: 06/29/17 12:45

Analyte	Result	Reporting Limit	Units	Dilution	Batch	Prepared	Analyzed	Method	Notes
Benzene	ND	0.0020	mg/kg	1	1706309	"	06/29/17	EPA 8260B	
Toluene	ND	0.0050	"	"	"	"	"	"	
Ethylbenzene	ND	0.0050	"	"	"	"	"	"	
Xylenes (total)	ND	0.0050	"	"	"	"	"	"	
Gasoline Range Hydrocarbons	ND	0.50	"	"	"	"	"	"	

Date Sampled: 06/29/17 12:45

Analyte	Result	Reporting Limit	Units	Dilution	Batch	Prepared	Analyzed	Method	Notes
Surrogate: 1,2-Dichloroethane-d4		109 %	23-173		"	"	"	"	
Surrogate: Toluene-d8		98.1 %	20-170		"	"	"	"	
Surrogate: 4-Bromofluorobenzene		98.8 %	21-167		"	"	"	"	

Summit Scientific

The results in this report apply to the samples analyzed in accordance with the chain of custody document. This analytical report must be reproduced in its entirety.



DCP Operating Company
370 17th Street #2500
Denver CO, 80202

Project: Nelson Milton
Project Number: [none]
Project Manager: Brian Humphrey

Reported:
06/30/17 06:51

Extractable Petroleum Hydrocarbons by 8015 - Quality Control
Summit Scientific

Analyte	Reporting			Spike	Source		%REC		RPD	
	Result	Limit	Units	Level	Result	%REC	Limits	RPD	Limit	Notes

Batch 1706308 - EPA 3550A

Blank (1706308-BLK1)

Prepared & Analyzed: 06/29/17

C10-C28 (DRO) ND 50 mg/kg

Surrogate: o-Terphenyl 12.8 " 12.5 102 30-150

LCS (1706308-BS1)

Prepared & Analyzed: 06/29/17

C10-C28 (DRO) 481 50 mg/kg 499 96.4 73-134

Surrogate: o-Terphenyl 13.8 " 12.5 110 30-150

Matrix Spike (1706308-MS1)

Source: 1706300-01

Prepared & Analyzed: 06/29/17

C10-C28 (DRO) 533 50 mg/kg 499 28.2 101 50-148

Surrogate: o-Terphenyl 13.9 " 12.5 112 30-150

Matrix Spike Dup (1706308-MSD1)

Source: 1706300-01

Prepared & Analyzed: 06/29/17

C10-C28 (DRO) 548 50 mg/kg 499 28.2 104 50-148 2.80 20

Surrogate: o-Terphenyl 14.4 " 12.5 115 30-150

Summit Scientific

The results in this report apply to the samples analyzed in accordance with the chain of custody document. This analytical report must be reproduced in its entirety.



DCP Operating Company
370 17th Street #2500
Denver CO, 80202

Project: Nelson Milton
Project Number: [none]
Project Manager: Brian Humphrey

Reported:
06/30/17 06:51

Volatile Organic Compounds by EPA Method 8260B - Quality Control
Summit Scientific

Analyte	Reporting			Spike	Source		%REC		RPD	
	Result	Limit	Units	Level	Result	%REC	Limits	RPD	Limit	Notes

Batch 1706309 - EPA 5030 Soil MS

Blank (1706309-BLK1)

Prepared & Analyzed: 06/29/17

Benzene	ND	0.0020	mg/kg							
Toluene	ND	0.0050	"							
Ethylbenzene	ND	0.0050	"							
Xylenes (total)	ND	0.0050	"							
Gasoline Range Hydrocarbons	ND	0.50	"							
Surrogate: 1,2-Dichloroethane-d4	0.0412		"	0.0400		103	23-173			
Surrogate: Toluene-d8	0.0398		"	0.0400		99.6	20-170			
Surrogate: 4-Bromofluorobenzene	0.0387		"	0.0400		96.8	21-167			

LCS (1706309-BS1)

Prepared & Analyzed: 06/29/17

Benzene	0.0897	0.0020	mg/kg	0.100		89.7	58-130			
Toluene	0.105	0.0050	"	0.100		105	61-134			
Ethylbenzene	0.119	0.0050	"	0.0992		120	74-139			
m,p-Xylene	0.232	0.010	"	0.200		116	73-137			
o-Xylene	0.111	0.0050	"	0.0980		113	73-141			
Xylenes (total)	0.342	0.0050	"				30-150			
Gasoline Range Hydrocarbons	ND	0.50	"				30-150			
Surrogate: 1,2-Dichloroethane-d4	0.0405		"	0.0400		101	23-173			
Surrogate: Toluene-d8	0.0392		"	0.0400		98.1	20-170			
Surrogate: 4-Bromofluorobenzene	0.0385		"	0.0400		96.3	21-167			

Matrix Spike (1706309-MS1)

Source: 1706300-01

Prepared & Analyzed: 06/29/17

Benzene	0.0873	0.0020	mg/kg	0.100		87.3	30-131			
Toluene	0.103	0.0050	"	0.100		103	30-134			
Ethylbenzene	0.121	0.0050	"	0.0992		122	22-153			
m,p-Xylene	0.236	0.010	"	0.200		118	10-159			
o-Xylene	0.114	0.0050	"	0.0980		116	31-151			
Xylenes (total)	0.349	0.0050	"				30-150			
Gasoline Range Hydrocarbons	ND	0.50	"				30-150			
Surrogate: 1,2-Dichloroethane-d4	0.0420		"	0.0400		105	23-173			
Surrogate: Toluene-d8	0.0394		"	0.0400		98.5	20-170			
Surrogate: 4-Bromofluorobenzene	0.0392		"	0.0400		98.1	21-167			

Summit Scientific

The results in this report apply to the samples analyzed in accordance with the chain of custody document. This analytical report must be reproduced in its entirety.



DCP Operating Company
370 17th Street #2500
Denver CO, 80202

Project: Nelson Milton
Project Number: [none]
Project Manager: Brian Humphrey

Reported:
06/30/17 06:51

Volatile Organic Compounds by EPA Method 8260B - Quality Control
Summit Scientific

Analyte	Reporting			Spike	Source		%REC		RPD	
	Result	Limit	Units	Level	Result	%REC	Limits	RPD	Limit	Notes

Batch 1706309 - EPA 5030 Soil MS

Matrix Spike Dup (1706309-MSD1)		Source: 1706300-01			Prepared & Analyzed: 06/29/17					
Benzene	0.0892	0.0020	mg/kg	0.100	89.2	30-131	2.21	34		
Toluene	0.106	0.0050	"	0.100	106	30-134	2.95	30		
Ethylbenzene	0.120	0.0050	"	0.0992	121	22-153	0.997	24		
m,p-Xylene	0.234	0.010	"	0.200	117	10-159	0.818	68		
o-Xylene	0.112	0.0050	"	0.0980	114	31-151	1.44	38		
Xylenes (total)	0.346	0.0050	"			30-150	1.02	20		
Gasoline Range Hydrocarbons	ND	0.50	"			30-150		20		
Surrogate: 1,2-Dichloroethane-d4	0.0424		"	0.0400	106	23-173				
Surrogate: Toluene-d8	0.0387		"	0.0400	96.7	20-170				
Surrogate: 4-Bromofluorobenzene	0.0393		"	0.0400	98.2	21-167				

Summit Scientific

The results in this report apply to the samples analyzed in accordance with the chain of custody document. This analytical report must be reproduced in its entirety.



DCP Operating Company
370 17th Street #2500
Denver CO, 80202

Project: Nelson Milton
Project Number: [none]
Project Manager: Brian Humphrey

Reported:
06/30/17 06:51

Notes and Definitions

DET	Analyte DETECTED
ND	Analyte NOT DETECTED at or above the reporting limit
NR	Not Reported
dry	Sample results reported on a dry weight basis
RPD	Relative Percent Difference