

EXTRACTION OIL & GAS

Location: COLORADO Slot: SLOT#06 HFE 8 (1125'FSL & 1075'FWL, SEC.22)
Field: WELD COUNTY (NAD83/TRUE NORTH) Well: HFE 8
Facility: SEC.22-T04N-R68W Wellbore: HFE 8 PWB

Plot reference wellpath is HFE 8 PWP (REV-B.0)

True vertical depths are referenced to CYCLONE 37 (28KB) (RKB)

Measured depths are referenced to CYCLONE 37 (28KB) (RKB)

CYCLONE 37 (28KB) (RKB) to Mean Sea Level: 4946 feet

Mean Sea Level to Ground level (At Slot: SLOT#06 HFE 8 (1125'FSL & 1075'FWL, SEC.22): 0 feet

Coordinates are in feet referenced to Slot

Grid System: NAD83 / Lambert Colorado SP, Northern Zone (501), US feet

North Reference: True north

Scale: True distance

Depths are in feet

Created by: ingmjmr on 2017-09-11

Database: WA_DEN_Denver_Defn

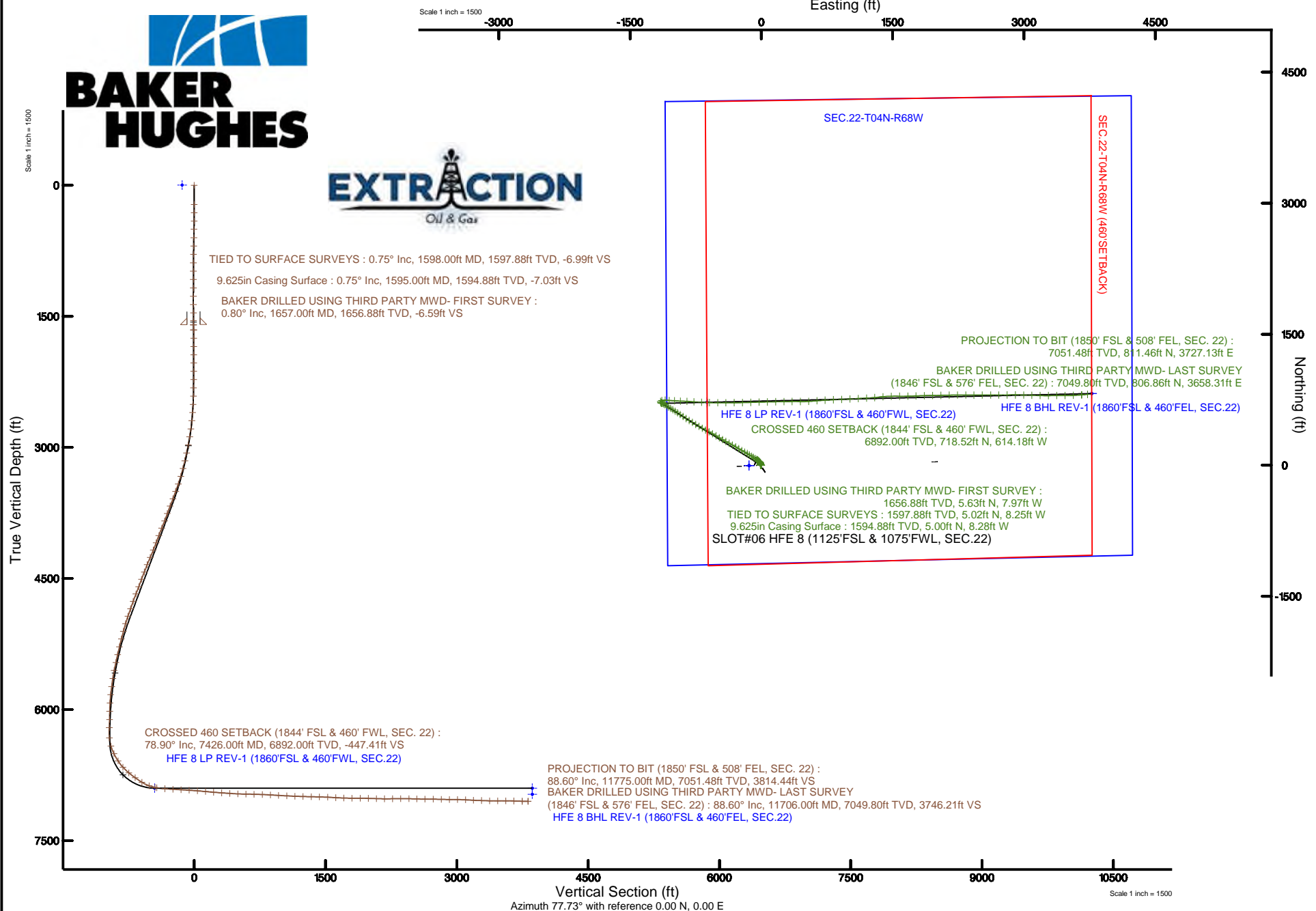



Actual Wellpath Report

HFE 8 AWP

Page 1 of 7



REFERENCE WELLPATH IDENTIFICATION

Operator	EXTRACTION OIL & GAS	Slot	SLOT#06 HFE 8 (1125'FSL & 1075'FWL, SEC.22)
Area	COLORADO	Well	HFE 8
Field	WELD COUNTY (NAD83/TRUE NORTH)	Wellbore	HFE 8 AWB
Facility	SEC.22-T04N-R68W		

REPORT SETUP INFORMATION

Projection System	NAD83 / Lambert Colorado SP, Northern Zone (501), US feet	Software System	WellArchitect® 5.1
North Reference	True	User	Ingmjmr
Scale	0.999957	Report Generated	9/12/2017 at 10:23:46 AM
Convergence at slot	0.33° East	Database/Source file	WA_DEN_Denver_Defn/HFE_8_AWP.xml

WELLPATH LOCATION

	Local coordinates		Grid coordinates		Geographic coordinates	
	North[ft]	East[ft]	Easting[US ft]	Northing[US ft]	Latitude	Longitude
Slot Location	2.91	140.04	3140891.60	1350610.35	40°17'41.006"N	104°59'41.662"W
Facility Reference Pt			3140751.59	1350606.64	40°17'40.978"N	104°59'43.469"W
Field Reference Pt			3185481.27	1419166.81	40°28'55.560"N	104°49'59.556"W

WELLPATH DATUM

Calculation method	Minimum curvature	CYCLONE 37 (28'KB) (RKB) to Facility Vertical Datum	4946.00ft
Horizontal Reference Pt	Slot	CYCLONE 37 (28'KB) (RKB) to Mean Sea Level	4946.00ft
Vertical Reference Pt	CYCLONE 37 (28'KB) (RKB)	CYCLONE 37 (28'KB) (RKB) to Ground Level at Slot (SLOT#06 HFE 8 (1125'FSL & 1075'FWL, SEC.22))	4946.00ft
MD Reference Pt	CYCLONE 37 (28'KB) (RKB)	Section Origin	N 0.00, E 0.00 ft
Field Vertical Reference	Mean Sea Level	Section Azimuth	77.73°



Actual Wellpath Report

HFE 8 AWP

Page 2 of 7



REFERENCE WELLPATH IDENTIFICATION			
Operator	EXTRACTION OIL & GAS	Slot	SLOT#06 HFE 8 (1125'FSL & 1075'FWL, SEC.22)
Area	COLORADO	Well	HFE 8
Field	WELD COUNTY (NAD83/TRUE NORTH)	Wellbore	HFE 8 AWB
Facility	SEC.22-T04N-R68W		

WELLPATH DATA (110 stations)										
MD [ft]	Inclination [°]	Azimuth [°]	TVD [ft]	Vert Sect [ft]	North [ft]	East [ft]	Latitude	Longitude	DLS [°/100ft]	Comments
1598.00	0.750	59.180	1597.88	-6.99	5.02	-8.25	40°17'41.056°N	104°59'41.768°W	0.00	TIED TO SURFACE SURVEYS
1657.00	0.800	353.100	1656.88	-6.59	5.63	-7.97	40°17'41.062°N	104°59'41.764°W	1.43	BAKER DRILLED USING THIRD PARTY MWD- FIRST SURVEY
1752.00	1.590	3.670	1751.85	-6.17	7.60	-7.96	40°17'41.082°N	104°59'41.764°W	0.86	
1846.00	1.900	359.090	1845.81	-5.50	10.46	-7.90	40°17'41.110°N	104°59'41.764°W	0.36	
1940.00	2.120	351.910	1939.75	-5.07	13.74	-8.17	40°17'41.142°N	104°59'41.767°W	0.36	
2035.00	2.520	343.090	2034.67	-5.11	17.48	-9.03	40°17'41.179°N	104°59'41.778°W	0.56	
2130.00	2.780	341.680	2129.57	-5.52	21.66	-10.36	40°17'41.220°N	104°59'41.795°W	0.28	
2224.00	2.780	336.400	2223.46	-6.21	25.92	-11.99	40°17'41.263°N	104°59'41.816°W	0.27	
2319.00	3.090	335.210	2318.34	-7.21	30.35	-13.99	40°17'41.306°N	104°59'41.842°W	0.33	
2414.00	3.310	328.510	2413.19	-8.67	35.02	-16.49	40°17'41.352°N	104°59'41.874°W	0.46	
2509.00	6.980	316.700	2507.79	-12.55	41.56	-21.88	40°17'41.417°N	104°59'41.944°W	4.00	
2603.00	6.720	315.110	2601.12	-18.46	49.61	-29.68	40°17'41.497°N	104°59'42.045°W	0.34	
2697.00	9.410	308.190	2694.19	-26.32	58.26	-39.61	40°17'41.582°N	104°59'42.173°W	3.04	
2792.00	10.910	303.610	2787.70	-37.52	68.04	-53.20	40°17'41.679°N	104°59'42.348°W	1.79	
2886.00	12.900	298.810	2879.67	-51.62	78.02	-69.80	40°17'41.777°N	104°59'42.562°W	2.36	
2981.00	15.200	301.980	2971.82	-68.54	89.73	-89.66	40°17'41.893°N	104°59'42.819°W	2.55	
3076.00	16.880	305.200	3063.12	-86.79	104.28	-111.50	40°17'42.037°N	104°59'43.101°W	2.00	
3170.00	17.410	299.690	3152.95	-106.47	119.11	-134.87	40°17'42.183°N	104°59'43.402°W	1.82	
3264.00	19.890	302.290	3242.01	-128.32	134.62	-160.61	40°17'42.337°N	104°59'43.734°W	2.78	
3359.00	21.520	298.410	3330.88	-153.05	151.55	-189.60	40°17'42.504°N	104°59'44.108°W	2.24	
3454.00	24.700	298.980	3418.24	-181.20	169.46	-222.29	40°17'42.681°N	104°59'44.530°W	3.36	
3548.00	26.780	300.390	3502.91	-211.54	189.69	-257.75	40°17'42.881°N	104°59'44.988°W	2.31	
3643.00	25.980	300.880	3588.02	-242.46	211.19	-294.07	40°17'43.093°N	104°59'45.457°W	0.87	
3737.00	27.880	297.970	3671.82	-274.26	232.07	-331.15	40°17'43.300°N	104°59'45.935°W	2.46	
3832.00	25.720	299.380	3756.62	-306.62	252.61	-368.74	40°17'43.503°N	104°59'46.420°W	2.37	
3926.00	26.690	297.480	3840.96	-338.09	272.35	-405.24	40°17'43.698°N	104°59'46.891°W	1.36	
4020.00	28.020	299.690	3924.44	-370.74	293.03	-443.15	40°17'43.902°N	104°59'47.381°W	1.78	
4115.00	27.310	300.170	4008.58	-403.42	315.04	-481.38	40°17'44.120°N	104°59'47.874°W	0.78	
4210.00	27.800	302.200	4092.81	-435.31	337.80	-518.97	40°17'44.344°N	104°59'48.359°W	1.11	
4304.00	28.810	300.480	4175.57	-467.58	360.97	-557.04	40°17'44.573°N	104°59'48.850°W	1.38	



Actual Wellpath Report

HFE 8 AWP

Page 3 of 7



REFERENCE WELLPATH IDENTIFICATION			
Operator	EXTRACTION OIL & GAS	Slot	SLOT#06 HFE 8 (1125'FSL & 1075'FWL, SEC.22)
Area	COLORADO	Well	HFE 8
Field	WELD COUNTY (NAD83/TRUE NORTH)	Wellbore	HFE 8 AWP
Facility	SEC.22-T04N-R68W		

WELLPATH DATA (110 stations)										
MD [ft]	Inclination [°]	Azimuth [°]	TVD [ft]	Vert Sect [ft]	North [ft]	East [ft]	Latitude	Longitude	DLS [°/100ft]	Comments
4399.00	28.680	296.910	4258.87	-502.06	382.90	-597.10	40°17'44.790"N	104°59'49.367"W	1.81	
4493.00	27.310	296.600	4341.87	-536.34	402.76	-636.49	40°17'44.986"N	104°59'49.876"W	1.47	
4588.00	28.190	299.780	4425.95	-569.97	423.67	-675.46	40°17'45.193"N	104°59'50.379"W	1.81	
4683.00	26.380	300.300	4510.37	-602.18	445.46	-713.16	40°17'45.408"N	104°59'50.865"W	1.92	
4777.00	27.800	302.600	4594.06	-633.09	467.81	-749.66	40°17'45.629"N	104°59'51.336"W	1.88	
4872.00	28.100	300.000	4677.98	-665.35	490.93	-787.70	40°17'45.858"N	104°59'51.827"W	1.32	
4967.00	25.810	300.790	4762.66	-697.02	512.71	-824.85	40°17'46.073"N	104°59'52.307"W	2.44	
5061.00	27.220	304.270	4846.77	-726.76	535.29	-860.19	40°17'46.296"N	104°59'52.763"W	2.23	
5156.00	25.720	302.900	4931.81	-756.24	558.72	-895.46	40°17'46.527"N	104°59'53.218"W	1.70	
5250.00	23.600	304.490	5017.23	-783.51	580.46	-928.10	40°17'46.742"N	104°59'53.639"W	2.36	
5345.00	21.210	303.790	5105.06	-808.46	600.79	-958.06	40°17'46.943"N	104°59'54.026"W	2.53	
5439.00	19.890	302.900	5193.07	-831.54	618.93	-985.62	40°17'47.122"N	104°59'54.382"W	1.44	
5533.00	18.600	302.510	5281.82	-853.45	635.68	-1011.69	40°17'47.288"N	104°59'54.718"W	1.38	
5628.00	17.720	300.570	5372.09	-874.80	651.17	-1036.91	40°17'47.441"N	104°59'55.044"W	1.12	
5723.00	16.790	303.700	5462.81	-894.94	666.14	-1060.78	40°17'47.589"N	104°59'55.352"W	1.38	
5817.00	16.390	304.580	5552.90	-913.45	681.20	-1082.99	40°17'47.738"N	104°59'55.638"W	0.50	
5912.00	10.910	298.410	5645.19	-929.44	693.09	-1101.95	40°17'47.855"N	104°59'55.883"W	5.96	
6007.00	10.780	302.600	5738.49	-942.56	702.16	-1117.34	40°17'47.945"N	104°59'56.082"W	0.84	
6101.00	7.200	291.710	5831.33	-953.68	709.07	-1130.22	40°17'48.013"N	104°59'56.248"W	4.20	
6196.00	3.890	286.780	5925.87	-961.43	712.21	-1138.84	40°17'48.044"N	104°59'56.359"W	3.52	
6290.00	1.100	233.590	6019.78	-965.04	712.59	-1142.62	40°17'48.048"N	104°59'56.408"W	3.56	
6385.00	2.390	311.590	6114.74	-967.05	713.37	-1144.84	40°17'48.055"N	104°59'56.437"W	2.54	
6479.00	5.920	326.390	6208.48	-969.97	718.71	-1148.99	40°17'48.108"N	104°59'56.490"W	3.89	
6597.00	6.500	14.170	6325.87	-969.21	730.26	-1150.72	40°17'48.222"N	104°59'56.512"W	4.28	
6691.00	18.380	67.670	6417.72	-952.14	741.11	-1135.62	40°17'48.330"N	104°59'56.318"W	16.38	
6786.00	26.910	94.290	6505.54	-916.63	745.21	-1100.17	40°17'48.370"N	104°59'55.860"W	13.83	
6881.00	34.290	93.890	6587.25	-870.26	741.78	-1051.97	40°17'48.336"N	104°59'55.238"W	7.77	
6975.00	43.390	93.010	6660.39	-813.56	738.29	-993.19	40°17'48.302"N	104°59'54.479"W	9.70	
7070.00	50.990	92.880	6724.91	-746.36	734.71	-923.64	40°17'48.267"N	104°59'53.582"W	8.00	
7164.00	55.100	92.700	6781.40	-673.84	731.06	-848.62	40°17'48.230"N	104°59'52.614"W	4.38	



Actual Wellpath Report

HFE 8 AWP

Page 4 of 7



REFERENCE WELLPATH IDENTIFICATION

Operator	EXTRACTION OIL & GAS	Slot	SLOT#06 HFE 8 (1125'FSL & 1075'FWL, SEC.22)
Area	COLORADO	Well	HFE 8
Field	WELD COUNTY (NAD83/TRUE NORTH)	Wellbore	HFE 8 AWB
Facility	SEC.22-T04N-R68W		

WELLPATH DATA (110 stations) † = interpolated/extrapolated station

MD (ft)	Inclination (°)	Azimuth (°)	TVD (ft)	Vert Sect (ft)	North (ft)	East (ft)	Latitude	Longitude	DLS ("/100ft)	Comments
7259.00	58.200	94.770	6833.63	-597.58	725.87	-769.46	40°17'48.179"N	104°59'51.592"W	3.74	
7354.00	71.720	92.000	6873.75	-514.88	720.91	-683.74	40°17'48.130"N	104°59'50.486"W	14.47	
7426.00†	78.897	91.930	6892.00	-447.41	718.52	-614.18	40°17'48.107"N	104°59'49.588"W	9.97	CROSSED 460 SETBACK (1844' FSL & 460' FWL, SEC. 22)
7448.00	81.090	91.910	6895.82	-426.41	717.80	-592.53	40°17'48.099"N	104°59'49.309"W	9.97	
7543.00	85.990	89.710	6906.51	-334.50	716.47	-498.17	40°17'48.086"N	104°59'48.091"W	5.65	
7637.00	86.300	89.400	6912.83	-242.70	717.20	-404.39	40°17'48.094"N	104°59'46.881"W	0.47	
7732.00	86.920	90.500	6918.45	-150.02	717.28	-309.56	40°17'48.094"N	104°59'45.657"W	1.33	
7827.00	86.700	88.780	6923.73	-57.21	717.88	-214.71	40°17'48.100"N	104°59'44.433"W	1.82	
7922.00	85.110	88.210	6930.52	35.87	720.37	-119.99	40°17'48.125"N	104°59'43.210"W	1.78	
8017.00	84.890	88.380	6938.80	128.91	723.18	-25.39	40°17'48.153"N	104°59'41.989"W	0.29	
8111.00	85.290	88.870	6946.84	220.87	725.43	68.24	40°17'48.175"N	104°59'40.781"W	0.67	
8206.00	85.990	88.780	6954.06	313.83	727.37	162.94	40°17'48.194"N	104°59'39.559"W	0.74	
8301.00	86.210	89.180	6960.53	406.78	729.06	257.70	40°17'48.211"N	104°59'38.336"W	0.48	
8395.00	87.580	89.490	6965.62	498.72	730.15	351.56	40°17'48.222"N	104°59'37.125"W	1.49	
8490.00	89.000	90.900	6968.45	591.44	729.83	446.51	40°17'48.218"N	104°59'35.899"W	2.11	
8584.00	89.220	86.490	6969.91	683.69	731.97	540.45	40°17'48.240"N	104°59'34.687"W	4.70	
8679.00	87.100	84.990	6972.96	777.70	739.02	635.13	40°17'48.309"N	104°59'33.465"W	2.73	
8773.00	86.920	87.370	6977.87	870.55	745.27	728.79	40°17'48.371"N	104°59'32.256"W	2.54	
8868.00	86.790	86.580	6983.08	964.17	750.28	823.51	40°17'48.420"N	104°59'31.034"W	0.84	
8963.00	86.790	88.300	6988.40	1057.66	754.51	918.26	40°17'48.462"N	104°59'29.811"W	1.81	
9057.00	88.200	86.800	6992.51	1150.19	758.53	1012.08	40°17'48.502"N	104°59'28.600"W	2.19	
9152.00	87.980	86.710	6995.67	1243.96	763.90	1106.88	40°17'48.555"N	104°59'27.377"W	0.25	
9247.00	88.600	87.990	6998.51	1337.58	768.29	1201.73	40°17'48.598"N	104°59'26.152"W	1.50	
9341.00	89.000	83.670	7000.48	1430.60	775.13	1295.44	40°17'48.666"N	104°59'24.943"W	4.61	
9436.00	87.010	84.900	7003.78	1524.91	784.58	1389.90	40°17'48.759"N	104°59'23.724"W	2.46	
9531.00	86.610	88.780	7009.07	1618.55	789.81	1484.60	40°17'48.811"N	104°59'22.502"W	4.10	
9625.00	88.290	90.980	7013.26	1710.34	790.00	1578.49	40°17'48.813"N	104°59'21.290"W	2.94	
9720.00	89.700	88.210	7014.92	1803.29	790.68	1673.46	40°17'48.819"N	104°59'20.064"W	3.27	
9814.00	89.700	88.210	7015.41	1895.72	793.61	1767.42	40°17'48.848"N	104°59'18.852"W	0.00	
9908.00	88.290	87.280	7017.06	1988.27	797.31	1861.33	40°17'48.885"N	104°59'17.640"W	1.80	



Actual Wellpath Report

HFE 8 AWP

Page 5 of 7



REFERENCE WELLPATH IDENTIFICATION			
Operator	EXTRACTION OIL & GAS	Slot	SLOT#06 HFE 8 (1125'FSL & 1075'FWL, SEC.22)
Area	COLORADO	Well	HFE 8
Field	WELD COUNTY (NAD83/TRUE NORTH)	Wellbore	HFE 8 AWP
Facility	SEC.22-T04N-R68W		

WELLPATH DATA (110 stations)										
MD [ft]	Inclination [°]	Azimuth [°]	TVD [ft]	Vert Sect [ft]	North [ft]	East [ft]	Latitude	Longitude	DLS "/100ft	Comments
10003.00	88.110	89.880	7020.05	2081.51	799.66	1956.24	40°17'48.908"N	104°59'16.415"W	2.74	
10098.00	89.400	89.400	7022.11	2174.44	800.26	2051.22	40°17'48.914"N	104°59'15.189"W	1.45	
10192.00	91.300	88.080	7021.54	2266.70	802.33	2145.18	40°17'48.934"N	104°59'13.976"W	2.46	
10287.00	90.500	89.790	7020.05	2359.88	804.09	2240.15	40°17'48.951"N	104°59'12.751"W	1.99	
10382.00	88.290	90.680	7021.05	2452.61	803.70	2335.14	40°17'48.947"N	104°59'11.525"W	2.51	
10476.00	88.690	90.190	7023.53	2544.28	802.99	2429.10	40°17'48.940"N	104°59'10.312"W	0.67	
10571.00	89.000	89.710	7025.44	2637.10	803.07	2524.08	40°17'48.941"N	104°59'09.087"W	0.60	
10666.00	89.790	89.400	7026.44	2730.08	803.81	2619.07	40°17'48.948"N	104°59'07.861"W	0.89	
10760.00	88.200	89.880	7028.09	2822.04	804.40	2713.05	40°17'48.954"N	104°59'06.648"W	1.77	
10855.00	88.910	89.400	7030.49	2914.96	805.00	2808.02	40°17'48.960"N	104°59'05.422"W	0.90	
10949.00	90.010	89.970	7031.37	3006.92	805.51	2902.01	40°17'48.965"N	104°59'04.209"W	1.32	
11044.00	87.010	91.200	7033.84	3099.49	804.55	2996.96	40°17'48.955"N	104°59'02.984"W	3.41	
11138.00	87.410	91.690	7038.42	3190.70	802.18	3090.82	40°17'48.931"N	104°59'01.772"W	0.67	
11233.00	88.200	92.310	7042.06	3282.70	798.86	3185.69	40°17'48.899"N	104°59'00.548"W	1.06	
11327.00	88.510	89.400	7044.76	3374.20	797.46	3279.63	40°17'48.885"N	104°58'59.336"W	3.11	
11422.00	89.480	89.710	7046.42	3467.16	798.20	3374.62	40°17'48.892"N	104°58'58.110"W	1.07	
11517.00	90.810	90.410	7046.18	3559.97	798.10	3469.61	40°17'48.891"N	104°58'56.884"W	1.58	
11611.00	88.110	86.400	7047.07	3652.31	800.72	3563.54	40°17'48.916"N	104°58'55.672"W	5.14	
11706.00	88.600	86.180	7049.80	3746.21	806.86	3658.31	40°17'48.977"N	104°58'54.449"W	0.57	BAKER DRILLED USING THIRD PARTY MWD- LAST SURVEY (1846' FSL & 576' FEL, SEC. 22)
11775.00	88.600	86.180	7051.48	3814.44	811.46	3727.13	40°17'49.022"N	104°58'53.560"W	0.00	PROJECTION TO BIT (1850' FSL & 508' FEL, SEC. 22)

HOLE & CASING SECTIONS - Ref Wellbore: HFE 8 AWP Ref Wellpath: HFE 8 AWP									
String/Diameter	Start MD [ft]	End MD [ft]	Interval [ft]	Start TVD [ft]	End TVD [ft]	Start N/S [ft]	Start E/W [ft]	End N/S [ft]	End E/W [ft]
9.625in Casing Surface	28.00	1595.00	1567.00	28.00	1594.88	0.01	-0.01	5.00	-8.28
8.5in Open Hole	1595.00	11775.00	10180.00	1594.88	7051.48	5.00	-8.28	811.46	3727.13



Actual Wellpath Report

HFE 8 AWP

Page 6 of 7



REFERENCE WELLPATH IDENTIFICATION			
Operator	EXTRACTION OIL & GAS	Slot	SLOT#06 HFE 8 (1125'FSL & 1075'FWL, SEC.22)
Area	COLORADO	Well	HFE 8
Field	WELD COUNTY (NAD83/TRUE NORTH)	Wellbore	HFE 8 AWB
Facility	SEC.22-T04N-R68W		

TARGETS								
Name	TVD [ft]	North [ft]	East [ft]	Grid East [US ft]	Grid North [US ft]	Latitude	Longitude	Shape
SEC.22-T04N-R68W	-2.00	-2.91	-140.04	3140751.59	1350606.64	40°17'40.978"N	104°59'43.469"W	polygon
HFE 8 BHL REV-1 (1860'FSL & 460'FEL, SEC.22)	6900.00	821.05	3774.42	3144661.11	1351452.85	40°17'49.117"N	104°58'52.950"W	point
HFE 8 LP REV-1 (1860'FSL & 460'FWL, SEC.22)	6900.00	720.99	-619.53	3140268.00	1351327.77	40°17'48.131"N	104°59'49.657"W	point
SEC.22-T04N-R68W (460'SETBACK)	6969.00	-2.91	-140.04	3140751.59	1350606.64	40°17'40.978"N	104°59'43.469"W	polygon
HFE 8 BHL (1860'FSL & 460'FEL, SEC.22)	6970.00	821.07	3774.42	3144661.11	1351452.87	40°17'49.117"N	104°58'52.950"W	point
HFE 8 LP (1860'FSL & 460'FWL, SEC.22)	6970.00	720.97	-619.54	3140267.99	1351327.75	40°17'48.131"N	104°59'49.657"W	point

WELLPATH COMPOSITION - Ref Wellbore: HFE 8 AWB Ref Wellpath: HFE 8 AWP				
Start MD [ft]	End MD [ft]	Positional Uncertainty Model	Log Name/Comment	Wellbore
0.00	1598.00	ISCWSA MWD, Rev. 4 (Standard)	SURFACE SURVEYS PROVIDED BY EXTRACTION <221-1598>	HFE 8 AWB
1598.00	11706.00	ISCWSA MWD, Rev. 4 (Standard)	BAKER DRILLED USING THIRD PARTY MWD <1657-11706>	HFE 8 AWB
11706.00	11775.00	Blind Drilling (std)	Projection to bit	HFE 8 AWB



Actual Wellpath Report

HFE 8 AWP

Page 7 of 7



REFERENCE WELLPATH IDENTIFICATION			
Operator	EXTRACTION OIL & GAS	Slot	SLOT#06 HFE 8 (1125'FSL & 1075'FWL, SEC.22)
Area	COLORADO	Well	HFE 8
Field	WELD COUNTY (NAD83/TRUE NORTH)	Wellbore	HFE 8 AWB
Facility	SEC.22-T04N-R68W		

WELLPATH COMMENTS				
MD [ft]	Inclination [°]	Azimuth [°]	TVD [ft]	Comment
1598.00	0.750	59.180	1597.88	TIED TO SURFACE SURVEYS
1657.00	0.800	353.100	1656.88	BAKER DRILLED USING THIRD PARTY MWD- FIRST SURVEY
7426.00	78.897	91.930	6892.00	CROSSED 460 SETBACK (1844' FSL & 460' FWL, SEC. 22)
11706.00	88.600	86.180	7049.80	BAKER DRILLED USING THIRD PARTY MWD- LAST SURVEY (1846' FSL & 576' FEL, SEC. 22)
11775.00	88.600	86.180	7051.48	PROJECTION TO BIT (1850' FSL & 508' FEL, SEC. 22)