



October 26, 2017

Mr. Matt Lepore, Director  
Colorado Oil and Gas Conservation Commission  
1120 Lincoln Street, Suite 801  
Denver, Colorado 80203

**RE: COGCC Rule 318A.e.: Proposed Spacing Unit  
Booth 8-L Pad (Loc ID: 452439)  
Wells: Booth W-8-7HC (API: 123-45589), Booth X-8-7HN (API: 123-45587)  
SESE Section 8, Township 6 North, Range 66 West  
Weld County, Colorado**

Dear Mr. Lepore:

Bayswater Exploration & Production, LLC (Bayswater) is planning to drill the above referenced wells in accordance with the provisions set out in Colorado Oil and Gas Conservation Commission (COGCC) Rule 318A.e. Bayswater's Proposed Spacing Unit consists of:

S/2SE/4 of Section 7, Township 6 North, Range 66 West  
S/2S/2 of Section 8, Township 6 North, Range 66 West  
S/2SW/4 of Section 9, Township 6 North, Range 66 West  
N/2NW/4 of Section 16, Township 6 North, Range 66 West  
N/2N/2 of Section 17, Township 6 North, Range 66 West  
N/2NE/4 of Section 18, Township 6 North, Range 66 West

Containing 640.00 acres, more or less

Bayswater is not the only owner within the Proposed Spacing Unit and has provided notice to the remaining owners, as required by COGCC Rule 318A.e.(6). Copies of the required notification letters are on file at Bayswater's office. The required thirty (30) day notice period has elapsed absent the receipt by Bayswater of any objection to their proposal by the owners within the Proposed Spacing Unit for the subject wells.

Enclosed is the Proposed Spacing Unit Exhibit to assist in your review and approval of Bayswater's proposed sundries for the subject wells. Many thanks for your attention to this matter.

Respectfully,

A handwritten signature in black ink, appearing to read 'Justin Garrett'.

Justin Garrett  
Regulatory Analyst  
Agent for Bayswater Exploration & Production, LLC

:jg

Enclosure: Proposed Spacing Unit Exhibit

**BOOTH 8-L PAD**  
**PROPOSED 318A.a.(4)D. SPACING UNIT**  
**SEC 7: S2SE**  
**SEC 8: S2S2**  
**SEC 9: S2SW**  
**SEC 16: N2NW**  
**SEC 17: N2N2**  
**SEC 18: N2NE**

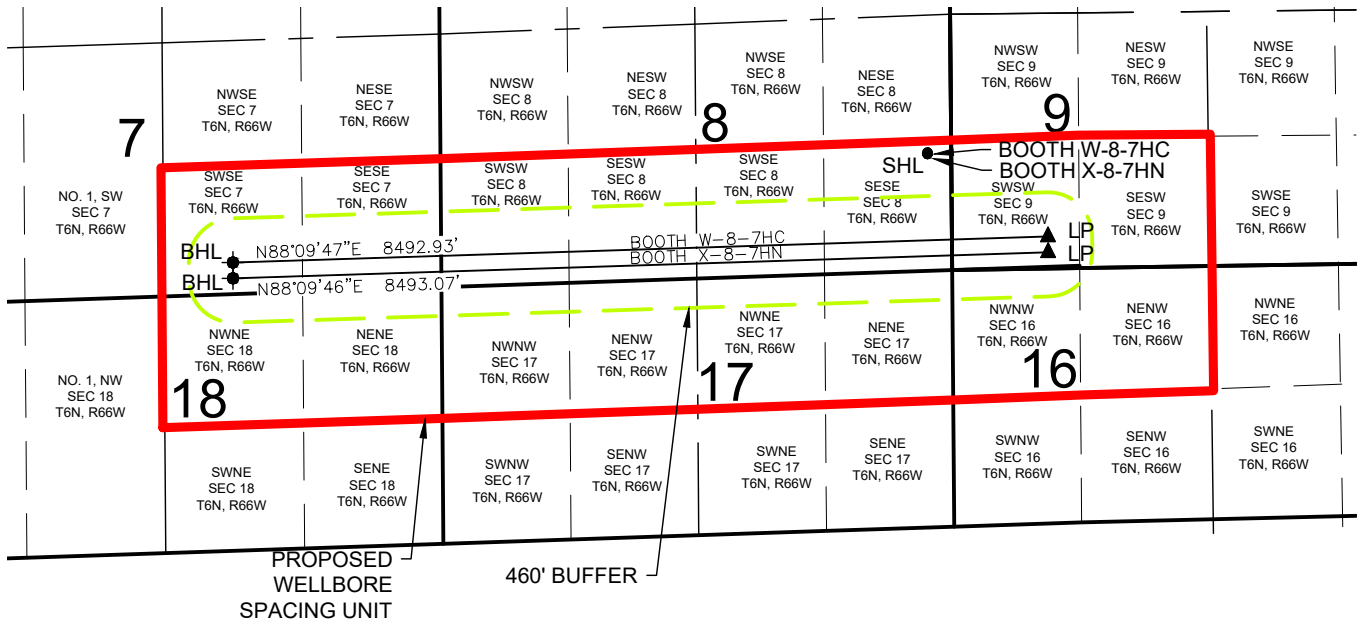

**BOOTH W-8-7HC WELL TO BE LOCATED 1231' FSL AND 248' FEL, SEC 8, T6N, R66W**  
**BOOTH X-8-7HN WELL TO BE LOCATED 1216' FSL AND 248' FEL, SEC 8, T6N, R66W**

**LEGEND**

- = PROPOSED WELL
- = BOTTOM HOLE
- ▲ = LANDING POINT
- SHL = SURFACE HOLE LOCATION
- BHL = BOTTOM HOLE LOCATION
- LP = LANDING POINT

DISCLAIMER:  
THIS PLOT DOES NOT REPRESENT A MONUMENTED LAND SURVEY AND SHOULD NOT BE  
RELIED UPON TO DETERMINE BOUNDARY LINES, PROPERTY OWNERSHIP OR OTHER  
PROPERTY INTERESTS. PARCEL LINES, IF DEPICTED HAVE NOT BEEN FIELD VERIFIED AND  
MAY BE BASED UPON PUBLICLY AVAILABLE DATA THAT ALSO HAS NOT BEEN  
INDEPENDENTLY VERIFIED.

