

# EXTRACTION OIL & GAS

Location: COLORADO Slot: SLOT#01 HFE 2 (1126'FSL & 935'FWL, SEC.22)  
Field: WELD COUNTY (NAD83/TRUE NORTH) Well: HFE 2  
Facility: SEC.22-T04N-R68W Wellbore: HFE 2 PWB

Plot reference wellpath is HFE 2 PWP (REV-B.0)

True vertical depths are referenced to CYCLONE 37 (28'KB) (RKB)

Measured depths are referenced to CYCLONE 37 (28'KB) (RKB)

CYCLONE 37 (28'KB) (RKB) to Mean Sea Level: 4948 feet

Mean Sea Level to Ground level (At Slot: SLOT#01 HFE 2 (1126'FSL & 935'FWL, SEC.22)): 0 feet

Coordinates are in feet referenced to Slot

Grid System: NAD83 / Lambert Colorado SP, Northern Zone (501), US feet

North Reference: True north

Scale: True distance

Depths are in feet

Created by: ingnjamr on 2017-09-11

Database: WA\_DEN\_Denver\_Defn



# BAKER HUGHES

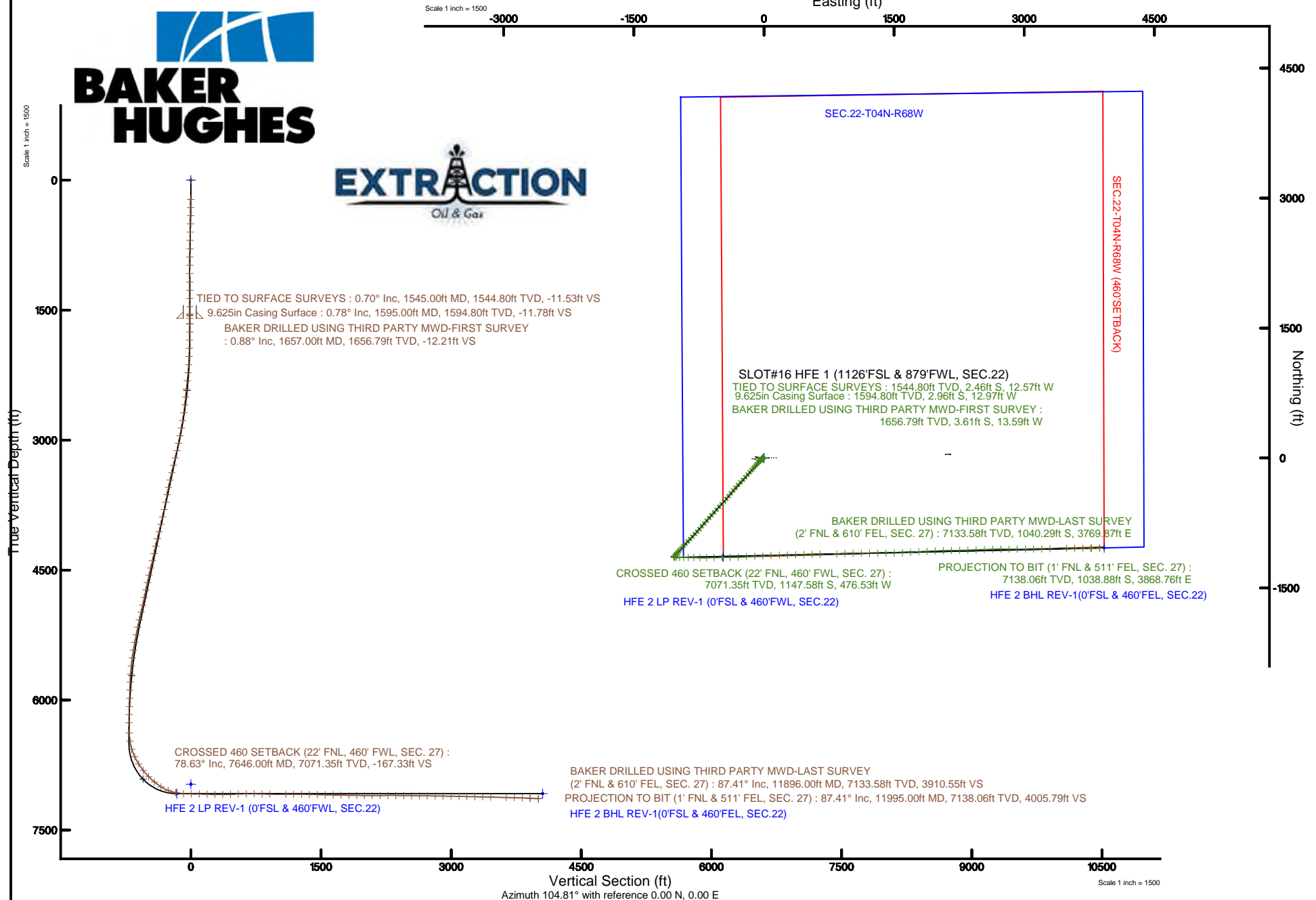



# Actual Wellpath Report

HFE 2 AWP

Page 1 of 7



## REFERENCE WELLPATH IDENTIFICATION

Operator	EXTRACTION OIL & GAS	Slot	SLOT#01 HFE 2 (1126'FSL & 935'FWL, SEC.22)
Area	COLORADO	Well	HFE 2
Field	WELD COUNTY (NAD83/TRUE NORTH)	Wellbore	HFE 2 AWB
Facility	SEC.22-T04N-R68W		

## REPORT SETUP INFORMATION

Projection System	NAD83 / Lambert Colorado SP, Northern Zone (501), US feet	Software System	WellArchitect® 5.1
North Reference	True	User	Ingmjmr
Scale	0.999957	Report Generated	9/11/2017 at 2:14:45 PM
Convergence at slot	0.33° East	Database/Source file	WA_DEN_Denver_Defn/HFE_2_AWP.xml

## WELLPATH LOCATION

	Local coordinates		Grid coordinates		Geographic coordinates	
	North[ft]	East[ft]	Easting[US ft]	Northing[US ft]	Latitude	Longitude
Slot Location	0.00	0.00	3140751.59	1350606.64	40°17'40.978"N	104°59'43.469"W
Facility Reference Pt			3140751.59	1350606.64	40°17'40.978"N	104°59'43.469"W
Field Reference Pt			3185481.27	1419166.81	40°28'55.560"N	104°49'59.556"W

## WELLPATH DATUM

Calculation method	Minimum curvature	CYCLONE 37 (28'KB) (RKB) to Facility Vertical Datum	4948.00ft
Horizontal Reference Pt	Slot	CYCLONE 37 (28'KB) (RKB) to Mean Sea Level	4948.00ft
Vertical Reference Pt	CYCLONE 37 (28'KB) (RKB)	CYCLONE 37 (28'KB) (RKB) to Ground Level at Slot (SLOT#01 HFE 2 (1126'FSL & 935'FWL, SEC.22))	4948.00ft
MD Reference Pt	CYCLONE 37 (28'KB) (RKB)	Section Origin	N 0.00, E 0.00 ft
Field Vertical Reference	Mean Sea Level	Section Azimuth	104.81°



# Actual Wellpath Report

HFE 2 AWP

Page 2 of 7



## REFERENCE WELLPATH IDENTIFICATION

Operator	EXTRACTION OIL & GAS	Slot	SLOT#01 HFE 2 (1126'FSL & 935'FWL, SEC.22)
Area	COLORADO	Well	HFE 2
Field	WELD COUNTY (NAD83/TRUE NORTH)	Wellbore	HFE 2 AWP
Facility	SEC.22-T04N-R68W		

## WELLPATH DATA (110 stations)

MD [ft]	Inclination [°]	Azimuth [°]	TVD [ft]	Vert Sect [ft]	North [ft]	East [ft]	Latitude	Longitude	DLS [°/100ft]	Comments
1545.00	0.700	214.870	1544.80	-11.53	-2.46	-12.57	40°17'40.953"N	104°59'43.631"W	0.27	TIED TO SURFACE SURVEYS
1657.00	0.880	226.490	1656.79	-12.21	-3.61	-13.59	40°17'40.942"N	104°59'43.644"W	0.21	BAKER DRILLED USING THIRD PARTY MWD-FIRST SURVEY
1752.00	0.710	274.700	1751.78	-13.18	-4.06	-14.70	40°17'40.937"N	104°59'43.659"W	0.70	
1846.00	1.500	231.210	1845.77	-14.48	-4.79	-16.24	40°17'40.930"N	104°59'43.678"W	1.17	
1941.00	2.610	234.690	1940.70	-16.60	-6.82	-18.98	40°17'40.910"N	104°59'43.714"W	1.18	
2035.00	4.600	227.900	2034.51	-20.03	-10.58	-23.52	40°17'40.873"N	104°59'43.772"W	2.16	
2130.00	6.320	230.810	2129.08	-25.19	-16.44	-30.40	40°17'40.815"N	104°59'43.861"W	1.83	
2225.00	8.790	229.880	2223.25	-32.43	-24.42	-40.01	40°17'40.736"N	104°59'43.985"W	2.60	
2319.00	11.180	225.870	2315.82	-41.26	-35.40	-52.04	40°17'40.628"N	104°59'44.140"W	2.65	
2414.00	12.280	222.080	2408.83	-50.64	-49.31	-65.42	40°17'40.490"N	104°59'44.313"W	1.41	
2509.00	13.700	218.470	2501.40	-59.79	-65.62	-79.19	40°17'40.329"N	104°59'44.491"W	1.72	
2603.00	15.690	218.910	2592.32	-69.44	-84.22	-94.10	40°17'40.145"N	104°59'44.683"W	2.12	
2698.00	17.010	220.980	2683.48	-80.82	-104.71	-111.28	40°17'39.943"N	104°59'44.905"W	1.52	
2792.00	19.180	221.510	2772.83	-93.82	-126.66	-130.54	40°17'39.726"N	104°59'45.153"W	2.32	
2886.00	21.210	221.690	2861.04	-108.45	-150.92	-152.08	40°17'39.486"N	104°59'45.431"W	2.16	
2981.00	23.200	220.810	2948.99	-124.42	-177.92	-175.74	40°17'39.219"N	104°59'45.737"W	2.12	
3076.00	24.790	221.510	3035.78	-141.57	-207.00	-201.17	40°17'38.932"N	104°59'46.065"W	1.70	
3170.00	25.320	223.010	3120.94	-159.92	-236.45	-227.95	40°17'38.641"N	104°59'46.410"W	0.88	
3264.00	26.200	223.490	3205.59	-179.38	-266.21	-255.94	40°17'38.347"N	104°59'46.772"W	0.96	
3359.00	26.910	223.890	3290.57	-199.89	-296.91	-285.28	40°17'38.044"N	104°59'47.150"W	0.77	
3454.00	25.810	222.300	3375.69	-219.89	-327.71	-314.10	40°17'37.739"N	104°59'47.522"W	1.38	
3548.00	27.220	220.410	3459.81	-238.62	-359.21	-341.81	40°17'37.428"N	104°59'47.880"W	1.75	
3643.00	26.690	218.690	3544.49	-256.65	-392.41	-369.23	40°17'37.100"N	104°59'48.234"W	0.99	
3737.00	25.720	218.070	3628.82	-273.25	-424.94	-395.01	40°17'36.778"N	104°59'48.566"W	1.07	
3832.00	24.080	218.910	3714.99	-289.30	-456.26	-419.89	40°17'36.469"N	104°59'48.888"W	1.77	
3926.00	25.590	222.170	3800.30	-306.46	-486.23	-445.57	40°17'36.173"N	104°59'49.219"W	2.17	
4020.00	26.910	223.190	3884.60	-325.90	-516.78	-473.76	40°17'35.871"N	104°59'49.583"W	1.48	
4115.00	24.880	223.010	3970.06	-345.57	-547.07	-502.11	40°17'35.571"N	104°59'49.948"W	2.14	
4210.00	27.490	221.600	4055.30	-364.90	-578.09	-530.30	40°17'35.265"N	104°59'50.312"W	2.82	
4304.00	29.390	222.000	4137.96	-385.21	-611.46	-560.14	40°17'34.935"N	104°59'50.697"W	2.03	



# Actual Wellpath Report

HFE 2 AWP

Page 3 of 7



REFERENCE WELLPATH IDENTIFICATION			
Operator	EXTRACTION OIL & GAS	Slot	SLOT#01 HFE 2 (1126'FSL & 935'FWL, SEC.22)
Area	COLORADO	Well	HFE 2
Field	WELD COUNTY (NAD83/TRUE NORTH)	Wellbore	HFE 2 AWP
Facility	SEC.22-T04N-R68W		

WELLPATH DATA (110 stations)										
MD [ft]	Inclination [°]	Azimuth [°]	TVD [ft]	Vert Sect [ft]	North [ft]	East [ft]	Latitude	Longitude	DLS [°/100ft]	Comments
4399.00	25.980	223.190	4222.07	-405.76	-643.96	-589.99	40°17'34.614"N	104°59'51.083"W	3.64	
4494.00	26.600	219.480	4307.25	-424.53	-675.55	-617.75	40°17'34.302"N	104°59'51.441"W	1.85	
4588.00	25.720	221.690	4391.62	-442.53	-707.03	-644.70	40°17'33.991"N	104°59'51.789"W	1.40	
4683.00	28.590	221.690	4476.14	-462.13	-739.40	-673.54	40°17'33.671"N	104°59'52.161"W	3.02	
4777.00	26.600	219.570	4559.44	-481.12	-772.42	-701.90	40°17'33.345"N	104°59'52.527"W	2.36	
4872.00	27.710	222.080	4643.97	-500.15	-805.21	-730.26	40°17'33.021"N	104°59'52.893"W	1.68	
4967.00	23.600	220.980	4729.59	-518.66	-835.97	-757.54	40°17'32.717"N	104°59'53.245"W	4.36	
5061.00	23.600	222.390	4815.73	-535.67	-864.08	-782.57	40°17'32.439"N	104°59'53.568"W	0.60	
5156.00	25.010	224.680	4902.31	-554.48	-892.40	-809.51	40°17'32.159"N	104°59'53.915"W	1.79	
5250.00	25.810	224.290	4987.22	-574.44	-921.18	-837.77	40°17'31.875"N	104°59'54.280"W	0.87	
5345.00	24.220	223.490	5073.30	-593.97	-950.12	-865.63	40°17'31.588"N	104°59'54.640"W	1.71	
5439.00	23.290	223.100	5159.34	-612.03	-977.68	-891.59	40°17'31.316"N	104°59'54.975"W	1.00	
5534.00	22.320	222.700	5246.91	-629.37	-1004.65	-916.66	40°17'31.050"N	104°59'55.298"W	1.03	
5628.00	19.710	223.410	5334.65	-645.31	-1029.29	-939.66	40°17'30.806"N	104°59'55.595"W	2.79	
5723.00	19.180	224.770	5424.23	-660.77	-1052.01	-961.66	40°17'30.582"N	104°59'55.879"W	0.73	
5817.00	16.570	225.080	5513.69	-675.24	-1072.44	-982.03	40°17'30.380"N	104°59'56.142"W	2.78	
5912.00	13.790	217.100	5605.37	-686.37	-1091.04	-998.46	40°17'30.196"N	104°59'56.354"W	3.65	
6007.00	11.490	217.100	5698.06	-694.25	-1107.62	-1011.00	40°17'30.032"N	104°59'56.515"W	2.42	
6101.00	8.400	213.490	5790.64	-700.00	-1120.82	-1020.44	40°17'29.902"N	104°59'56.637"W	3.35	
6196.00	6.100	207.980	5884.88	-703.37	-1131.06	-1026.63	40°17'29.800"N	104°59'56.717"W	2.53	
6290.00	3.890	213.490	5978.51	-705.53	-1138.13	-1030.74	40°17'29.731"N	104°59'56.770"W	2.40	
6385.00	1.500	271.090	6073.42	-707.77	-1140.80	-1033.76	40°17'29.704"N	104°59'56.809"W	3.51	
6479.00	1.900	285.810	6167.37	-710.53	-1140.35	-1036.49	40°17'29.709"N	104°59'56.844"W	0.63	
6574.00	1.810	212.870	6262.34	-712.57	-1141.18	-1038.82	40°17'29.700"N	104°59'56.874"W	2.32	
6692.00	2.920	113.190	6380.27	-710.17	-1143.93	-1037.07	40°17'29.673"N	104°59'56.852"W	3.12	
6786.00	7.910	99.970	6473.82	-701.35	-1145.99	-1028.49	40°17'29.653"N	104°59'56.741"W	5.44	
6881.00	18.120	89.180	6566.27	-680.55	-1146.92	-1007.22	40°17'29.644"N	104°59'56.467"W	11.00	
6975.00	25.500	89.880	6653.49	-646.88	-1146.66	-972.32	40°17'29.646"N	104°59'56.016"W	7.86	
7070.00	32.390	90.810	6736.57	-602.38	-1146.98	-926.38	40°17'29.643"N	104°59'55.423"W	7.27	
7164.00	39.110	92.480	6812.81	-548.92	-1148.62	-871.52	40°17'29.627"N	104°59'54.715"W	7.22	

## REFERENCE WELLPATH IDENTIFICATION

Operator	EXTRACTION OIL & GAS	Slot	SLOT#01 HFE 2 (1126'FSL & 935'FWL, SEC.22)
Area	COLORADO	Well	HFE 2
Field	WELD COUNTY (NAD83/TRUE NORTH)	Wellbore	HFE 2 AWP
Facility	SEC.22-T04N-R68W		

## WELLPATH DATA (110 stations) † = interpolated/extrapolated station

MD [ft]	Inclination [°]	Azimuth [°]	TVD [ft]	Vert Sect [ft]	North [ft]	East [ft]	Latitude	Longitude	DLS [°/100ft]	Comments
7259.00	45.290	90.410	6883.16	-486.89	-1150.16	-807.76	40°17'29.612"N	104°59'53.893"W	6.67	
7354.00	51.300	90.900	6946.33	-418.15	-1150.99	-736.87	40°17'29.604"N	104°59'52.978"W	6.34	
7449.00	57.800	88.870	7001.41	-343.43	-1150.78	-659.53	40°17'29.606"N	104°59'51.980"W	7.06	
7543.00	69.600	88.870	7042.98	-262.54	-1149.12	-575.43	40°17'29.622"N	104°59'50.895"W	12.55	
7638.00	77.690	89.310	7069.71	-174.87	-1147.68	-484.36	40°17'29.636"N	104°59'49.719"W	8.53	
7646.00†	78.626	89.248	7071.35	-167.33	-1147.58	-476.53	40°17'29.637"N	104°59'49.618"W	11.73	CROSSED 460 SETBACK (22' FNL, 460' FWL, SEC. 27)
7732.00	88.690	88.600	7080.84	-85.23	-1145.97	-391.18	40°17'29.653"N	104°59'48.517"W	11.73	
7827.00	88.690	88.470	7083.01	5.94	-1143.54	-296.24	40°17'29.677"N	104°59'47.292"W	0.14	
7922.00	89.000	86.710	7084.93	96.66	-1139.55	-201.35	40°17'29.717"N	104°59'46.067"W	1.88	
8017.00	88.200	87.110	7087.25	187.03	-1134.43	-106.51	40°17'29.767"N	104°59'44.843"W	0.94	
8111.00	89.620	85.700	7089.04	276.20	-1128.54	-12.72	40°17'29.826"N	104°59'43.633"W	2.13	
8206.00	89.700	89.400	7089.60	366.91	-1124.48	82.18	40°17'29.866"N	104°59'42.408"W	3.90	
8301.00	91.910	87.590	7088.27	458.06	-1121.98	177.12	40°17'29.890"N	104°59'41.183"W	3.01	
8395.00	92.090	88.690	7084.99	548.06	-1118.93	271.02	40°17'29.920"N	104°59'39.971"W	1.19	
8490.00	91.380	88.210	7082.11	639.17	-1116.36	365.94	40°17'29.946"N	104°59'38.747"W	0.90	
8584.00	88.600	88.470	7082.13	729.30	-1113.64	459.89	40°17'29.973"N	104°59'37.534"W	2.97	
8679.00	88.380	88.380	7084.63	820.41	-1111.03	554.82	40°17'29.999"N	104°59'36.309"W	0.25	
8773.00	89.400	90.900	7086.45	911.11	-1110.44	648.79	40°17'30.004"N	104°59'35.096"W	2.89	
8963.00	90.100	86.890	7087.28	1093.78	-1106.78	838.71	40°17'30.040"N	104°59'32.645"W	2.14	
9057.00	90.410	87.990	7086.86	1183.49	-1102.58	932.62	40°17'30.082"N	104°59'31.434"W	1.22	
9152.00	89.220	89.490	7087.17	1274.78	-1100.49	1027.59	40°17'30.103"N	104°59'30.208"W	2.02	
9247.00	88.600	90.190	7088.98	1366.53	-1100.23	1122.57	40°17'30.105"N	104°59'28.982"W	0.98	
9341.00	88.910	89.400	7091.02	1457.30	-1099.89	1216.55	40°17'30.108"N	104°59'27.770"W	0.90	
9436.00	88.600	89.400	7093.08	1548.86	-1098.89	1311.52	40°17'30.118"N	104°59'26.544"W	0.33	
9531.00	88.510	89.180	7095.48	1640.37	-1097.72	1406.48	40°17'30.130"N	104°59'25.319"W	0.25	
9625.00	89.310	88.690	7097.27	1730.77	-1095.97	1500.45	40°17'30.147"N	104°59'24.106"W	1.00	
9720.00	89.090	88.080	7098.59	1821.88	-1093.29	1595.40	40°17'30.173"N	104°59'22.881"W	0.68	
9814.00	89.090	86.710	7100.09	1911.56	-1089.02	1689.29	40°17'30.216"N	104°59'21.669"W	1.46	
9908.00	88.690	85.610	7101.91	2000.60	-1082.73	1783.06	40°17'30.278"N	104°59'20.459"W	1.24	
10003.00	90.590	87.680	7102.50	2090.85	-1077.17	1877.88	40°17'30.332"N	104°59'19.235"W	2.96	



# Actual Wellpath Report

HFE 2 AWP

Page 5 of 7



REFERENCE WELLPATH IDENTIFICATION			
Operator	EXTRACTION OIL & GAS	Slot	SLOT#01 HFE 2 (1126'FSL & 935'FWL, SEC.22)
Area	COLORADO	Well	HFE 2
Field	WELD COUNTY (NAD83/TRUE NORTH)	Wellbore	HFE 2 AWP
Facility	SEC.22-T04N-R68W		

WELLPATH DATA (110 stations)										
MD [ft]	Inclination [°]	Azimuth [°]	TVD [ft]	Vert Sect [ft]	North [ft]	East [ft]	Latitude	Longitude	DLS [°/100ft]	Comments
10098.00	90.720	88.970	7101.42	2181.46	-1072.74	1972.77	40°17'30.376"N	104°59'18.011"W	0.76	
10193.00	90.500	88.690	7100.41	2272.31	-1069.14	2067.70	40°17'30.412"N	104°59'16.786"W	1.83	
10287.00	89.310	89.380	7100.56	2362.76	-1067.56	2161.68	40°17'30.427"N	104°59'15.573"W	1.46	
10382.00	89.220	88.600	7101.78	2454.16	-1065.88	2256.66	40°17'30.444"N	104°59'14.347"W	0.83	
10477.00	89.220	88.080	7103.07	2545.25	-1063.13	2351.61	40°17'30.471"N	104°59'13.122"W	0.55	
10571.00	88.910	87.680	7104.61	2635.16	-1059.65	2445.53	40°17'30.505"N	104°59'11.910"W	0.54	
10665.00	90.060	88.870	7105.45	2725.27	-1056.82	2539.48	40°17'30.533"N	104°59'10.697"W	1.76	
10761.00	88.910	86.580	7106.32	2817.02	-1053.01	2635.39	40°17'30.571"N	104°59'09.460"W	2.67	
10855.00	89.220	90.410	7107.85	2907.20	-1050.55	2729.33	40°17'30.595"N	104°59'08.247"W	4.09	
10950.00	88.820	90.590	7109.48	2999.24	-1051.38	2824.31	40°17'30.587"N	104°59'07.022"W	0.46	
11044.00	88.910	89.310	7111.34	3090.08	-1051.29	2918.29	40°17'30.587"N	104°59'05.809"W	1.36	
11139.00	88.600	89.970	7113.40	3181.74	-1050.70	3013.27	40°17'30.593"N	104°59'04.583"W	0.77	
11233.00	88.820	89.000	7115.52	3272.38	-1049.85	3107.24	40°17'30.601"N	104°59'03.371"W	1.06	
11328.00	88.910	89.000	7117.40	3363.76	-1048.19	3202.21	40°17'30.617"N	104°59'02.145"W	0.09	
11423.00	88.510	87.810	7119.54	3454.87	-1045.55	3297.14	40°17'30.643"N	104°59'00.920"W	1.32	
11612.00	88.380	89.710	7124.67	3636.43	-1041.46	3486.02	40°17'30.684"N	104°58'58.483"W	1.01	
11706.00	88.510	90.280	7127.22	3727.27	-1041.45	3579.99	40°17'30.684"N	104°58'57.270"W	0.62	
11801.00	88.200	89.570	7129.95	3819.04	-1041.33	3674.95	40°17'30.685"N	104°58'56.045"W	0.82	
11896.00	87.410	89.180	7133.58	3910.55	-1040.29	3769.87	40°17'30.695"N	104°58'54.820"W	0.93	BAKER DRILLED USING THIRD PARTY MWD-LAST SURVEY (2' FNL & 610' FEL, SEC. 27)
11995.00	87.410	89.180	7138.06	4005.79	-1038.88	3868.76	40°17'30.709"N	104°58'53.543"W	0.00	PROJECTION TO BIT (1' FNL & 511' FEL, SEC. 27)

HOLE & CASING SECTIONS - Ref Wellbore: HFE 2 AWP      Ref Wellpath: HFE 2 AWP									
String/Diameter	Start MD [ft]	End MD [ft]	Interval [ft]	Start TVD [ft]	End TVD [ft]	Start N/S [ft]	Start E/W [ft]	End N/S [ft]	End E/W [ft]
9.625in Casing Surface	28.00	1595.00	1567.00	28.00	1594.80	0.01	-0.02	-2.96	-12.97
8.5in Open Hole	1595.00	11995.00	10400.00	1594.80	7138.06	-2.96	-12.97	-1038.88	3868.76



# Actual Wellpath Report

HFE 2 AWP

Page 6 of 7



REFERENCE WELLPATH IDENTIFICATION			
Operator	EXTRACTION OIL & GAS	Slot	SLOT#01 HFE 2 (1126'FSL & 935'FWL, SEC.22)
Area	COLORADO	Well	HFE 2
Field	WELD COUNTY (NAD83/TRUE NORTH)	Wellbore	HFE 2 AWB
Facility	SEC.22-T04N-R68W		

TARGETS								
Name	TVD [ft]	North [ft]	East [ft]	Grid East [US ft]	Grid North [US ft]	Latitude	Longitude	Shape
SEC.22-T04N-R68W	0.00	0.00	0.00	3140751.59	1350606.64	40°17'40.978"N	104°59'43.469"W	polygon
SEC.22-T04N-R68W (460'SETBACK)	6971.00	0.00	0.00	3140751.59	1350606.64	40°17'40.978"N	104°59'43.469"W	polygon
HFE 2 BHL REV-1(0'FSL & 460'FEL, SEC.22)	7080.00	-1036.50	3919.78	3144677.03	1349592.51	40°17'30.732"N	104°58'52.885"W	point
HFE 2 LP REV-1 (0'FSL & 460'FWL, SEC.22)	7080.00	-1136.59	-468.37	3140289.71	1349467.46	40°17'29.746"N	104°59'49.513"W	point

WELLPATH COMPOSITION - Ref Wellbore: HFE 2 AWB    Ref Wellpath: HFE 2 AWP				
Start MD [ft]	End MD [ft]	Positional Uncertainty Model	Log Name/Comment	Wellbore
0.00	1545.00	ISCWSA MWD, Rev. 4 (Standard)	SURFACE SURVEYS PROVIDED BY EXTRACTION <221-1545>	HFE 2 AWB
1545.00	11896.00	ISCWSA MWD, Rev. 4 (Standard)	BAKER DRILLED USING THIRD PARTY MWD <1657-11896>	HFE 2 AWB
11896.00	11995.00	Blind Drilling (std)	Projection to bit	HFE 2 AWB



# Actual Wellpath Report

HFE 2 AWP

Page 7 of 7



REFERENCE WELLPATH IDENTIFICATION			
Operator	EXTRACTION OIL & GAS	Slot	SLOT#01 HFE 2 (1126'FSL & 935'FWL, SEC.22)
Area	COLORADO	Well	HFE 2
Field	WELD COUNTY (NAD83/TRUE NORTH)	Wellbore	HFE 2 AWB
Facility	SEC.22-T04N-R68W		

WELLPATH COMMENTS				
MD [ft]	Inclination [°]	Azimuth [°]	TVD [ft]	Comment
1545.00	0.700	214.870	1544.80	TIED TO SURFACE SURVEYS
1657.00	0.880	226.490	1656.79	BAKER DRILLED USING THIRD PARTY MWD-FIRST SURVEY
7646.00	78.626	89.248	7071.35	CROSSED 460 SETBACK (22' FNL, 460' FWL, SEC. 27)
11896.00	87.410	89.180	7133.58	BAKER DRILLED USING THIRD PARTY MWD-LAST SURVEY (2' FNL & 610' FEL, SEC. 27)
11995.00	87.410	89.180	7138.06	PROJECTION TO BIT (1' FNL & 511' FEL, SEC. 27)