

Test Report

eANALYTICS LABORATORY

October 20, 2017

Client: Bayswater Exploration

Project: Mering 13-27

Lab ID: 7661

Date Samples Received: 10/16/2017

Number of Samples: 8

Sample Condition: Samples arrived intact and in appropriate sample containers.
Samples were received within the temperature range specified
in the method(s) or with thermal preservation in process.

Comments: Sample names updated per David Pittman 10/19/17.

Thank you for allowing eAnalytics Laboratory to provide laboratory services for you.

Christopher Dieken
Quality Assurance Manager

Todd Rhea
Laboratory Manager

eAnalytics Laboratory
4130 Clydesdale Parkway Loveland CO 80538

The results contained within this report relate only to the items analyzed

Page 1 of 8

Chain of Custody

eANALYTICS

LABORATORY

Test Report

October 18, 2017

Chain of Custody

eANALYTICS

LABORATORY

eANALYTICS LABORATORY			Chain of Custody Form	
CLIENT INFORMATION			ANALYSIS INFORMATION	
Client Information Company: Boysen Exploration Project: MEBing 13-27 Project Manager: David Pittman Sample: David Pittman Phone/Fax: 4130 447-0000 Address: 720 17th St Ste 610 Denver CO			Analysis Information Other Analysis:	
Lab ID	Sample Name	Sampling Date/Time	Analysis Type	Analysis Result
#1	WEST SITE Flow Line	10/16/17	S	
#2	WEST SITE Flow Line	10/16/17	1W	
#3	EAST SITE LINE	10/16/17	1S	
#4	CRACK-Flow Line	10/16/17	1W	
#5	WEST SITE SW	10/16/17	1W	
#6	CRACK 40' South FL	10/16/17	1W	
#7	EAST SITE LINE	10/16/17	1W	
#8	CRACK Flow Line	10/16/17	1S	
NO DRD FOR WATER				
Comments:				
Turnaround Time (Business Days) YAS logo when sample is analyzed by eANALYTICS <input type="checkbox"/> Normal (1-3 Days) <input type="checkbox"/> Rush (2-5 Days) <input type="checkbox"/> Same Day (Next Day)			Chain of Custody Analyzed by: David Pittman Checked by: David Pittman Company: Boysen Exploration Date: 10/16/17 Time: 10:00 AM Signature: David Pittman Date: 10/16/17 Time: 10:00 AM Signature: David Pittman	
Samples Received Intact? <input checked="" type="checkbox"/> Yes / <input type="checkbox"/> No Samples Received on Ice? <input checked="" type="checkbox"/> Yes / <input type="checkbox"/> No			eANALYTICS Laboratory 4130 Clydesdale Parkway Loveland CO 80538 (970) 447-0000	
Lab ID # 71621			Page 2 of 8	

eAnalytics Laboratory
 4130 Clydesdale Parkway Loveland CO 80538

The results contained within this report relate only to the items analyzed.

eAnalytics Laboratory

4130 Clydesdale Parkway Loveland CO 80538

The results contained within this report relate only to the items analyzed.

eANALYTICS
L A B O R A T O R Y

Client: Bayswater Exploration

Lab ID: 7661

Project: Mering 13-27

Analysis: Volatile Organics
TEPHMethod: EPA8260
#N/A

Sample Name	Benzene mg/kg	Toluene mg/kg	Ethyl- benzene mg/kg	Total Xylenes mg/kg	TVPH mg/kg	TEPH mg/kg	Date Sampled	Date Analyzed	Lab ID
#1 West Site Flow Line	<0.010	<0.010	<0.010	0.033	<50.0	<50.0	10/16/17	10/17/17	7661 1
#1 East Site Liner	<0.010	<0.010	<0.010	0.112	<50.0	<50.0	10/16/17	10/17/17	7661 3
#5 Creek - Flow Line 2'	<0.010	<0.010	<0.010	<0.010	<50.0	<50.0	10/16/17	10/17/17	7661 8

#2 + #2E ARE RESAMPLES FROM REPORT 7639 - NOW CLEAN

eAnalytics Laboratory

4130 Clydesdale Parkway Loveland CO 80538

The results contained within this report relate only to the items analyzed.

Page 3 of 8

eANALYTICS
LABORATORY

Client: Bayswater Exploration

Lab ID: 7661

Project: Mering 13-27

Analysis: Volatile Organics

Method: EPA8260

Sample Name	Benzene mg/L	Toluene mg/L	Ethyl- benzene mg/L	Total Xylenes mg/L	TVPH mg/L	Date Sampled	Date Analyzed	Lab ID
#1 #1 West Site Flow Line	0.036	0.014	<0.001	0.032	0.56	10/16/17	10/16/17	7661 2
#4 Creek - Flowline	<0.001	<0.001	<0.001	<0.001	<0.50	10/16/17	10/16/17	7661 4
#2 West Site SW	0.046	0.009	<0.001	0.030	0.57	10/16/17	10/16/17	7661 5
#3 Creek 40' South F.L	<0.001	<0.001	<0.001	<0.001	<0.50	10/16/17	10/16/17	7661 6
#1E #1 East Site Liner	0.034	0.012	0.001	0.044	0.94	10/16/17	10/16/17	7661 7

#1E (#1 EAST SITE LINER) IS RESAMPLE FROM REPORT 7640 -

eAnalytics Laboratory

4130 Clydesdale Parkway Loveland CO 80538

The results contained within this report relate only to the items analyzed

Page 4 of 8

eANALYTICS
L A B O R A T O R Y

Client: Bayswater Exploration

Lab ID: 7661

Project: Mering 13-27

Method: EPA8260

Sample Name	Dibromo- fluoromethane % Recovery	1,2 Dichloro- ethane-D4 % Recovery	Toluene-D8 % Recovery	Bromo- fluorobenzene % Recovery	Date Sampled	Date Analyzed	Lab ID
#1 West Site Flow Line	113	119	100	92	10/16/17	10/17/17	7661 1
#1 East Site Liner	102	106	106	114	10/16/17	10/17/17	7661 3
#5 Creek - Flow Line 2'	104	111	98	75	10/16/17	10/17/17	7661 8

eAnalytics Laboratory

4130 Clydesdale Parkway Loveland CO 80538

The results contained within this report relate only to the items analyzed

eANALYTICS
L A B O R A T O R Y

Client: Bayswater Exploration

Lab ID: 7661

Project: Mering 13-27

Method: EPA8260

Sample Name	Dibromo- fluoromethane % Recovery	1,2 Dichloro- ethane-D4 % Recovery	Toluene-D8 % Recovery	Bromo- fluorobenzene % Recovery	Date Sampled	Date Analyzed	Lab ID
#1 West Site Flow Line	97	88	94	80	10/16/17	10/16/17	7661 2
#4 Creek - Flowline	93	89	96	79	10/16/17	10/16/17	7661 4
#2 West Site SW	94	92	96	85	10/16/17	10/16/17	7661 5
#3 Creek 40' South F.L.	96	98	96	84	10/16/17	10/16/17	7661 6
#1 East Site Liner	96	88	96	87	10/16/17	10/16/17	7661 7

eAnalytics Laboratory

4130 Clydesdale Parkway Loveland CO 80538

The results contained within this report relate only to the items analyzed

eANALYTICS
L A B O R A T O R Y

Client: Bayswater Exploration

Lab ID: 7661

Project: Mering 13-27

Analysis: Volatile Organics
TEPHMethod: EPA8260
#N/A

Sample Name	Benzene % Rec	Toluene % Rec	Ethyl- benzene % Rec	Total Xylenes % Rec	TVPH % Rec	TEPH % Rec	Date Analyzed	Lab ID
Laboratory Control Sample (70-130%)	94	92	92	90	101	94	10/17/17	LCS 7661 1
Method Blank	<0.010	<0.010	<0.010	<0.010	<50.0	<50.0	10/17/17	MB 7661 1
	mg/kg	mg/kg	mg/kg	mg/kg	mg/kg	mg/kg		

eAnalytics Laboratory

4130 Clydesdale Parkway Loveland CO 80538

The results contained within this report relate only to the items analyzed

Page 7 of 8

eANALYTICS
L A B O R A T O R Y

Client: Bayswater Exploration

Lab ID: 7661

Project: Mering 13-27

Analysis: Volatile Organics

Method: EPA8260

Sample Name	Benzene % Rec	Toluene % Rec	Ethyl- benzene % Rec	Total Xylenes % Rec	TVPH % Rec	Date Analyzed	Lab ID
Laboratory Control Sample (70-130%)	109	100	96	91	98	10/16/17	LCS 7661 1
Method Blank	<0.001	<0.001	<0.001	<0.001	<0.50	10/16/17	MB 7661 1
	mg/L	mg/L	mg/L	mg/L	mg/L		

eAnalytics Laboratory

4130 Clydesdale Parkway Loveland CO 80538

The results contained within this report relate only to the items analyzed

Test Report

eANALYTICS LABORATORY

October 20, 2017

Client: Bayswater Exploration

Project: Meyring 13 - Creek

Lab ID: 7672

Date Samples Received: 10/19/2017

Number of Samples: 2

Sample Condition: Samples arrived intact and in appropriate sample containers.
Samples were received within the temperature range specified
in the method(s) or with thermal preservation in process.

Comments:

Thank you for allowing eAnalytics Laboratory to provide laboratory services for you.

Christopher Dieken
Quality Assurance Manager

Todd Rhea
Laboratory Manager

eAnalytics Laboratory
4130 Clydesdale Parkway Loveland CO 80538

The results contained within this report relate only to the items analyzed

Page 1 of 5

Chain of Custody

eANALYTICS
LABORATORY

Chain of Custody For

[illegible]

Lab ID # 7072

eAnalytics Laboratory
4130 Clydesdale Parkway Loveland CO 80538
(970) 667-6713

Page of

eAnalytics Laboratory

4130 Clydesdale Parkway Loveland CO 80538

The results contained within this report relate only to the items analyzed

Page 2 of 5

eANALYTICS
LABORATORY

Client: Bayswater Exploration

Lab ID: 7672

Project: Meyring 13 - Creek

Analysis: Volatile Organics

Method: EPA8260

Sample Name	Benzene	Toluene	Ethyl- benzene	Total Xylenes	TVPH	Date Sampled	Date Analyzed	Lab ID	
	mg/L	mg/L	mg/L	mg/L	mg/L				
#1 Creek - Flowline	<0.001	<0.001	<0.001	<0.001	<0.50	10/19/17	10/20/17	7672	1
#2 Creek - 40' South F.L.	<0.001	<0.001	<0.001	<0.001	<0.50	10/19/17	10/20/17	7672	2

eAnalytics Laboratory

4130 Clydesdale Parkway Loveland CO 80538

The results contained within this report relate only to the items analyzed

eANALYTICS
L A B O R A T O R Y

Client: Bayswater Exploration

Lab ID: 7672

Project: Meyring 13 - Creek

Method: EPA8260

Sample Name	Dibromo- fluoromethane % Recovery	1,2 Dichloro- ethane-D4 % Recovery	Toluene-D8 % Recovery	Bromo- fluorobenzene % Recovery	Date Sampled	Date Analyzed	Lab ID
#1 Creek - Flowline	101	99	100	90	10/19/17	10/20/17	7672 1
#2 Creek - 40' South F.L.	103	97	100	89	10/19/17	10/20/17	7672 2

eAnalytics Laboratory

4130 Clydesdale Parkway Loveland CO 80538

The results contained within this report relate only to the items analyzed

eANALYTICS
LABORATORY

Client: Bayswater Exploration

Lab ID: 7672

Project: Meyring 13 - Creek

Analysis: Volatile Organics

Method: EPA8260

Sample Name	Benzene % Rec	Toluene % Rec	Ethyl- benzene % Rec	Total Xylenes % Rec	TVPH % Rec	Date Analyzed	Lab ID
Laboratory Control Sample (70-130%)	101	98	94	86	107	10/20/17	LCS 7672 1
Method Blank	<0.001	<0.001	<0.001	<0.001	<0.50	10/20/17	MB 7672 1
	mg/L	mg/L	mg/L	mg/L	mg/L		

eAnalytics Laboratory

4130 Clydesdale Parkway Loveland CO 80538

The results contained within this report relate only to the items analyzed.

MEYRING 13-27

WEST Dig Site

10/16 117

NORTH

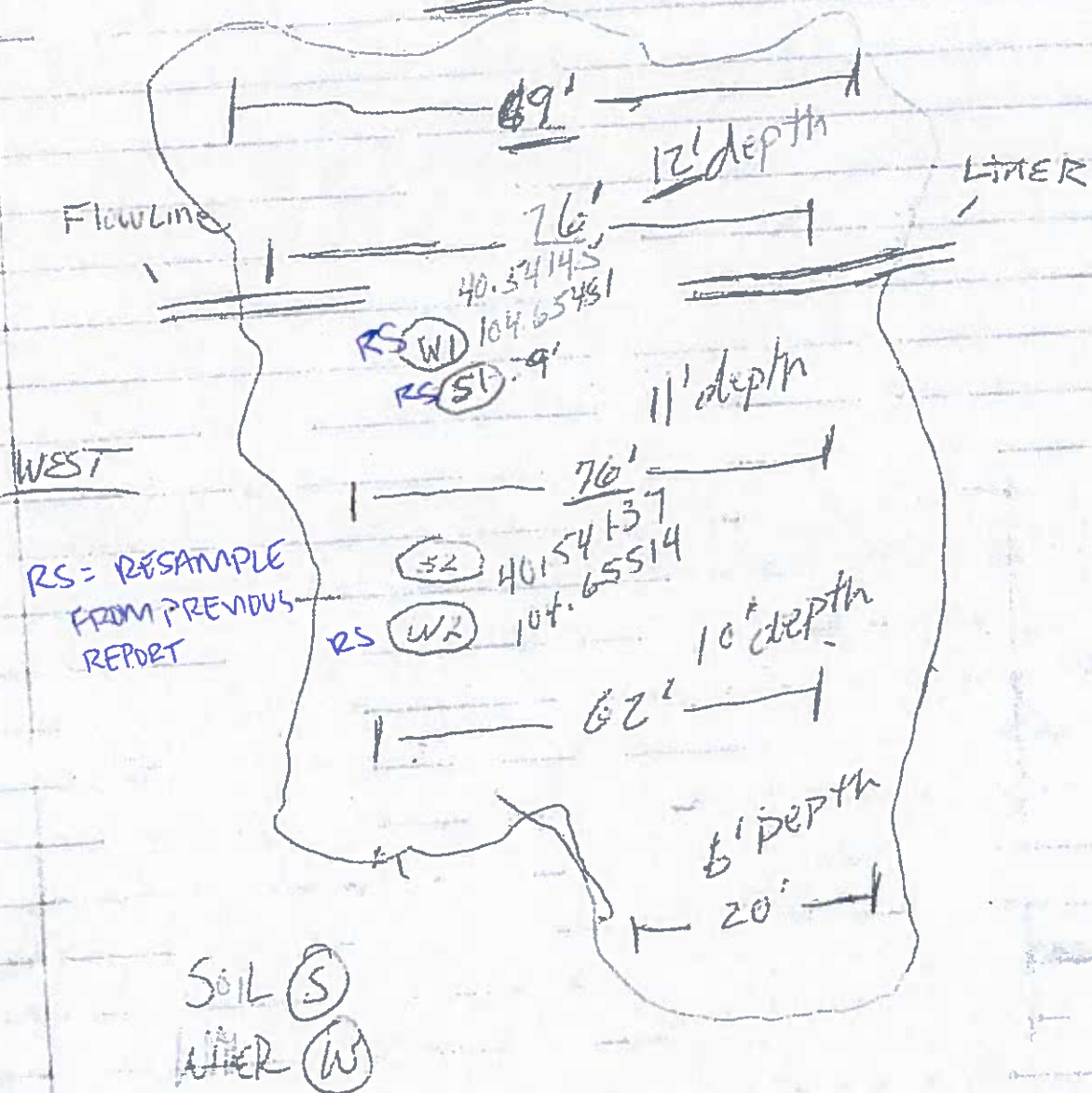

10/16/17

NORTH

Meyring 13-27 CREEK

NORTH

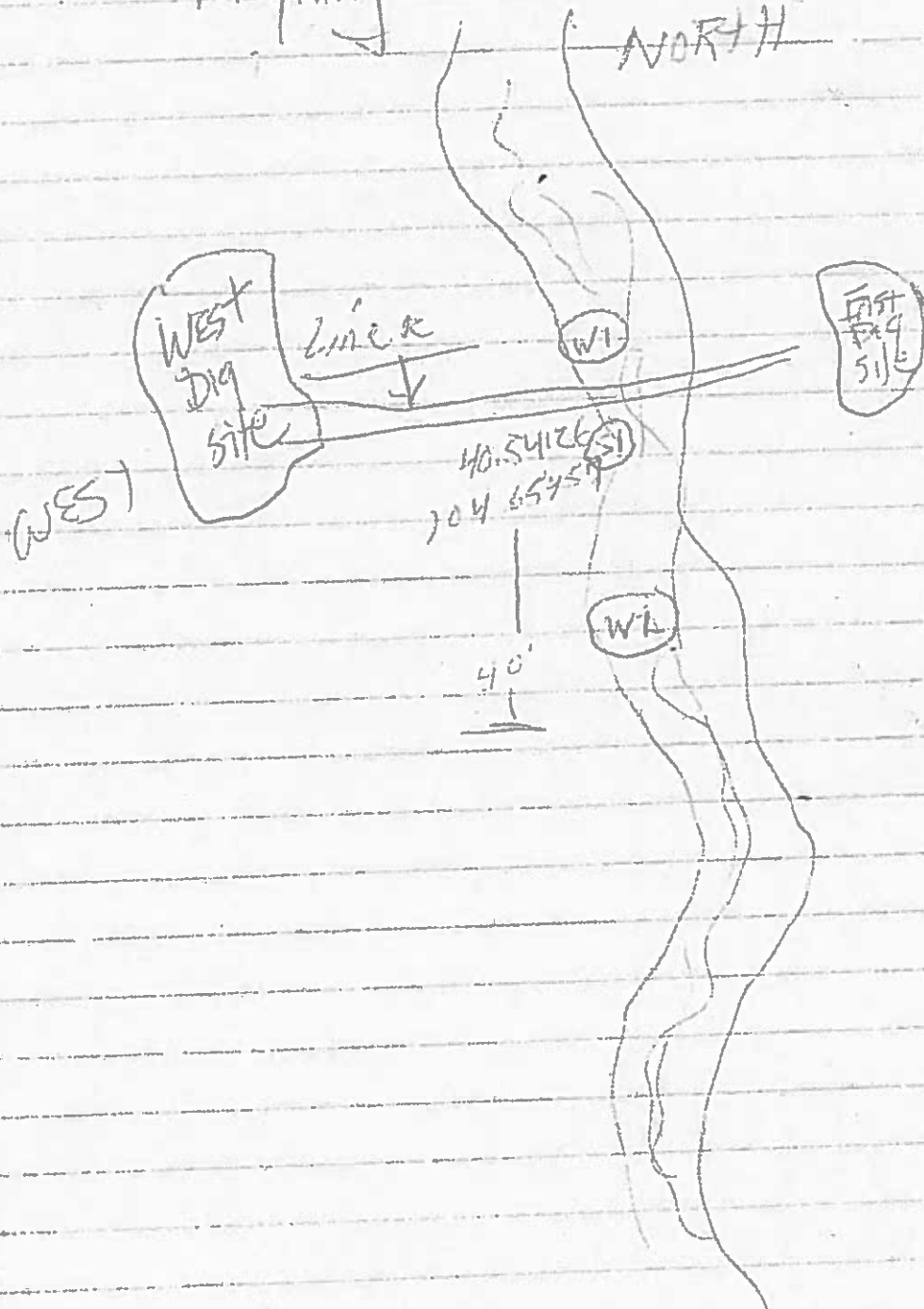

MERING 13-27
EAST SITE
10/16/17

