

Synergy Resources

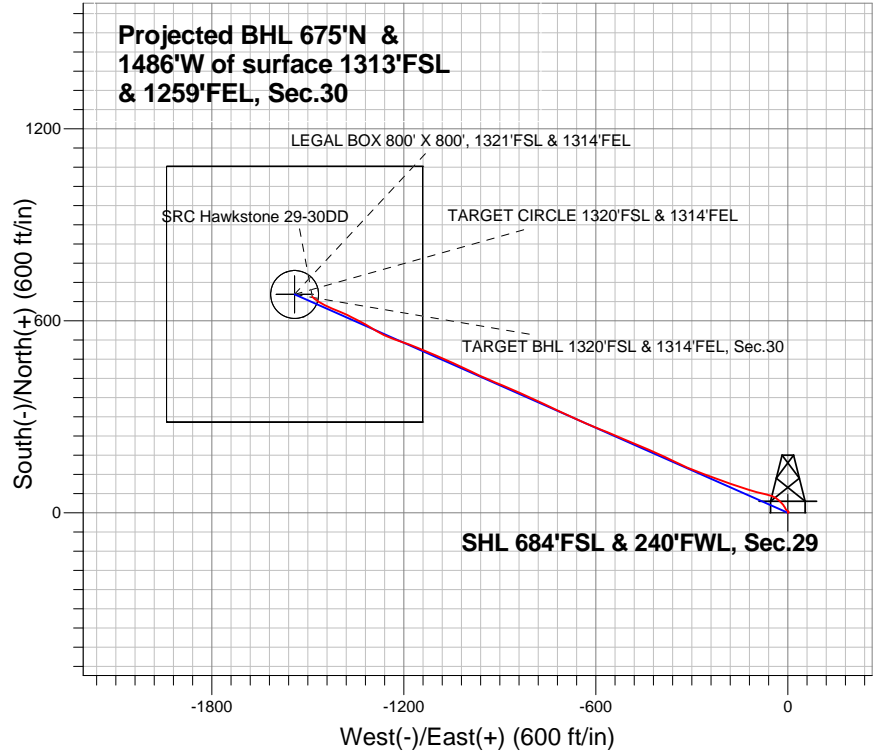
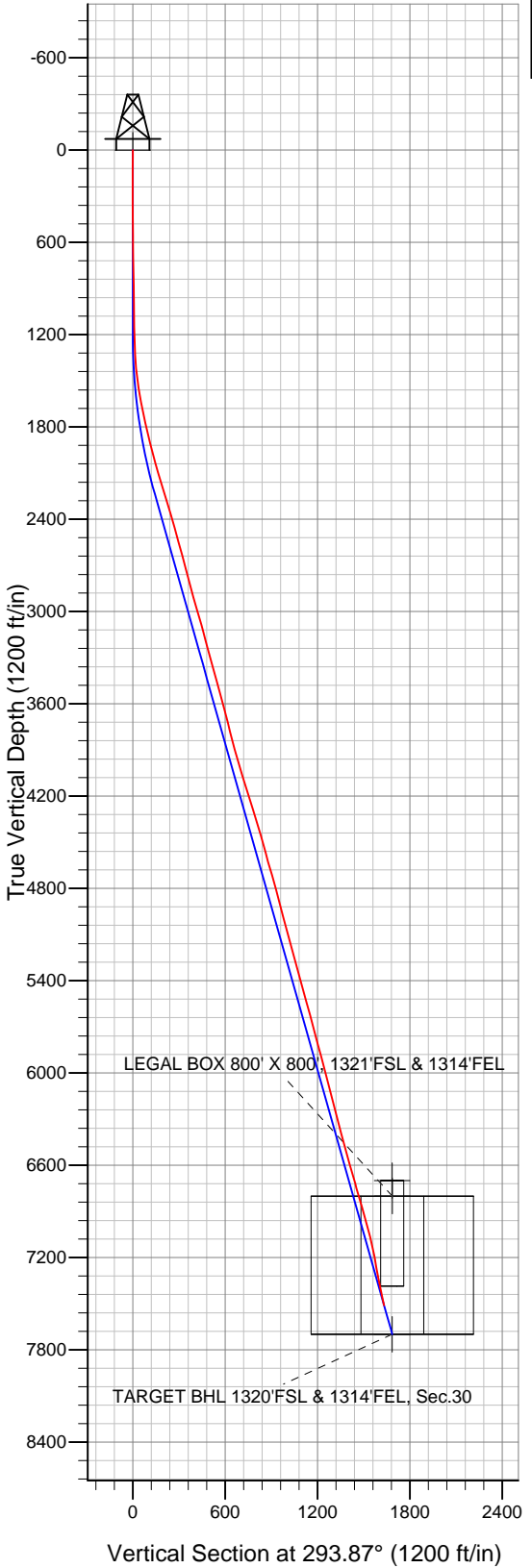

LEGEND

- SRC Hawkstone 29-30DD, Wellbore #1, Plan #4 (5-16-14) V0
- Wellbore #1

Final Survey Plot

Projected Final Survey -
 7725'MD & 7510'TVD @ 1632' VS
 12.3 deg Inc 309.7 deg AZ

Project: SEC.29-T7N-R65W
 Site: SRC Hawkstone 29-30DD Pad Sec.29-T7N-R65W
 Well: SRC Hawkstone 29-30DD
 Plan: Wellbore #1



Synergy Resources

SEC.29-T7N-R65W

SRC Hawkstone 29-30DD Pad Sec.29-T7N-R65W

SRC Hawkstone 29-30DD

Wellbore #1

Design: Wellbore #1

Standard Survey Report

26 August, 2014

Company:	Synergy Resources	Local Co-ordinate Reference:	Well SRC Hawkstone 29-30DD
Project:	SEC.29-T7N-R65W	TVD Reference:	WELL @ 4896.0ft (RKB - 13')
Site:	SRC Hawkstone 29-30DD Pad Sec.29-T7N-R65W	MD Reference:	WELL @ 4896.0ft (RKB - 13')
Well:	SRC Hawkstone 29-30DD	North Reference:	True
Wellbore:	Wellbore #1	Survey Calculation Method:	Minimum Curvature
Design:	Wellbore #1	Database:	Landmark

Project	SEC.29-T7N-R65W, Weld County, CO		
Map System:	US State Plane 1983	System Datum:	Mean Sea Level
Geo Datum:	North American Datum 1983		Using Well Reference Point
Map Zone:	Colorado Northern Zone		Using geodetic scale factor

Site	SRC Hawkstone 29-30DD Pad Sec.29-T7N-R65W				
Site Position:		Northing:	1,440,806.88 ft	Latitude:	40.540633
From:	Lat/Long	Easting:	3,223,505.88 ft	Longitude:	-104.695816
Position Uncertainty:	0.0 ft	Slot Radius:	"	Grid Convergence:	0.52 °

Well	SRC Hawkstone 29-30DD					
Well Position	+N/-S	0.0 ft	Northing:	1,440,800.00 ft	Latitude:	40.540614
	+E/-W	0.0 ft	Easting:	3,223,512.89 ft	Longitude:	-104.695791
Position Uncertainty		0.0 ft	Wellhead Elevation:	ft	Ground Level:	4,883.0 ft

Wellbore	Wellbore #1				
Magnetics	Model Name	Sample Date	Declination (°)	Dip Angle (°)	Field Strength (nT)
	IGRF2010	12/30/2013	8.50	67.09	52,944
	IGRF2010	5/13/2014	8.45	67.07	52,905

Design	Wellbore #1				
Audit Notes:					
Version:	1.0	Phase:	ACTUAL	Tie On Depth:	0.0
Vertical Section:	Depth From (TVD) (ft)	+N/-S (ft)	+E/-W (ft)	Direction (°)	
	0.0	0.0	0.0	293.87	

Survey Program	Date	6/17/2014			
From (ft)	To (ft)	Survey (Wellbore)	Tool Name	Description	
105.0	7,725.0	Survey #1 (Wellbore #1)	MWD	MWD - Standard	

Survey										
Measured Depth (ft)	Inclination (°)	Azimuth (°)	Vertical Depth (ft)	+N/-S (ft)	+E/-W (ft)	Vertical Section (ft)	Dogleg Rate (°/100ft)	Build Rate (°/100ft)	Turn Rate (°/100ft)	
0.0	0.00	0.00	0.0	0.0	0.0	0.0	0.00	0.00	0.00	
1.0	0.01	57.10	1.0	0.0	0.0	0.0	1.24	1.24	0.00	
SHL 684'FSL & 240'FWL, Sec.29										
105.0	1.30	57.10	105.0	0.6	1.0	-0.7	1.24	1.24	0.00	
135.0	1.20	65.40	135.0	1.0	1.6	-1.0	0.69	-0.33	27.67	
166.0	0.60	65.90	166.0	1.2	2.0	-1.4	1.94	-1.94	1.61	
196.0	0.40	20.40	196.0	1.3	2.2	-1.5	1.43	-0.67	-151.67	
226.0	0.30	320.50	226.0	1.5	2.2	-1.4	1.20	-0.33	-199.67	
257.0	0.60	339.40	257.0	1.7	2.1	-1.2	1.07	0.97	60.97	
288.0	0.50	329.60	288.0	2.0	1.9	-1.0	0.44	-0.32	-31.61	
317.0	0.30	347.40	317.0	2.2	1.9	-0.8	0.80	-0.69	61.38	

Company:	Synergy Resources	Local Co-ordinate Reference:	Well SRC Hawkstone 29-30DD
Project:	SEC.29-T7N-R65W	TVD Reference:	WELL @ 4896.0ft (RKB - 13')
Site:	SRC Hawkstone 29-30DD Pad Sec.29-T7N-R65W	MD Reference:	WELL @ 4896.0ft (RKB - 13')
Well:	SRC Hawkstone 29-30DD	North Reference:	True
Wellbore:	Wellbore #1	Survey Calculation Method:	Minimum Curvature
Design:	Wellbore #1	Database:	Landmark

Survey										
Measured Depth (ft)	Inclination (°)	Azimuth (°)	Vertical Depth (ft)	+N/-S (ft)	+E/-W (ft)	Vertical Section (ft)	Dogleg Rate (°/100ft)	Build Rate (°/100ft)	Turn Rate (°/100ft)	
348.0	0.70	339.30	348.0	2.4	1.8	-0.7	1.31	1.29	-26.13	
378.0	0.70	321.50	378.0	2.7	1.6	-0.4	0.72	0.00	-59.33	
409.0	0.50	330.10	409.0	3.0	1.4	-0.1	0.71	-0.65	27.74	
439.0	0.70	330.10	439.0	3.3	1.3	0.2	0.67	0.67	0.00	
469.0	0.60	343.70	469.0	3.6	1.1	0.4	0.61	-0.33	45.33	
529.0	0.60	330.50	529.0	4.1	0.9	0.9	0.23	0.00	-22.00	
559.0	0.90	321.90	559.0	4.5	0.7	1.2	1.07	1.00	-28.67	
610.0	0.70	319.60	610.0	5.0	0.2	1.8	0.40	-0.39	-4.51	
699.0	0.80	304.30	698.9	5.8	-0.7	2.9	0.25	0.11	-17.19	
793.0	1.00	299.40	792.9	6.6	-1.9	4.4	0.23	0.21	-5.21	
888.0	0.90	311.30	887.9	7.5	-3.2	5.9	0.23	-0.11	12.53	
982.0	0.90	311.70	981.9	8.4	-4.3	7.3	0.01	0.00	0.43	
1,076.0	1.00	314.30	1,075.9	9.5	-5.4	8.8	0.12	0.11	2.77	
1,169.0	1.10	308.90	1,168.9	10.6	-6.7	10.4	0.15	0.11	-5.81	
1,264.0	2.20	347.20	1,263.8	13.0	-7.8	12.4	1.58	1.16	40.32	
1,357.0	4.80	328.20	1,356.7	18.0	-10.3	16.7	3.02	2.80	-20.43	
1,452.0	7.50	321.70	1,451.1	26.3	-16.2	25.5	2.93	2.84	-6.84	
1,546.0	8.70	312.60	1,544.2	35.9	-25.2	37.6	1.86	1.28	-9.68	
1,641.0	11.10	304.30	1,637.8	45.9	-38.1	53.4	2.93	2.53	-8.74	
1,736.0	12.80	287.90	1,730.7	54.3	-55.7	72.9	3.98	1.79	-17.26	
1,831.0	13.30	280.20	1,823.3	59.5	-76.4	94.0	1.90	0.53	-8.11	
1,924.0	14.00	283.70	1,913.7	64.0	-97.9	115.4	1.16	0.75	3.76	
2,019.0	14.60	288.80	2,005.7	70.6	-120.4	138.7	1.47	0.63	5.37	
2,114.0	17.20	289.00	2,097.1	79.0	-145.0	164.6	2.74	2.74	0.21	
2,207.0	16.70	288.50	2,186.0	87.8	-170.7	191.6	0.56	-0.54	-0.54	
2,300.0	17.20	290.10	2,275.0	96.7	-196.3	218.6	0.74	0.54	1.72	
2,393.0	16.50	289.90	2,364.0	106.0	-221.6	245.5	0.76	-0.75	-0.22	
2,487.0	15.70	289.30	2,454.3	114.7	-246.2	271.5	0.87	-0.85	-0.64	
2,582.0	15.50	290.80	2,545.8	123.5	-270.2	297.0	0.47	-0.21	1.58	
2,675.0	14.90	292.20	2,635.6	132.4	-292.8	321.4	0.76	-0.65	1.51	
2,769.0	15.10	293.90	2,726.4	141.9	-315.2	345.7	0.51	0.21	1.81	
2,862.0	14.70	294.80	2,816.2	151.8	-337.0	369.6	0.50	-0.43	0.97	
2,955.0	15.50	295.30	2,906.0	162.0	-359.0	393.8	0.87	0.86	0.54	
3,049.0	16.40	295.10	2,996.4	173.0	-382.3	419.7	0.96	0.96	-0.21	
3,144.0	16.00	294.40	3,087.6	184.1	-406.4	446.2	0.47	-0.42	-0.74	
3,239.0	14.20	295.00	3,179.3	194.5	-428.9	470.9	1.90	-1.89	0.63	
3,332.0	15.40	292.90	3,269.3	204.1	-450.6	494.6	1.41	1.29	-2.26	
3,426.0	15.40	291.60	3,359.9	213.5	-473.7	519.6	0.37	0.00	-1.38	
3,522.0	15.40	292.50	3,452.4	223.1	-497.3	545.1	0.25	0.00	0.94	
3,617.0	15.00	293.60	3,544.1	232.9	-520.3	570.0	0.52	-0.42	1.16	
3,709.0	14.90	293.90	3,633.0	242.4	-542.0	593.7	0.14	-0.11	0.33	
3,804.0	14.60	291.50	3,724.9	251.8	-564.3	617.9	0.72	-0.32	-2.53	
3,898.0	14.30	292.50	3,815.9	260.5	-586.0	641.3	0.42	-0.32	1.06	
3,993.0	15.20	292.70	3,907.8	269.8	-608.4	665.5	0.95	0.95	0.21	
4,087.0	16.30	293.20	3,998.2	279.8	-631.9	691.0	1.18	1.17	0.53	
4,182.0	17.10	294.10	4,089.2	290.7	-656.9	718.3	0.88	0.84	0.95	
4,275.0	17.90	294.40	4,177.9	302.2	-682.4	746.3	0.87	0.86	0.32	
4,370.0	17.80	295.10	4,268.3	314.4	-708.8	775.4	0.25	-0.11	0.74	
4,465.0	16.80	295.90	4,359.0	326.6	-734.3	803.6	1.08	-1.05	0.84	
4,557.0	16.10	295.50	4,447.3	337.9	-757.8	829.7	0.77	-0.76	-0.43	
4,649.0	14.90	294.80	4,535.9	348.3	-780.0	854.3	1.32	-1.30	-0.76	
4,743.0	15.70	294.10	4,626.6	358.6	-802.6	879.1	0.87	0.85	-0.74	
4,836.0	16.10	293.90	4,716.0	369.0	-825.9	904.5	0.43	0.43	-0.22	

Company:	Synergy Resources	Local Co-ordinate Reference:	Well SRC Hawkstone 29-30DD
Project:	SEC.29-T7N-R65W	TVD Reference:	WELL @ 4896.0ft (RKB - 13')
Site:	SRC Hawkstone 29-30DD Pad Sec.29-T7N-R65W	MD Reference:	WELL @ 4896.0ft (RKB - 13')
Well:	SRC Hawkstone 29-30DD	North Reference:	True
Wellbore:	Wellbore #1	Survey Calculation Method:	Minimum Curvature
Design:	Wellbore #1	Database:	Landmark

Measured Depth (ft)	Inclination (°)	Azimuth (°)	Vertical Depth (ft)	+N/-S (ft)	+E/-W (ft)	Vertical Section (ft)	Dogleg Rate (°/100ft)	Build Rate (°/100ft)	Turn Rate (°/100ft)
4,933.0	15.50	293.70	4,809.4	379.6	-850.0	931.0	0.62	-0.62	-0.21
5,027.0	14.00	294.40	4,900.3	389.4	-871.9	954.9	1.61	-1.60	0.74
5,120.0	14.50	292.70	4,990.4	398.5	-892.9	977.8	0.70	0.54	-1.83
5,215.0	16.40	292.90	5,082.0	408.3	-916.2	1,003.1	2.00	2.00	0.21
5,308.0	15.10	292.70	5,171.5	418.1	-939.5	1,028.3	1.40	-1.40	-0.22
5,404.0	15.70	295.10	5,264.0	428.4	-962.8	1,053.8	0.91	0.63	2.50
5,498.0	14.40	295.70	5,354.8	438.9	-984.8	1,078.2	1.39	-1.38	0.64
5,592.0	15.20	295.70	5,445.7	449.3	-1,006.5	1,102.2	0.85	0.85	0.00
5,686.0	15.80	294.30	5,536.3	459.9	-1,029.2	1,127.3	0.75	0.64	-1.49
5,778.0	15.40	295.10	5,624.9	470.2	-1,051.7	1,152.1	0.49	-0.43	0.87
5,873.0	14.50	295.10	5,716.7	480.6	-1,073.9	1,176.6	0.95	-0.95	0.00
5,967.0	15.30	293.00	5,807.5	490.5	-1,096.0	1,200.7	1.03	0.85	-2.23
6,061.0	14.90	290.20	5,898.3	499.5	-1,118.7	1,225.2	0.88	-0.43	-2.98
6,156.0	14.90	292.70	5,990.1	508.4	-1,141.5	1,249.6	0.68	0.00	2.63
6,251.0	14.10	292.90	6,082.0	517.6	-1,163.4	1,273.4	0.84	-0.84	0.21
6,344.0	14.10	290.80	6,172.2	526.1	-1,184.4	1,296.0	0.55	0.00	-2.26
6,438.0	15.10	288.30	6,263.2	534.0	-1,206.8	1,319.6	1.26	1.06	-2.66
6,530.0	15.20	290.80	6,352.0	542.0	-1,229.4	1,343.6	0.72	0.11	2.72
6,625.0	14.90	291.30	6,443.7	550.9	-1,252.4	1,368.2	0.34	-0.32	0.53
6,720.0	14.90	301.30	6,535.6	561.7	-1,274.3	1,392.5	2.70	0.00	10.53
6,815.0	17.30	299.40	6,626.8	575.0	-1,297.0	1,418.7	2.59	2.53	-2.00
6,909.0	14.90	299.90	6,717.1	587.8	-1,319.7	1,444.7	2.56	-2.55	0.53
7,003.0	17.20	298.00	6,807.5	600.4	-1,342.4	1,470.5	2.51	2.45	-2.02
7,055.9	16.09	297.00	6,858.2	607.4	-1,355.9	1,485.7	2.16	-2.09	-1.88
LEGAL BOX 800' X 800', 1321'FSL & 1314'FEL									
7,094.0	15.30	296.20	6,894.8	612.0	-1,365.1	1,496.0	2.16	-2.08	-2.11
7,189.0	14.90	294.30	6,986.6	622.6	-1,387.4	1,520.7	0.67	-0.42	-2.00
7,282.0	14.80	292.00	7,076.5	631.9	-1,409.3	1,544.5	0.64	-0.11	-2.47
7,376.0	10.30	293.60	7,168.2	639.8	-1,428.2	1,564.9	4.80	-4.79	1.70
7,471.0	10.10	296.40	7,261.7	646.9	-1,443.4	1,581.8	0.56	-0.21	2.95
7,565.0	11.80	298.80	7,354.0	655.2	-1,459.2	1,599.6	1.87	1.81	2.55
7,683.0	12.30	309.70	7,469.4	669.1	-1,479.5	1,623.7	1.97	0.42	9.24
7,725.0	12.30	309.70	7,510.4	674.8	-1,486.4	1,632.3	0.00	0.00	0.00
TARGET BHL 1320'FSL & 1314'FEL, Sec.30									

Checked By: _____ Approved By: _____ Date: _____