



October 6, 2017

Mr. Matt Lepore, Director
Colorado Oil and Gas Conservation Commission
1120 Lincoln Street, Suite 801
Denver, Colorado 80203

**RE: COGCC Rule 318A.e.: Proposed Spacing Unit
G & D Hanks O-27-28HN Well: SWSE Section 27, Township 7 North, Range 66 West
Weld County, Colorado**

Dear Mr. Lepore:

Bayswater Exploration & Production, LLC (Bayswater) is planning to drill the above referenced well in accordance with the provisions set out in Colorado Oil and Gas Conservation Commission (COGCC) Rule 318A.e. Bayswater's Proposed Spacing Unit consists of:

N $\frac{1}{2}$ S $\frac{1}{2}$ of Section 27 & 28, Township 7 North, Range 66 West
NE $\frac{1}{4}$ SE $\frac{1}{4}$ of Section 29, Township 7 North, Range 66 West
Containing 360.00 acres, more or less

Bayswater is not the only owner within the Proposed Spacing Unit and has provided notice to the remaining owners, as required by COGCC Rule 318A.e.(6). Copies of the required notification letters are on file at Bayswater's office. The required thirty (30) day notice period has elapsed absent the receipt by Bayswater of any objection to their proposal by the owners within the Proposed Spacing Unit for the subject well.

Enclosed is the Proposed Spacing Unit Exhibit to assist in your review and approval of Bayswater's proposed Application for Permit to Drill for the G & D Hanks O-27-28HN Well. Many thanks for your attention to this matter.

Respectfully,

A handwritten signature in blue ink, appearing to read 'Jeff Annable', written over a light blue circular stamp.

Jeff Annable
Regulatory Analyst
Agent for Bayswater Exploration & Production, LLC

:ja

Enclosure: Proposed Spacing Unit Exhibit

G & D HANKS 27-N PAD
PROPOSED 318A.a.(4)D. SPACING UNIT
SEC 27, T7N, R66W: N2S2
SEC 28, T7N, R66W: N2S2
SEC 29, T7N, R66W: NE4SE4

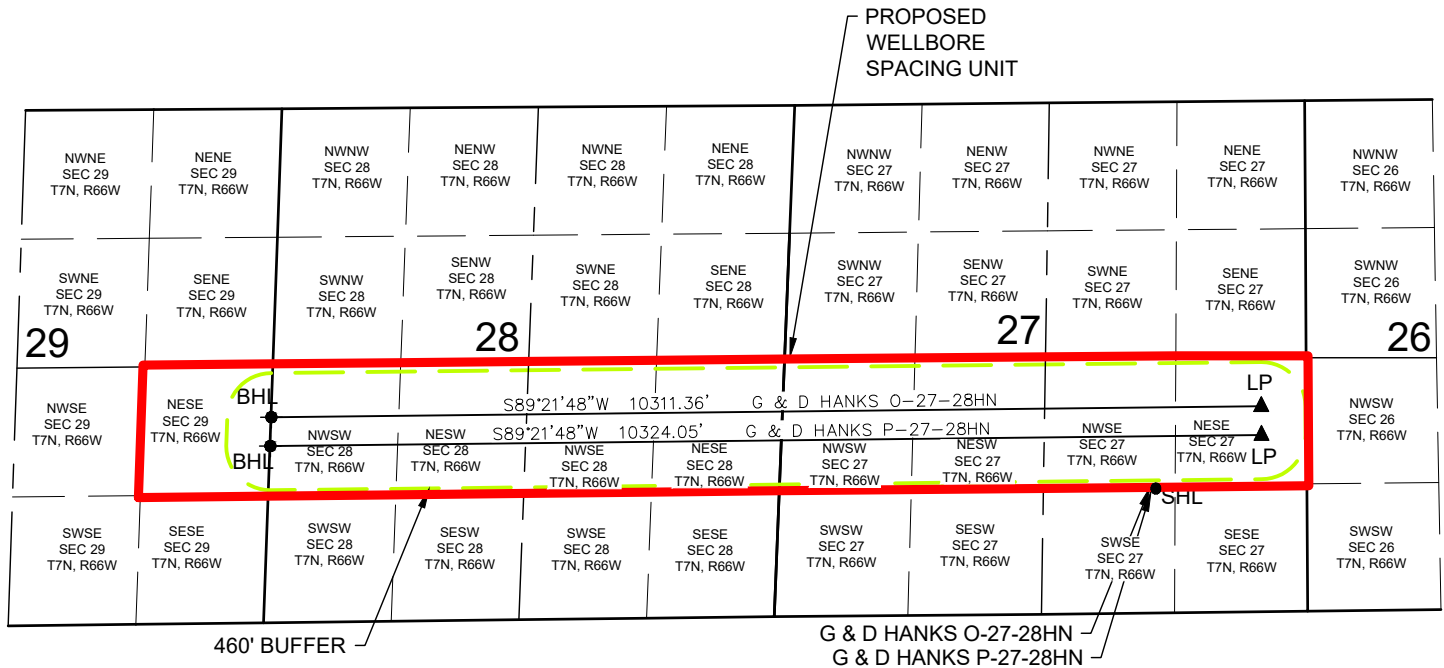

G & D HANKS O-27-28HN WELL TO BE LOCATED 1303' FSL AND 1574' FEL, SEC 27, T7N, R66W
G & D HANKS P-27-28HN WELL TO BE LOCATED 1288' FSL AND 1574' FEL, SEC 27, T7N, R66W

LEGEND

- = PROPOSED WELL
- = BOTTOM HOLE
- ▲ = LANDING POINT
- SHL = SURFACE HOLE LOCATION
- BHL = BOTTOM HOLE LOCATION
- LP = LANDING POINT

DISCLAIMER:
THIS PLOT DOES NOT REPRESENT A MONUMENTED LAND SURVEY AND SHOULD NOT BE
RELIED UPON TO DETERMINE BOUNDARY LINES, PROPERTY OWNERSHIP OR OTHER
PROPERTY INTERESTS. PARCEL LINES, IF DEPICTED HAVE NOT BEEN FIELD VERIFIED AND
MAY BE BASED UPON PUBLICLY AVAILABLE DATA THAT ALSO HAS NOT BEEN
INDEPENDENTLY VERIFIED.

