

G & D HANKS 27-N PAD MULTI-WELL PLAN

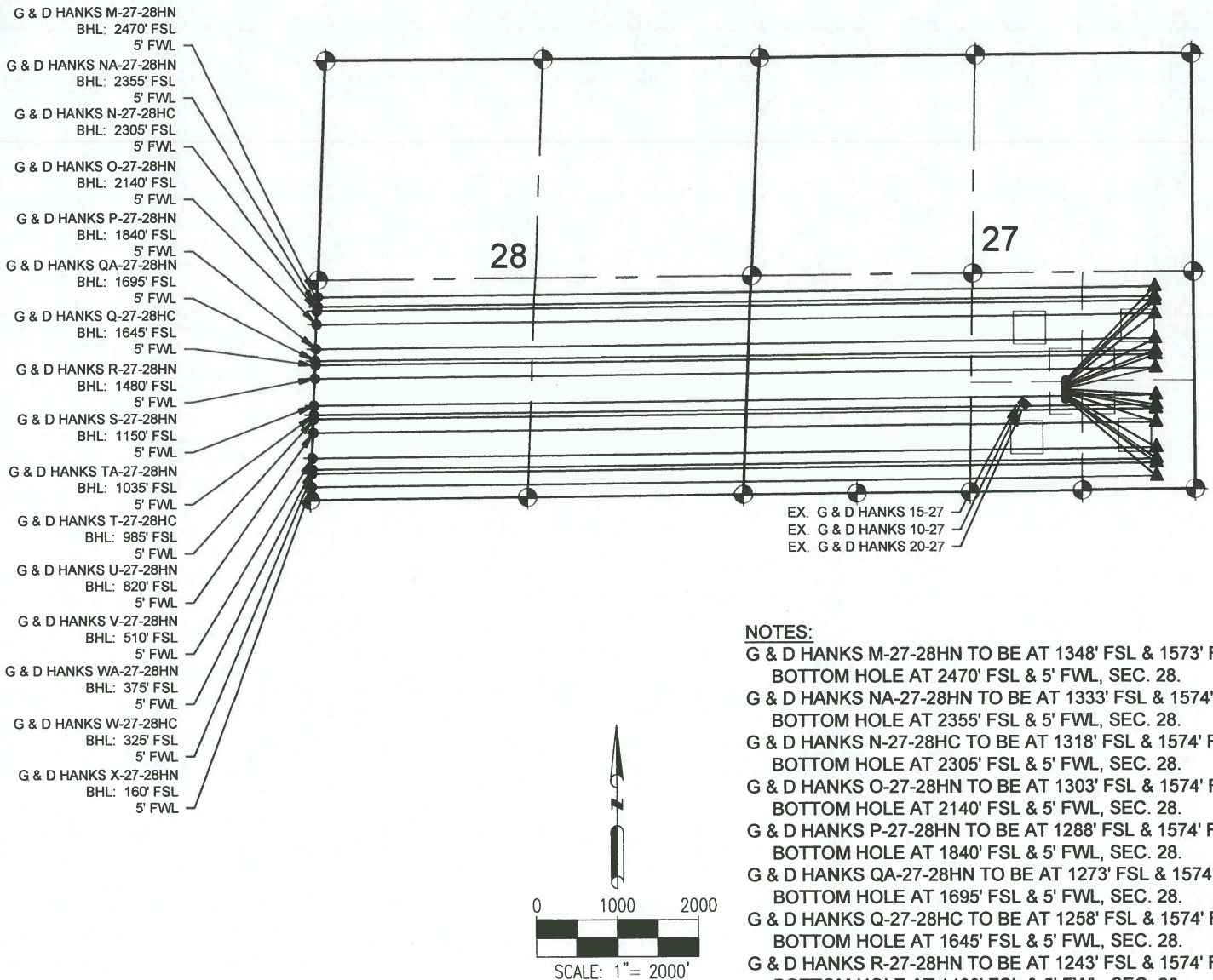

NOTES:

G & D HANKS M-27-28HN TO BE AT 1348' FSL & 1573' FEL.
 BOTTOM HOLE AT 2470' FSL & 5' FWL, SEC. 28.
 G & D HANKS NA-27-28HN TO BE AT 1333' FSL & 1574' FEL.
 BOTTOM HOLE AT 2355' FSL & 5' FWL, SEC. 28.
 G & D HANKS N-27-28HC TO BE AT 1318' FSL & 1574' FEL.
 BOTTOM HOLE AT 2305' FSL & 5' FWL, SEC. 28.
 G & D HANKS O-27-28HN TO BE AT 1303' FSL & 1574' FEL.
 BOTTOM HOLE AT 2140' FSL & 5' FWL, SEC. 28.
 G & D HANKS P-27-28HN TO BE AT 1288' FSL & 1574' FEL.
 BOTTOM HOLE AT 1840' FSL & 5' FWL, SEC. 28.
 G & D HANKS QA-27-28HN TO BE AT 1273' FSL & 1574' FEL.
 BOTTOM HOLE AT 1695' FSL & 5' FWL, SEC. 28.
 G & D HANKS Q-27-28HC TO BE AT 1258' FSL & 1574' FEL.
 BOTTOM HOLE AT 1645' FSL & 5' FWL, SEC. 28.
 G & D HANKS R-27-28HN TO BE AT 1243' FSL & 1574' FEL.
 BOTTOM HOLE AT 1480' FSL & 5' FWL, SEC. 28.
 G & D HANKS S-27-28HN TO BE AT 1228' FSL & 1575' FEL.
 BOTTOM HOLE AT 1150' FSL & 5' FWL, SEC. 28.
 G & D HANKS TA-27-28HN TO BE AT 1213' FSL & 1575' FEL.
 BOTTOM HOLE AT 1035' FSL & 5' FWL, SEC. 28.
 G & D HANKS T-27-28HC TO BE AT 1198' FSL & 1575' FEL.
 BOTTOM HOLE AT 985' FSL & 5' FWL, SEC. 28.
 G & D HANKS U-27-28HN TO BE AT 1183' FSL & 1575' FEL.
 BOTTOM HOLE AT 820' FSL & 5' FWL, SEC. 28.
 G & D HANKS V-27-28HN TO BE AT 1168' FSL & 1575' FEL.
 BOTTOM HOLE AT 510' FSL & 5' FWL, SEC. 28.
 G & D HANKS WA-27-28HN TO BE AT 1153' FSL & 1575' FEL.
 BOTTOM HOLE AT 375' FSL & 5' FWL, SEC. 28.
 G & D HANKS W-27-28HC TO BE AT 1138' FSL & 1575' FEL.
 BOTTOM HOLE AT 325' FSL & 5' FWL, SEC. 28.
 G & D HANKS X-27-28HN TO BE AT 1123' FSL & 1575' FEL.
 BOTTOM HOLE AT 160' FSL & 5' FWL, SEC. 28.

LEGEND

● = EXISTING MONUMENT ◆ = BOTTOM HOLE
 ○ = CALCULATED POSITION ▲ = LANDING POINT
 ● = PROPOSED WELL LP = LANDING POINT
 ◆ = EXISTING WELL BHL = BOTTOM HOLE LOCATION

NOTES:

1. THIS FIELD SURVEY CONFORMS TO THE MINIMUM STANDARDS SET BY THE C.O.G.C.C., RULE NO. 215

DISCLAIMER:

THIS PLOT DOES NOT REPRESENT A MONUMENTED LAND SURVEY AND SHOULD NOT BE RELIED UPON TO DETERMINE BOUNDARY LINES, PROPERTY OWNERSHIP OR OTHER PROPERTY INTERESTS. PARCEL LINES, IF DEPICTED HAVE NOT BEEN FIELD VERIFIED AND MAY BE BASED UPON PUBLICLY AVAILABLE DATA THAT ALSO HAS NOT BEEN INDEPENDENTLY VERIFIED.

EX. WELL G & D HANKS 15-27 IS AT 1080' FSL & 2111' FEL.
 EX. WELL G & D HANKS 10-27 IS AT 1067' FSL & 2094' FEL.
 EX. WELL G & D HANKS 20-27 IS AT 1057' FSL & 2073' FEL.



7535 Hilltop Circle
 Denver, CO 80221
 (303) 928-7128
 www.ascentgeomatics.com

FIELD DATE:

08-18-17

DRAWING DATE:

08-28-17

BY:

MMP

CHECKED BY:

KAD

SITE NAME:

G & D HANKS 27-N PAD

SURFACE LOCATION:

SW 1/4 SE 1/4 SEC. 27, T7N, R66W, 6TH P.M.

WELD COUNTY, COLORADO

PREPARED FOR:



BAYSWATER
 EXPLORATION AND PRODUCTION, LLC