

NOTES:

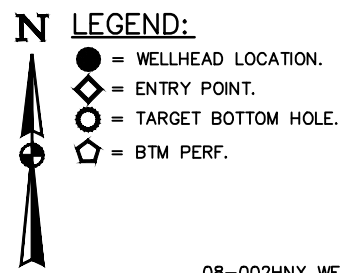

08-002HNX WELLHEAD LOCATION

08-002HN WELLHEAD LOCATION

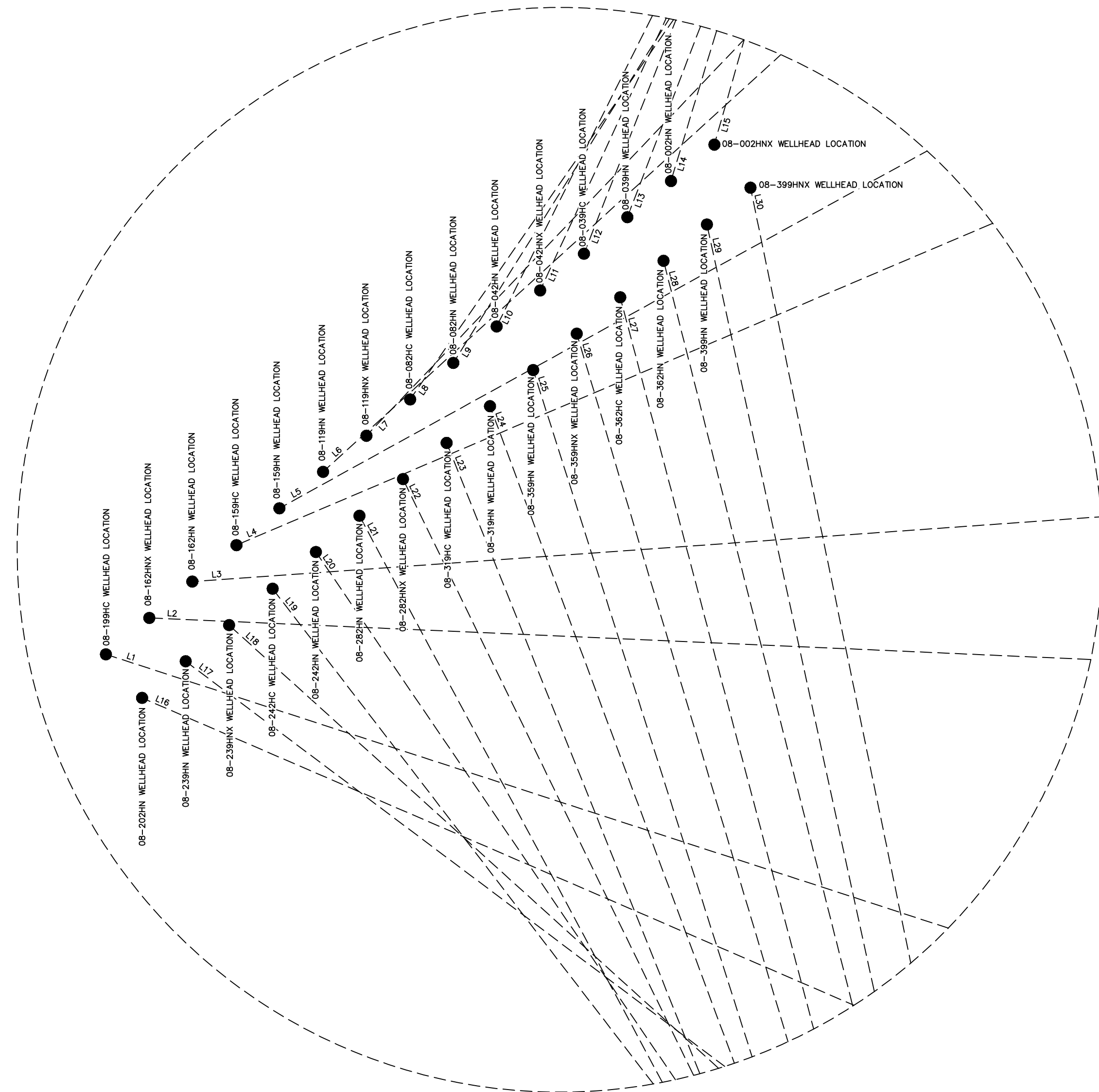

Detail "A"
No Scale

LINE	DIRECTION	LENGTH
L1	S71°59'41"E	842.08'
L2	S87°28'03"E	789.89'
L3	N85°55'04"E	779.65'
L4	N66°56'45"E	832.17'
L5	N61°06'47"E	861.44'
L6	N47°39'35"E	1004.46'
L7	N43°37'08"E	1059.48'
L8	N34°43'35"E	1262.24'
L9	N32°06'11"E	1331.35'
L10	N26°37'20"E	1552.78'
L11	N24°49'52"E	1629.24'
L12	N21°28'37"E	1836.47'
L13	N20°57'45"E	1847.30'
L14	N16°52'16"E	2236.00'
L15	N15°51'32"E	2334.00'
L16	S66°38'37"E	862.00'
L17	S53°03'52"E	975.90'
L18	S47°50'23"E	1036.94'
L19	S37°32'24"E	1243.04'
L20	S34°15'31"E	1325.29'
L21	S28°07'14"E	1558.95'
L22	S25°58'35"E	1651.48'
L23	S21°52'05"E	1911.78'
L24	S20°24'06"E	2010.02'
L25	S17°40'40"E	2270.74'
L26	S16°36'37"E	2372.11'
L27	S14°48'22"E	2609.40'
L28	S14°14'36"E	2663.80'
L29	S12°18'42"E	3021.52'
L30	S11°40'48"E	3125.99'

LINE	DIRECTION	LENGTH
L31	N89°53'33"E	100.00'
L32	N89°53'33"E	100.00'
L33	N89°53'33"E	100.00'
L34	N89°53'34"E	100.00'
L35	N89°53'34"E	100.00'
L36	N89°53'35"E	100.00'
L37	N89°53'35"E	100.00'
L38	N89°53'35"E	100.00'
L39	N89°53'35"E	100.00'
L40	N89°53'36"E	100.00'
L41	N89°53'36"E	100.00'
L42	N89°53'36"E	100.00'
L43	N89°53'37"E	100.00'
L44	N89°53'37"E	100.00'
L45	N89°53'38"E	100.00'
L46	N89°55'26"E	100.00'
L47	N89°55'26"E	100.00'
L48	N89°55'26"E	100.00'
L49	N89°55'26"E	100.00'
L50	N89°55'26"E	100.00'
L51	N89°55'26"E	100.00'
L52	N89°55'26"E	100.00'
L53	N89°55'26"E	100.00'
L54	N89°55'26"E	100.00'
L55	N89°55'26"E	100.00'
L56	N89°55'26"E	100.00'
L57	N89°55'26"E	100.00'
L58	N89°55'26"E	100.00'
L59	N89°55'26"E	100.00'
L60	N89°55'26"E	100.00'

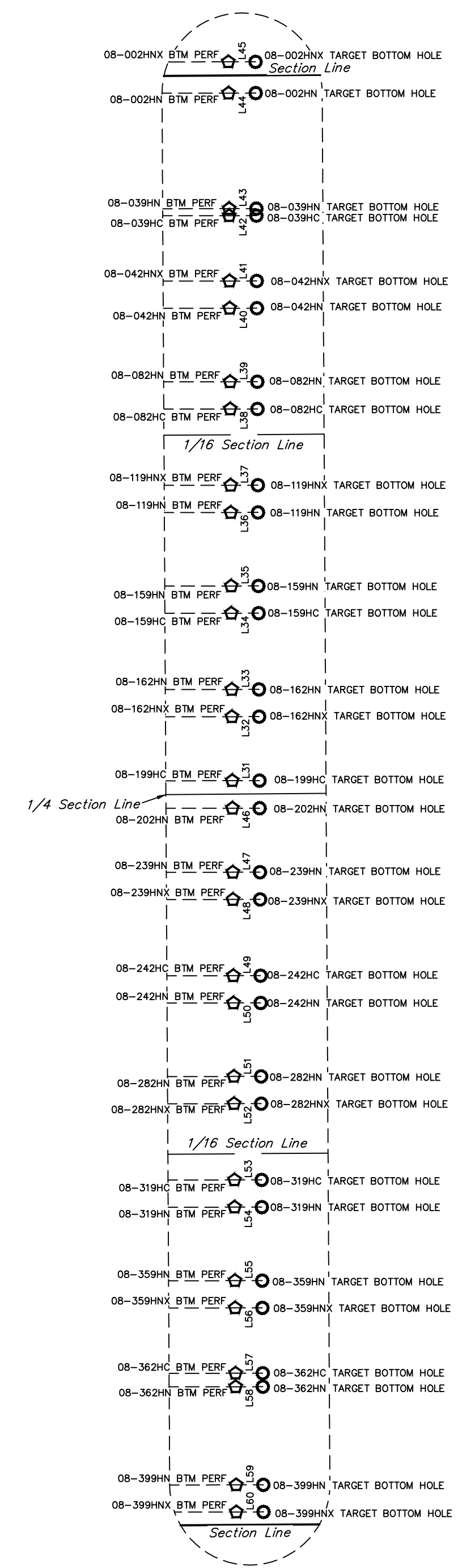

Detail "B"
No Scale

NOTES:

GREAT WESTERN OPERATING COMPANY

UINTEA
ENGINEERING & LAND SURVEYING

UELS, LLC
Corporate Office * 85 South 200 East
Vernal, UT 84078 * (435) 789-1017

BRANT LD PAD
SE 1/4 NE 1/4, SECTION 11, T1S, R67W, 6th P.M.
ADAMS COUNTY, COLORADO

SURVEYED BY	CHAD MEIERS, D.N.	02-14-17	SCALE
DRAWN BY	K.B.	06-30-17	1" = 1000'

MULTI-WELL PLAN **FIGURE #5**