



99999999

(06906014)

R. 68W

RECEIVED

FEB 20 1969

COLO. OIL & GAS CONS. COMM.

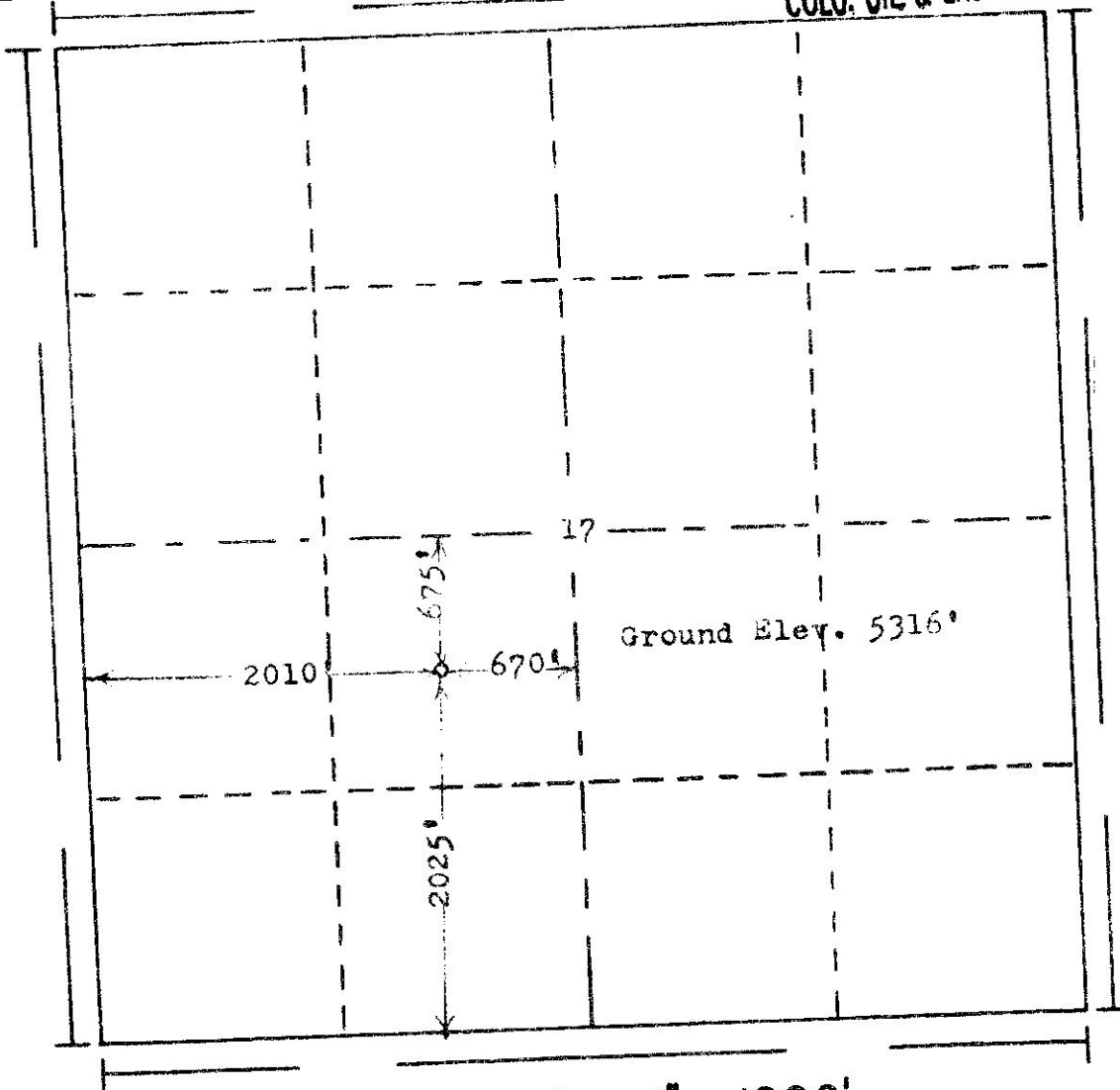

Scale... 1" = 1000'

Powers Elevation Company, Inc. of Denver, Colorado  
has in accordance with a request from Mr. Pomeroy  
for Occidental Petroleum Co.

determined the location of No.1 Elder

to be CNE SW Section 17 Township 9N  
Range 68W of the 6th Principal Meridian  
Barmer County, Colorado

I hereby certify that this plat is an  
accurate representation of a correct  
survey showing the location of

Date 2-1-69



00222022

Barney D. Hall  
Licensed Land Surveyor No. 2853  
State of Colorado