

WIGEON FED PAD LOCATION DRAWING

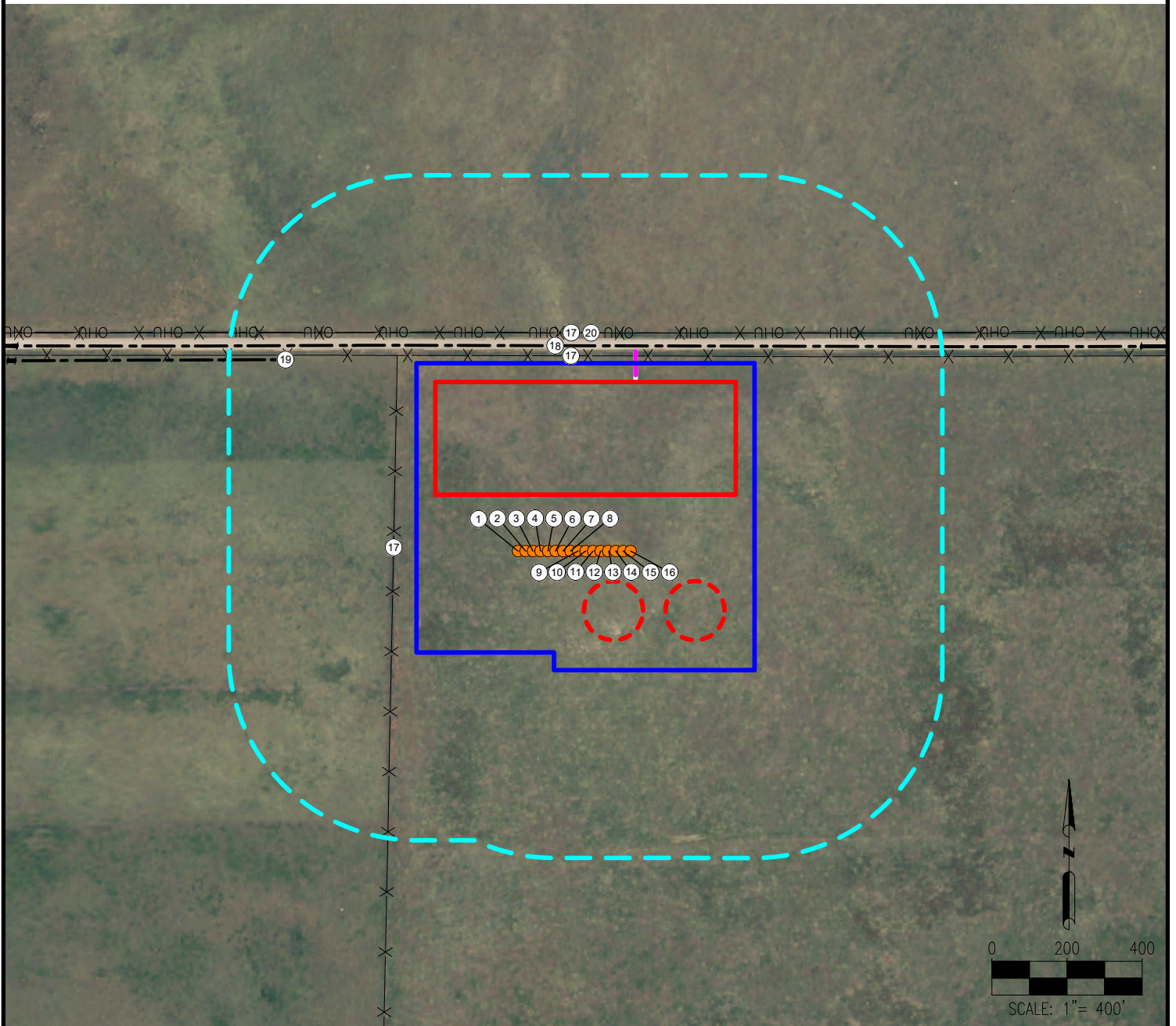

- | | | | |
|-------------------------|---------------------------|------------------------------------------|---------------------------------|
| 1. WIGEON FED 33-28-1HN | 7. WIGEON FED 33-28-7HN | 13. WIGEON FED 33-28-13HN | 19. PRIVATE ROAD IS ±914' NW |
| 2. WIGEON FED 33-28-2HC | 8. WIGEON FED 33-28-8HN | 14. WIGEON FED 33-28-14HN | 20. OVERHEAD UTILITY IS ±581' N |
| 3. WIGEON FED 33-28-3HN | 9. WIGEON FED 33-28-9HN | 15. WIGEON FED 33-28-15HC | |
| 4. WIGEON FED 33-28-4HN | 10. WIGEON FED 33-28-10HN | 16. WIGEON FED 33-28-16HN | |
| 5. WIGEON FED 33-28-5HN | 11. WIGEON FED 33-28-11HC | 17. FENCES ARE ±471' W, ±520' N, ±581' N | |
| 6. WIGEON FED 33-28-6HC | 12. WIGEON FED 33-28-12HN | 18. COUNTY ROAD 86 IS ±535' N | |

LEGEND:

- | | |
|----------------------------------------------------------------------------------------------------------------------------------------------------------------------------------------|---------------------------------------------------------------------------------------------------------------------------------------------------------------------------------------------|
| <ul style="list-style-type: none"> ● = PROPOSED WELL = EXISTING ROAD = FENCE = OHU = OVERHEAD UTILITY | <ul style="list-style-type: none"> = PROPOSED ACCESS ROAD = DISTURBANCE AREA = PROPOSED FACILITY BERM = PROPOSED MLVT = 500' RADIUS |
|----------------------------------------------------------------------------------------------------------------------------------------------------------------------------------------|---------------------------------------------------------------------------------------------------------------------------------------------------------------------------------------------|

MEASURED FROM NEAREST WELL OR FACILITY:	
BUILDING	±5280' W
BUILDING UNIT	±5280' W
PUBLIC ROAD (WELD COUNTY ROAD 86)	±83' N
PROPERTY LINE (KATHLEEN & MYRON)	±29' W
UTILITY (POWERLINE)	±131' N
RAILROAD	+5280' S
MEASURED FROM NEAREST EDGE OF DISTURBANCE:	
SURFACE WATER (WETLAND)	±1118' S

REFERENCE LOCATION

****WIGEON FED 33-28-8HN****

LAT: 40.609984° N
 LONG: 104.095904° W
 ELEVATION: 4955'
 550' FNL & 2184' FEL
 PDOP: 1.6
 GPS OPERATOR: IAN CARABAJAL

DISCLAIMER:
 THIS PLOT DOES NOT REPRESENT A MONUMENTED LAND SURVEY AND SHOULD NOT BE RELIED UPON TO DETERMINE BOUNDARY LINES, PROPERTY OWNERSHIP OR OTHER PROPERTY INTERESTS. PARCEL LINES, IF DEPICTED HAVE NOT BEEN FIELD VERIFIED AND MAY BE BASED UPON PUBLICLY AVAILABLE DATA THAT ALSO HAS NOT BEEN INDEPENDENTLY VERIFIED.

DATA SOURCE:
 AERIAL IMAGERY: NAIP 2015
 WATER WELLS: COLORADO DWR
 NHD: USGS

PUBLICLY AVAILABLE DATA SOURCES HAVE NOT BEEN INDEPENDENTLY VERIFIED BY ASCENT.

MEASURED FROM NEAREST EDGE OF DISTURBANCE:	
WATER WELL	±2365' E SWL = 0'
PERMIT: 50243-MH	RECEIPT: 0050243
WATER WELL	±5280' NW SWL = 175'
PERMIT: 69080	RECEIPT: 9065171

DISTURBANCE ACREAGE:
 16.5 ACRES DRILLING OPERATIONS
 9.9 ACRES INTERIM RECLAIM

CURRENT SURFACE USE: RANGELAND
 FUTURE SURFACE USE: RANGELAND

7535 Hilltop Circle
 Denver, CO 80221
 (303) 928-7128
 www.ascentgeomatics.com

FIELD DATE:
09-06-17

DRAWING DATE:
09-11-17

BY:
DJP

CHECKED:
RMC

SITE NAME:
WIGEON FED PAD

SURFACE LOCATION:
**LOT 2 SEC. 4, T7N, R60W, 6TH P.M.
 WELD COUNTY, COLORADO**

PREPARED FOR: