

SRC ENERGY

Location: COLORADO Slot: SLOT#13 DONN 30N-20A-L (738°FNL & 250°FEL, SEC.21)
Field: WELD COUNTY (NAD83, TRUE NORTH) Well: DONN 30N 20A-L
Facility: SEC.21-T06N-R66W Wellbore: DONN 30N-20A-L PWB

| | |
|--|--|
| Plot reference wellpath is DONN 30N-20A-L PWB (REV.8.0) | Grid System: NAD83 / Lambert Colorado SP, Northern Zone (501), US feet |
| True vertical depths are referenced to PRECISION DRILLING (25) (RKB) | North Reference: True north |
| Measured depths are referenced to PRECISION DRILLING (25) (RKB) | Scale: True distance |
| PRECISION DRILLING (25) (RKB) to Mean Sea Level: 4778 feet | Depths are in feet |
| Mean Sea Level to Mud line (At Slot: SLOT#13 DONN 30N-20A-L (738°FNL & 250°FEL, SEC.21)): 0 feet | Created by: doddanna on 2017-08-25 |
| Coordinates are in feet referenced to Slot | Database: Denver DB |

Location Information

| Facility Name | | | | Grid East (US ft) | Grid North (US ft) | Latitude | Longitude |
|---|--------------|--------------|-------------------|--------------------|--------------------|-----------------|-----------------|
| SEC.21-T06N-R66W | | | | 3201871.604 | 1417148.268 | 40°28'34.342"N | 104°46'27.660"W |
| Slot | Local N (ft) | Local E (ft) | Grid East (US ft) | Grid North (US ft) | Latitude | Longitude | |
| SLOT#13 DONN 30N-20A-L (738FNL & 250FEL, SEC.21) | 1063.77 | 25.04 | 3201887.935 | 1418212.163 | 40°28'44.854"N | 104°46'27.336"W | |
| PRECISION DRILLING (25) (RKB) to Mud line (At Slot: SLOT#13 DONN 30N-20A-L (738FNL & 250FEL, SEC.21)) | | | | | | 4778ft | |
| Mean Sea Level to Mud line (At Slot: SLOT#13 DONN 30N-20A-L (738FNL & 250FEL, SEC.21)) | | | | | | 0ft | |
| PRECISION DRILLING (25) (RKB) to Mean Sea Level | | | | | | 4778ft | |

Survey Program

| Start MD (ft) | End MD (ft) | Tool | Model | Log Name/Comment | Wellbore |
|---------------|-------------|--------------------|---|------------------|--------------------|
| 25.00 | 1750.00 | BHI NavTrak | Custom BHI NavTrak (Standard Rotating+Axial Cor) (Rockies 0.03Gt model) | | DONN 30N-20A-L PWB |
| 1750.00 | 17652.35 | BHI AutoTrak Curve | Custom BHI AutoTrak Curve (FR1, Short) (Rockies 0.03Gt model) | | DONN 30N-20A-L PWB |



SRC ENERGY

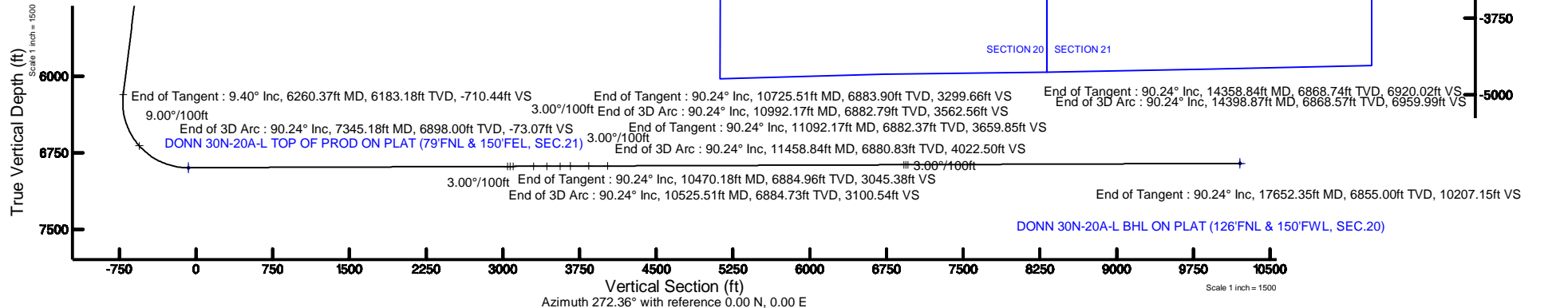
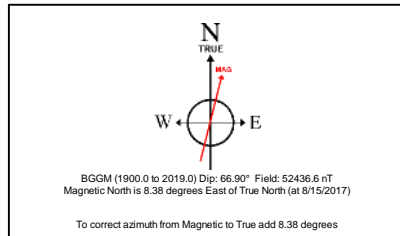

Targets

| Name | MD (ft) | TVD (ft) | Local N (ft) | Local E (ft) | Grid East (US ft) | Grid North (US ft) | Latitude | Longitude |
|---|----------|----------|--------------|--------------|-------------------|--------------------|----------------|-----------------|
| SEC.20-T06N-R66W | | 0.00 | 0.00 | 0.00 | 3201887.93 | 1418212.16 | 40°28'44.854"N | 104°46'27.336"W |
| SEC.21-T06N-R66W | | 48.00 | -3882.80 | -6166.64 | 3195753.51 | 1414279.17 | 40°28'06.478"N | 104°47'47.123"W |
| DONN 30N-20A-L BHL ON PLAT (126°FNL & 150°FEL, SEC.20) | 17652.35 | 6855.00 | 420.71 | -10198.48 | 3191686.73 | 1418549.38 | 40°28'48.990"N | 104°48'39.312"W |
| DONN 30N-20A-L TOP OF PROD ON PLAT (79°FNL & 150°FEL, SEC.21) | 7345.18 | 6898.00 | 661.60 | 100.43 | 3201982.94 | 1418874.54 | 40°28'51.381"N | 104°46'26.036"W |

Hole and Casing Sections

| Name | Start MD (ft) | End MD (ft) | Interval (ft) | Start TVD (ft) | End TVD (ft) | Start Local N (ft) | Start Local E (ft) | End Local N (ft) | End Local E (ft) | Wellbore |
|------------------------|---------------|-------------|---------------|----------------|--------------|--------------------|--------------------|------------------|------------------|--------------------|
| 13.5in Open Hole | 25.00 | 1750.00 | 1725.00 | 25.00 | 1733.39 | 0.00 | 0.00 | 136.22 | 166.18 | DONN 30N-20A-L PWB |
| 9.625in Casing Surface | 25.00 | 1750.00 | 1725.00 | 25.00 | 1733.39 | 0.00 | 0.00 | 136.22 | 166.18 | DONN 30N-20A-L PWB |
| 8.5in Open Hole | 1750.00 | 17652.35 | 15902.35 | 1733.39 | 6855.00 | 136.22 | 166.18 | 420.71 | -10198.48 | DONN 30N-20A-L PWB |

Well Profile Data

| Design Comment | MD (ft) | Inc (°) | Az (°) | TVD (ft) | Local N (ft) | Local E (ft) | DLS (°/100ft) | VS (ft) |
|----------------|----------|---------|---------|----------|--------------|--------------|---------------|----------|
| Tie On | 25.00 | 0.000 | 50.657 | 25.00 | 0.00 | 0.00 | 0.00 | 0.00 |
| End of Tangent | 200.00 | 0.000 | 50.657 | 200.00 | 0.00 | 0.00 | 0.00 | 0.00 |
| End of Build | 670.04 | 9.401 | 50.657 | 667.93 | 24.39 | 29.75 | 2.00 | -28.72 |
| End of Tangent | 6260.37 | 9.401 | 50.657 | 6183.18 | 603.27 | 735.93 | 0.00 | -710.44 |
| End of 3D Arc | 7345.18 | 90.239 | 268.660 | 6898.00 | 661.60 | 100.43 | 9.00 | -73.07 |
| End of Tangent | 10470.18 | 90.239 | 268.660 | 6884.96 | 588.52 | -3023.69 | 0.00 | 3045.38 |
| End of 3D Arc | 10525.51 | 90.239 | 267.000 | 6884.73 | 586.43 | -3078.98 | 3.00 | 3100.54 |
| End of Tangent | 10725.51 | 90.239 | 267.000 | 6883.90 | 575.96 | -3278.71 | 0.00 | 3299.66 |
| End of 3D Arc | 10992.17 | 90.239 | 259.000 | 6882.79 | 543.49 | -3543.17 | 3.00 | 3562.56 |
| End of Tangent | 11092.17 | 90.239 | 259.000 | 6882.37 | 524.41 | -3641.33 | 0.00 | 3659.85 |
| End of 3D Arc | 11458.84 | 90.239 | 270.000 | 6880.83 | 489.32 | -4005.74 | 3.00 | 4022.50 |
| End of Tangent | 14358.84 | 90.239 | 270.000 | 6868.74 | 489.32 | -6905.72 | 0.00 | 6920.02 |
| End of 3D Arc | 14398.87 | 90.239 | 268.799 | 6868.57 | 488.90 | -6945.74 | 3.00 | 6959.99 |
| End of Tangent | 17652.35 | 90.239 | 268.799 | 6855.00 | 420.71 | -10198.48 | 0.00 | 10207.15 |

~VERSION INFORMATION

VERS. 2.0 : CWLS LOG ASCII STANDARD-VERSION 2.0

WRAP. NO : ASCII DATA SECTION CONTAINS ONE ROW PER WELLPATH STATION

~WELL INFORMATION

| #MNEM | .UNITS | DATA | :DESCRIPTION |
|-------|--------|--------------------------------|-------------------------------|
| #---- | .----- | ---- | :----- |
| STRT | .ft | 0.00 | :START MD |
| STOP | .ft | 17652.35 | :STOP MD |
| STEP | .ft | 0.0 | :STEP (non-uniform increment) |
| NULL | . | -999.99 | :NULL |
| COMP | . | SRC ENERGY | :OPERATOR |
| WELL | . | DONN 30N 20A-L | :WELL |
| FLD | . | WELD COUNTY (NAD83,TRUE NORTH) | :FIELD |
| LOC | . | COLORADO | :AREA (aka: Location) |
| CNTY | . | N/A | :COUNTY |
| STAT | . | N/A | :STATE |
| CTRY | . | N/A | :COUNTRY |
| SRVC | . | Baker Hughes | :CONTRACTOR |
| DATE | . | 08/16/2017 | :LOG REV DATE |
| API | . | | :API NUMBER |

~OTHER INFORMATION

#Software: WellArchitect(R) Version 5.1

| #MNEM | .UNITS | DATA | :DESCRIPTION |
|---------------|--------|---|----------------------|
| #---- | .----- | ---- | :----- |
| WPTYPE | . | PLANNED WELLPATH | :WELLPATH TYPE |
| FACILITY | . | SEC.21-T06N-R66W | :FACILITY |
| SLOT | . | SLOT#13 DONN 30N-20A-L (738'FNL & 250'FEL, SEC.21):SLOT | :SLOT |
| WELLBORE | . | DONN 30N-20A-L PWB | :WELLBORE |
| WELLPATH | . | DONN 30N-20A-L PWP (REV-B.0) | :WELLPATH |
| MDREFPT | . | PRECISION DRILLING (25') (RKB) | :MD REFERENCE POINT |
| TVDREFPT | . | PRECISION DRILLING (25') (RKB) | :TVD REFERENCE POINT |
| LCLREFPT | . | Slot | :LOCAL COORDINATE |
| REFERENCE PT | | | |
| VSAZIMUTH.deg | | 272.36 | :VERTICAL SECTION |
| AZIMUTH | | | |
| VSORIGN .ft | | 0.00 | :VERTICAL SECTION |
| ORIGIN NORTH | | | |
| VSORIGE .ft | | 0.00 | :VERTICAL SECTION |
| ORIGIN EAST | | | |

~CURVE (WELLPATH) INFORMATION

| #MNEM | .UNITS | :DESCRIPTION |
|--------|--------|-----------------------------------|
| #---- | .----- | :----- |
| DEPT | .ft | :MEASURED DEPTH |
| INC | .deg | :INCLINATION |
| AZI | .deg | :AZIMUTH |
| TVD | .ft | :TRUE VERTICAL DEPTH |
| SECT | .ft | :CROSS SECTION (CURTAIN/VERTICAL) |
| LOCALN | .ft | :LOCAL NORTH |

DONN_30N-20A-L_PWP__REV-B.0_.las

LOCALE .ft :LOCAL EAST
LAT .deg :LATITUDE
LONG .deg :LONGITUDE
DLS .deg/100ft :DOGLEG SEVERITY

~ASCII DATA

| | | | | | | | |
|--------------|------|-------|---------|---------|--------|--------|------------|
| 0.00 | 0.00 | 50.66 | 0.00 | 0.00 | 0.00 | 0.00 | 40.4791260 |
| -104.7742600 | 0.00 | | | | | | |
| 25.00 | 0.00 | 50.66 | 25.00 | 0.00 | 0.00 | 0.00 | 40.4791260 |
| -104.7742600 | 0.00 | | | | | | |
| 125.00 | 0.00 | 50.66 | 125.00 | 0.00 | 0.00 | 0.00 | 40.4791260 |
| -104.7742600 | 0.00 | | | | | | |
| 200.00 | 0.00 | 50.66 | 200.00 | 0.00 | 0.00 | 0.00 | 40.4791260 |
| -104.7742600 | 0.00 | | | | | | |
| 225.00 | 0.50 | 50.66 | 225.00 | -0.08 | 0.07 | 0.08 | 40.4791262 |
| -104.7742597 | 2.00 | | | | | | |
| 325.00 | 2.50 | 50.66 | 324.96 | -2.04 | 1.73 | 2.11 | 40.4791307 |
| -104.7742524 | 2.00 | | | | | | |
| 425.00 | 4.50 | 50.66 | 424.77 | -6.59 | 5.60 | 6.83 | 40.4791414 |
| -104.7742354 | 2.00 | | | | | | |
| 525.00 | 6.50 | 50.66 | 524.30 | -13.75 | 11.67 | 14.24 | 40.4791580 |
| -104.7742088 | 2.00 | | | | | | |
| 625.00 | 8.50 | 50.66 | 623.44 | -23.49 | 19.95 | 24.34 | 40.4791808 |
| -104.7741725 | 2.00 | | | | | | |
| 670.04 | 9.40 | 50.66 | 667.93 | -28.72 | 24.39 | 29.75 | 40.4791929 |
| -104.7741530 | 2.00 | | | | | | |
| 725.00 | 9.40 | 50.66 | 722.16 | -35.43 | 30.08 | 36.70 | 40.4792086 |
| -104.7741281 | 0.00 | | | | | | |
| 825.00 | 9.40 | 50.66 | 820.81 | -47.62 | 40.44 | 49.33 | 40.4792370 |
| -104.7740827 | 0.00 | | | | | | |
| 925.00 | 9.40 | 50.66 | 919.47 | -59.82 | 50.79 | 61.96 | 40.4792654 |
| -104.7740373 | 0.00 | | | | | | |
| 1025.00 | 9.40 | 50.66 | 1018.13 | -72.01 | 61.15 | 74.59 | 40.4792938 |
| -104.7739919 | 0.00 | | | | | | |
| 1125.00 | 9.40 | 50.66 | 1116.78 | -84.20 | 71.50 | 87.23 | 40.4793223 |
| -104.7739465 | 0.00 | | | | | | |
| 1225.00 | 9.40 | 50.66 | 1215.44 | -96.40 | 81.86 | 99.86 | 40.4793507 |
| -104.7739011 | 0.00 | | | | | | |
| 1325.00 | 9.40 | 50.66 | 1314.10 | -108.59 | 92.21 | 112.49 | 40.4793791 |
| -104.7738556 | 0.00 | | | | | | |
| 1425.00 | 9.40 | 50.66 | 1412.75 | -120.79 | 102.57 | 125.12 | 40.4794075 |
| -104.7738102 | 0.00 | | | | | | |
| 1525.00 | 9.40 | 50.66 | 1511.41 | -132.98 | 112.92 | 137.75 | 40.4794360 |
| -104.7737648 | 0.00 | | | | | | |
| 1625.00 | 9.40 | 50.66 | 1610.07 | -145.18 | 123.28 | 150.39 | 40.4794644 |
| -104.7737194 | 0.00 | | | | | | |
| 1725.00 | 9.40 | 50.66 | 1708.73 | -157.37 | 133.63 | 163.02 | 40.4794928 |
| -104.7736740 | 0.00 | | | | | | |
| 1825.00 | 9.40 | 50.66 | 1807.38 | -169.57 | 143.99 | 175.65 | 40.4795212 |
| -104.7736286 | 0.00 | | | | | | |
| 1925.00 | 9.40 | 50.66 | 1906.04 | -181.76 | 154.34 | 188.28 | 40.4795496 |
| -104.7735832 | 0.00 | | | | | | |

DONN_30N-20A-L_PWP__REV-B.0_.las

| | | | | | | | |
|--------------|------|-------|---------|---------|--------|--------|------------|
| 2025.00 | 9.40 | 50.66 | 2004.70 | -193.96 | 164.70 | 200.91 | 40.4795781 |
| -104.7735378 | 0.00 | | | | | | |
| 2125.00 | 9.40 | 50.66 | 2103.35 | -206.15 | 175.05 | 213.55 | 40.4796065 |
| -104.7734924 | 0.00 | | | | | | |
| 2225.00 | 9.40 | 50.66 | 2202.01 | -218.34 | 185.41 | 226.18 | 40.4796349 |
| -104.7734470 | 0.00 | | | | | | |
| 2325.00 | 9.40 | 50.66 | 2300.67 | -230.54 | 195.76 | 238.81 | 40.4796633 |
| -104.7734016 | 0.00 | | | | | | |
| 2425.00 | 9.40 | 50.66 | 2399.32 | -242.73 | 206.12 | 251.44 | 40.4796918 |
| -104.7733562 | 0.00 | | | | | | |
| 2525.00 | 9.40 | 50.66 | 2497.98 | -254.93 | 216.47 | 264.08 | 40.4797202 |
| -104.7733107 | 0.00 | | | | | | |
| 2625.00 | 9.40 | 50.66 | 2596.64 | -267.12 | 226.83 | 276.71 | 40.4797486 |
| -104.7732653 | 0.00 | | | | | | |
| 2725.00 | 9.40 | 50.66 | 2695.30 | -279.32 | 237.18 | 289.34 | 40.4797770 |
| -104.7732199 | 0.00 | | | | | | |
| 2825.00 | 9.40 | 50.66 | 2793.95 | -291.51 | 247.54 | 301.97 | 40.4798055 |
| -104.7731745 | 0.00 | | | | | | |
| 2925.00 | 9.40 | 50.66 | 2892.61 | -303.71 | 257.89 | 314.60 | 40.4798339 |
| -104.7731291 | 0.00 | | | | | | |
| 3025.00 | 9.40 | 50.66 | 2991.27 | -315.90 | 268.25 | 327.24 | 40.4798623 |
| -104.7730837 | 0.00 | | | | | | |
| 3125.00 | 9.40 | 50.66 | 3089.92 | -328.10 | 278.60 | 339.87 | 40.4798907 |
| -104.7730383 | 0.00 | | | | | | |
| 3225.00 | 9.40 | 50.66 | 3188.58 | -340.29 | 288.96 | 352.50 | 40.4799191 |
| -104.7729929 | 0.00 | | | | | | |
| 3325.00 | 9.40 | 50.66 | 3287.24 | -352.48 | 299.31 | 365.13 | 40.4799476 |
| -104.7729475 | 0.00 | | | | | | |
| 3425.00 | 9.40 | 50.66 | 3385.89 | -364.68 | 309.67 | 377.76 | 40.4799760 |
| -104.7729021 | 0.00 | | | | | | |
| 3525.00 | 9.40 | 50.66 | 3484.55 | -376.87 | 320.02 | 390.40 | 40.4800044 |
| -104.7728567 | 0.00 | | | | | | |
| 3625.00 | 9.40 | 50.66 | 3583.21 | -389.07 | 330.38 | 403.03 | 40.4800328 |
| -104.7728113 | 0.00 | | | | | | |
| 3725.00 | 9.40 | 50.66 | 3681.87 | -401.26 | 340.73 | 415.66 | 40.4800613 |
| -104.7727658 | 0.00 | | | | | | |
| 3825.00 | 9.40 | 50.66 | 3780.52 | -413.46 | 351.09 | 428.29 | 40.4800897 |
| -104.7727204 | 0.00 | | | | | | |
| 3925.00 | 9.40 | 50.66 | 3879.18 | -425.65 | 361.44 | 440.92 | 40.4801181 |
| -104.7726750 | 0.00 | | | | | | |
| 4025.00 | 9.40 | 50.66 | 3977.84 | -437.85 | 371.80 | 453.56 | 40.4801465 |
| -104.7726296 | 0.00 | | | | | | |
| 4125.00 | 9.40 | 50.66 | 4076.49 | -450.04 | 382.15 | 466.19 | 40.4801749 |
| -104.7725842 | 0.00 | | | | | | |
| 4225.00 | 9.40 | 50.66 | 4175.15 | -462.24 | 392.51 | 478.82 | 40.4802034 |
| -104.7725388 | 0.00 | | | | | | |
| 4325.00 | 9.40 | 50.66 | 4273.81 | -474.43 | 402.86 | 491.45 | 40.4802318 |
| -104.7724934 | 0.00 | | | | | | |
| 4425.00 | 9.40 | 50.66 | 4372.46 | -486.62 | 413.22 | 504.08 | 40.4802602 |
| -104.7724480 | 0.00 | | | | | | |
| 4525.00 | 9.40 | 50.66 | 4471.12 | -498.82 | 423.57 | 516.72 | 40.4802886 |
| -104.7724026 | 0.00 | | | | | | |

DONN_30N-20A-L_PWP__REV-B.0_.las

| | | | | | | | |
|--------------|-------|--------|---------|---------|--------|--------|------------|
| 4625.00 | 9.40 | 50.66 | 4569.78 | -511.01 | 433.93 | 529.35 | 40.4803171 |
| -104.7723572 | 0.00 | | | | | | |
| 4725.00 | 9.40 | 50.66 | 4668.44 | -523.21 | 444.28 | 541.98 | 40.4803455 |
| -104.7723118 | 0.00 | | | | | | |
| 4825.00 | 9.40 | 50.66 | 4767.09 | -535.40 | 454.64 | 554.61 | 40.4803739 |
| -104.7722664 | 0.00 | | | | | | |
| 4925.00 | 9.40 | 50.66 | 4865.75 | -547.60 | 464.99 | 567.25 | 40.4804023 |
| -104.7722209 | 0.00 | | | | | | |
| 5025.00 | 9.40 | 50.66 | 4964.41 | -559.79 | 475.35 | 579.88 | 40.4804307 |
| -104.7721755 | 0.00 | | | | | | |
| 5125.00 | 9.40 | 50.66 | 5063.06 | -571.99 | 485.70 | 592.51 | 40.4804592 |
| -104.7721301 | 0.00 | | | | | | |
| 5225.00 | 9.40 | 50.66 | 5161.72 | -584.18 | 496.06 | 605.14 | 40.4804876 |
| -104.7720847 | 0.00 | | | | | | |
| 5325.00 | 9.40 | 50.66 | 5260.38 | -596.38 | 506.41 | 617.77 | 40.4805160 |
| -104.7720393 | 0.00 | | | | | | |
| 5425.00 | 9.40 | 50.66 | 5359.03 | -608.57 | 516.77 | 630.41 | 40.4805444 |
| -104.7719939 | 0.00 | | | | | | |
| 5525.00 | 9.40 | 50.66 | 5457.69 | -620.77 | 527.12 | 643.04 | 40.4805729 |
| -104.7719485 | 0.00 | | | | | | |
| 5625.00 | 9.40 | 50.66 | 5556.35 | -632.96 | 537.48 | 655.67 | 40.4806013 |
| -104.7719031 | 0.00 | | | | | | |
| 5725.00 | 9.40 | 50.66 | 5655.01 | -645.15 | 547.83 | 668.30 | 40.4806297 |
| -104.7718577 | 0.00 | | | | | | |
| 5825.00 | 9.40 | 50.66 | 5753.66 | -657.35 | 558.19 | 680.93 | 40.4806581 |
| -104.7718123 | 0.00 | | | | | | |
| 5925.00 | 9.40 | 50.66 | 5852.32 | -669.54 | 568.54 | 693.57 | 40.4806865 |
| -104.7717669 | 0.00 | | | | | | |
| 6025.00 | 9.40 | 50.66 | 5950.98 | -681.74 | 578.90 | 706.20 | 40.4807150 |
| -104.7717214 | 0.00 | | | | | | |
| 6125.00 | 9.40 | 50.66 | 6049.63 | -693.93 | 589.25 | 718.83 | 40.4807434 |
| -104.7716760 | 0.00 | | | | | | |
| 6225.00 | 9.40 | 50.66 | 6148.29 | -706.13 | 599.61 | 731.46 | 40.4807718 |
| -104.7716306 | 0.00 | | | | | | |
| 6260.37 | 9.40 | 50.66 | 6183.18 | -710.44 | 603.27 | 735.93 | 40.4807819 |
| -104.7716146 | 0.00 | | | | | | |
| 6325.00 | 6.03 | 13.85 | 6247.26 | -715.06 | 609.92 | 740.83 | 40.4808001 |
| -104.7715970 | 9.00 | | | | | | |
| 6425.00 | 9.43 | 306.59 | 6346.51 | -709.33 | 619.92 | 735.50 | 40.4808276 |
| -104.7716161 | 9.00 | | | | | | |
| 6525.00 | 17.40 | 287.68 | 6443.75 | -688.09 | 629.36 | 714.64 | 40.4808535 |
| -104.7716911 | 9.00 | | | | | | |
| 6625.00 | 26.04 | 280.73 | 6536.57 | -651.88 | 638.01 | 678.75 | 40.4808772 |
| -104.7718201 | 9.00 | | | | | | |
| 6725.00 | 34.85 | 277.11 | 6622.71 | -601.58 | 645.65 | 628.73 | 40.4808982 |
| -104.7719999 | 9.00 | | | | | | |
| 6825.00 | 43.74 | 274.80 | 6700.02 | -538.44 | 652.09 | 565.80 | 40.4809159 |
| -104.7722261 | 9.00 | | | | | | |
| 6925.00 | 52.65 | 273.15 | 6766.62 | -464.01 | 657.18 | 491.51 | 40.4809299 |
| -104.7724932 | 9.00 | | | | | | |
| 7025.00 | 61.59 | 271.85 | 6820.86 | -380.12 | 660.79 | 407.70 | 40.4809398 |
| -104.7727944 | 9.00 | | | | | | |

DONN_30N-20A-L_PWP__REV-B.0_.las

| | | | | | | | |
|--------------|-------|--------|---------|---------|--------|----------|------------|
| 7125.00 | 70.53 | 270.75 | 6861.40 | -288.83 | 662.83 | 316.42 | 40.4809454 |
| -104.7731226 | 9.00 | | | | | | |
| 7225.00 | 79.48 | 269.77 | 6887.25 | -192.40 | 663.25 | 219.93 | 40.4809465 |
| -104.7734694 | 9.00 | | | | | | |
| 7325.00 | 88.43 | 268.84 | 6897.77 | -93.20 | 662.04 | 120.59 | 40.4809432 |
| -104.7738265 | 9.00 | | | | | | |
| 7345.18 | 90.24 | 268.66 | 6898.00 | -73.07 | 661.60 | 100.43 | 40.4809420 |
| -104.7738990 | 9.00 | | | | | | |
| 7425.00 | 90.24 | 268.66 | 6897.67 | 6.59 | 659.73 | 20.62 | 40.4809369 |
| -104.7741859 | 0.00 | | | | | | |
| 7525.00 | 90.24 | 268.66 | 6897.25 | 106.38 | 657.39 | -79.35 | 40.4809305 |
| -104.7745452 | 0.00 | | | | | | |
| 7625.00 | 90.24 | 268.66 | 6896.83 | 206.17 | 655.06 | -179.32 | 40.4809240 |
| -104.7749046 | 0.00 | | | | | | |
| 7725.00 | 90.24 | 268.66 | 6896.42 | 305.96 | 652.72 | -279.29 | 40.4809176 |
| -104.7752640 | 0.00 | | | | | | |
| 7825.00 | 90.24 | 268.66 | 6896.00 | 405.75 | 650.38 | -379.26 | 40.4809112 |
| -104.7756233 | 0.00 | | | | | | |
| 7925.00 | 90.24 | 268.66 | 6895.58 | 505.54 | 648.04 | -479.24 | 40.4809048 |
| -104.7759827 | 0.00 | | | | | | |
| 8025.00 | 90.24 | 268.66 | 6895.16 | 605.33 | 645.70 | -579.21 | 40.4808983 |
| -104.7763421 | 0.00 | | | | | | |
| 8125.00 | 90.24 | 268.66 | 6894.75 | 705.12 | 643.36 | -679.18 | 40.4808919 |
| -104.7767014 | 0.00 | | | | | | |
| 8225.00 | 90.24 | 268.66 | 6894.33 | 804.91 | 641.03 | -779.15 | 40.4808855 |
| -104.7770608 | 0.00 | | | | | | |
| 8325.00 | 90.24 | 268.66 | 6893.91 | 904.70 | 638.69 | -879.12 | 40.4808791 |
| -104.7774202 | 0.00 | | | | | | |
| 8425.00 | 90.24 | 268.66 | 6893.50 | 1004.49 | 636.35 | -979.09 | 40.4808726 |
| -104.7777795 | 0.00 | | | | | | |
| 8525.00 | 90.24 | 268.66 | 6893.08 | 1104.28 | 634.01 | -1079.07 | 40.4808662 |
| -104.7781389 | 0.00 | | | | | | |
| 8625.00 | 90.24 | 268.66 | 6892.66 | 1204.07 | 631.67 | -1179.04 | 40.4808598 |
| -104.7784983 | 0.00 | | | | | | |
| 8725.00 | 90.24 | 268.66 | 6892.24 | 1303.86 | 629.33 | -1279.01 | 40.4808533 |
| -104.7788576 | 0.00 | | | | | | |
| 8825.00 | 90.24 | 268.66 | 6891.83 | 1403.65 | 626.99 | -1378.98 | 40.4808469 |
| -104.7792170 | 0.00 | | | | | | |
| 8925.00 | 90.24 | 268.66 | 6891.41 | 1503.44 | 624.66 | -1478.95 | 40.4808405 |
| -104.7795764 | 0.00 | | | | | | |
| 9025.00 | 90.24 | 268.66 | 6890.99 | 1603.23 | 622.32 | -1578.92 | 40.4808340 |
| -104.7799357 | 0.00 | | | | | | |
| 9125.00 | 90.24 | 268.66 | 6890.58 | 1703.02 | 619.98 | -1678.90 | 40.4808276 |
| -104.7802951 | 0.00 | | | | | | |
| 9225.00 | 90.24 | 268.66 | 6890.16 | 1802.81 | 617.64 | -1778.87 | 40.4808212 |
| -104.7806545 | 0.00 | | | | | | |
| 9325.00 | 90.24 | 268.66 | 6889.74 | 1902.60 | 615.30 | -1878.84 | 40.4808147 |
| -104.7810138 | 0.00 | | | | | | |
| 9425.00 | 90.24 | 268.66 | 6889.32 | 2002.39 | 612.96 | -1978.81 | 40.4808083 |
| -104.7813732 | 0.00 | | | | | | |
| 9525.00 | 90.24 | 268.66 | 6888.91 | 2102.19 | 610.62 | -2078.78 | 40.4808018 |
| -104.7817326 | 0.00 | | | | | | |

DONN_30N-20A-L_PWP__REV-B.0_.las

| | | | | | | | |
|--------------|-------|--------|---------|---------|--------|----------|------------|
| 9625.00 | 90.24 | 268.66 | 6888.49 | 2201.98 | 608.29 | -2178.76 | 40.4807954 |
| -104.7820919 | 0.00 | | | | | | |
| 9725.00 | 90.24 | 268.66 | 6888.07 | 2301.77 | 605.95 | -2278.73 | 40.4807890 |
| -104.7824513 | 0.00 | | | | | | |
| 9825.00 | 90.24 | 268.66 | 6887.66 | 2401.56 | 603.61 | -2378.70 | 40.4807825 |
| -104.7828107 | 0.00 | | | | | | |
| 9925.00 | 90.24 | 268.66 | 6887.24 | 2501.35 | 601.27 | -2478.67 | 40.4807761 |
| -104.7831700 | 0.00 | | | | | | |
| 10025.00 | 90.24 | 268.66 | 6886.82 | 2601.14 | 598.93 | -2578.64 | 40.4807696 |
| -104.7835294 | 0.00 | | | | | | |
| 10125.00 | 90.24 | 268.66 | 6886.40 | 2700.93 | 596.59 | -2678.61 | 40.4807632 |
| -104.7838888 | 0.00 | | | | | | |
| 10225.00 | 90.24 | 268.66 | 6885.99 | 2800.72 | 594.26 | -2778.59 | 40.4807567 |
| -104.7842481 | 0.00 | | | | | | |
| 10325.00 | 90.24 | 268.66 | 6885.57 | 2900.51 | 591.92 | -2878.56 | 40.4807503 |
| -104.7846075 | 0.00 | | | | | | |
| 10425.00 | 90.24 | 268.66 | 6885.15 | 3000.30 | 589.58 | -2978.53 | 40.4807438 |
| -104.7849669 | 0.00 | | | | | | |
| 10470.18 | 90.24 | 268.66 | 6884.96 | 3045.38 | 588.52 | -3023.69 | 40.4807409 |
| -104.7851292 | 0.00 | | | | | | |
| 10525.00 | 90.24 | 267.02 | 6884.74 | 3100.03 | 586.45 | -3078.48 | 40.4807352 |
| -104.7853261 | 3.00 | | | | | | |
| 10525.51 | 90.24 | 267.00 | 6884.73 | 3100.54 | 586.43 | -3078.98 | 40.4807351 |
| -104.7853280 | 3.00 | | | | | | |
| 10625.00 | 90.24 | 267.00 | 6884.32 | 3199.59 | 581.22 | -3178.34 | 40.4807208 |
| -104.7856851 | 0.00 | | | | | | |
| 10725.00 | 90.24 | 267.00 | 6883.90 | 3299.15 | 575.99 | -3278.20 | 40.4807064 |
| -104.7860441 | 0.00 | | | | | | |
| 10725.51 | 90.24 | 267.00 | 6883.90 | 3299.66 | 575.96 | -3278.71 | 40.4807063 |
| -104.7860459 | 0.00 | | | | | | |
| 10825.00 | 90.24 | 264.02 | 6883.48 | 3398.43 | 568.17 | -3377.88 | 40.4806849 |
| -104.7864024 | 3.00 | | | | | | |
| 10925.00 | 90.24 | 261.02 | 6883.07 | 3496.94 | 555.14 | -3477.02 | 40.4806491 |
| -104.7867587 | 3.00 | | | | | | |
| 10992.17 | 90.24 | 259.00 | 6882.79 | 3562.56 | 543.49 | -3543.17 | 40.4806171 |
| -104.7869965 | 3.00 | | | | | | |
| 11025.00 | 90.24 | 259.00 | 6882.65 | 3594.50 | 537.22 | -3575.39 | 40.4805999 |
| -104.7871124 | 0.00 | | | | | | |
| 11092.17 | 90.24 | 259.00 | 6882.37 | 3659.85 | 524.41 | -3641.33 | 40.4805647 |
| -104.7873494 | 0.00 | | | | | | |
| 11125.00 | 90.24 | 259.99 | 6882.23 | 3691.85 | 518.42 | -3673.60 | 40.4805482 |
| -104.7874654 | 3.00 | | | | | | |
| 11225.00 | 90.24 | 262.99 | 6881.81 | 3790.04 | 503.62 | -3772.49 | 40.4805076 |
| -104.7878208 | 3.00 | | | | | | |
| 11325.00 | 90.24 | 265.99 | 6881.39 | 3889.09 | 494.01 | -3872.02 | 40.4804811 |
| -104.7881786 | 3.00 | | | | | | |
| 11425.00 | 90.24 | 268.99 | 6880.98 | 3988.71 | 489.62 | -3971.91 | 40.4804691 |
| -104.7885377 | 3.00 | | | | | | |
| 11458.84 | 90.24 | 270.00 | 6880.83 | 4022.50 | 489.32 | -4005.74 | 40.4804682 |
| -104.7886593 | 3.00 | | | | | | |
| 11525.00 | 90.24 | 270.00 | 6880.56 | 4088.61 | 489.32 | -4071.90 | 40.4804682 |
| -104.7888971 | 0.00 | | | | | | |

DONN_30N-20A-L_PWP__REV-B.0_.las

| | | | | | | | |
|--------------|-------|--------|---------|---------|--------|----------|------------|
| 11625.00 | 90.24 | 270.00 | 6880.14 | 4188.53 | 489.32 | -4171.90 | 40.4804681 |
| -104.7892566 | 0.00 | | | | | | |
| 11725.00 | 90.24 | 270.00 | 6879.72 | 4288.44 | 489.32 | -4271.90 | 40.4804681 |
| -104.7896161 | 0.00 | | | | | | |
| 11825.00 | 90.24 | 270.00 | 6879.31 | 4388.35 | 489.32 | -4371.90 | 40.4804680 |
| -104.7899755 | 0.00 | | | | | | |
| 11925.00 | 90.24 | 270.00 | 6878.89 | 4488.27 | 489.32 | -4471.90 | 40.4804680 |
| -104.7903350 | 0.00 | | | | | | |
| 12025.00 | 90.24 | 270.00 | 6878.47 | 4588.18 | 489.32 | -4571.90 | 40.4804679 |
| -104.7906944 | 0.00 | | | | | | |
| 12125.00 | 90.24 | 270.00 | 6878.06 | 4688.10 | 489.32 | -4671.90 | 40.4804679 |
| -104.7910539 | 0.00 | | | | | | |
| 12225.00 | 90.24 | 270.00 | 6877.64 | 4788.01 | 489.32 | -4771.90 | 40.4804678 |
| -104.7914134 | 0.00 | | | | | | |
| 12325.00 | 90.24 | 270.00 | 6877.22 | 4887.93 | 489.32 | -4871.90 | 40.4804678 |
| -104.7917728 | 0.00 | | | | | | |
| 12425.00 | 90.24 | 270.00 | 6876.80 | 4987.84 | 489.32 | -4971.90 | 40.4804677 |
| -104.7921323 | 0.00 | | | | | | |
| 12525.00 | 90.24 | 270.00 | 6876.39 | 5087.75 | 489.32 | -5071.90 | 40.4804677 |
| -104.7924918 | 0.00 | | | | | | |
| 12625.00 | 90.24 | 270.00 | 6875.97 | 5187.67 | 489.32 | -5171.89 | 40.4804676 |
| -104.7928512 | 0.00 | | | | | | |
| 12725.00 | 90.24 | 270.00 | 6875.55 | 5287.58 | 489.32 | -5271.89 | 40.4804676 |
| -104.7932107 | 0.00 | | | | | | |
| 12825.00 | 90.24 | 270.00 | 6875.14 | 5387.50 | 489.32 | -5371.89 | 40.4804675 |
| -104.7935701 | 0.00 | | | | | | |
| 12925.00 | 90.24 | 270.00 | 6874.72 | 5487.41 | 489.32 | -5471.89 | 40.4804674 |
| -104.7939296 | 0.00 | | | | | | |
| 13025.00 | 90.24 | 270.00 | 6874.30 | 5587.32 | 489.32 | -5571.89 | 40.4804674 |
| -104.7942891 | 0.00 | | | | | | |
| 13125.00 | 90.24 | 270.00 | 6873.88 | 5687.24 | 489.32 | -5671.89 | 40.4804673 |
| -104.7946485 | 0.00 | | | | | | |
| 13225.00 | 90.24 | 270.00 | 6873.47 | 5787.15 | 489.32 | -5771.89 | 40.4804673 |
| -104.7950080 | 0.00 | | | | | | |
| 13325.00 | 90.24 | 270.00 | 6873.05 | 5887.07 | 489.32 | -5871.89 | 40.4804672 |
| -104.7953675 | 0.00 | | | | | | |
| 13425.00 | 90.24 | 270.00 | 6872.63 | 5986.98 | 489.32 | -5971.89 | 40.4804671 |
| -104.7957269 | 0.00 | | | | | | |
| 13525.00 | 90.24 | 270.00 | 6872.22 | 6086.90 | 489.32 | -6071.89 | 40.4804671 |
| -104.7960864 | 0.00 | | | | | | |
| 13625.00 | 90.24 | 270.00 | 6871.80 | 6186.81 | 489.32 | -6171.89 | 40.4804670 |
| -104.7964459 | 0.00 | | | | | | |
| 13725.00 | 90.24 | 270.00 | 6871.38 | 6286.72 | 489.32 | -6271.88 | 40.4804669 |
| -104.7968053 | 0.00 | | | | | | |
| 13825.00 | 90.24 | 270.00 | 6870.96 | 6386.64 | 489.32 | -6371.88 | 40.4804669 |
| -104.7971648 | 0.00 | | | | | | |
| 13925.00 | 90.24 | 270.00 | 6870.55 | 6486.55 | 489.32 | -6471.88 | 40.4804668 |
| -104.7975242 | 0.00 | | | | | | |
| 14025.00 | 90.24 | 270.00 | 6870.13 | 6586.47 | 489.32 | -6571.88 | 40.4804667 |
| -104.7978837 | 0.00 | | | | | | |
| 14125.00 | 90.24 | 270.00 | 6869.71 | 6686.38 | 489.32 | -6671.88 | 40.4804666 |
| -104.7982432 | 0.00 | | | | | | |

DONN_30N-20A-L_PWP__REV-B.0_.las

| | | | | | | | |
|--------------|-------|--------|---------|---------|--------|----------|------------|
| 14225.00 | 90.24 | 270.00 | 6869.30 | 6786.29 | 489.32 | -6771.88 | 40.4804666 |
| -104.7986026 | 0.00 | | | | | | |
| 14325.00 | 90.24 | 270.00 | 6868.88 | 6886.21 | 489.32 | -6871.88 | 40.4804665 |
| -104.7989621 | 0.00 | | | | | | |
| 14358.84 | 90.24 | 270.00 | 6868.74 | 6920.02 | 489.32 | -6905.72 | 40.4804665 |
| -104.7990837 | 0.00 | | | | | | |
| 14398.87 | 90.24 | 268.80 | 6868.57 | 6959.99 | 488.90 | -6945.74 | 40.4804653 |
| -104.7992276 | 3.00 | | | | | | |
| 14425.00 | 90.24 | 268.80 | 6868.46 | 6986.07 | 488.35 | -6971.87 | 40.4804638 |
| -104.7993215 | 0.00 | | | | | | |
| 14525.00 | 90.24 | 268.80 | 6868.04 | 7085.88 | 486.26 | -7071.85 | 40.4804579 |
| -104.7996809 | 0.00 | | | | | | |
| 14625.00 | 90.24 | 268.80 | 6867.63 | 7185.69 | 484.16 | -7171.82 | 40.4804521 |
| -104.8000403 | 0.00 | | | | | | |
| 14725.00 | 90.24 | 268.80 | 6867.21 | 7285.49 | 482.06 | -7271.80 | 40.4804463 |
| -104.8003997 | 0.00 | | | | | | |
| 14825.00 | 90.24 | 268.80 | 6866.79 | 7385.30 | 479.97 | -7371.78 | 40.4804404 |
| -104.8007591 | 0.00 | | | | | | |
| 14925.00 | 90.24 | 268.80 | 6866.38 | 7485.10 | 477.87 | -7471.76 | 40.4804346 |
| -104.8011184 | 0.00 | | | | | | |
| 15025.00 | 90.24 | 268.80 | 6865.96 | 7584.91 | 475.78 | -7571.73 | 40.4804287 |
| -104.8014778 | 0.00 | | | | | | |
| 15125.00 | 90.24 | 268.80 | 6865.54 | 7684.71 | 473.68 | -7671.71 | 40.4804229 |
| -104.8018372 | 0.00 | | | | | | |
| 15225.00 | 90.24 | 268.80 | 6865.12 | 7784.52 | 471.58 | -7771.69 | 40.4804171 |
| -104.8021966 | 0.00 | | | | | | |
| 15325.00 | 90.24 | 268.80 | 6864.71 | 7884.33 | 469.49 | -7871.66 | 40.4804112 |
| -104.8025560 | 0.00 | | | | | | |
| 15425.00 | 90.24 | 268.80 | 6864.29 | 7984.13 | 467.39 | -7971.64 | 40.4804054 |
| -104.8029153 | 0.00 | | | | | | |
| 15525.00 | 90.24 | 268.80 | 6863.87 | 8083.94 | 465.30 | -8071.62 | 40.4803995 |
| -104.8032747 | 0.00 | | | | | | |
| 15625.00 | 90.24 | 268.80 | 6863.46 | 8183.74 | 463.20 | -8171.60 | 40.4803937 |
| -104.8036341 | 0.00 | | | | | | |
| 15725.00 | 90.24 | 268.80 | 6863.04 | 8283.55 | 461.10 | -8271.57 | 40.4803879 |
| -104.8039935 | 0.00 | | | | | | |
| 15825.00 | 90.24 | 268.80 | 6862.62 | 8383.36 | 459.01 | -8371.55 | 40.4803820 |
| -104.8043529 | 0.00 | | | | | | |
| 15925.00 | 90.24 | 268.80 | 6862.20 | 8483.16 | 456.91 | -8471.53 | 40.4803762 |
| -104.8047123 | 0.00 | | | | | | |
| 16025.00 | 90.24 | 268.80 | 6861.79 | 8582.97 | 454.82 | -8571.50 | 40.4803703 |
| -104.8050716 | 0.00 | | | | | | |
| 16125.00 | 90.24 | 268.80 | 6861.37 | 8682.77 | 452.72 | -8671.48 | 40.4803645 |
| -104.8054310 | 0.00 | | | | | | |
| 16225.00 | 90.24 | 268.80 | 6860.95 | 8782.58 | 450.62 | -8771.46 | 40.4803586 |
| -104.8057904 | 0.00 | | | | | | |
| 16325.00 | 90.24 | 268.80 | 6860.54 | 8882.38 | 448.53 | -8871.44 | 40.4803528 |
| -104.8061498 | 0.00 | | | | | | |
| 16425.00 | 90.24 | 268.80 | 6860.12 | 8982.19 | 446.43 | -8971.41 | 40.4803469 |
| -104.8065092 | 0.00 | | | | | | |
| 16525.00 | 90.24 | 268.80 | 6859.70 | 9082.00 | 444.34 | -9071.39 | 40.4803411 |
| -104.8068685 | 0.00 | | | | | | |

DONN_30N-20A-L_PWP__REV-B.0_.las

| | | | | | | | |
|--------------|-------|--------|---------|----------|--------|-----------|------------|
| 16625.00 | 90.24 | 268.80 | 6859.29 | 9181.80 | 442.24 | -9171.37 | 40.4803352 |
| -104.8072279 | 0.00 | | | | | | |
| 16725.00 | 90.24 | 268.80 | 6858.87 | 9281.61 | 440.15 | -9271.34 | 40.4803294 |
| -104.8075873 | 0.00 | | | | | | |
| 16825.00 | 90.24 | 268.80 | 6858.45 | 9381.41 | 438.05 | -9371.32 | 40.4803235 |
| -104.8079467 | 0.00 | | | | | | |
| 16925.00 | 90.24 | 268.80 | 6858.03 | 9481.22 | 435.95 | -9471.30 | 40.4803176 |
| -104.8083061 | 0.00 | | | | | | |
| 17025.00 | 90.24 | 268.80 | 6857.62 | 9581.03 | 433.86 | -9571.28 | 40.4803118 |
| -104.8086654 | 0.00 | | | | | | |
| 17125.00 | 90.24 | 268.80 | 6857.20 | 9680.83 | 431.76 | -9671.25 | 40.4803059 |
| -104.8090248 | 0.00 | | | | | | |
| 17225.00 | 90.24 | 268.80 | 6856.78 | 9780.64 | 429.67 | -9771.23 | 40.4803001 |
| -104.8093842 | 0.00 | | | | | | |
| 17325.00 | 90.24 | 268.80 | 6856.37 | 9880.44 | 427.57 | -9871.21 | 40.4802942 |
| -104.8097436 | 0.00 | | | | | | |
| 17425.00 | 90.24 | 268.80 | 6855.95 | 9980.25 | 425.47 | -9971.18 | 40.4802883 |
| -104.8101030 | 0.00 | | | | | | |
| 17525.00 | 90.24 | 268.80 | 6855.53 | 10080.05 | 423.38 | -10071.16 | 40.4802825 |
| -104.8104623 | 0.00 | | | | | | |
| 17625.00 | 90.24 | 268.80 | 6855.11 | 10179.86 | 421.28 | -10171.14 | 40.4802766 |
| -104.8108217 | 0.00 | | | | | | |
| 17652.35 | 90.24 | 268.80 | 6855.00 | 10207.15 | 420.71 | -10198.48 | 40.4802750 |
| -104.8109200 | 0.00 | | | | | | |

Planned Wellpath Report

DONN 30N-20A-L PWP (REV-B.0)

Page 1 of 6



REFERENCE WELLPATH IDENTIFICATION

| | | | |
|----------|--------------------------------|----------|--|
| Operator | SRC ENERGY | Slot | SLOT#13 DONN 30N-20A-L (738'FNL & 250'FEL, SEC.21) |
| Area | COLORADO | Well | DONN 30N 20A-L |
| Field | WELD COUNTY (NAD83,TRUE NORTH) | Wellbore | DONN 30N-20A-L PWB |
| Facility | SEC.21-T06N-R66W | | |

REPORT SETUP INFORMATION

| | | | |
|---------------------|---|----------------------|--|
| Projection System | NAD83 / Lambert Colorado SP, Northern Zone (501), US feet | Software System | WellArchitect® 5.1 |
| North Reference | True | User | Doddanna |
| Scale | 0.999965 | Report Generated | 8/25/2017 at 11:34:41 AM |
| Convergence at slot | 0.47° East | Database/Source file | Denver DB/DONN_30N-20A-L_PWP__REV-B.0_.xml |

WELLPATH LOCATION

| | Local coordinates | | Grid coordinates | | Geographic coordinates | |
|-----------------------|-------------------|----------|------------------|-----------------|------------------------|-----------------|
| | North[ft] | East[ft] | Easting[US ft] | Northing[US ft] | Latitude | Longitude |
| Slot Location | 1063.77 | 25.04 | 3201887.94 | 1418212.16 | 40°28'44.854"N | 104°46'27.336"W |
| Facility Reference Pt | | | 3201871.60 | 1417148.27 | 40°28'34.342"N | 104°46'27.660"W |
| Field Reference Pt | | | 3171284.48 | 1426358.81 | 40°30'07.643"N | 104°53'02.634"W |

WELLPATH DATUM

| | | | |
|--------------------------|--------------------------------|---|-------------------|
| Calculation method | Minimum curvature | PRECISION DRILLING (25') (RKB) to Facility Vertical Datum | 4778.00ft |
| Horizontal Reference Pt | Slot | PRECISION DRILLING (25') (RKB) to Mean Sea Level | 4778.00ft |
| Vertical Reference Pt | PRECISION DRILLING (25') (RKB) | PRECISION DRILLING (25') (RKB) to Mud Line at Slot (SLOT#13 DONN 30N-20A-L (738'FNL & 250'FEL, SEC.21)) | 4778.00ft |
| MD Reference Pt | PRECISION DRILLING (25') (RKB) | Section Origin | N 0.00, E 0.00 ft |
| Field Vertical Reference | Mean Sea Level | Section Azimuth | 272.36° |

Planned Wellpath Report

DONN 30N-20A-L PWP (REV-B.0)

Page 2 of 6



REFERENCE WELLPATH IDENTIFICATION

| | | | |
|----------|--------------------------------|----------|--|
| Operator | SRC ENERGY | Slot | SLOT#13 DONN 30N-20A-L (738'FNL & 250'FEL, SEC.21) |
| Area | COLORADO | Well | DONN 30N 20A-L |
| Field | WELD COUNTY (NAD83,TRUE NORTH) | Wellbore | DONN 30N-20A-L PWB |
| Facility | SEC.21-T06N-R66W | | |

WELLPATH DATA (191 stations) † = interpolated/extrapolated station

| MD [ft] | Inclination [°] | Azimuth [°] | TVD [ft] | Vert Sect [ft] | North [ft] | East [ft] | DLS [°/100ft] | Comments |
|------------|--------------------|----------------|-------------|-------------------|---------------|--------------|------------------|----------------|
| 0.00† | 0.000 | 50.657 | 0.00 | 0.00 | 0.00 | 0.00 | 0.00 | |
| 25.00 | 0.000 | 50.657 | 25.00 | 0.00 | 0.00 | 0.00 | 0.00 | Tie On |
| 125.00† | 0.000 | 50.657 | 125.00 | 0.00 | 0.00 | 0.00 | 0.00 | |
| 200.00 | 0.000 | 50.657 | 200.00 | 0.00 | 0.00 | 0.00 | 0.00 | End of Tangent |
| 225.00† | 0.500 | 50.657 | 225.00 | -0.08 | 0.07 | 0.08 | 2.00 | |
| 325.00† | 2.500 | 50.657 | 324.96 | -2.04 | 1.73 | 2.11 | 2.00 | |
| 425.00† | 4.500 | 50.657 | 424.77 | -6.59 | 5.60 | 6.83 | 2.00 | |
| 525.00† | 6.500 | 50.657 | 524.30 | -13.75 | 11.67 | 14.24 | 2.00 | |
| 625.00† | 8.500 | 50.657 | 623.44 | -23.49 | 19.95 | 24.34 | 2.00 | |
| 670.04 | 9.401 | 50.657 | 667.93 | -28.72 | 24.39 | 29.75 | 2.00 | End of Build |
| 725.00† | 9.401 | 50.657 | 722.16 | -35.43 | 30.08 | 36.70 | 0.00 | |
| 825.00† | 9.401 | 50.657 | 820.81 | -47.62 | 40.44 | 49.33 | 0.00 | |
| 925.00† | 9.401 | 50.657 | 919.47 | -59.82 | 50.79 | 61.96 | 0.00 | |
| 1025.00† | 9.401 | 50.657 | 1018.13 | -72.01 | 61.15 | 74.59 | 0.00 | |
| 1125.00† | 9.401 | 50.657 | 1116.78 | -84.20 | 71.50 | 87.23 | 0.00 | |
| 1225.00† | 9.401 | 50.657 | 1215.44 | -96.40 | 81.86 | 99.86 | 0.00 | |
| 1325.00† | 9.401 | 50.657 | 1314.10 | -108.59 | 92.21 | 112.49 | 0.00 | |
| 1425.00† | 9.401 | 50.657 | 1412.75 | -120.79 | 102.57 | 125.12 | 0.00 | |
| 1525.00† | 9.401 | 50.657 | 1511.41 | -132.98 | 112.92 | 137.75 | 0.00 | |
| 1625.00† | 9.401 | 50.657 | 1610.07 | -145.18 | 123.28 | 150.39 | 0.00 | |
| 1725.00† | 9.401 | 50.657 | 1708.73 | -157.37 | 133.63 | 163.02 | 0.00 | |
| 1825.00† | 9.401 | 50.657 | 1807.38 | -169.57 | 143.99 | 175.65 | 0.00 | |
| 1925.00† | 9.401 | 50.657 | 1906.04 | -181.76 | 154.34 | 188.28 | 0.00 | |
| 2025.00† | 9.401 | 50.657 | 2004.70 | -193.96 | 164.70 | 200.91 | 0.00 | |
| 2125.00† | 9.401 | 50.657 | 2103.35 | -206.15 | 175.05 | 213.55 | 0.00 | |
| 2225.00† | 9.401 | 50.657 | 2202.01 | -218.34 | 185.41 | 226.18 | 0.00 | |
| 2325.00† | 9.401 | 50.657 | 2300.67 | -230.54 | 195.76 | 238.81 | 0.00 | |
| 2425.00† | 9.401 | 50.657 | 2399.32 | -242.73 | 206.12 | 251.44 | 0.00 | |
| 2525.00† | 9.401 | 50.657 | 2497.98 | -254.93 | 216.47 | 264.08 | 0.00 | |
| 2625.00† | 9.401 | 50.657 | 2596.64 | -267.12 | 226.83 | 276.71 | 0.00 | |
| 2725.00† | 9.401 | 50.657 | 2695.30 | -279.32 | 237.18 | 289.34 | 0.00 | |
| 2825.00† | 9.401 | 50.657 | 2793.95 | -291.51 | 247.54 | 301.97 | 0.00 | |
| 2925.00† | 9.401 | 50.657 | 2892.61 | -303.71 | 257.89 | 314.60 | 0.00 | |
| 3025.00† | 9.401 | 50.657 | 2991.27 | -315.90 | 268.25 | 327.24 | 0.00 | |
| 3125.00† | 9.401 | 50.657 | 3089.92 | -328.10 | 278.60 | 339.87 | 0.00 | |
| 3225.00† | 9.401 | 50.657 | 3188.58 | -340.29 | 288.96 | 352.50 | 0.00 | |
| 3325.00† | 9.401 | 50.657 | 3287.24 | -352.48 | 299.31 | 365.13 | 0.00 | |
| 3425.00† | 9.401 | 50.657 | 3385.89 | -364.68 | 309.67 | 377.76 | 0.00 | |
| 3525.00† | 9.401 | 50.657 | 3484.55 | -376.87 | 320.02 | 390.40 | 0.00 | |
| 3625.00† | 9.401 | 50.657 | 3583.21 | -389.07 | 330.38 | 403.03 | 0.00 | |
| 3725.00† | 9.401 | 50.657 | 3681.87 | -401.26 | 340.73 | 415.66 | 0.00 | |
| 3825.00† | 9.401 | 50.657 | 3780.52 | -413.46 | 351.09 | 428.29 | 0.00 | |
| 3925.00† | 9.401 | 50.657 | 3879.18 | -425.65 | 361.44 | 440.92 | 0.00 | |
| 4025.00† | 9.401 | 50.657 | 3977.84 | -437.85 | 371.80 | 453.56 | 0.00 | |
| 4125.00† | 9.401 | 50.657 | 4076.49 | -450.04 | 382.15 | 466.19 | 0.00 | |

Planned Wellpath Report

DONN 30N-20A-L PWP (REV-B.0)

Page 3 of 6



REFERENCE WELLPATH IDENTIFICATION

| | | | |
|----------|--------------------------------|----------|--|
| Operator | SRC ENERGY | Slot | SLOT#13 DONN 30N-20A-L (738'FNL & 250'FEL, SEC.21) |
| Area | COLORADO | Well | DONN 30N 20A-L |
| Field | WELD COUNTY (NAD83,TRUE NORTH) | Wellbore | DONN 30N-20A-L PWB |
| Facility | SEC.21-T06N-R66W | | |

WELLPATH DATA (191 stations) † = interpolated/extrapolated station

| MD [ft] | Inclination [°] | Azimuth [°] | TVD [ft] | Vert Sect [ft] | North [ft] | East [ft] | DLS [°/100ft] | Comments |
|------------|--------------------|----------------|----------------------|-------------------|---------------|--------------|------------------|----------------|
| 4225.00† | 9.401 | 50.657 | 4175.15 | -462.24 | 392.51 | 478.82 | 0.00 | |
| 4325.00† | 9.401 | 50.657 | 4273.81 | -474.43 | 402.86 | 491.45 | 0.00 | |
| 4425.00† | 9.401 | 50.657 | 4372.46 | -486.62 | 413.22 | 504.08 | 0.00 | |
| 4525.00† | 9.401 | 50.657 | 4471.12 | -498.82 | 423.57 | 516.72 | 0.00 | |
| 4625.00† | 9.401 | 50.657 | 4569.78 | -511.01 | 433.93 | 529.35 | 0.00 | |
| 4725.00† | 9.401 | 50.657 | 4668.44 | -523.21 | 444.28 | 541.98 | 0.00 | |
| 4825.00† | 9.401 | 50.657 | 4767.09 | -535.40 | 454.64 | 554.61 | 0.00 | |
| 4925.00† | 9.401 | 50.657 | 4865.75 | -547.60 | 464.99 | 567.25 | 0.00 | |
| 5025.00† | 9.401 | 50.657 | 4964.41 | -559.79 | 475.35 | 579.88 | 0.00 | |
| 5125.00† | 9.401 | 50.657 | 5063.06 | -571.99 | 485.70 | 592.51 | 0.00 | |
| 5225.00† | 9.401 | 50.657 | 5161.72 | -584.18 | 496.06 | 605.14 | 0.00 | |
| 5325.00† | 9.401 | 50.657 | 5260.38 | -596.38 | 506.41 | 617.77 | 0.00 | |
| 5425.00† | 9.401 | 50.657 | 5359.03 | -608.57 | 516.77 | 630.41 | 0.00 | |
| 5525.00† | 9.401 | 50.657 | 5457.69 | -620.77 | 527.12 | 643.04 | 0.00 | |
| 5625.00† | 9.401 | 50.657 | 5556.35 | -632.96 | 537.48 | 655.67 | 0.00 | |
| 5725.00† | 9.401 | 50.657 | 5655.01 | -645.15 | 547.83 | 668.30 | 0.00 | |
| 5825.00† | 9.401 | 50.657 | 5753.66 | -657.35 | 558.19 | 680.93 | 0.00 | |
| 5925.00† | 9.401 | 50.657 | 5852.32 | -669.54 | 568.54 | 693.57 | 0.00 | |
| 6025.00† | 9.401 | 50.657 | 5950.98 | -681.74 | 578.90 | 706.20 | 0.00 | |
| 6125.00† | 9.401 | 50.657 | 6049.63 | -693.93 | 589.25 | 718.83 | 0.00 | |
| 6225.00† | 9.401 | 50.657 | 6148.29 | -706.13 | 599.61 | 731.46 | 0.00 | |
| 6260.37 | 9.401 | 50.657 | 6183.18 | -710.44 | 603.27 | 735.93 | 0.00 | End of Tangent |
| 6325.00† | 6.032 | 13.852 | 6247.26 | -715.06 | 609.92 | 740.83 | 9.00 | |
| 6425.00† | 9.426 | 306.590 | 6346.51 | -709.33 | 619.92 | 735.50 | 9.00 | |
| 6525.00† | 17.399 | 287.678 | 6443.75 | -688.09 | 629.36 | 714.64 | 9.00 | |
| 6625.00† | 26.040 | 280.733 | 6536.57 | -651.88 | 638.01 | 678.75 | 9.00 | |
| 6725.00† | 34.854 | 277.106 | 6622.71 | -601.58 | 645.65 | 628.73 | 9.00 | |
| 6825.00† | 43.736 | 274.803 | 6700.02 | -538.44 | 652.09 | 565.80 | 9.00 | |
| 6925.00† | 52.652 | 273.148 | 6766.62 | -464.01 | 657.18 | 491.51 | 9.00 | |
| 7025.00† | 61.585 | 271.848 | 6820.86 | -380.12 | 660.79 | 407.70 | 9.00 | |
| 7125.00† | 70.530 | 270.751 | 6861.40 | -288.83 | 662.83 | 316.42 | 9.00 | |
| 7225.00† | 79.480 | 269.770 | 6887.25 | -192.40 | 663.25 | 219.93 | 9.00 | |
| 7325.00† | 88.433 | 268.844 | 6897.77 | -93.20 | 662.04 | 120.59 | 9.00 | |
| 7345.18 | 90.239 | 268.660 | 6898.00 ¹ | -73.07 | 661.60 | 100.43 | 9.00 | End of 3D Arc |
| 7425.00† | 90.239 | 268.660 | 6897.67 | 6.59 | 659.73 | 20.62 | 0.00 | |
| 7525.00† | 90.239 | 268.660 | 6897.25 | 106.38 | 657.39 | -79.35 | 0.00 | |
| 7625.00† | 90.239 | 268.660 | 6896.83 | 206.17 | 655.06 | -179.32 | 0.00 | |
| 7725.00† | 90.239 | 268.660 | 6896.42 | 305.96 | 652.72 | -279.29 | 0.00 | |
| 7825.00† | 90.239 | 268.660 | 6896.00 | 405.75 | 650.38 | -379.26 | 0.00 | |
| 7925.00† | 90.239 | 268.660 | 6895.58 | 505.54 | 648.04 | -479.24 | 0.00 | |
| 8025.00† | 90.239 | 268.660 | 6895.16 | 605.33 | 645.70 | -579.21 | 0.00 | |
| 8125.00† | 90.239 | 268.660 | 6894.75 | 705.12 | 643.36 | -679.18 | 0.00 | |
| 8225.00† | 90.239 | 268.660 | 6894.33 | 804.91 | 641.03 | -779.15 | 0.00 | |
| 8325.00† | 90.239 | 268.660 | 6893.91 | 904.70 | 638.69 | -879.12 | 0.00 | |
| 8425.00† | 90.239 | 268.660 | 6893.50 | 1004.49 | 636.35 | -979.09 | 0.00 | |

Planned Wellpath Report

DONN 30N-20A-L PWP (REV-B.0)

Page 4 of 6



REFERENCE WELLPATH IDENTIFICATION

| | | | |
|----------|--------------------------------|----------|--|
| Operator | SRC ENERGY | Slot | SLOT#13 DONN 30N-20A-L (738'FNL & 250'FEL, SEC.21) |
| Area | COLORADO | Well | DONN 30N 20A-L |
| Field | WELD COUNTY (NAD83,TRUE NORTH) | Wellbore | DONN 30N-20A-L PWB |
| Facility | SEC.21-T06N-R66W | | |

WELLPATH DATA (191 stations) † = interpolated/extrapolated station

| MD [ft] | Inclination [°] | Azimuth [°] | TVD [ft] | Vert Sect [ft] | North [ft] | East [ft] | DLS [°/100ft] | Comments |
|------------|--------------------|----------------|-------------|-------------------|---------------|--------------|------------------|----------------|
| 8525.00† | 90.239 | 268.660 | 6893.08 | 1104.28 | 634.01 | -1079.07 | 0.00 | |
| 8625.00† | 90.239 | 268.660 | 6892.66 | 1204.07 | 631.67 | -1179.04 | 0.00 | |
| 8725.00† | 90.239 | 268.660 | 6892.24 | 1303.86 | 629.33 | -1279.01 | 0.00 | |
| 8825.00† | 90.239 | 268.660 | 6891.83 | 1403.65 | 626.99 | -1378.98 | 0.00 | |
| 8925.00† | 90.239 | 268.660 | 6891.41 | 1503.44 | 624.66 | -1478.95 | 0.00 | |
| 9025.00† | 90.239 | 268.660 | 6890.99 | 1603.23 | 622.32 | -1578.92 | 0.00 | |
| 9125.00† | 90.239 | 268.660 | 6890.58 | 1703.02 | 619.98 | -1678.90 | 0.00 | |
| 9225.00† | 90.239 | 268.660 | 6890.16 | 1802.81 | 617.64 | -1778.87 | 0.00 | |
| 9325.00† | 90.239 | 268.660 | 6889.74 | 1902.60 | 615.30 | -1878.84 | 0.00 | |
| 9425.00† | 90.239 | 268.660 | 6889.32 | 2002.39 | 612.96 | -1978.81 | 0.00 | |
| 9525.00† | 90.239 | 268.660 | 6888.91 | 2102.19 | 610.62 | -2078.78 | 0.00 | |
| 9625.00† | 90.239 | 268.660 | 6888.49 | 2201.98 | 608.29 | -2178.76 | 0.00 | |
| 9725.00† | 90.239 | 268.660 | 6888.07 | 2301.77 | 605.95 | -2278.73 | 0.00 | |
| 9825.00† | 90.239 | 268.660 | 6887.66 | 2401.56 | 603.61 | -2378.70 | 0.00 | |
| 9925.00† | 90.239 | 268.660 | 6887.24 | 2501.35 | 601.27 | -2478.67 | 0.00 | |
| 10025.00† | 90.239 | 268.660 | 6886.82 | 2601.14 | 598.93 | -2578.64 | 0.00 | |
| 10125.00† | 90.239 | 268.660 | 6886.40 | 2700.93 | 596.59 | -2678.61 | 0.00 | |
| 10225.00† | 90.239 | 268.660 | 6885.99 | 2800.72 | 594.26 | -2778.59 | 0.00 | |
| 10325.00† | 90.239 | 268.660 | 6885.57 | 2900.51 | 591.92 | -2878.56 | 0.00 | |
| 10425.00† | 90.239 | 268.660 | 6885.15 | 3000.30 | 589.58 | -2978.53 | 0.00 | |
| 10470.18 | 90.239 | 268.660 | 6884.96 | 3045.38 | 588.52 | -3023.69 | 0.00 | End of Tangent |
| 10525.00† | 90.239 | 267.015 | 6884.74 | 3100.03 | 586.45 | -3078.48 | 3.00 | |
| 10525.51 | 90.239 | 267.000 | 6884.73 | 3100.54 | 586.43 | -3078.98 | 3.00 | End of 3D Arc |
| 10625.00† | 90.239 | 267.000 | 6884.32 | 3199.59 | 581.22 | -3178.34 | 0.00 | |
| 10725.00† | 90.239 | 267.000 | 6883.90 | 3299.15 | 575.99 | -3278.20 | 0.00 | |
| 10725.51 | 90.239 | 267.000 | 6883.90 | 3299.66 | 575.96 | -3278.71 | 0.00 | End of Tangent |
| 10825.00† | 90.240 | 264.015 | 6883.48 | 3398.43 | 568.17 | -3377.88 | 3.00 | |
| 10925.00† | 90.239 | 261.015 | 6883.07 | 3496.94 | 555.14 | -3477.02 | 3.00 | |
| 10992.17 | 90.239 | 259.000 | 6882.79 | 3562.56 | 543.49 | -3543.17 | 3.00 | End of 3D Arc |
| 11025.00† | 90.239 | 259.000 | 6882.65 | 3594.50 | 537.22 | -3575.39 | 0.00 | |
| 11092.17 | 90.239 | 259.000 | 6882.37 | 3659.85 | 524.41 | -3641.33 | 0.00 | End of Tangent |
| 11125.00† | 90.239 | 259.985 | 6882.23 | 3691.85 | 518.42 | -3673.60 | 3.00 | |
| 11225.00† | 90.240 | 262.985 | 6881.81 | 3790.04 | 503.62 | -3772.49 | 3.00 | |
| 11325.00† | 90.240 | 265.985 | 6881.39 | 3889.09 | 494.01 | -3872.02 | 3.00 | |
| 11425.00† | 90.239 | 268.985 | 6880.98 | 3988.71 | 489.62 | -3971.91 | 3.00 | |
| 11458.84 | 90.239 | 270.000 | 6880.83 | 4022.50 | 489.32 | -4005.74 | 3.00 | End of 3D Arc |
| 11525.00† | 90.239 | 270.000 | 6880.56 | 4088.61 | 489.32 | -4071.90 | 0.00 | |
| 11625.00† | 90.239 | 270.000 | 6880.14 | 4188.53 | 489.32 | -4171.90 | 0.00 | |
| 11725.00† | 90.239 | 270.000 | 6879.72 | 4288.44 | 489.32 | -4271.90 | 0.00 | |
| 11825.00† | 90.239 | 270.000 | 6879.31 | 4388.35 | 489.32 | -4371.90 | 0.00 | |
| 11925.00† | 90.239 | 270.000 | 6878.89 | 4488.27 | 489.32 | -4471.90 | 0.00 | |
| 12025.00† | 90.239 | 270.000 | 6878.47 | 4588.18 | 489.32 | -4571.90 | 0.00 | |
| 12125.00† | 90.239 | 270.000 | 6878.06 | 4688.10 | 489.32 | -4671.90 | 0.00 | |
| 12225.00† | 90.239 | 270.000 | 6877.64 | 4788.01 | 489.32 | -4771.90 | 0.00 | |
| 12325.00† | 90.239 | 270.000 | 6877.22 | 4887.93 | 489.32 | -4871.90 | 0.00 | |

Planned Wellpath Report

DONN 30N-20A-L PWP (REV-B.0)

Page 5 of 6



REFERENCE WELLPATH IDENTIFICATION

| | | | |
|----------|--------------------------------|----------|--|
| Operator | SRC ENERGY | Slot | SLOT#13 DONN 30N-20A-L (738'FNL & 250'FEL, SEC.21) |
| Area | COLORADO | Well | DONN 30N 20A-L |
| Field | WELD COUNTY (NAD83,TRUE NORTH) | Wellbore | DONN 30N-20A-L PWB |
| Facility | SEC.21-T06N-R66W | | |

WELLPATH DATA (191 stations) † = interpolated/extrapolated station

| MD [ft] | Inclination [°] | Azimuth [°] | TVD [ft] | Vert Sect [ft] | North [ft] | East [ft] | DLS [°/100ft] | Comments |
|------------|--------------------|----------------|-------------|-------------------|---------------|--------------|------------------|----------------|
| 12425.00† | 90.239 | 270.000 | 6876.80 | 4987.84 | 489.32 | -4971.90 | 0.00 | |
| 12525.00† | 90.239 | 270.000 | 6876.39 | 5087.75 | 489.32 | -5071.90 | 0.00 | |
| 12625.00† | 90.239 | 270.000 | 6875.97 | 5187.67 | 489.32 | -5171.89 | 0.00 | |
| 12725.00† | 90.239 | 270.000 | 6875.55 | 5287.58 | 489.32 | -5271.89 | 0.00 | |
| 12825.00† | 90.239 | 270.000 | 6875.14 | 5387.50 | 489.32 | -5371.89 | 0.00 | |
| 12925.00† | 90.239 | 270.000 | 6874.72 | 5487.41 | 489.32 | -5471.89 | 0.00 | |
| 13025.00† | 90.239 | 270.000 | 6874.30 | 5587.32 | 489.32 | -5571.89 | 0.00 | |
| 13125.00† | 90.239 | 270.000 | 6873.88 | 5687.24 | 489.32 | -5671.89 | 0.00 | |
| 13225.00† | 90.239 | 270.000 | 6873.47 | 5787.15 | 489.32 | -5771.89 | 0.00 | |
| 13325.00† | 90.239 | 270.000 | 6873.05 | 5887.07 | 489.32 | -5871.89 | 0.00 | |
| 13425.00† | 90.239 | 270.000 | 6872.63 | 5986.98 | 489.32 | -5971.89 | 0.00 | |
| 13525.00† | 90.239 | 270.000 | 6872.22 | 6086.90 | 489.32 | -6071.89 | 0.00 | |
| 13625.00† | 90.239 | 270.000 | 6871.80 | 6186.81 | 489.32 | -6171.89 | 0.00 | |
| 13725.00† | 90.239 | 270.000 | 6871.38 | 6286.72 | 489.32 | -6271.88 | 0.00 | |
| 13825.00† | 90.239 | 270.000 | 6870.96 | 6386.64 | 489.32 | -6371.88 | 0.00 | |
| 13925.00† | 90.239 | 270.000 | 6870.55 | 6486.55 | 489.32 | -6471.88 | 0.00 | |
| 14025.00† | 90.239 | 270.000 | 6870.13 | 6586.47 | 489.32 | -6571.88 | 0.00 | |
| 14125.00† | 90.239 | 270.000 | 6869.71 | 6686.38 | 489.32 | -6671.88 | 0.00 | |
| 14225.00† | 90.239 | 270.000 | 6869.30 | 6786.29 | 489.32 | -6771.88 | 0.00 | |
| 14325.00† | 90.239 | 270.000 | 6868.88 | 6886.21 | 489.32 | -6871.88 | 0.00 | |
| 14358.84 | 90.239 | 270.000 | 6868.74 | 6920.02 | 489.32 | -6905.72 | 0.00 | End of Tangent |
| 14398.87 | 90.239 | 268.799 | 6868.57 | 6959.99 | 488.90 | -6945.74 | 3.00 | End of 3D Arc |
| 14425.00† | 90.239 | 268.799 | 6868.46 | 6986.07 | 488.35 | -6971.87 | 0.00 | |
| 14525.00† | 90.239 | 268.799 | 6868.04 | 7085.88 | 486.26 | -7071.85 | 0.00 | |
| 14625.00† | 90.239 | 268.799 | 6867.63 | 7185.69 | 484.16 | -7171.82 | 0.00 | |
| 14725.00† | 90.239 | 268.799 | 6867.21 | 7285.49 | 482.06 | -7271.80 | 0.00 | |
| 14825.00† | 90.239 | 268.799 | 6866.79 | 7385.30 | 479.97 | -7371.78 | 0.00 | |
| 14925.00† | 90.239 | 268.799 | 6866.38 | 7485.10 | 477.87 | -7471.76 | 0.00 | |
| 15025.00† | 90.239 | 268.799 | 6865.96 | 7584.91 | 475.78 | -7571.73 | 0.00 | |
| 15125.00† | 90.239 | 268.799 | 6865.54 | 7684.71 | 473.68 | -7671.71 | 0.00 | |
| 15225.00† | 90.239 | 268.799 | 6865.12 | 7784.52 | 471.58 | -7771.69 | 0.00 | |
| 15325.00† | 90.239 | 268.799 | 6864.71 | 7884.33 | 469.49 | -7871.66 | 0.00 | |
| 15425.00† | 90.239 | 268.799 | 6864.29 | 7984.13 | 467.39 | -7971.64 | 0.00 | |
| 15525.00† | 90.239 | 268.799 | 6863.87 | 8083.94 | 465.30 | -8071.62 | 0.00 | |
| 15625.00† | 90.239 | 268.799 | 6863.46 | 8183.74 | 463.20 | -8171.60 | 0.00 | |
| 15725.00† | 90.239 | 268.799 | 6863.04 | 8283.55 | 461.10 | -8271.57 | 0.00 | |
| 15825.00† | 90.239 | 268.799 | 6862.62 | 8383.36 | 459.01 | -8371.55 | 0.00 | |
| 15925.00† | 90.239 | 268.799 | 6862.20 | 8483.16 | 456.91 | -8471.53 | 0.00 | |
| 16025.00† | 90.239 | 268.799 | 6861.79 | 8582.97 | 454.82 | -8571.50 | 0.00 | |
| 16125.00† | 90.239 | 268.799 | 6861.37 | 8682.77 | 452.72 | -8671.48 | 0.00 | |
| 16225.00† | 90.239 | 268.799 | 6860.95 | 8782.58 | 450.62 | -8771.46 | 0.00 | |
| 16325.00† | 90.239 | 268.799 | 6860.54 | 8882.38 | 448.53 | -8871.44 | 0.00 | |
| 16425.00† | 90.239 | 268.799 | 6860.12 | 8982.19 | 446.43 | -8971.41 | 0.00 | |
| 16525.00† | 90.239 | 268.799 | 6859.70 | 9082.00 | 444.34 | -9071.39 | 0.00 | |
| 16625.00† | 90.239 | 268.799 | 6859.29 | 9181.80 | 442.24 | -9171.37 | 0.00 | |

Planned Wellpath Report

DONN 30N-20A-L PWP (REV-B.0)

Page 6 of 6



REFERENCE WELLPATH IDENTIFICATION

| | | | |
|----------|--------------------------------|----------|--|
| Operator | SRC ENERGY | Slot | SLOT#13 DONN 30N-20A-L (738'FNL & 250'FEL, SEC.21) |
| Area | COLORADO | Well | DONN 30N 20A-L |
| Field | WELD COUNTY (NAD83,TRUE NORTH) | Wellbore | DONN 30N-20A-L PWB |
| Facility | SEC.21-T06N-R66W | | |

WELLPATH DATA (191 stations) † = interpolated/extrapolated station

| MD [ft] | Inclination [°] | Azimuth [°] | TVD [ft] | Vert Sect [ft] | North [ft] | East [ft] | DLS [°/100ft] | Comments |
|-----------|-----------------|-------------|----------------------|----------------|------------|-----------|---------------|----------------|
| 16725.00† | 90.239 | 268.799 | 6858.87 | 9281.61 | 440.15 | -9271.34 | 0.00 | |
| 16825.00† | 90.239 | 268.799 | 6858.45 | 9381.41 | 438.05 | -9371.32 | 0.00 | |
| 16925.00† | 90.239 | 268.799 | 6858.03 | 9481.22 | 435.95 | -9471.30 | 0.00 | |
| 17025.00† | 90.239 | 268.799 | 6857.62 | 9581.03 | 433.86 | -9571.28 | 0.00 | |
| 17125.00† | 90.239 | 268.799 | 6857.20 | 9680.83 | 431.76 | -9671.25 | 0.00 | |
| 17225.00† | 90.239 | 268.799 | 6856.78 | 9780.64 | 429.67 | -9771.23 | 0.00 | |
| 17325.00† | 90.239 | 268.799 | 6856.37 | 9880.44 | 427.57 | -9871.21 | 0.00 | |
| 17425.00† | 90.239 | 268.799 | 6855.95 | 9980.25 | 425.47 | -9971.18 | 0.00 | |
| 17525.00† | 90.239 | 268.799 | 6855.53 | 10080.05 | 423.38 | -10071.16 | 0.00 | |
| 17625.00† | 90.239 | 268.799 | 6855.11 | 10179.86 | 421.28 | -10171.14 | 0.00 | |
| 17652.35 | 90.239 | 268.799 | 6855.00 ² | 10207.15 | 420.71 | -10198.48 | 0.00 | End of Tangent |

HOLE & CASING SECTIONS

- Ref Wellbore: DONN 30N-20A-L PWB Ref Wellpath: DONN 30N-20A-L PWP (REV-B.0)

| String/Diameter | Start MD [ft] | End MD [ft] | Interval [ft] | Start TVD [ft] | End TVD [ft] | Start N/S [ft] | Start E/W [ft] | End N/S [ft] | End E/W [ft] |
|------------------------|---------------|-------------|---------------|----------------|--------------|----------------|----------------|--------------|--------------|
| 13.5in Open Hole | 25.00 | 1750.00 | 1725.00 | 25.00 | 1733.39 | 0.00 | 0.00 | 136.22 | 166.18 |
| 9.625in Casing Surface | 25.00 | 1750.00 | 1725.00 | 25.00 | 1733.39 | 0.00 | 0.00 | 136.22 | 166.18 |
| 8.5in Open Hole | 1750.00 | 17652.35 | 15902.35 | 1733.39 | 6855.00 | 136.22 | 166.18 | 420.71 | -10198.48 |

TARGETS

| Name | MD [ft] | TVD [ft] | North [ft] | East [ft] | Grid East [US ft] | Grid North [US ft] | Latitude | Longitude | Shape |
|--|----------|----------|------------|-----------|-------------------|--------------------|----------------|-----------------|---------|
| SEC.20-T06N-R66W | | 0.00 | 0.00 | 0.00 | 3201887.93 | 1418212.16 | 40°28'44.854"N | 104°46'27.336"W | polygon |
| SEC.21-T06N-R66W | | 40.00 | -3882.80 | -6166.64 | 3195753.51 | 1414279.17 | 40°28'06.478"N | 104°47'47.123"W | polygon |
| 2) DONN 30N-20A-L BHL ON PLAT (126'FNL & 150'FWL, SEC.20) | 17652.35 | 6855.00 | 420.71 | -10198.48 | 3191686.73 | 1418549.38 | 40°28'48.990"N | 104°48'39.312"W | circle |
| 1) DONN 30N-20A-L TOP OF PROD ON PLAT (79'FNL & 150'FEL, SEC.21) | 7345.18 | 6898.00 | 661.60 | 100.43 | 3201982.94 | 1418874.54 | 40°28'51.391"N | 104°46'26.036"W | circle |

SURVEY PROGRAM -

Ref Wellbore: DONN 30N-20A-L PWB Ref Wellpath: DONN 30N-20A-L PWP (REV-B.0)

| Start MD [ft] | End MD [ft] | Positional Uncertainty Model | Log Name/Comment | Wellbore |
|---------------|-------------|---|------------------|--------------------|
| 25.00 | 1750.00 | Custom BHI NaviTrak (Standard Rotating+Axial Corr) (Rockies 0.03Gt model) | | DONN 30N-20A-L PWB |
| 1750.00 | 17652.35 | Custom BHI AutoTrak Curve (IFR1, Short) (Rockies 0.03Gt model) | | DONN 30N-20A-L PWB |