

Location:	COLORADO	Slot:	SLOT#21 DONN 5N-20B-L (898'FNL & 251'FEL, SEC.21)
Field:	WELD COUNTY (NAD83,TRUE NORTH)	Well:	DONN 5N-20B-L
Facility:	SEC.21-T06N-R66W	Wellbore:	DONN 5N-20B-L PWB

Plot reference wellpath is DONN 5N-208-L PWP (REV.8.0)	Grid System: NAD83 / Lambert Colorado SP, Northern Zone (501), US feet
True vertical depths are referenced to PRECISION DRILLING (25) (RKB)	North Reference: True north
Measured depths are referenced to PRECISION DRILLING (25) (RKB)	Scale: True distance
PRECISION DRILLING (25) (RKB) to Mean Sea Level: 4777 feet	Depths are in feet
Mean Sea Level to Mud line (At Slot: SLOT#21 DONN 5N-208-L (896FNL & 251FEL, SEC.21)): 0 feet	Created by: doddiana on 2017-08-25
Coordinates are in feet referenced to Slot	Database: Denver DB

Facility Name			Grid East (US ft)	Grid North (US ft)	Latitude	Longitude
SEC.21-TD6N-R66W			3201871.604	1417148.268	40°28'34.342"N	104°46'27.660"W
Slot	Local N (ft)	Local E (ft)	Grid East (US ft)	Grid North (US ft)	Latitude	Longitude
SLOT#21 DONN SN-20B-L (898FNL & 251FEL, SEC.21)	903.83	23.92	3201888.131	1418052.230	40°28'43.273"N	104°46'27.350"W
PRECISION DRILLING (25) (RKb) to Mud line (At Slot: SLOT#21 DONN SN-20B-L (898FNL & 251FEL, SEC.21))					4777R	
Mean Sea Level to Mud line (At Slot: SLOT#21 DONN SN-20B-L (898FNL & 251FEL, SEC.21))					0R	
PRECISION DRILLING (25) (RKb) to Mean Sea Level					4777R	

Start MD (ft)	End MD (ft)	Tool	Model	Log Name/Comment	Wellbore
25.00	1750.00	BHI NavTrak	Custom BHI NavTrak (Standard Rotating-Axial Corr) (Rockies 0.03Gt model)		DONN 5N-208-L PWB
1750.00	17820.26	BHI AutoTrak Curve	Custom BHI AutoTrak Curve (FR1, Short) (Rockies 0.03Gt model)		DONN 5N-208-L PWB

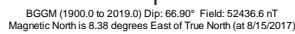

To correct azimuth from Magnetic to True add 8.38 degrees

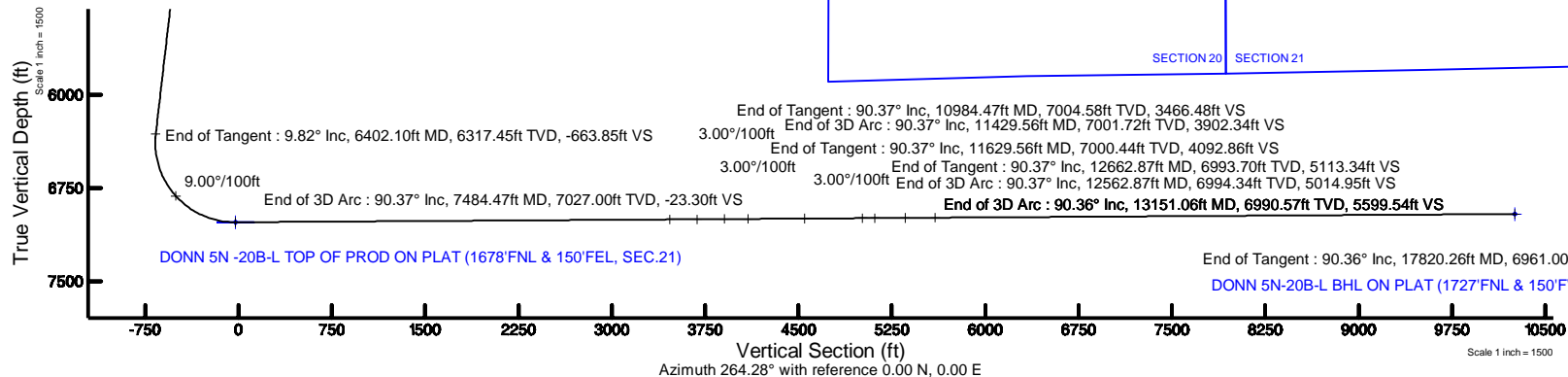

Name	MD (ft)	TVD (ft)	Local N (ft)	Local E (ft)	Grid East (US ft)	Grid North (US ft)	Latitude	Longitude
SEC.20-T06N-R66W		-1.00	159.94	1.11	3201887.93	1418212.16	40°28'44.854"N	104°46'27.336"W
SEC.21-T06N-R66W		39.00	-3722.87	-6165.52	3195753.51	1414279.17	40°28'08.478"N	104°47'47.123"W
DOWN SN-208-L-BH1 ON PLAT (1727FNL & 150FNL, SEC.20)	17820.26	6961.00	-1021.26	-10204.15	3191693.06	1416947.54	40°28'33.161"N	104°48'39.391"W
DOWN SN -208-L TOP OF PROD ON PLAT (1678FNL & 150FEEL, SEC.21)	7484.47	7027.00	-772.04	101.27	3201996.76	1417275.30	40°28'35.587"N	104°48'26.040"W

Name	Start MD (ft)	End MD (ft)	Interval (ft)	Start TVD (ft)	End TVD (ft)	Start Local N (ft)	Start Local E (ft)	End Local N (ft)	End Local E (ft)	Wellbore
13.5in Open Hole	25.00	1750.00	1725.00	25.00	1733.54	0.00	0.00	-139.27	151.20	DONN 5N-20B-L PWB
9.625in Casing Surface	25.00	1750.00	1725.00	25.00	1733.54	0.00	0.00	-139.27	151.20	DONN 5N-20B-L PWB
8.5in Open Hole	1750.00	17820.26	16070.26	1733.54	6961.00	-139.27	151.20	-1021.26	-10204.15	DONN 5N-20B-L PWB

Design Comment	MD (ft)	Inc (°)	Az (°)	TVD (ft)	Local N (ft)	Local E (ft)	DLS (°/100ft)	VS (ft)
Tie On	25.00	0.000	132.648	25.00	0.00	0.00	0.00	0.00
End of Tangent	300.00	0.000	132.648	300.00	0.00	0.00	0.00	0.00
End of Build	791.11	9.822	132.648	788.70	-28.45	30.89	2.00	-27.90
End of Tangent	6402.10	9.822	132.648	6317.45	-676.93	734.92	0.00	-663.85
End of 3D Arc	7484.47	90.367	268.647	7027.00	-777.82	101.27	9.00	-23.30
End of Tangent	10984.47	90.367	268.647	7004.58	-860.46	-3397.69	0.00	3466.48
End of 3D Arc	11429.56	90.367	282.000	7001.72	-819.26	-3839.84	3.00	3902.34
End of Tangent	11629.56	90.367	282.000	7000.44	-777.67	-4035.47	0.00	4092.86
End of 3D Arc	12562.87	90.367	254.000	6994.34	-809.92	-4958.94	3.00	5014.95
End of Tangent	12662.87	90.367	254.000	6993.70	-837.49	-5055.07	0.00	5113.34
End of 3D Arc	13151.06	90.363	268.646	6990.57	-910.93	-5536.35	3.00	5599.54
End of Tangent	17820.26	90.363	268.646	6961.00	-1021.26	-10204.15	0.00	10255.13

~VERSION INFORMATION

VERS. 2.0 : CWLS LOG ASCII STANDARD-VERSION 2.0

WRAP. NO : ASCII DATA SECTION CONTAINS ONE ROW PER WELLPATH STATION

~WELL INFORMATION

#MNEM	.UNITS	DATA	:DESCRIPTION
#----	.-----	----	:-----
STRT	.ft	0.00	:START MD
STOP	.ft	17820.26	:STOP MD
STEP	.ft	0.0	:STEP (non-uniform increment)
NULL	.	-999.99	:NULL
COMP	.	SRC ENERGY	:OPERATOR
WELL	.	DONN 5N-20B-L	:WELL
FLD	.	WELD COUNTY (NAD83,TRUE NORTH)	:FIELD
LOC	.	COLORADO	:AREA (aka: Location)
CNTY	.	N/A	:COUNTY
STAT	.	N/A	:STATE
CTRY	.	N/A	:COUNTRY
SRVC	.	Baker Hughes	:CONTRACTOR
DATE	.	08/17/2017	:LOG REV DATE
API	.		:API NUMBER

~OTHER INFORMATION

#Software: WellArchitect(R) Version 5.1

#MNEM	.UNITS	DATA	:DESCRIPTION
#----	.-----	----	:-----
WPTYPE	.	PLANNED WELLPATH	:WELLPATH TYPE
FACILITY	.	SEC.21-T06N-R66W	:FACILITY
SLOT	.	SLOT#21 DONN 5N-20B-L (898'FNL & 251'FEL, SEC.21)	:SLOT
WELLBORE	.	DONN 5N-20B-L PWB	:WELLBORE
WELLPATH	.	DONN 5N-20B-L PWP (REV-B.0)	:WELLPATH
MDREFPT	.	PRECISION DRILLING (25') (RKB)	:MD REFERENCE POINT
TVDREFPT	.	PRECISION DRILLING (25') (RKB)	:TVD REFERENCE POINT
LCLREFPT	.	Slot	:LOCAL COORDINATE
REFERENCE PT			
VSAZIMUTH.deg		264.28	:VERTICAL SECTION
AZIMUTH			
VSORIGN .ft		0.00	:VERTICAL SECTION
ORIGIN NORTH			
VSORIGE .ft		0.00	:VERTICAL SECTION
ORIGIN EAST			

~CURVE (WELLPATH) INFORMATION

#MNEM	.UNITS	:DESCRIPTION
#----	.-----	:-----
DEPT	.ft	:MEASURED DEPTH
INC	.deg	:INCLINATION
AZI	.deg	:AZIMUTH
TVD	.ft	:TRUE VERTICAL DEPTH
SECT	.ft	:CROSS SECTION (CURTAIN/VERTICAL)
LOCALN	.ft	:LOCAL NORTH

DONN_5N-20B-L_PWP__REV-B.0_.las

LOCALE .ft :LOCAL EAST
 LAT .deg :LATITUDE
 LONG .deg :LONGITUDE
 DLS .deg/100ft :DOGLEG SEVERITY

~ASCII DATA

0.00	0.00	132.65	0.00	0.00	0.00	0.00	40.4786870
-104.7742640	0.00						
25.00	0.00	132.65	25.00	0.00	0.00	0.00	40.4786870
-104.7742640	0.00						
125.00	0.00	132.65	125.00	0.00	0.00	0.00	40.4786870
-104.7742640	0.00						
225.00	0.00	132.65	225.00	0.00	0.00	0.00	40.4786870
-104.7742640	0.00						
300.00	0.00	132.65	300.00	0.00	0.00	0.00	40.4786870
-104.7742640	0.00						
325.00	0.50	132.65	325.00	-0.07	-0.07	0.08	40.4786868
-104.7742637	2.00						
425.00	2.50	132.65	424.96	-1.81	-1.85	2.01	40.4786819
-104.7742568	2.00						
525.00	4.50	132.65	524.77	-5.87	-5.98	6.50	40.4786706
-104.7742407	2.00						
625.00	6.50	132.65	624.30	-12.24	-12.48	13.54	40.4786528
-104.7742153	2.00						
725.00	8.50	132.65	723.44	-20.91	-21.32	23.15	40.4786285
-104.7741808	2.00						
791.11	9.82	132.65	788.70	-27.90	-28.45	30.89	40.4786089
-104.7741530	2.00						
825.00	9.82	132.65	822.10	-31.74	-32.37	35.14	40.4785982
-104.7741377	0.00						
925.00	9.82	132.65	920.64	-43.08	-43.92	47.69	40.4785664
-104.7740926	0.00						
1025.00	9.82	132.65	1019.17	-54.41	-55.48	60.23	40.4785347
-104.7740475	0.00						
1125.00	9.82	132.65	1117.70	-65.74	-67.04	72.78	40.4785030
-104.7740024	0.00						
1225.00	9.82	132.65	1216.24	-77.08	-78.60	85.33	40.4784713
-104.7739573	0.00						
1325.00	9.82	132.65	1314.77	-88.41	-90.15	97.88	40.4784395
-104.7739122	0.00						
1425.00	9.82	132.65	1413.31	-99.75	-101.71	110.42	40.4784078
-104.7738671	0.00						
1525.00	9.82	132.65	1511.84	-111.08	-113.27	122.97	40.4783761
-104.7738220	0.00						
1625.00	9.82	132.65	1610.37	-122.41	-124.83	135.52	40.4783444
-104.7737769	0.00						
1725.00	9.82	132.65	1708.91	-133.75	-136.38	148.07	40.4783126
-104.7737318	0.00						
1825.00	9.82	132.65	1807.44	-145.08	-147.94	160.61	40.4782809
-104.7736867	0.00						
1925.00	9.82	132.65	1905.98	-156.42	-159.50	173.16	40.4782492
-104.7736416	0.00						

DONN_5N-20B-L_PWP__REV-B.0_.las

2025.00	9.82	132.65	2004.51	-167.75	-171.05	185.71	40.4782175
-104.7735965	0.00						
2125.00	9.82	132.65	2103.05	-179.08	-182.61	198.25	40.4781858
-104.7735514	0.00						
2225.00	9.82	132.65	2201.58	-190.42	-194.17	210.80	40.4781540
-104.7735063	0.00						
2325.00	9.82	132.65	2300.11	-201.75	-205.73	223.35	40.4781223
-104.7734612	0.00						
2425.00	9.82	132.65	2398.65	-213.09	-217.28	235.90	40.4780906
-104.7734161	0.00						
2525.00	9.82	132.65	2497.18	-224.42	-228.84	248.44	40.4780589
-104.7733710	0.00						
2625.00	9.82	132.65	2595.72	-235.75	-240.40	260.99	40.4780271
-104.7733259	0.00						
2725.00	9.82	132.65	2694.25	-247.09	-251.96	273.54	40.4779954
-104.7732808	0.00						
2825.00	9.82	132.65	2792.79	-258.42	-263.51	286.09	40.4779637
-104.7732357	0.00						
2925.00	9.82	132.65	2891.32	-269.76	-275.07	298.63	40.4779320
-104.7731906	0.00						
3025.00	9.82	132.65	2989.85	-281.09	-286.63	311.18	40.4779002
-104.7731455	0.00						
3125.00	9.82	132.65	3088.39	-292.42	-298.19	323.73	40.4778685
-104.7731003	0.00						
3225.00	9.82	132.65	3186.92	-303.76	-309.74	336.28	40.4778368
-104.7730552	0.00						
3325.00	9.82	132.65	3285.46	-315.09	-321.30	348.82	40.4778051
-104.7730101	0.00						
3425.00	9.82	132.65	3383.99	-326.43	-332.86	361.37	40.4777733
-104.7729650	0.00						
3525.00	9.82	132.65	3482.52	-337.76	-344.42	373.92	40.4777416
-104.7729199	0.00						
3625.00	9.82	132.65	3581.06	-349.09	-355.97	386.47	40.4777099
-104.7728748	0.00						
3725.00	9.82	132.65	3679.59	-360.43	-367.53	399.01	40.4776782
-104.7728297	0.00						
3825.00	9.82	132.65	3778.13	-371.76	-379.09	411.56	40.4776464
-104.7727846	0.00						
3925.00	9.82	132.65	3876.66	-383.10	-390.65	424.11	40.4776147
-104.7727395	0.00						
4025.00	9.82	132.65	3975.20	-394.43	-402.20	436.65	40.4775830
-104.7726944	0.00						
4125.00	9.82	132.65	4073.73	-405.77	-413.76	449.20	40.4775513
-104.7726493	0.00						
4225.00	9.82	132.65	4172.26	-417.10	-425.32	461.75	40.4775196
-104.7726042	0.00						
4325.00	9.82	132.65	4270.80	-428.43	-436.87	474.30	40.4774878
-104.7725591	0.00						
4425.00	9.82	132.65	4369.33	-439.77	-448.43	486.84	40.4774561
-104.7725140	0.00						
4525.00	9.82	132.65	4467.87	-451.10	-459.99	499.39	40.4774244
-104.7724689	0.00						

DONN_5N-20B-L_PWP__REV-B.0_.las

4625.00	9.82	132.65	4566.40	-462.44	-471.55	511.94	40.4773927
-104.7724238	0.00						
4725.00	9.82	132.65	4664.94	-473.77	-483.10	524.49	40.4773609
-104.7723787	0.00						
4825.00	9.82	132.65	4763.47	-485.10	-494.66	537.03	40.4773292
-104.7723336	0.00						
4925.00	9.82	132.65	4862.00	-496.44	-506.22	549.58	40.4772975
-104.7722885	0.00						
5025.00	9.82	132.65	4960.54	-507.77	-517.78	562.13	40.4772658
-104.7722434	0.00						
5125.00	9.82	132.65	5059.07	-519.11	-529.33	574.68	40.4772340
-104.7721983	0.00						
5225.00	9.82	132.65	5157.61	-530.44	-540.89	587.22	40.4772023
-104.7721532	0.00						
5325.00	9.82	132.65	5256.14	-541.77	-552.45	599.77	40.4771706
-104.7721081	0.00						
5425.00	9.82	132.65	5354.67	-553.11	-564.01	612.32	40.4771389
-104.7720630	0.00						
5525.00	9.82	132.65	5453.21	-564.44	-575.56	624.87	40.4771071
-104.7720179	0.00						
5625.00	9.82	132.65	5551.74	-575.78	-587.12	637.41	40.4770754
-104.7719728	0.00						
5725.00	9.82	132.65	5650.28	-587.11	-598.68	649.96	40.4770437
-104.7719277	0.00						
5825.00	9.82	132.65	5748.81	-598.44	-610.24	662.51	40.4770120
-104.7718826	0.00						
5925.00	9.82	132.65	5847.35	-609.78	-621.79	675.05	40.4769802
-104.7718375	0.00						
6025.00	9.82	132.65	5945.88	-621.11	-633.35	687.60	40.4769485
-104.7717924	0.00						
6125.00	9.82	132.65	6044.41	-632.45	-644.91	700.15	40.4769168
-104.7717473	0.00						
6225.00	9.82	132.65	6142.95	-643.78	-656.46	712.70	40.4768851
-104.7717022	0.00						
6325.00	9.82	132.65	6241.48	-655.11	-668.02	725.24	40.4768533
-104.7716571	0.00						
6402.10	9.82	132.65	6317.45	-663.85	-676.93	734.92	40.4768289
-104.7716224	0.00						
6425.00	8.47	142.49	6340.06	-666.04	-679.60	737.38	40.4768216
-104.7716135	9.00						
6525.00	7.95	209.05	6439.24	-665.98	-691.51	738.51	40.4767889
-104.7716094	9.00						
6625.00	14.69	241.27	6537.33	-650.34	-703.67	724.01	40.4767555
-104.7716616	9.00						
6725.00	23.01	252.14	6631.91	-619.50	-715.79	694.23	40.4767222
-104.7717686	9.00						
6825.00	31.69	257.36	6720.66	-574.22	-727.55	649.90	40.4766899
-104.7719280	9.00						
6925.00	40.50	260.50	6801.38	-515.61	-738.68	592.12	40.4766594
-104.7721357	9.00						
7025.00	49.37	262.68	6872.10	-445.13	-748.90	522.31	40.4766314
-104.7723866	9.00						

DONN_5N-20B-L_PWP__REV-B.0_.las

7125.00	58.27	264.33	6931.07	-364.50	-757.95	442.18	40.4766065
-104.7726746	9.00						
7225.00	67.19	265.70	6976.84	-275.72	-765.62	353.72	40.4765855
-104.7729926	9.00						
7325.00	76.12	266.90	7008.29	-180.95	-771.71	259.09	40.4765687
-104.7733327	9.00						
7425.00	85.05	268.01	7024.62	-82.55	-776.08	160.64	40.4765568
-104.7736866	9.00						
7484.47	90.37	268.65	7027.00	-23.30	-777.82	101.27	40.4765520
-104.7739000	9.00						
7525.00	90.37	268.65	7026.74	17.11	-778.77	60.75	40.4765494
-104.7740457	0.00						
7625.00	90.37	268.65	7026.10	116.82	-781.13	-39.22	40.4765429
-104.7744050	0.00						
7725.00	90.37	268.65	7025.46	216.53	-783.50	-139.19	40.4765364
-104.7747643	0.00						
7825.00	90.37	268.65	7024.82	316.24	-785.86	-239.16	40.4765299
-104.7751237	0.00						
7925.00	90.37	268.65	7024.18	415.94	-788.22	-339.13	40.4765234
-104.7754830	0.00						
8025.00	90.37	268.65	7023.54	515.65	-790.58	-439.10	40.4765170
-104.7758423	0.00						
8125.00	90.37	268.65	7022.90	615.36	-792.94	-539.08	40.4765105
-104.7762017	0.00						
8225.00	90.37	268.65	7022.26	715.07	-795.30	-639.05	40.4765040
-104.7765610	0.00						
8325.00	90.37	268.65	7021.62	814.78	-797.66	-739.02	40.4764975
-104.7769204	0.00						
8425.00	90.37	268.65	7020.98	914.49	-800.02	-838.99	40.4764910
-104.7772797	0.00						
8525.00	90.37	268.65	7020.34	1014.19	-802.39	-938.96	40.4764845
-104.7776390	0.00						
8625.00	90.37	268.65	7019.69	1113.90	-804.75	-1038.93	40.4764780
-104.7779984	0.00						
8725.00	90.37	268.65	7019.05	1213.61	-807.11	-1138.90	40.4764715
-104.7783577	0.00						
8825.00	90.37	268.65	7018.41	1313.32	-809.47	-1238.87	40.4764650
-104.7787170	0.00						
8925.00	90.37	268.65	7017.77	1413.03	-811.83	-1338.84	40.4764585
-104.7790764	0.00						
9025.00	90.37	268.65	7017.13	1512.73	-814.19	-1438.81	40.4764520
-104.7794357	0.00						
9125.00	90.37	268.65	7016.49	1612.44	-816.55	-1538.78	40.4764455
-104.7797951	0.00						
9225.00	90.37	268.65	7015.85	1712.15	-818.91	-1638.75	40.4764390
-104.7801544	0.00						
9325.00	90.37	268.65	7015.21	1811.86	-821.27	-1738.72	40.4764325
-104.7805137	0.00						
9425.00	90.37	268.65	7014.57	1911.57	-823.64	-1838.69	40.4764260
-104.7808731	0.00						
9525.00	90.37	268.65	7013.93	2011.28	-826.00	-1938.66	40.4764195
-104.7812324	0.00						

DONN_5N-20B-L_PWP__REV-B.0_.las

9625.00	90.37	268.65	7013.29	2110.98	-828.36	-2038.63	40.4764130
-104.7815917	0.00						
9725.00	90.37	268.65	7012.65	2210.69	-830.72	-2138.60	40.4764065
-104.7819511	0.00						
9825.00	90.37	268.65	7012.01	2310.40	-833.08	-2238.57	40.4764000
-104.7823104	0.00						
9925.00	90.37	268.65	7011.37	2410.11	-835.44	-2338.54	40.4763935
-104.7826697	0.00						
10025.00	90.37	268.65	7010.73	2509.82	-837.80	-2438.51	40.4763870
-104.7830291	0.00						
10125.00	90.37	268.65	7010.09	2609.53	-840.16	-2538.48	40.4763805
-104.7833884	0.00						
10225.00	90.37	268.65	7009.45	2709.23	-842.53	-2638.45	40.4763740
-104.7837478	0.00						
10325.00	90.37	268.65	7008.81	2808.94	-844.89	-2738.42	40.4763675
-104.7841071	0.00						
10425.00	90.37	268.65	7008.16	2908.65	-847.25	-2838.39	40.4763610
-104.7844664	0.00						
10525.00	90.37	268.65	7007.52	3008.36	-849.61	-2938.36	40.4763545
-104.7848258	0.00						
10625.00	90.37	268.65	7006.88	3108.07	-851.97	-3038.33	40.4763479
-104.7851851	0.00						
10725.00	90.37	268.65	7006.24	3207.78	-854.33	-3138.30	40.4763414
-104.7855444	0.00						
10825.00	90.37	268.65	7005.60	3307.48	-856.69	-3238.27	40.4763349
-104.7859038	0.00						
10925.00	90.37	268.65	7004.96	3407.19	-859.05	-3338.24	40.4763284
-104.7862631	0.00						
10984.47	90.37	268.65	7004.58	3466.48	-860.46	-3397.69	40.4763245
-104.7864768	0.00						
11025.00	90.37	269.86	7004.32	3506.86	-860.98	-3438.21	40.4763231
-104.7866225	3.00						
11125.00	90.37	272.86	7003.68	3606.09	-858.61	-3538.17	40.4763295
-104.7869818	3.00						
11225.00	90.37	275.86	7003.03	3704.53	-851.00	-3637.87	40.4763504
-104.7873401	3.00						
11325.00	90.37	278.86	7002.39	3801.93	-838.18	-3737.03	40.4763855
-104.7876966	3.00						
11425.00	90.37	281.86	7001.75	3898.00	-820.20	-3835.39	40.4764348
-104.7880501	3.00						
11429.56	90.37	282.00	7001.72	3902.34	-819.26	-3839.84	40.4764374
-104.7880661	3.00						
11525.00	90.37	282.00	7001.11	3993.26	-799.41	-3933.20	40.4764919
-104.7884017	0.00						
11625.00	90.37	282.00	7000.47	4088.51	-778.62	-4031.01	40.4765489
-104.7887533	0.00						
11629.56	90.37	282.00	7000.44	4092.86	-777.67	-4035.47	40.4765515
-104.7887693	0.00						
11725.00	90.37	279.14	6999.82	4184.46	-760.17	-4129.28	40.4765995
-104.7891065	3.00						
11825.00	90.37	276.14	6999.17	4281.74	-746.88	-4228.38	40.4766359
-104.7894628	3.00						

DONN_5N-20B-L_PWP__REV-B.0_.las

11925.00	90.38	273.14	6998.52	4380.10	-738.80	-4328.04	40.4766580
-104.7898210	3.00						
12025.00	90.38	270.14	6997.86	4479.27	-735.95	-4427.99	40.4766658
-104.7901802	3.00						
12125.00	90.38	267.14	6997.20	4578.96	-738.33	-4527.95	40.4766593
-104.7905395	3.00						
12225.00	90.38	264.14	6996.54	4678.92	-745.93	-4627.64	40.4766383
-104.7908979	3.00						
12325.00	90.38	261.14	6995.88	4778.87	-758.75	-4726.80	40.4766031
-104.7912543	3.00						
12425.00	90.37	258.14	6995.23	4878.52	-776.74	-4825.16	40.4765537
-104.7916078	3.00						
12525.00	90.37	255.14	6994.58	4977.62	-799.85	-4922.44	40.4764902
-104.7919575	3.00						
12562.87	90.37	254.00	6994.34	5014.95	-809.92	-4958.94	40.4764625
-104.7920887	3.00						
12625.00	90.37	254.00	6993.94	5076.08	-827.05	-5018.66	40.4764155
-104.7923033	0.00						
12662.87	90.37	254.00	6993.70	5113.34	-837.49	-5055.07	40.4763868
-104.7924342	0.00						
12725.00	90.37	255.86	6993.30	5174.64	-853.64	-5115.06	40.4763424
-104.7926498	3.00						
12825.00	90.37	258.86	6992.65	5273.90	-875.51	-5212.62	40.4762823
-104.7930005	3.00						
12925.00	90.37	261.86	6992.01	5373.65	-892.25	-5311.20	40.4762363
-104.7933548	3.00						
13025.00	90.37	264.86	6991.37	5473.62	-903.80	-5410.51	40.4762046
-104.7937117	3.00						
13125.00	90.36	267.86	6990.73	5573.54	-910.14	-5510.30	40.4761871
-104.7940704	3.00						
13151.06	90.36	268.65	6990.57	5599.54	-910.93	-5536.35	40.4761849
-104.7941641	3.00						
13225.00	90.36	268.65	6990.10	5673.26	-912.68	-5610.26	40.4761801
-104.7944297	0.00						
13325.00	90.36	268.65	6989.47	5772.97	-915.04	-5710.23	40.4761735
-104.7947891	0.00						
13425.00	90.36	268.65	6988.83	5872.68	-917.41	-5810.20	40.4761670
-104.7951484	0.00						
13525.00	90.36	268.65	6988.20	5972.39	-919.77	-5910.17	40.4761604
-104.7955077	0.00						
13625.00	90.36	268.65	6987.57	6072.10	-922.13	-6010.14	40.4761539
-104.7958671	0.00						
13725.00	90.36	268.65	6986.93	6171.81	-924.50	-6110.11	40.4761473
-104.7962264	0.00						
13825.00	90.36	268.65	6986.30	6271.51	-926.86	-6210.08	40.4761408
-104.7965857	0.00						
13925.00	90.36	268.65	6985.67	6371.22	-929.22	-6310.05	40.4761342
-104.7969451	0.00						
14025.00	90.36	268.65	6985.03	6470.93	-931.58	-6410.02	40.4761276
-104.7973044	0.00						
14125.00	90.36	268.65	6984.40	6570.64	-933.95	-6509.99	40.4761211
-104.7976637	0.00						

DONN_5N-20B-L_PWP__REV-B.0_.las

14225.00	90.36	268.65	6983.77	6670.35	-936.31	-6609.96	40.4761145
-104.7980231	0.00						
14325.00	90.36	268.65	6983.14	6770.06	-938.67	-6709.93	40.4761080
-104.7983824	0.00						
14425.00	90.36	268.65	6982.50	6869.77	-941.03	-6809.90	40.4761014
-104.7987417	0.00						
14525.00	90.36	268.65	6981.87	6969.47	-943.40	-6909.87	40.4760948
-104.7991011	0.00						
14625.00	90.36	268.65	6981.24	7069.18	-945.76	-7009.84	40.4760883
-104.7994604	0.00						
14725.00	90.36	268.65	6980.60	7168.89	-948.12	-7109.81	40.4760817
-104.7998197	0.00						
14825.00	90.36	268.65	6979.97	7268.60	-950.49	-7209.78	40.4760752
-104.8001791	0.00						
14925.00	90.36	268.65	6979.34	7368.31	-952.85	-7309.75	40.4760686
-104.8005384	0.00						
15025.00	90.36	268.65	6978.70	7468.02	-955.21	-7409.72	40.4760620
-104.8008977	0.00						
15125.00	90.36	268.65	6978.07	7567.72	-957.57	-7509.69	40.4760555
-104.8012571	0.00						
15225.00	90.36	268.65	6977.44	7667.43	-959.94	-7609.66	40.4760489
-104.8016164	0.00						
15325.00	90.36	268.65	6976.80	7767.14	-962.30	-7709.63	40.4760423
-104.8019757	0.00						
15425.00	90.36	268.65	6976.17	7866.85	-964.66	-7809.60	40.4760357
-104.8023351	0.00						
15525.00	90.36	268.65	6975.54	7966.56	-967.02	-7909.57	40.4760292
-104.8026944	0.00						
15625.00	90.36	268.65	6974.90	8066.27	-969.39	-8009.54	40.4760226
-104.8030537	0.00						
15725.00	90.36	268.65	6974.27	8165.97	-971.75	-8109.51	40.4760160
-104.8034131	0.00						
15825.00	90.36	268.65	6973.64	8265.68	-974.11	-8209.49	40.4760094
-104.8037724	0.00						
15925.00	90.36	268.65	6973.00	8365.39	-976.48	-8309.46	40.4760029
-104.8041317	0.00						
16025.00	90.36	268.65	6972.37	8465.10	-978.84	-8409.43	40.4759963
-104.8044911	0.00						
16125.00	90.36	268.65	6971.74	8564.81	-981.20	-8509.40	40.4759897
-104.8048504	0.00						
16225.00	90.36	268.65	6971.10	8664.52	-983.56	-8609.37	40.4759831
-104.8052097	0.00						
16325.00	90.36	268.65	6970.47	8764.23	-985.93	-8709.34	40.4759765
-104.8055691	0.00						
16425.00	90.36	268.65	6969.84	8863.93	-988.29	-8809.31	40.4759700
-104.8059284	0.00						
16525.00	90.36	268.65	6969.20	8963.64	-990.65	-8909.28	40.4759634
-104.8062877	0.00						
16625.00	90.36	268.65	6968.57	9063.35	-993.02	-9009.25	40.4759568
-104.8066471	0.00						
16725.00	90.36	268.65	6967.94	9163.06	-995.38	-9109.22	40.4759502
-104.8070064	0.00						

DONN_5N-20B-L_PWP__REV-B.0_.las

16825.00	90.36	268.65	6967.30	9262.77	-997.74	-9209.19	40.4759436
-104.8073657	0.00						
16925.00	90.36	268.65	6966.67	9362.48	-1000.10	-9309.16	40.4759370
-104.8077250	0.00						
17025.00	90.36	268.65	6966.04	9462.18	-1002.47	-9409.13	40.4759304
-104.8080844	0.00						
17125.00	90.36	268.65	6965.40	9561.89	-1004.83	-9509.10	40.4759239
-104.8084437	0.00						
17225.00	90.36	268.65	6964.77	9661.60	-1007.19	-9609.07	40.4759173
-104.8088030	0.00						
17325.00	90.36	268.65	6964.14	9761.31	-1009.55	-9709.04	40.4759107
-104.8091624	0.00						
17425.00	90.36	268.65	6963.50	9861.02	-1011.92	-9809.01	40.4759041
-104.8095217	0.00						
17525.00	90.36	268.65	6962.87	9960.73	-1014.28	-9908.98	40.4758975
-104.8098810	0.00						
17625.00	90.36	268.65	6962.24	10060.43	-1016.64	-10008.95	40.4758909
-104.8102404	0.00						
17725.00	90.36	268.65	6961.60	10160.14	-1019.01	-10108.92	40.4758843
-104.8105997	0.00						
17820.26	90.36	268.65	6961.00	10255.13	-1021.26	-10204.15	40.4758780
-104.8109420	0.00						

Planned Wellpath Report

DONN 5N-20B-L PWP (REV-B.0)

Page 1 of 6



REFERENCE WELLPATH IDENTIFICATION

Operator	SRC ENERGY	Slot	SLOT#21 DONN 5N-20B-L (898'FNL & 251'FEL, SEC.21)
Area	COLORADO	Well	DONN 5N-20B-L
Field	WELD COUNTY (NAD83,TRUE NORTH)	Wellbore	DONN 5N-20B-L PWB
Facility	SEC.21-T06N-R66W		

REPORT SETUP INFORMATION

Projection System	NAD83 / Lambert Colorado SP, Northern Zone (501), US feet	Software System	WellArchitect® 5.1
North Reference	True	User	Doddanna
Scale	0.999965	Report Generated	8/25/2017 at 10:24:36 AM
Convergence at slot	0.47° East	Database/Source file	Denver DB/DONN_5N-20B-L_PWP__REV-B.0_.xml

WELLPATH LOCATION

	Local coordinates		Grid coordinates		Geographic coordinates	
	North[ft]	East[ft]	Easting[US ft]	Northing[US ft]	Latitude	Longitude
Slot Location	903.83	23.92	3201888.13	1418052.23	40°28'43.273"N	104°46'27.350"W
Facility Reference Pt			3201871.60	1417148.27	40°28'34.342"N	104°46'27.660"W
Field Reference Pt			3171284.48	1426358.81	40°30'07.643"N	104°53'02.634"W

WELLPATH DATUM

Calculation method	Minimum curvature	PRECISION DRILLING (25') (RKB) to Facility Vertical Datum	4777.00ft
Horizontal Reference Pt	Slot	PRECISION DRILLING (25') (RKB) to Mean Sea Level	4777.00ft
Vertical Reference Pt	PRECISION DRILLING (25') (RKB)	PRECISION DRILLING (25') (RKB) to Mud Line at Slot (SLOT#21 DONN 5N-20B-L (898'FNL & 251'FEL, SEC.21))	4777.00ft
MD Reference Pt	PRECISION DRILLING (25') (RKB)	Section Origin	N 0.00, E 0.00 ft
Field Vertical Reference	Mean Sea Level	Section Azimuth	264.28°

Planned Wellpath Report

DONN 5N-20B-L PWP (REV-B.0)

Page 2 of 6



REFERENCE WELLPATH IDENTIFICATION

Operator	SRC ENERGY	Slot	SLOT#21 DONN 5N-20B-L (898'FNL & 251'FEL, SEC.21)
Area	COLORADO	Well	DONN 5N-20B-L
Field	WELD COUNTY (NAD83,TRUE NORTH)	Wellbore	DONN 5N-20B-L PWB
Facility	SEC.21-T06N-R66W		

WELLPATH DATA (190 stations) † = interpolated/extrapolated station

MD [ft]	Inclination [°]	Azimuth [°]	TVD [ft]	Vert Sect [ft]	North [ft]	East [ft]	DLS [°/100ft]	Comments
0.00†	0.000	132.648	0.00	0.00	0.00	0.00	0.00	
25.00	0.000	132.648	25.00	0.00	0.00	0.00	0.00	Tie On
125.00†	0.000	132.648	125.00	0.00	0.00	0.00	0.00	
225.00†	0.000	132.648	225.00	0.00	0.00	0.00	0.00	
300.00	0.000	132.648	300.00	0.00	0.00	0.00	0.00	End of Tangent
325.00†	0.500	132.648	325.00	-0.07	-0.07	0.08	2.00	
425.00†	2.500	132.648	424.96	-1.81	-1.85	2.01	2.00	
525.00†	4.500	132.648	524.77	-5.87	-5.98	6.50	2.00	
625.00†	6.500	132.648	624.30	-12.24	-12.48	13.54	2.00	
725.00†	8.500	132.648	723.44	-20.91	-21.32	23.15	2.00	
791.11	9.822	132.648	788.70	-27.90	-28.45	30.89	2.00	End of Build
825.00†	9.822	132.648	822.10	-31.74	-32.37	35.14	0.00	
925.00†	9.822	132.648	920.64	-43.08	-43.92	47.69	0.00	
1025.00†	9.822	132.648	1019.17	-54.41	-55.48	60.23	0.00	
1125.00†	9.822	132.648	1117.70	-65.74	-67.04	72.78	0.00	
1225.00†	9.822	132.648	1216.24	-77.08	-78.60	85.33	0.00	
1325.00†	9.822	132.648	1314.77	-88.41	-90.15	97.88	0.00	
1425.00†	9.822	132.648	1413.31	-99.75	-101.71	110.42	0.00	
1525.00†	9.822	132.648	1511.84	-111.08	-113.27	122.97	0.00	
1625.00†	9.822	132.648	1610.37	-122.41	-124.83	135.52	0.00	
1725.00†	9.822	132.648	1708.91	-133.75	-136.38	148.07	0.00	
1825.00†	9.822	132.648	1807.44	-145.08	-147.94	160.61	0.00	
1925.00†	9.822	132.648	1905.98	-156.42	-159.50	173.16	0.00	
2025.00†	9.822	132.648	2004.51	-167.75	-171.05	185.71	0.00	
2125.00†	9.822	132.648	2103.05	-179.08	-182.61	198.25	0.00	
2225.00†	9.822	132.648	2201.58	-190.42	-194.17	210.80	0.00	
2325.00†	9.822	132.648	2300.11	-201.75	-205.73	223.35	0.00	
2425.00†	9.822	132.648	2398.65	-213.09	-217.28	235.90	0.00	
2525.00†	9.822	132.648	2497.18	-224.42	-228.84	248.44	0.00	
2625.00†	9.822	132.648	2595.72	-235.75	-240.40	260.99	0.00	
2725.00†	9.822	132.648	2694.25	-247.09	-251.96	273.54	0.00	
2825.00†	9.822	132.648	2792.79	-258.42	-263.51	286.09	0.00	
2925.00†	9.822	132.648	2891.32	-269.76	-275.07	298.63	0.00	
3025.00†	9.822	132.648	2989.85	-281.09	-286.63	311.18	0.00	
3125.00†	9.822	132.648	3088.39	-292.42	-298.19	323.73	0.00	
3225.00†	9.822	132.648	3186.92	-303.76	-309.74	336.28	0.00	
3325.00†	9.822	132.648	3285.46	-315.09	-321.30	348.82	0.00	
3425.00†	9.822	132.648	3383.99	-326.43	-332.86	361.37	0.00	
3525.00†	9.822	132.648	3482.52	-337.76	-344.42	373.92	0.00	
3625.00†	9.822	132.648	3581.06	-349.09	-355.97	386.47	0.00	
3725.00†	9.822	132.648	3679.59	-360.43	-367.53	399.01	0.00	
3825.00†	9.822	132.648	3778.13	-371.76	-379.09	411.56	0.00	
3925.00†	9.822	132.648	3876.66	-383.10	-390.65	424.11	0.00	
4025.00†	9.822	132.648	3975.20	-394.43	-402.20	436.65	0.00	
4125.00†	9.822	132.648	4073.73	-405.77	-413.76	449.20	0.00	

Planned Wellpath Report

DONN 5N-20B-L PWP (REV-B.0)

Page 3 of 6



REFERENCE WELLPATH IDENTIFICATION

Operator	SRC ENERGY	Slot	SLOT#21 DONN 5N-20B-L (898'FNL & 251'FEL, SEC.21)
Area	COLORADO	Well	DONN 5N-20B-L
Field	WELD COUNTY (NAD83,TRUE NORTH)	Wellbore	DONN 5N-20B-L PWB
Facility	SEC.21-T06N-R66W		

WELLPATH DATA (190 stations) † = interpolated/extrapolated station

MD [ft]	Inclination [°]	Azimuth [°]	TVD [ft]	Vert Sect [ft]	North [ft]	East [ft]	DLS [°/100ft]	Comments
4225.00†	9.822	132.648	4172.26	-417.10	-425.32	461.75	0.00	
4325.00†	9.822	132.648	4270.80	-428.43	-436.87	474.30	0.00	
4425.00†	9.822	132.648	4369.33	-439.77	-448.43	486.84	0.00	
4525.00†	9.822	132.648	4467.87	-451.10	-459.99	499.39	0.00	
4625.00†	9.822	132.648	4566.40	-462.44	-471.55	511.94	0.00	
4725.00†	9.822	132.648	4664.94	-473.77	-483.10	524.49	0.00	
4825.00†	9.822	132.648	4763.47	-485.10	-494.66	537.03	0.00	
4925.00†	9.822	132.648	4862.00	-496.44	-506.22	549.58	0.00	
5025.00†	9.822	132.648	4960.54	-507.77	-517.78	562.13	0.00	
5125.00†	9.822	132.648	5059.07	-519.11	-529.33	574.68	0.00	
5225.00†	9.822	132.648	5157.61	-530.44	-540.89	587.22	0.00	
5325.00†	9.822	132.648	5256.14	-541.77	-552.45	599.77	0.00	
5425.00†	9.822	132.648	5354.67	-553.11	-564.01	612.32	0.00	
5525.00†	9.822	132.648	5453.21	-564.44	-575.56	624.87	0.00	
5625.00†	9.822	132.648	5551.74	-575.78	-587.12	637.41	0.00	
5725.00†	9.822	132.648	5650.28	-587.11	-598.68	649.96	0.00	
5825.00†	9.822	132.648	5748.81	-598.44	-610.24	662.51	0.00	
5925.00†	9.822	132.648	5847.35	-609.78	-621.79	675.05	0.00	
6025.00†	9.822	132.648	5945.88	-621.11	-633.35	687.60	0.00	
6125.00†	9.822	132.648	6044.41	-632.45	-644.91	700.15	0.00	
6225.00†	9.822	132.648	6142.95	-643.78	-656.46	712.70	0.00	
6325.00†	9.822	132.648	6241.48	-655.11	-668.02	725.24	0.00	
6402.10	9.822	132.648	6317.45	-663.85	-676.93	734.92	0.00	End of Tangent
6425.00†	8.474	142.492	6340.06	-666.04	-679.60	737.38	9.00	
6525.00†	7.948	209.048	6439.24	-665.98	-691.51	738.51	9.00	
6625.00†	14.688	241.269	6537.33	-650.34	-703.67	724.01	9.00	
6725.00†	23.012	252.140	6631.91	-619.50	-715.79	694.23	9.00	
6825.00†	31.694	257.362	6720.66	-574.22	-727.55	649.90	9.00	
6925.00†	40.504	260.503	6801.38	-515.61	-738.68	592.12	9.00	
7025.00†	49.373	262.676	6872.10	-445.13	-748.90	522.31	9.00	
7125.00†	58.274	264.335	6931.07	-364.50	-757.95	442.18	9.00	
7225.00†	67.192	265.701	6976.84	-275.72	-765.62	353.72	9.00	
7325.00†	76.120	266.898	7008.29	-180.95	-771.71	259.09	9.00	
7425.00†	85.053	268.006	7024.62	-82.55	-776.08	160.64	9.00	
7484.47	90.367	268.647	7027.00 ¹	-23.30	-777.82	101.27	9.00	End of 3D Arc
7525.00†	90.367	268.647	7026.74	17.11	-778.77	60.75	0.00	
7625.00†	90.367	268.647	7026.10	116.82	-781.13	-39.22	0.00	
7725.00†	90.367	268.647	7025.46	216.53	-783.50	-139.19	0.00	
7825.00†	90.367	268.647	7024.82	316.24	-785.86	-239.16	0.00	
7925.00†	90.367	268.647	7024.18	415.94	-788.22	-339.13	0.00	
8025.00†	90.367	268.647	7023.54	515.65	-790.58	-439.10	0.00	
8125.00†	90.367	268.647	7022.90	615.36	-792.94	-539.08	0.00	
8225.00†	90.367	268.647	7022.26	715.07	-795.30	-639.05	0.00	
8325.00†	90.367	268.647	7021.62	814.78	-797.66	-739.02	0.00	
8425.00†	90.367	268.647	7020.98	914.49	-800.02	-838.99	0.00	

Planned Wellpath Report

DONN 5N-20B-L PWP (REV-B.0)

Page 4 of 6



REFERENCE WELLPATH IDENTIFICATION

Operator	SRC ENERGY	Slot	SLOT#21 DONN 5N-20B-L (898'FNL & 251'FEL, SEC.21)
Area	COLORADO	Well	DONN 5N-20B-L
Field	WELD COUNTY (NAD83,TRUE NORTH)	Wellbore	DONN 5N-20B-L PWB
Facility	SEC.21-T06N-R66W		

WELLPATH DATA (190 stations) † = interpolated/extrapolated station

MD [ft]	Inclination [°]	Azimuth [°]	TVD [ft]	Vert Sect [ft]	North [ft]	East [ft]	DLS [°/100ft]	Comments
8525.00†	90.367	268.647	7020.34	1014.19	-802.39	-938.96	0.00	
8625.00†	90.367	268.647	7019.69	1113.90	-804.75	-1038.93	0.00	
8725.00†	90.367	268.647	7019.05	1213.61	-807.11	-1138.90	0.00	
8825.00†	90.367	268.647	7018.41	1313.32	-809.47	-1238.87	0.00	
8925.00†	90.367	268.647	7017.77	1413.03	-811.83	-1338.84	0.00	
9025.00†	90.367	268.647	7017.13	1512.73	-814.19	-1438.81	0.00	
9125.00†	90.367	268.647	7016.49	1612.44	-816.55	-1538.78	0.00	
9225.00†	90.367	268.647	7015.85	1712.15	-818.91	-1638.75	0.00	
9325.00†	90.367	268.647	7015.21	1811.86	-821.27	-1738.72	0.00	
9425.00†	90.367	268.647	7014.57	1911.57	-823.64	-1838.69	0.00	
9525.00†	90.367	268.647	7013.93	2011.28	-826.00	-1938.66	0.00	
9625.00†	90.367	268.647	7013.29	2110.98	-828.36	-2038.63	0.00	
9725.00†	90.367	268.647	7012.65	2210.69	-830.72	-2138.60	0.00	
9825.00†	90.367	268.647	7012.01	2310.40	-833.08	-2238.57	0.00	
9925.00†	90.367	268.647	7011.37	2410.11	-835.44	-2338.54	0.00	
10025.00†	90.367	268.647	7010.73	2509.82	-837.80	-2438.51	0.00	
10125.00†	90.367	268.647	7010.09	2609.53	-840.16	-2538.48	0.00	
10225.00†	90.367	268.647	7009.45	2709.23	-842.53	-2638.45	0.00	
10325.00†	90.367	268.647	7008.81	2808.94	-844.89	-2738.42	0.00	
10425.00†	90.367	268.647	7008.16	2908.65	-847.25	-2838.39	0.00	
10525.00†	90.367	268.647	7007.52	3008.36	-849.61	-2938.36	0.00	
10625.00†	90.367	268.647	7006.88	3108.07	-851.97	-3038.33	0.00	
10725.00†	90.367	268.647	7006.24	3207.78	-854.33	-3138.30	0.00	
10825.00†	90.367	268.647	7005.60	3307.48	-856.69	-3238.27	0.00	
10925.00†	90.367	268.647	7004.96	3407.19	-859.05	-3338.24	0.00	
10984.47	90.367	268.647	7004.58	3466.48	-860.46	-3397.69	0.00	End of Tangent
11025.00†	90.368	269.863	7004.32	3506.86	-860.98	-3438.21	3.00	
11125.00†	90.369	272.863	7003.68	3606.09	-858.61	-3538.17	3.00	
11225.00†	90.369	275.863	7003.03	3704.53	-851.00	-3637.87	3.00	
11325.00†	90.369	278.863	7002.39	3801.93	-838.18	-3737.03	3.00	
11425.00†	90.367	281.863	7001.75	3898.00	-820.20	-3835.39	3.00	
11429.56	90.367	282.000	7001.72	3902.34	-819.26	-3839.84	3.00	End of 3D Arc
11525.00†	90.367	282.000	7001.11	3993.26	-799.41	-3933.20	0.00	
11625.00†	90.367	282.000	7000.47	4088.51	-778.62	-4031.01	0.00	
11629.56	90.367	282.000	7000.44	4092.86	-777.67	-4035.47	0.00	End of Tangent
11725.00†	90.371	279.137	6999.82	4184.46	-760.17	-4129.28	3.00	
11825.00†	90.374	276.137	6999.17	4281.74	-746.88	-4228.38	3.00	
11925.00†	90.377	273.137	6998.52	4380.10	-738.80	-4328.04	3.00	
12025.00†	90.378	270.136	6997.86	4479.27	-735.95	-4427.99	3.00	
12125.00†	90.378	267.136	6997.20	4578.96	-738.33	-4527.95	3.00	
12225.00†	90.377	264.136	6996.54	4678.92	-745.93	-4627.64	3.00	
12325.00†	90.376	261.136	6995.88	4778.87	-758.75	-4726.80	3.00	
12425.00†	90.373	258.136	6995.23	4878.52	-776.74	-4825.16	3.00	
12525.00†	90.369	255.136	6994.58	4977.62	-799.85	-4922.44	3.00	
12562.87	90.367	254.000	6994.34	5014.95	-809.92	-4958.94	3.00	End of 3D Arc

Planned Wellpath Report

DONN 5N-20B-L PWP (REV-B.0)

Page 5 of 6



REFERENCE WELLPATH IDENTIFICATION

Operator	SRC ENERGY	Slot	SLOT#21 DONN 5N-20B-L (898'FNL & 251'FEL, SEC.21)
Area	COLORADO	Well	DONN 5N-20B-L
Field	WELD COUNTY (NAD83,TRUE NORTH)	Wellbore	DONN 5N-20B-L PWB
Facility	SEC.21-T06N-R66W		

WELLPATH DATA (190 stations) † = interpolated/extrapolated station

MD [ft]	Inclination [°]	Azimuth [°]	TVD [ft]	Vert Sect [ft]	North [ft]	East [ft]	DLS [°/100ft]	Comments
12625.00†	90.367	254.000	6993.94	5076.08	-827.05	-5018.66	0.00	
12662.87	90.367	254.000	6993.70	5113.34	-837.49	-5055.07	0.00	End of Tangent
12725.00†	90.368	255.864	6993.30	5174.64	-853.64	-5115.06	3.00	
12825.00†	90.368	258.864	6992.65	5273.90	-875.51	-5212.62	3.00	
12925.00†	90.368	261.864	6992.01	5373.65	-892.25	-5311.20	3.00	
13025.00†	90.366	264.864	6991.37	5473.62	-903.80	-5410.51	3.00	
13125.00†	90.364	267.864	6990.73	5573.54	-910.14	-5510.30	3.00	
13151.06	90.363	268.646	6990.57	5599.54	-910.93	-5536.35	3.00	End of 3D Arc
13225.00†	90.363	268.646	6990.10	5673.26	-912.68	-5610.26	0.00	
13325.00†	90.363	268.646	6989.47	5772.97	-915.04	-5710.23	0.00	
13425.00†	90.363	268.646	6988.83	5872.68	-917.41	-5810.20	0.00	
13525.00†	90.363	268.646	6988.20	5972.39	-919.77	-5910.17	0.00	
13625.00†	90.363	268.646	6987.57	6072.10	-922.13	-6010.14	0.00	
13725.00†	90.363	268.646	6986.93	6171.81	-924.50	-6110.11	0.00	
13825.00†	90.363	268.646	6986.30	6271.51	-926.86	-6210.08	0.00	
13925.00†	90.363	268.646	6985.67	6371.22	-929.22	-6310.05	0.00	
14025.00†	90.363	268.646	6985.03	6470.93	-931.58	-6410.02	0.00	
14125.00†	90.363	268.646	6984.40	6570.64	-933.95	-6509.99	0.00	
14225.00†	90.363	268.646	6983.77	6670.35	-936.31	-6609.96	0.00	
14325.00†	90.363	268.646	6983.14	6770.06	-938.67	-6709.93	0.00	
14425.00†	90.363	268.646	6982.50	6869.77	-941.03	-6809.90	0.00	
14525.00†	90.363	268.646	6981.87	6969.47	-943.40	-6909.87	0.00	
14625.00†	90.363	268.646	6981.24	7069.18	-945.76	-7009.84	0.00	
14725.00†	90.363	268.646	6980.60	7168.89	-948.12	-7109.81	0.00	
14825.00†	90.363	268.646	6979.97	7268.60	-950.49	-7209.78	0.00	
14925.00†	90.363	268.646	6979.34	7368.31	-952.85	-7309.75	0.00	
15025.00†	90.363	268.646	6978.70	7468.02	-955.21	-7409.72	0.00	
15125.00†	90.363	268.646	6978.07	7567.72	-957.57	-7509.69	0.00	
15225.00†	90.363	268.646	6977.44	7667.43	-959.94	-7609.66	0.00	
15325.00†	90.363	268.646	6976.80	7767.14	-962.30	-7709.63	0.00	
15425.00†	90.363	268.646	6976.17	7866.85	-964.66	-7809.60	0.00	
15525.00†	90.363	268.646	6975.54	7966.56	-967.02	-7909.57	0.00	
15625.00†	90.363	268.646	6974.90	8066.27	-969.39	-8009.54	0.00	
15725.00†	90.363	268.646	6974.27	8165.97	-971.75	-8109.51	0.00	
15825.00†	90.363	268.646	6973.64	8265.68	-974.11	-8209.49	0.00	
15925.00†	90.363	268.646	6973.00	8365.39	-976.48	-8309.46	0.00	
16025.00†	90.363	268.646	6972.37	8465.10	-978.84	-8409.43	0.00	
16125.00†	90.363	268.646	6971.74	8564.81	-981.20	-8509.40	0.00	
16225.00†	90.363	268.646	6971.10	8664.52	-983.56	-8609.37	0.00	
16325.00†	90.363	268.646	6970.47	8764.23	-985.93	-8709.34	0.00	
16425.00†	90.363	268.646	6969.84	8863.93	-988.29	-8809.31	0.00	
16525.00†	90.363	268.646	6969.20	8963.64	-990.65	-8909.28	0.00	
16625.00†	90.363	268.646	6968.57	9063.35	-993.02	-9009.25	0.00	
16725.00†	90.363	268.646	6967.94	9163.06	-995.38	-9109.22	0.00	
16825.00†	90.363	268.646	6967.30	9262.77	-997.74	-9209.19	0.00	

Planned Wellpath Report

DONN 5N-20B-L PWP (REV-B.0)

Page 6 of 6



REFERENCE WELLPATH IDENTIFICATION

Operator	SRC ENERGY	Slot	SLOT#21 DONN 5N-20B-L (898'FNL & 251'FEL, SEC.21)
Area	COLORADO	Well	DONN 5N-20B-L
Field	WELD COUNTY (NAD83,TRUE NORTH)	Wellbore	DONN 5N-20B-L PWB
Facility	SEC.21-T06N-R66W		

WELLPATH DATA (190 stations) † = interpolated/extrapolated station

MD [ft]	Inclination [°]	Azimuth [°]	TVD [ft]	Vert Sect [ft]	North [ft]	East [ft]	DLS [°/100ft]	Comments
16925.00†	90.363	268.646	6966.67	9362.48	-1000.10	-9309.16	0.00	
17025.00†	90.363	268.646	6966.04	9462.18	-1002.47	-9409.13	0.00	
17125.00†	90.363	268.646	6965.40	9561.89	-1004.83	-9509.10	0.00	
17225.00†	90.363	268.646	6964.77	9661.60	-1007.19	-9609.07	0.00	
17325.00†	90.363	268.646	6964.14	9761.31	-1009.55	-9709.04	0.00	
17425.00†	90.363	268.646	6963.50	9861.02	-1011.92	-9809.01	0.00	
17525.00†	90.363	268.646	6962.87	9960.73	-1014.28	-9908.98	0.00	
17625.00†	90.363	268.646	6962.24	10060.43	-1016.64	-10008.95	0.00	
17725.00†	90.363	268.646	6961.60	10160.14	-1019.01	-10108.92	0.00	
17820.26	90.363	268.646	6961.00 ²	10255.13	-1021.26	-10204.15	0.00	End of Tangent

HOLE & CASING SECTIONS

- Ref Wellbore: DONN 5N-20B-L PWB Ref Wellpath: DONN 5N-20B-L PWP (REV-B.0)

String/Diameter	Start MD [ft]	End MD [ft]	Interval [ft]	Start TVD [ft]	End TVD [ft]	Start N/S [ft]	Start E/W [ft]	End N/S [ft]	End E/W [ft]
13.5in Open Hole	25.00	1750.00	1725.00	25.00	1733.54	0.00	0.00	-139.27	151.20
9.625in Casing Surface	25.00	1750.00	1725.00	25.00	1733.54	0.00	0.00	-139.27	151.20
8.5in Open Hole	1750.00	17820.26	16070.26	1733.54	6961.00	-139.27	151.20	-1021.26	-10204.15

TARGETS

Name	MD [ft]	TVD [ft]	North [ft]	East [ft]	Grid East [US ft]	Grid North [US ft]	Latitude	Longitude	Shape
SEC.20-T06N-R66W		-1.00	159.94	1.11	3201887.93	1418212.16	40°28'44.854"N	104°46'27.336"W	polygon
SEC.21-T06N-R66W		39.00	-3722.87	-6165.52	3195753.51	1414279.17	40°28'06.478"N	104°47'47.123"W	polygon
2) DONN 5N-20B-L BHL ON PLAT (1727'FNL & 150'FWL, SEC.20)	17820.26	6961.00	-1021.26	-10204.15	3191693.06	1416947.54	40°28'33.161"N	104°48'39.391"W	circle
1) DONN 5N -20B-L TOP OF PROD ON PLAT (1678'FNL & 150'FEL, SEC.21)	7484.47	7027.00	-777.82	101.27	3201995.76	1417275.30	40°28'35.587"N	104°46'26.040"W	circle

SURVEY PROGRAM - Ref Wellbore: DONN 5N-20B-L PWB Ref Wellpath: DONN 5N-20B-L PWP (REV-B.0)

Start MD [ft]	End MD [ft]	Positional Uncertainty Model	Log Name/Comment	Wellbore
25.00	1750.00	Custom BHI NaviTrak (Standard Rotating+Axial Corr) (Rockies 0.03Gt model)		DONN 5N-20B-L PWB
1750.00	17820.26	Custom BHI AutoTrak Curve (IFR1, Short) (Rockies 0.03Gt model)		DONN 5N-20B-L PWB