

Location:	COLORADO	Slot:	SLOT#23 DONN 5C-20-L (938'FNL & 252'FEL, SEC.21)
Field:	WELD COUNTY (NAD83,TRUE NORTH)	Well:	DONN 5C-20-L
Facility:	SEC.21-T06N-R66W	Wellbore:	DONN 5C-20-L PWB
Plot reference wellpath is DONN 5C-20-L PWP (REV-B.0)		Grid System: NAD83 / Lambert Colorado SP, Northern Zone (501), US feet	
True vertical depths are referenced to PRECISION DRILLING (25') (RKB)		North Reference: True north	
Measured depths are referenced to PRECISION DRILLING (25') (RKB)		Scale: True distance	
PRECISION DRILLING (25') (RKB) to Mean Sea Level: 4776 feet		Depths are in feet	
Mean Sea Level to Mud line (At Slot: SLOT#23 DONN 5C-20-L (938'FNL & 252'FEL, SEC.21)): 0 feet		Created by: doddanna on 2017-08-25	
Coordinates are in feet referenced to Slot		Database: Denver DB	

Facility Name				Grid East (US ft)	Grid North (US ft)	Latitude	Longitude
SEC.21-T06N-R66W				3201871.604	1417148.268	40°28'34.342"N	104°46'27.660"W
Slot	Local N (ft)	Local E (ft)	Grid East (US ft)	Grid North (US ft)	Latitude	Longitude	
SLOT#23 DONN 5C-20-L (R38FNL & 252FEL, SEC.21)	863.76	23.65	3201888.181	1418012.156	40°28'42.877"N	104°46'27.354"W	
PRECISION DRILLING (25) (RKB) to Mud line (At Slot: SLOT#23 DONN 5C-20-L (R38FNL & 252FEL, SEC.21))						4776ft	
Mean Sea Level to Mud line (At Slot: SLOT#23 DONN 5C-20-L (R38FNL & 252FEL, SEC.21))						0ft	
PRECISION DRILLING (25) (RKB) to Mean Sea Level						4776ft	

Start MD (ft)	End MD (ft)	Tool	Model	Log Name/Comment	Wellbore
25.00	1750.00	BHI NavTrak	Custom BHI NavTrak (IFR1, Standard Rotating+Axial Core) (Rockies 0.03Gt model)		DONN 5C-20-L PWB
1750.00	18000.13	BHI AutoTrak Curve	Custom BHI AutoTrak Curve (IFR1, Short) (Rockies 0.03Gt model)		DONN 5C-20-L PWB

Name	MD (ft)	TVD (ft)	Local N (ft)	Local E (ft)	Grid East (US ft)	Grid North (US ft)	Latitude	Longitude
SEC.20-TODN-R66W		-2.00	200.01	1.39	3201887.93	1418212.16	40°28'44.854"N	104°46'27.336"W
SEC.21-TODN-R66W		38.00	-3682.79	-6165.25	3195753.51	1414279.17	40°28'06.478"N	104°47'47.123"W
DONN SC-20-L-BHK ON PLAT (2197FN/L & 1507FW/L SEC.20)	18600.13	7150.00	-1393.43	-10205.72	3191694.50	1416545.30	40°28'29.188"N	104°48'39.413"W
DONN SC-20-L TOP OF PROD ON PLAT (2077FN/L & 150FEL SEC.21)	7682.94	7180.00	-1136.99	101.24	3201998.72	1416876.07	40°28'31.642"N	104°46'35.044"W

Name	Start MD (ft)	End MD (ft)	Interval (ft)	Start TVD (ft)	End TVD (ft)	Start Local N (ft)	Start Local E (ft)	End Local N (ft)	End Local E (ft)	Wellbore
13.5in Open Hole	25.00	1750.00	1725.00	25.00	1727.35	0.00	0.00	-191.98	140.54	DONN 5C-20-L PWB
9.625in Casing Surface	25.00	1750.00	1725.00	25.00	1727.35	0.00	0.00	-191.98	140.54	DONN 5C-20-L PWB
8.5in Open Hole	1750.00	18000.13	16250.13	1727.35	7150.00	-191.98	140.54	-1383.43	-10205.72	DONN 5C-20-L PWB

Design Comment	MD (ft)	Inc (°)	Az (°)	TVD (ft)	Local N (ft)	Local E (ft)	DLS (°/100ft)	VS (ft)
Tie On	25.00	0.000	143.795	25.00	0.00	0.00	0.00	0.00
End of Tangent	300.00	0.000	143.795	300.00	0.00	0.00	0.00	0.00
End of Build	895.18	11.904	143.795	890.91	-49.71	36.39	2.00	-29.38
End of Tangent	6605.93	11.904	143.795	6478.85	-1000.19	732.16	0.00	-591.17
End of 3D Arc	7682.94	90.167	268.630	7180.00	-1136.99	101.24	9.00	52.41
End of Tangent	14032.94	90.167	268.630	7161.49	-1288.81	-6246.92	0.00	6363.43
End of 3D Arc	14211.94	90.167	274.000	7160.97	-1284.71	-6425.81	3.00	6540.14
End of Tangent	14411.94	90.167	274.000	7160.39	-1270.75	-6625.32	0.00	6735.97
End of 3D Arc	14937.60	90.167	258.230	7158.84	-1306.26	-7148.12	3.00	7258.80
End of Tangent	15037.60	90.167	258.230	7158.55	-1326.66	-7246.02	0.00	7358.55
End of 3D Arc	15417.62	90.165	269.631	7157.45	-1366.77	-7623.28	3.00	7737.78
End of Tangent	18000.13	90.165	269.631	7150.00	-1383.43	-10205.72	0.00	10299.06

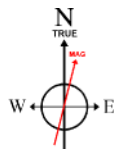

BGGM (1900.0 to 2019.0) Dip: 66.90° Field: 52436.6 nT
Magnetic North is 8.38 degrees East of True North (at 8/15/2017)

To correct azimuth from Magnetic to True add 8.38 degrees

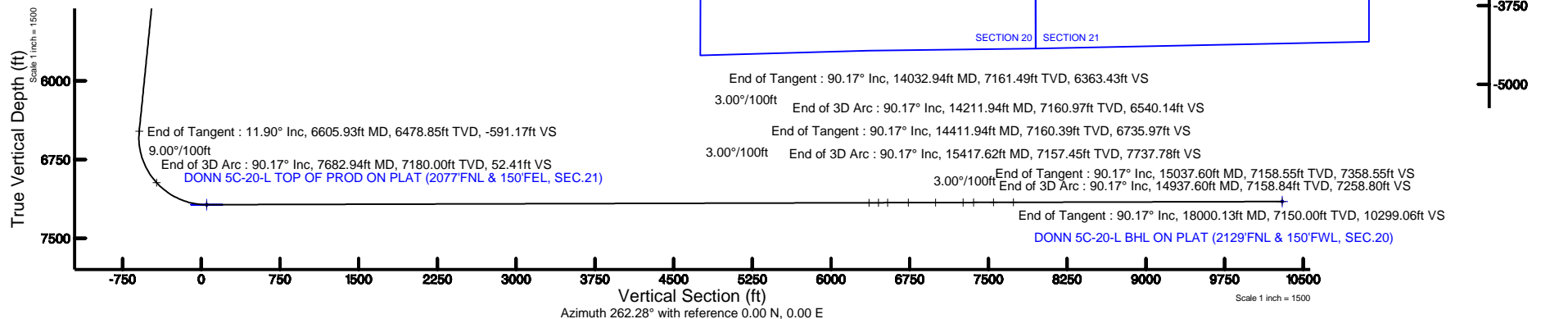

DONN_5C-20-L_PWP__REV-B.0_.las

~VERSION INFORMATION

VERS. 2.0 : CWLS LOG ASCII STANDARD-VERSION 2.0

WRAP. NO : ASCII DATA SECTION CONTAINS ONE ROW PER WELLPATH STATION

~WELL INFORMATION

#MNEM	.UNITS	DATA	:DESCRIPTION
#----	.-----	----	:-----
STRT	.ft	0.00	:START MD
STOP	.ft	18000.13	:STOP MD
STEP	.ft	0.0	:STEP (non-uniform
increment)			
NULL	.	-999.99	:NULL
COMP	.	SRC ENERGY	:OPERATOR
WELL	.	DONN 5C-20-L	:WELL
FLD	.	WELD COUNTY (NAD83,TRUE NORTH)	:FIELD
LOC	.	COLORADO	:AREA (aka: Location)
CNTY	.	N/A	:COUNTY
STAT	.	N/A	:STATE
CTRY	.	N/A	:COUNTRY
SRVC	.	Baker Hughes	:CONTRACTOR
DATE	.	08/17/2017	:LOG REV DATE
API	.		:API NUMBER

~OTHER INFORMATION

#Software: WellArchitect(R) Version 5.1

#MNEM	.UNITS	DATA	:DESCRIPTION
#----	.-----	----	:-----
WPTYPE	.	PLANNED WELLPATH	:WELLPATH TYPE
FACILITY	.	SEC.21-T06N-R66W	:FACILITY
SLOT	.	SLOT#23 DONN 5C-20-L (938'FNL & 252'FEL, SEC.21):SLOT	:SLOT
WELLBORE	.	DONN 5C-20-L PWB	:WELLBORE
WELLPATH	.	DONN 5C-20-L PWP (REV-B.0)	:WELLPATH
MDREFPT	.	PRECISION DRILLING (25') (RKB)	:MD REFERENCE POINT
TVDREFPT	.	PRECISION DRILLING (25') (RKB)	:TVD REFERENCE POINT
LCLREFPT	.	Slot	:LOCAL COORDINATE
REFERENCE PT			
VSAZIMUTH.deg		262.28	:VERTICAL SECTION
AZIMUTH			
VSORIGN .ft		0.00	:VERTICAL SECTION
ORIGIN NORTH			
VSORIGE .ft		0.00	:VERTICAL SECTION
ORIGIN EAST			

~CURVE (WELLPATH) INFORMATION

#MNEM	.UNITS	:DESCRIPTION
#----	.-----	:-----
DEPT	.ft	:MEASURED DEPTH
INC	.deg	:INCLINATION
AZI	.deg	:AZIMUTH
TVD	.ft	:TRUE VERTICAL DEPTH
SECT	.ft	:CROSS SECTION (CURTAIN/VERTICAL)
LOCALN	.ft	:LOCAL NORTH

DONN_5C-20-L_PWP__REV-B.0_.las

LOCALE .ft :LOCAL EAST
LAT .deg :LATITUDE
LONG .deg :LONGITUDE
DLS .deg/100ft :DOGLEG SEVERITY

~ASCII DATA

0.00	0.00	143.79	0.00	0.00	0.00	0.00	40.4785770
-104.7742650	0.00						
25.00	0.00	143.79	25.00	0.00	0.00	0.00	40.4785770
-104.7742650	0.00						
125.00	0.00	143.79	125.00	0.00	0.00	0.00	40.4785770
-104.7742650	0.00						
225.00	0.00	143.79	225.00	0.00	0.00	0.00	40.4785770
-104.7742650	0.00						
300.00	0.00	143.79	300.00	0.00	0.00	0.00	40.4785770
-104.7742650	0.00						
325.00	0.50	143.79	325.00	-0.05	-0.09	0.06	40.4785768
-104.7742648	2.00						
425.00	2.50	143.79	424.96	-1.30	-2.20	1.61	40.4785710
-104.7742592	2.00						
525.00	4.50	143.79	524.77	-4.21	-7.13	5.22	40.4785574
-104.7742462	2.00						
625.00	6.50	143.79	624.30	-8.78	-14.86	10.88	40.4785362
-104.7742259	2.00						
725.00	8.50	143.79	723.44	-15.01	-25.39	18.59	40.4785073
-104.7741982	2.00						
825.00	10.50	143.79	822.07	-22.88	-38.71	28.34	40.4784708
-104.7741631	2.00						
895.18	11.90	143.79	890.91	-29.38	-49.71	36.39	40.4784406
-104.7741342	2.00						
925.00	11.90	143.79	920.09	-32.31	-54.67	40.02	40.4784269
-104.7741211	0.00						
1025.00	11.90	143.79	1017.94	-42.15	-71.32	52.20	40.4783812
-104.7740773	0.00						
1125.00	11.90	143.79	1115.79	-51.99	-87.96	64.39	40.4783356
-104.7740336	0.00						
1225.00	11.90	143.79	1213.64	-61.83	-104.60	76.57	40.4782899
-104.7739898	0.00						
1325.00	11.90	143.79	1311.48	-71.66	-121.25	88.76	40.4782442
-104.7739460	0.00						
1425.00	11.90	143.79	1409.33	-81.50	-137.89	100.94	40.4781985
-104.7739022	0.00						
1525.00	11.90	143.79	1507.18	-91.34	-154.53	113.12	40.4781528
-104.7738584	0.00						
1625.00	11.90	143.79	1605.03	-101.18	-171.18	125.31	40.4781071
-104.7738146	0.00						
1725.00	11.90	143.79	1702.88	-111.01	-187.82	137.49	40.4780615
-104.7737708	0.00						
1825.00	11.90	143.79	1800.73	-120.85	-204.47	149.67	40.4780158
-104.7737270	0.00						
1925.00	11.90	143.79	1898.58	-130.69	-221.11	161.86	40.4779701
-104.7736832	0.00						

DONN_5C-20-L_PWP__REV-B.0_.las

2025.00	11.90	143.79	1996.43	-140.53	-237.75	174.04	40.4779244
-104.7736394	0.00						
2125.00	11.90	143.79	2094.28	-150.36	-254.40	186.22	40.4778787
-104.7735956	0.00						
2225.00	11.90	143.79	2192.13	-160.20	-271.04	198.41	40.4778330
-104.7735518	0.00						
2325.00	11.90	143.79	2289.98	-170.04	-287.68	210.59	40.4777873
-104.7735080	0.00						
2425.00	11.90	143.79	2387.83	-179.88	-304.33	222.77	40.4777417
-104.7734642	0.00						
2525.00	11.90	143.79	2485.68	-189.71	-320.97	234.96	40.4776960
-104.7734204	0.00						
2625.00	11.90	143.79	2583.53	-199.55	-337.62	247.14	40.4776503
-104.7733766	0.00						
2725.00	11.90	143.79	2681.38	-209.39	-354.26	259.33	40.4776046
-104.7733329	0.00						
2825.00	11.90	143.79	2779.23	-219.23	-370.90	271.51	40.4775589
-104.7732891	0.00						
2925.00	11.90	143.79	2877.08	-229.06	-387.55	283.69	40.4775132
-104.7732453	0.00						
3025.00	11.90	143.79	2974.93	-238.90	-404.19	295.88	40.4774675
-104.7732015	0.00						
3125.00	11.90	143.79	3072.78	-248.74	-420.83	308.06	40.4774219
-104.7731577	0.00						
3225.00	11.90	143.79	3170.63	-258.58	-437.48	320.24	40.4773762
-104.7731139	0.00						
3325.00	11.90	143.79	3268.48	-268.41	-454.12	332.43	40.4773305
-104.7730701	0.00						
3425.00	11.90	143.79	3366.33	-278.25	-470.77	344.61	40.4772848
-104.7730263	0.00						
3525.00	11.90	143.79	3464.18	-288.09	-487.41	356.79	40.4772391
-104.7729825	0.00						
3625.00	11.90	143.79	3562.03	-297.93	-504.05	368.98	40.4771934
-104.7729387	0.00						
3725.00	11.90	143.79	3659.88	-307.76	-520.70	381.16	40.4771478
-104.7728949	0.00						
3825.00	11.90	143.79	3757.73	-317.60	-537.34	393.34	40.4771021
-104.7728511	0.00						
3925.00	11.90	143.79	3855.57	-327.44	-553.98	405.53	40.4770564
-104.7728073	0.00						
4025.00	11.90	143.79	3953.42	-337.28	-570.63	417.71	40.4770107
-104.7727635	0.00						
4125.00	11.90	143.79	4051.27	-347.11	-587.27	429.90	40.4769650
-104.7727198	0.00						
4225.00	11.90	143.79	4149.12	-356.95	-603.92	442.08	40.4769193
-104.7726760	0.00						
4325.00	11.90	143.79	4246.97	-366.79	-620.56	454.26	40.4768736
-104.7726322	0.00						
4425.00	11.90	143.79	4344.82	-376.63	-637.20	466.45	40.4768280
-104.7725884	0.00						
4525.00	11.90	143.79	4442.67	-386.46	-653.85	478.63	40.4767823
-104.7725446	0.00						

DONN_5C-20-L_PWP__REV-B.0_.las

4625.00	11.90	143.79	4540.52	-396.30	-670.49	490.81	40.4767366
-104.7725008	0.00						
4725.00	11.90	143.79	4638.37	-406.14	-687.13	503.00	40.4766909
-104.7724570	0.00						
4825.00	11.90	143.79	4736.22	-415.98	-703.78	515.18	40.4766452
-104.7724132	0.00						
4925.00	11.90	143.79	4834.07	-425.81	-720.42	527.36	40.4765995
-104.7723694	0.00						
5025.00	11.90	143.79	4931.92	-435.65	-737.07	539.55	40.4765538
-104.7723256	0.00						
5125.00	11.90	143.79	5029.77	-445.49	-753.71	551.73	40.4765082
-104.7722818	0.00						
5225.00	11.90	143.79	5127.62	-455.33	-770.35	563.91	40.4764625
-104.7722380	0.00						
5325.00	11.90	143.79	5225.47	-465.16	-787.00	576.10	40.4764168
-104.7721942	0.00						
5425.00	11.90	143.79	5323.32	-475.00	-803.64	588.28	40.4763711
-104.7721505	0.00						
5525.00	11.90	143.79	5421.17	-484.84	-820.28	600.47	40.4763254
-104.7721067	0.00						
5625.00	11.90	143.79	5519.02	-494.68	-836.93	612.65	40.4762797
-104.7720629	0.00						
5725.00	11.90	143.79	5616.87	-504.51	-853.57	624.83	40.4762340
-104.7720191	0.00						
5825.00	11.90	143.79	5714.72	-514.35	-870.22	637.02	40.4761884
-104.7719753	0.00						
5925.00	11.90	143.79	5812.57	-524.19	-886.86	649.20	40.4761427
-104.7719315	0.00						
6025.00	11.90	143.79	5910.42	-534.03	-903.50	661.38	40.4760970
-104.7718877	0.00						
6125.00	11.90	143.79	6008.27	-543.86	-920.15	673.57	40.4760513
-104.7718439	0.00						
6225.00	11.90	143.79	6106.12	-553.70	-936.79	685.75	40.4760056
-104.7718001	0.00						
6325.00	11.90	143.79	6203.97	-563.54	-953.43	697.93	40.4759599
-104.7717563	0.00						
6425.00	11.90	143.79	6301.82	-573.38	-970.08	710.12	40.4759142
-104.7717125	0.00						
6525.00	11.90	143.79	6399.66	-583.21	-986.72	722.30	40.4758686
-104.7716687	0.00						
6605.93	11.90	143.79	6478.85	-591.17	-1000.19	732.16	40.4758316
-104.7716333	0.00						
6625.00	11.03	151.23	6497.54	-592.77	-1003.38	734.20	40.4758228
-104.7716260	9.00						
6725.00	10.58	200.67	6595.97	-591.84	-1020.39	735.57	40.4757762
-104.7716211	9.00						
6825.00	16.20	232.05	6693.34	-575.38	-1037.59	721.30	40.4757289
-104.7716724	9.00						
6925.00	23.95	245.67	6787.24	-543.81	-1054.57	691.74	40.4756823
-104.7717786	9.00						
7025.00	32.33	252.73	6875.37	-497.90	-1070.91	647.62	40.4756375
-104.7719372	9.00						

DONN_5C-20-L_PWP__REV-B.0_.las

7125.00	40.95	257.09	6955.55	-438.78	-1086.20	590.03	40.4755955
-104.7721442	9.00						
7225.00	49.68	260.15	7025.81	-367.90	-1100.06	520.38	40.4755575
-104.7723945	9.00						
7325.00	58.48	262.51	7084.42	-287.02	-1112.16	440.40	40.4755243
-104.7726820	9.00						
7425.00	67.31	264.45	7129.94	-198.11	-1122.20	352.04	40.4754967
-104.7729996	9.00						
7525.00	76.17	266.16	7161.25	-103.38	-1129.93	257.49	40.4754755
-104.7733395	9.00						
7625.00	85.03	267.74	7177.57	-5.16	-1135.16	159.08	40.4754611
-104.7736932	9.00						
7682.94	90.17	268.63	7180.00	52.41	-1136.99	101.24	40.4754561
-104.7739011	9.00						
7725.00	90.17	268.63	7179.88	94.21	-1138.00	59.19	40.4754534
-104.7740522	0.00						
7825.00	90.17	268.63	7179.59	193.59	-1140.39	-40.78	40.4754468
-104.7744116	0.00						
7925.00	90.17	268.63	7179.29	292.98	-1142.78	-140.75	40.4754402
-104.7747709	0.00						
8025.00	90.17	268.63	7179.00	392.37	-1145.17	-240.72	40.4754337
-104.7751302	0.00						
8125.00	90.17	268.63	7178.71	491.75	-1147.56	-340.69	40.4754271
-104.7754896	0.00						
8225.00	90.17	268.63	7178.42	591.14	-1149.95	-440.66	40.4754205
-104.7758489	0.00						
8325.00	90.17	268.63	7178.13	690.52	-1152.34	-540.63	40.4754140
-104.7762083	0.00						
8425.00	90.17	268.63	7177.84	789.91	-1154.73	-640.61	40.4754074
-104.7765676	0.00						
8525.00	90.17	268.63	7177.55	889.30	-1157.12	-740.58	40.4754008
-104.7769269	0.00						
8625.00	90.17	268.63	7177.25	988.68	-1159.52	-840.55	40.4753942
-104.7772863	0.00						
8725.00	90.17	268.63	7176.96	1088.07	-1161.91	-940.52	40.4753877
-104.7776456	0.00						
8825.00	90.17	268.63	7176.67	1187.45	-1164.30	-1040.49	40.4753811
-104.7780049	0.00						
8925.00	90.17	268.63	7176.38	1286.84	-1166.69	-1140.46	40.4753745
-104.7783643	0.00						
9025.00	90.17	268.63	7176.09	1386.23	-1169.08	-1240.43	40.4753680
-104.7787236	0.00						
9125.00	90.17	268.63	7175.80	1485.61	-1171.47	-1340.40	40.4753614
-104.7790829	0.00						
9225.00	90.17	268.63	7175.51	1585.00	-1173.86	-1440.37	40.4753548
-104.7794423	0.00						
9325.00	90.17	268.63	7175.21	1684.39	-1176.25	-1540.34	40.4753482
-104.7798016	0.00						
9425.00	90.17	268.63	7174.92	1783.77	-1178.64	-1640.32	40.4753416
-104.7801609	0.00						
9525.00	90.17	268.63	7174.63	1883.16	-1181.03	-1740.29	40.4753351
-104.7805203	0.00						

DONN_5C-20-L_PWP__REV-B.0_.las

9625.00	90.17	268.63	7174.34	1982.54	-1183.42	-1840.26	40.4753285
-104.7808796	0.00						
9725.00	90.17	268.63	7174.05	2081.93	-1185.82	-1940.23	40.4753219
-104.7812389	0.00						
9825.00	90.17	268.63	7173.76	2181.32	-1188.21	-2040.20	40.4753153
-104.7815983	0.00						
9925.00	90.17	268.63	7173.47	2280.70	-1190.60	-2140.17	40.4753087
-104.7819576	0.00						
10025.00	90.17	268.63	7173.17	2380.09	-1192.99	-2240.14	40.4753021
-104.7823169	0.00						
10125.00	90.17	268.63	7172.88	2479.47	-1195.38	-2340.11	40.4752955
-104.7826763	0.00						
10225.00	90.17	268.63	7172.59	2578.86	-1197.77	-2440.08	40.4752890
-104.7830356	0.00						
10325.00	90.17	268.63	7172.30	2678.25	-1200.16	-2540.05	40.4752824
-104.7833949	0.00						
10425.00	90.17	268.63	7172.01	2777.63	-1202.55	-2640.03	40.4752758
-104.7837543	0.00						
10525.00	90.17	268.63	7171.72	2877.02	-1204.94	-2740.00	40.4752692
-104.7841136	0.00						
10625.00	90.17	268.63	7171.42	2976.41	-1207.33	-2839.97	40.4752626
-104.7844729	0.00						
10725.00	90.17	268.63	7171.13	3075.79	-1209.72	-2939.94	40.4752560
-104.7848323	0.00						
10825.00	90.17	268.63	7170.84	3175.18	-1212.11	-3039.91	40.4752494
-104.7851916	0.00						
10925.00	90.17	268.63	7170.55	3274.56	-1214.51	-3139.88	40.4752428
-104.7855509	0.00						
11025.00	90.17	268.63	7170.26	3373.95	-1216.90	-3239.85	40.4752362
-104.7859103	0.00						
11125.00	90.17	268.63	7169.97	3473.34	-1219.29	-3339.82	40.4752296
-104.7862696	0.00						
11225.00	90.17	268.63	7169.68	3572.72	-1221.68	-3439.79	40.4752230
-104.7866289	0.00						
11325.00	90.17	268.63	7169.38	3672.11	-1224.07	-3539.76	40.4752164
-104.7869883	0.00						
11425.00	90.17	268.63	7169.09	3771.49	-1226.46	-3639.74	40.4752098
-104.7873476	0.00						
11525.00	90.17	268.63	7168.80	3870.88	-1228.85	-3739.71	40.4752032
-104.7877069	0.00						
11625.00	90.17	268.63	7168.51	3970.27	-1231.24	-3839.68	40.4751966
-104.7880663	0.00						
11725.00	90.17	268.63	7168.22	4069.65	-1233.63	-3939.65	40.4751900
-104.7884256	0.00						
11825.00	90.17	268.63	7167.93	4169.04	-1236.02	-4039.62	40.4751834
-104.7887849	0.00						
11925.00	90.17	268.63	7167.64	4268.43	-1238.41	-4139.59	40.4751768
-104.7891443	0.00						
12025.00	90.17	268.63	7167.34	4367.81	-1240.81	-4239.56	40.4751702
-104.7895036	0.00						
12125.00	90.17	268.63	7167.05	4467.20	-1243.20	-4339.53	40.4751635
-104.7898629	0.00						

DONN_5C-20-L_PWP__REV-B.0_.las

12225.00	90.17	268.63	7166.76	4566.58	-1245.59	-4439.50	40.4751569
-104.7902223	0.00						
12325.00	90.17	268.63	7166.47	4665.97	-1247.98	-4539.47	40.4751503
-104.7905816	0.00						
12425.00	90.17	268.63	7166.18	4765.36	-1250.37	-4639.45	40.4751437
-104.7909409	0.00						
12525.00	90.17	268.63	7165.89	4864.74	-1252.76	-4739.42	40.4751371
-104.7913003	0.00						
12625.00	90.17	268.63	7165.60	4964.13	-1255.15	-4839.39	40.4751305
-104.7916596	0.00						
12725.00	90.17	268.63	7165.30	5063.51	-1257.54	-4939.36	40.4751239
-104.7920189	0.00						
12825.00	90.17	268.63	7165.01	5162.90	-1259.93	-5039.33	40.4751172
-104.7923783	0.00						
12925.00	90.17	268.63	7164.72	5262.29	-1262.32	-5139.30	40.4751106
-104.7927376	0.00						
13025.00	90.17	268.63	7164.43	5361.67	-1264.71	-5239.27	40.4751040
-104.7930969	0.00						
13125.00	90.17	268.63	7164.14	5461.06	-1267.10	-5339.24	40.4750974
-104.7934563	0.00						
13225.00	90.17	268.63	7163.85	5560.44	-1269.50	-5439.21	40.4750908
-104.7938156	0.00						
13325.00	90.17	268.63	7163.56	5659.83	-1271.89	-5539.18	40.4750841
-104.7941749	0.00						
13425.00	90.17	268.63	7163.26	5759.22	-1274.28	-5639.16	40.4750775
-104.7945343	0.00						
13525.00	90.17	268.63	7162.97	5858.60	-1276.67	-5739.13	40.4750709
-104.7948936	0.00						
13625.00	90.17	268.63	7162.68	5957.99	-1279.06	-5839.10	40.4750643
-104.7952529	0.00						
13725.00	90.17	268.63	7162.39	6057.38	-1281.45	-5939.07	40.4750576
-104.7956122	0.00						
13825.00	90.17	268.63	7162.10	6156.76	-1283.84	-6039.04	40.4750510
-104.7959716	0.00						
13925.00	90.17	268.63	7161.81	6256.15	-1286.23	-6139.01	40.4750444
-104.7963309	0.00						
14025.00	90.17	268.63	7161.51	6355.53	-1288.62	-6238.98	40.4750377
-104.7966902	0.00						
14032.94	90.17	268.63	7161.49	6363.43	-1288.81	-6246.92	40.4750372
-104.7967188	0.00						
14125.00	90.17	271.39	7161.22	6454.64	-1288.79	-6338.97	40.4750372
-104.7970496	3.00						
14211.94	90.17	274.00	7160.97	6540.14	-1284.71	-6425.81	40.4750484
-104.7973618	3.00						
14225.00	90.17	274.00	7160.93	6552.93	-1283.79	-6438.83	40.4750509
-104.7974086	0.00						
14325.00	90.17	274.00	7160.64	6650.84	-1276.82	-6538.59	40.4750699
-104.7977672	0.00						
14411.94	90.17	274.00	7160.39	6735.97	-1270.75	-6625.32	40.4750865
-104.7980789	0.00						
14425.00	90.17	273.61	7160.35	6748.77	-1269.89	-6638.35	40.4750889
-104.7981257	3.00						

DONN_5C-20-L_PWP__REV-B.0_.las

14525.00	90.17	270.61	7160.06	6847.29	-1266.21	-6738.27	40.4750989
-104.7984849	3.00						
14625.00	90.17	267.61	7159.76	6946.57	-1267.77	-6838.25	40.4750946
-104.7988442	3.00						
14725.00	90.17	264.61	7159.47	7046.33	-1274.55	-6938.00	40.4750758
-104.7992028	3.00						
14825.00	90.17	261.61	7159.17	7146.31	-1286.55	-7037.27	40.4750428
-104.7995596	3.00						
14925.00	90.17	258.61	7158.88	7246.22	-1303.73	-7135.77	40.4749956
-104.7999136	3.00						
14937.60	90.17	258.23	7158.84	7258.80	-1306.26	-7148.12	40.4749887
-104.7999580	3.00						
15025.00	90.17	258.23	7158.59	7345.98	-1324.09	-7233.68	40.4749397
-104.8002655	0.00						
15037.60	90.17	258.23	7158.55	7358.55	-1326.66	-7246.02	40.4749326
-104.8003099	0.00						
15125.00	90.17	260.85	7158.30	7445.84	-1342.52	-7331.95	40.4748890
-104.8006187	3.00						
15225.00	90.17	263.85	7158.01	7545.83	-1355.83	-7431.05	40.4748524
-104.8009749	3.00						
15325.00	90.17	266.85	7157.72	7645.67	-1363.93	-7530.71	40.4748300
-104.8013331	3.00						
15417.62	90.17	269.63	7157.45	7737.78	-1366.77	-7623.28	40.4748222
-104.8016658	3.00						
15425.00	90.17	269.63	7157.43	7745.10	-1366.82	-7630.66	40.4748220
-104.8016924	0.00						
15525.00	90.17	269.63	7157.14	7844.28	-1367.46	-7730.65	40.4748202
-104.8020518	0.00						
15625.00	90.17	269.63	7156.85	7943.46	-1368.11	-7830.65	40.4748183
-104.8024112	0.00						
15725.00	90.17	269.63	7156.56	8042.63	-1368.75	-7930.65	40.4748165
-104.8027706	0.00						
15825.00	90.17	269.63	7156.27	8141.81	-1369.40	-8030.65	40.4748146
-104.8031301	0.00						
15925.00	90.17	269.63	7155.98	8240.99	-1370.04	-8130.64	40.4748127
-104.8034895	0.00						
16025.00	90.17	269.63	7155.70	8340.17	-1370.69	-8230.64	40.4748109
-104.8038489	0.00						
16125.00	90.17	269.63	7155.41	8439.34	-1371.33	-8330.64	40.4748090
-104.8042083	0.00						
16225.00	90.17	269.63	7155.12	8538.52	-1371.98	-8430.64	40.4748072
-104.8045678	0.00						
16325.00	90.17	269.63	7154.83	8637.70	-1372.62	-8530.63	40.4748053
-104.8049272	0.00						
16425.00	90.17	269.63	7154.54	8736.88	-1373.27	-8630.63	40.4748034
-104.8052866	0.00						
16525.00	90.17	269.63	7154.25	8836.06	-1373.91	-8730.63	40.4748016
-104.8056460	0.00						
16625.00	90.17	269.63	7153.97	8935.23	-1374.56	-8830.63	40.4747997
-104.8060055	0.00						
16725.00	90.17	269.63	7153.68	9034.41	-1375.20	-8930.62	40.4747978
-104.8063649	0.00						

DONN_5C-20-L_PWP__REV-B.0_.las

16825.00	90.17	269.63	7153.39	9133.59	-1375.85	-9030.62	40.4747959
-104.8067243	0.00						
16925.00	90.17	269.63	7153.10	9232.77	-1376.49	-9130.62	40.4747941
-104.8070838	0.00						
17025.00	90.17	269.63	7152.81	9331.95	-1377.14	-9230.62	40.4747922
-104.8074432	0.00						
17125.00	90.17	269.63	7152.52	9431.12	-1377.78	-9330.61	40.4747903
-104.8078026	0.00						
17225.00	90.17	269.63	7152.24	9530.30	-1378.43	-9430.61	40.4747885
-104.8081620	0.00						
17325.00	90.17	269.63	7151.95	9629.48	-1379.07	-9530.61	40.4747866
-104.8085215	0.00						
17425.00	90.17	269.63	7151.66	9728.66	-1379.72	-9630.61	40.4747847
-104.8088809	0.00						
17525.00	90.17	269.63	7151.37	9827.83	-1380.36	-9730.60	40.4747828
-104.8092403	0.00						
17625.00	90.17	269.63	7151.08	9927.01	-1381.01	-9830.60	40.4747809
-104.8095997	0.00						
17725.00	90.17	269.63	7150.79	10026.19	-1381.65	-9930.60	40.4747791
-104.8099592	0.00						
17825.00	90.17	269.63	7150.51	10125.37	-1382.30	-10030.60	40.4747772
-104.8103186	0.00						
17925.00	90.17	269.63	7150.22	10224.55	-1382.94	-10130.59	40.4747753
-104.8106780	0.00						
18000.13	90.17	269.63	7150.00	10299.06	-1383.43	-10205.72	40.4747739
-104.8109481	0.00						

Planned Wellpath Report

DONN 5C-20-L PWP (REV-B.0)

Page 1 of 6



REFERENCE WELLPATH IDENTIFICATION

Operator	SRC ENERGY	Slot	SLOT#23 DONN 5C-20-L (938'FNL & 252'FEL, SEC.21)
Area	COLORADO	Well	DONN 5C-20-L
Field	WELD COUNTY (NAD83,TRUE NORTH)	Wellbore	DONN 5C-20-L PWB
Facility	SEC.21-T06N-R66W		

REPORT SETUP INFORMATION

Projection System	NAD83 / Lambert Colorado SP, Northern Zone (501), US feet	Software System	WellArchitect® 5.1
North Reference	True	User	Doddanna
Scale	0.999965	Report Generated	8/25/2017 at 9:35:25 AM
Convergence at slot	0.47° East	Database/Source file	Denver DB/DONN_5C-20-L_PWP__REV-B.0_.xml

WELLPATH LOCATION

	Local coordinates		Grid coordinates		Geographic coordinates	
	North[ft]	East[ft]	Easting[US ft]	Northing[US ft]	Latitude	Longitude
Slot Location	863.76	23.65	3201888.18	1418012.16	40°28'42.877"N	104°46'27.354"W
Facility Reference Pt			3201871.60	1417148.27	40°28'34.342"N	104°46'27.660"W
Field Reference Pt			3171284.48	1426358.81	40°30'07.643"N	104°53'02.634"W

WELLPATH DATUM

Calculation method	Minimum curvature	PRECISION DRILLING (25') (RKB) to Facility Vertical Datum	4776.00ft
Horizontal Reference Pt	Slot	PRECISION DRILLING (25') (RKB) to Mean Sea Level	4776.00ft
Vertical Reference Pt	PRECISION DRILLING (25') (RKB)	PRECISION DRILLING (25') (RKB) to Mud Line at Slot (SLOT#23 DONN 5C-20-L (938'FNL & 252'FEL, SEC.21))	4776.00ft
MD Reference Pt	PRECISION DRILLING (25') (RKB)	Section Origin	N 0.00, E 0.00 ft
Field Vertical Reference	Mean Sea Level	Section Azimuth	262.28°

Planned Wellpath Report

DONN 5C-20-L PWP (REV-B.0)

Page 2 of 6



REFERENCE WELLPATH IDENTIFICATION

Operator	SRC ENERGY	Slot	SLOT#23 DONN 5C-20-L (938'FNL & 252'FEL, SEC.21)
Area	COLORADO	Well	DONN 5C-20-L
Field	WELD COUNTY (NAD83,TRUE NORTH)	Wellbore	DONN 5C-20-L PWB
Facility	SEC.21-T06N-R66W		

WELLPATH DATA (192 stations) † = interpolated/extrapolated station

MD [ft]	Inclination [°]	Azimuth [°]	TVD [ft]	Vert Sect [ft]	North [ft]	East [ft]	DLS [°/100ft]	Comments
0.00†	0.000	143.795	0.00	0.00	0.00	0.00	0.00	
25.00	0.000	143.795	25.00	0.00	0.00	0.00	0.00	Tie On
125.00†	0.000	143.795	125.00	0.00	0.00	0.00	0.00	
225.00†	0.000	143.795	225.00	0.00	0.00	0.00	0.00	
300.00	0.000	143.795	300.00	0.00	0.00	0.00	0.00	End of Tangent
325.00†	0.500	143.795	325.00	-0.05	-0.09	0.06	2.00	
425.00†	2.500	143.795	424.96	-1.30	-2.20	1.61	2.00	
525.00†	4.500	143.795	524.77	-4.21	-7.13	5.22	2.00	
625.00†	6.500	143.795	624.30	-8.78	-14.86	10.88	2.00	
725.00†	8.500	143.795	723.44	-15.01	-25.39	18.59	2.00	
825.00†	10.500	143.795	822.07	-22.88	-38.71	28.34	2.00	
895.18	11.904	143.795	890.91	-29.38	-49.71	36.39	2.00	End of Build
925.00†	11.904	143.795	920.09	-32.31	-54.67	40.02	0.00	
1025.00†	11.904	143.795	1017.94	-42.15	-71.32	52.20	0.00	
1125.00†	11.904	143.795	1115.79	-51.99	-87.96	64.39	0.00	
1225.00†	11.904	143.795	1213.64	-61.83	-104.60	76.57	0.00	
1325.00†	11.904	143.795	1311.48	-71.66	-121.25	88.76	0.00	
1425.00†	11.904	143.795	1409.33	-81.50	-137.89	100.94	0.00	
1525.00†	11.904	143.795	1507.18	-91.34	-154.53	113.12	0.00	
1625.00†	11.904	143.795	1605.03	-101.18	-171.18	125.31	0.00	
1725.00†	11.904	143.795	1702.88	-111.01	-187.82	137.49	0.00	
1825.00†	11.904	143.795	1800.73	-120.85	-204.47	149.67	0.00	
1925.00†	11.904	143.795	1898.58	-130.69	-221.11	161.86	0.00	
2025.00†	11.904	143.795	1996.43	-140.53	-237.75	174.04	0.00	
2125.00†	11.904	143.795	2094.28	-150.36	-254.40	186.22	0.00	
2225.00†	11.904	143.795	2192.13	-160.20	-271.04	198.41	0.00	
2325.00†	11.904	143.795	2289.98	-170.04	-287.68	210.59	0.00	
2425.00†	11.904	143.795	2387.83	-179.88	-304.33	222.77	0.00	
2525.00†	11.904	143.795	2485.68	-189.71	-320.97	234.96	0.00	
2625.00†	11.904	143.795	2583.53	-199.55	-337.62	247.14	0.00	
2725.00†	11.904	143.795	2681.38	-209.39	-354.26	259.33	0.00	
2825.00†	11.904	143.795	2779.23	-219.23	-370.90	271.51	0.00	
2925.00†	11.904	143.795	2877.08	-229.06	-387.55	283.69	0.00	
3025.00†	11.904	143.795	2974.93	-238.90	-404.19	295.88	0.00	
3125.00†	11.904	143.795	3072.78	-248.74	-420.83	308.06	0.00	
3225.00†	11.904	143.795	3170.63	-258.58	-437.48	320.24	0.00	
3325.00†	11.904	143.795	3268.48	-268.41	-454.12	332.43	0.00	
3425.00†	11.904	143.795	3366.33	-278.25	-470.77	344.61	0.00	
3525.00†	11.904	143.795	3464.18	-288.09	-487.41	356.79	0.00	
3625.00†	11.904	143.795	3562.03	-297.93	-504.05	368.98	0.00	
3725.00†	11.904	143.795	3659.88	-307.76	-520.70	381.16	0.00	
3825.00†	11.904	143.795	3757.73	-317.60	-537.34	393.34	0.00	
3925.00†	11.904	143.795	3855.57	-327.44	-553.98	405.53	0.00	
4025.00†	11.904	143.795	3953.42	-337.28	-570.63	417.71	0.00	
4125.00†	11.904	143.795	4051.27	-347.11	-587.27	429.90	0.00	

Planned Wellpath Report

DONN 5C-20-L PWP (REV-B.0)

Page 3 of 6



REFERENCE WELLPATH IDENTIFICATION

Operator	SRC ENERGY	Slot	SLOT#23 DONN 5C-20-L (938'FNL & 252'FEL, SEC.21)
Area	COLORADO	Well	DONN 5C-20-L
Field	WELD COUNTY (NAD83,TRUE NORTH)	Wellbore	DONN 5C-20-L PWB
Facility	SEC.21-T06N-R66W		

WELLPATH DATA (192 stations) † = interpolated/extrapolated station

MD [ft]	Inclination [°]	Azimuth [°]	TVD [ft]	Vert Sect [ft]	North [ft]	East [ft]	DLS [°/100ft]	Comments
4225.00†	11.904	143.795	4149.12	-356.95	-603.92	442.08	0.00	
4325.00†	11.904	143.795	4246.97	-366.79	-620.56	454.26	0.00	
4425.00†	11.904	143.795	4344.82	-376.63	-637.20	466.45	0.00	
4525.00†	11.904	143.795	4442.67	-386.46	-653.85	478.63	0.00	
4625.00†	11.904	143.795	4540.52	-396.30	-670.49	490.81	0.00	
4725.00†	11.904	143.795	4638.37	-406.14	-687.13	503.00	0.00	
4825.00†	11.904	143.795	4736.22	-415.98	-703.78	515.18	0.00	
4925.00†	11.904	143.795	4834.07	-425.81	-720.42	527.36	0.00	
5025.00†	11.904	143.795	4931.92	-435.65	-737.07	539.55	0.00	
5125.00†	11.904	143.795	5029.77	-445.49	-753.71	551.73	0.00	
5225.00†	11.904	143.795	5127.62	-455.33	-770.35	563.91	0.00	
5325.00†	11.904	143.795	5225.47	-465.16	-787.00	576.10	0.00	
5425.00†	11.904	143.795	5323.32	-475.00	-803.64	588.28	0.00	
5525.00†	11.904	143.795	5421.17	-484.84	-820.28	600.47	0.00	
5625.00†	11.904	143.795	5519.02	-494.68	-836.93	612.65	0.00	
5725.00†	11.904	143.795	5616.87	-504.51	-853.57	624.83	0.00	
5825.00†	11.904	143.795	5714.72	-514.35	-870.22	637.02	0.00	
5925.00†	11.904	143.795	5812.57	-524.19	-886.86	649.20	0.00	
6025.00†	11.904	143.795	5910.42	-534.03	-903.50	661.38	0.00	
6125.00†	11.904	143.795	6008.27	-543.86	-920.15	673.57	0.00	
6225.00†	11.904	143.795	6106.12	-553.70	-936.79	685.75	0.00	
6325.00†	11.904	143.795	6203.97	-563.54	-953.43	697.93	0.00	
6425.00†	11.904	143.795	6301.82	-573.38	-970.08	710.12	0.00	
6525.00†	11.904	143.795	6399.66	-583.21	-986.72	722.30	0.00	
6605.93	11.904	143.795	6478.85	-591.17	-1000.19	732.16	0.00	End of Tangent
6625.00†	11.029	151.233	6497.54	-592.77	-1003.38	734.20	9.00	
6725.00†	10.579	200.667	6595.97	-591.84	-1020.39	735.57	9.00	
6825.00†	16.205	232.048	6693.34	-575.38	-1037.59	721.30	9.00	
6925.00†	23.951	245.669	6787.24	-543.81	-1054.57	691.74	9.00	
7025.00†	32.327	252.728	6875.37	-497.90	-1070.91	647.62	9.00	
7125.00†	40.947	257.094	6955.55	-438.78	-1086.20	590.03	9.00	
7225.00†	49.682	260.155	7025.81	-367.90	-1100.06	520.38	9.00	
7325.00†	58.479	262.507	7084.42	-287.02	-1112.16	440.40	9.00	
7425.00†	67.311	264.451	7129.94	-198.11	-1122.20	352.04	9.00	
7525.00†	76.165	266.158	7161.25	-103.38	-1129.93	257.49	9.00	
7625.00†	85.029	267.738	7177.57	-5.16	-1135.16	159.08	9.00	
7682.94	90.167	268.630	7180.00†	52.41	-1136.99	101.24	9.00	End of 3D Arc
7725.00†	90.167	268.630	7179.88	94.21	-1138.00	59.19	0.00	
7825.00†	90.167	268.630	7179.59	193.59	-1140.39	-40.78	0.00	
7925.00†	90.167	268.630	7179.29	292.98	-1142.78	-140.75	0.00	
8025.00†	90.167	268.630	7179.00	392.37	-1145.17	-240.72	0.00	
8125.00†	90.167	268.630	7178.71	491.75	-1147.56	-340.69	0.00	
8225.00†	90.167	268.630	7178.42	591.14	-1149.95	-440.66	0.00	
8325.00†	90.167	268.630	7178.13	690.52	-1152.34	-540.63	0.00	
8425.00†	90.167	268.630	7177.84	789.91	-1154.73	-640.61	0.00	

Planned Wellpath Report

DONN 5C-20-L PWP (REV-B.0)

Page 4 of 6



REFERENCE WELLPATH IDENTIFICATION

Operator	SRC ENERGY	Slot	SLOT#23 DONN 5C-20-L (938'FNL & 252'FEL, SEC.21)
Area	COLORADO	Well	DONN 5C-20-L
Field	WELD COUNTY (NAD83,TRUE NORTH)	Wellbore	DONN 5C-20-L PWB
Facility	SEC.21-T06N-R66W		

WELLPATH DATA (192 stations) † = interpolated/extrapolated station

MD [ft]	Inclination [°]	Azimuth [°]	TVD [ft]	Vert Sect [ft]	North [ft]	East [ft]	DLS [°/100ft]	Comments
8525.00†	90.167	268.630	7177.55	889.30	-1157.12	-740.58	0.00	
8625.00†	90.167	268.630	7177.25	988.68	-1159.52	-840.55	0.00	
8725.00†	90.167	268.630	7176.96	1088.07	-1161.91	-940.52	0.00	
8825.00†	90.167	268.630	7176.67	1187.45	-1164.30	-1040.49	0.00	
8925.00†	90.167	268.630	7176.38	1286.84	-1166.69	-1140.46	0.00	
9025.00†	90.167	268.630	7176.09	1386.23	-1169.08	-1240.43	0.00	
9125.00†	90.167	268.630	7175.80	1485.61	-1171.47	-1340.40	0.00	
9225.00†	90.167	268.630	7175.51	1585.00	-1173.86	-1440.37	0.00	
9325.00†	90.167	268.630	7175.21	1684.39	-1176.25	-1540.34	0.00	
9425.00†	90.167	268.630	7174.92	1783.77	-1178.64	-1640.32	0.00	
9525.00†	90.167	268.630	7174.63	1883.16	-1181.03	-1740.29	0.00	
9625.00†	90.167	268.630	7174.34	1982.54	-1183.42	-1840.26	0.00	
9725.00†	90.167	268.630	7174.05	2081.93	-1185.82	-1940.23	0.00	
9825.00†	90.167	268.630	7173.76	2181.32	-1188.21	-2040.20	0.00	
9925.00†	90.167	268.630	7173.47	2280.70	-1190.60	-2140.17	0.00	
10025.00†	90.167	268.630	7173.17	2380.09	-1192.99	-2240.14	0.00	
10125.00†	90.167	268.630	7172.88	2479.47	-1195.38	-2340.11	0.00	
10225.00†	90.167	268.630	7172.59	2578.86	-1197.77	-2440.08	0.00	
10325.00†	90.167	268.630	7172.30	2678.25	-1200.16	-2540.05	0.00	
10425.00†	90.167	268.630	7172.01	2777.63	-1202.55	-2640.03	0.00	
10525.00†	90.167	268.630	7171.72	2877.02	-1204.94	-2740.00	0.00	
10625.00†	90.167	268.630	7171.42	2976.41	-1207.33	-2839.97	0.00	
10725.00†	90.167	268.630	7171.13	3075.79	-1209.72	-2939.94	0.00	
10825.00†	90.167	268.630	7170.84	3175.18	-1212.11	-3039.91	0.00	
10925.00†	90.167	268.630	7170.55	3274.56	-1214.51	-3139.88	0.00	
11025.00†	90.167	268.630	7170.26	3373.95	-1216.90	-3239.85	0.00	
11125.00†	90.167	268.630	7169.97	3473.34	-1219.29	-3339.82	0.00	
11225.00†	90.167	268.630	7169.68	3572.72	-1221.68	-3439.79	0.00	
11325.00†	90.167	268.630	7169.38	3672.11	-1224.07	-3539.76	0.00	
11425.00†	90.167	268.630	7169.09	3771.49	-1226.46	-3639.74	0.00	
11525.00†	90.167	268.630	7168.80	3870.88	-1228.85	-3739.71	0.00	
11625.00†	90.167	268.630	7168.51	3970.27	-1231.24	-3839.68	0.00	
11725.00†	90.167	268.630	7168.22	4069.65	-1233.63	-3939.65	0.00	
11825.00†	90.167	268.630	7167.93	4169.04	-1236.02	-4039.62	0.00	
11925.00†	90.167	268.630	7167.64	4268.43	-1238.41	-4139.59	0.00	
12025.00†	90.167	268.630	7167.34	4367.81	-1240.81	-4239.56	0.00	
12125.00†	90.167	268.630	7167.05	4467.20	-1243.20	-4339.53	0.00	
12225.00†	90.167	268.630	7166.76	4566.58	-1245.59	-4439.50	0.00	
12325.00†	90.167	268.630	7166.47	4665.97	-1247.98	-4539.47	0.00	
12425.00†	90.167	268.630	7166.18	4765.36	-1250.37	-4639.45	0.00	
12525.00†	90.167	268.630	7165.89	4864.74	-1252.76	-4739.42	0.00	
12625.00†	90.167	268.630	7165.60	4964.13	-1255.15	-4839.39	0.00	
12725.00†	90.167	268.630	7165.30	5063.51	-1257.54	-4939.36	0.00	
12825.00†	90.167	268.630	7165.01	5162.90	-1259.93	-5039.33	0.00	
12925.00†	90.167	268.630	7164.72	5262.29	-1262.32	-5139.30	0.00	

Planned Wellpath Report

DONN 5C-20-L PWP (REV-B.0)

Page 5 of 6



REFERENCE WELLPATH IDENTIFICATION

Operator	SRC ENERGY	Slot	SLOT#23 DONN 5C-20-L (938'FNL & 252'FEL, SEC.21)
Area	COLORADO	Well	DONN 5C-20-L
Field	WELD COUNTY (NAD83,TRUE NORTH)	Wellbore	DONN 5C-20-L PWB
Facility	SEC.21-T06N-R66W		

WELLPATH DATA (192 stations) † = interpolated/extrapolated station

MD [ft]	Inclination [°]	Azimuth [°]	TVD [ft]	Vert Sect [ft]	North [ft]	East [ft]	DLS [°/100ft]	Comments
13025.00†	90.167	268.630	7164.43	5361.67	-1264.71	-5239.27	0.00	
13125.00†	90.167	268.630	7164.14	5461.06	-1267.10	-5339.24	0.00	
13225.00†	90.167	268.630	7163.85	5560.44	-1269.50	-5439.21	0.00	
13325.00†	90.167	268.630	7163.56	5659.83	-1271.89	-5539.18	0.00	
13425.00†	90.167	268.630	7163.26	5759.22	-1274.28	-5639.16	0.00	
13525.00†	90.167	268.630	7162.97	5858.60	-1276.67	-5739.13	0.00	
13625.00†	90.167	268.630	7162.68	5957.99	-1279.06	-5839.10	0.00	
13725.00†	90.167	268.630	7162.39	6057.38	-1281.45	-5939.07	0.00	
13825.00†	90.167	268.630	7162.10	6156.76	-1283.84	-6039.04	0.00	
13925.00†	90.167	268.630	7161.81	6256.15	-1286.23	-6139.01	0.00	
14025.00†	90.167	268.630	7161.51	6355.53	-1288.62	-6238.98	0.00	
14032.94	90.167	268.630	7161.49	6363.43	-1288.81	-6246.92	0.00	End of Tangent
14125.00†	90.167	271.392	7161.22	6454.64	-1288.79	-6338.97	3.00	
14211.94	90.167	274.000	7160.97	6540.14	-1284.71	-6425.81	3.00	End of 3D Arc
14225.00†	90.167	274.000	7160.93	6552.93	-1283.79	-6438.83	0.00	
14325.00†	90.167	274.000	7160.64	6650.84	-1276.82	-6538.59	0.00	
14411.94	90.167	274.000	7160.39	6735.97	-1270.75	-6625.32	0.00	End of Tangent
14425.00†	90.167	273.608	7160.35	6748.77	-1269.89	-6638.35	3.00	
14525.00†	90.168	270.608	7160.06	6847.29	-1266.21	-6738.27	3.00	
14625.00†	90.169	267.608	7159.76	6946.57	-1267.77	-6838.25	3.00	
14725.00†	90.169	264.608	7159.47	7046.33	-1274.55	-6938.00	3.00	
14825.00†	90.168	261.608	7159.17	7146.31	-1286.55	-7037.27	3.00	
14925.00†	90.167	258.608	7158.88	7246.22	-1303.73	-7135.77	3.00	
14937.60	90.167	258.230	7158.84	7258.80	-1306.26	-7148.12	3.00	End of 3D Arc
15025.00†	90.167	258.230	7158.59	7345.98	-1324.09	-7233.68	0.00	
15037.60	90.167	258.230	7158.55	7358.55	-1326.66	-7246.02	0.00	End of Tangent
15125.00†	90.167	260.852	7158.30	7445.84	-1342.52	-7331.95	3.00	
15225.00†	90.167	263.852	7158.01	7545.83	-1355.83	-7431.05	3.00	
15325.00†	90.166	266.852	7157.72	7645.67	-1363.93	-7530.71	3.00	
15417.62	90.165	269.631	7157.45	7737.78	-1366.77	-7623.28	3.00	End of 3D Arc
15425.00†	90.165	269.631	7157.43	7745.10	-1366.82	-7630.66	0.00	
15525.00†	90.165	269.631	7157.14	7844.28	-1367.46	-7730.65	0.00	
15625.00†	90.165	269.631	7156.85	7943.46	-1368.11	-7830.65	0.00	
15725.00†	90.165	269.631	7156.56	8042.63	-1368.75	-7930.65	0.00	
15825.00†	90.165	269.631	7156.27	8141.81	-1369.40	-8030.65	0.00	
15925.00†	90.165	269.631	7155.98	8240.99	-1370.04	-8130.64	0.00	
16025.00†	90.165	269.631	7155.70	8340.17	-1370.69	-8230.64	0.00	
16125.00†	90.165	269.631	7155.41	8439.34	-1371.33	-8330.64	0.00	
16225.00†	90.165	269.631	7155.12	8538.52	-1371.98	-8430.64	0.00	
16325.00†	90.165	269.631	7154.83	8637.70	-1372.62	-8530.63	0.00	
16425.00†	90.165	269.631	7154.54	8736.88	-1373.27	-8630.63	0.00	
16525.00†	90.165	269.631	7154.25	8836.06	-1373.91	-8730.63	0.00	
16625.00†	90.165	269.631	7153.97	8935.23	-1374.56	-8830.63	0.00	
16725.00†	90.165	269.631	7153.68	9034.41	-1375.20	-8930.62	0.00	
16825.00†	90.165	269.631	7153.39	9133.59	-1375.85	-9030.62	0.00	

Planned Wellpath Report

DONN 5C-20-L PWP (REV-B.0)

Page 6 of 6



REFERENCE WELLPATH IDENTIFICATION

Operator	SRC ENERGY	Slot	SLOT#23 DONN 5C-20-L (938'FNL & 252'FEL, SEC.21)
Area	COLORADO	Well	DONN 5C-20-L
Field	WELD COUNTY (NAD83,TRUE NORTH)	Wellbore	DONN 5C-20-L PWB
Facility	SEC.21-T06N-R66W		

WELLPATH DATA (192 stations) † = interpolated/extrapolated station

MD [ft]	Inclination [°]	Azimuth [°]	TVD [ft]	Vert Sect [ft]	North [ft]	East [ft]	DLS [°/100ft]	Comments
16925.00†	90.165	269.631	7153.10	9232.77	-1376.49	-9130.62	0.00	
17025.00†	90.165	269.631	7152.81	9331.95	-1377.14	-9230.62	0.00	
17125.00†	90.165	269.631	7152.52	9431.12	-1377.78	-9330.61	0.00	
17225.00†	90.165	269.631	7152.24	9530.30	-1378.43	-9430.61	0.00	
17325.00†	90.165	269.631	7151.95	9629.48	-1379.07	-9530.61	0.00	
17425.00†	90.165	269.631	7151.66	9728.66	-1379.72	-9630.61	0.00	
17525.00†	90.165	269.631	7151.37	9827.83	-1380.36	-9730.60	0.00	
17625.00†	90.165	269.631	7151.08	9927.01	-1381.01	-9830.60	0.00	
17725.00†	90.165	269.631	7150.79	10026.19	-1381.65	-9930.60	0.00	
17825.00†	90.165	269.631	7150.51	10125.37	-1382.30	-10030.60	0.00	
17925.00†	90.165	269.631	7150.22	10224.55	-1382.94	-10130.59	0.00	
18000.13	90.165	269.631	7150.00 ²	10299.06	-1383.43	-10205.72	0.00	End of Tangent

HOLE & CASING SECTIONS

- Ref Wellbore: DONN 5C-20-L PWB Ref Wellpath: DONN 5C-20-L PWP (REV-B.0)

String/Diameter	Start MD [ft]	End MD [ft]	Interval [ft]	Start TVD [ft]	End TVD [ft]	Start N/S [ft]	Start E/W [ft]	End N/S [ft]	End E/W [ft]
13.5in Open Hole	25.00	1750.00	1725.00	25.00	1727.35	0.00	0.00	-191.98	140.54
9.625in Casing Surface	25.00	1750.00	1725.00	25.00	1727.35	0.00	0.00	-191.98	140.54
8.5in Open Hole	1750.00	18000.13	16250.13	1727.35	7150.00	-191.98	140.54	-1383.43	-10205.72

TARGETS

Name	MD [ft]	TVD [ft]	North [ft]	East [ft]	Grid East [US ft]	Grid North [US ft]	Latitude	Longitude	Shape
SEC.20-T06N-R66W		-2.00	200.01	1.39	3201887.93	1418212.16	40°28'44.854"N	104°46'27.336"W	polygon
SEC.21-T06N-R66W		38.00	-3682.79	-6165.25	3195753.51	1414279.17	40°28'06.478"N	104°47'47.123"W	polygon
2) DONN 5C-20-L BHL ON PLAT (2129'FNL & 150'FWL, SEC.20)	18000.13	7150.00	-1383.43	-10205.72	3191694.50	1416545.30	40°28'29.186"N	104°48'39.413"W	circle
1) DONN 5C-20-L TOP OF PROD ON PLAT (2077'FNL & 150'FEL, SEC.21)	7682.94	7180.00	-1136.99	101.24	3201998.72	1416876.07	40°28'31.642"N	104°46'26.044"W	circle

SURVEY PROGRAM - Ref Wellbore: DONN 5C-20-L PWB Ref Wellpath: DONN 5C-20-L PWP (REV-B.0)

Start MD [ft]	End MD [ft]	Positional Uncertainty Model	Log Name/Comment	Wellbore
25.00	1750.00	Custom BHI NaviTrak (IFR1, Standard Rotating+Axial Corr) (Rockies 0.03Gt model)		DONN 5C-20-L PWB
1750.00	18000.13	Custom BHI AutoTrak Curve (IFR1, Short) (Rockies 0.03Gt model)		DONN 5C-20-L PWB