

SRC ENERGY

Location: COLORADO Slot: SLOT#16 DONN 4N-20C-L (798°FNL & 251°FEL, SEC.21)
Field: WELD COUNTY (NAD83, TRUE NORTH) Well: DONN 4N-20C-L
Facility: SEC.21-T06N-R66W Wellbore: DONN 4N-20C-L PWB

Plot reference wellpath is DONN 4N-20C-L PWP (REV:8.0)	Grid System: NAD83 / Lambert Colorado SP, Northern Zone (501), US feet
True vertical depths are referenced to PRECISION DRILLING (25) (RKB)	North Reference: True north
Measured depths are referenced to PRECISION DRILLING (25) (RKB)	Scale: True distance
PRECISION DRILLING (25) (RKB) to Mean Sea Level: 4777 feet	Depths are in feet
Mean Sea Level to Mud line (At Slot: SLOT#16 DONN 4N-20C-L (798°FNL & 251°FEL, SEC.21)): 0 feet	Created by: doddanna on 2017-08-25
Coordinates are in feet referenced to Slot	Database: Denver DB

Location Information

Facility Name				Grid East (US ft)	Grid North (US ft)	Latitude	Longitude
SEC.21-T06N-R66W				3201871.604	1417148.268	40°28'34.342"N	104°46'27.660"W
Slot	Local N (ft)	Local E (ft)	Grid East (US ft)	Grid North (US ft)	Latitude	Longitude	
SLOT#16 DONN 4N-20C-L (798FNL & 251FEL, SEC.21)	1003.65	24.76	3201888.149	1418152.053	40°28'44.260"N	104°46'27.340"W	
PRECISION DRILLING (25) (RKB) to Mud line (At Slot: SLOT#16 DONN 4N-20C-L (798FNL & 251FEL, SEC.21))						477ft	
Mean Sea Level to Mud line (At Slot: SLOT#16 DONN 4N-20C-L (798FNL & 251FEL, SEC.21))						0ft	
PRECISION DRILLING (25) (RKB) to Mean Sea Level						477ft	

Survey Program

Start MD (ft)	End MD (ft)	Tool	Model	Log Name/Comment	Wellbore
25.00	1750.00	BHI NavTrak	Custom BHI NavTrak (Standard Rotating+Axial Cor) (Rockies 0.03Gt model)		DONN 4N-20C-L PWB
1750.00	17836.95	BHI AutoTrak Curve	Custom BHI AutoTrak Curve (FR1, Short) (Rockies 0.03Gt model)		DONN 4N-20C-L PWB



SRC ENERGY

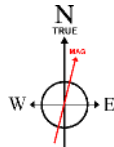

BGGM (1900.0 to 2019.0) Dip: 66.90° Field: 52436.6 nT
Magnetic North is 8.38 degrees East of True North (at 8/15/2017)

To correct azimuth from Magnetic to True add 8.38 degrees

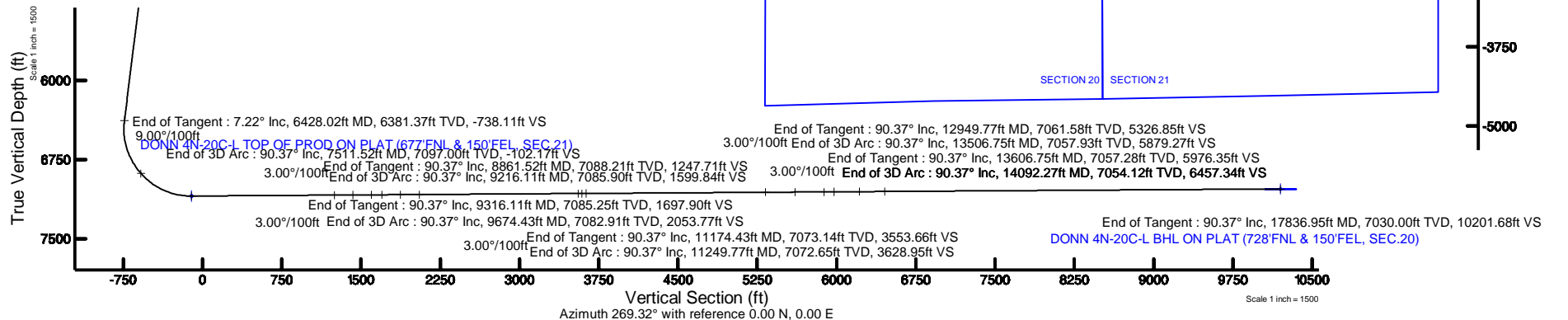

~VERSION INFORMATION

VERS. 2.0 : CWLS LOG ASCII STANDARD-VERSION 2.0

WRAP. NO : ASCII DATA SECTION CONTAINS ONE ROW PER WELLPATH STATION

~WELL INFORMATION

#MNEM	.UNITS	DATA	:DESCRIPTION
#----	.-----	----	:-----
STRT	.ft	0.00	:START MD
STOP	.ft	17836.95	:STOP MD
STEP	.ft	0.0	:STEP (non-uniform increment)
NULL	.	-999.99	:NULL
COMP	.	SRC ENERGY	:OPERATOR
WELL	.	DONN 4N-20C-L	:WELL
FLD	.	WELD COUNTY (NAD83,TRUE NORTH)	:FIELD
LOC	.	COLORADO	:AREA (aka: Location)
CNTY	.	N/A	:COUNTY
STAT	.	N/A	:STATE
CTRY	.	N/A	:COUNTRY
SRVC	.	Baker Hughes	:CONTRACTOR
DATE	.	08/16/2017	:LOG REV DATE
API	.		:API NUMBER

~OTHER INFORMATION

#Software: WellArchitect(R) Version 5.1

#MNEM	.UNITS	DATA	:DESCRIPTION
#----	.-----	----	:-----
WPTYPE	.	PLANNED WELLPATH	:WELLPATH TYPE
FACILITY	.	SEC.21-T06N-R66W	:FACILITY
SLOT	.	SLOT#16 DONN 4N-20C-L (798'FNL & 251'FEL, SEC.21)	:SLOT
WELLBORE	.	DONN 4N-20C-L PWB	:WELLBORE
WELLPATH	.	DONN 4N-20C-L PWP (REV-B.0)	:WELLPATH
MDREFPT	.	PRECISION DRILLING (25') (RKB)	:MD REFERENCE POINT
TVDREFPT	.	PRECISION DRILLING (25') (RKB)	:TVD REFERENCE POINT
LCLREFPT	.	Slot	:LOCAL COORDINATE
REFERENCE PT			
VSAZIMUTH.deg		269.32	:VERTICAL SECTION
AZIMUTH			
VSORIGN .ft		0.00	:VERTICAL SECTION
ORIGIN NORTH			
VSORIGE .ft		0.00	:VERTICAL SECTION
ORIGIN EAST			

~CURVE (WELLPATH) INFORMATION

#MNEM	.UNITS	:DESCRIPTION
#----	.-----	:-----
DEPT	.ft	:MEASURED DEPTH
INC	.deg	:INCLINATION
AZI	.deg	:AZIMUTH
TVD	.ft	:TRUE VERTICAL DEPTH
SECT	.ft	:CROSS SECTION (CURTAIN/VERTICAL)
LOCALN	.ft	:LOCAL NORTH

DONN_4N-20C-L_PWP__REV-B.0_.las

LOCALE .ft :LOCAL EAST
 LAT .deg :LATITUDE
 LONG .deg :LONGITUDE
 DLS .deg/100ft :DOGLEG SEVERITY

~ASCII DATA

0.00	0.00	80.34	0.00	0.00	0.00	0.00	40.4789610
-104.7742610	0.00						
25.00	0.00	80.34	25.00	0.00	0.00	0.00	40.4789610
-104.7742610	0.00						
125.00	0.00	80.34	125.00	0.00	0.00	0.00	40.4789610
-104.7742610	0.00						
225.00	0.00	80.34	225.00	0.00	0.00	0.00	40.4789610
-104.7742610	0.00						
300.00	0.00	80.34	300.00	0.00	0.00	0.00	40.4789610
-104.7742610	0.00						
325.00	0.50	80.34	325.00	-0.11	0.02	0.11	40.4789611
-104.7742606	2.00						
425.00	2.50	80.34	424.96	-2.69	0.46	2.69	40.4789623
-104.7742513	2.00						
525.00	4.50	80.34	524.77	-8.72	1.48	8.71	40.4789651
-104.7742297	2.00						
625.00	6.50	80.34	624.30	-18.19	3.09	18.15	40.4789695
-104.7741957	2.00						
660.88	7.22	80.34	659.93	-22.42	3.81	22.38	40.4789715
-104.7741806	2.00						
725.00	7.22	80.34	723.54	-30.38	5.16	30.32	40.4789752
-104.7741520	0.00						
825.00	7.22	80.34	822.75	-42.79	7.27	42.70	40.4789810
-104.7741075	0.00						
925.00	7.22	80.34	921.95	-55.20	9.38	55.09	40.4789868
-104.7740630	0.00						
1025.00	7.22	80.34	1021.16	-67.61	11.49	67.48	40.4789925
-104.7740185	0.00						
1125.00	7.22	80.34	1120.37	-80.02	13.60	79.86	40.4789983
-104.7739739	0.00						
1225.00	7.22	80.34	1219.58	-92.43	15.71	92.25	40.4790041
-104.7739294	0.00						
1325.00	7.22	80.34	1318.78	-104.84	17.82	104.63	40.4790099
-104.7738849	0.00						
1425.00	7.22	80.34	1417.99	-117.25	19.93	117.02	40.4790157
-104.7738404	0.00						
1525.00	7.22	80.34	1517.20	-129.66	22.04	129.40	40.4790215
-104.7737958	0.00						
1625.00	7.22	80.34	1616.41	-142.07	24.15	141.79	40.4790273
-104.7737513	0.00						
1725.00	7.22	80.34	1715.61	-154.48	26.25	154.17	40.4790331
-104.7737068	0.00						
1825.00	7.22	80.34	1814.82	-166.89	28.36	166.56	40.4790389
-104.7736623	0.00						
1925.00	7.22	80.34	1914.03	-179.29	30.47	178.95	40.4790446
-104.7736178	0.00						

DONN_4N-20C-L_PWP__REV-B.0_.las

2025.00	7.22	80.34	2013.24	-191.70	32.58	191.33	40.4790504
-104.7735732	0.00						
2125.00	7.22	80.34	2112.44	-204.11	34.69	203.72	40.4790562
-104.7735287	0.00						
2225.00	7.22	80.34	2211.65	-216.52	36.80	216.10	40.4790620
-104.7734842	0.00						
2325.00	7.22	80.34	2310.86	-228.93	38.91	228.49	40.4790678
-104.7734397	0.00						
2425.00	7.22	80.34	2410.07	-241.34	41.02	240.87	40.4790736
-104.7733952	0.00						
2525.00	7.22	80.34	2509.28	-253.75	43.13	253.26	40.4790794
-104.7733506	0.00						
2625.00	7.22	80.34	2608.48	-266.16	45.24	265.64	40.4790852
-104.7733061	0.00						
2725.00	7.22	80.34	2707.69	-278.57	47.35	278.03	40.4790910
-104.7732616	0.00						
2825.00	7.22	80.34	2806.90	-290.98	49.46	290.41	40.4790967
-104.7732171	0.00						
2925.00	7.22	80.34	2906.11	-303.39	51.56	302.80	40.4791025
-104.7731726	0.00						
3025.00	7.22	80.34	3005.31	-315.80	53.67	315.19	40.4791083
-104.7731280	0.00						
3125.00	7.22	80.34	3104.52	-328.21	55.78	327.57	40.4791141
-104.7730835	0.00						
3225.00	7.22	80.34	3203.73	-340.62	57.89	339.96	40.4791199
-104.7730390	0.00						
3325.00	7.22	80.34	3302.94	-353.03	60.00	352.34	40.4791257
-104.7729945	0.00						
3425.00	7.22	80.34	3402.14	-365.44	62.11	364.73	40.4791315
-104.7729500	0.00						
3525.00	7.22	80.34	3501.35	-377.85	64.22	377.11	40.4791373
-104.7729054	0.00						
3625.00	7.22	80.34	3600.56	-390.26	66.33	389.50	40.4791431
-104.7728609	0.00						
3725.00	7.22	80.34	3699.77	-402.67	68.44	401.88	40.4791488
-104.7728164	0.00						
3825.00	7.22	80.34	3798.97	-415.08	70.55	414.27	40.4791546
-104.7727719	0.00						
3925.00	7.22	80.34	3898.18	-427.49	72.66	426.65	40.4791604
-104.7727274	0.00						
4025.00	7.22	80.34	3997.39	-439.90	74.76	439.04	40.4791662
-104.7726828	0.00						
4125.00	7.22	80.34	4096.60	-452.31	76.87	451.43	40.4791720
-104.7726383	0.00						
4225.00	7.22	80.34	4195.80	-464.72	78.98	463.81	40.4791778
-104.7725938	0.00						
4325.00	7.22	80.34	4295.01	-477.13	81.09	476.20	40.4791836
-104.7725493	0.00						
4425.00	7.22	80.34	4394.22	-489.54	83.20	488.58	40.4791894
-104.7725047	0.00						
4525.00	7.22	80.34	4493.43	-501.95	85.31	500.97	40.4791952
-104.7724602	0.00						

DONN_4N-20C-L_PWP__REV-B.0_.las

4625.00	7.22	80.34	4592.64	-514.36	87.42	513.35	40.4792009
-104.7724157	0.00						
4725.00	7.22	80.34	4691.84	-526.77	89.53	525.74	40.4792067
-104.7723712	0.00						
4825.00	7.22	80.34	4791.05	-539.18	91.64	538.12	40.4792125
-104.7723267	0.00						
4925.00	7.22	80.34	4890.26	-551.59	93.75	550.51	40.4792183
-104.7722821	0.00						
5025.00	7.22	80.34	4989.47	-563.99	95.86	562.89	40.4792241
-104.7722376	0.00						
5125.00	7.22	80.34	5088.67	-576.40	97.97	575.28	40.4792299
-104.7721931	0.00						
5225.00	7.22	80.34	5187.88	-588.81	100.07	587.67	40.4792357
-104.7721486	0.00						
5325.00	7.22	80.34	5287.09	-601.22	102.18	600.05	40.4792415
-104.7721041	0.00						
5425.00	7.22	80.34	5386.30	-613.63	104.29	612.44	40.4792472
-104.7720595	0.00						
5525.00	7.22	80.34	5485.50	-626.04	106.40	624.82	40.4792530
-104.7720150	0.00						
5625.00	7.22	80.34	5584.71	-638.45	108.51	637.21	40.4792588
-104.7719705	0.00						
5725.00	7.22	80.34	5683.92	-650.86	110.62	649.59	40.4792646
-104.7719260	0.00						
5825.00	7.22	80.34	5783.13	-663.27	112.73	661.98	40.4792704
-104.7718815	0.00						
5925.00	7.22	80.34	5882.33	-675.68	114.84	674.36	40.4792762
-104.7718369	0.00						
6025.00	7.22	80.34	5981.54	-688.09	116.95	686.75	40.4792820
-104.7717924	0.00						
6125.00	7.22	80.34	6080.75	-700.50	119.06	699.13	40.4792878
-104.7717479	0.00						
6225.00	7.22	80.34	6179.96	-712.91	121.17	711.52	40.4792936
-104.7717034	0.00						
6325.00	7.22	80.34	6279.17	-725.32	123.27	723.91	40.4792993
-104.7716588	0.00						
6425.00	7.22	80.34	6378.37	-737.73	125.38	736.29	40.4793051
-104.7716143	0.00						
6428.02	7.22	80.34	6381.37	-738.11	125.45	736.66	40.4793053
-104.7716130	0.00						
6525.00	1.90	302.09	6478.12	-742.78	127.33	741.32	40.4793105
-104.7715963	9.00						
6625.00	10.64	274.24	6577.44	-732.17	128.90	730.68	40.4793148
-104.7716345	9.00						
6725.00	19.61	271.59	6673.88	-706.15	130.05	704.65	40.4793179
-104.7717281	9.00						
6825.00	28.60	270.57	6765.06	-665.36	130.75	663.85	40.4793199
-104.7718747	9.00						
6925.00	37.60	270.01	6848.75	-610.81	130.99	609.29	40.4793205
-104.7720708	9.00						
7025.00	46.60	269.64	6922.87	-543.84	130.76	542.32	40.4793199
-104.7723116	9.00						

DONN_4N-20C-L_PWP__REV-B.0_.las

7125.00	55.59	269.36	6985.61	-466.10	130.07	464.59	40.4793180
-104.7725910	9.00						
7225.00	64.59	269.14	7035.42	-379.51	128.94	378.00	40.4793149
-104.7729022	9.00						
7325.00	73.59	268.95	7071.07	-286.19	127.38	284.70	40.4793106
-104.7732376	9.00						
7425.00	82.59	268.78	7091.69	-188.45	125.45	186.97	40.4793053
-104.7735889	9.00						
7511.52	90.37	268.64	7097.00	-102.17	123.50	100.71	40.4793000
-104.7738990	9.00						
7525.00	90.37	268.64	7096.91	-88.69	123.18	87.23	40.4792991
-104.7739475	0.00						
7625.00	90.37	268.64	7096.26	11.31	120.81	-12.74	40.4792926
-104.7743068	0.00						
7725.00	90.37	268.64	7095.61	111.30	118.43	-112.71	40.4792861
-104.7746662	0.00						
7825.00	90.37	268.64	7094.96	211.29	116.05	-212.68	40.4792795
-104.7750255	0.00						
7925.00	90.37	268.64	7094.31	311.28	113.68	-312.65	40.4792730
-104.7753849	0.00						
8025.00	90.37	268.64	7093.66	411.27	111.30	-412.62	40.4792665
-104.7757442	0.00						
8125.00	90.37	268.64	7093.01	511.26	108.92	-512.59	40.4792600
-104.7761036	0.00						
8225.00	90.37	268.64	7092.36	611.25	106.55	-612.56	40.4792534
-104.7764629	0.00						
8325.00	90.37	268.64	7091.70	711.24	104.17	-712.53	40.4792469
-104.7768223	0.00						
8425.00	90.37	268.64	7091.05	811.23	101.79	-812.50	40.4792404
-104.7771816	0.00						
8525.00	90.37	268.64	7090.40	911.22	99.41	-912.47	40.4792338
-104.7775410	0.00						
8625.00	90.37	268.64	7089.75	1011.21	97.04	-1012.44	40.4792273
-104.7779003	0.00						
8725.00	90.37	268.64	7089.10	1111.20	94.66	-1112.41	40.4792208
-104.7782597	0.00						
8825.00	90.37	268.64	7088.45	1211.20	92.28	-1212.38	40.4792142
-104.7786190	0.00						
8861.52	90.37	268.64	7088.21	1247.71	91.42	-1248.88	40.4792118
-104.7787502	0.00						
8925.00	90.37	266.73	7087.80	1311.16	88.85	-1312.31	40.4792048
-104.7789782	3.00						
9025.00	90.38	263.73	7087.14	1410.89	80.54	-1411.95	40.4791820
-104.7793364	3.00						
9125.00	90.37	260.73	7086.49	1510.12	67.03	-1511.02	40.4791449
-104.7796925	3.00						
9216.11	90.37	258.00	7085.90	1599.84	50.22	-1600.55	40.4790987
-104.7800143	3.00						
9225.00	90.37	258.00	7085.84	1608.56	48.37	-1609.25	40.4790936
-104.7800456	0.00						
9316.11	90.37	258.00	7085.25	1697.90	29.43	-1698.37	40.4790416
-104.7803659	0.00						

DONN_4N-20C-L_PWP__REV-B.0_.las

9325.00	90.37	258.27	7085.19	1706.62	27.60	-1707.07	40.4790366
-104.7803972	3.00						
9425.00	90.37	261.27	7084.53	1805.22	9.84	-1805.47	40.4789878
-104.7807509	3.00						
9525.00	90.38	264.27	7083.88	1904.55	-2.75	-1904.66	40.4789533
-104.7811074	3.00						
9625.00	90.37	267.27	7083.23	2004.35	-10.13	-2004.37	40.4789330
-104.7814659	3.00						
9674.43	90.37	268.75	7082.91	2053.77	-11.85	-2053.77	40.4789282
-104.7816434	3.00						
9725.00	90.37	268.75	7082.58	2104.33	-12.95	-2104.32	40.4789252
-104.7818252	0.00						
9825.00	90.37	268.75	7081.93	2204.32	-15.13	-2204.30	40.4789192
-104.7821845	0.00						
9925.00	90.37	268.75	7081.27	2304.32	-17.31	-2304.27	40.4789132
-104.7825439	0.00						
10025.00	90.37	268.75	7080.62	2404.31	-19.49	-2404.25	40.4789072
-104.7829033	0.00						
10125.00	90.37	268.75	7079.97	2504.30	-21.68	-2504.22	40.4789012
-104.7832626	0.00						
10225.00	90.37	268.75	7079.32	2604.29	-23.86	-2604.19	40.4788951
-104.7836220	0.00						
10325.00	90.37	268.75	7078.67	2704.29	-26.04	-2704.17	40.4788891
-104.7839814	0.00						
10425.00	90.37	268.75	7078.02	2804.28	-28.22	-2804.14	40.4788831
-104.7843407	0.00						
10525.00	90.37	268.75	7077.37	2904.27	-30.40	-2904.12	40.4788771
-104.7847001	0.00						
10625.00	90.37	268.75	7076.72	3004.27	-32.58	-3004.09	40.4788711
-104.7850594	0.00						
10725.00	90.37	268.75	7076.07	3104.26	-34.76	-3104.07	40.4788650
-104.7854188	0.00						
10825.00	90.37	268.75	7075.42	3204.25	-36.95	-3204.04	40.4788590
-104.7857782	0.00						
10925.00	90.37	268.75	7074.76	3304.25	-39.13	-3304.01	40.4788530
-104.7861375	0.00						
11025.00	90.37	268.75	7074.11	3404.24	-41.31	-3403.99	40.4788470
-104.7864969	0.00						
11125.00	90.37	268.75	7073.46	3504.23	-43.49	-3503.96	40.4788409
-104.7868563	0.00						
11174.43	90.37	268.75	7073.14	3553.66	-44.57	-3553.38	40.4788380
-104.7870339	0.00						
11225.00	90.37	267.23	7072.81	3604.21	-46.34	-3603.92	40.4788331
-104.7872156	3.00						
11249.77	90.37	266.49	7072.65	3628.95	-47.70	-3628.64	40.4788293
-104.7873044	3.00						
11325.00	90.37	266.49	7072.16	3704.09	-52.30	-3703.73	40.4788167
-104.7875744	0.00						
11425.00	90.37	266.49	7071.51	3803.97	-58.42	-3803.54	40.4787998
-104.7879331	0.00						
11525.00	90.37	266.49	7070.86	3903.85	-64.55	-3903.36	40.4787830
-104.7882919	0.00						

DONN_4N-20C-L_PWP__REV-B.0_.las

11625.00	90.37	266.49	7070.21	4003.72	-70.67	-4003.17	40.4787661
-104.7886507	0.00						
11725.00	90.37	266.49	7069.56	4103.60	-76.79	-4102.98	40.4787493
-104.7890094	0.00						
11825.00	90.37	266.49	7068.91	4203.48	-82.91	-4202.79	40.4787324
-104.7893682	0.00						
11925.00	90.37	266.49	7068.25	4303.35	-89.04	-4302.60	40.4787156
-104.7897270	0.00						
12025.00	90.37	266.49	7067.60	4403.23	-95.16	-4402.41	40.4786987
-104.7900858	0.00						
12125.00	90.37	266.49	7066.95	4503.10	-101.28	-4502.22	40.4786819
-104.7904445	0.00						
12225.00	90.37	266.49	7066.30	4602.98	-107.40	-4602.03	40.4786650
-104.7908033	0.00						
12325.00	90.37	266.49	7065.65	4702.86	-113.52	-4701.84	40.4786482
-104.7911621	0.00						
12425.00	90.37	266.49	7065.00	4802.73	-119.65	-4801.65	40.4786313
-104.7915208	0.00						
12525.00	90.37	266.49	7064.35	4902.61	-125.77	-4901.46	40.4786144
-104.7918796	0.00						
12625.00	90.37	266.49	7063.70	5002.48	-131.89	-5001.27	40.4785976
-104.7922384	0.00						
12725.00	90.37	266.49	7063.05	5102.36	-138.01	-5101.08	40.4785807
-104.7925972	0.00						
12825.00	90.37	266.49	7062.40	5202.24	-144.13	-5200.89	40.4785639
-104.7929559	0.00						
12925.00	90.37	266.49	7061.74	5302.11	-150.26	-5300.70	40.4785470
-104.7933147	0.00						
12949.77	90.37	266.49	7061.58	5326.85	-151.77	-5325.42	40.4785428
-104.7934035	0.00						
13025.00	90.38	268.75	7061.09	5402.04	-154.90	-5400.58	40.4785342
-104.7936737	3.00						
13125.00	90.38	271.75	7060.44	5502.02	-154.47	-5500.57	40.4785353
-104.7940331	3.00						
13225.00	90.38	274.75	7059.78	5601.77	-148.80	-5600.39	40.4785508
-104.7943920	3.00						
13325.00	90.38	277.75	7059.12	5701.02	-137.92	-5699.79	40.4785806
-104.7947492	3.00						
13425.00	90.38	280.75	7058.47	5799.51	-121.86	-5798.47	40.4786247
-104.7951040	3.00						
13506.75	90.37	283.20	7057.93	5879.27	-104.90	-5878.44	40.4786711
-104.7953915	3.00						
13525.00	90.37	283.20	7057.81	5896.98	-100.73	-5896.20	40.4786826
-104.7954553	0.00						
13606.75	90.37	283.20	7057.28	5976.35	-82.06	-5975.79	40.4787338
-104.7957414	0.00						
13625.00	90.37	282.65	7057.16	5994.08	-77.98	-5993.58	40.4787450
-104.7958054	3.00						
13725.00	90.37	279.65	7056.51	6091.94	-58.64	-6091.68	40.4787980
-104.7961580	3.00						
13825.00	90.37	276.65	7055.86	6190.74	-44.46	-6190.65	40.4788368
-104.7965138	3.00						

DONN_4N-20C-L_PWP__REV-B.0_.las

13925.00	90.37	273.65	7055.20	6290.21	-35.48	-6290.24	40.4788614
-104.7968717	3.00						
14025.00	90.37	270.65	7054.55	6390.08	-31.73	-6390.15	40.4788716
-104.7972309	3.00						
14092.27	90.37	268.63	7054.12	6457.34	-32.15	-6457.41	40.4788704
-104.7974727	3.00						
14125.00	90.37	268.63	7053.91	6490.07	-32.93	-6490.13	40.4788683
-104.7975903	0.00						
14225.00	90.37	268.63	7053.26	6590.06	-35.31	-6590.10	40.4788617
-104.7979496	0.00						
14325.00	90.37	268.63	7052.62	6690.05	-37.69	-6690.07	40.4788550
-104.7983090	0.00						
14425.00	90.37	268.63	7051.98	6790.04	-40.08	-6790.04	40.4788484
-104.7986683	0.00						
14525.00	90.37	268.63	7051.33	6890.03	-42.46	-6890.01	40.4788418
-104.7990277	0.00						
14625.00	90.37	268.63	7050.69	6990.02	-44.84	-6989.98	40.4788352
-104.7993870	0.00						
14725.00	90.37	268.63	7050.04	7090.01	-47.23	-7089.95	40.4788286
-104.7997464	0.00						
14825.00	90.37	268.63	7049.40	7190.00	-49.61	-7189.92	40.4788220
-104.8001057	0.00						
14925.00	90.37	268.63	7048.76	7289.99	-51.99	-7289.89	40.4788153
-104.8004651	0.00						
15025.00	90.37	268.63	7048.11	7389.98	-54.38	-7389.86	40.4788087
-104.8008244	0.00						
15125.00	90.37	268.63	7047.47	7489.98	-56.76	-7489.83	40.4788021
-104.8011838	0.00						
15225.00	90.37	268.63	7046.82	7589.97	-59.14	-7589.80	40.4787955
-104.8015431	0.00						
15325.00	90.37	268.63	7046.18	7689.96	-61.53	-7689.77	40.4787888
-104.8019025	0.00						
15425.00	90.37	268.63	7045.54	7789.95	-63.91	-7789.74	40.4787822
-104.8022618	0.00						
15525.00	90.37	268.63	7044.89	7889.94	-66.29	-7889.71	40.4787756
-104.8026211	0.00						
15625.00	90.37	268.63	7044.25	7989.93	-68.68	-7989.68	40.4787689
-104.8029805	0.00						
15725.00	90.37	268.63	7043.60	8089.92	-71.06	-8089.65	40.4787623
-104.8033398	0.00						
15825.00	90.37	268.63	7042.96	8189.91	-73.44	-8189.62	40.4787557
-104.8036992	0.00						
15925.00	90.37	268.63	7042.31	8289.90	-75.83	-8289.59	40.4787490
-104.8040585	0.00						
16025.00	90.37	268.63	7041.67	8389.89	-78.21	-8389.56	40.4787424
-104.8044179	0.00						
16125.00	90.37	268.63	7041.03	8489.88	-80.59	-8489.53	40.4787358
-104.8047772	0.00						
16225.00	90.37	268.63	7040.38	8589.87	-82.98	-8589.49	40.4787291
-104.8051366	0.00						
16325.00	90.37	268.63	7039.74	8689.86	-85.36	-8689.46	40.4787225
-104.8054959	0.00						

DONN_4N-20C-L_PWP__REV-B.0_.las

16425.00	90.37	268.63	7039.09	8789.86	-87.74	-8789.43	40.4787159
-104.8058552	0.00						
16525.00	90.37	268.63	7038.45	8889.85	-90.13	-8889.40	40.4787092
-104.8062146	0.00						
16625.00	90.37	268.63	7037.81	8989.84	-92.51	-8989.37	40.4787026
-104.8065739	0.00						
16725.00	90.37	268.63	7037.16	9089.83	-94.89	-9089.34	40.4786959
-104.8069333	0.00						
16825.00	90.37	268.63	7036.52	9189.82	-97.28	-9189.31	40.4786893
-104.8072926	0.00						
16925.00	90.37	268.63	7035.87	9289.81	-99.66	-9289.28	40.4786826
-104.8076520	0.00						
17025.00	90.37	268.63	7035.23	9389.80	-102.04	-9389.25	40.4786760
-104.8080113	0.00						
17125.00	90.37	268.63	7034.59	9489.79	-104.43	-9489.22	40.4786694
-104.8083707	0.00						
17225.00	90.37	268.63	7033.94	9589.78	-106.81	-9589.19	40.4786627
-104.8087300	0.00						
17325.00	90.37	268.63	7033.30	9689.77	-109.19	-9689.16	40.4786561
-104.8090893	0.00						
17425.00	90.37	268.63	7032.65	9789.76	-111.58	-9789.13	40.4786494
-104.8094487	0.00						
17525.00	90.37	268.63	7032.01	9889.75	-113.96	-9889.10	40.4786428
-104.8098080	0.00						
17625.00	90.37	268.63	7031.37	9989.75	-116.34	-9989.07	40.4786361
-104.8101674	0.00						
17725.00	90.37	268.63	7030.72	10089.74	-118.73	-10089.04	40.4786294
-104.8105267	0.00						
17825.00	90.37	268.63	7030.08	10189.73	-121.11	-10189.01	40.4786228
-104.8108861	0.00						
17836.95	90.37	268.63	7030.00	10201.68	-121.39	-10200.95	40.4786220
-104.8109290	0.00						

Planned Wellpath Report

DONN 4N-20C-L PWP (REV-B.0)

Page 1 of 6



REFERENCE WELLPATH IDENTIFICATION

Operator	SRC ENERGY	Slot	SLOT#16 DONN 4N-20C-L (798'FNL & 251'FEL, SEC.21)
Area	COLORADO	Well	DONN 4N-20C-L
Field	WELD COUNTY (NAD83,TRUE NORTH)	Wellbore	DONN 4N-20C-L PWB
Facility	SEC.21-T06N-R66W		

REPORT SETUP INFORMATION

Projection System	NAD83 / Lambert Colorado SP, Northern Zone (501), US feet	Software System	WellArchitect® 5.1
North Reference	True	User	Doddanna
Scale	0.999965	Report Generated	8/25/2017 at 11:13:50 AM
Convergence at slot	0.47° East	Database/Source file	Denver DB/DONN_4N-20C-L_PWP__REV-B.0_.xml

WELLPATH LOCATION

	Local coordinates		Grid coordinates		Geographic coordinates	
	North[ft]	East[ft]	Easting[US ft]	Northing[US ft]	Latitude	Longitude
Slot Location	1003.65	24.76	3201888.15	1418152.05	40°28'44.260"N	104°46'27.340"W
Facility Reference Pt			3201871.60	1417148.27	40°28'34.342"N	104°46'27.660"W
Field Reference Pt			3171284.48	1426358.81	40°30'07.643"N	104°53'02.634"W

WELLPATH DATUM

Calculation method	Minimum curvature	PRECISION DRILLING (25') (RKB) to Facility Vertical Datum	4777.00ft
Horizontal Reference Pt	Slot	PRECISION DRILLING (25') (RKB) to Mean Sea Level	4777.00ft
Vertical Reference Pt	PRECISION DRILLING (25') (RKB)	PRECISION DRILLING (25') (RKB) to Mud Line at Slot (SLOT#16 DONN 4N-20C-L (798'FNL & 251'FEL, SEC.21))	4777.00ft
MD Reference Pt	PRECISION DRILLING (25') (RKB)	Section Origin	N 0.00, E 0.00 ft
Field Vertical Reference	Mean Sea Level	Section Azimuth	269.32°

Planned Wellpath Report

DONN 4N-20C-L PWP (REV-B.0)

Page 2 of 6



REFERENCE WELLPATH IDENTIFICATION

Operator	SRC ENERGY	Slot	SLOT#16 DONN 4N-20C-L (798'FNL & 251'FEL, SEC.21)
Area	COLORADO	Well	DONN 4N-20C-L
Field	WELD COUNTY (NAD83,TRUE NORTH)	Wellbore	DONN 4N-20C-L PWB
Facility	SEC.21-T06N-R66W		

WELLPATH DATA (195 stations) † = interpolated/extrapolated station

MD [ft]	Inclination [°]	Azimuth [°]	TVD [ft]	Vert Sect [ft]	North [ft]	East [ft]	DLS [°/100ft]	Comments
0.00†	0.000	80.336	0.00	0.00	0.00	0.00	0.00	
25.00	0.000	80.336	25.00	0.00	0.00	0.00	0.00	2
125.00†	0.000	80.336	125.00	0.00	0.00	0.00	0.00	
225.00†	0.000	80.336	225.00	0.00	0.00	0.00	0.00	
300.00	0.000	80.336	300.00	0.00	0.00	0.00	0.00	End of Tangent
325.00†	0.500	80.336	325.00	-0.11	0.02	0.11	2.00	
425.00†	2.500	80.336	424.96	-2.69	0.46	2.69	2.00	
525.00†	4.500	80.336	524.77	-8.72	1.48	8.71	2.00	
625.00†	6.500	80.336	624.30	-18.19	3.09	18.15	2.00	
660.88	7.218	80.336	659.93	-22.42	3.81	22.38	2.00	End of Build
725.00†	7.218	80.336	723.54	-30.38	5.16	30.32	0.00	
825.00†	7.218	80.336	822.75	-42.79	7.27	42.70	0.00	
925.00†	7.218	80.336	921.95	-55.20	9.38	55.09	0.00	
1025.00†	7.218	80.336	1021.16	-67.61	11.49	67.48	0.00	
1125.00†	7.218	80.336	1120.37	-80.02	13.60	79.86	0.00	
1225.00†	7.218	80.336	1219.58	-92.43	15.71	92.25	0.00	
1325.00†	7.218	80.336	1318.78	-104.84	17.82	104.63	0.00	
1425.00†	7.218	80.336	1417.99	-117.25	19.93	117.02	0.00	
1525.00†	7.218	80.336	1517.20	-129.66	22.04	129.40	0.00	
1625.00†	7.218	80.336	1616.41	-142.07	24.15	141.79	0.00	
1725.00†	7.218	80.336	1715.61	-154.48	26.25	154.17	0.00	
1825.00†	7.218	80.336	1814.82	-166.89	28.36	166.56	0.00	
1925.00†	7.218	80.336	1914.03	-179.29	30.47	178.95	0.00	
2025.00†	7.218	80.336	2013.24	-191.70	32.58	191.33	0.00	
2125.00†	7.218	80.336	2112.44	-204.11	34.69	203.72	0.00	
2225.00†	7.218	80.336	2211.65	-216.52	36.80	216.10	0.00	
2325.00†	7.218	80.336	2310.86	-228.93	38.91	228.49	0.00	
2425.00†	7.218	80.336	2410.07	-241.34	41.02	240.87	0.00	
2525.00†	7.218	80.336	2509.28	-253.75	43.13	253.26	0.00	
2625.00†	7.218	80.336	2608.48	-266.16	45.24	265.64	0.00	
2725.00†	7.218	80.336	2707.69	-278.57	47.35	278.03	0.00	
2825.00†	7.218	80.336	2806.90	-290.98	49.46	290.41	0.00	
2925.00†	7.218	80.336	2906.11	-303.39	51.56	302.80	0.00	
3025.00†	7.218	80.336	3005.31	-315.80	53.67	315.19	0.00	
3125.00†	7.218	80.336	3104.52	-328.21	55.78	327.57	0.00	
3225.00†	7.218	80.336	3203.73	-340.62	57.89	339.96	0.00	
3325.00†	7.218	80.336	3302.94	-353.03	60.00	352.34	0.00	
3425.00†	7.218	80.336	3402.14	-365.44	62.11	364.73	0.00	
3525.00†	7.218	80.336	3501.35	-377.85	64.22	377.11	0.00	
3625.00†	7.218	80.336	3600.56	-390.26	66.33	389.50	0.00	
3725.00†	7.218	80.336	3699.77	-402.67	68.44	401.88	0.00	
3825.00†	7.218	80.336	3798.97	-415.08	70.55	414.27	0.00	
3925.00†	7.218	80.336	3898.18	-427.49	72.66	426.65	0.00	
4025.00†	7.218	80.336	3997.39	-439.90	74.76	439.04	0.00	
4125.00†	7.218	80.336	4096.60	-452.31	76.87	451.43	0.00	

Planned Wellpath Report

DONN 4N-20C-L PWP (REV-B.0)

Page 3 of 6



REFERENCE WELLPATH IDENTIFICATION

Operator	SRC ENERGY	Slot	SLOT#16 DONN 4N-20C-L (798'FNL & 251'FEL, SEC.21)
Area	COLORADO	Well	DONN 4N-20C-L
Field	WELD COUNTY (NAD83,TRUE NORTH)	Wellbore	DONN 4N-20C-L PWB
Facility	SEC.21-T06N-R66W		

WELLPATH DATA (195 stations) † = interpolated/extrapolated station

MD [ft]	Inclination [°]	Azimuth [°]	TVD [ft]	Vert Sect [ft]	North [ft]	East [ft]	DLS [°/100ft]	Comments
4225.00†	7.218	80.336	4195.80	-464.72	78.98	463.81	0.00	
4325.00†	7.218	80.336	4295.01	-477.13	81.09	476.20	0.00	
4425.00†	7.218	80.336	4394.22	-489.54	83.20	488.58	0.00	
4525.00†	7.218	80.336	4493.43	-501.95	85.31	500.97	0.00	
4625.00†	7.218	80.336	4592.64	-514.36	87.42	513.35	0.00	
4725.00†	7.218	80.336	4691.84	-526.77	89.53	525.74	0.00	
4825.00†	7.218	80.336	4791.05	-539.18	91.64	538.12	0.00	
4925.00†	7.218	80.336	4890.26	-551.59	93.75	550.51	0.00	
5025.00†	7.218	80.336	4989.47	-563.99	95.86	562.89	0.00	
5125.00†	7.218	80.336	5088.67	-576.40	97.97	575.28	0.00	
5225.00†	7.218	80.336	5187.88	-588.81	100.07	587.67	0.00	
5325.00†	7.218	80.336	5287.09	-601.22	102.18	600.05	0.00	
5425.00†	7.218	80.336	5386.30	-613.63	104.29	612.44	0.00	
5525.00†	7.218	80.336	5485.50	-626.04	106.40	624.82	0.00	
5625.00†	7.218	80.336	5584.71	-638.45	108.51	637.21	0.00	
5725.00†	7.218	80.336	5683.92	-650.86	110.62	649.59	0.00	
5825.00†	7.218	80.336	5783.13	-663.27	112.73	661.98	0.00	
5925.00†	7.218	80.336	5882.33	-675.68	114.84	674.36	0.00	
6025.00†	7.218	80.336	5981.54	-688.09	116.95	686.75	0.00	
6125.00†	7.218	80.336	6080.75	-700.50	119.06	699.13	0.00	
6225.00†	7.218	80.336	6179.96	-712.91	121.17	711.52	0.00	
6325.00†	7.218	80.336	6279.17	-725.32	123.27	723.91	0.00	
6425.00†	7.218	80.336	6378.37	-737.73	125.38	736.29	0.00	
6428.02	7.218	80.336	6381.37	-738.11	125.45	736.66	0.00	End of Tangent
6525.00†	1.902	302.093	6478.12	-742.78	127.33	741.32	9.00	
6625.00†	10.638	274.236	6577.44	-732.17	128.90	730.68	9.00	
6725.00†	19.614	271.589	6673.88	-706.15	130.05	704.65	9.00	
6825.00†	28.604	270.568	6765.06	-665.36	130.75	663.85	9.00	
6925.00†	37.599	270.007	6848.75	-610.81	130.99	609.29	9.00	
7025.00†	46.596	269.637	6922.87	-543.84	130.76	542.32	9.00	
7125.00†	55.593	269.363	6985.61	-466.10	130.07	464.59	9.00	
7225.00†	64.591	269.143	7035.42	-379.51	128.94	378.00	9.00	
7325.00†	73.590	268.954	7071.07	-286.19	127.38	284.70	9.00	
7425.00†	82.588	268.781	7091.69	-188.45	125.45	186.97	9.00	
7511.52	90.373	268.638	7097.00†	-102.17	123.50	100.71	9.00	End of 3D Arc
7525.00†	90.373	268.638	7096.91	-88.69	123.18	87.23	0.00	
7625.00†	90.373	268.638	7096.26	11.31	120.81	-12.74	0.00	
7725.00†	90.373	268.638	7095.61	111.30	118.43	-112.71	0.00	
7825.00†	90.373	268.638	7094.96	211.29	116.05	-212.68	0.00	
7925.00†	90.373	268.638	7094.31	311.28	113.68	-312.65	0.00	
8025.00†	90.373	268.638	7093.66	411.27	111.30	-412.62	0.00	
8125.00†	90.373	268.638	7093.01	511.26	108.92	-512.59	0.00	
8225.00†	90.373	268.638	7092.36	611.25	106.55	-612.56	0.00	
8325.00†	90.373	268.638	7091.70	711.24	104.17	-712.53	0.00	
8425.00†	90.373	268.638	7091.05	811.23	101.79	-812.50	0.00	

Planned Wellpath Report

DONN 4N-20C-L PWP (REV-B.0)

Page 4 of 6



REFERENCE WELLPATH IDENTIFICATION

Operator	SRC ENERGY	Slot	SLOT#16 DONN 4N-20C-L (798'FNL & 251'FEL, SEC.21)
Area	COLORADO	Well	DONN 4N-20C-L
Field	WELD COUNTY (NAD83,TRUE NORTH)	Wellbore	DONN 4N-20C-L PWB
Facility	SEC.21-T06N-R66W		

WELLPATH DATA (195 stations) † = interpolated/extrapolated station

MD [ft]	Inclination [°]	Azimuth [°]	TVD [ft]	Vert Sect [ft]	North [ft]	East [ft]	DLS [°/100ft]	Comments
8525.00†	90.373	268.638	7090.40	911.22	99.41	-912.47	0.00	
8625.00†	90.373	268.638	7089.75	1011.21	97.04	-1012.44	0.00	
8725.00†	90.373	268.638	7089.10	1111.20	94.66	-1112.41	0.00	
8825.00†	90.373	268.638	7088.45	1211.20	92.28	-1212.38	0.00	
8861.52	90.373	268.638	7088.21	1247.71	91.42	-1248.88	0.00	End of Tangent
8925.00†	90.374	266.733	7087.80	1311.16	88.85	-1312.31	3.00	
9025.00†	90.375	263.733	7087.14	1410.89	80.54	-1411.95	3.00	
9125.00†	90.374	260.733	7086.49	1510.12	67.03	-1511.02	3.00	
9216.11	90.373	258.000	7085.90	1599.84	50.22	-1600.55	3.00	End of 3D Arc
9225.00†	90.373	258.000	7085.84	1608.56	48.37	-1609.25	0.00	
9316.11	90.373	258.000	7085.25	1697.90	29.43	-1698.37	0.00	End of Tangent
9325.00†	90.373	258.267	7085.19	1706.62	27.60	-1707.07	3.00	
9425.00†	90.374	261.267	7084.53	1805.22	9.84	-1805.47	3.00	
9525.00†	90.375	264.267	7083.88	1904.55	-2.75	-1904.66	3.00	
9625.00†	90.374	267.267	7083.23	2004.35	-10.13	-2004.37	3.00	
9674.43	90.373	268.750	7082.91	2053.77	-11.85	-2053.77	3.00	End of 3D Arc
9725.00†	90.373	268.750	7082.58	2104.33	-12.95	-2104.32	0.00	
9825.00†	90.373	268.750	7081.93	2204.32	-15.13	-2204.30	0.00	
9925.00†	90.373	268.750	7081.27	2304.32	-17.31	-2304.27	0.00	
10025.00†	90.373	268.750	7080.62	2404.31	-19.49	-2404.25	0.00	
10125.00†	90.373	268.750	7079.97	2504.30	-21.68	-2504.22	0.00	
10225.00†	90.373	268.750	7079.32	2604.29	-23.86	-2604.19	0.00	
10325.00†	90.373	268.750	7078.67	2704.29	-26.04	-2704.17	0.00	
10425.00†	90.373	268.750	7078.02	2804.28	-28.22	-2804.14	0.00	
10525.00†	90.373	268.750	7077.37	2904.27	-30.40	-2904.12	0.00	
10625.00†	90.373	268.750	7076.72	3004.27	-32.58	-3004.09	0.00	
10725.00†	90.373	268.750	7076.07	3104.26	-34.76	-3104.07	0.00	
10825.00†	90.373	268.750	7075.42	3204.25	-36.95	-3204.04	0.00	
10925.00†	90.373	268.750	7074.76	3304.25	-39.13	-3304.01	0.00	
11025.00†	90.373	268.750	7074.11	3404.24	-41.31	-3403.99	0.00	
11125.00†	90.373	268.750	7073.46	3504.23	-43.49	-3503.96	0.00	
11174.43	90.373	268.750	7073.14	3553.66	-44.57	-3553.38	0.00	End of Tangent
11225.00†	90.373	267.233	7072.81	3604.21	-46.34	-3603.92	3.00	
11249.77	90.373	266.490	7072.65	3628.95	-47.70	-3628.64	3.00	End of 3D Arc
11325.00†	90.373	266.490	7072.16	3704.09	-52.30	-3703.73	0.00	
11425.00†	90.373	266.490	7071.51	3803.97	-58.42	-3803.54	0.00	
11525.00†	90.373	266.490	7070.86	3903.85	-64.55	-3903.36	0.00	
11625.00†	90.373	266.490	7070.21	4003.72	-70.67	-4003.17	0.00	
11725.00†	90.373	266.490	7069.56	4103.60	-76.79	-4102.98	0.00	
11825.00†	90.373	266.490	7068.91	4203.48	-82.91	-4202.79	0.00	
11925.00†	90.373	266.490	7068.25	4303.35	-89.04	-4302.60	0.00	
12025.00†	90.373	266.490	7067.60	4403.23	-95.16	-4402.41	0.00	
12125.00†	90.373	266.490	7066.95	4503.10	-101.28	-4502.22	0.00	
12225.00†	90.373	266.490	7066.30	4602.98	-107.40	-4602.03	0.00	
12325.00†	90.373	266.490	7065.65	4702.86	-113.52	-4701.84	0.00	

Planned Wellpath Report

DONN 4N-20C-L PWP (REV-B.0)

Page 5 of 6



REFERENCE WELLPATH IDENTIFICATION

Operator	SRC ENERGY	Slot	SLOT#16 DONN 4N-20C-L (798'FNL & 251'FEL, SEC.21)
Area	COLORADO	Well	DONN 4N-20C-L
Field	WELD COUNTY (NAD83,TRUE NORTH)	Wellbore	DONN 4N-20C-L PWB
Facility	SEC.21-T06N-R66W		

WELLPATH DATA (195 stations) † = interpolated/extrapolated station

MD [ft]	Inclination [°]	Azimuth [°]	TVD [ft]	Vert Sect [ft]	North [ft]	East [ft]	DLS [°/100ft]	Comments
12425.00†	90.373	266.490	7065.00	4802.73	-119.65	-4801.65	0.00	
12525.00†	90.373	266.490	7064.35	4902.61	-125.77	-4901.46	0.00	
12625.00†	90.373	266.490	7063.70	5002.48	-131.89	-5001.27	0.00	
12725.00†	90.373	266.490	7063.05	5102.36	-138.01	-5101.08	0.00	
12825.00†	90.373	266.490	7062.40	5202.24	-144.13	-5200.89	0.00	
12925.00†	90.373	266.490	7061.74	5302.11	-150.26	-5300.70	0.00	
12949.77	90.373	266.490	7061.58	5326.85	-151.77	-5325.42	0.00	End of Tangent
13025.00†	90.375	268.747	7061.09	5402.04	-154.90	-5400.58	3.00	
13125.00†	90.376	271.747	7060.44	5502.02	-154.47	-5500.57	3.00	
13225.00†	90.377	274.747	7059.78	5601.77	-148.80	-5600.39	3.00	
13325.00†	90.377	277.747	7059.12	5701.02	-137.92	-5699.79	3.00	
13425.00†	90.375	280.747	7058.47	5799.51	-121.86	-5798.47	3.00	
13506.75	90.373	283.200	7057.93	5879.27	-104.90	-5878.44	3.00	End of 3D Arc
13525.00†	90.373	283.200	7057.81	5896.98	-100.73	-5896.20	0.00	
13606.75	90.373	283.200	7057.28	5976.35	-82.06	-5975.79	0.00	End of Tangent
13625.00†	90.373	282.653	7057.16	5994.08	-77.98	-5993.58	3.00	
13725.00†	90.374	279.653	7056.51	6091.94	-58.64	-6091.68	3.00	
13825.00†	90.374	276.652	7055.86	6190.74	-44.46	-6190.65	3.00	
13925.00†	90.373	273.652	7055.20	6290.21	-35.48	-6290.24	3.00	
14025.00†	90.371	270.652	7054.55	6390.08	-31.73	-6390.15	3.00	
14092.27	90.369	268.634	7054.12	6457.34	-32.15	-6457.41	3.00	End of 3D Arc
14125.00†	90.369	268.634	7053.91	6490.07	-32.93	-6490.13	0.00	
14225.00†	90.369	268.634	7053.26	6590.06	-35.31	-6590.10	0.00	
14325.00†	90.369	268.634	7052.62	6690.05	-37.69	-6690.07	0.00	
14425.00†	90.369	268.634	7051.98	6790.04	-40.08	-6790.04	0.00	
14525.00†	90.369	268.634	7051.33	6890.03	-42.46	-6890.01	0.00	
14625.00†	90.369	268.634	7050.69	6990.02	-44.84	-6989.98	0.00	
14725.00†	90.369	268.634	7050.04	7090.01	-47.23	-7089.95	0.00	
14825.00†	90.369	268.634	7049.40	7190.00	-49.61	-7189.92	0.00	
14925.00†	90.369	268.634	7048.76	7289.99	-51.99	-7289.89	0.00	
15025.00†	90.369	268.634	7048.11	7389.98	-54.38	-7389.86	0.00	
15125.00†	90.369	268.634	7047.47	7489.98	-56.76	-7489.83	0.00	
15225.00†	90.369	268.634	7046.82	7589.97	-59.14	-7589.80	0.00	
15325.00†	90.369	268.634	7046.18	7689.96	-61.53	-7689.77	0.00	
15425.00†	90.369	268.634	7045.54	7789.95	-63.91	-7789.74	0.00	
15525.00†	90.369	268.634	7044.89	7889.94	-66.29	-7889.71	0.00	
15625.00†	90.369	268.634	7044.25	7989.93	-68.68	-7989.68	0.00	
15725.00†	90.369	268.634	7043.60	8089.92	-71.06	-8089.65	0.00	
15825.00†	90.369	268.634	7042.96	8189.91	-73.44	-8189.62	0.00	
15925.00†	90.369	268.634	7042.31	8289.90	-75.83	-8289.59	0.00	
16025.00†	90.369	268.634	7041.67	8389.89	-78.21	-8389.56	0.00	
16125.00†	90.369	268.634	7041.03	8489.88	-80.59	-8489.53	0.00	
16225.00†	90.369	268.634	7040.38	8589.87	-82.98	-8589.49	0.00	
16325.00†	90.369	268.634	7039.74	8689.86	-85.36	-8689.46	0.00	
16425.00†	90.369	268.634	7039.09	8789.86	-87.74	-8789.43	0.00	

Planned Wellpath Report

DONN 4N-20C-L PWP (REV-B.0)

Page 6 of 6



REFERENCE WELLPATH IDENTIFICATION

Operator	SRC ENERGY	Slot	SLOT#16 DONN 4N-20C-L (798'FNL & 251'FEL, SEC.21)
Area	COLORADO	Well	DONN 4N-20C-L
Field	WELD COUNTY (NAD83,TRUE NORTH)	Wellbore	DONN 4N-20C-L PWB
Facility	SEC.21-T06N-R66W		

WELLPATH DATA (195 stations) † = interpolated/extrapolated station

MD [ft]	Inclination [°]	Azimuth [°]	TVD [ft]	Vert Sect [ft]	North [ft]	East [ft]	DLS [°/100ft]	Comments
16525.00†	90.369	268.634	7038.45	8889.85	-90.13	-8889.40	0.00	
16625.00†	90.369	268.634	7037.81	8989.84	-92.51	-8989.37	0.00	
16725.00†	90.369	268.634	7037.16	9089.83	-94.89	-9089.34	0.00	
16825.00†	90.369	268.634	7036.52	9189.82	-97.28	-9189.31	0.00	
16925.00†	90.369	268.634	7035.87	9289.81	-99.66	-9289.28	0.00	
17025.00†	90.369	268.634	7035.23	9389.80	-102.04	-9389.25	0.00	
17125.00†	90.369	268.634	7034.59	9489.79	-104.43	-9489.22	0.00	
17225.00†	90.369	268.634	7033.94	9589.78	-106.81	-9589.19	0.00	
17325.00†	90.369	268.634	7033.30	9689.77	-109.19	-9689.16	0.00	
17425.00†	90.369	268.634	7032.65	9789.76	-111.58	-9789.13	0.00	
17525.00†	90.369	268.634	7032.01	9889.75	-113.96	-9889.10	0.00	
17625.00†	90.369	268.634	7031.37	9989.75	-116.34	-9989.07	0.00	
17725.00†	90.369	268.634	7030.72	10089.74	-118.73	-10089.04	0.00	
17825.00†	90.369	268.634	7030.08	10189.73	-121.11	-10189.01	0.00	
17836.95	90.369	268.634	7030.00 ²	10201.68	-121.39	-10200.95	0.00	End of Tangent

HOLE & CASING SECTIONS

- Ref Wellbore: DONN 4N-20C-L PWB Ref Wellpath: DONN 4N-20C-L PWP (REV-B.0)

String/Diameter	Start MD [ft]	End MD [ft]	Interval [ft]	Start TVD [ft]	End TVD [ft]	Start N/S [ft]	Start E/W [ft]	End N/S [ft]	End E/W [ft]
13.5in Open Hole	25.00	1750.00	1725.00	25.00	1740.42	0.00	0.00	26.78	157.27
9.625in Casing Surface	25.00	1750.00	1725.00	25.00	1740.42	0.00	0.00	26.78	157.27
8.5in Open Hole	1750.00	17836.95	16086.95	1740.42	7030.00	26.78	157.27	-121.39	-10200.95

TARGETS

Name	MD [ft]	TVD [ft]	North [ft]	East [ft]	Grid East [US ft]	Grid North [US ft]	Latitude	Longitude	Shape
SEC.20-T06N-R66W		-1.00	60.11	0.28	3201887.93	1418212.16	40°28'44.854"N	104°46'27.336"W	polygon
SEC.21-T06N-R66W		39.00	-3822.69	-6166.36	3195753.51	1414279.17	40°28'06.478"N	104°47'47.123"W	polygon
2) DONN 4N-20C-L BHL ON PLAT (728'FNL & 150'FEL, SEC.20)	17836.95	7030.00	-121.39	-10200.95	3191688.91	1417947.18	40°28'43.039"N	104°48'39.344"W	circle
1) DONN 4N-20C-L TOP OF PROD ON PLAT (677'FNL & 150'FEL, SEC.21)	7511.52	7097.00	123.50	100.71	3201987.84	1418276.37	40°28'45.480"N	104°46'26.036"W	circle

SURVEY PROGRAM - Ref Wellbore: DONN 4N-20C-L PWB Ref Wellpath: DONN 4N-20C-L PWP (REV-B.0)

Start MD [ft]	End MD [ft]	Positional Uncertainty Model	Log Name/Comment	Wellbore
25.00	1750.00	Custom BHI NaviTrak (Standard Rotating+Axial Corr) (Rockies 0.03Gt model)		DONN 4N-20C-L PWB
1750.00	17836.95	Custom BHI AutoTrak Curve (IFR1, Short) (Rockies 0.03Gt model)		DONN 4N-20C-L PWB

SURVEY PROGRAM

- Ref Wellbore: DONN 4N-20C-L PWB

Ref Wellpath: DONN 4N-20C-L PWP (REV-B.0)

Start MD [ft]	End MD [ft]	Positional Uncertainty Model	Log Name/Comment	Wellbore
------------------	----------------	------------------------------	---------------------	----------