



G E R R I T Y
O I L & G A S
C O R P O R A T I O N

April 14, 1993

Guttersen & Company
P. O. Box 528
Kersey, Colorado 80644

Re: Township 3 North, Range 64 West, 6th P.M.
Section 23: S $\frac{1}{2}$
Weld County, Colorado
Parker Blue D 23-9, 10, 11, 13, 14, 15, 3J

Gentlemen:

The purpose of this letter is to advise you that Gerrity Oil & Gas Corporation will be drilling seven wells for oil and gas at the following drillsite locations:

#9 - NE $\frac{1}{4}$ SE $\frac{1}{4}$
#10 - NW $\frac{1}{4}$ SE $\frac{1}{4}$
#11 - NE $\frac{1}{4}$ SW $\frac{1}{4}$
#13 - SW $\frac{1}{4}$ SW $\frac{1}{4}$
#14 - SE $\frac{1}{4}$ SW $\frac{1}{4}$
#15 - SW $\frac{1}{4}$ SE $\frac{1}{4}$
#3J - NW $\frac{1}{4}$ SW $\frac{1}{4}$
Section 23, T3N-R64W
Weld County, Colorado

Access to the drillsites will be by means of the access road identified in the plat attached to this letter. A representative of Gerrity Oil & Gas Corporation will be in contact with you in the near future to discuss the location of the roads, production sites and facilities that will be necessary in connection with the drilling, completion and production of the wells at the drillsites identified above.

If you have any questions about this letter or the activities to be conducted in connection with the drilling of the wells identified above, please contact Tom Majors at our Platteville, Colorado office, telephone number 353-3657, or 939-8585 from Denver.

Very truly yours,

Debra Allen-Wittke
Landman

DAW:kkp

c: Tom Majors
Clerk to the Board of Commissioners
Dianne Goodrich
Mike Nuss

4100 East Mississippi Avenue
Suite 1200
Denver, Colorado 80222
Fax 303 757.1197
Telephone 303 757.1110

**PARKER BLUE D 23-9, 10, 11, 13, 14, 15, 3J
SECTION 23 - TOWNSHIP 3 NORTH - RANGE 64 WEST
OF THE SIXTH PRINCIPAL MERIDIAN
WELD COUNTY, COLORADO**

ACCESS TO BE DETERMINED BY ART GUTTERSEN & TOM MAJORS

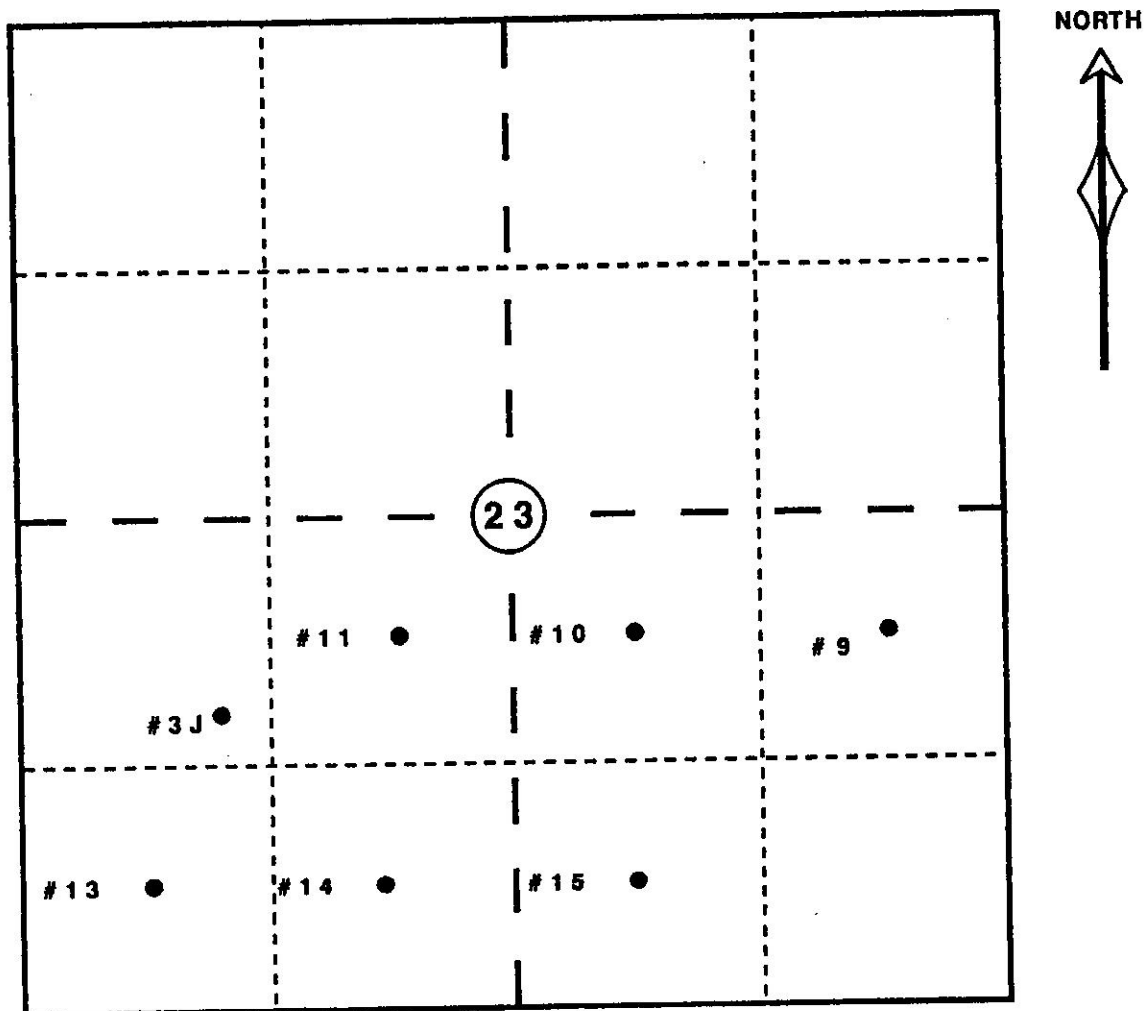

SCALE: 1 INCH = 1000'

**GERRITY
OIL & GAS
CORPORATION**

WAIVER

TO WHOM IT MAY CONCERN:

Please be advised that Gutteresen & Co., a Colorado Limited Partnership, with an address of P.O. Box 528, Kersey, CO 80644, pursuant to paragraph 11A3(b), hereby waives the 30-day minimum notice requirement set forth in paragraph 11A of Cause No. 1, Docket No. 1-12-20, adopted by the Oil and Gas Conservation Commission for the State of Colorado, subject to the provisions hereof.

This Waiver is for the sole and exclusive benefit of Gerrity Oil and Gas Corporation for any wells drilled by it on the lands described on Exhibit "A" attached hereto and made a part hereof. This Waiver is ineffective as to any applicant/operator other than Gerrity Oil and Gas Corporation.

This Waiver is in no way intended to amend, modify or alter the terms of that certain Agreement dated December 31, 1992, effective, however, for all purposes as of June 1, 1992, by and between Gutteresen & Co. and Gerrity Oil and Gas Corporation.

In witness whereof, this Waiver has been executed this 23rd day of March, 1993.

GUTTERSEN & CO.

By 
Mike Gutteresen, General Partner

EXHIBIT A - PART I

Surface Check

Basis of Title: Weld County Assessor's Records

Guttersen & Company
P.O. Box 528
Kersey, CO 80644

Township 2 North, Range 63 West, 6th P.M.

Section 4: Part SW ¼ (Parcel #130304000003)
Section 5: All
Section 8: All

Township 2 North, Range 64 West, 6th P.M.

Section 4: N ½, SE ¼

Township 3 North, Range 63 West, 6th P.M.

Section 5: All
Section 6: S ½, E ½ NE ¼, SW ¼ NE ¼, SE ¼ NW ¼
Section 7: All
Section 8: E ½
Section 17: All
Section 18: SW ¼, S ½ NW ¼, N ½ SE ¼
Section 19: All
Section 28: NW ¼
Section 29: All
Section 30: W ½, W ½ E ½
Section 32: All
Section 33: W ½

Township 3 North, Range 64 West, 6th P.M.

Section 1: All
Section 2: S ½
Section 3: All exc. parcel described by metes and bounds (Parcel # 121503000008)
Section 4: All exc. parcel described by metes and bounds (Parcel # 121504000018)
Section 9: All exc. parcel described by metes and bounds (Parcel # 121509000006)
Section 10: NE ¼
Section 11: All
Section 12: S ½
Section 13: All
Section 14: E ½ NW ¼, W ½ NE ¼, E ½ E ¼
Section 15: All
Section 17: SE ¼
Section 20: E ½ SW ¼
Section 21: All
Section 22: NW ¼
Section 23: All
Section 24: S ½ NW ¼
Section 25: NE ¼, Pt. NW ¼ (Parcel # 121525000006)
Section 29: All
Section 33: All

Township 4 North, Range 63 West, 6th P.M.

Section 7: Pt. SE ¼ (Parcel # 105107000008)
Section 8: All
Section 9: All
Section 17: All
Section 29: All

Township 4 North, Range 64 West, 6th P.M.

Section 33: All
Section 34: NW ¼, SE ¼

EXHIBIT A - PART 2

Township 4 North, Range 63 West, 6th P.M.

Section 32: All

Township 3 North, Range 64 West, 6th P.M.

Section 10: S½

Section 14: W½NW¼

SW¼

W½SE¼

Section 16: All

Section 22: E½

SW¼

Section 28: All

Township 2 North, Range 63 West, 6th P.M.

Section 4: S½NW¼

Lot 2

Township 3 North, Range 63 West, 6th P.M.

Section 8: W½

Section 18: NE¼

NE¼NW¼

Lot 1

S½SE¼

Section 20: All

Section 28: SW¼

Section 30: E½E½

Township 4 North, Range 63 West, 6th P.M.

Section 16: All

Section 20: All

Township 3 North, Range 64 West, 6th P.M.

Section 12: N½

EXHIBIT A - PART 3

Township 3 North, Range 64 West, 6th P.M.

Section 27: All
Section 34: All
Section 35: All
Section 26: S½, NW¼

Township 2 North, Range 64 West, 6th P.M.

Section 2: All
Section 3: All
Section 10: All
Section 11: N½