

State of Colorado
Oil and Gas Conservation Commission

1120 Lincoln Street, Suite 801, Denver, Colorado 80203 (303)894-2100 Fax: (303)894-2109



FOR OGCC USE ONLY

1. TYPE OF WORK

☒ Drill, ☐ Deepen, ☐ Re-enter, ☐ Recomplete and Operate

2. TYPE OF WELL

OIL ☒ GAS ☐ COAL BED ☐ OTHER: ☐
SINGLE ZONE ☐ MULTIPLE ZONE ☒ COMMINGLE ZONES ☒Refilling ☐Side Track ☐Plugging Surety Bond ID#
019S101144308BCM

1999 0028

3. OGCC Operator Number: 41385

4. Name of Operator: HS Resources, Inc.

5. Address: 3939 Carson Avenue

City: Evans

State: CO

Zip: 80620

6. Contact Name & Phone

Elaine Winick

No: 970-330-0614

Fax: 970-330-0431

7. Well Name: HSR-FOSTER RIDGE

Well Number: 8-27

8. Unit Name (if Appl.):

Unit No:

9. Proposed Total Depth: 8400'

WELL LOCATION INFORMATION

10. QtrQtr: SWNE Sec: 27 Twn: 3N Rng: 68W Meridian: 6th

Footage From Exterior Section Lines:

At Surface: 1538' FNL & 2187' FEL

11. Field Name: Wattenberg

Field Number: 90750

12. Ground Elevation: 4928'

13. County: Weld

14. If well is: ☒ Directional ☐ Horizontal (Highly Deviated), submit deviated drilling plan

Footage From Exterior Section Lines and Sec Twp Rng:

At top of Production Zone: 1992' FNL & 658' FEL At Bottom Hole: 1992' FNL & 658' FEL

15. Is location in a high density area (Rule 603b)? ☐ Yes ☒ No

16. Distance to nearest building, public road, major above ground utility or railroad: 250'

17. Distance to nearest Property Line: 453'

18. Distance to nearest well completed in the same Formation: 1400'

19. LEASE, SPACING, AND POOLING INFORMATION

Objective Formation(s)	Formation Code	Spacing Order Number	Unit Acreage Assigned to Well	Unit Configuration (N/2, SE/4, etc.)
J Sand	J SND	232	320	S/2 NE/4
Niobrara-Codell	NB-CD	407	80	S/2 NE/4

20. Mineral Ownership: ☒ Fee21. Surface Ownership: ☒ Fee

State

State

Federal

Federal

Indian

Indian

Lease #

22. Is the Surface Owner also the Mineral Owner?

☒ Yes☐ No

Surface Surety ID#

101144303

If No: ☐ Surface Owners Agreement Attached or☐ \$25,000 Blanket Bond☐ \$2,000 Surface Bond☐ \$5,000 Surface Bond

23. Describe lease area associated only with the proposed well by QtrQtr, Sec, Twp, Rng (attach separate sheet/map if required):

NE/4 Sec 27-T3N-R68W

24. Distance to Nearest Lease Line: 648'

25. Total Acres in Lease: 480

DRILLING PLANS AND PROCEDURES

26. Approx. Spud Date: 2/20/2001

* IF Air/Gas Drilling, Notify Local Fire Officials

27. Drilling Contractor Number:

Name:

Phone #

28. Is H₂S Anticipated: ☐ Yes ☒ No

If yes, attach contingency plan.

☐ Yes ☒ No

29. Will salt sections be encountered during drilling?

☐ Yes☒ No

30. Will salt (>15,000 ppm TDS Cl) or oil based muds be used during drilling?

☐ Yes☒ No

31. If questions 29 or 30 are yes, is this location in a sensitive area (Rule 903)?

32. Mud disposal:

☒ Offsite☐ Onsite

Method:

☐ Land Farming☒ Land Spreading☐ Disposal Facility☐ Other:

NOTE: The use of an earthen pit for recompletion fluids requires a pit permit (Rule 905b).

33. CASING AND CEMENTING PROGRAM

String	Size of Hole	Size of Casing	Weight per Foot	Setting Depth	Sks Cement	Cement Bottom	Cement Top
Surface	12-1/4"	8-5/8"	24#	550'	385	550'	surface
Production	7-7/8"	4-1/2"	11.6#	8400'	200	8400'	
Liner	N/A						

Stage Tool

34. BOP Equipment Type:

Annular Preventor

☒

Double Ram

Rotating Head

None

35. Comments, if any:

Interest is not common.

I hereby certify that the statements made in this form are, to the best of my knowledge, true, correct, and complete.

Print Name: Fred J. Clausen

Signed: Title: Drilling Manager Date: 1/12/2001

OGCC Approved:

Director of COGCC

Date: FEB 20 2001

Permit Number:

Permit Number:

010330

Expiration Date:

FEB 19 2002

API NUMBER

05-23-20301-00

CONDITIONS OF APPROVAL, IF ANY:

Provide 24 hour notice of MIRU to Dave Shelton at 303-894-2100 x 108. Comply with Rule 317.i and provide cement coverage from TD to a minimum of 200' above Niobrara. Verify coverage with cement bond log. Run and submit directional survey from TD to surface casing.

LOCATION: SW1/4 OF NE1/4 OF SEC. 27, T.3N., R.68W. (1454 NSL, 2241 ESL)

Ground Elevation: 4928

Number of Acres: 40

AQUIFER	ELEVATION		NET SAND	DEPTH TO		ANNUAL APPROP A-F	STATUS
	BOT.	TOP		BOT.	TOP		
UPPER DAWSON	----	----	----	----	----	----	---
LOWER DAWSON	----	----	----	----	----	----	---
DENVER	----	----	----	----	----	----	---
UPPER ARAPAHOE	----	----	----	----	----	----	---
LOWER ARAPAHOE	----	----	----	----	----	----	---
LARAMIE-FOX HILLS	----	----	----	----	----	----	---

note: E indicates location is at aquifer boundary and values
may be more approximate.
Data for the LARAMIE FOX-HILLS may be missing or approximate
and should be checked against DENVER BASIN ATLAS NO. 4
want to do another (Y/N) (press P to print)



	QTR	QTR	SEC	TWNS	RANGE	PM	NAME	DEPTH	TPERF	BPERF
A	NE	SW	19	030N	0680W	S	CASH ROBERT J.	100		
B	NW	NW	20	030N	0680W	S	ROY SCOTT B			
C	SW	SW	22	030N	0680W	S	WEINGARDT FRANK ED	98		
D	NW	NW	28	030N	0680W	S	SILENGO MYRA JANE	77	10	77
E	NE	NW	29	030N	0680W	S	DE BUSE F. MICHAEL			
F	NW	NW	29	030N	0680W	S	FOSTER JAMES	100		
G	NE	NE	30	030N	0680W	S	MILLER MELVIN M.			
H	NE	NE	30	030N	0680W	S	WEERS HAROLD C.			
I	NW	NW	30	030N	0680W	S	WALKER DONALD	60	30	60
J	NW	SE	30	030N	0680W	S	BISHOP J			
K	SW	SW	30	030N	0680W	S	ALLRED MILBERN L	50	30	50
L	SW	SW	30	030N	0680W	S	MCALLISTER RICHARD	50		
M	SW	SW	30	030N	0680W	S	LAPHAN DONALD R	53		
N	NE	NW	31	030N	0680W	S	SEEWALD JOE J	53		
O	NE	NW	31	030N	0680W	S	SCHNEIDER PATRICIA J	50		
P	NW	NW	31	030N	0680W	S	QUALLS D N	30		
Q	NW	NW	31	030N	0680W	S	SEEWALD JOE	50		
R	NW	NW	31	030N	0680W	S	STAMP JAMES E	35		
S	NW	NW	31	030N	0680W	S	WILLIS MARSHA	52		
T	NW	NW	31	030N	0680W	S	BOGOTT JUSTINE J			

Letter=Choice | F10=Mark 1 | PgUp/PgDn=±20 | UpAr/DnAr =±1 | Esc=Quit

Minimum Curvature Directional Program

HSR-FOSTER RIDGE 8-27A

SE/NE Sec 27, T3N, R68W

Surface Location: 1538' FNL & 2187' FEL

Bottomhole Location: 1992' FNL & 658' FEL

Target Azimuth 106.54

Measured Depth	Inclination Degrees	Azimuth Degrees	TVD Feet	North Feet	East Feet	DOGLEG Severity	Vertical Section
0	0.00	106.54					
500	0.00	106.54	500.00	0.00	0.00	0.00	0.00
1,000	0.00	106.54	1000.00	0.00	0.00	0.00	0.00
3,500	0.00	106.54	3500.00	0.00	0.01	0.00	0.01
3,516	0.00	106.54	3516.27	0.00	0.01	0.00	0.01
3,616	5.00	106.54	3616.08	-1.24	4.18	5.00	4.36
3,716	10.00	106.54	3715.13	-4.95	16.68	5.00	17.40
3,816	15.00	106.54	3812.67	-11.11	37.41	5.00	39.03
3,916	20.00	106.54	3907.95	-19.66	66.21	5.00	69.07
4,016	25.00	106.54	4000.25	-30.54	102.86	5.00	107.30
4,116	30.00	106.54	4088.87	-43.67	147.09	5.00	153.43
4,219	30.00	106.54	4178.18	-58.35	196.52	0.00	205.00
4,323	30.00	106.54	4267.49	-73.03	245.95	0.00	256.56
4,426	30.00	106.54	4356.80	-87.71	295.38	0.00	308.12
4,529	30.00	106.54	4446.11	-102.38	344.81	0.00	359.69
4,632	30.00	106.54	4535.43	-117.06	394.24	0.00	411.25
4,735	30.00	106.54	4624.74	-131.74	443.67	0.00	462.82
4,838	30.00	106.54	4714.05	-146.42	493.10	0.00	514.38
4,941	30.00	106.54	4803.36	-161.09	542.53	0.00	565.94
5,044	30.00	106.54	4892.67	-175.77	591.96	0.00	617.51
5,148	30.00	106.54	4981.98	-190.45	641.40	0.00	669.07
5,251	30.00	106.54	5071.29	-205.12	690.83	0.00	720.64
5,354	30.00	106.54	5160.61	-219.80	740.26	0.00	772.20
5,457	30.00	106.54	5249.92	-234.48	789.69	0.00	823.76
5,560	30.00	106.54	5339.23	-249.16	839.12	0.00	875.33
5,663	30.00	106.54	5428.54	-263.83	888.55	0.00	926.89
5,766	30.00	106.54	5517.85	-278.51	937.98	0.00	978.46
5,869	30.00	106.54	5607.16	-293.19	987.41	0.00	1030.02
5,973	30.00	106.54	5696.47	-307.87	1036.84	0.00	1081.58
6,076	30.00	106.54	5785.79	-322.54	1086.27	0.00	1133.15
6,179	30.00	106.54	5875.10	-337.22	1135.71	0.00	1184.71
6,282	30.00	106.54	5964.41	-351.90	1185.14	0.00	1236.28
6,385	30.00	106.54	6053.72	-366.58	1234.57	0.00	1287.84
6,485	27.50	106.54	6141.37	-380.26	1280.67	2.50	1335.93
6,585	25.00	106.54	6231.04	-392.85	1323.05	2.50	1380.15
6,685	22.50	106.54	6322.55	-404.31	1361.65	2.50	1420.41
6,785	20.00	106.54	6415.73	-414.62	1396.39	2.50	1466.65
6,885	17.50	106.54	6510.40	-423.77	1427.20	2.50	1488.78
6,985	15.00	106.54	6606.38	-431.74	1454.02	2.50	1516.76
7,085	12.50	106.54	6703.49	-438.50	1476.80	2.50	1540.52
7,185	10.00	106.54	6801.54	-444.05	1495.49	2.50	1560.03
7,285	7.50	106.54	6900.36	-448.38	1510.07	2.50	1575.24
7,385	5.00	106.54	6999.74	-451.48	1520.51	2.50	1586.12
7,485	2.50	106.54	7099.50	-453.34	1526.78	2.50	1592.66
7,585	0.00	106.54	7199.45	-453.96	1528.87	2.50	1594.84
7,685	0.00	106.54	7299.45	-453.96	1528.87	0.00	1594.84
7,785	0.00	106.54	7399.45	-453.96	1528.87	0.00	1594.84
7,885	0.00	106.54	7499.45	-453.96	1528.87	0.00	1594.84
7,985	0.00	106.54	7599.45	-453.96	1528.87	0.00	1594.84
8,085	0.00	106.54	7699.45	-453.96	1528.87	0.00	1594.84
8,185	0.00	106.54	7799.45	-453.96	1528.87	0.00	1594.84
8,285	0.00	106.54	7899.45	-453.96	1528.87	0.00	1594.84
8,385	0.00	106.54	7999.45	-453.96	1528.87	0.00	1594.84



RECEIVED
JAN 15 0
COGCC

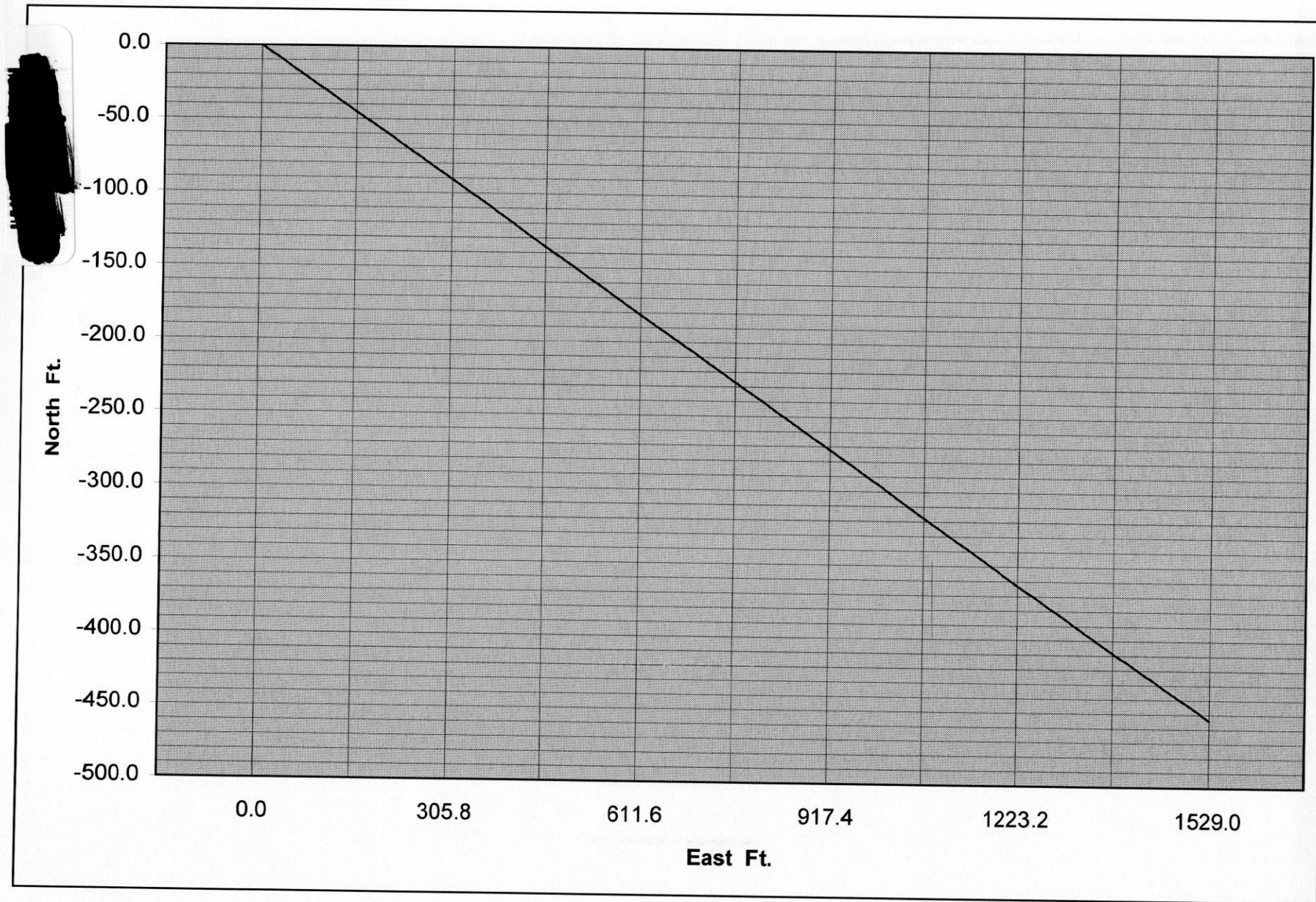



RECEIVED
JAN 15 01
COGCC

HSR-Foster Ridge 8-27A

