

UNGRADED ELEVATION: 7266.6'

FINAL ELEVATION: 7256.2'

PROPOSED AREA OF DISTURBANCE: 6.4± ACRES

DRAINS TO BUZZARD CREEK

STORMWATER BMP's

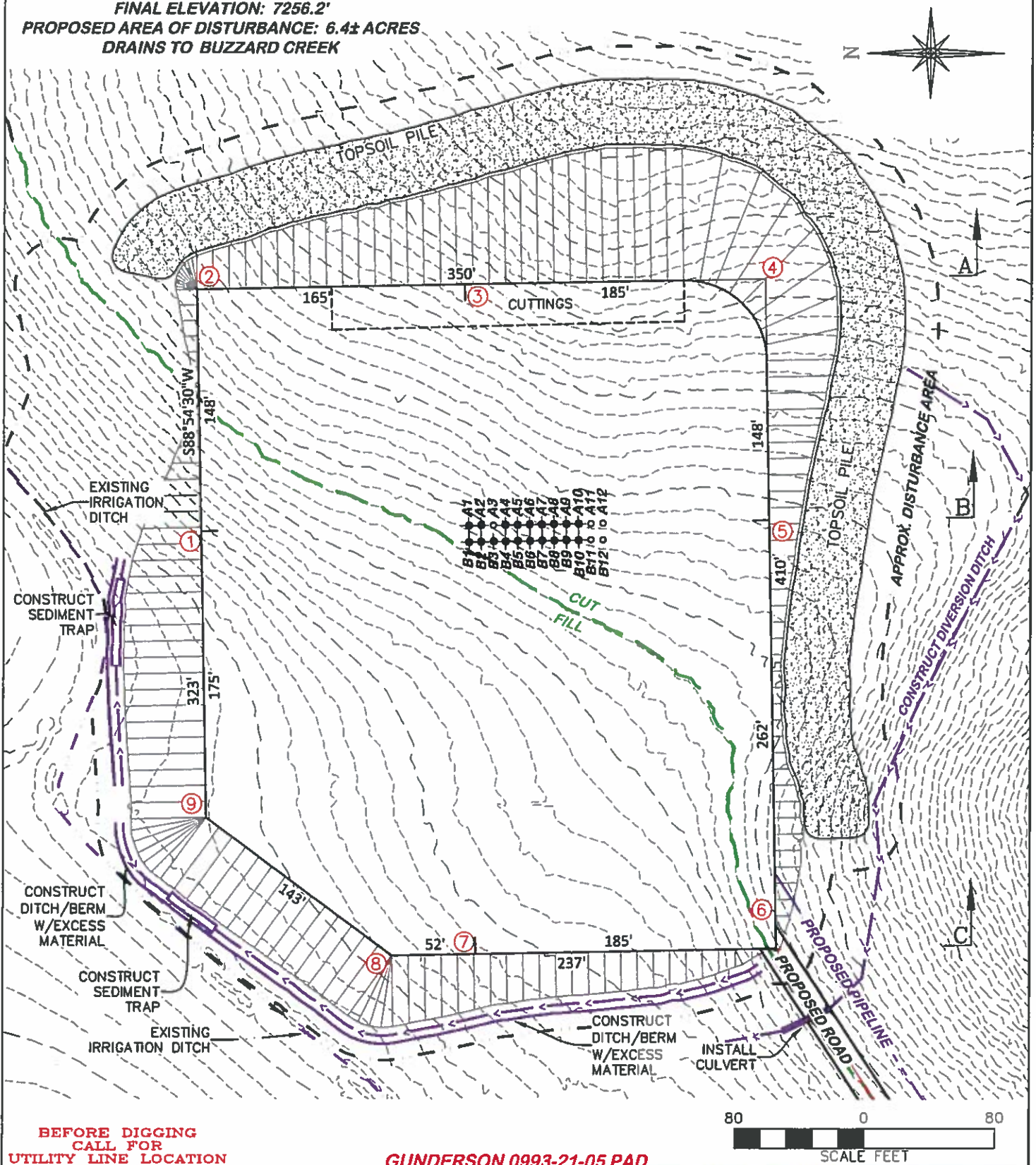

BEFORE DIGGING
CALL FOR
UTILITY LINE LOCATION

GUNDERSON 0993-21-05 PAD

80 0 80
SCALE FEET



RIFFIN & ASSOCIATES, INC.

(307) 362-5028

1414 ELK ST., ROCK SPRINGS, WY 82901

DRAWN: 8/8/2017 - DEH

SCALE: 1" = 80'

REVISED: N/A -

DRG JOB No. 21281

06 STM WTR

STORMWATER BMP's

LARAMIE ENERGY LLC

GUNDERSON 0993-21-05

SWNW, SECTION 21, T.9 S., R.93 W., 6th P.M.,
MESA COUNTY, COLORADO