

T5S, R96W, 6th P.M.

Caerus Oil & Gas LLC

NPR 24A-10 596
NE 1/4 SW 1/4, SECTION 10, T5S, R96W, 6th P.M.
GARFIELD COUNTY, COLORADO

BASIS OF BEARINGS
 BASIS OF BEARINGS IS A G.P.S. OBSERVATION
BASIS OF ELEVATION

SPOT ELEVATION AT THE NORTHWEST CORNER OF SECTION 30, T5S, R95W, 6th P.M., TAKEN FROM THE FORKED GULCH QUADRANGLE, GARFIELD COUNTY, COLORADO, 7.5 MINUTE QUAD. (TOPOGRAPHIC MAP) PUBLISHED BY THE UNITED STATES DEPARTMENT OF THE INTERIOR, GEOLOGICAL SURVEY. SAID ELEVATION IS MARKED AS BEING 5966 FEET.

LINE TABLE		
LINE	DIRECTION	LENGTH
L1	S89°57'05"E	623.70'
L2	S89°54'44"E	1114.74'



1917 Brass Cap
 2.3' High
 Lat: 39.636808°
 Long: 108.164797°

1917 Brass Cap
 1.3' High
 Lat: 39.636814°
 Long: 108.155431°

1917 Brass Cap
 1.3' High
 Lat: 39.636825°
 Long: 108.146133°

S89°59'42"W - 2638.90' (Meas.) S89°55'33"W - 2619.23' (Meas.)

S00°02'33"E - 2632.90' (Meas.)

N00°09'45"W - 2633.18' (Meas.)

1917 Brass Cap
 2.5' High, Mound
 of Stones
 Lat: 39.629583°
 Long: 108.164786°

1917 Brass Cap
 2.0' High
 Lat: 39.629600°
 Long: 108.146103°

NPR 24A-10 596
 Elev. Graded Ground = 6708.7'

Target
 Bottom Hole

N00°03'53"W - 2642.02' (Meas.)

N00°08'22"E - 2647.60' (Meas. to True)

2516'

N86°58'58"E
 1438.15'

1309'

1881'

1957'

1917 Brass Cap
 2.0' High, Pine Post
 Lat: 39.622331°
 Long: 108.164769°

W.C. 1917 Brass Cap
 Lat: 39.622331°
 Long: 108.157622°

True Position
 Lat: 39.622328°
 Long: 108.155408°

True Position
 Lat: 39.622333°
 Long: 108.146122°

N89°54'44"W
 -2630.73' (Meas. to True)

W.C. SE Cor. Sec. 10
 1917 Brass Cap, 2.0' High
 Lat: 39.622328°
 Long: 108.142167°

S 1/4 Cor. Sec. 11
 1917 Brass Cap,
 2.3' High
 Lat: 39.622325°
 Long: 108.136786°

PDOP = 3.8

LEGEND:

- └─┘ = 90° SYMBOL
- = PROPOSED WELLHEAD.
- = TARGET BOTTOM HOLE.
- ▲ = SECTION CORNERS LOCATED. (NAD 83)
- △ = SECTION CORNERS RE-ESTABLISHED. (Not Set on Ground.) (NAD 83)

NAD 83 (SURFACE LOCATION)	NAD 83 (TARGET BOTTOM HOLE)
LATITUDE = 39°37'38.97" (39.627492)	LATITUDE = 39°37'39.73" (39.627703)
LONGITUDE = 108°09'21.06" (108.155850)	LONGITUDE = 108°09'02.71" (108.150753)
NAD 27 (SURFACE LOCATION)	NAD 27 (TARGET BOTTOM HOLE)
LATITUDE = 39°37'39.06" (39.627517)	LATITUDE = 39°37'39.82" (39.627728)
LONGITUDE = 108°09'18.77" (108.155214)	LONGITUDE = 108°09'00.42" (108.150117)
UTM NAD 27 (ZONE 12)	UTM NAD 27 (ZONE 12)
N: 14403104.70 E: 2441496.56	N: 14403226.60 E: 2442929.59



UELS, LLC
 Corporate Office * 85 South 200 East
 Vernal, UT 84078 * (435) 789-1017

SURVEYED BY	BART HUNTING, J.F.	08-28-17	SCALE
DRAWN BY	M.D.	09-06-17	1" = 1000'

WELL LOCATION PLAT

CERTIFICATE
 THIS IS TO CERTIFY THAT THE ABOVE PLAT WAS PREPARED AND LOCATION AS SHOWN WAS STAKED ON THE GROUND FROM FIELD SCOPES OF ACTUAL SURVEYS MADE BY ME OR UNDER MY SUPERVISION AND THAT THE SAME ARE TRUE AND CORRECT TO THE BEST OF MY KNOWLEDGE AND BELIEF.

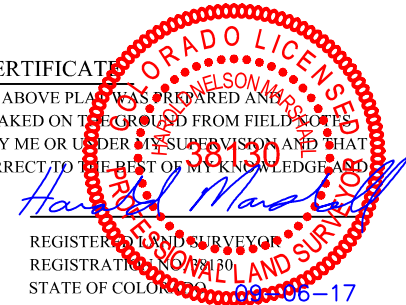

REGISTERED LAND SURVEYOR
 REGISTRATION NO. 38130
 STATE OF COLORADO