

FRANE SURVEYING INC.

Physical Address: 34834 Annie Cir.
Mail to: Box 2372, Elizabeth, CO 80107
Ph. 303-243-0037
www.franesurveying.com
Job # 17-115-YOSEMITE 1-3

Frane Surveying, in accordance with a request from **Grand Mesa Operating** has determined the location of **YOSEMITE 1-3** to be **1007 Feet FSL**, and **891 Feet FEL**, (90° off Section lines) of Section **3**, Township **8s**, Range **55w** of the 6th Principal Meridian, **Lincoln County, Colorado**.

Date: Staked on 09/08/17 drawn on 09/14/17.
Rev: 09/14/17

Re: Staked by Elijah Frane
Drawn: Drawn by Elijah Frane

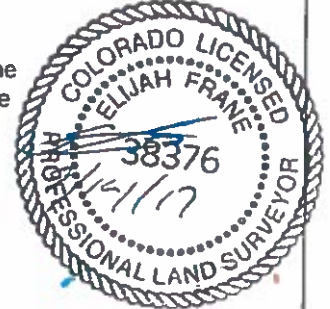

Reference Area Map

GRAND MESA OPERATING
SE 1/4 SEC. 3-8s-55w
YOSEMITE 1-3
LINCOLN, Co. COLORADO



REFERENCE AREA
LAT=39.37497 (DEC. DEGREE)
LONG=103.53563 (DEC. DEGREE)

