

# GADWALL PAD REFERENCE AREA MAP

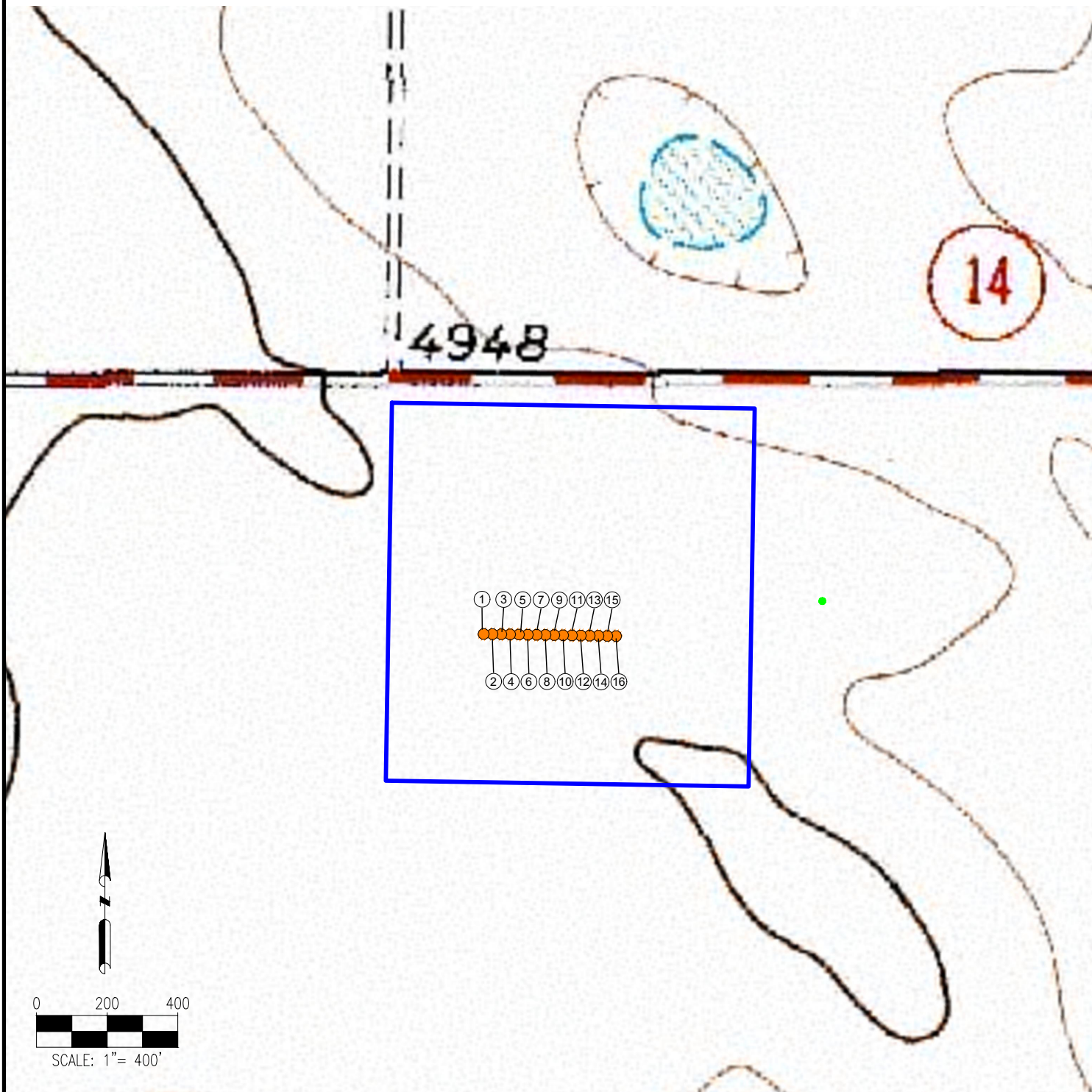

1. GADWALL 30-31-1HN
2. GADWALL 30-31-2HC
3. GADWALL 30-31-3HN
4. GADWALL 30-31-4HN
5. GADWALL 30-31-5HN
6. GADWALL 30-31-6HC
7. GADWALL 30-31-7HN
8. GADWALL 30-31-8HN

9. GADWALL FED 30-31-9HN
10. GADWALL FED 30-31-10HN
11. GADWALL FED 30-31-11HC
12. GADWALL FED 30-31-12HN
13. GADWALL FED 30-31-13HN
14. GADWALL FED 30-31-14HN
15. GADWALL FED 30-31-15HC
16. GADWALL FED 30-31-16HN

## REFERENCE LOCATION

\*\*REFERENCE PHOTO POINT\*\*

LAT: 40.638697° N  
LONG: 104.130363° W  
ELEVATION: 4942'

DISCLAIMER:  
THIS PLOT DOES NOT REPRESENT A MONUMENTED LAND SURVEY AND SHOULD NOT BE RELIED UPON TO DETERMINE BOUNDARY LINES, PROPERTY OWNERSHIP OR OTHER PROPERTY INTERESTS. PARCEL LINES, IF DEPICTED HAVE NOT BEEN FIELD VERIFIED AND MAY BE BASED UPON PUBLICLY AVAILABLE DATA THAT ALSO HAS NOT BEEN INDEPENDENTLY VERIFIED.

DATA SOURCE:  
TOPO MAP: USGS

PUBLICLY AVAILABLE DATA SOURCES HAVE NOT BEEN INDEPENDENTLY VERIFIED BY ASCENT.

## LEGEND:

● = PROPOSED WELL

● = REFERENCE PHOTO POINT

▭ = DISTURBANCE AREA



7535 Hilltop Circle  
Denver, CO 80221  
(303) 928-7128  
www.ascentgeomatics.com

FIELD DATE:  
08-10-17

DRAWING DATE:  
08-24-17

BY:  
RMC

CHECKED:  
DJP

SITE NAME:  
GADWALL PAD

SURFACE LOCATION:

NW 1/4 NE 1/4 SEC. 30, T8N, R60W, 6TH P.M.  
WELD COUNTY, COLORADO

PREPARED FOR:

