



Battery Southeast Corner



### Flood Anchoring on Crude Oil Tanks

Location Number: 330209



**BRG: 250.8° LAT: 40.224443 LON: -104.852586**

### Produced Water Flood Anchoring

Location Number: 330209



Separators  
Location Number: 330209



Separator Flood Anchoring  
Location Number: 330209

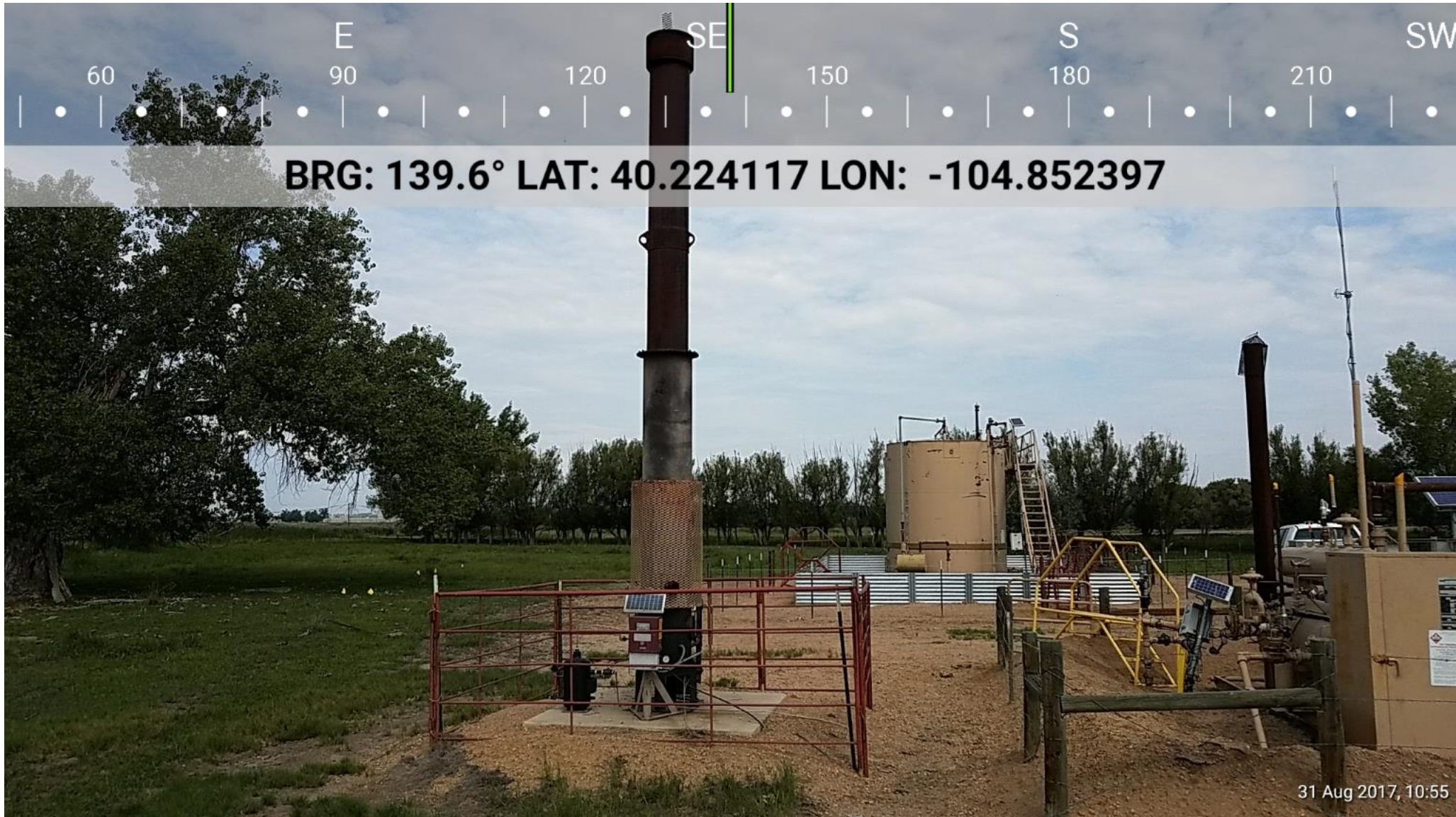

## Emission Control Burner

Location Number: 330209



**BRG: 151.1° LAT: 40.223122 LON: -104.851681**



**Wellhead**  
Location Number: 330209