

# HYDROLOGY MAP

## WAYNE 5N64W22X PAD

SECTION: 22  
TOWNSHIP: 5N  
RANGE: 64W  
6TH P.M.  
WELD COUNTY, CO

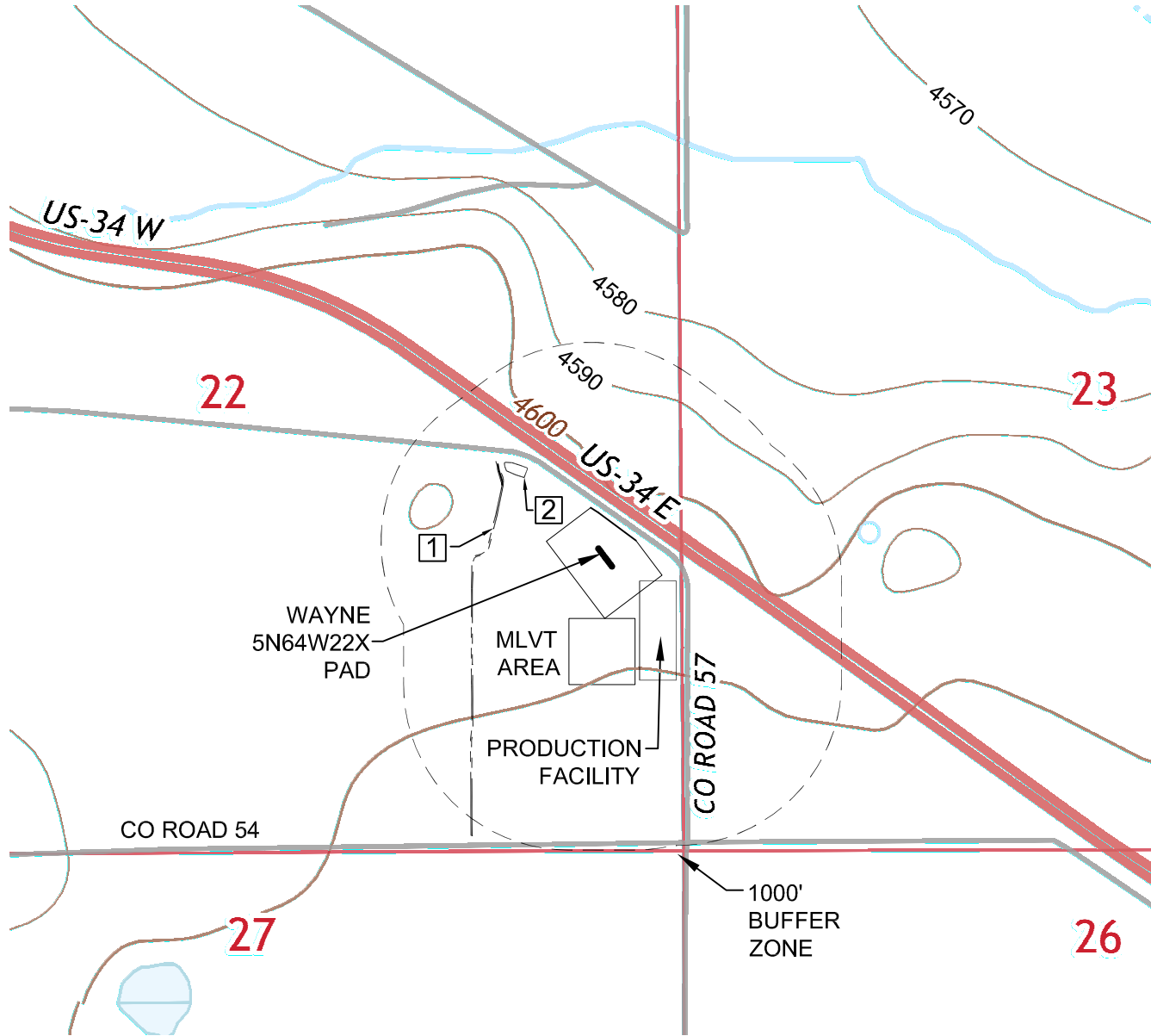

DISTANCES BELOW MEASURED FROM THE PROPOSED  
EDGE OF DISTURBANCE OF THE OIL AND GAS LOCATION

- 1 IRRIGATION DITCH: 644' NW (NEAREST DOWN GRADIENT WATER FEATURE)
- 2 HOLDING POND: 621' NW

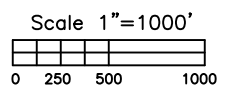

DATE: 6/22/2017