

PROPOSED PAD CONTOURS MISSOURI WELL PAD

SECTION: 31
TOWNSHIP: 1N
RANGE: 65W

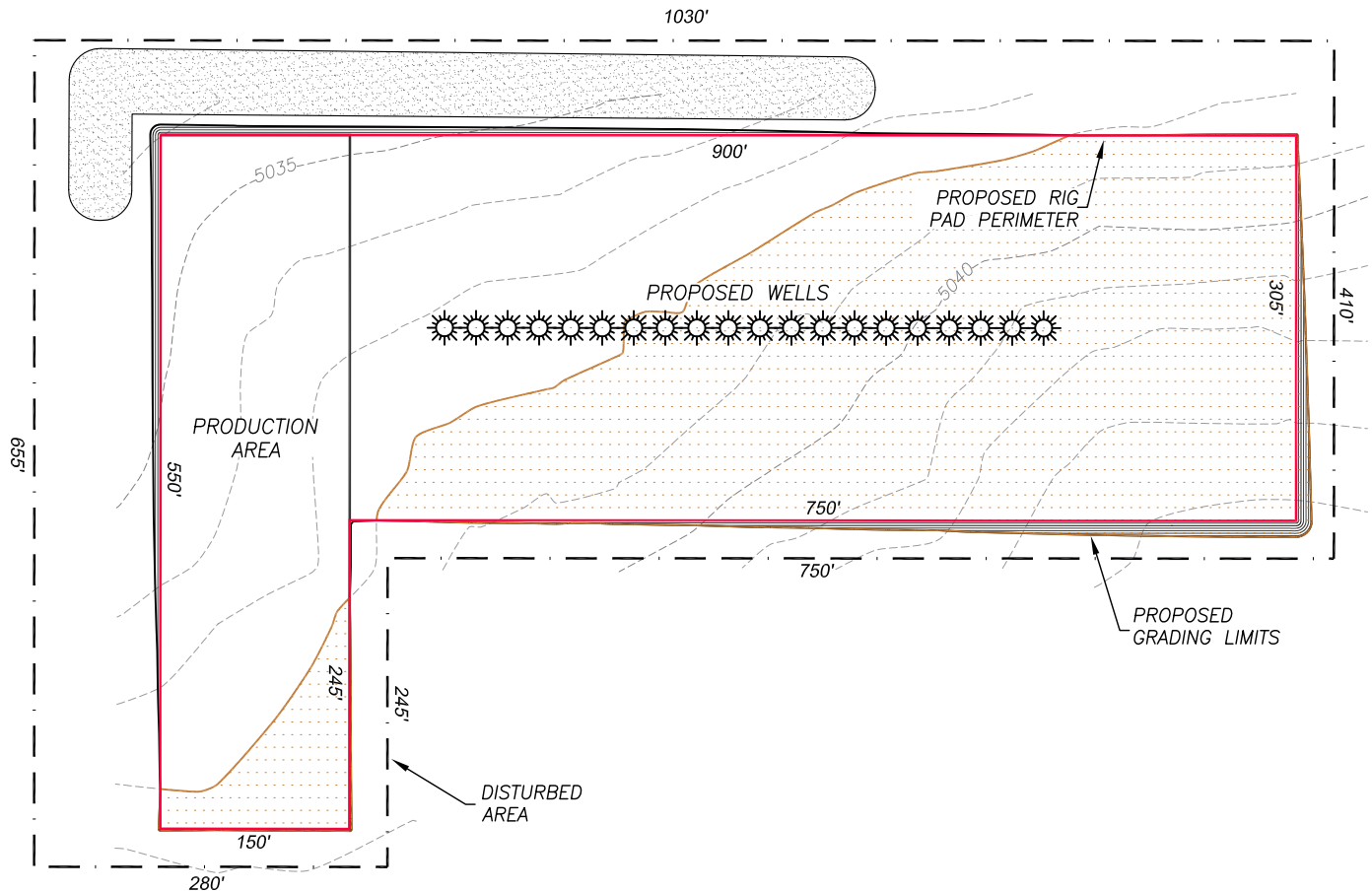

PROPOSED PAD DETAILS

Disturbed Area: 11.3 Ac.
Grading Limits: 7.5 Ac.
Drill Pad: 7.2 Ac.

Existing Elev. @ Well: 5037.2'
Proposed Pad Elev.: 5038.0'

Cut slope ratio: 2.0
Fill slope ratio: 2.0
Cut Swell Factor: 1.00
Fill Shrink Factor: 1.00

PAD EARTHWORK VOLUMES

Total cut: 13916± C.Y.
Total fill: 8116± C.Y.
Balance Export: 5800± C.Y.



NOTES

1. Contour interval = 1'
2. No allowance has been made for soil expansion or compaction.
3. Proposed pad elevation is finish grade, no allowance has been made for gravel being placed on pad.
4. Balance Export Volume is based on removal of 6" of topsoil over entire pad.

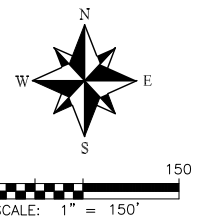

PROPOSED PAD CROSS SECTIONS MISSOURI WELL PAD

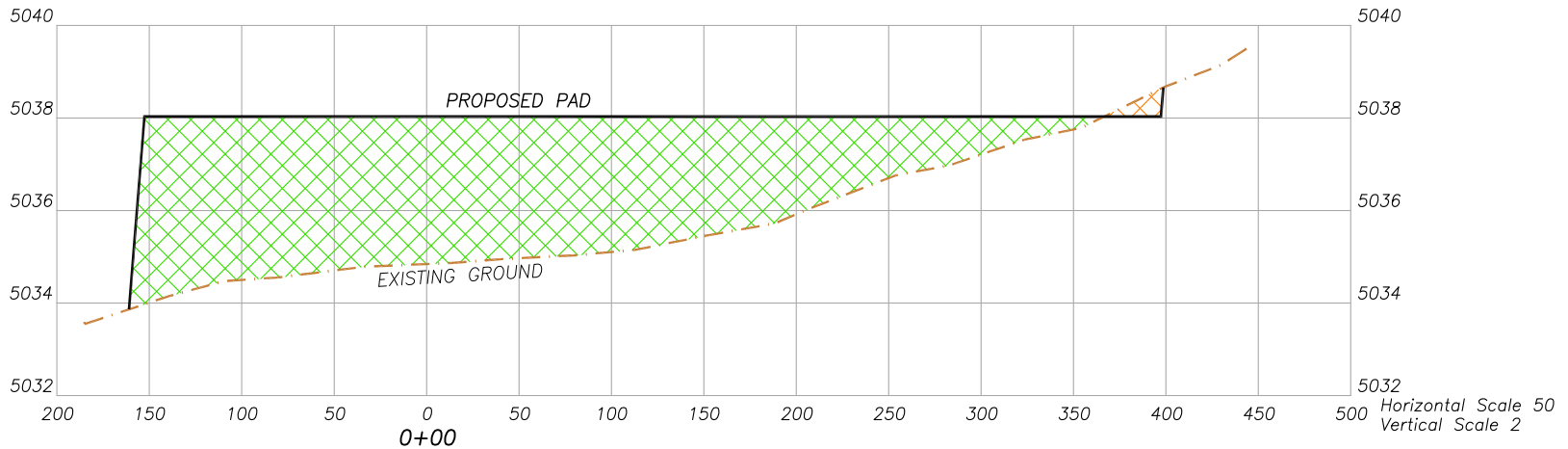
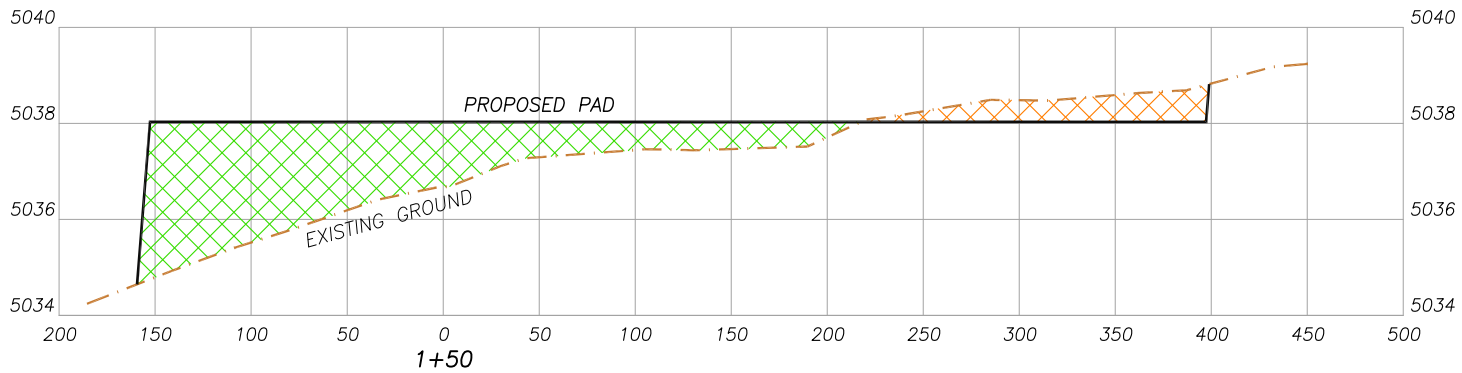
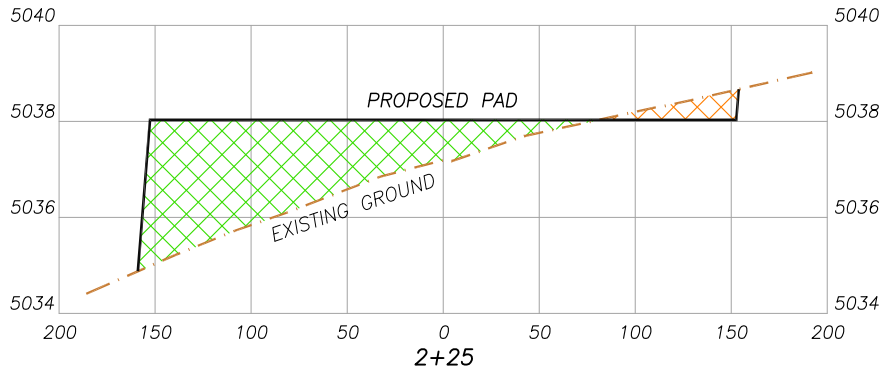

PROPOSED PAD CROSS SECTIONS MISSOURI WELL PAD

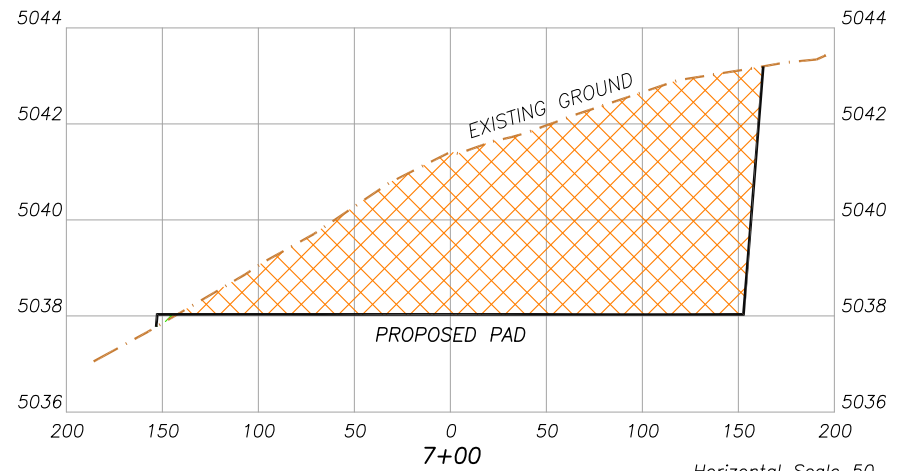
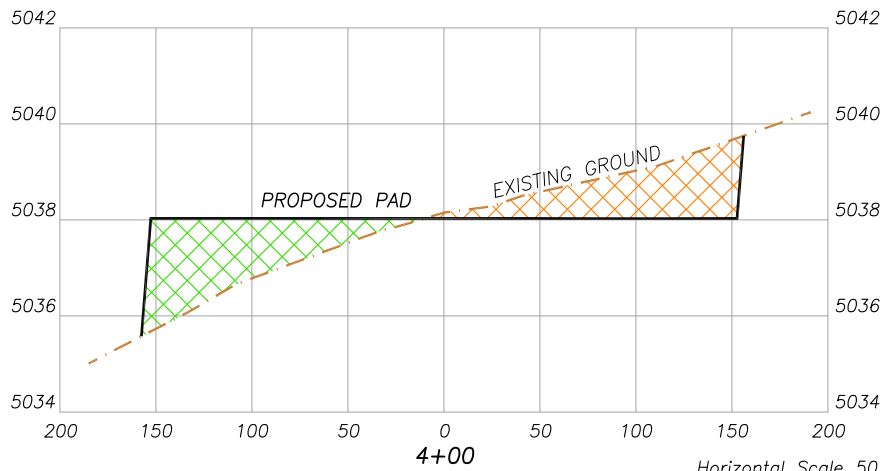
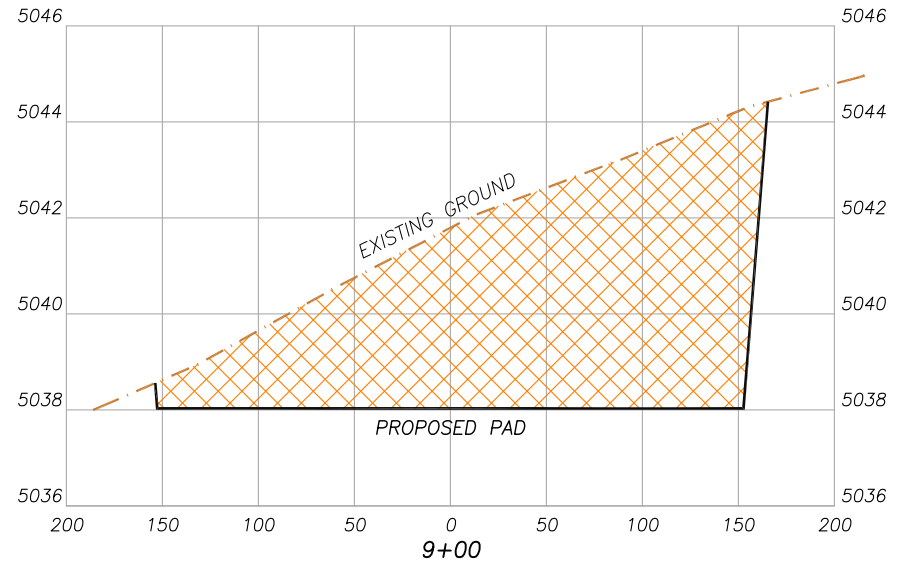
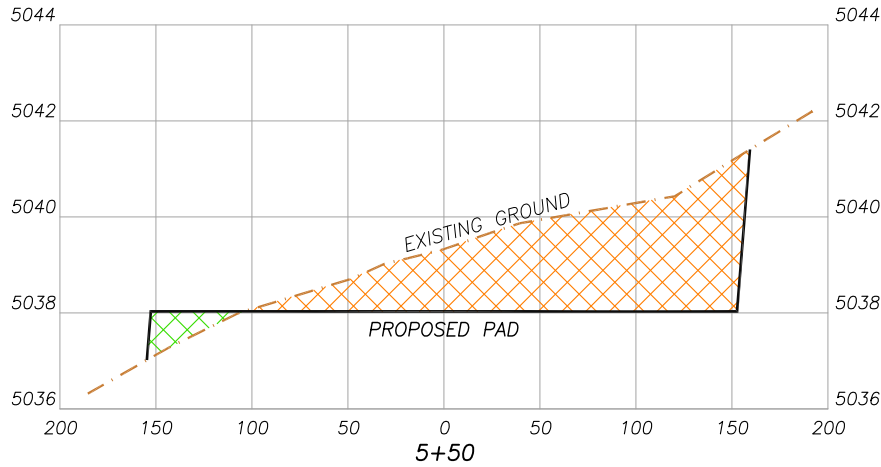

Horizontal Scale 50
Vertical Scale 2

Horizontal Scale 50
Vertical Scale 2