

Bayswater Exploration & Production, LLC

Well Name: **Booth U-8-7HN**

Surface Location: Booth 8-L Pad Sec.8-T6N-R66W

North American Datum 1983 , US State Plane 1983, Colorado Northern Zone

Ground Elevation: 4808.0

+N/-S	+E/-W	Northing	Easting	Latitude	Longitude	Slot
0.0	0.0	1425353.14	3196523.36	40.498846	-104.793339	
RKB - 23' WELL @ 4831.0ft (RKB - 23')						

WELLBORE TARGET DETAILS

Name	TVD	+N/-S	+E/-W	Shape
SHL 1261'FSL, 248'FEL, SEC.8	1.0	0.0	0.0	Point
BHL 824'FSL, 2170'FEL, SEC.7	7037.0	-681.3	-7234.8	Point
LPL 830'FSL, 601'FEL, SEC.8	7080.0	-438.6	-349.1	Point

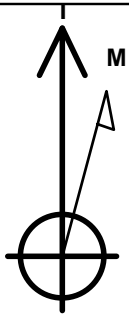

Azimuths to True North
Magnetic North: 8.09°

Magnetic Field
Strength: 52556.9nT
Dip Angle: 66.92°
Date: 5/16/2017
Model: IGRF2010

Booth 8-L Pad Sec.8-T6N-R66W
Booth U-8-7HN
Plan #1 (5-03-17)
9:02, May 16 2017

ANNOTATIONS

TVD	MD	Annotation
800.0	800.0	KOP - Start Build 1.50
4419.8	4449.1	Start Drop -2.00
6507.2	6537.6	Start Build 10.00
7080.0	7441.0	Start DLS 0.50 TFO 132.14
7080.0	7441.7	Start 6889.4 hold at 7441.7 MD
7037.0	14331.1	TD at 14331.1

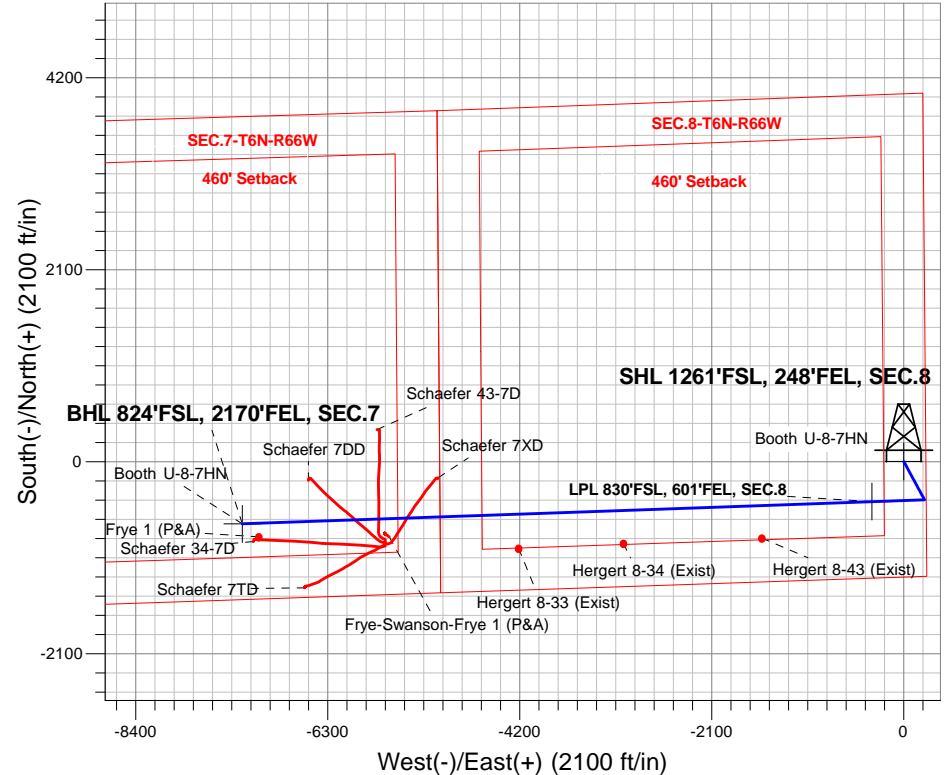

ENSIGN
Directional

SECTION DETAILS

Sec	MD	Inc	Azi	TVD	+N/-S	+E/-W	Dleg	TFace	VSec	Target
1	0.0	0.00	0.00	0.0	0.0	0.0	0.00	0.00	0.0	
2	800.0	0.00	0.00	800.0	0.0	0.0	0.00	0.00	0.0	
3	1308.4	7.63	151.51	1306.9	-29.7	16.1	1.50	151.51	-13.3	
4	4449.1	7.63	151.51	4419.8	-396.0	214.9	0.00	0.00	-176.8	
5	4830.4	0.00	0.00	4800.0	-418.3	227.0	2.00	180.00	-186.8	
6	6537.6	0.00	0.00	6507.2	-418.3	227.0	0.00	0.00	-186.8	
7	7441.0	90.36	267.98	7080.0	-438.6	-349.1	10.00	267.98	388.6	
8	7441.0	90.36	267.98	7080.0	-438.6	-349.1	0.00	0.00	388.7	LPL 830'FSL, 601'FEL, SEC.8
9	7441.7	90.36	267.98	7080.0	-438.7	-349.8	0.50	132.14	389.4	
10	14331.1	90.36	267.98	7037.0	-681.3	-7234.8	0.00	0.00	7266.8	BHL 824'FSL, 2170'FEL, SEC.7

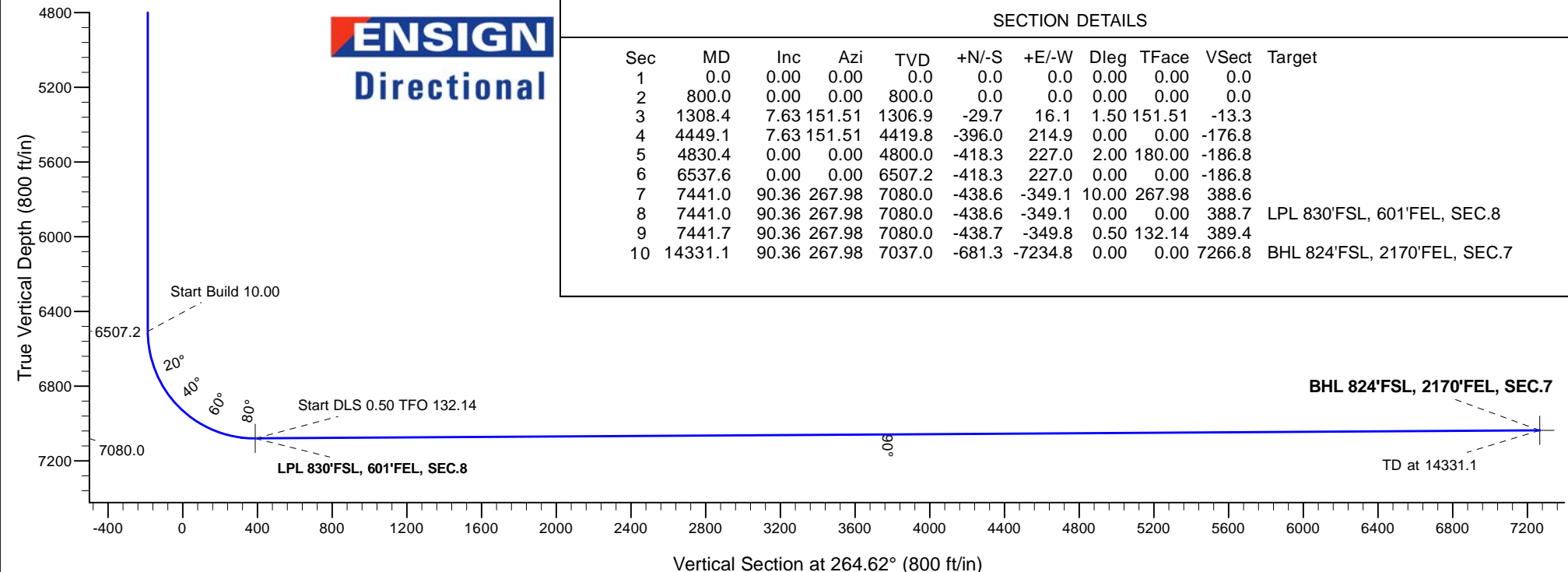



Bayswater Exploration & Production, LLC

SEC.8-T6N-R66W

Booth 8-L Pad Sec.8-T6N-R66W

Booth U-8-7HN

Wellbore #1

Plan: Plan #1 (5-03-17)

Standard Planning Report

16 May, 2017



BAYSWATER
EXPLORATION & PRODUCTION, LLC

Database:	US_EDM	Local Co-ordinate Reference:	Well Booth U-8-7HN
Company:	Bayswater Exploration & Production, LLC	TVD Reference:	WELL @ 4831.0ft (RKB - 23')
Project:	SEC.8-T6N-R66W	MD Reference:	WELL @ 4831.0ft (RKB - 23')
Site:	Booth 8-L Pad Sec.8-T6N-R66W	North Reference:	True
Well:	Booth U-8-7HN	Survey Calculation Method:	Minimum Curvature
Wellbore:	Wellbore #1		
Design:	Plan #1 (5-03-17)		

Project	SEC.8-T6N-R66W, Weld County, Colorado		
Map System:	US State Plane 1983	System Datum:	Mean Sea Level
Geo Datum:	North American Datum 1983		Using Well Reference Point
Map Zone:	Colorado Northern Zone		Using geodetic scale factor

Site	Booth 8-L Pad Sec.8-T6N-R66W		
Site Position:		Northing:	1,425,653.29 usft
From:	Lat/Long	Easting:	3,196,515.96 usft
Position Uncertainty:	0.0 ft	Slot Radius:	13-3/16 "
		Latitude:	40.499670
		Longitude:	-104.793357
		Grid Convergence:	0.46 °

Well	Booth U-8-7HN		
Well Position	+N/-S	-300.2 ft	Northing: 1,425,353.15 usft
	+E/-W	5.0 ft	Easting: 3,196,523.36 usft
Position Uncertainty	0.0 ft	Wellhead Elevation:	0.0 ft
		Latitude:	40.498846
		Longitude:	-104.793339
		Ground Level:	4,808.0 ft

Wellbore	Wellbore #1				
Magnetics	Model Name	Sample Date	Declination (°)	Dip Angle (°)	Field Strength (nT)
	IGRF2010	5/16/2017	8.09	66.92	52,557

Design	Plan #1 (5-03-17)			
Audit Notes:				
Version:	Phase:	PROTOTYPE	Tie On Depth:	0.0
Vertical Section:	Depth From (TVD)	+N/-S (ft)	+E/-W (ft)	Direction (°)
	0.0	0.0	0.0	264.62

Plan Sections										
Measured Depth (ft)	Inclination (°)	Azimuth (°)	Vertical Depth (ft)	+N/-S (ft)	+E/-W (ft)	Dogleg Rate (°/100usft)	Build Rate (°/100usft)	Turn Rate (°/100usft)	TFO (°)	Target
0.0	0.00	0.00	0.0	0.0	0.0	0.00	0.00	0.00	0.00	
800.0	0.00	0.00	800.0	0.0	0.0	0.00	0.00	0.00	0.00	
1,308.4	7.63	151.51	1,306.9	-29.7	16.1	1.50	1.50	0.00	151.51	
4,449.1	7.63	151.51	4,419.8	-396.0	214.9	0.00	0.00	0.00	0.00	
4,830.4	0.00	0.00	4,800.0	-418.3	227.0	2.00	-2.00	0.00	180.00	
6,537.6	0.00	0.00	6,507.2	-418.3	227.0	0.00	0.00	0.00	0.00	
7,441.0	90.36	267.98	7,080.0	-438.6	-349.1	10.00	10.00	0.00	267.98	
7,441.0	90.36	267.98	7,080.0	-438.6	-349.1	0.00	0.00	0.00	0.00	LPL 830'FSL, 601'FEI
7,441.7	90.36	267.98	7,080.0	-438.7	-349.8	0.50	-0.34	0.37	132.14	
14,331.1	90.36	267.98	7,037.0	-681.3	-7,234.8	0.00	0.00	0.00	0.00	BHL 824'FSL, 2170'FI

Database:	US_EDM	Local Co-ordinate Reference:	Well Booth U-8-7HN
Company:	Bayswater Exploration & Production, LLC	TVD Reference:	WELL @ 4831.0ft (RKB - 23')
Project:	SEC.8-T6N-R66W	MD Reference:	WELL @ 4831.0ft (RKB - 23')
Site:	Booth 8-L Pad Sec.8-T6N-R66W	North Reference:	True
Well:	Booth U-8-7HN	Survey Calculation Method:	Minimum Curvature
Wellbore:	Wellbore #1		
Design:	Plan #1 (5-03-17)		

Planned Survey									
Measured Depth (ft)	Inclination (°)	Azimuth (°)	Vertical Depth (ft)	+N/-S (ft)	+E/-W (ft)	Vertical Section (ft)	Dogleg Rate (°/100usft)	Build Rate (°/100usft)	Turn Rate (°/100usft)
0.0	0.00	0.00	0.0	0.0	0.0	0.0	0.00	0.00	0.00
100.0	0.00	0.00	100.0	0.0	0.0	0.0	0.00	0.00	0.00
200.0	0.00	0.00	200.0	0.0	0.0	0.0	0.00	0.00	0.00
300.0	0.00	0.00	300.0	0.0	0.0	0.0	0.00	0.00	0.00
400.0	0.00	0.00	400.0	0.0	0.0	0.0	0.00	0.00	0.00
500.0	0.00	0.00	500.0	0.0	0.0	0.0	0.00	0.00	0.00
600.0	0.00	0.00	600.0	0.0	0.0	0.0	0.00	0.00	0.00
700.0	0.00	0.00	700.0	0.0	0.0	0.0	0.00	0.00	0.00
800.0	0.00	0.00	800.0	0.0	0.0	0.0	0.00	0.00	0.00
KOP - Start Build 1.50									
900.0	1.50	151.51	900.0	-1.2	0.6	-0.5	1.50	1.50	0.00
1,000.0	3.00	151.51	999.9	-4.6	2.5	-2.1	1.50	1.50	0.00
1,100.0	4.50	151.51	1,099.7	-10.3	5.6	-4.6	1.50	1.50	0.00
1,200.0	6.00	151.51	1,199.3	-18.4	10.0	-8.2	1.50	1.50	0.00
1,300.0	7.50	151.51	1,298.6	-28.7	15.6	-12.8	1.50	1.50	0.00
1,308.4	7.63	151.51	1,306.9	-29.7	16.1	-13.3	1.50	1.50	0.00
1,400.0	7.63	151.51	1,397.7	-40.4	21.9	-18.0	0.00	0.00	0.00
1,500.0	7.63	151.51	1,496.8	-52.0	28.2	-23.2	0.00	0.00	0.00
1,600.0	7.63	151.51	1,595.9	-63.7	34.6	-28.4	0.00	0.00	0.00
1,700.0	7.63	151.51	1,695.0	-75.4	40.9	-33.7	0.00	0.00	0.00
1,800.0	7.63	151.51	1,794.2	-87.0	47.2	-38.9	0.00	0.00	0.00
1,900.0	7.63	151.51	1,893.3	-98.7	53.6	-44.1	0.00	0.00	0.00
2,000.0	7.63	151.51	1,992.4	-110.4	59.9	-49.3	0.00	0.00	0.00
2,100.0	7.63	151.51	2,091.5	-122.0	66.2	-54.5	0.00	0.00	0.00
2,200.0	7.63	151.51	2,190.6	-133.7	72.6	-59.7	0.00	0.00	0.00
2,300.0	7.63	151.51	2,289.7	-145.4	78.9	-64.9	0.00	0.00	0.00
2,400.0	7.63	151.51	2,388.8	-157.0	85.2	-70.1	0.00	0.00	0.00
2,500.0	7.63	151.51	2,488.0	-168.7	91.5	-75.3	0.00	0.00	0.00
2,600.0	7.63	151.51	2,587.1	-180.3	97.9	-80.5	0.00	0.00	0.00
2,700.0	7.63	151.51	2,686.2	-192.0	104.2	-85.7	0.00	0.00	0.00
2,800.0	7.63	151.51	2,785.3	-203.7	110.5	-90.9	0.00	0.00	0.00
2,900.0	7.63	151.51	2,884.4	-215.3	116.9	-96.2	0.00	0.00	0.00
3,000.0	7.63	151.51	2,983.5	-227.0	123.2	-101.4	0.00	0.00	0.00
3,100.0	7.63	151.51	3,082.7	-238.7	129.5	-106.6	0.00	0.00	0.00
3,200.0	7.63	151.51	3,181.8	-250.3	135.8	-111.8	0.00	0.00	0.00
3,300.0	7.63	151.51	3,280.9	-262.0	142.2	-117.0	0.00	0.00	0.00
3,400.0	7.63	151.51	3,380.0	-273.7	148.5	-122.2	0.00	0.00	0.00
3,500.0	7.63	151.51	3,479.1	-285.3	154.8	-127.4	0.00	0.00	0.00
3,600.0	7.63	151.51	3,578.2	-297.0	161.2	-132.6	0.00	0.00	0.00
3,700.0	7.63	151.51	3,677.3	-308.7	167.5	-137.8	0.00	0.00	0.00
3,800.0	7.63	151.51	3,776.5	-320.3	173.8	-143.0	0.00	0.00	0.00
3,900.0	7.63	151.51	3,875.6	-332.0	180.2	-148.2	0.00	0.00	0.00
4,000.0	7.63	151.51	3,974.7	-343.6	186.5	-153.4	0.00	0.00	0.00
4,100.0	7.63	151.51	4,073.8	-355.3	192.8	-158.7	0.00	0.00	0.00
4,200.0	7.63	151.51	4,172.9	-367.0	199.1	-163.9	0.00	0.00	0.00
4,300.0	7.63	151.51	4,272.0	-378.6	205.5	-169.1	0.00	0.00	0.00
4,400.0	7.63	151.51	4,371.2	-390.3	211.8	-174.3	0.00	0.00	0.00
4,449.1	7.63	151.51	4,419.8	-396.0	214.9	-176.8	0.00	0.00	0.00
Start Drop -2.00									
4,500.0	6.61	151.51	4,470.3	-401.6	217.9	-179.3	2.00	-2.00	0.00
4,600.0	4.61	151.51	4,569.8	-410.2	222.6	-183.1	2.00	-2.00	0.00
4,700.0	2.61	151.51	4,669.6	-415.7	225.6	-185.6	2.00	-2.00	0.00
4,800.0	0.61	151.51	4,769.6	-418.2	226.9	-186.7	2.00	-2.00	0.00
4,830.4	0.00	0.00	4,800.0	-418.3	227.0	-186.8	2.00	-2.00	0.00

Database:	US_EDM	Local Co-ordinate Reference:	Well Booth U-8-7HN
Company:	Bayswater Exploration & Production, LLC	TVD Reference:	WELL @ 4831.0ft (RKB - 23')
Project:	SEC.8-T6N-R66W	MD Reference:	WELL @ 4831.0ft (RKB - 23')
Site:	Booth 8-L Pad Sec.8-T6N-R66W	North Reference:	True
Well:	Booth U-8-7HN	Survey Calculation Method:	Minimum Curvature
Wellbore:	Wellbore #1		
Design:	Plan #1 (5-03-17)		

Planned Survey									
Measured Depth (ft)	Inclination (°)	Azimuth (°)	Vertical Depth (ft)	+N/-S (ft)	+E/-W (ft)	Vertical Section (ft)	Dogleg Rate (°/100usft)	Build Rate (°/100usft)	Turn Rate (°/100usft)
4,900.0	0.00	0.00	4,869.6	-418.3	227.0	-186.8	0.00	0.00	0.00
5,000.0	0.00	0.00	4,969.6	-418.3	227.0	-186.8	0.00	0.00	0.00
5,100.0	0.00	0.00	5,069.6	-418.3	227.0	-186.8	0.00	0.00	0.00
5,200.0	0.00	0.00	5,169.6	-418.3	227.0	-186.8	0.00	0.00	0.00
5,300.0	0.00	0.00	5,269.6	-418.3	227.0	-186.8	0.00	0.00	0.00
5,400.0	0.00	0.00	5,369.6	-418.3	227.0	-186.8	0.00	0.00	0.00
5,500.0	0.00	0.00	5,469.6	-418.3	227.0	-186.8	0.00	0.00	0.00
5,600.0	0.00	0.00	5,569.6	-418.3	227.0	-186.8	0.00	0.00	0.00
5,700.0	0.00	0.00	5,669.6	-418.3	227.0	-186.8	0.00	0.00	0.00
5,800.0	0.00	0.00	5,769.6	-418.3	227.0	-186.8	0.00	0.00	0.00
5,900.0	0.00	0.00	5,869.6	-418.3	227.0	-186.8	0.00	0.00	0.00
6,000.0	0.00	0.00	5,969.6	-418.3	227.0	-186.8	0.00	0.00	0.00
6,100.0	0.00	0.00	6,069.6	-418.3	227.0	-186.8	0.00	0.00	0.00
6,200.0	0.00	0.00	6,169.6	-418.3	227.0	-186.8	0.00	0.00	0.00
6,300.0	0.00	0.00	6,269.6	-418.3	227.0	-186.8	0.00	0.00	0.00
6,400.0	0.00	0.00	6,369.6	-418.3	227.0	-186.8	0.00	0.00	0.00
6,500.0	0.00	0.00	6,469.6	-418.3	227.0	-186.8	0.00	0.00	0.00
6,537.6	0.00	0.00	6,507.2	-418.3	227.0	-186.8	0.00	0.00	0.00
Start Build 10.00									
6,600.0	6.24	267.98	6,569.5	-418.4	223.6	-183.4	10.00	10.00	0.00
6,700.0	16.24	267.98	6,667.4	-419.1	204.1	-164.0	10.00	10.00	0.00
6,800.0	26.25	267.98	6,760.5	-420.4	168.0	-127.8	10.00	10.00	0.00
6,900.0	36.25	267.98	6,845.9	-422.2	116.2	-76.1	10.00	10.00	0.00
7,000.0	46.25	267.98	6,921.0	-424.5	50.4	-10.4	10.00	10.00	0.00
7,100.0	56.25	267.98	6,983.5	-427.3	-27.4	67.4	10.00	10.00	0.00
7,200.0	66.26	267.98	7,031.5	-430.4	-115.0	154.8	10.00	10.00	0.00
7,300.0	76.26	267.98	7,063.6	-433.7	-209.5	249.2	10.00	10.00	0.00
7,400.0	86.26	267.98	7,078.8	-437.2	-308.1	347.8	10.00	10.00	0.00
7,441.0	90.36	267.98	7,080.0	-438.6	-349.1	388.7	10.00	10.00	0.00
Start DLS 0.50 TFO 132.14									
7,441.7	90.36	267.98	7,080.0	-438.7	-349.8	389.4	0.48	-0.33	0.36
Start 6889.4 hold at 7441.7 MD									
7,500.0	90.36	267.98	7,079.6	-440.7	-408.0	447.6	0.00	0.00	0.00
7,600.0	90.36	267.98	7,079.0	-444.2	-508.0	547.4	0.00	0.00	0.00
7,700.0	90.36	267.98	7,078.4	-447.8	-607.9	647.2	0.00	0.00	0.00
7,800.0	90.36	267.98	7,077.8	-451.3	-707.8	747.0	0.00	0.00	0.00
7,900.0	90.36	267.98	7,077.1	-454.8	-807.8	846.9	0.00	0.00	0.00
8,000.0	90.36	267.98	7,076.5	-458.3	-907.7	946.7	0.00	0.00	0.00
8,100.0	90.36	267.98	7,075.9	-461.8	-1,007.7	1,046.5	0.00	0.00	0.00
8,200.0	90.36	267.98	7,075.3	-465.4	-1,107.6	1,146.3	0.00	0.00	0.00
8,300.0	90.36	267.98	7,074.6	-468.9	-1,207.5	1,246.2	0.00	0.00	0.00
8,400.0	90.36	267.98	7,074.0	-472.4	-1,307.5	1,346.0	0.00	0.00	0.00
8,500.0	90.36	267.98	7,073.4	-475.9	-1,407.4	1,445.8	0.00	0.00	0.00
8,600.0	90.36	267.98	7,072.8	-479.4	-1,507.3	1,545.6	0.00	0.00	0.00
8,700.0	90.36	267.98	7,072.1	-483.0	-1,607.3	1,645.5	0.00	0.00	0.00
8,800.0	90.36	267.98	7,071.5	-486.5	-1,707.2	1,745.3	0.00	0.00	0.00
8,900.0	90.36	267.98	7,070.9	-490.0	-1,807.1	1,845.1	0.00	0.00	0.00
9,000.0	90.36	267.98	7,070.3	-493.5	-1,907.1	1,945.0	0.00	0.00	0.00
9,100.0	90.36	267.98	7,069.6	-497.1	-2,007.0	2,044.8	0.00	0.00	0.00
9,200.0	90.36	267.98	7,069.0	-500.6	-2,107.0	2,144.6	0.00	0.00	0.00
9,300.0	90.36	267.98	7,068.4	-504.1	-2,206.9	2,244.4	0.00	0.00	0.00
9,400.0	90.36	267.98	7,067.8	-507.6	-2,306.8	2,344.3	0.00	0.00	0.00
9,500.0	90.36	267.98	7,067.2	-511.1	-2,406.8	2,444.1	0.00	0.00	0.00

Database:	US_EDM	Local Co-ordinate Reference:	Well Booth U-8-7HN
Company:	Bayswater Exploration & Production, LLC	TVD Reference:	WELL @ 4831.0ft (RKB - 23')
Project:	SEC.8-T6N-R66W	MD Reference:	WELL @ 4831.0ft (RKB - 23')
Site:	Booth 8-L Pad Sec.8-T6N-R66W	North Reference:	True
Well:	Booth U-8-7HN	Survey Calculation Method:	Minimum Curvature
Wellbore:	Wellbore #1		
Design:	Plan #1 (5-03-17)		

Planned Survey										
Measured Depth (ft)	Inclination (°)	Azimuth (°)	Vertical Depth (ft)	+N/-S (ft)	+E/-W (ft)	Vertical Section (ft)	Dogleg Rate (°/100usft)	Build Rate (°/100usft)	Turn Rate (°/100usft)	
9,600.0	90.36	267.98	7,066.5	-514.7	-2,506.7	2,543.9	0.00	0.00	0.00	
9,700.0	90.36	267.98	7,065.9	-518.2	-2,606.6	2,643.7	0.00	0.00	0.00	
9,800.0	90.36	267.98	7,065.3	-521.7	-2,706.6	2,743.6	0.00	0.00	0.00	
9,900.0	90.36	267.98	7,064.7	-525.2	-2,806.5	2,843.4	0.00	0.00	0.00	
10,000.0	90.36	267.98	7,064.0	-528.8	-2,906.4	2,943.2	0.00	0.00	0.00	
10,100.0	90.36	267.98	7,063.4	-532.3	-3,006.4	3,043.0	0.00	0.00	0.00	
10,200.0	90.36	267.98	7,062.8	-535.8	-3,106.3	3,142.9	0.00	0.00	0.00	
10,300.0	90.36	267.98	7,062.2	-539.3	-3,206.2	3,242.7	0.00	0.00	0.00	
10,400.0	90.36	267.98	7,061.5	-542.8	-3,306.2	3,342.5	0.00	0.00	0.00	
10,500.0	90.36	267.98	7,060.9	-546.4	-3,406.1	3,442.3	0.00	0.00	0.00	
10,600.0	90.36	267.98	7,060.3	-549.9	-3,506.1	3,542.2	0.00	0.00	0.00	
10,700.0	90.36	267.98	7,059.7	-553.4	-3,606.0	3,642.0	0.00	0.00	0.00	
10,800.0	90.36	267.98	7,059.0	-556.9	-3,705.9	3,741.8	0.00	0.00	0.00	
10,900.0	90.36	267.98	7,058.4	-560.5	-3,805.9	3,841.6	0.00	0.00	0.00	
11,000.0	90.36	267.98	7,057.8	-564.0	-3,905.8	3,941.5	0.00	0.00	0.00	
11,100.0	90.36	267.98	7,057.2	-567.5	-4,005.7	4,041.3	0.00	0.00	0.00	
11,200.0	90.36	267.98	7,056.5	-571.0	-4,105.7	4,141.1	0.00	0.00	0.00	
11,300.0	90.36	267.98	7,055.9	-574.5	-4,205.6	4,241.0	0.00	0.00	0.00	
11,400.0	90.36	267.98	7,055.3	-578.1	-4,305.5	4,340.8	0.00	0.00	0.00	
11,500.0	90.36	267.98	7,054.7	-581.6	-4,405.5	4,440.6	0.00	0.00	0.00	
11,600.0	90.36	267.98	7,054.0	-585.1	-4,505.4	4,540.4	0.00	0.00	0.00	
11,700.0	90.36	267.98	7,053.4	-588.6	-4,605.4	4,640.3	0.00	0.00	0.00	
11,800.0	90.36	267.98	7,052.8	-592.2	-4,705.3	4,740.1	0.00	0.00	0.00	
11,900.0	90.36	267.98	7,052.2	-595.7	-4,805.2	4,839.9	0.00	0.00	0.00	
12,000.0	90.36	267.98	7,051.5	-599.2	-4,905.2	4,939.7	0.00	0.00	0.00	
12,100.0	90.36	267.98	7,050.9	-602.7	-5,005.1	5,039.6	0.00	0.00	0.00	
12,200.0	90.36	267.98	7,050.3	-606.2	-5,105.0	5,139.4	0.00	0.00	0.00	
12,300.0	90.36	267.98	7,049.7	-609.8	-5,205.0	5,239.2	0.00	0.00	0.00	
12,400.0	90.36	267.98	7,049.1	-613.3	-5,304.9	5,339.0	0.00	0.00	0.00	
12,500.0	90.36	267.98	7,048.4	-616.8	-5,404.8	5,438.9	0.00	0.00	0.00	
12,600.0	90.36	267.98	7,047.8	-620.3	-5,504.8	5,538.7	0.00	0.00	0.00	
12,700.0	90.36	267.98	7,047.2	-623.9	-5,604.7	5,638.5	0.00	0.00	0.00	
12,800.0	90.36	267.98	7,046.6	-627.4	-5,704.6	5,738.3	0.00	0.00	0.00	
12,900.0	90.36	267.98	7,045.9	-630.9	-5,804.6	5,838.2	0.00	0.00	0.00	
13,000.0	90.36	267.98	7,045.3	-634.4	-5,904.5	5,938.0	0.00	0.00	0.00	
13,100.0	90.36	267.98	7,044.7	-637.9	-6,004.5	6,037.8	0.00	0.00	0.00	
13,200.0	90.36	267.98	7,044.1	-641.5	-6,104.4	6,137.6	0.00	0.00	0.00	
13,300.0	90.36	267.98	7,043.4	-645.0	-6,204.3	6,237.5	0.00	0.00	0.00	
13,400.0	90.36	267.98	7,042.8	-648.5	-6,304.3	6,337.3	0.00	0.00	0.00	
13,500.0	90.36	267.98	7,042.2	-652.0	-6,404.2	6,437.1	0.00	0.00	0.00	
13,600.0	90.36	267.98	7,041.6	-655.5	-6,504.1	6,536.9	0.00	0.00	0.00	
13,700.0	90.36	267.98	7,040.9	-659.1	-6,604.1	6,636.8	0.00	0.00	0.00	
13,800.0	90.36	267.98	7,040.3	-662.6	-6,704.0	6,736.6	0.00	0.00	0.00	
13,900.0	90.36	267.98	7,039.7	-666.1	-6,803.9	6,836.4	0.00	0.00	0.00	
14,000.0	90.36	267.98	7,039.1	-669.6	-6,903.9	6,936.3	0.00	0.00	0.00	
14,100.0	90.36	267.98	7,038.4	-673.2	-7,003.8	7,036.1	0.00	0.00	0.00	
14,200.0	90.36	267.98	7,037.8	-676.7	-7,103.8	7,135.9	0.00	0.00	0.00	
14,300.0	90.36	267.98	7,037.2	-680.2	-7,203.7	7,235.7	0.00	0.00	0.00	
14,331.1	90.36	267.98	7,037.0	-681.3	-7,234.8	7,266.8	0.00	0.00	0.00	
TD at 14331.1										

Database:	US_EDM	Local Co-ordinate Reference:	Well Booth U-8-7HN
Company:	Bayswater Exploration & Production, LLC	TVD Reference:	WELL @ 4831.0ft (RKB - 23')
Project:	SEC.8-T6N-R66W	MD Reference:	WELL @ 4831.0ft (RKB - 23')
Site:	Booth 8-L Pad Sec.8-T6N-R66W	North Reference:	True
Well:	Booth U-8-7HN	Survey Calculation Method:	Minimum Curvature
Wellbore:	Wellbore #1		
Design:	Plan #1 (5-03-17)		

Design Targets									
Target Name	Dip Angle	Dip Dir.	TVD	+N/-S	+E/-W	Northing	Easting	Latitude	Longitude
- hit/miss target	(°)	(°)	(ft)	(ft)	(ft)	(usft)	(usft)		
- Shape									
SHL 1261'FSL, 248'FEL - plan hits target center - Point	0.00	0.00	1.0	0.0	0.0	1,425,353.15	3,196,523.36	40.498846	-104.793339
BHL 824'FSL, 2170'FEL - plan hits target center - Point	0.00	0.00	7,037.0	-681.3	-7,234.8	1,424,614.24	3,189,294.50	40.496973	-104.819352
LPL 830'FSL, 601'FEL, 6 - plan hits target center - Point	0.00	0.00	7,080.0	-438.6	-349.1	1,424,911.76	3,196,177.78	40.497642	-104.794594

Plan Annotations				
Measured Depth	Vertical Depth	Local Coordinates		Comment
(ft)	(ft)	+N/-S (ft)	+E/-W (ft)	
800.0	800.0	0.0	0.0	KOP - Start Build 1.50
4,449.1	4,419.8	-29.7	16.1	Start Drop -2.00
6,537.6	6,507.2	-396.0	214.9	Start Build 10.00
7,441.0	7,080.0	-418.3	227.0	Start DLS 0.50 TFO 132.14
7,441.7	7,080.0	-418.3	227.0	Start 6889.4 hold at 7441.7 MD
14,331.1	7,037.0	-438.6	-349.1	TD at 14331.1