

SECTION: 31
TOWNSHIP: 12N
RANGE: 66W

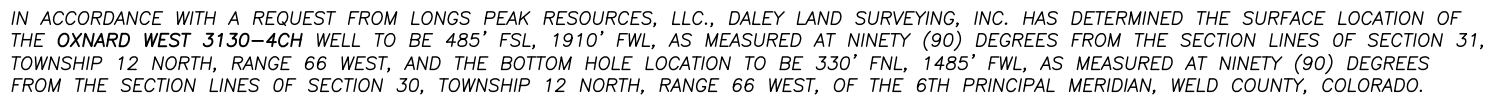

FOR AND ON BEHALF OF
DALEY LAND SURVEYING INC.,
Robert Daley, PLS 35597

- 1) BEARINGS FOR THIS MAP ARE ASSUMED AND BASED UPON GPS OBSERVATIONS MADE BETWEEN MONUMENTS LOCATED AT THE EAST QUARTER CORNER AND THE SOUTHEAST CORNER OF SECTION 31, T.12N., R.66W.
- 2) HORIZONTAL DATUM IS NAD83.
- 3) VERTICAL DATUM IS NAVD88 AND ORIGINATES FROM THE LOCAL C.O.R.S. NETWORK, UTILIZING THE GEOID12A MODEL.
- 4) SEE LOCATION DRAWING FOR VISIBLE IMPROVEMENTS WITHIN 500' OF PROPOSED DISTURBED AREA.
- 5) SURFACE USE: PASTURE.
- 6) INST. OPERATOR: SCOTT ESTABROOKS.

<u>NAD 83 LATITUDE AND LONGITUDE</u>	
<u>SURFACE LOCATION:</u>	<u>LANDING POINT/TPZ:</u>
LATITUDE: N40.95897°	LATITUDE: N40.95854°
LONGITUDE: W104.82267°	LONGITUDE: W104.82421°
ELEV: 6011'	
PDOP: 1.2	<u>BOTTOM HOLE:</u>
QTR/QTR: SE4/SW4	LATITUDE: N40.98560°
	LONGITUDE: W104.82423°



**DALEY LAND
SURVEYING, INC.**
303.953.9841