



January 25, 2017

Mr. Mike Dinkel, REM, CSEM
Kerr-McGee Oil & Gas Onshore LP
1099 18th Street, Suite 1800
Denver, Colorado 80202

**RE: Colorado Oil & Gas Conservation Commission (COGCC)
Form 4 (Interim Reclamation Completion Notice)
Barclay 3N-27HZ (327117)
Kerr-McGee Oil & Gas Onshore LP (Operator: 47120)**

Dear Mr. Dinkel:

Apex Companies, LLC (Apex) is pleased to present this letter to Kerr-McGee Oil & Gas Onshore LP (Kerr-McGee) documenting the results of a vegetation assessment that demonstrates successful completion of interim reclamation efforts per COGCC Rule 1003 on the above referenced location in Weld County, Colorado. Attached is a topographic location map, which identifies the referenced location.

Based on communications with Kerr-McGee personnel and subsequent site visits, Apex inspectors confirmed that the unused portions of the reduced production footprint have been stabilized and seeded with Dryland Pasture/ Sandy Soil Mix. This seed mixture was applied at 20 pounds pure live seed (pls) per acre, and is composed of Tetraploid Perennial Ryegrass (9.84%), Smooth Brome, Lincoln (9.33%), Sandberg Bluegrass (7.5%), Intermediate Wheatgrass (7.5%), Sand Dropseed (7.5%), Indian Ricegrass (7.5%), Green Needlegrass (7.5%), Sideoats Grama (7.5%), Intermediate Wheatgrass, Oahe (7.38%), Dahurian Wildrye (7.22%), Orchardgrass, Paiute (7.145%), Pubescent Wheatgrass Luna (6.675%), Switchgrass (5.00%), and Inert-Other (2.41%).

On June 28, 2016, modified step-point vegetation surveys were conducted on the reclaimed portion of the well pad, and on adjacent reference areas. Foliar and basal cover, along with non-vegetated, and noxious weed occurrences were documented; 100 survey points were recorded within the reclaimed disturbance and 100 survey points were recorded within the reference area. Noxious weeds listed by the Colorado Department of Agriculture were excluded from the vegetative coverage calculation.

Survey results indicate the reclaimed area has a foliar vegetative cover that is 239.27% of the reference area. Vegetation survey results are provided in the attached survey summary tables and data sheets. Based on the results of the survey, interim reclamation as defined by COGCC Rule 1003.e (2) has been achieved. Photographs required by COGCC Rule 1003.e (3) are also attached along with a diagram illustrating vegetation survey efforts.

Apex appreciates the opportunity to provide environmental consulting services to Kerr-McGee with this project. Should you have any questions or require additional information, please don't hesitate to contact me.

Sincerely,
Apex Companies, LLC

A handwritten signature in black ink, appearing to read 'Chris Hines', written over a light blue horizontal line.

Chris Hines
Project Manager
970-261-1127
chris.hines@apexcos.com

Attachments:

1. Vegetation Survey (Summary of Field Data)
2. Vegetation Survey Site Map
3. Topographic Location Map
4. Vegetation Survey (Photos)
5. Vegetation Survey (Field Data Tables)



Vegetation Survey (Summary of Field Data)

Client	Kerr-McGee Oil & Gas Onshore LP
COGCC Location Name (ID)	BARCLAY 3N-27HZ (327117)
Assessment Date	6/28/2016
Inspector Name - Title	Jennie Schoedel - Environmental Scientist
Data Processor Name - Title	Jennie Schoedel-Environmental Scientist

Based on the survey methodology, the Foliar Cover % in each survey area is calculated by summing the total number of foliar occurrences, minus noxious weeds, and dividing by the total occurrences in the transect. For this location:

Reclaim Area (Foliar Cover)	Reference Area (Foliar Cover)
$(37 + 2 + 0) / 141 =$ 27.66%	$(2 + 15 + 0) / 147 =$ 11.56%

The Percent of Reference (%) used to evaluate each reclaim area for compliance with COGCC Rule 1003.e(2) for determining interim reclamation success, is calculated by dividing the Foliar Cover % in the Reclaim Area by the Foliar Cover % in the Reference Area. For this location:

Percent of Reference (Reclaim % / Reference %)
$27.66\% / 11.56\% =$ 239.27%

Reclaim Area Vegetation

Foliar Cover	27.66%
Basal Cover	7.80%
Non Vegetated	63.12%
Noxious Weeds	1.42%
QA Total <i>(must equal 100)</i>	100.00%
Grass (Foliar)	37
Forb (Foliar)	2
Shrubs (Foliar)	0
Noxious Weed (Foliar)	2
Grass (Basal)	10
Forb (Basal)	1
Shrubs (Basal)	0
Noxious Weed (Basal)	0
Bare Ground	16
Litter	73
Rock	0
Total Occurrences	141

Reference Area Vegetation

Foliar Cover	11.56%
Basal Cover	0.00%
Non Vegetated	65.99%
Noxious Weeds	22.45%
QA Total <i>(must equal 100)</i>	100.00%
Grass (Foliar)	2
Forb (Foliar)	15
Shrubs (Foliar)	0
Noxious Weed (Foliar)	30
Grass (Basal)	0
Forb (Basal)	0
Shrubs (Basal)	0
Noxious Weed (Basal)	3
Bare Ground	5
Litter	92
Rock	0
Total Occurrences	147

Vegetation Survey Site Map

Barclay 3N-27HZ

(327117)

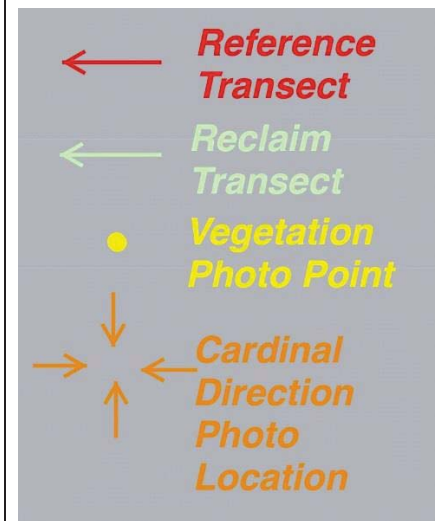

Legal Description: SESW, Sec 27,
T3N-R66W
County: Weld

Land Use: Rangeland
Reference Area Cover: 11.56%
Reclamation Cover: 27.66%
Cover Ratio
(Reclaim/Reference): 239.27%

Inspector: J. Schoedel
Assessment Date: 06/28/2016



Topographic
Location Map

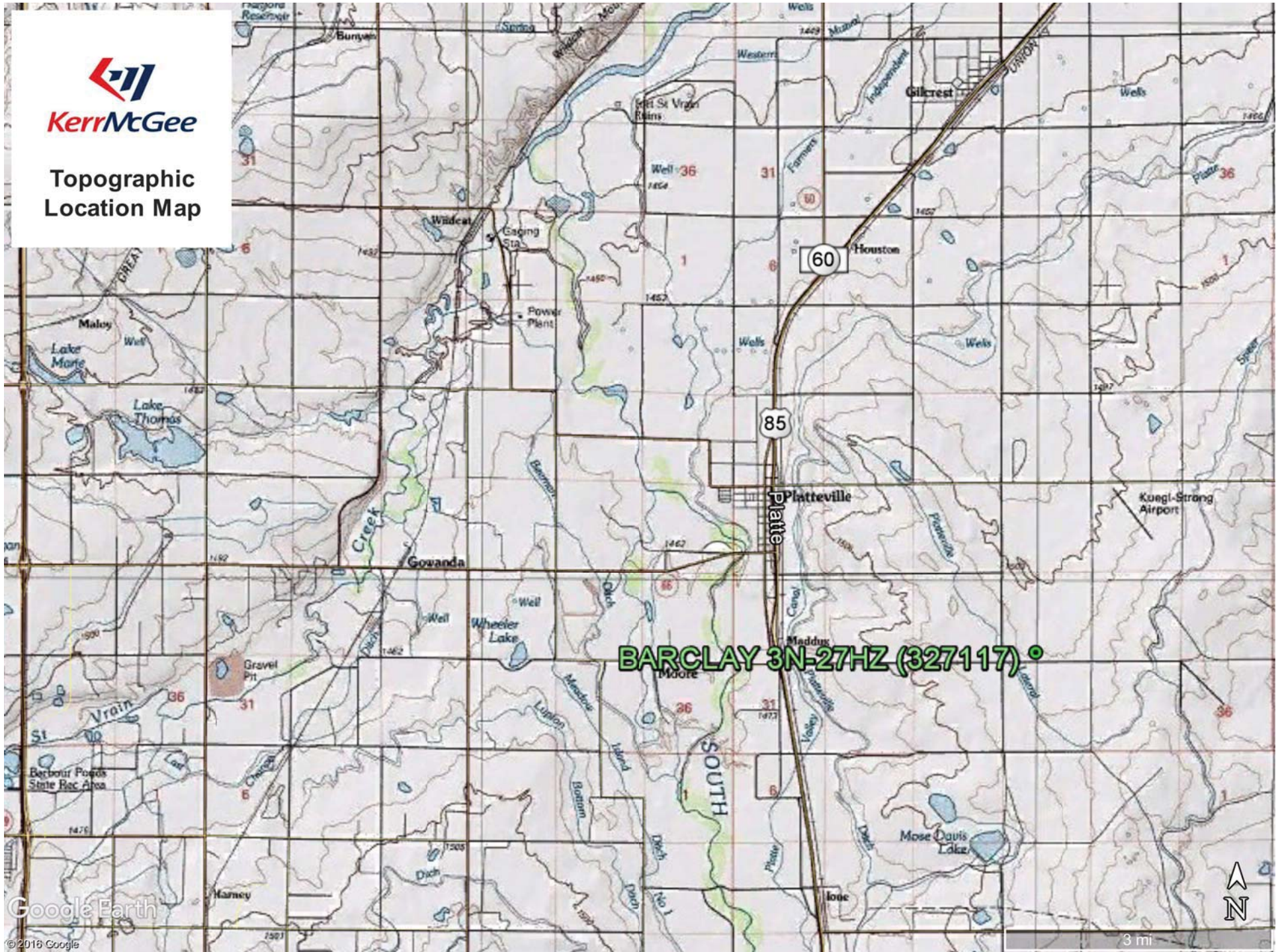

BARCLAY 3N-27HZ (327117) °





Edge of Disturbance - Facing East
40.191201°/-104.765118°



Kerr-McGee Oil & Gas Onshore LP
Form 4 (Interim Reclamation Completion Notice)
BARCLAY 3N-27HZ (327117)

Vegetation Assessment
Completed (06/28/2016)



South of Disturbance - Facing North
40.190168°/-104.765569°



North of Disturbance - Facing South
40.191100°/-104.765620°



West of Disturbance - Facing East
40.190580°/-104.766223°

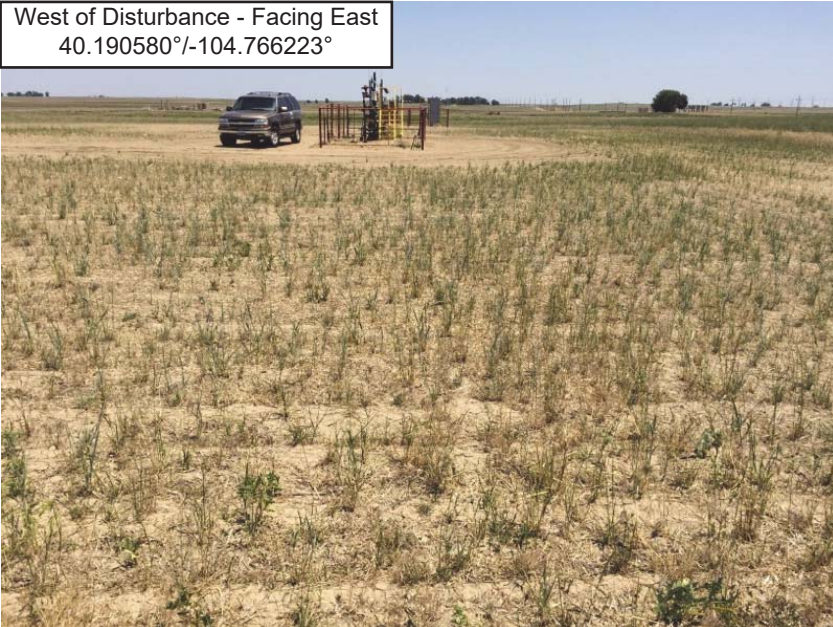

East of Disturbance - Facing West
40.190673°/-104.764967°



Reclaim Area Vegetation Photo Point
40.190166°/-104.764876°



Reclaim Transect 1 - Facing East
40.189697°/-104.766104°



Reclaim Transect 2 - Facing South
40.190996°/-104.764448°



Reference Area Vegetation Photo Point
40.191831°/-104.765494°



Reference Transect 1 - Facing East
40.191470°/-104.765284°



Reference Transect 2 - Facing South
40.190965°/-104.763905°



VEGETATION MONITORING FORM: Kerr-McGee Oil & Gas Onshore LP

COGCC Location Name (ID): BARCLAY 3N-27HZ (327117)		CO #: COP0288	Date of Assessment: 06/28/2016
Transect ID: Reclaim Transect 1	Length of Transect (ft.): 500	Transect Type: <input checked="" type="checkbox"/> Reclamation <input type="checkbox"/> Reference	
Inspector(s) (Name and Title): Jennie Schoedel - Environmental Scientist			
Weather at Time of Inspection: Partly Cloudy, 90s		Method: Step Point	

Point	Foliar		Basal		Non-Vegetative
	Type	Species	Type	Species	
1	-		-		Litter
2	-		-		Litter
3	-		-		Litter
4	Grass	Pascopyrum smithii (Agropyron)	-		Litter
5	Grass	Pascopyrum smithii (Agropyron)	-		Litter
6	-		-		Litter
7	Grass	Pascopyrum smithii (Agropyron)	B-Grass	Pascopyrum smithii (Agropyron)	-
8	-		-		Litter
9	Grass	Pascopyrum smithii (Agropyron)	-		Litter
10	Grass	Pascopyrum smithii (Agropyron)	-		Litter
11	Grass	Pascopyrum smithii (Agropyron)	-		Litter
12	-		-		Litter
13	Grass	Pascopyrum smithii (Agropyron)	-		Litter
14	-		-		Litter
15	Grass	Pascopyrum smithii (Agropyron)	-		Litter
16	Grass	Pascopyrum smithii (Agropyron)	-		Litter
17	-		-		Litter
18	Grass	Other spp. 1	-		Litter
19	Noxious Weed	Bromus tectorum	-		Litter
20	-		-		Litter
21	Grass	Pascopyrum smithii (Agropyron)	-		Litter
22	-		-		Litter
23	Grass	Pascopyrum smithii (Agropyron)	B-Grass	Pascopyrum smithii (Agropyron)	-
24	-		-		Litter
25	Grass	Elymus lanceolatus	-		Litter
26	-		-		Litter
27	Noxious Weed	Bromus tectorum	-		Litter
28	-		-		Bare Ground
29	Grass	Pascopyrum smithii (Agropyron)	-		Litter

Point	Foliar		Basal		Non-Vegetative
	Type	Species	Type	Species	
30	-		-		Litter
31	-		-		Bare Ground
32	-		-		Litter
33	Grass	Pascopyrum smithii (Agropyron)	B-Grass	Pascopyrum smithii (Agropyron)	-
34	-		-		Litter
35	-		-		Bare Ground
36	Grass	Pascopyrum smithii (Agropyron)	-		Litter
37	-		-		Litter
38	Grass	Bromus inermis	-		Litter
39	-		-		Litter
40	-		-		Litter
41	Grass	Pascopyrum smithii (Agropyron)	-		Litter
42	-		-		Litter
43	-		-		Litter
44	-		-		Litter
45	Grass	Pascopyrum smithii (Agropyron)	-		Bare Ground
46	-		-		Litter
47	-		-		Litter
48	Grass	Pascopyrum smithii (Agropyron)	B-Grass	Pascopyrum smithii (Agropyron)	-
49	-		-		Litter
50	-		-		Litter

Photo Requirements

Representative photo looking down the length of each transect; including reference area.	<input checked="" type="checkbox"/>	YES	<input type="checkbox"/>	NO
Photo facing each cardinal direction (N, E, S, W) from edge of disturbance looking to well heads.	<input checked="" type="checkbox"/>	YES	<input type="checkbox"/>	NO
Representative photo down edge of disturbance.	<input checked="" type="checkbox"/>	YES	<input type="checkbox"/>	NO
Photo that documents the total cover of live perennial vegetation for the reference area.	<input checked="" type="checkbox"/>	YES	<input type="checkbox"/>	NO
Photo that documents the total cover of live perennial vegetation of the disturbed area.	<input checked="" type="checkbox"/>	YES	<input type="checkbox"/>	NO

General Notes: Grass other species 1 crested wheat grass

List any newly identified species not present in drop-down lists.

INSPECTION CERTIFICATION

I certify that this document and all attachments were prepared by me or under my direction or supervision in accordance with a system designed to assure that qualified personnel properly gather and evaluate the information submitted. The information submitted is, to the best of my knowledge and belief, true, accurate, and complete. I am aware that there are significant penalties for submitting false information, including the possibility of termination.

Inspector (Name)

Jennie Schoedel - Environmental Scientist



Date: 06/28/2016

VEGETATION MONITORING FORM: Kerr-McGee Oil & Gas Onshore LP

COGCC Location Name (ID): BARCLAY 3N-27HZ (327117)		CO #: COP0288	Date of Assessment: 06/28/2016
Transect ID: Reclaim Transect 2	Length of Transect (ft.): 500	Transect Type: <input checked="" type="checkbox"/> Reclamation <input type="checkbox"/> Reference	
Inspector(s) (Name and Title): Jennie Schoedel - Environmental Scientist			
Weather at Time of Inspection: Partly Cloudy, 90s		Method: Step Point	

Point	Foliar		Basal		Non-Vegetative
	Type	Species	Type	Species	
1	-		-		Litter
2	Grass	Pascopyrum smithii (Agropyron)	-		Litter
3	Grass	Pascopyrum smithii (Agropyron)	B-Grass	Pascopyrum smithii (Agropyron)	-
4	-		-		Bare Ground
5	-		-		Litter
6	-		-		Litter
7	Forb	Hippuris vulgaris	-		Litter
8	-		-		Bare Ground
9	-		-		Litter
10	-		-		Litter
11	Grass	Elymus lanceolatus	-		Litter
12	-		-		Bare Ground
13	Grass	Pascopyrum smithii (Agropyron)	B-Grass	Pascopyrum smithii (Agropyron)	-
14	-		-		Litter
15	Grass	Bromus inermis	-		Litter
16	-		-		Bare Ground
17	-		-		Litter
18	-		-		Bare Ground
19	Grass	Pascopyrum smithii (Agropyron)	-		Litter
20	-		-		Bare Ground
21	-		-		Litter
22	Grass	Pascopyrum smithii (Agropyron)	B-Grass	Pascopyrum smithii (Agropyron)	-
23	-		-		Bare Ground
24	-		-		Litter
25	Grass	Pascopyrum smithii (Agropyron)	-		Litter
26	-		-		Litter
27	-		-		Litter
28	Grass	Pascopyrum smithii (Agropyron)	-		Litter
29	Grass	Bromus inermis	-		Litter

Point	Foliar		Basal		Non-Vegetative
	Type	Species	Type	Species	
30	-		-		Litter
31	-		-		Litter
32	Grass	Pascopyrum smithii (Agropyron)	B-Grass	Pascopyrum smithii (Agropyron)	-
33	-		-		Litter
34	Grass	Pascopyrum smithii (Agropyron)	-		Litter
35	-		-		Litter
36	-		-		Bare Ground
37	Grass	Elymus lanceolatus	-		Litter
38	-		-		Bare Ground
39	-		-		Bare Ground
40	Grass	Pascopyrum smithii (Agropyron)	-		Litter
41	Grass	Pascopyrum smithii (Agropyron)	-		Litter
42	-		-		Litter
43	-		-		Litter
44	-		-		Litter
45	Grass	Elymus lanceolatus	B-Grass	Elymus lanceolatus	-
46	-		-		Bare Ground
47	Forb	Hippuris vulgaris	B-Forb	Hippuris vulgaris	-
48	-		-		Bare Ground
49	Grass	Pascopyrum smithii (Agropyron)	B-Grass	Pascopyrum smithii (Agropyron)	-
50	-		-		Litter

Photo Requirements

Representative photo looking down the length of each transect; including reference area.	<input checked="" type="checkbox"/>	YES	<input type="checkbox"/>	NO
Photo facing each cardinal direction (N, E, S, W) from edge of disturbance looking to well heads.	<input checked="" type="checkbox"/>	YES	<input type="checkbox"/>	NO
Representative photo down edge of disturbance.	<input checked="" type="checkbox"/>	YES	<input type="checkbox"/>	NO
Photo that documents the total cover of live perennial vegetation for the reference area.	<input checked="" type="checkbox"/>	YES	<input type="checkbox"/>	NO
Photo that documents the total cover of live perennial vegetation of the disturbed area.	<input checked="" type="checkbox"/>	YES	<input type="checkbox"/>	NO

General Notes:

List any newly identified species not present in drop-down lists.

INSPECTION CERTIFICATION

I certify that this document and all attachments were prepared by me or under my direction or supervision in accordance with a system designed to assure that qualified personnel properly gather and evaluate the information submitted. The information submitted is, to the best of my knowledge and belief, true, accurate, and complete. I am aware that there are significant penalties for submitting false information, including the possibility of termination.

Inspector (Name)

Jennie Schoedel -Environmental Scientist



Date: 06/28/2016

VEGETATION MONITORING FORM: Kerr-McGee Oil & Gas Onshore LP

COGCC Location Name (ID): BARCLAY 3N-27HZ (327117)		CO #: COP0288	Date of Assessment: 06/28/2016
Transect ID: Reference Transect 1	Length of Transect (ft.): 500	Transect Type: <input type="checkbox"/> Reclamation <input checked="" type="checkbox"/> Reference	
Inspector(s) (Name and Title): Jennie Schoedel - Environmental Scientist			
Weather at Time of Inspection: Partly Cloudy, 90s		Method: Step Point	

Point	Foliar		Basal		Non-Vegetative
	Type	Species	Type	Species	
1	-		-		Litter
2	Noxious Weed	Bromus tectorum	-		Litter
3	-		-		Litter
4	Forb	Lactuca serriola	-		Litter
5	-		-		Litter
6	Forb	Lactuca serriola	-		Litter
7	-		-		Litter
8	-		-		Litter
9	Forb	Lactuca serriola	-		Litter
10	-		-		Litter
11	Noxious Weed	Bromus tectorum	-		Litter
12	Forb	Lactuca serriola	-		Litter
13	Noxious Weed	Bromus tectorum	-		Litter
14	-		-		Litter
15	Noxious Weed	Bromus tectorum	-		Litter
16	-		-		Litter
17	-		-		Litter
18	Noxious Weed	Bromus tectorum	-		Bare Ground
19	-		-		Litter
20	-		-		Litter
21	Noxious Weed	Bromus tectorum	-		Litter
22	-		-		Litter
23	Noxious Weed	Bromus tectorum	-		Litter
24	Noxious Weed	Bromus tectorum	-		Litter
25	-		-		Litter
26	Forb	Tragopogon porrifoliu	-		Litter
27	-		-		Litter
28	Noxious Weed	Bromus tectorum	B-Noxious Weed	Bromus tectorum	-
29	-		-		Litter

Point	Foliar		Basal		Non-Vegetative
	Type	Species	Type	Species	
30	Forb	Lactuca serriola	-		Litter
31	-		-		Litter
32	Noxious Weed	Bromus tectorum	-		Litter
33	-		-		Litter
34	-		-		Litter
35	Noxious Weed	Bromus tectorum	-		Litter
36	-		-		Litter
37	Forb	Lactuca serriola	-		Litter
38	-		-		Litter
39	Noxious Weed	Bromus tectorum	-		Litter
40	-		-		Litter
41	Forb	Lactuca serriola	-		Litter
42	-		-		Litter
43	Forb	Lactuca serriola	B-Noxious Weed	Bromus tectorum	-
44	-		-		Litter
45	Noxious Weed	Bromus tectorum	-		Litter
46	-		-		Litter
47	Noxious Weed	Bromus tectorum	-		Litter
48	Noxious Weed	Bromus tectorum	-		Litter
49	-		-		Litter
50	-		-		Litter

Photo Requirements

Representative photo looking down the length of each transect; including reference area.	<input checked="" type="checkbox"/>	YES	<input type="checkbox"/>	NO
Photo facing each cardinal direction (N, E, S, W) from edge of disturbance looking to well heads.	<input checked="" type="checkbox"/>	YES	<input type="checkbox"/>	NO
Representative photo down edge of disturbance.	<input checked="" type="checkbox"/>	YES	<input type="checkbox"/>	NO
Photo that documents the total cover of live perennial vegetation for the reference area.	<input checked="" type="checkbox"/>	YES	<input type="checkbox"/>	NO
Photo that documents the total cover of live perennial vegetation of the disturbed area.	<input checked="" type="checkbox"/>	YES	<input type="checkbox"/>	NO

General Notes:

List any newly identified species not present in drop-down lists.

INSPECTION CERTIFICATION

I certify that this document and all attachments were prepared by me or under my direction or supervision in accordance with a system designed to assure that qualified personnel properly gather and evaluate the information submitted. The information submitted is, to the best of my knowledge and belief, true, accurate, and complete. I am aware that there are significant penalties for submitting false information, including the possibility of termination.

Inspector (Name)

Jennie Schoedel - Environmental Scientist



Date: 06/28/2016

VEGETATION MONITORING FORM: Kerr-McGee Oil & Gas Onshore LP

COGCC Location Name (ID): BARCLAY 3N-27HZ (327117)		CO #: COP0288	Date of Assessment: 06/28/2016
Transect ID: Reference Transect 2	Length of Transect (ft.): 500	Transect Type: <input type="checkbox"/> Reclamation <input checked="" type="checkbox"/> Reference	
Inspector(s) (Name and Title): Jennie Schoedel - Environmental Scientist			
Weather at Time of Inspection: Partly Cloudy, 90s		Method: Step Point	

Point	Foliar		Basal		Non-Vegetative
	Type	Species	Type	Species	
1	Noxious Weed	Bromus tectorum	-		Litter
2	-		-		Litter
3	-		-		Litter
4	Noxious Weed	Bromus tectorum	-		Litter
5	-		-		Litter
6	Noxious Weed	Bromus tectorum	-		Litter
7	-		-		Litter
8	Noxious Weed	Bromus tectorum	-		Litter
9	Noxious Weed	Bromus tectorum	B-Noxious Weed	Bromus tectorum	-
10	Noxious Weed	Bromus tectorum	-		Litter
11	Noxious Weed	Bromus tectorum	-		Litter
12	-		-		Bare Ground
13	-		-		Litter
14	Noxious Weed	Bromus tectorum	-		Litter
15	-		-		Litter
16	Noxious Weed	Bromus tectorum	-		Litter
17	-		-		Litter
18	-		-		Litter
19	Noxious Weed	Bromus tectorum	-		Litter
20	Noxious Weed	Bromus tectorum	-		Litter
21	-		-		Bare Ground
22	-		-		Litter
23	-		-		Litter
24	Forb	Lactuca serriola	-		Litter
25	-		-		Litter
26	Forb	Hippuris vulgaris	-		Litter
27	-		-		Litter
28	-		-		Bare Ground
29	-		-		Litter

Point	Foliar		Basal		Non-Vegetative
	Type	Species	Type	Species	
30	Grass	Secale cereale	-		Litter
31	-		-		Litter
32	Forb	Hippuris vulgaris	-		Bare Ground
33	-		-		Litter
34	-		-		Litter
35	-		-		Litter
36	Noxious Weed	Bromus tectorum	-		Litter
37	Noxious Weed	Bromus tectorum	-		Litter
38	-		-		Litter
39	Grass	Secale cereale	-		Litter
40	-		-		Litter
41	-		-		Litter
42	Noxious Weed	Bromus tectorum	-		Litter
43	-		-		Litter
44	Forb	Hippuris vulgaris	-		Litter
45	-		-		Litter
46	Forb	Lactuca serriola	-		Litter
47	-		-		Litter
48	Forb	Lactuca serriola	-		Litter
49	-		-		Litter
50	Noxious Weed	Bromus tectorum	-		Litter

Photo Requirements

Representative photo looking down the length of each transect; including reference area.	<input checked="" type="checkbox"/>	YES	<input type="checkbox"/>	NO
Photo facing each cardinal direction (N, E, S, W) from edge of disturbance looking to well heads.	<input checked="" type="checkbox"/>	YES	<input type="checkbox"/>	NO
Representative photo down edge of disturbance.	<input checked="" type="checkbox"/>	YES	<input type="checkbox"/>	NO
Photo that documents the total cover of live perennial vegetation for the reference area.	<input checked="" type="checkbox"/>	YES	<input type="checkbox"/>	NO
Photo that documents the total cover of live perennial vegetation of the disturbed area.	<input checked="" type="checkbox"/>	YES	<input type="checkbox"/>	NO

General Notes:

List any newly identified species not present in drop-down lists.

INSPECTION CERTIFICATION

I certify that this document and all attachments were prepared by me or under my direction or supervision in accordance with a system designed to assure that qualified personnel properly gather and evaluate the information submitted. The information submitted is, to the best of my knowledge and belief, true, accurate, and complete. I am aware that there are significant penalties for submitting false information, including the possibility of termination.

Inspector (Name)

Jennie Schoedel - Environmental Scientist



Date: 06/28/2016