

Location:	COLORADO	Slot:	SLOT#01 CONNER 19-18-1CDH (350'FSL & 1795'FWL, SEC.19)
Field:	ADAMS COUNTY (NAD83/ TRUE NORTH)	Well:	CONNER 19-18-1CDH
Facility:	SEC.19-T01S-R65W	Wellbore:	CONNER 19-18-1CDH PWB

Location:	COLORADO	Slot:	SLOT#01 CONNER 19-18-1CDH (350'FSL & 1795'FWL, SEC.19)
Field:	ADAMS COUNTY (NAD83/ TRUE NORTH)	Well:	CONNER 19-18-1CDH
Facility:	SEC.19-T01S-R65W	Wellbore:	CONNER 19-18-1CDH PWB

Plot reference wellpath is CONNER 19-18-1CDH PWP (REV-A.0)

Grid System: NAD83 / Lambert Colorado SP, Northern Zone (501), US feet

True vertical depths are referenced to RIG (5142'GL + 13'KB) (RKB)

North Reference: True north

Measured depths are referenced to RIG (5142'GL + 13'KB) (RKB)

Scale: True distance

RIG (5142'GL + 13'KB) (RKB) to Mean Sea Level: 5155 feet

Depths are in feet

Mean Sea Level to Mud line (At Slot: SLOT#01 CONNER 19-18-1CDH (350'FSL & 1795'FWL, SEC.19)): 0 feet

Created by: ingmjmr on 2017-07-28

Coordinates are in feet referenced to Slo

Database: WA_DEN_Denver_Defn

Location Information

Facility Name			Grid East (US ft)	Grid North (US ft)	Latitude	Longitude
SEC. 19-T01S-R66W			3222009.380	1223555.333	39°56'39.552"N	104°42'29.448"W
Slot	Local N (ft)	Local E (ft)	Grid East (US ft)	Grid North (US ft)	Latitude	Longitude
SLOT#01 CONNER 19-18-1CDH (350FWL & 1795FWL, SEC.19)	0.00	0.00	3222009.380	1223555.333	39°56'39.552"N	104°42'29.448"W
RIG (5142'GL + 13'XB) (RKB) to Mud line (At Slot: SLOT#01 CONNER 19-18-1CDH (350FWL & 1795FWL, SEC.19))					5155ft	
Mean Sea Level to Mud line (At Slot: SLOT#01 CONNER 19-18-1CDH (350FWL & 1795FWL, SEC.19))					0ft	
RIG (5142'GL + 13'XB) (RKB) to Mean Sea Level					5155ft	

Well Profile Data

Design Comment	MD (ft)	Inc (°)	Az (°)	TVD (ft)	Local N (ft)	Local E (ft)	DLS (°/100ft)	VS (ft)
Tie On	13.00	0.000	249.094	13.00	0.00	0.00	0.00	0.00
End of Tangent	800.00	0.000	249.094	800.00	0.00	0.00	0.00	0.00
End of Build	1413.32	12.266	249.094	1408.65	-23.34	-61.10	2.00	-15.03
End of Tangent	7192.39	12.266	249.094	7055.78	-461.46	-1208.08	0.00	-297.11
End of 3D Arc	8136.02	90.000	0.075	7660.00	110.00	-1330.00	10.00	285.46
End of Tangent	17868.37	90.000	0.075	7660.00	9842.34	-1317.32	0.00	9930.11

Survey Program

Start MD (ft)	End MD (ft)	Tool	Model	Log Name/Comment	Wellbore
13.00	700.00	BHI NavTrak	Custom BHI NavTrak (Standard Rotating+Axial Corr) (Rockies 0.03Gi model)		CONNER 19-18-1CDH PWB
700.00	17866.37	BHI AutoTrak Curve	Custom BHI AutoTrak Curve (Axial Corr, Short spacing) (Rockies 0.03Gi model)		CONNER 19-18-1CDH PWB

Hole and Casing Sections

Name	Start MD (ft)	End MD (ft)	Interval (ft)	Start TVD (ft)	End TVD (ft)	Start Local N (ft)	Start Local E (ft)	End Local N (ft)	End Local E (ft)	Wellbore
9.625in Casing Surface	13.00	700.00	687.00	73.00	N/A	0.00	0.00	0.00	0.00	CONNER 19-18-1CDH PWB
8.5in Open Hole	70.00	17668.37	17168.37	700.00	N/A	0.00	0.00	N/A	N/A	CONNER 19-18-1CDH PWB



BGGM (1900.0 to 2019.0) Dip: 66.52° Field: 52170.6 nT
Magnetic North is 8.32 degrees East of True North (at 7/17/2017)

To correct azimuth from Magnetic to True add 8.32 degrees

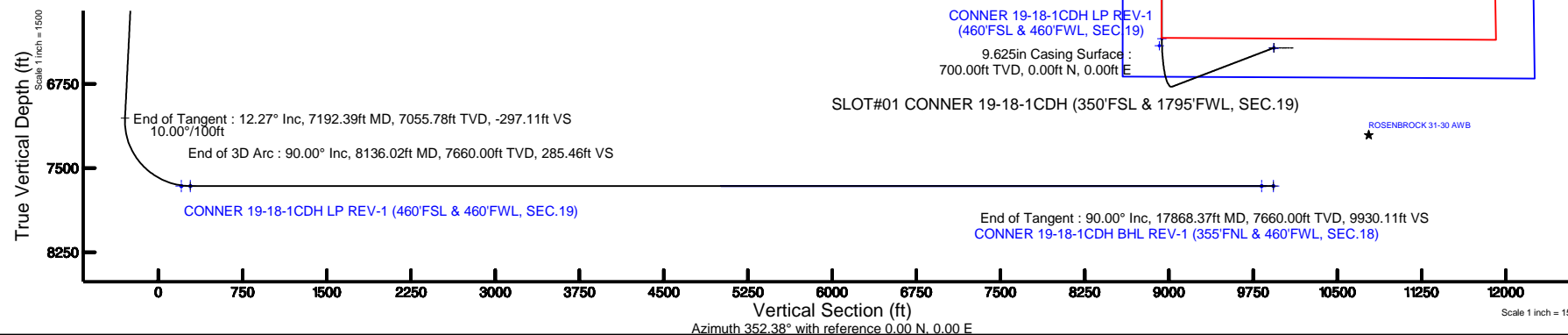



Planned Wellpath Report

CONNER 19-18-1CDH PWP (REV-A.0)

Page 1 of 10



REFERENCE WELLPATH IDENTIFICATION

Operator	PETROSHARE	Slot	SLOT#01 CONNER 19-18-1CDH (350'FSL & 1795'FWL, SEC.19)
Area	COLORADO	Well	CONNER 19-18-1CDH
Field	ADAMS COUNTY (NAD83/ TRUE NORTH)	Wellbore	CONNER 19-18-1CDH PWB
Facility	SEC.19-T01S-R65W		

REPORT SETUP INFORMATION

Projection System	NAD83 / Lambert Colorado SP, Northern Zone (501), US feet	Software System	WellArchitect® 5.1
North Reference	True	User	Ingmjmr
Scale	0.999971	Report Generated	7/27/2017 at 3:57:43 PM
Convergence at slot	0.51° East	Database/Source file	WA_DEN_Denver_Defn/CONNER_19-18-1CDH_PWP_REV-A.0_.xml

WELLPATH LOCATION

	Local coordinates		Grid coordinates		Geographic coordinates	
	North[ft]	East[ft]	Easting[US ft]	Northing[US ft]	Latitude	Longitude
Slot Location	0.00	0.00	3222009.38	1223555.33	39°56'39.552"N	104°42'29.448"W
Facility Reference Pt			3222009.38	1223555.33	39°56'39.552"N	104°42'29.448"W
Field Reference Pt			3175478.75	1240632.48	39°59'31.992"N	104°52'25.320"W

WELLPATH DATUM

Calculation method	Minimum curvature	RIG (5142'GL + 13'KB) (RKB) to Facility Vertical Datum	5155.00ft
Horizontal Reference Pt	Slot	RIG (5142'GL + 13'KB) (RKB) to Mean Sea Level	5155.00ft
Vertical Reference Pt	RIG (5142'GL + 13'KB) (RKB)	RIG (5142'GL + 13'KB) (RKB) to Mud Line at Slot (SLOT#01 CONNER 19-18-1CDH (350'FSL & 1795'FWL, SEC.19))	5155.00ft
MD Reference Pt	RIG (5142'GL + 13'KB) (RKB)	Section Origin	N 0.00, E 0.00 ft
Field Vertical Reference	Mean Sea Level	Section Azimuth	352.38°



Planned Wellpath Report

CONNER 19-18-1CDH PWP (REV-A.0)

Page 2 of 10



REFERENCE WELLPATH IDENTIFICATION

Operator	PETROSHARE	Slot	SLOT#01 CONNER 19-18-1CDH (350'FSL & 1795'FWL, SEC.19)
Area	COLORADO	Well	CONNER 19-18-1CDH
Field	ADAMS COUNTY (NAD83/ TRUE NORTH)	Wellbore	CONNER 19-18-1CDH PWB
Facility	SEC.19-T01S-R65W		

WELLPATH DATA (195 stations) † = interpolated/extrapolated station

MD [ft]	Inclination [°]	Azimuth [°]	TVD [ft]	Vert Sect [ft]	North [ft]	East [ft]	Latitude	Longitude	DLS [°/100ft]	Comments
0.00†	0.000	249.094	0.00	0.00	0.00	0.00	39°56'39.552"N	104°42'29.448"W	0.00	
13.00	0.000	249.094	13.00	0.00	0.00	0.00	39°56'39.552"N	104°42'29.448"W	0.00	Tie On
113.00†	0.000	249.094	113.00	0.00	0.00	0.00	39°56'39.552"N	104°42'29.448"W	0.00	
213.00†	0.000	249.094	213.00	0.00	0.00	0.00	39°56'39.552"N	104°42'29.448"W	0.00	
313.00†	0.000	249.094	313.00	0.00	0.00	0.00	39°56'39.552"N	104°42'29.448"W	0.00	
413.00†	0.000	249.094	413.00	0.00	0.00	0.00	39°56'39.552"N	104°42'29.448"W	0.00	
513.00†	0.000	249.094	513.00	0.00	0.00	0.00	39°56'39.552"N	104°42'29.448"W	0.00	
613.00†	0.000	249.094	613.00	0.00	0.00	0.00	39°56'39.552"N	104°42'29.448"W	0.00	
700.00†	0.000	249.094	700.00	0.00	0.00	0.00	39°56'39.552"N	104°42'29.448"W	0.00	FOX HILLS
713.00†	0.000	249.094	713.00	0.00	0.00	0.00	39°56'39.552"N	104°42'29.448"W	0.00	
800.00	0.000	249.094	800.00	0.00	0.00	0.00	39°56'39.552"N	104°42'29.448"W	0.00	End of Tangent
813.00†	0.260	249.094	813.00	-0.01	-0.01	-0.03	39°56'39.552"N	104°42'29.448"W	2.00	
913.00†	2.260	249.094	912.97	-0.51	-0.80	-2.08	39°56'39.544"N	104°42'29.475"W	2.00	
1013.00†	4.260	249.094	1012.80	-1.82	-2.82	-7.39	39°56'39.524"N	104°42'29.543"W	2.00	
1113.00†	6.260	249.094	1112.38	-3.92	-6.10	-15.96	39°56'39.492"N	104°42'29.653"W	2.00	
1213.00†	8.260	249.094	1211.57	-6.83	-10.60	-27.76	39°56'39.447"N	104°42'29.804"W	2.00	
1313.00†	10.260	249.094	1310.26	-10.52	-16.35	-42.79	39°56'39.390"N	104°42'29.997"W	2.00	
1413.00†	12.260	249.094	1408.33	-15.01	-23.31	-61.03	39°56'39.322"N	104°42'30.232"W	2.00	
1413.32	12.266	249.094	1408.65	-15.03	-23.34	-61.10	39°56'39.321"N	104°42'30.232"W	2.00	End of Build
1513.00†	12.266	249.094	1506.05	-19.89	-30.89	-80.88	39°56'39.247"N	104°42'30.486"W	0.00	
1613.00†	12.266	249.094	1603.77	-24.77	-38.48	-100.73	39°56'39.172"N	104°42'30.741"W	0.00	
1713.00†	12.266	249.094	1701.48	-29.65	-46.06	-120.57	39°56'39.097"N	104°42'30.996"W	0.00	
1813.00†	12.266	249.094	1799.20	-34.54	-53.64	-140.42	39°56'39.022"N	104°42'31.251"W	0.00	
1913.00†	12.266	249.094	1896.92	-39.42	-61.22	-160.27	39°56'38.947"N	104°42'31.506"W	0.00	
2013.00†	12.266	249.094	1994.63	-44.30	-68.80	-180.12	39°56'38.872"N	104°42'31.761"W	0.00	
2113.00†	12.266	249.094	2092.35	-49.18	-76.38	-199.96	39°56'38.797"N	104°42'32.015"W	0.00	
2213.00†	12.266	249.094	2190.07	-54.06	-83.96	-219.81	39°56'38.722"N	104°42'32.270"W	0.00	
2313.00†	12.266	249.094	2287.79	-58.94	-91.54	-239.66	39°56'38.647"N	104°42'32.525"W	0.00	
2413.00†	12.266	249.094	2385.50	-63.82	-99.12	-259.51	39°56'38.572"N	104°42'32.780"W	0.00	
2513.00†	12.266	249.094	2483.22	-68.70	-106.71	-279.35	39°56'38.497"N	104°42'33.035"W	0.00	



Planned Wellpath Report

CONNER 19-18-1CDH PWP (REV-A.0)

Page 3 of 10



REFERENCE WELLPATH IDENTIFICATION

Operator	PETROSHARE	Slot	SLOT#01 CONNER 19-18-1CDH (350'FSL & 1795'FWL, SEC.19)
Area	COLORADO	Well	CONNER 19-18-1CDH
Field	ADAMS COUNTY (NAD83/ TRUE NORTH)	Wellbore	CONNER 19-18-1CDH PWB
Facility	SEC.19-T01S-R65W		

WELLPATH DATA (195 stations) † = interpolated/extrapolated station

MD [ft]	Inclination [°]	Azimuth [°]	TVD [ft]	Vert Sect [ft]	North [ft]	East [ft]	Latitude	Longitude	DLS [°/100ft]	Comments
2613.00†	12.266	249.094	2580.94	-73.59	-114.29	-299.20	39°56'38.423"N	104°42'33.289"W	0.00	
2713.00†	12.266	249.094	2678.65	-78.47	-121.87	-319.05	39°56'38.348"N	104°42'33.544"W	0.00	
2813.00†	12.266	249.094	2776.37	-83.35	-129.45	-338.89	39°56'38.273"N	104°42'33.799"W	0.00	
2913.00†	12.266	249.094	2874.09	-88.23	-137.03	-358.74	39°56'38.198"N	104°42'34.054"W	0.00	
3013.00†	12.266	249.094	2971.80	-93.11	-144.61	-378.59	39°56'38.123"N	104°42'34.309"W	0.00	
3113.00†	12.266	249.094	3069.52	-97.99	-152.19	-398.44	39°56'38.048"N	104°42'34.564"W	0.00	
3213.00†	12.266	249.094	3167.24	-102.87	-159.77	-418.28	39°56'37.973"N	104°42'34.818"W	0.00	
3313.00†	12.266	249.094	3264.96	-107.75	-167.35	-438.13	39°56'37.898"N	104°42'35.073"W	0.00	
3413.00†	12.266	249.094	3362.67	-112.63	-174.94	-457.98	39°56'37.823"N	104°42'35.328"W	0.00	
3513.00†	12.266	249.094	3460.39	-117.52	-182.52	-477.83	39°56'37.748"N	104°42'35.583"W	0.00	
3613.00†	12.266	249.094	3558.11	-122.40	-190.10	-497.67	39°56'37.673"N	104°42'35.838"W	0.00	
3713.00†	12.266	249.094	3655.82	-127.28	-197.68	-517.52	39°56'37.598"N	104°42'36.092"W	0.00	
3813.00†	12.266	249.094	3753.54	-132.16	-205.26	-537.37	39°56'37.523"N	104°42'36.347"W	0.00	
3913.00†	12.266	249.094	3851.26	-137.04	-212.84	-557.21	39°56'37.449"N	104°42'36.602"W	0.00	
4013.00†	12.266	249.094	3948.98	-141.92	-220.42	-577.06	39°56'37.374"N	104°42'36.857"W	0.00	
4113.00†	12.266	249.094	4046.69	-146.80	-228.00	-596.91	39°56'37.299"N	104°42'37.112"W	0.00	
4213.00†	12.266	249.094	4144.41	-151.68	-235.59	-616.76	39°56'37.224"N	104°42'37.367"W	0.00	
4313.00†	12.266	249.094	4242.13	-156.57	-243.17	-636.60	39°56'37.149"N	104°42'37.621"W	0.00	
4413.00†	12.266	249.094	4339.84	-161.45	-250.75	-656.45	39°56'37.074"N	104°42'37.876"W	0.00	
4513.00†	12.266	249.094	4437.56	-166.33	-258.33	-676.30	39°56'36.999"N	104°42'38.131"W	0.00	
4613.00†	12.266	249.094	4535.28	-171.21	-265.91	-696.14	39°56'36.924"N	104°42'38.386"W	0.00	
4713.00†	12.266	249.094	4632.99	-176.09	-273.49	-715.99	39°56'36.849"N	104°42'38.641"W	0.00	
4813.00†	12.266	249.094	4730.71	-180.97	-281.07	-735.84	39°56'36.774"N	104°42'38.895"W	0.00	
4913.00†	12.266	249.094	4828.43	-185.85	-288.65	-755.69	39°56'36.699"N	104°42'39.150"W	0.00	
4945.31†	12.266	249.094	4860.00	-187.43	-291.10	-762.10	39°56'36.675"N	104°42'39.233"W	0.00	SUSSEX/SHANNON
5013.00†	12.266	249.094	4926.15	-190.73	-296.23	-775.53	39°56'36.624"N	104°42'39.405"W	0.00	
5113.00†	12.266	249.094	5023.86	-195.62	-303.82	-795.38	39°56'36.549"N	104°42'39.660"W	0.00	
5213.00†	12.266	249.094	5121.58	-200.50	-311.40	-815.23	39°56'36.475"N	104°42'39.915"W	0.00	
5313.00†	12.266	249.094	5219.30	-205.38	-318.98	-835.08	39°56'36.400"N	104°42'40.170"W	0.00	
5413.00†	12.266	249.094	5317.01	-210.26	-326.56	-854.92	39°56'36.325"N	104°42'40.424"W	0.00	



Planned Wellpath Report

CONNER 19-18-1CDH PWP (REV-A.0)

Page 4 of 10



REFERENCE WELLPATH IDENTIFICATION

Operator	PETROSHARE	Slot	SLOT#01 CONNER 19-18-1CDH (350'FSL & 1795'FWL, SEC.19)
Area	COLORADO	Well	CONNER 19-18-1CDH
Field	ADAMS COUNTY (NAD83/ TRUE NORTH)	Wellbore	CONNER 19-18-1CDH PWB
Facility	SEC.19-T01S-R65W		

WELLPATH DATA (195 stations) † = interpolated/extrapolated station

MD [ft]	Inclination [°]	Azimuth [°]	TVD [ft]	Vert Sect [ft]	North [ft]	East [ft]	Latitude	Longitude	DLS [°/100ft]	Comments
5513.00†	12.266	249.094	5414.73	-215.14	-334.14	-874.77	39°56'36.250"N	104°42'40.679"W	0.00	
5613.00†	12.266	249.094	5512.45	-220.02	-341.72	-894.62	39°56'36.175"N	104°42'40.934"W	0.00	
5713.00†	12.266	249.094	5610.16	-224.90	-349.30	-914.46	39°56'36.100"N	104°42'41.189"W	0.00	
5813.00†	12.266	249.094	5707.88	-229.78	-356.88	-934.31	39°56'36.025"N	104°42'41.444"W	0.00	
5913.00†	12.266	249.094	5805.60	-234.67	-364.46	-954.16	39°56'35.950"N	104°42'41.698"W	0.00	
6013.00†	12.266	249.094	5903.32	-239.55	-372.05	-974.01	39°56'35.875"N	104°42'41.953"W	0.00	
6113.00†	12.266	249.094	6001.03	-244.43	-379.63	-993.85	39°56'35.800"N	104°42'42.208"W	0.00	
6213.00†	12.266	249.094	6098.75	-249.31	-387.21	-1013.70	39°56'35.725"N	104°42'42.463"W	0.00	
6313.00†	12.266	249.094	6196.47	-254.19	-394.79	-1033.55	39°56'35.650"N	104°42'42.718"W	0.00	
6413.00†	12.266	249.094	6294.18	-259.07	-402.37	-1053.40	39°56'35.575"N	104°42'42.973"W	0.00	
6513.00†	12.266	249.094	6391.90	-263.95	-409.95	-1073.24	39°56'35.500"N	104°42'43.227"W	0.00	
6613.00†	12.266	249.094	6489.62	-268.83	-417.53	-1093.09	39°56'35.426"N	104°42'43.482"W	0.00	
6713.00†	12.266	249.094	6587.33	-273.71	-425.11	-1112.94	39°56'35.351"N	104°42'43.737"W	0.00	
6813.00†	12.266	249.094	6685.05	-278.60	-432.69	-1132.78	39°56'35.276"N	104°42'43.992"W	0.00	
6913.00†	12.266	249.094	6782.77	-283.48	-440.28	-1152.63	39°56'35.201"N	104°42'44.247"W	0.00	
7013.00†	12.266	249.094	6880.49	-288.36	-447.86	-1172.48	39°56'35.126"N	104°42'44.501"W	0.00	
7113.00†	12.266	249.094	6978.20	-293.24	-455.44	-1192.33	39°56'35.051"N	104°42'44.756"W	0.00	
7192.39	12.266	249.094	7055.78	-297.11	-461.46	-1208.08	39°56'34.991"N	104°42'44.959"W	0.00	End of Tangent
7213.00†	11.701	258.652	7075.94	-297.75	-462.65	-1212.18	39°56'34.980"N	104°42'45.011"W	10.00	
7313.00†	13.790	304.268	7173.71	-290.44	-457.92	-1232.02	39°56'35.026"N	104°42'45.266"W	10.00	
7404.25†	20.270	326.729	7261.00	-268.88	-438.54	-1249.71	39°56'35.218"N	104°42'45.493"W	10.00	NIOBRARA A CHALK
7413.00†	20.992	328.133	7269.19	-266.08	-435.94	-1251.37	39°56'35.244"N	104°42'45.514"W	10.00	
7428.93†	22.334	330.461	7284.00	-260.67	-430.89	-1254.37	39°56'35.293"N	104°42'45.553"W	10.00	NIOBRARA A MARL
7513.00†	29.806	339.319	7359.49	-225.44	-397.38	-1269.65	39°56'35.625"N	104°42'45.749"W	10.00	
7604.21†	38.323	345.192	7435.00	-175.19	-348.73	-1284.92	39°56'36.105"N	104°42'45.945"W	10.00	NIOBRARA B CHALK
7613.00†	39.156	345.638	7441.86	-169.73	-343.41	-1286.31	39°56'36.158"N	104°42'45.963"W	10.00	
7648.90†	42.576	347.309	7469.00	-146.37	-320.57	-1291.79	39°56'36.384"N	104°42'46.033"W	10.00	NIOBRARA B MARL
7713.00†	48.732	349.813	7513.79	-100.66	-275.66	-1300.82	39°56'36.827"N	104°42'46.149"W	10.00	
7714.84†	48.909	349.877	7515.00	-99.28	-274.30	-1301.06	39°56'36.841"N	104°42'46.152"W	10.00	NIOBRARA C CHALK
7756.07†	52.895	351.241	7541.00	-67.30	-242.74	-1306.30	39°56'37.153"N	104°42'46.220"W	10.00	NIOBRARA C MARL



Planned Wellpath Report

CONNER 19-18-1CDH PWP (REV-A.0)

Page 5 of 10



REFERENCE WELLPATH IDENTIFICATION			
Operator	PETROSHARE	Slot	SLOT#01 CONNER 19-18-1CDH (350'FSL & 1795'FWL, SEC.19)
Area	COLORADO	Well	CONNER 19-18-1CDH
Field	ADAMS COUNTY (NAD83/ TRUE NORTH)	Wellbore	CONNER 19-18-1CDH PWB
Facility	SEC.19-T01S-R65W		

WELLPATH DATA (195 stations) † = interpolated/extrapolated station										
MD [ft]	Inclination [°]	Azimuth [°]	TVD [ft]	Vert Sect [ft]	North [ft]	East [ft]	Latitude	Longitude	DLS [°/100ft]	Comments
7813.00†	58.419	352.906	7573.10	-20.32	-196.20	-1312.76	39°56'37.613"N	104°42'46.303"W	10.00	
7913.00†	68.167	355.409	7618.00	68.85	-107.44	-1321.76	39°56'38.490"N	104°42'46.418"W	10.00	
8013.00†	77.948	357.590	7647.11	164.14	-12.08	-1327.54	39°56'39.432"N	104°42'46.493"W	10.00	
8017.35†	78.374	357.681	7648.00	168.38	-7.82	-1327.72	39°56'39.474"N	104°42'46.495"W	10.00	FORT HAYS
8113.00†	87.744	359.616	7659.55	262.65	86.99	-1329.94	39°56'40.411"N	104°42'46.523"W	10.00	
8136.02	90.000	0.075	7660.00†	285.46	110.00	-1330.00	39°56'40.639"N	104°42'46.524"W	10.00	End of 3D Arc
8213.00†	90.000	0.075	7660.00	361.75	186.98	-1329.90	39°56'41.399"N	104°42'46.523"W	0.00	
8313.00†	90.000	0.075	7660.00	460.85	286.98	-1329.77	39°56'42.388"N	104°42'46.521"W	0.00	
8413.00†	90.000	0.075	7660.00	559.95	386.98	-1329.64	39°56'43.376"N	104°42'46.520"W	0.00	
8513.00†	90.000	0.075	7660.00	659.05	486.98	-1329.51	39°56'44.364"N	104°42'46.518"W	0.00	
8613.00†	90.000	0.075	7660.00	758.15	586.98	-1329.38	39°56'45.352"N	104°42'46.517"W	0.00	
8713.00†	90.000	0.075	7660.00	857.25	686.98	-1329.25	39°56'46.341"N	104°42'46.515"W	0.00	
8813.00†	90.000	0.075	7660.00	956.34	786.98	-1329.12	39°56'47.329"N	104°42'46.513"W	0.00	
8913.00†	90.000	0.075	7660.00	1055.44	886.98	-1328.99	39°56'48.317"N	104°42'46.512"W	0.00	
9013.00†	90.000	0.075	7660.00	1154.54	986.98	-1328.86	39°56'49.305"N	104°42'46.510"W	0.00	
9113.00†	90.000	0.075	7660.00	1253.64	1086.98	-1328.73	39°56'50.294"N	104°42'46.509"W	0.00	
9213.00†	90.000	0.075	7660.00	1352.74	1186.98	-1328.60	39°56'51.282"N	104°42'46.507"W	0.00	
9313.00†	90.000	0.075	7660.00	1451.84	1286.98	-1328.47	39°56'52.270"N	104°42'46.505"W	0.00	
9413.00†	90.000	0.075	7660.00	1550.94	1386.98	-1328.34	39°56'53.258"N	104°42'46.504"W	0.00	
9513.00†	90.000	0.075	7660.00	1650.04	1486.98	-1328.21	39°56'54.247"N	104°42'46.502"W	0.00	
9613.00†	90.000	0.075	7660.00	1749.13	1586.98	-1328.08	39°56'55.235"N	104°42'46.501"W	0.00	
9713.00†	90.000	0.075	7660.00	1848.23	1686.98	-1327.95	39°56'56.223"N	104°42'46.499"W	0.00	
9813.00†	90.000	0.075	7660.00	1947.33	1786.98	-1327.82	39°56'57.211"N	104°42'46.497"W	0.00	
9913.00†	90.000	0.075	7660.00	2046.43	1886.98	-1327.69	39°56'58.200"N	104°42'46.496"W	0.00	
10013.00†	90.000	0.075	7660.00	2145.53	1986.98	-1327.55	39°56'59.188"N	104°42'46.494"W	0.00	
10113.00†	90.000	0.075	7660.00	2244.63	2086.98	-1327.42	39°57'00.176"N	104°42'46.493"W	0.00	
10213.00†	90.000	0.075	7660.00	2343.73	2186.98	-1327.29	39°57'01.164"N	104°42'46.491"W	0.00	
10313.00†	90.000	0.075	7660.00	2442.83	2286.98	-1327.16	39°57'02.153"N	104°42'46.489"W	0.00	
10413.00†	90.000	0.075	7660.00	2541.93	2386.98	-1327.03	39°57'03.141"N	104°42'46.488"W	0.00	
10513.00†	90.000	0.075	7660.00	2641.02	2486.98	-1326.90	39°57'04.129"N	104°42'46.486"W	0.00	



Planned Wellpath Report

CONNER 19-18-1CDH PWP (REV-A.0)

Page 6 of 10



REFERENCE WELLPATH IDENTIFICATION

Operator	PETROSHARE	Slot	SLOT#01 CONNER 19-18-1CDH (350'FSL & 1795'FWL, SEC.19)
Area	COLORADO	Well	CONNER 19-18-1CDH
Field	ADAMS COUNTY (NAD83/ TRUE NORTH)	Wellbore	CONNER 19-18-1CDH PWB
Facility	SEC.19-T01S-R65W		

WELLPATH DATA (195 stations) † = interpolated/extrapolated station

MD [ft]	Inclination [°]	Azimuth [°]	TVD [ft]	Vert Sect [ft]	North [ft]	East [ft]	Latitude	Longitude	DLS [°/100ft]	Comments
10613.00†	90.000	0.075	7660.00	2740.12	2586.98	-1326.77	39°57'05.117"N	104°42'46.484"W	0.00	
10713.00†	90.000	0.075	7660.00	2839.22	2686.98	-1326.64	39°57'06.105"N	104°42'46.483"W	0.00	
10813.00†	90.000	0.075	7660.00	2938.32	2786.98	-1326.51	39°57'07.094"N	104°42'46.481"W	0.00	
10913.00†	90.000	0.075	7660.00	3037.42	2886.98	-1326.38	39°57'08.082"N	104°42'46.480"W	0.00	
11013.00†	90.000	0.075	7660.00	3136.52	2986.98	-1326.25	39°57'09.070"N	104°42'46.478"W	0.00	
11113.00†	90.000	0.075	7660.00	3235.62	3086.98	-1326.12	39°57'10.058"N	104°42'46.476"W	0.00	
11213.00†	90.000	0.075	7660.00	3334.72	3186.98	-1325.99	39°57'11.047"N	104°42'46.475"W	0.00	
11313.00†	90.000	0.075	7660.00	3433.81	3286.98	-1325.86	39°57'12.035"N	104°42'46.473"W	0.00	
11413.00†	90.000	0.075	7660.00	3532.91	3386.98	-1325.73	39°57'13.023"N	104°42'46.472"W	0.00	
11513.00†	90.000	0.075	7660.00	3632.01	3486.98	-1325.60	39°57'14.011"N	104°42'46.470"W	0.00	
11613.00†	90.000	0.075	7660.00	3731.11	3586.98	-1325.47	39°57'15.000"N	104°42'46.468"W	0.00	
11713.00†	90.000	0.075	7660.00	3830.21	3686.98	-1325.34	39°57'15.988"N	104°42'46.467"W	0.00	
11813.00†	90.000	0.075	7660.00	3929.31	3786.98	-1325.21	39°57'16.976"N	104°42'46.465"W	0.00	
11913.00†	90.000	0.075	7660.00	4028.41	3886.98	-1325.08	39°57'17.964"N	104°42'46.464"W	0.00	
12013.00†	90.000	0.075	7660.00	4127.51	3986.98	-1324.95	39°57'18.953"N	104°42'46.462"W	0.00	
12113.00†	90.000	0.075	7660.00	4226.60	4086.98	-1324.82	39°57'19.941"N	104°42'46.460"W	0.00	
12213.00†	90.000	0.075	7660.00	4325.70	4186.98	-1324.69	39°57'20.929"N	104°42'46.459"W	0.00	
12313.00†	90.000	0.075	7660.00	4424.80	4286.98	-1324.56	39°57'21.917"N	104°42'46.457"W	0.00	
12413.00†	90.000	0.075	7660.00	4523.90	4386.98	-1324.43	39°57'22.906"N	104°42'46.456"W	0.00	
12513.00†	90.000	0.075	7660.00	4623.00	4486.98	-1324.30	39°57'23.894"N	104°42'46.454"W	0.00	
12613.00†	90.000	0.075	7660.00	4722.10	4586.98	-1324.17	39°57'24.882"N	104°42'46.452"W	0.00	
12713.00†	90.000	0.075	7660.00	4821.20	4686.98	-1324.04	39°57'25.870"N	104°42'46.451"W	0.00	
12813.00†	90.000	0.075	7660.00	4920.30	4786.98	-1323.91	39°57'26.859"N	104°42'46.449"W	0.00	
12913.00†	90.000	0.075	7660.00	5019.40	4886.98	-1323.78	39°57'27.847"N	104°42'46.448"W	0.00	
13013.00†	90.000	0.075	7660.00	5118.49	4986.98	-1323.65	39°57'28.835"N	104°42'46.446"W	0.00	
13113.00†	90.000	0.075	7660.00	5217.59	5086.98	-1323.52	39°57'29.823"N	104°42'46.444"W	0.00	
13213.00†	90.000	0.075	7660.00	5316.69	5186.98	-1323.39	39°57'30.811"N	104°42'46.443"W	0.00	
13313.00†	90.000	0.075	7660.00	5415.79	5286.98	-1323.26	39°57'31.800"N	104°42'46.441"W	0.00	
13413.00†	90.000	0.075	7660.00	5514.89	5386.98	-1323.13	39°57'32.788"N	104°42'46.440"W	0.00	
13513.00†	90.000	0.075	7660.00	5613.99	5486.98	-1323.00	39°57'33.776"N	104°42'46.438"W	0.00	



Planned Wellpath Report

CONNER 19-18-1CDH PWP (REV-A.0)

Page 7 of 10

**BAKER
HUGHES**
a GE company



REFERENCE WELLPATH IDENTIFICATION

Operator	PETROSHARE	Slot	SLOT#01 CONNER 19-18-1CDH (350'FSL & 1795'FWL, SEC.19)
Area	COLORADO	Well	CONNER 19-18-1CDH
Field	ADAMS COUNTY (NAD83/ TRUE NORTH)	Wellbore	CONNER 19-18-1CDH PWB
Facility	SEC.19-T01S-R65W		

WELLPATH DATA (195 stations) † = interpolated/extrapolated station

MD [ft]	Inclination [°]	Azimuth [°]	TVD [ft]	Vert Sect [ft]	North [ft]	East [ft]	Latitude	Longitude	DLS [°/100ft]	Comments
13613.00†	90.000	0.075	7660.00	5713.09	5586.98	-1322.87	39°57'34.764"N	104°42'46.436"W	0.00	
13713.00†	90.000	0.075	7660.00	5812.19	5686.98	-1322.73	39°57'35.753"N	104°42'46.435"W	0.00	
13813.00†	90.000	0.075	7660.00	5911.28	5786.98	-1322.60	39°57'36.741"N	104°42'46.433"W	0.00	
13913.00†	90.000	0.075	7660.00	6010.38	5886.98	-1322.47	39°57'37.729"N	104°42'46.432"W	0.00	
14013.00†	90.000	0.075	7660.00	6109.48	5986.98	-1322.34	39°57'38.717"N	104°42'46.430"W	0.00	
14113.00†	90.000	0.075	7660.00	6208.58	6086.98	-1322.21	39°57'39.706"N	104°42'46.428"W	0.00	
14213.00†	90.000	0.075	7660.00	6307.68	6186.98	-1322.08	39°57'40.694"N	104°42'46.427"W	0.00	
14313.00†	90.000	0.075	7660.00	6406.78	6286.98	-1321.95	39°57'41.682"N	104°42'46.425"W	0.00	
14413.00†	90.000	0.075	7660.00	6505.88	6386.98	-1321.82	39°57'42.670"N	104°42'46.424"W	0.00	
14513.00†	90.000	0.075	7660.00	6604.98	6486.98	-1321.69	39°57'43.659"N	104°42'46.422"W	0.00	
14613.00†	90.000	0.075	7660.00	6704.07	6586.97	-1321.56	39°57'44.647"N	104°42'46.420"W	0.00	
14713.00†	90.000	0.075	7660.00	6803.17	6686.97	-1321.43	39°57'45.635"N	104°42'46.419"W	0.00	
14813.00†	90.000	0.075	7660.00	6902.27	6786.97	-1321.30	39°57'46.623"N	104°42'46.417"W	0.00	
14913.00†	90.000	0.075	7660.00	7001.37	6886.97	-1321.17	39°57'47.612"N	104°42'46.416"W	0.00	
15013.00†	90.000	0.075	7660.00	7100.47	6986.97	-1321.04	39°57'48.600"N	104°42'46.414"W	0.00	
15113.00†	90.000	0.075	7660.00	7199.57	7086.97	-1320.91	39°57'49.588"N	104°42'46.412"W	0.00	
15213.00†	90.000	0.075	7660.00	7298.67	7186.97	-1320.78	39°57'50.576"N	104°42'46.411"W	0.00	
15313.00†	90.000	0.075	7660.00	7397.77	7286.97	-1320.65	39°57'51.565"N	104°42'46.409"W	0.00	
15413.00†	90.000	0.075	7660.00	7496.87	7386.97	-1320.52	39°57'52.553"N	104°42'46.407"W	0.00	
15513.00†	90.000	0.075	7660.00	7595.96	7486.97	-1320.39	39°57'53.541"N	104°42'46.406"W	0.00	
15613.00†	90.000	0.075	7660.00	7695.06	7586.97	-1320.26	39°57'54.529"N	104°42'46.404"W	0.00	
15713.00†	90.000	0.075	7660.00	7794.16	7686.97	-1320.13	39°57'55.517"N	104°42'46.403"W	0.00	
15813.00†	90.000	0.075	7660.00	7893.26	7786.97	-1320.00	39°57'56.506"N	104°42'46.401"W	0.00	
15913.00†	90.000	0.075	7660.00	7992.36	7886.97	-1319.87	39°57'57.494"N	104°42'46.399"W	0.00	
16013.00†	90.000	0.075	7660.00	8091.46	7986.97	-1319.74	39°57'58.482"N	104°42'46.398"W	0.00	
16113.00†	90.000	0.075	7660.00	8190.56	8086.97	-1319.61	39°57'59.470"N	104°42'46.396"W	0.00	
16213.00†	90.000	0.075	7660.00	8289.66	8186.97	-1319.48	39°58'00.459"N	104°42'46.395"W	0.00	
16313.00†	90.000	0.075	7660.00	8388.75	8286.97	-1319.35	39°58'01.447"N	104°42'46.393"W	0.00	
16413.00†	90.000	0.075	7660.00	8487.85	8386.97	-1319.22	39°58'02.435"N	104°42'46.391"W	0.00	
16513.00†	90.000	0.075	7660.00	8586.95	8486.97	-1319.09	39°58'03.423"N	104°42'46.390"W	0.00	



Planned Wellpath Report

CONNER 19-18-1CDH PWP (REV-A.0)

Page 8 of 10



REFERENCE WELLPATH IDENTIFICATION

Operator	PETROSHARE	Slot	SLOT#01 CONNER 19-18-1CDH (350'FSL & 1795'FWL, SEC.19)
Area	COLORADO	Well	CONNER 19-18-1CDH
Field	ADAMS COUNTY (NAD83/ TRUE NORTH)	Wellbore	CONNER 19-18-1CDH PWB
Facility	SEC.19-T01S-R65W		

WELLPATH DATA (195 stations) † = interpolated/extrapolated station

MD [ft]	Inclination [°]	Azimuth [°]	TVD [ft]	Vert Sect [ft]	North [ft]	East [ft]	Latitude	Longitude	DLS [°/100ft]	Comments
16613.00†	90.000	0.075	7660.00	8686.05	8586.97	-1318.96	39°58'04.412"N	104°42'46.388"W	0.00	
16713.00†	90.000	0.075	7660.00	8785.15	8686.97	-1318.83	39°58'05.400"N	104°42'46.387"W	0.00	
16813.00†	90.000	0.075	7660.00	8884.25	8786.97	-1318.70	39°58'06.388"N	104°42'46.385"W	0.00	
16913.00†	90.000	0.075	7660.00	8983.35	8886.97	-1318.57	39°58'07.376"N	104°42'46.383"W	0.00	
17013.00†	90.000	0.075	7660.00	9082.45	8986.97	-1318.44	39°58'08.365"N	104°42'46.382"W	0.00	
17113.00†	90.000	0.075	7660.00	9181.54	9086.97	-1318.31	39°58'09.353"N	104°42'46.380"W	0.00	
17213.00†	90.000	0.075	7660.00	9280.64	9186.97	-1318.18	39°58'10.341"N	104°42'46.379"W	0.00	
17313.00†	90.000	0.075	7660.00	9379.74	9286.97	-1318.05	39°58'11.329"N	104°42'46.377"W	0.00	
17413.00†	90.000	0.075	7660.00	9478.84	9386.97	-1317.91	39°58'12.318"N	104°42'46.375"W	0.00	
17513.00†	90.000	0.075	7660.00	9577.94	9486.97	-1317.78	39°58'13.306"N	104°42'46.374"W	0.00	
17613.00†	90.000	0.075	7660.00	9677.04	9586.97	-1317.65	39°58'14.294"N	104°42'46.372"W	0.00	
17713.00†	90.000	0.075	7660.00	9776.14	9686.97	-1317.52	39°58'15.282"N	104°42'46.371"W	0.00	
17813.00†	90.000	0.075	7660.00	9875.24	9786.97	-1317.39	39°58'16.270"N	104°42'46.369"W	0.00	
17868.36†	90.000	0.075	7660.00	9930.10	9842.33	-1317.32	39°58'16.818"N	104°42'46.368"W	0.00	CODELL/LANDING ZONE
17868.37	90.000	0.075	7660.00 ²	9930.11	9842.34	-1317.32	39°58'16.818"N	104°42'46.368"W	0.00	End of Tangent

HOLE & CASING SECTIONS

- Ref Wellbore: CONNER 19-18-1CDH PWB Ref Wellpath: CONNER 19-18-1CDH PWP (REV-A.0)

String/Diameter	Start MD [ft]	End MD [ft]	Interval [ft]	Start TVD [ft]	End TVD [ft]	Start N/S [ft]	Start E/W [ft]	End N/S [ft]	End E/W [ft]
9.625in Casing Surface	13.00	700.00	687.00	13.00	700.00	0.00	0.00	0.00	0.00
8.5in Open Hole	700.00	17868.37	17168.37	700.00	N/A	0.00	0.00	N/A	N/A



Planned Wellpath Report

CONNER 19-18-1CDH PWP (REV-A.0)

Page 9 of 10



REFERENCE WELLPATH IDENTIFICATION

Operator	PETROSHARE	Slot	SLOT#01 CONNER 19-18-1CDH (350'FSL & 1795'FWL, SEC.19)
Area	COLORADO	Well	CONNER 19-18-1CDH
Field	ADAMS COUNTY (NAD83/ TRUE NORTH)	Wellbore	CONNER 19-18-1CDH PWB
Facility	SEC.19-T01S-R65W		

TARGETS

Name	MD [ft]	TVD [ft]	North [ft]	East [ft]	Grid East [US ft]	Grid North [US ft]	Latitude	Longitude	Shape
SEC.18-T01S-R65W		0.00	0.00	0.00	3222009.38	1223555.33	39°56'39.552"N	104°42'29.448"W	polygon
SEC.19-T01S-R65W		0.00	0.00	0.00	3222009.38	1223555.33	39°56'39.552"N	104°42'29.448"W	polygon
CONNER 19-18-1CDH BHL (460'FNL & 460'FWL, SEC.18)		7660.00	9737.34	-1317.32	3220605.21	1233280.22	39°58'15.780"N	104°42'46.368"W	point
2) CONNER 19-18-1CDH BHL REV-1 (355'FNL & 460'FWL, SEC.18)	17868.37	7660.00	9842.34	-1317.32	3220604.27	1233385.21	39°58'16.818"N	104°42'46.368"W	point
CONNER 19-18-1CDH LP (460'FSL & 460'FWL, SEC.19)		7660.00	25.54	-1359.89	3220649.35	1223568.73	39°56'39.804"N	104°42'46.908"W	point
1) CONNER 19-18-1CDH LP REV-1 (460'FSL & 460'FWL, SEC.19)	8136.02	7660.00	110.00	-1330.00	3220678.49	1223653.45	39°56'40.639"N	104°42'46.524"W	point
SEC.18-T01S-R65W (460' SETBACK)		7660.00	0.00	0.00	3222009.38	1223555.33	39°56'39.552"N	104°42'29.448"W	polygon
SEC.19-T01S-R65W (460' SETBACK)		7660.00	0.00	0.00	3222009.38	1223555.33	39°56'39.552"N	104°42'29.448"W	polygon

SURVEY PROGRAM -

Ref Wellbore: CONNER 19-18-1CDH PWB Ref Wellpath: CONNER 19-18-1CDH PWP (REV-A.0)

Start MD [ft]	End MD [ft]	Positional Uncertainty Model	Log Name/Comment	Wellbore
13.00	700.00	Custom BHI NaviTrak (Standard Rotating+Axial Corr) (Rockies 0.03Gt model)		CONNER 19-18-1CDH PWB
700.00	17868.37	Custom BHI AutoTrak Curve (Axial Corr, Short spacing) (Rockies 0.03Gt model)		CONNER 19-18-1CDH PWB



Planned Wellpath Report

CONNER 19-18-1CDH PWP (REV-A.0)

Page 10 of 10



REFERENCE WELLPATH IDENTIFICATION

Operator	PETROSHARE	Slot	SLOT#01 CONNER 19-18-1CDH (350'FSL & 1795'FWL, SEC.19)
Area	COLORADO	Well	CONNER 19-18-1CDH
Field	ADAMS COUNTY (NAD83/ TRUE NORTH)	Wellbore	CONNER 19-18-1CDH PWB
Facility	SEC.19-T01S-R65W		

WELLPATH COMMENTS

MD [ft]	Inclination [°]	Azimuth [°]	TVD [ft]	Comment
700.00	0.000	249.094	700.00	FOX HILLS
4945.31	12.266	249.094	4860.00	SUSSEX/SHANNON
7404.25	20.270	326.729	7261.00	NIOBRARA A CHALK
7428.93	22.334	330.461	7284.00	NIOBRARA A MARL
7604.21	38.323	345.192	7435.00	NIOBRARA B CHALK
7648.90	42.576	347.309	7469.00	NIOBRARA B MARL
7714.84	48.909	349.877	7515.00	NIOBRARA C CHALK
7756.07	52.895	351.241	7541.00	NIOBRARA C MARL
8017.35	78.374	357.681	7648.00	FORT HAYS
17868.36	90.000	0.075	7660.00	CODELL/LANDING ZONE

DESIGN COMMENTS

MD [ft]	Inclination [°]	Azimuth [°]	TVD [ft]	Comment
13.00	0.000	249.094	13.00	Tie On
800.00	0.000	249.094	800.00	End of Tangent
1413.32	12.266	249.094	1408.65	End of Build
7192.39	12.266	249.094	7055.78	End of Tangent
8136.02	90.000	0.075	7660.00	End of 3D Arc
17868.37	90.000	0.075	7660.00	End of Tangent