



Corporate Office
1775 Sherman Street, #3000
Denver, Colorado 80203
303.860.5800
www.pdce.com

June 1, 2017

State of Colorado, Oil & Gas Conservation Commission
Attn: Matt Lepore
1120 Lincoln Street, Suite 801
Denver, CO 80203

Re: **Letter to the Director, Rule 318A.e.**
Judy 6D-212
NESE Section 6, T4N-R64W
Weld County, Colorado

Dear Director:

PDC Energy ("PDC") hereby certifies to the Director that PDC holds all minerals in the proposed 400 acre wellbore spacing unit consisting of T4N-R64W Section 3: NWSW, Section 4: N2S2, Section 5: N2S2, Section 6: NESE; therefore, no 30-day notice is needed to owners in the proposed wellbore spacing unit. This horizontal well location crosses existing unit boundaries and requires the formation of the proposed unit. PDC hereby requests the Director to approve the well.

If you should have any questions or concerns regarding this permit, please contact the undersigned at (303) 318-6102 or Venessa.chase@pdce.com.

Sincerely,

A handwritten signature in blue ink that reads "Venessa Chase".



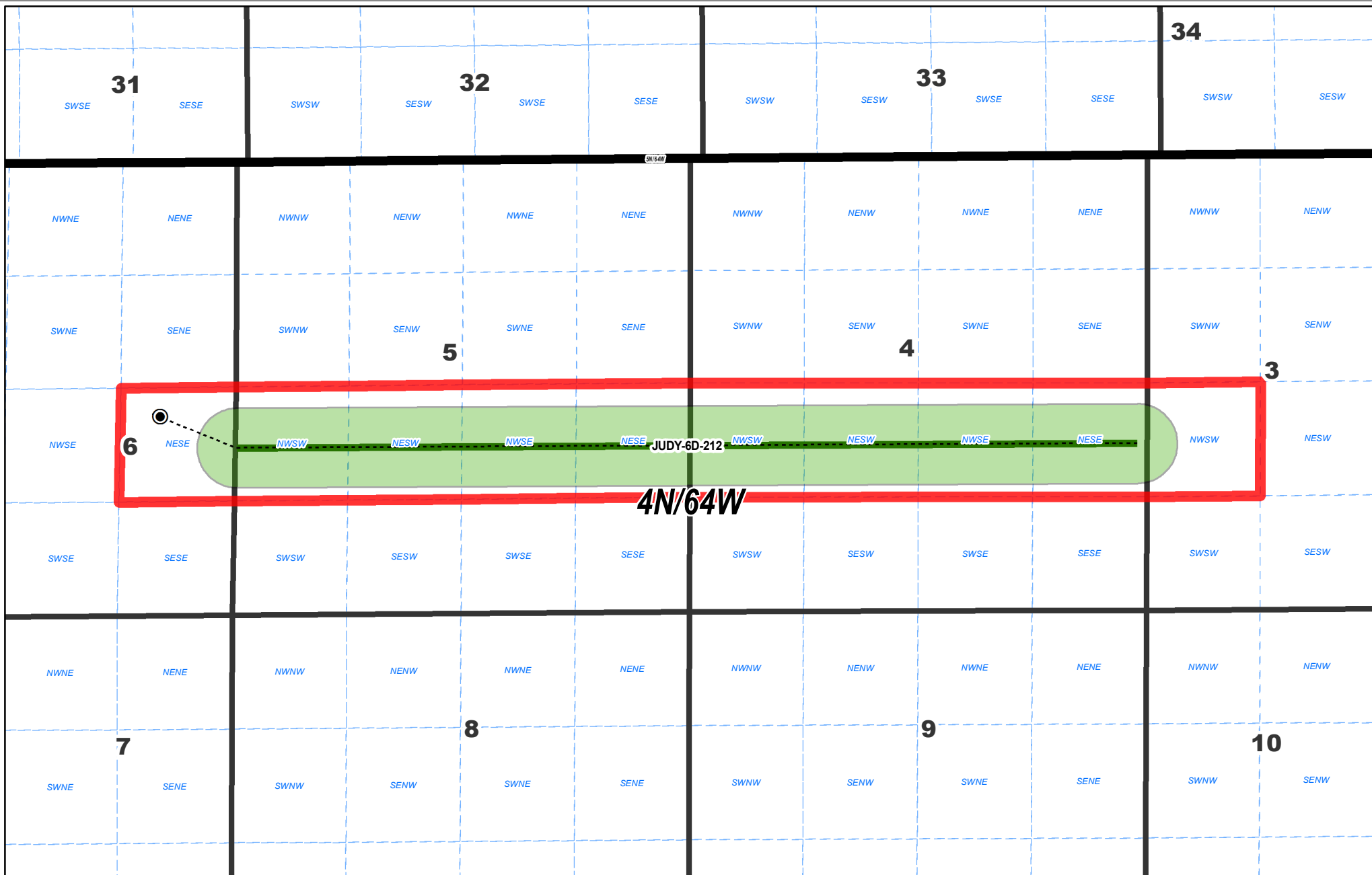

Venessa Chase
Permitting Supervisor - Wattenberg
PDC Energy, Inc.



**DJ Preliminary Proposed Spacing Unit
JUDY 6D-212**

Date: 5/1/2017

Legend

-  Townships
-  Sections
-  Qtr Qtr (Weld Cty)
-  Preliminary Proposed Spacing Unit
-  460' Foot Wellbore Buffer
-  Spaced Wellbore

Disclaimer:
PDC Energy, Inc. makes no representation or warranty regarding the accuracy or completeness of this map, which is being provided as a courtesy only. PDC Energy, Inc. expressly disclaims all liability and responsibility for any representation, warranty, statement or depiction in this map, whether express, statutory or implied, as to the content, character or nature of any information contained in this map, including, but not limited to, the leasehold acreage positions, well locations and statuses or any other information depicted. Any conclusions derived from this map are at the sole cost, risk and expense of the user.
© 2014 PDC Energy, Inc. All Rights Reserved.

