



July 14, 2017

Mr. Matthew Lepore, Director
Colorado Oil & Gas Conservation Commission
1120 Lincoln Street, Ste. 801
Denver, Colorado 80203

RE: Rule 318.A.e.
Trott 8E-10-1C
Trott 8E-10-3N
Trott 8E-10-5N

Surface Location: NESE, Section 7, Township 4 North, Range 68 West, Weld County, CO

Dear Mr. Lepore,

Extraction Oil and Gas is planning to drill the captioned horizontal wells in accordance with the provision of COGCC Rule 318A.e.

The proposed wellbore spacing unit consists of:

Sec. 8-4N-68W: N/2S/2 & S/2N/2

The spacing unit is a 320-acre wellbore spacing unit for the Niobrara and Codell formations.

Extraction Oil and Gas hereby certifies to the Director that all Owners within the proposed spacing unit above were notified and 30 days have passed without objection.

If you have any questions or issues regarding this permit, please contact Alyssa Andrews at (720) 481-2379.

Sincerely,

Alyssa Andrews
Regulatory Analyst
Extraction Oil & Gas, Inc.

TROTT 7-L PAD
PROPOSED 318A.a.(4)D. SPACING UNIT
SEC 8: N2S2, S2N2

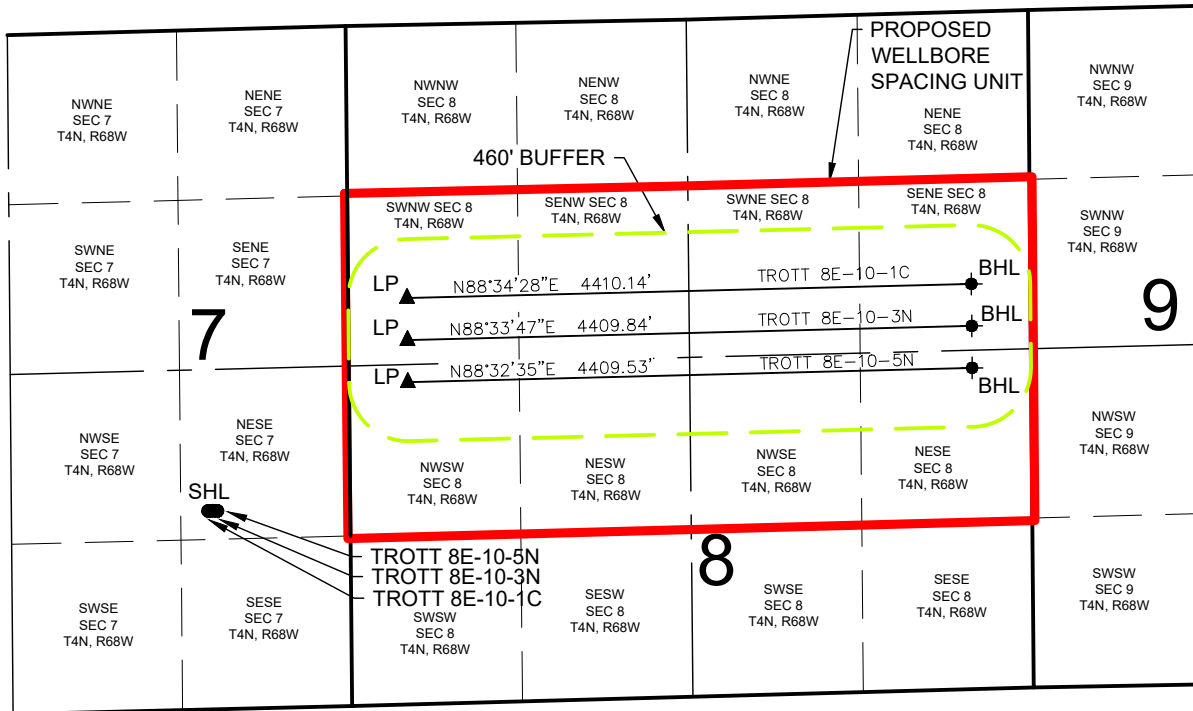

TROTT 8E-10-1C WELL TO BE LOCATED 1549' FSL AND 1038' FEL, SEC 7, T4N, R68W
TROTT 8E-10-3N WELL TO BE LOCATED 1550' FSL AND 1110' FEL, SEC 7, T4N, R68W
TROTT 8E-10-5N WELL TO BE LOCATED 1550' FSL AND 1074' FEL, SEC 7, T4N, R68W

LEGEND

● = PROPOSED WELL
 ● = BOTTOM HOLE
 ▲ = LANDING POINT

SHL = SURFACE HOLE LOCATION
 BHL = BOTTOM HOLE LOCATION
 LP = LANDING POINT

DISCLAIMER:
 THIS PLOT DOES NOT REPRESENT A MONUMENTED LAND SURVEY AND SHOULD NOT BE
 RELIED UPON TO DETERMINE BOUNDARY LINES, PROPERTY OWNERSHIP OR OTHER
 PROPERTY INTERESTS. PARCEL LINES, IF DEPICTED HAVE NOT BEEN FIELD VERIFIED AND
 MAY BE BASED UPON PUBLICLY AVAILABLE DATA THAT ALSO HAS NOT BEEN
 INDEPENDENTLY VERIFIED.

