



Holloway & Holloway, Inc.
P.O. Box 3331
Greeley, CO 80633
(303) 867-3715
(303) 352-5852

123-19740

R66W



99999999

N



Basis of Bearings: Bearings were determined based upon the West line of the SW $\frac{1}{4}$ as bearing North & South with all other bearings as being relative thereto.

W $\frac{1}{4}$ cor. CL highway N&S at CL road East

E $\frac{1}{4}$ cor. CL road E&W at line fence South

T 2 N

North 2649'

CL uprr

Gr. Elev. 4900' dryland farming (plowed)

102' 654' wellhead

2133'

2627'

N89°56'E 2654'

2610'

SW cor. CL Highway N&S at CL roads E&W

Basis of elev USC&GS B.M. 4882'

S $\frac{1}{4}$ cor. re-bar in roadway

SE cor. re-bar in roadway

Scale --- 1" = 1000'

In accordance with a request from Bataa Oil, Inc. the Undersigned has determined the location of the Succo 43-20 well

to be 2133' FSL & 654' FEL at right angles as co-ordinates

Section 20 Township 2N Range 66W of the 6th principal Meridian Weld County, Colorado.

I hereby certify, that this oil and/or gas well location certificate was prepared for Bataa Oil, Inc. that it is not a land survey plat or improvement survey plat, and that it is not to be relied upon for the establishment of fence, building or other future improvement lines

Date 1-21-99

Holloway & Holloway, Inc.
States of

Colorado



00083422

FOR 7.5

BY U.S. GEOLOGICAL SURVEY, DIVISION OF
FOLDER DISSEMINATING TOPOGRAPHIC MAPS AND SYMBOLS IN

3130
2080
3210

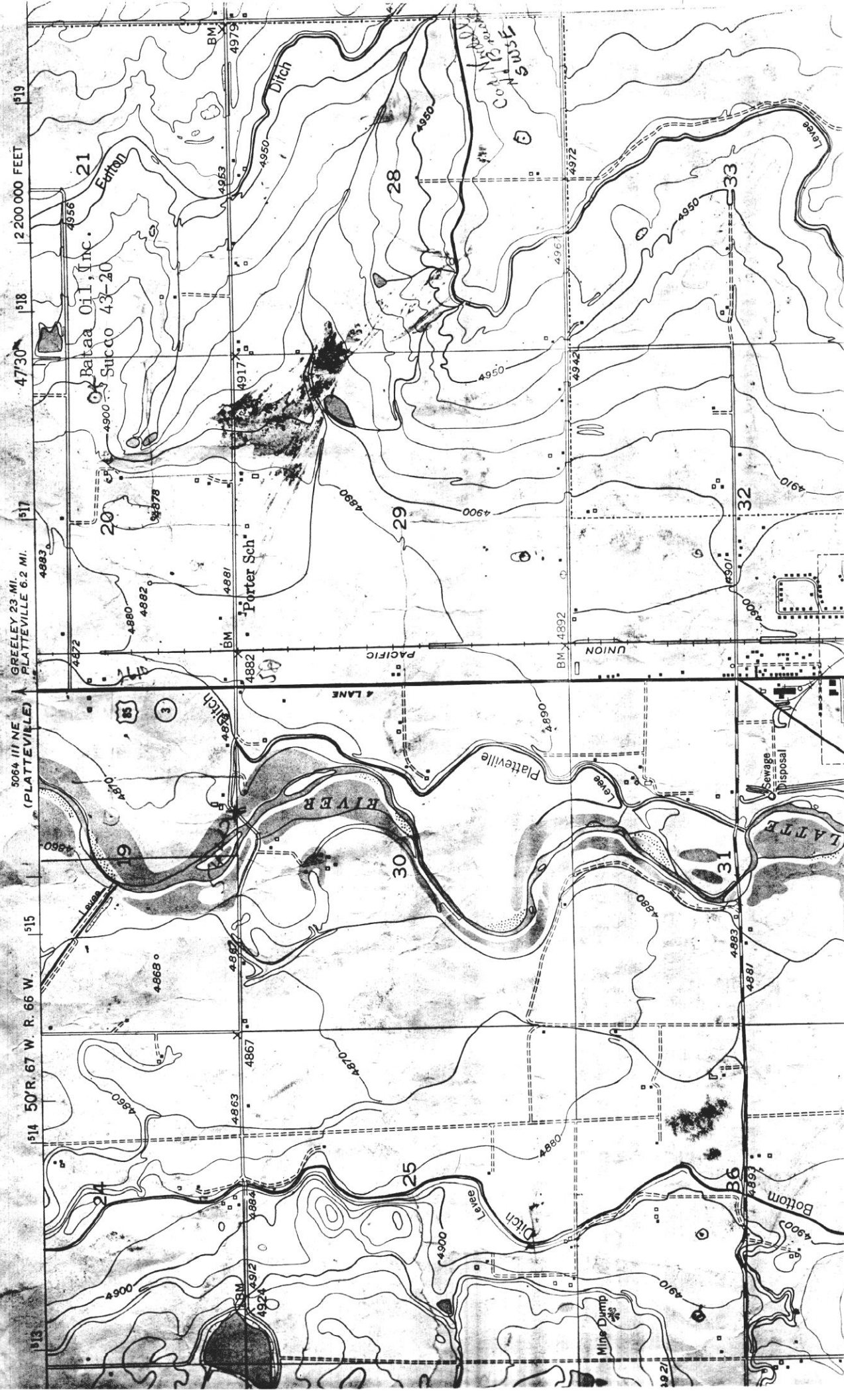

SHEET NO. 30
WELD COUNTY, COLORADO, SOUTHERN PART
(FORT LUPTON QUADRANGLE)

104°45'

R66w

Success 43-20

40°07'30"

