

# SILVERBACK 36-A PAD MULTI-WELL PLAN

SILVERBACK 25N-20-3N  
BHL: 600' FNL (STATE LINE)  
818' FNL (SEC 24)  
1100' FWL

SILVERBACK 2  
BHL: 600' FSL  
1320' FWL

SILVERBACK 1  
BHL: 300' FSL  
660' FWL

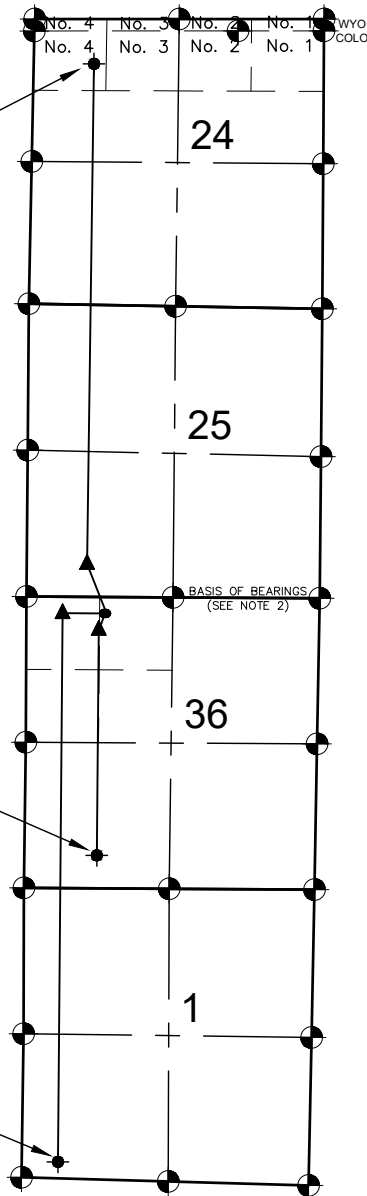
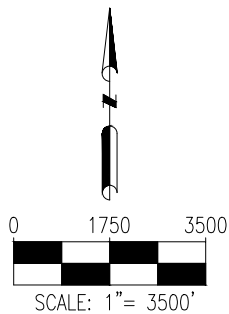

## LEGEND

- = EXISTING MONUMENT
- = CALCULATED POSITION
- = PROPOSED WELL
- ◆ = EXISTING WELL
- ▲ = LANDING POINT
- BHL = BOTTOM HOLE LOCATION

## NOTES:

1. THIS FIELD SURVEY CONFORMS TO THE MINIMUM STANDARDS SET BY THE C.O.G.C.C., RULE NO. 215
2. BEARINGS ARE BASED ON THE ASSUMPTION THAT THE NORTH LINE OF THE NORTHEAST QUARTER OF SECTION 36, BEARS S89°39'24"E BETWEEN THE MONUMENTS SHOWN HEREON.
3. ALL DISTANCES AND BEARINGS SHOWN HEREON ARE GROUND VALUES AS GPS MEASURED IN THE FIELD, WITH TIES TO WELLS MEASURED PERPENDICULAR TO SECTION LINES. THIS LOW DISTORTION PROJECTION (LDP) IS BASED ON THE NORTH AMERICAN DATUM OF 1983, U.S. SURVEY FOOT WITH A LATITUDE ORIGIN OF 41.002642°N, A CENTRAL MERIDIAN LONGITUDE OF 104.314670°W, AND A SCALE FACTOR ON THE CENTRAL MERIDIAN OF 1.00025 (EXACT). THE LDP BASIS OF BEARINGS IS GEODETIC NORTH.
4. FIELD VERIFICATION OF MONUMENTS COMPLETED WITHIN 1 YEAR OF SIGNATURE DATE.

## NOTES:

- SILVERBACK 1 TO BE AT 300' FNL & 1407' FWL.  
BOTTOM HOLE AT 300' FSL & 660' FWL, SEC. 1, T11N, R62W.
- SILVERBACK 2 TO BE AT 300' FNL & 1435' FWL.  
BOTTOM HOLE AT 600' FSL & 1320' FWL, SEC. 36.
- SILVERBACK 25N-20-3N TO BE AT 300' FNL & 1463' FWL.  
BOTTOM HOLE AT 600' FNL & 1100' FWL, WY STATE LINE.  
BOTTOM HOLE AT 818' FNL & 1100' FWL, SEC. 24.



FIELD DATE:  
09-30-15  
DRAWING DATE:  
07-20-17  
BY:  
IJM  
CHECKED:  
CSG

SITE NAME:  
SILVERBACK 36-A PAD  
SURFACE LOCATION:  
NE 1/4 NW 1/4 SEC. 36, T12N, R62W, 6TH P.M.  
WELD COUNTY, COLORADO

PREPARED FOR:

