



01818855

104°42'00" W

104°41'00" W

40°24'00" N

40°23'00" N

40°22'00" N

40°24'00" N

40°23'00" N

40°22'00" N

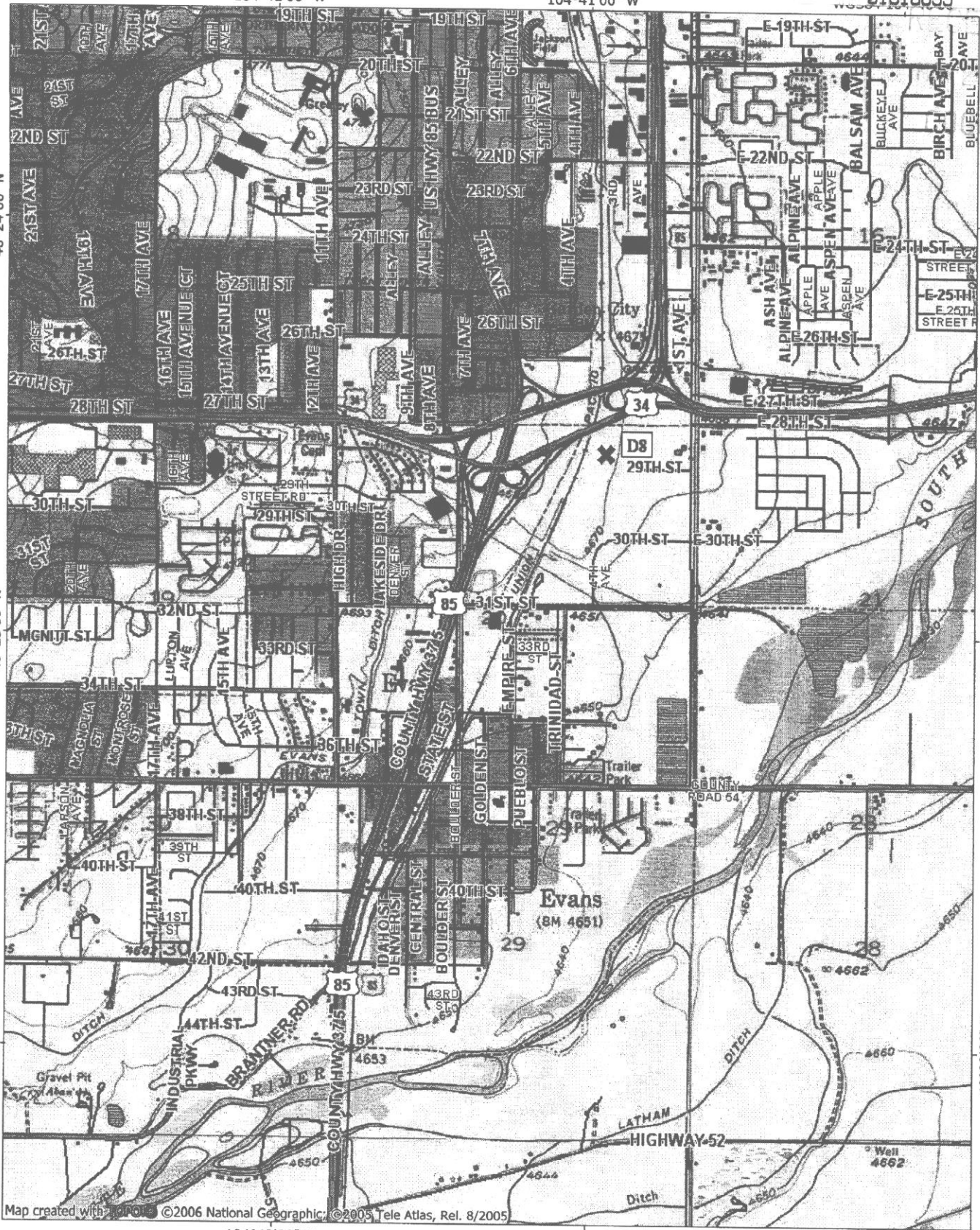

Map created with TOPO! ©2006 National Geographic, ©2005 Tele Atlas, Rel. 8/2005

104°42'00" W

104°41'00" W

WGS84 104°40'00" W

TN MN

9 1/2°

02/26/07

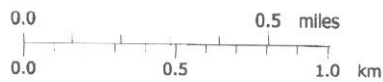

# EXHIBIT A

## GREELEY DIRECTIONAL PROJECT

RECEIVED



EXISTING WELL NAME	SURFACE LOCATION AND GEOGRAPHIC COORDINATES (NAD83) SECTION 20, TWP 5 NORTH, RNG 65 WEST		
A1 CLARK	40°23'29.03688"N	104°40'49.88462"W	165' FNL & 751' FEL
A2 DELTA PARK	40°23'28.79736"N	104°40'49.88462"W	190' FNL & 750' FEL
A3 PARKVIEW SOUTH	40°23'28.55713"N	104°40'49.84584"W	214' FNL & 749' FEL
A4 SMITH 5 SPOT	40°23'28.32128"N	104°40'49.84327"W	238' FNL & 748' FEL
A5 BUS BARN	40°23'28.08555"N	104°40'49.82893"W	262' FNL & 747' FEL
A6 SAM PAK	40°23'27.84424"N	104°40'49.82893"W	286' FNL & 746' FEL
B8 BMC	40°23'29.19453"N	104°40'52.11786"W	150' FNL & 924' FEL
B9 GREELEY INDUSTRIAL SOUTH	40°23'29.19944"N	104°40'51.79244"W	150' FNL & 899' FEL
B10 SHUPE 5 SPOT	40°23'30.21505"N	104°40'50.68047"W	149' FNL & 875' FEL
B11 HWY 85-2	40°23'30.22299"N	104°40'50.36346"W	148' FNL & 850' FEL
B12 HWY 85-1	40°23'29.22062"N	104°40'50.83161"W	147' FNL & 825' FEL
D2 CDOT-3	40°23'28.64400"N	104°40'55.16400"W	201' FNL & 1156' FEL
D7 CDOT 2	40°23'28.57200"N	104°40'55.81200"W	209' FNL & 1205' FEL
D8 EHRLIC MOTORS	40°23'28.57200"N	104°40'55.95600"W	211' FNL & 1215' FEL

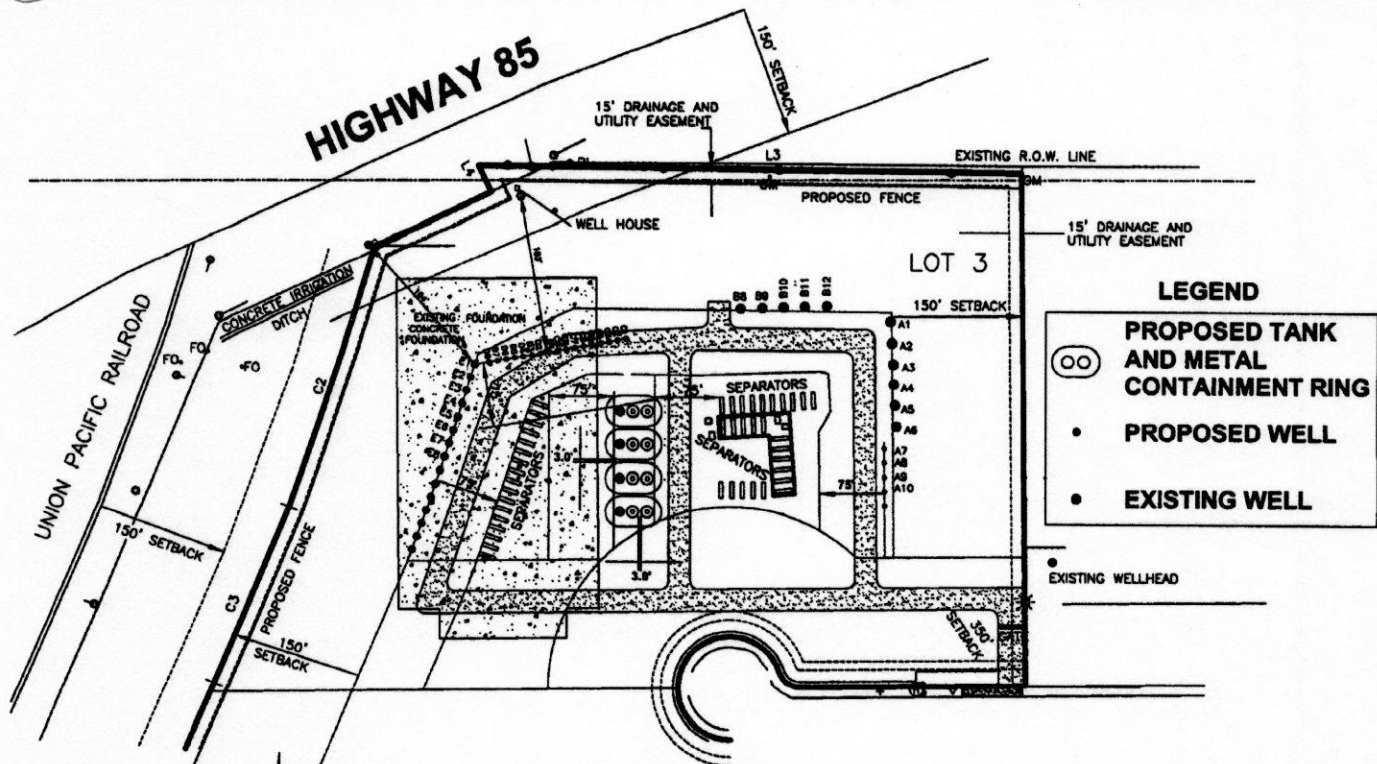

**NE1/4**  
**SECTION 20, T5N, R65W**



7800 MILLER DRIVE UNIT C  
FREDERICK, COLORADO 80504  
303-702-1617

David L. Swanson  
COLORADO P.L.S. #36070

**FIELD DATE: 06-01-06 WO# 501-06-470**  
**DATE OF COMPLETION: 06-02-06**

