

TROTT 8E-10-11N WELL LOCATION CERTIFICATE

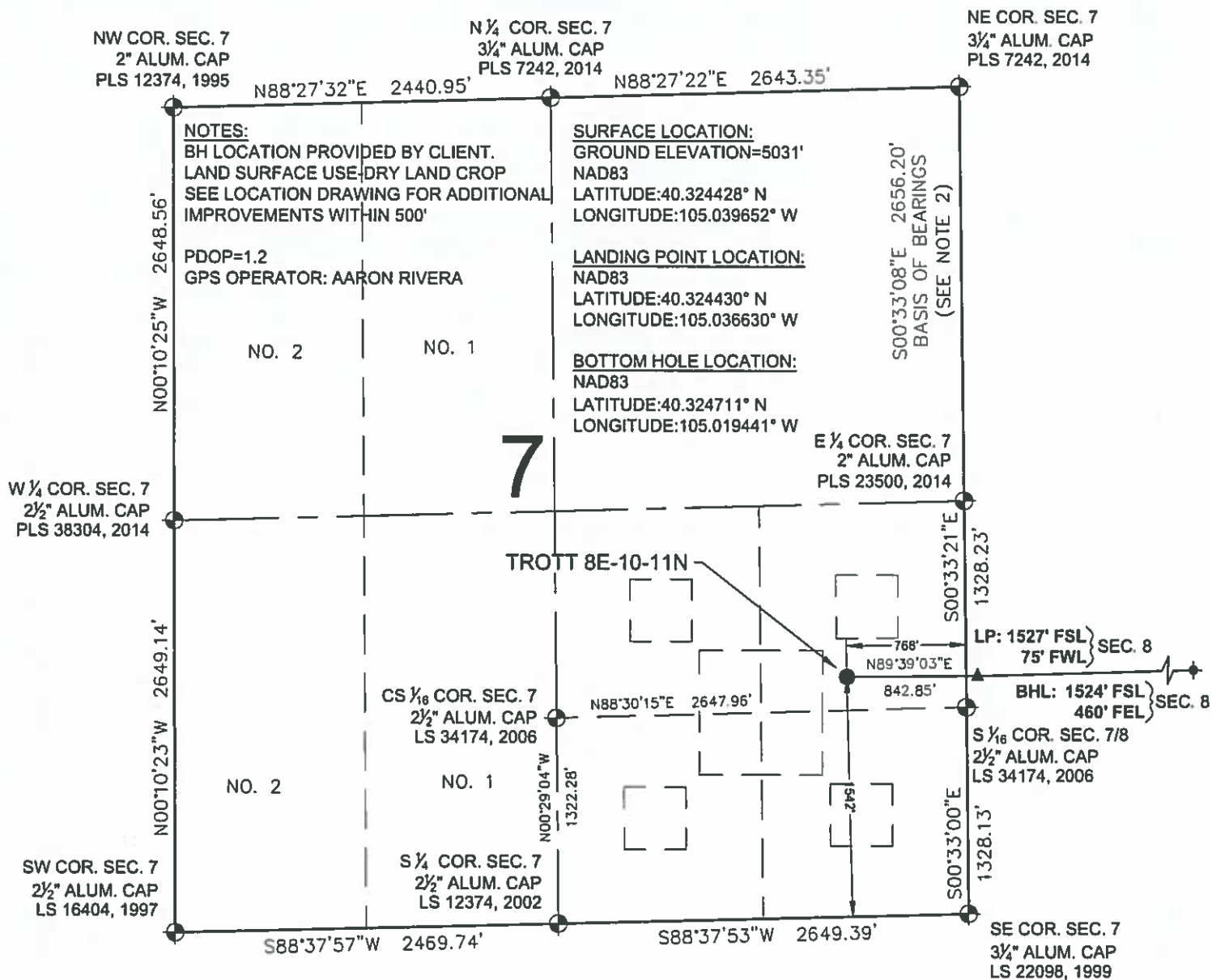

**WELL TROTT 8E-10-11N TO BE
LOCATED 1542' FSL & 768' FEL**

I, MICHAEL L. POOL, A LICENSED PROFESSIONAL LAND SURVEYOR IN THE STATE OF COLORADO DO HEREBY CERTIFY TO **EXTRACTION OIL & GAS**, THAT THE SURVEY AND WELL LOCATION CERTIFICATE SHOWN HEREON WERE DONE BY ME OR UNDER MY DIRECT SUPERVISION AND THAT THE DRAWING SHOWN HEREON ACCURATELY DEPICTS THE PROPOSED LOCATION OF THE WELL. THIS CERTIFICATE DOES NOT REPRESENT A LAND SURVEY PLAT OR IMPROVEMENT SURVEY PLAT AS DEFINED BY C.R.S. 38-51-102 AND CANNOT BE RELIED UPON TO DETERMINE OWNERSHIP.



NOTICE: ACCORDING TO COLORADO LAW YOU MUST COMMENCE ANY LEGAL ACTION BASED UPON ANY DEFECT IN THIS SURVEY WITHIN THREE YEARS AFTER YOU FIRST DISCOVER SUCH DEFECT. IN NO EVENT MAY ANY ACTION BASED UPON ANY DEFECT IN THIS SURVEY BE COMMENCED MORE THAN TEN YEARS FROM THIS SAID DATE OF THIS CERTIFICATION SHOWN HEREON.

MICHAEL L. POOL, PLS 38304
 COLORADO LICENSED PROFESSIONAL LAND SURVEYOR
 FOR AND ON BEHALF OF P.F.S., LLC

SHEET 1 OF 2

PREPARED BY: 7515 Hittop Circle Denver, CO 80221 (303) 928-7128 www.ascentgeomatics.com	FIELD DATE: 04-05-17 DRAWING DATE: 05-02-17 BY: IJM CHECKED BY: CSG	WELL NAME: TROTT 8E-10-11N SURFACE LOCATION: NE 1/4 SE 1/4 SEC. 7, T4N, R68W, 6TH P.M. WELD COUNTY, COLORADO	PREPARED FOR:
---	--	--	-------------------

TROTT 8E-10-11N WELL LOCATION CERTIFICATE

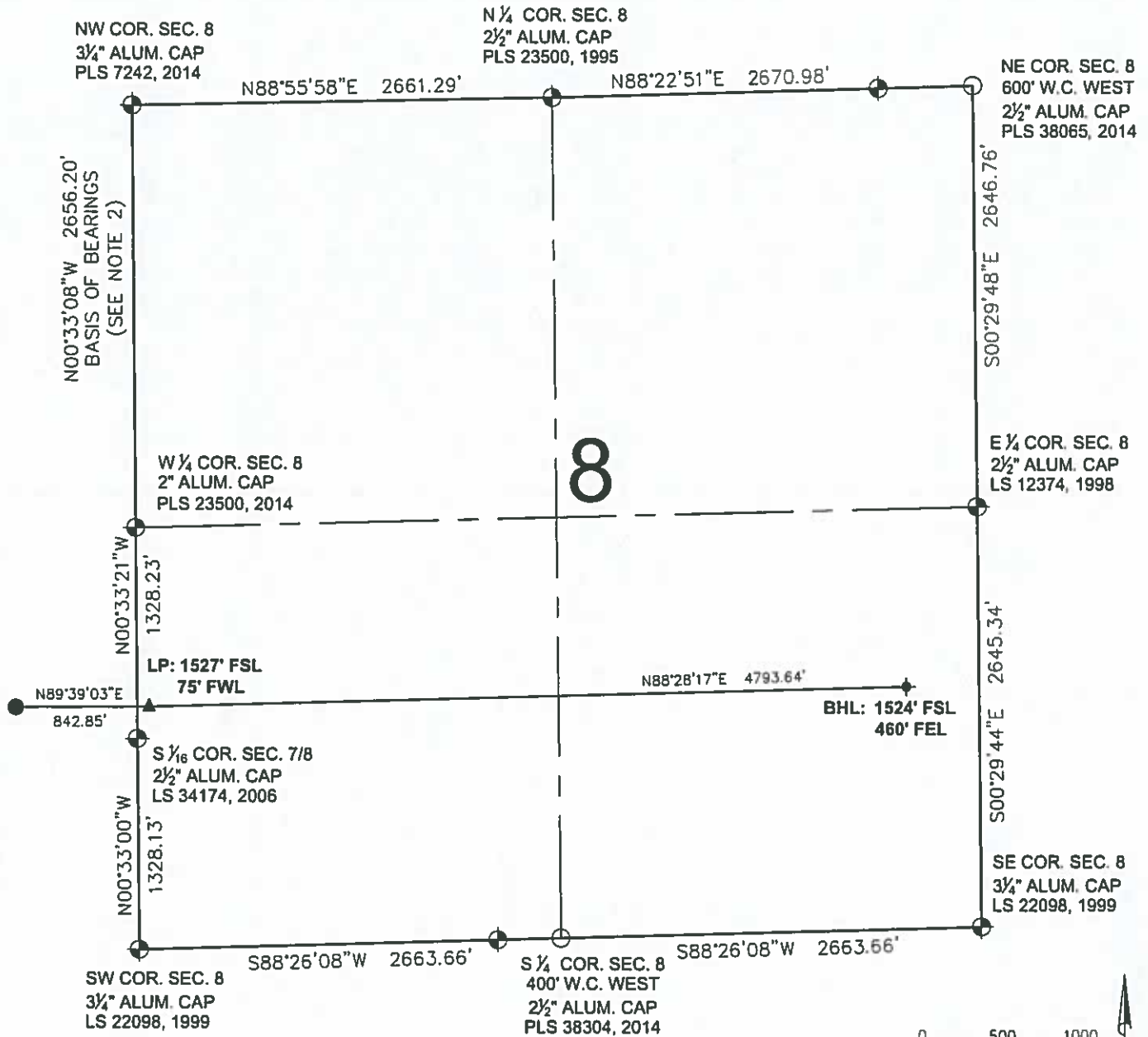

LEGEND

- ⊕ = EXISTING MONUMENT
- = CALCULATED POSITION
- = PROPOSED WELL
- ◆ = EXISTING WELL
- ⬆ = BOTTOM HOLE
- ▲ = LANDING POINT
- LP = LANDING POINT
- BHL = BOTTOM HOLE LOCATION

MICHAEL L. POOL, PLS 38304
COLORADO LICENSED PROFESSIONAL LAND SURVEYOR
FOR AND ON BEHALF OF P.F.S., LLC



SHEET 2 OF 2

PREPARED BY: 7535 Hilltop Circle Denver, CO 80221 (303) 928-7128 www.ascentsurveying.com	FIELD DATE: 04-05-17 DRAWING DATE: 05-02-17 BY: IJM CHECKED BY: CSG	WELL NAME: TROTT 8E-10-11N SURFACE LOCATION: NE 1/4 SE 1/4 SEC. 7, T4N, R68W, 6TH P.M. WELD COUNTY, COLORADO	PREPARED FOR: EXTRACTION Oil & Gas
---	--	--	---