

Physical Address: 345 Comanche St.
Mail to: Box 384, Kiowa, CO 80117
Ph. 303-621-8672 - Fax 303-621-7749
www.highprairiesurvey.com

Job # 11094 Ma-State #1

Inv # 2325

High Prairie Surveying of Kiowa, Colorado has in accordance with a request from **Wiepking Fullerton** has determined the location of **Ma-State #1** to be **620 feet FSL**, and **1988 feet FWL**, (90° off Section lines) of **SECTION 24**, Township **10s**, Range **56w** of the 6th Principal Meridian, **Lincoln County**, Colorado.

Date: Staked on March 4, 2013 drawn on March 7, 2013.

Re: Staked by Keith Westfall

Drawn: Drawn by Dustin Cotter

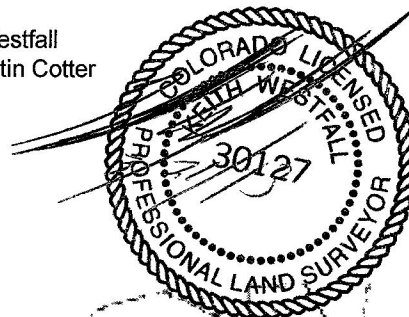

Reference Area

