

LEGEND:

 PROPOSED LOCATION



UELS, LLC
Corporate Office * 85 South 200 East
Vernal, UT 84078 * (435) 789-1017



NEWPEK, LLC

FAUVER #1-20
1900' FSL 660' FWL
NW 1/4 SW 1/4, SECTION 20, T9N, R56W, 6th P.M.
WELD COUNTY, COLORADO

SURVEYED BY	G.W., C.T.	06-01-17	SCALE
DRAWN BY	J.L.G.	06-08-17	1 : 100,000
ACCESS ROAD MAP			TOPO A

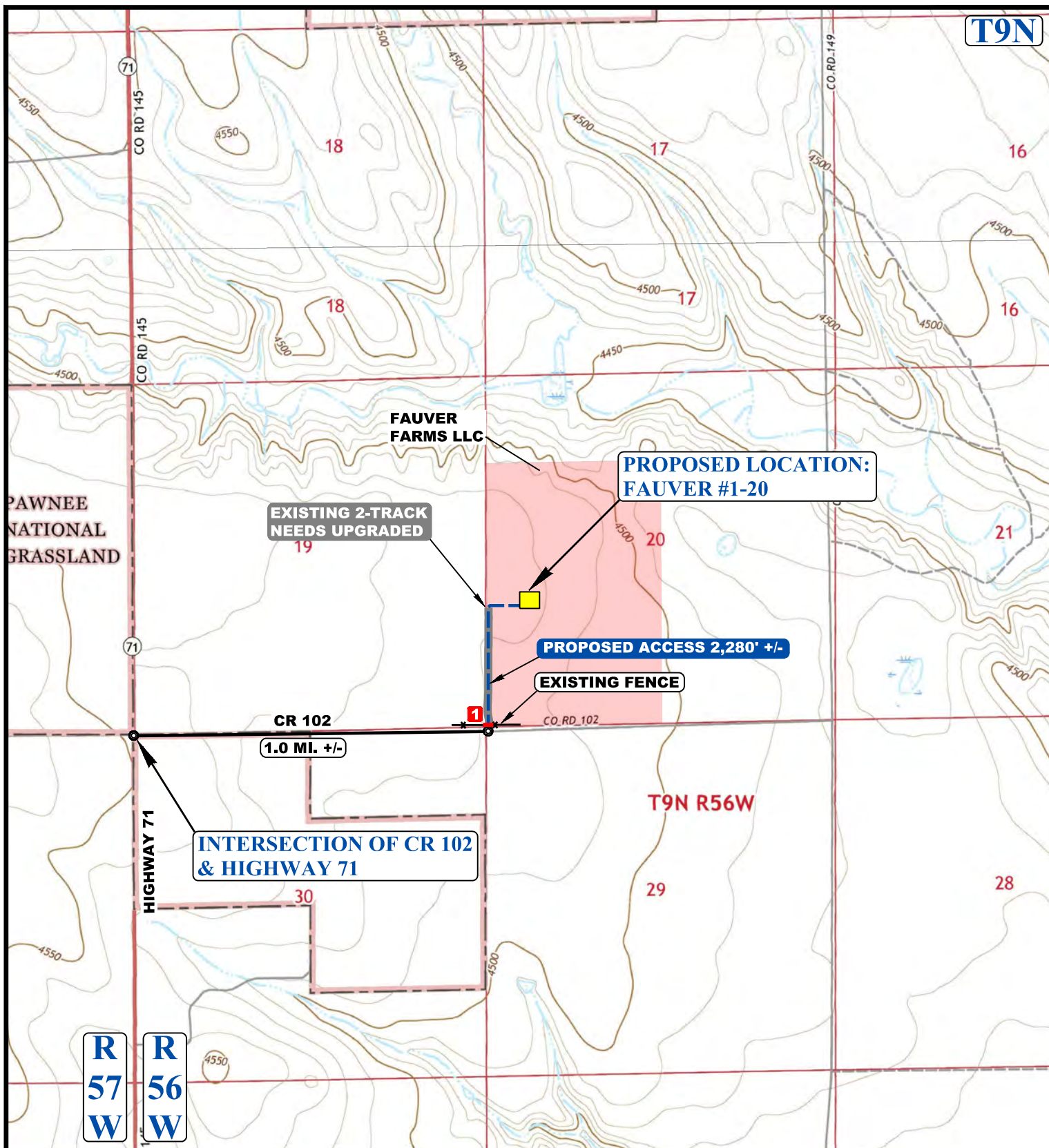

NOTE: PARCEL DATA SHOWN HAS BEEN OBTAINED FROM VARIOUS SOURCES AND SHOULD BE USED FOR MAPPING, GRAPHIC AND PLANNING PURPOSES ONLY. NO WARRANTY IS MADE BY UTAH ENGINEERING AND LAND SURVEYING (UELS) FOR ACCURACY OF THE PARCEL DATA.

LEGEND:

- EXISTING ROAD
- PROPOSED ROAD
- EXISTING 2-TRACK
- INSTALL CATTLE GUARD



UELS, LLC
Corporate Office * 85 South 200 East
Vernal, UT 84078 * (435) 789-1017



NEWPEK, LLC

FAUVER #1-20
1900' FSL 660' FWL
NW 1/4 SW 1/4, SECTION 20, T9N, R56W, 6th P.M.
WELD COUNTY, COLORADO

SURVEYED BY	G.W., C.T.	06-01-17	SCALE
DRAWN BY	J.L.G.	06-08-17	1 : 24,000
ACCESS ROAD MAP			TOPO B