



ENCANA OIL & GAS (USA) INC

Location: COLORADO Slot: Slot #3 24-12
 Field: Weld County Well: Neighbors 24-12
 Installation: SEC.12-T2N-R68W Wellbore: Neighbors 24-12 (PWB)



INTEQ



FINAL MWD SURVEY PLOT

Scale 1 cm = 40 ft

East (feet) ->

-80 0 80 160 240 320 400 480 560 640

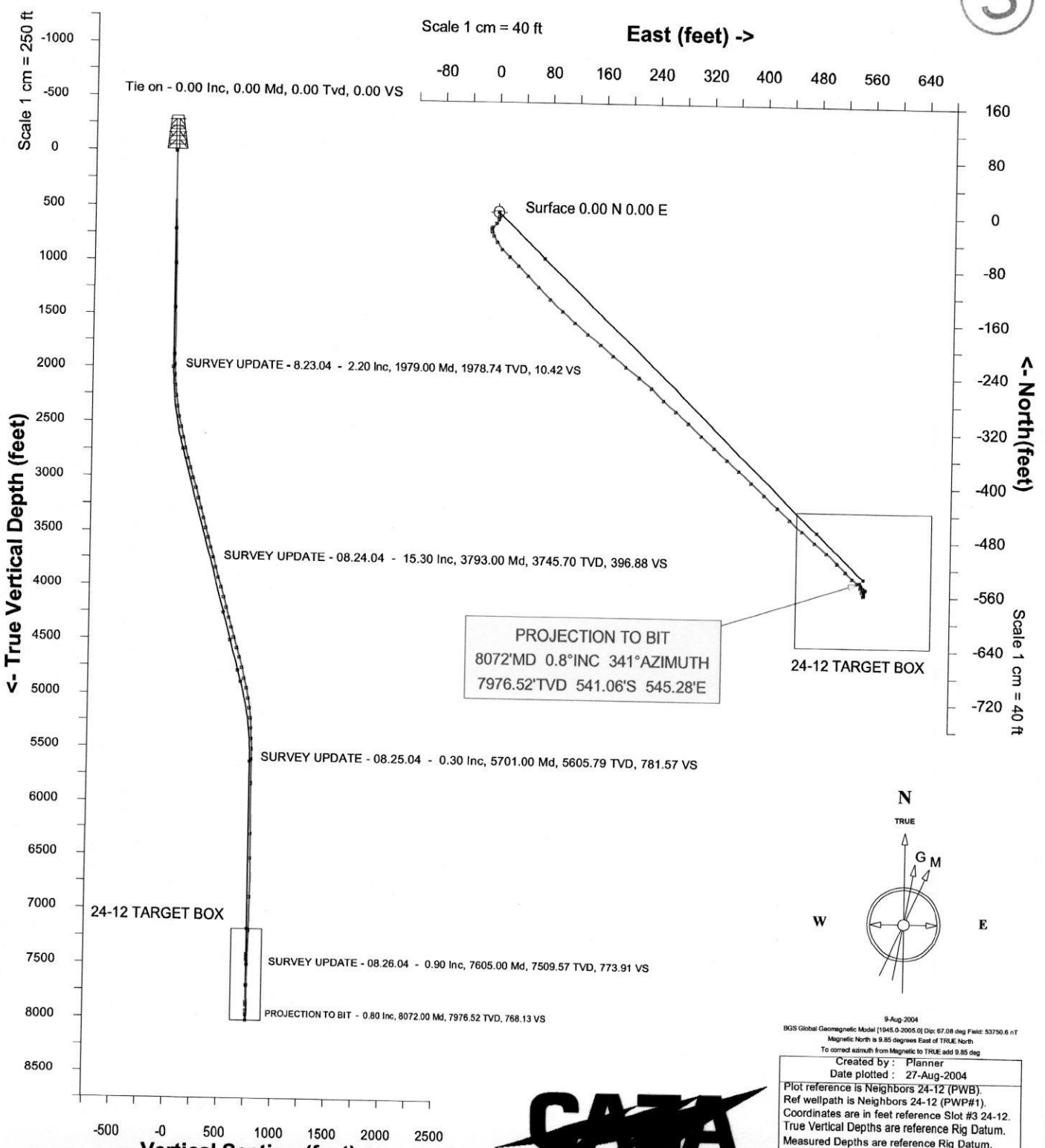

PROJECTION TO BIT
 8072'MD 0.8°INC 341°AZIMUTH
 7976.52'TVD 541.06'S 545.28'E

24-12 TARGET BOX

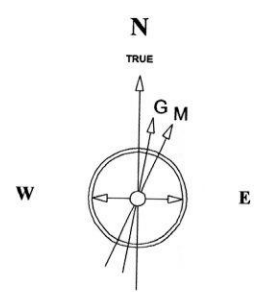

9 Aug 2004
 BGS Global Geomagnetic Model [1945.0-2005.0] Dip: 67.08 deg Field: 53750.6 nT
 Magnetic North is 9.85 degrees East of TRUE North
 To correct azimuth from Magnetic to TRUE add 9.85 deg

Created by: Planner
 Date plotted: 27-Aug-2004
 Plot reference is Neighbors 24-12 (PWB).
 Ref wellpath is Neighbors 24-12 (PWP#1).
 Coordinates are in feet reference Slot #3 24-12.
 True Vertical Depths are reference Rig Datum.
 Measured Depths are reference Rig Datum.
 Rig Datum: Datum #1
 Rig Datum to Mean Sea Level: 0.00 ft.
 Plot North is aligned to TRUE North.



Scale 1 cm = 250 ft

Vertical Section (feet) ->

Azimuth 134.23 with reference 0.00 N, 0.00 E from Slot #3 24-12

ENCANA OIL & GAS (USA) INC, Slot #3
 24-12
 SEC.12-T2N-R68W,
 Weld County, COLORADO

SURVEY LISTING Page 1
 Wellbore: Neighbors 24-12 (AWB)
 Wellpath: Neighbors 24-12 (AWP#1)
 Date Printed: 27-Aug-2004



Wellbore		
Name	Created	Last Revised
Neighbors 24-12 (AWB)	23-Aug-2004	27-Aug-2004

Well		
Name	Government ID	Last Revised
Neighbors 24-12		24-Oct-2003

Slot						
Name	Grid Northing	Grid Easting	Latitude	Longitude	North	East
Slot #3 24-12	297673.8880	2152288.3417	N40 8 57.2640	W104 57 18.8280	21.86N	22.36E

Installation				
Name	Easting	Northing	Coord System Name	North Alignment
SEC.12-T2N-R68W	2152266.1125	297651.8946	CO-N on NORTH AMERICAN DATUM 1927 datum	True

Field				
Name	Easting	Northing	Coord System Name	North Alignment
Weld County	2162679.5372	300202.4514	CO-N on NORTH AMERICAN DATUM 1927 datum	True

Created By

Comments

All data is in Feet unless otherwise stated
 Coordinates are from Slot MD's are from Rig and TVD's are from Rig (Datum #2 0.00ft above Mean Sea Level)
 Vertical Section is from 0.00N 0.00E on azimuth 134.78 degrees
 Bottom hole distance is 768.17 Feet on azimuth 134.78 degrees from Wellhead
 Calculation method uses Minimum Curvature method
 Prepared by Baker Hughes INTEQ



INTEQ

Wellpath Report

MD[ft]	Inc[deg]	Azi[deg]	TVD[ft]	North[ft]	East[ft]	Doqleg [deg/100ft]	Vertical Section[ft]
0.00	0.00	0.00	0.00	0.00N	0.00E	0.00	0.00
709.00	1.10	173.30	708.96	6.76S	0.79E	0.16	5.32
1027.00	0.70	212.00	1026.92	11.44S	0.12E	0.22	8.14
1441.00	1.00	205.60	1440.87	16.84S	2.78W	0.08	9.89
1884.00	1.40	239.70	1883.78	23.06S	9.12W	0.18	9.76
1979.00	2.20	183.80	1978.74	25.46S	10.25W	1.93	10.66
2075.00	3.10	165.20	2074.64	29.81S	9.71W	1.29	14.11
2171.00	5.50	156.10	2170.36	36.53S	7.18W	2.59	20.63
2266.00	7.30	147.00	2264.77	45.75S	2.05W	2.17	30.77
2361.00	8.40	138.90	2358.88	56.04S	5.80E	1.64	43.59
2457.00	10.50	133.20	2453.57	67.32S	16.79E	2.39	59.33
2553.00	12.20	135.00	2547.69	80.48S	30.34E	1.81	78.22
2648.00	13.30	135.40	2640.35	95.36S	45.11E	1.16	99.19
2744.00	14.80	136.40	2733.47	112.10S	61.32E	1.58	122.49
2839.00	15.20	134.60	2825.24	129.63S	78.56E	0.65	147.07
2935.00	15.60	131.50	2917.79	147.02S	97.19E	0.95	172.54
3030.00	15.40	132.00	3009.34	163.93S	116.13E	0.25	197.90
3125.00	16.00	131.10	3100.79	180.97S	135.37E	0.68	223.56
3221.00	14.80	129.40	3193.34	197.46S	154.81E	1.34	248.97
3317.00	14.80	130.70	3286.16	213.23S	173.58E	0.35	273.41
3412.00	15.70	128.70	3377.81	229.18S	192.82E	1.10	298.30
3507.00	14.90	128.70	3469.45	244.86S	212.38E	0.84	323.22
3603.00	14.80	131.50	3562.24	260.70S	231.19E	0.75	347.74
3698.00	15.10	133.50	3654.03	277.26S	249.26E	0.63	372.22
3793.00	15.30	130.10	3745.70	293.85S	267.82E	0.96	397.09
3889.00	15.40	131.10	3838.28	310.39S	287.12E	0.29	422.43
3983.00	16.00	132.20	3928.77	327.29S	306.12E	0.71	447.83
4078.00	16.20	132.20	4020.05	344.99S	325.63E	0.21	474.15
4174.00	14.70	131.80	4112.57	362.10S	344.64E	1.57	499.69
4270.00	14.90	131.10	4205.39	378.34S	363.02E	0.28	524.17
4366.00	15.90	133.60	4297.94	395.52S	381.84E	1.25	549.64
4461.00	16.30	131.50	4389.22	413.33S	401.25E	0.74	575.96
4557.00	15.90	133.30	4481.45	431.27S	420.91E	0.67	602.55
4652.00	15.50	133.60	4572.91	448.95S	439.57E	0.43	628.25
4747.00	15.50	131.50	4664.45	466.12S	458.27E	0.59	653.62
4842.00	15.30	130.00	4756.04	482.58S	477.38E	0.47	678.78
4937.00	13.60	131.80	4848.03	498.09S	495.31E	1.85	702.43
5033.00	12.40	133.20	4941.57	512.67S	511.24E	1.29	724.00
5128.00	9.50	135.40	5034.83	525.23S	524.18E	3.08	742.04
5224.00	7.40	133.30	5129.79	535.12S	534.25E	2.21	756.15
5319.00	5.20	128.30	5224.21	541.98S	542.08E	2.38	766.54
5415.00	2.90	130.70	5319.96	546.26S	547.33E	2.40	773.29
5510.00	2.80	134.60	5414.85	549.46S	550.81E	0.23	778.00
5606.00	0.90	119.20	5510.79	551.47S	553.14E	2.03	781.07
5701.00	0.30	359.50	5605.79	551.59S	553.78E	1.14	781.62
5923.00	0.30	253.50	5827.78	551.17S	553.22E	0.22	780.92
6400.00	1.00	187.00	6304.76	555.66S	551.52E	0.19	782.87
6625.00	1.00	174.30	6529.72	559.56S	551.47E	0.10	785.59
6987.00	1.00	338.90	6891.70	559.76S	550.65E	0.55	785.14
7290.00	1.40	340.30	7194.64	553.80S	548.45E	0.13	779.39
7605.00	0.90	353.00	7509.57	547.73S	546.85E	0.18	773.98
8027.00	0.80	341.00	7931.53	541.65S	545.49E	0.05	768.73

All data is in Feet unless otherwise stated
 Coordinates are from Slot MD's are from Rig and TVD's are from Rig (Datum #2 0.00ft above Mean Sea Level)
 Vertical Section is from 0.00N 0.00E on azimuth 134.78 degrees
 Bottom hole distance is 768.17 Feet on azimuth 134.78 degrees from Wellhead
 Calculation method uses Minimum Curvature method
 Prepared by Baker Hughes INTEQ

ENCANA OIL & GAS (USA) INC, Slot #3
 24-12
 SEC.12-T2N-R68W,
 Weld County, COLORADO

SURVEY LISTING Page 3
 Wellbore: Neighbors 24-12 (AWB)
 Wellpath: Neighbors 24-12 (AWP#1)
 Date Printed: 27-Aug-2004



INTEQ

Wellpath Report							
MD[ft]	Inc[deg]	Azi[deg]	TVD[ft]	North[ft]	East[ft]	Dogleg [deg/100ft]	Vertical Section[ft]
8072.00	0.80	341.00	7976.52	541.06S	545.28E	0.00	768.17

All data is in Feet unless otherwise stated
 Coordinates are from Slot MD's are from Rig and TVD's are from Rig (Datum #2 0.00ft above Mean Sea Level)
 Vertical Section is from 0.00N 0.00E on azimuth 134.78 degrees
 Bottom hole distance is 768.17 Feet on azimuth 134.78 degrees from Wellhead
 Calculation method uses Minimum Curvature method
 Prepared by Baker Hughes INTEQ

ENCANA OIL & GAS (USA) INC, Slot #3
 24-12
 SEC.12-T2N-R68W,
 Weld County, COLORADO

SURVEY LISTING Page 4
 Wellbore: Neighbors 24-12 (AWB)
 Wellpath: Neighbors 24-12 (AWP#1)
 Date Printed: 27-Aug-2004



Comments

MD(ft)	TVD(ft)	North(ft)	East(ft)	Comment
1979.00	1978.74	25.46S	10.25W	SURVEY UPDATE - 8.23.04
3793.00	3745.70	293.85S	267.82E	SURVEY UPDATE - 08.24.04
5701.00	5605.79	551.59S	553.78E	SURVEY UPDATE - 08.25.04
7605.00	7509.57	547.73S	546.85E	SURVEY UPDATE - 08.26.04
8072.00	7976.52	541.06S	545.28E	PROJECTION TO BIT

Survey Tool Program

Reference	Survey Name	MD(ft)	TVD(ft)	Survey Tool	Error Model
360241	Log #1	1979.00	1978.74	Navi Trak	Standard
360800	Log #2	3793.00	3745.70	Navi Trak	
361396	Log #3	5701.00	5605.79	Navi Trak	Standard
361959	Log #4	7605.00	7509.57	Navi Trak	Standard
363365	Log #5	8072.00	7976.52	Navi Trak	Standard

All data is in Feet unless otherwise stated
 Coordinates are from Slot MD's are from Rig and TVD's are from Rig (Datum #2 0.00ft above Mean Sea Level)
 Vertical Section is from 0.00N 0.00E on azimuth 134.78 degrees
 Bottom hole distance is 768.17 Feet on azimuth 134.78 degrees from Wellhead
 Calculation method uses Minimum Curvature method
 Prepared by Baker Hughes INTEQ