

T7N, R80W, 6th P.M.

SandRidge Exploration & Production, LLC

Lease Area Plan, Mallard 0780 1-15H22 located as shown in Sections 15, 16, and 22 of T7N, R80W, 6th P.M., Jackson County, Colorado.

BASIS OF BEARINGS:  
US STATE PLANE 1983  
CO NORTH 0501 GRID

BASIS OF ELEVATION  
SPOT ELEVATION AT THE NE CORNER OF SECTION 16, T7N, R80W, 6TH PM, TAKEN FROM THE MAC FARLANE RESERVOIR QUADRANGLE, USGS 7.5 MIN QUAD (TOPOGRAPHIC MAP) WITH SAID ELEVATION MARKED AS BEING 8120 FEET.

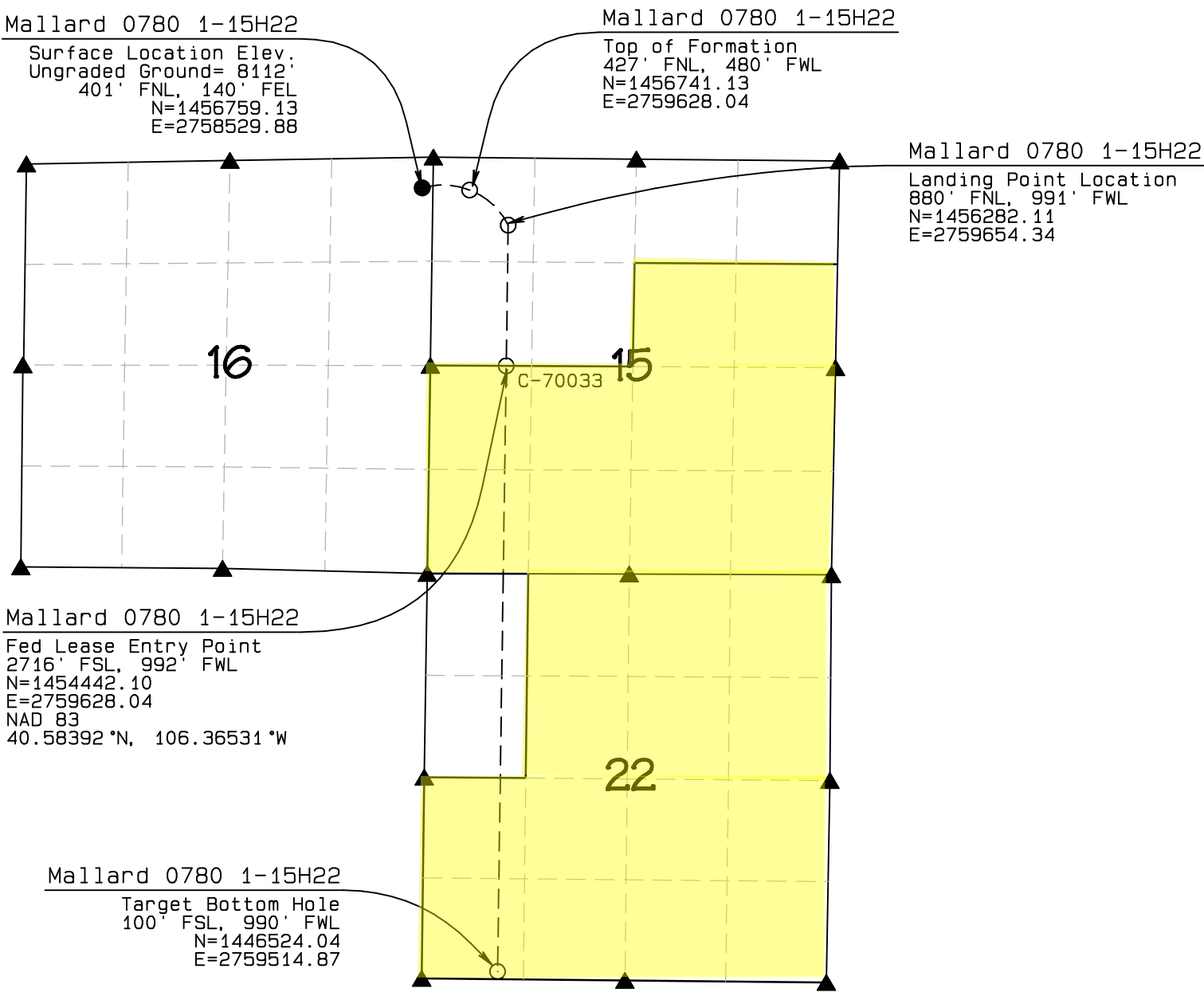

THIS IS TO CERTIFY THAT THE ABOVE PLAT WAS PREPARED FROM FIELD NOTES OF ACTUAL SURVEYS MADE BY ME OR UNDER MY SUPERVISION AND THAT THE SAME ARE TRUE AND CORRECT TO THE BEST OF MY KNOWLEDGE AND BELIEF.



RANDALL R. MILNER  
COLORADO PLS NO. 38084  
(970) 723-3725



GRAPHIC SCALE 1"=2000'



2000 0 2000

LEGEND

FOUND CORNER ▲  
PROPOSED WELL ●  
PROPOSED BHL/LPL ○

NORTH PARK ENGINEERING &  
CONSULTING, INC.

P.O. BOX 395  
WALDEN, CO 80480  
(970) 723-3725

DATE OF FIELD WORK: APR 19, 2017 DRAWING COMPLETION: MAY 24, 2017  
SURVEYED BY: LRK DRAWN BY: ADL CHECKED BY: RRM