



Lat40°, Inc. 6250 W. 10th Street, Unit 2, Greeley, CO 970-515-5294

NOTIFICATION ZONE DRAWING

KLIPPERT 5N63W19 1-10 PAD

SECTION: 19
TOWNSHIP: 5N
RANGE: 63W
6TH. P.M.
WELD COUNTY, CO

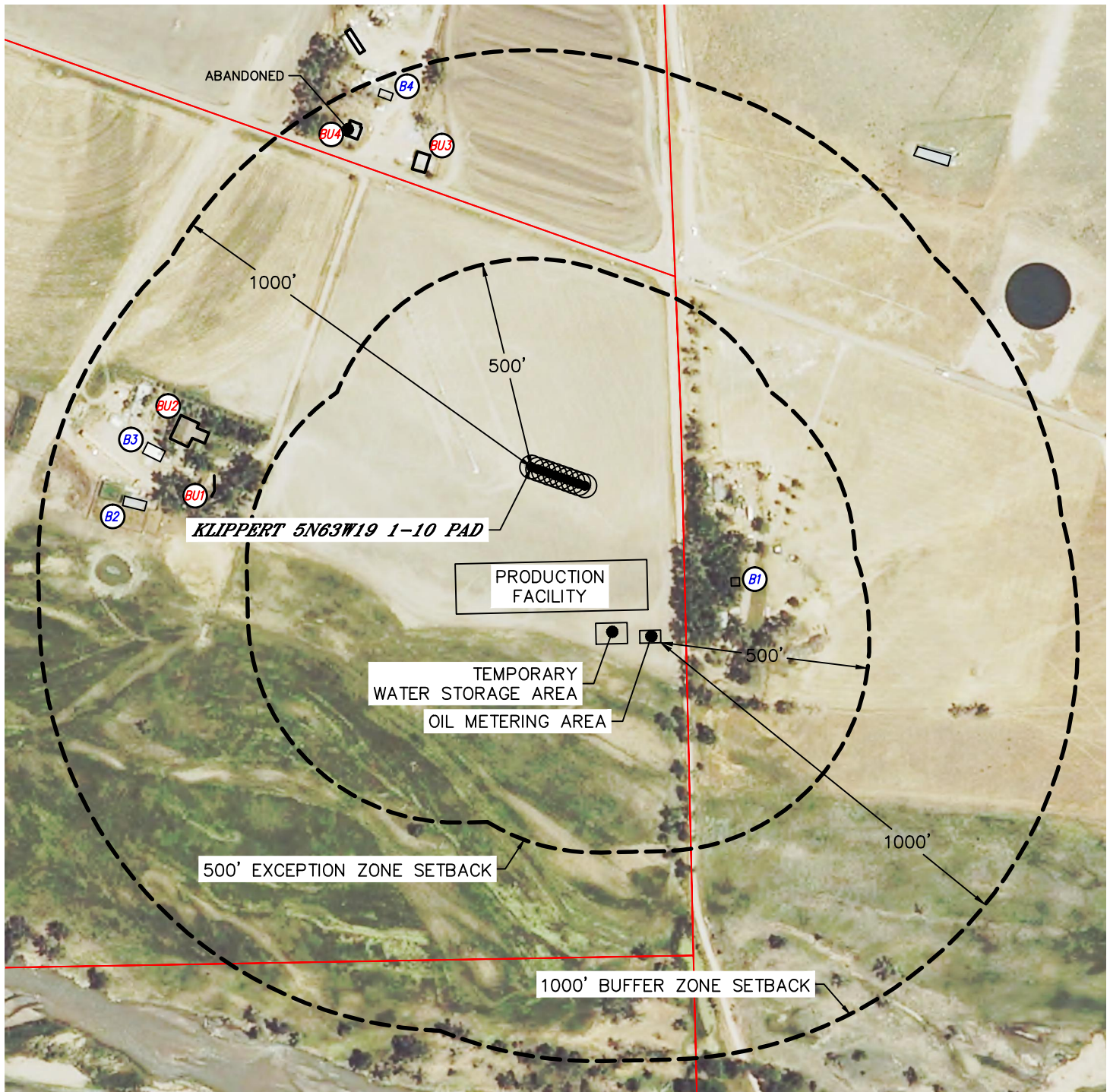

EXCEPTION ZONE:

NO EXISTING BUILDING UNITS WITHIN EXCEPTION ZONE

BUFFER ZONE:

- BUILDING UNIT BU1 ±603' NW
- BUILDING UNIT BU2 ±667' NW
- BUILDING UNIT BU3 ±751' NW
- BUILDING UNIT BU4 ±890' NW

LEGEND

- PROPERTY LINE
- BUILDING
- BUILDING UNIT

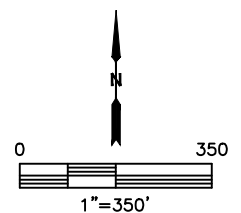

DATE: 3/31/2017
PROJECT#: 2016094