



Lat40°, Inc. 6250 W. 10th Street, Unit 2, Greeley, CO 970-515-5294

# HYDROLOGY MAP

KLIPPERT 5N63W19 1-10 PAD

SECTION: 19  
TOWNSHIP: 5N  
RANGE: 63W  
6TH. P.M.  
WELD COUNTY, CO

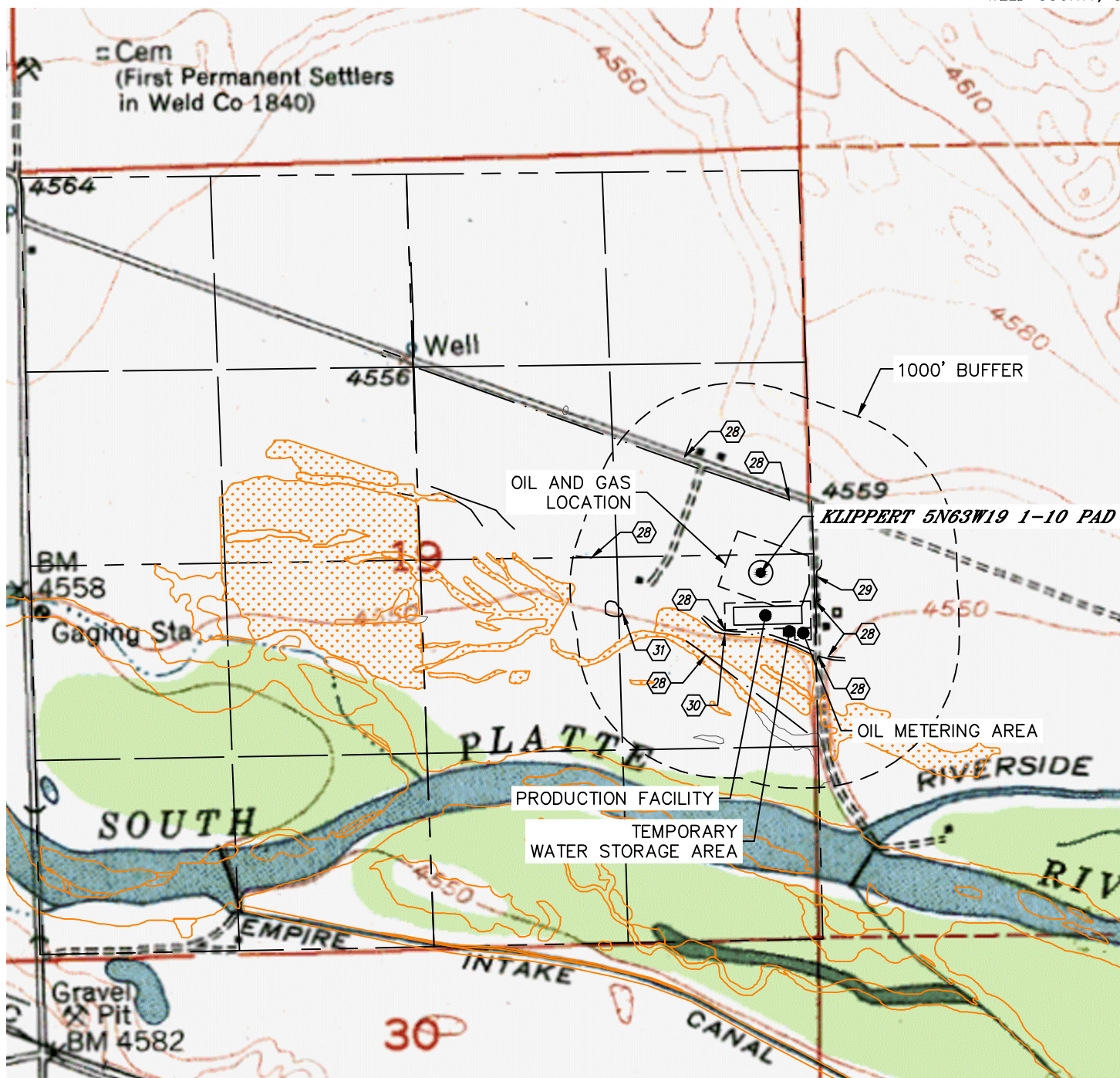

DISTANCES MEASURED FROM THE EDGE OF THE OIL AND GAS LOCATION.

- 28 DITCH 5' S, 35' E, 122' & 162' SE, 214' SW, 314' NE, 619' & 878' NW
- 29 BORROW DITCH 49' E
- 30 APPROXIMATE EDGE OF USFSW NATIONAL WETLANDS INVENTORY 31' S
- 31 POND 689' W

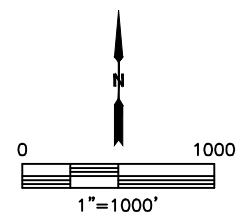

NEAREST DOWN GRADIENT SURFACE WATER: DITCH 5' S

DATE: 3/31/2017  
PROJECT#: 2016094