



---

**Corporate Office**  
1775 Sherman Street, #3000  
Denver, Colorado 80203  
303.860.5800  
www.pdce.com

June 15, 2017

Department of Natural Resources  
Oil and Gas Conservation Commission  
The Chancery Building  
Attn: Matt Lepore  
1120 Lincoln St., Suite 801  
Denver, CO 80203

Re: **30 Day Certification Letter – Rule 318Ae**  
Sandin 24V-401  
SWNE Section 24, T5N-R65W, 6<sup>th</sup> PM  
Weld County, Colorado

Dear Director,

PDC Energy, Inc. ("PDC") hereby certifies to the Director that a thirty (30-day) notice has been given by certified mail to all owners in the proposed wellbore spacing unit consisting of T5N-R64W Section 7: W2W2, Section 18: W2W2, Section 19: NWNW; T5N-R65W Section 12: E2E2, Section 13: E2E2, Section 24: NENE, 720 acres. We have not received any objections to such well location or proposed spacing unit, therefore, PDC hereby requests the Director to approve the well.

If you should have any questions or concerns regarding this permit, please contact the undersigned at (303) 318-6102.

Sincerely,

A handwritten signature in blue ink that reads "Venessa Chase".

Venessa Chase  
Permitting Supervisor - Wattenberg  
PDC Energy

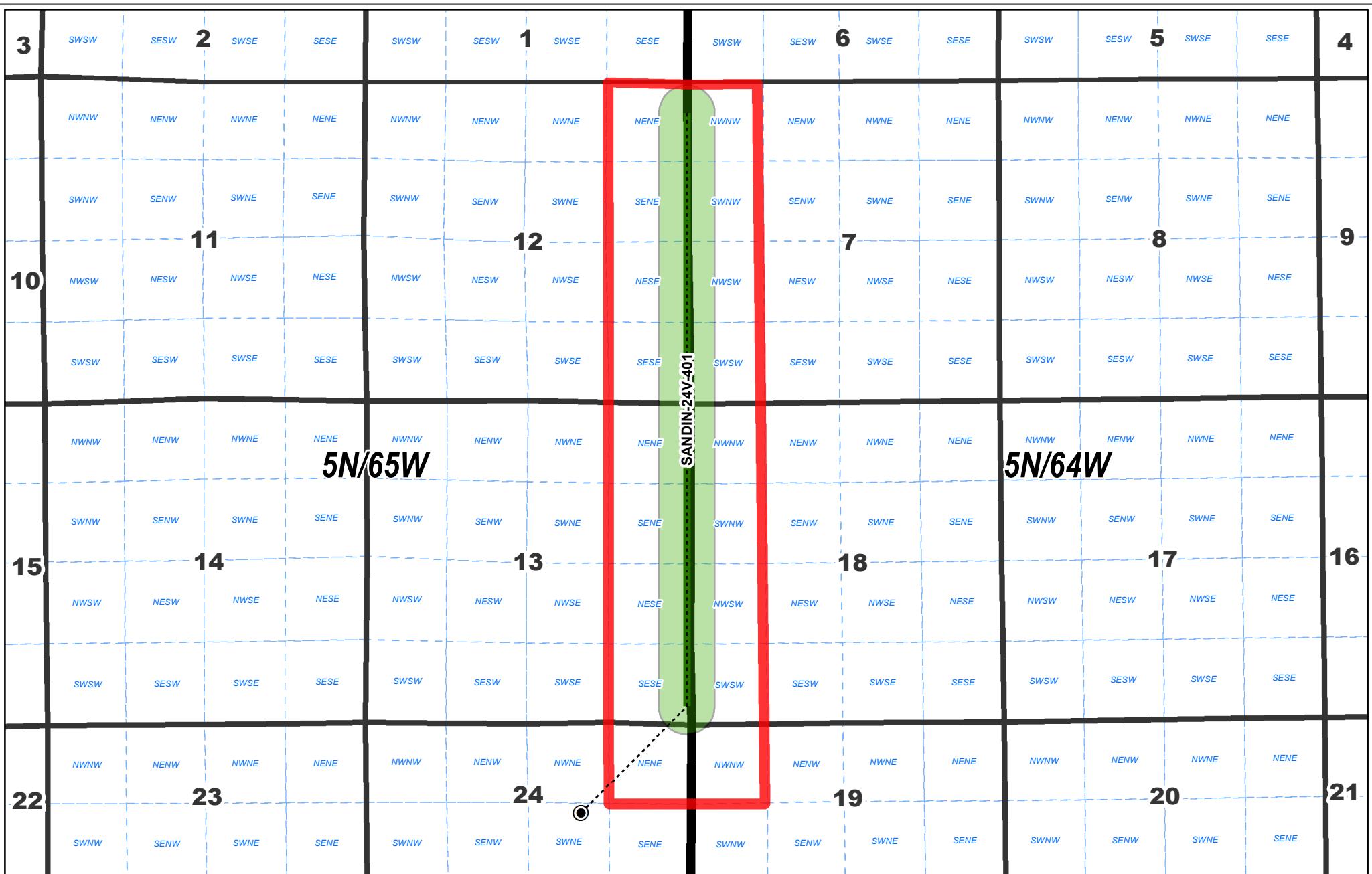

**DJ Preliminary Proposed Spacing Unit**  
**SANDIN 24V-401**

**Date: 6/15/2017**

**Legend**

- Townships
- Sections
- Qtr Qtr (Weld Cty)
- Preliminary Proposed Spacing Unit
- 460' Foot Wellbore Buffer
- Spaced Wellbore

Disclaimer:  
PDC Energy, Inc. makes no representation or warranty regarding the accuracy or completeness of this map, which is being provided as a courtesy only. PDC Energy, Inc. expressly disclaims all liability and responsibility for any representation, warranty, statement or depiction in this map, whether express, statutory or implied, as to the content, character or nature of any information contained in this map, including, but not limited to, the leasehold acreage positions, well locations and statuses or any other information depicted. Any conclusions derived from this map are at the sole cost, risk and expense of the user.  
© 2014 PDC Energy, Inc. All Rights Reserved.

