

# WARNER 01N-64W-17 PAD REFERENCE AREA MAP

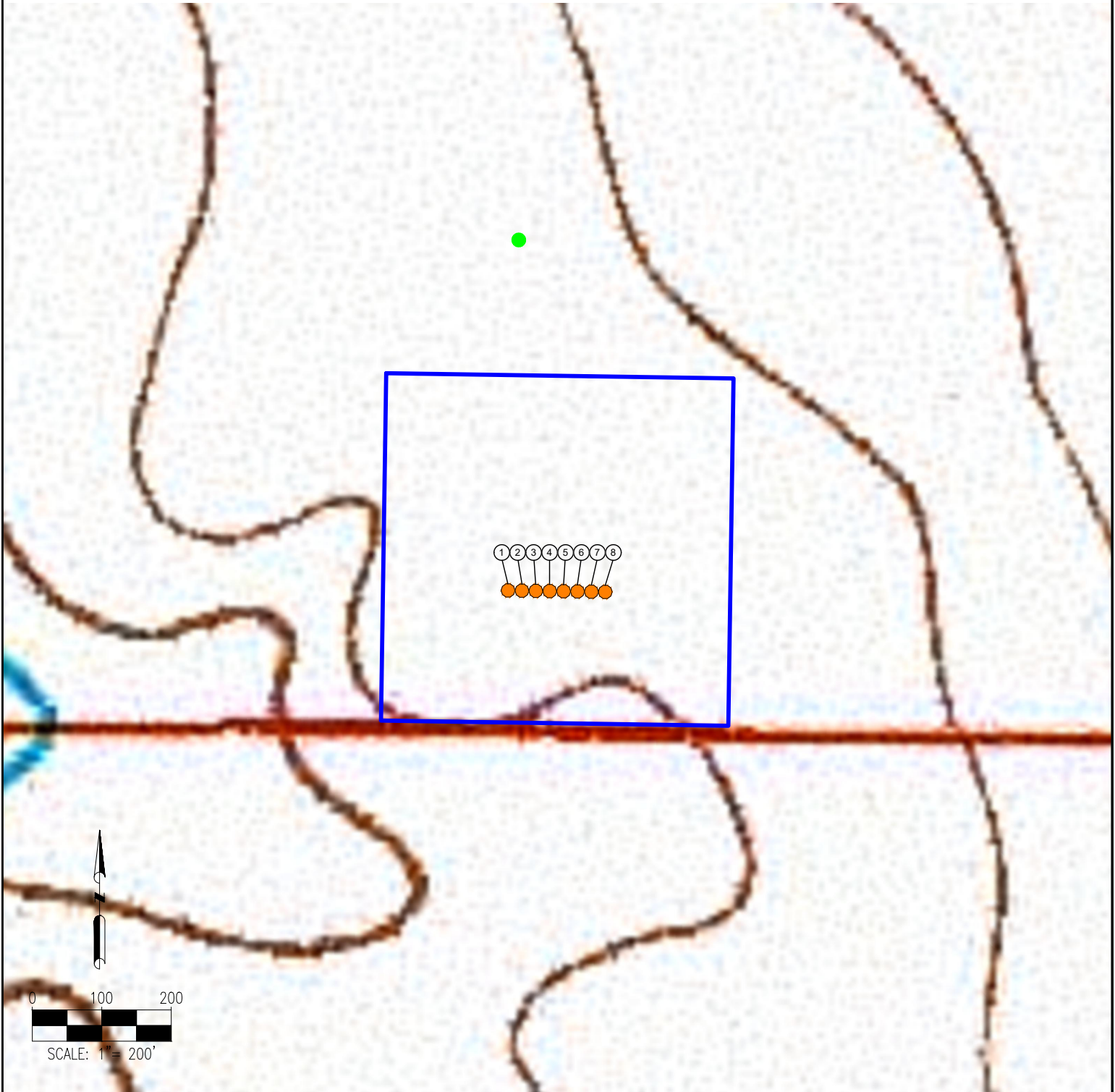

1. WARNER 01N-64W-17-1H
2. WARNER 01N-64W-17-2H
3. WARNER 01N-64W-17-3H
4. WARNER 01N-64W-17-4H
5. WARNER 01N-64W-17-5H
6. WARNER 01N-64W-17-6H

7. WARNER 01N-64W-17-7H
8. WARNER 01N-64W-17-8H

## REFERENCE LOCATION

\*\*REFERENCE PHOTO POINT\*\*

LAT: 40.046091° N  
LONG: 104.575708° W  
ELEVATION: 5071'

DISCLAIMER:  
THIS PLOT DOES NOT REPRESENT A MONUMENTED LAND SURVEY AND SHOULD NOT BE  
RELIED UPON TO DETERMINE BOUNDARY LINES, PROPERTY OWNERSHIP OR OTHER  
PROPERTY INTERESTS. PARCEL LINES, IF DEPICTED HAVE NOT BEEN FIELD VERIFIED AND  
MAY BE BASED UPON PUBLICLY AVAILABLE DATA THAT ALSO HAS NOT BEEN  
INDEPENDENTLY VERIFIED.

DATA SOURCE:  
TOPO MAP: USGS

PUBLICLY AVAILABLE DATA SOURCES HAVE NOT BEEN  
INDEPENDENTLY VERIFIED BY PFS.

## LEGEND:



= PROPOSED WELL



= REFERENCE PHOTO POINT



= DISTURBANCE AREA

PREPARED BY:



7535 HiTop Circle  
Denver, CO 80221  
(303) 928-7128  
www.ascentgeomatics.com

FIELD DATE:  
03-16-17

DRAWING DATE:  
04-19-17

BY:  
DJP

CHECKED BY:  
MMP

SITE NAME:

WARNER 01N-64W-17 PAD

SURFACE LOCATION:

SE 1/4 SW 1/4 SEC. 17, T1N, R64W, 6TH P.M.

WELD COUNTY, COLORADO

PREPARED FOR:

