

# FRANE SURVEYING INC.

Physical Address: 34834 Annie Cir.  
Mail to: Box 2372, Elizabeth, CO 80107  
Ph. 303-243-0037  
www.franesurveying.com  
Job # 17-068 Yellowstone 1-2

Frane Surveying of Elizabeth, Colorado, has in accordance with a request from **Grand Mesa Operating CO.** has determined the location of **Yellowstone 1-2** to be **2072 feet FNL**, and **1312 feet FEL**, of **SECTION 2**, Township **8s**, Range **55w** of the 6th Principal Meridian, **Lincoln County**, Colorado.

Date: Staked on 04/10/17 drawn on 04/29/17.

Re:

Drawn:

Staked by Elijah Frane

Drawn by Elijah Frane

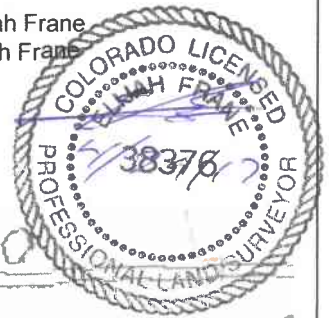

## 1000' Hydrology Map

